

# **DEFIANT**

## **VERTICAL BLINDS**

**VL30 / VL31**  
**Premium Profiled**

**FITTING INSTRUCTIONS**

# VL30

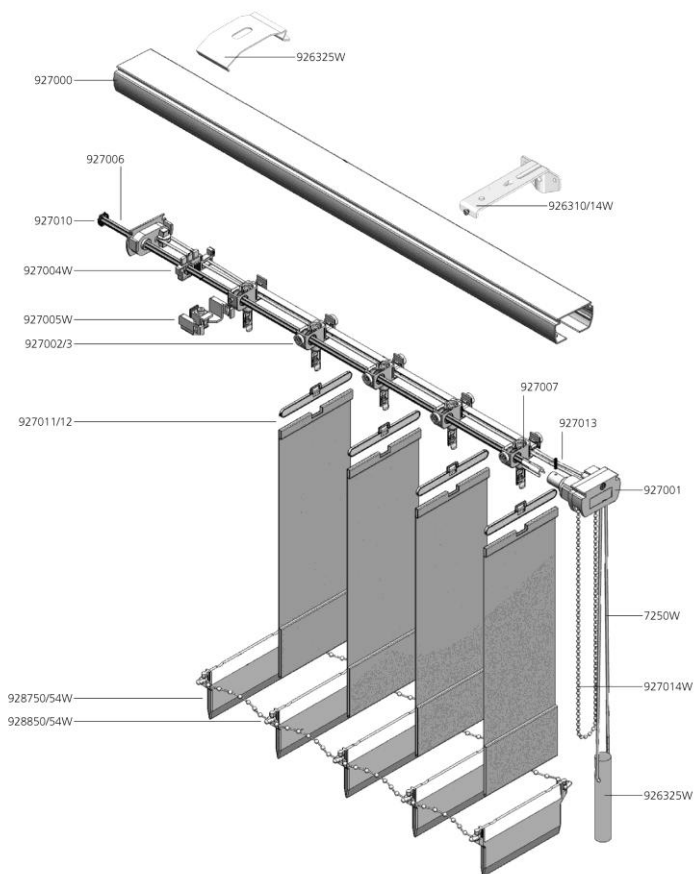

# DEFIANT

## VL30 Premium Profiled

## VL31 Premium Profiled with wand control

### FITTING INSTRUCTIONS

#### Top-Fix Brackets

Fix brackets to ceiling or lintel with holes drilled on a line at least 75mm from the wall or window frame for blinds with 127mm louvres or 55mm for blinds with 89mm louvres. End brackets should be about 40mm from the ends of the track. Any remaining brackets should be spaced evenly between these two brackets.

#### Face-Fix Brackets

Fix brackets to wall or window frame as closely as possible to the ceiling or lintel with same spacing as recommended for the top fixing brackets.

#### Fitting the Track

The track must be fitted into the brackets keeping controls to side ordered. Locate the small lip projecting from brackets into groove in track. Push track up into brackets. Spring clip brackets will hold track without further adjustment. If brackets have retaining screws, these should now be screwed into the other slot in the track.

**Please do not over tighten the screws. This is unnecessary and will damage the track.**

#### VL30

Remove packing material from track, releasing the cord and chain; the cord control traverses the louvres and the chain control rotates them.

#### Fitting the Louvres

Turn hooks so that the slots are 90° to the track. Hang the louvres, keeping all seams facing the same way. Your blind is now ready to operate.

**NB. Do not traverse blinds with louvres in closed position. Always turn them 90° to the track before operating cord control.**

## **Optional cord and chain tidy**

Fix rear section to wall or window frame so that bottom of chain and cord loops fit neatly into it. Press in front section so that loops are enclosed.

## **Child Safety**

Please read the Child Safety Warning Tag and ensure it remains attached to the blind.

**Yewdale Bridge  
Enterprise Way  
Wickford  
Essex  
SS11 8DH**

**Tel: 01268 570900  
Fax: 01268 732509  
Email: [sales@yewdalebridge.com](mailto:sales@yewdalebridge.com)**

©Yewdale Bridge November 2007 E & OE