

DEFIANT

ROLLER BLINDS

**R20 Sidewinder
R20C Crank
R20S Spring
Roller Blinds**



FITTING INSTRUCTIONS

No. 936

DEFIANT

R20 Sidewinder

ES

933015W Universal end set 32mm

933025W Universal end set 40mm

933035W Universal end set 45mm

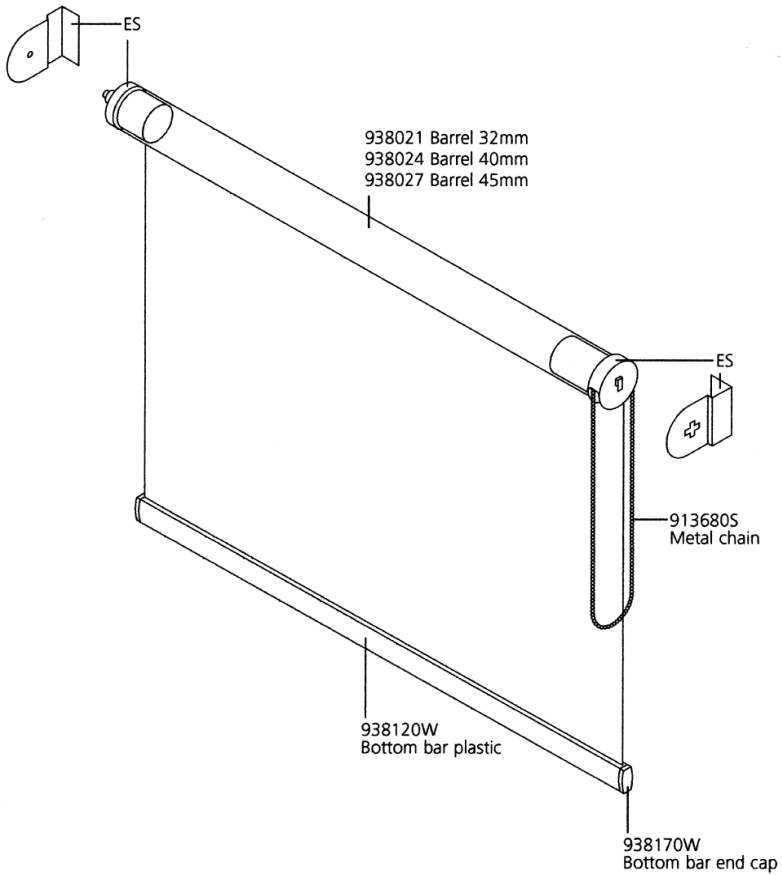

DEFIANT R20 Sidewinder

FITTING INSTRUCTIONS

- 1 The standard universal metal brackets supplied with the blind may be top, face or side-fixed.
- 2 Check that blind fits correctly. The pin-end is sprung for easy fitting, but the pin should be depressed once in place. The fabric should roll off the BACK of the barrel, unless ordered reverse-roll.
- 3 Fix the control-end bracket using appropriate screws/plugs.
- 4 Locate the blind in the control-end bracket, and mark position of pin-end bracket.
- 5 Remove blind and fix pin-end bracket using appropriate screws/plugs.
NB. To operate correctly, blind MUST be fixed level.
- 6 Insert pin in pin-end of blind into bracket. Press blind against bracket to depress sprung pin, and insert lug on control-end into its bracket until it drops into place.
- 7 Check that blind operates correctly.

OPTIONAL COMPONENTS

- A Plastic bracket covers. These are simply slid over the brackets and clicked into place.
- B Chain tidy. Fix rear section to wall or window frame so that bottom of chain loop fits neatly into it. Press in front section so that loop is enclosed.

NB. Large blinds are heavy and it is important that the correct fixings are used. If unsure, seek expert advice. Chain or cord loops should be out of reach of young children.

DEFIANT R20C Crank Control

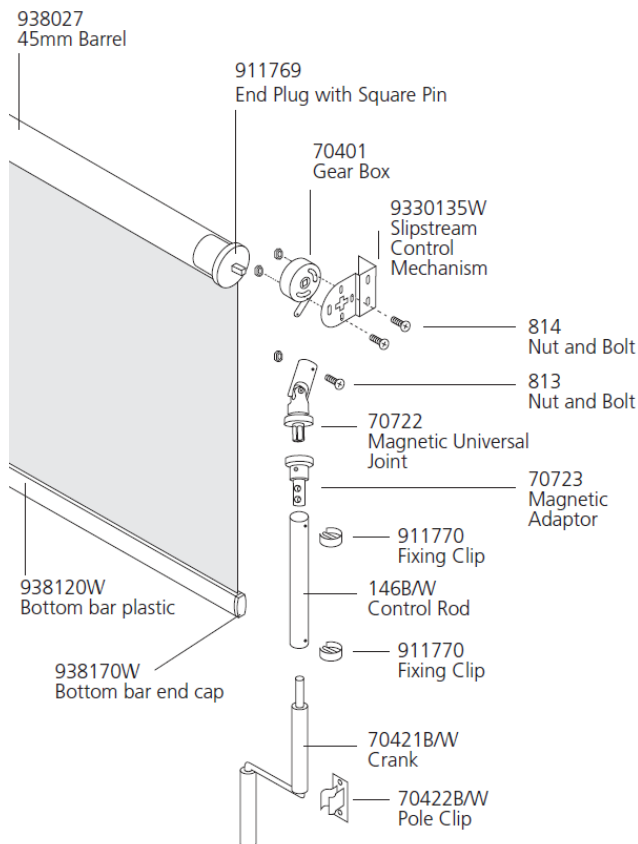

FITTING INSTRUCTIONS

- 1 Fit as per the R20 Sidewinder instructions but please see parts diagram above (Gear Box can be rotated to cater for face fix or top fix requirements).

DEFIANT R20S Spring Control

(Back Bar is optional extra)

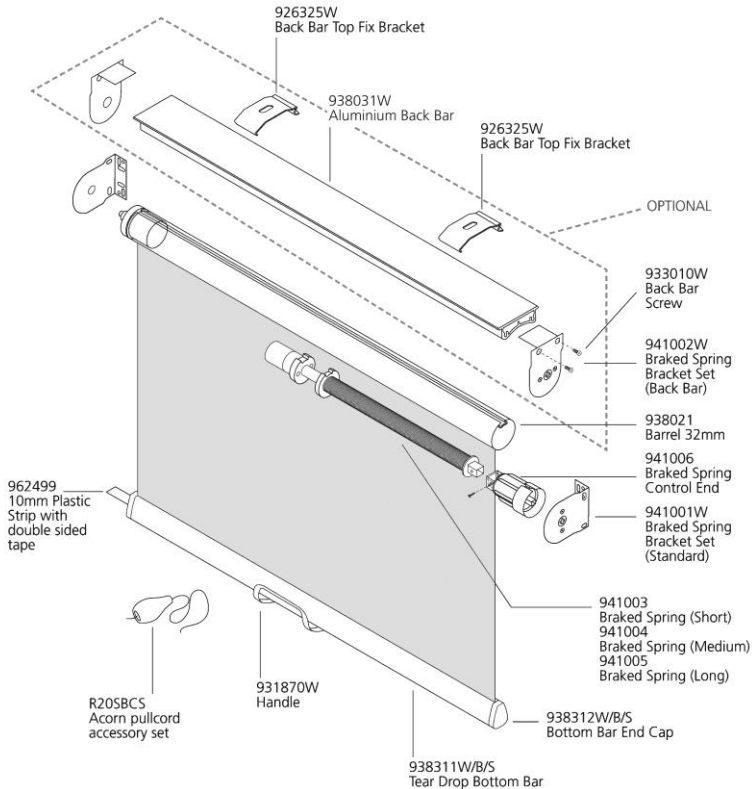

FITTING INSTRUCTIONS

- 1 Fit as per the R20 Sidewinder instructions but please see parts diagram above (back bar is optional).
- 2 Spring must be on the right hand side unless fabric is reverse rolled.

Continued over...

- 3 The spring would have been tensioned during manufacture but the tension can be increased or decreased if required. If the fabric does not wind up completely when the blind is operated greater spring tension can be applied as follows:
- a. Bring the blind down 250mm from its uppermost position.
 - b. Remove the blind from the brackets and roll the fabric by hand back onto the barrel.
 - c. Replace the blind in the brackets.
 - d. If tension is still not enough, repeat steps a to c.
 - e. If tension too much follow the above but in reverse ie remove blind from brackets and unroll the fabric by hand of the roller.
- Ensure blind is not over tensioned as it will result in the bottom bar crashing into the blind and potentially jamming.
- If the blind is installed outside the recess then adjusting the tension can be done without taking the blind out of its brackets if preferred. Use a flat head screwdriver through the hole in the bracket to either increase or decrease the tension as desired.

**Yewdale
Enterprise Way
Wickford
Essex
SS11 8DH**

**Tel: 01268 570900
Fax: 01268 732509
Email: sales@yewdale.co.uk
Web: www.yewdale.co.uk**

©Yewdale August 2013 E & OE