

SPECIFICATION

LAMP TYPE: LED

FINISH: WHITE (RAL 9003)

MATERIALS: POLYCARBONATE / MILD STEEL

WEIGHTS:

600MM(L) - HF 2.2KG

1200MM(L) - HF 3.5KG, HFEM/EP 4KG

1800MM(L) - HF 4.5KG, HFEM/EP 5KG

SUPPLY: 220 - 240V AC, 50/60Hz

POWER:

600MM(L) = 19W (1700 lumens)

1200MM(L) = 37W (3500 lumens)

1800MM(L) = 49W (5000 lumens)

OPERATING TEMP: 0° - 25° C

CONNECTION: 2.5MM INPUT TERMINAL BLOCK

IP RATING: IP54

GENERAL INFORMATION

- 1 – A QUALIFIED ELECTRICIAN, IN ACCORDANCE WITH IEE WIRING REGULATION SHOULD CARRY OUT CONNECTION TO MAINS WIRING
 - 2 – THIS FITTING MUST BE EARTHED
 - 3- ENSURE THAT THE RATED VOLTAGE AND FREQUENCY REQUIREMENTS ARE COMPATIBLE WITH THE AVAILABLE MAINS SUPPLY
 - 4 – CLEANING OF THE DIFFUSER SHOULD BE CARRIED OUT USING CLEAN, SOFT AND LINT FREE CLOTHS. USE ANTI STATIC CLEANING FLUID
 - 5 – DO NOT CARRY OUT HIGH VOLTAGE INSULATION TESTS, I.E 500/1000V, THIS MAY DAMAGE INTERNAL COMPONENTS
- IMPORTANT! WHEN CONTINUOUSLY LINKING PRODUCTS WITH A COM6 PRESENT, THE FOLLOWING CONSTRAINTS APPLY;
HF - MAX 2amp SWITCHING
DALI / DSI - MAX 4 DRIVERS

TECHNICAL SUPPORT

Telephone: 0161 331 5700

E-mail: technical@whitecroflighting.com

<http://www.whitecroflighting.com/>

Whitecroft
lighting

STYLUS AREA & COMFORT

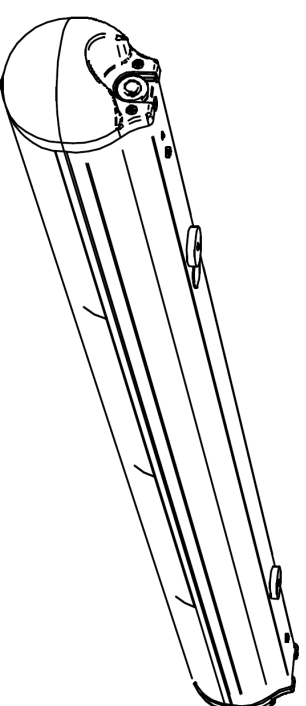

Installation Instructions

PKLEAFLETSYUGR

REV (6) -Mar 2018



Whitecroft Lighting Limited

Burlington Street, Ashton-under-Lyne, Lancashire OL7 0AX

Telephone +44 (0)161 331 5700

Facsimile: +44 (0)870 5 084 210

Registered No. 3848973 England

Registered Office: As above

STYLUS AREA & COMFORT INSTALLATION

WHITECROFT LIGHTING LIMIED

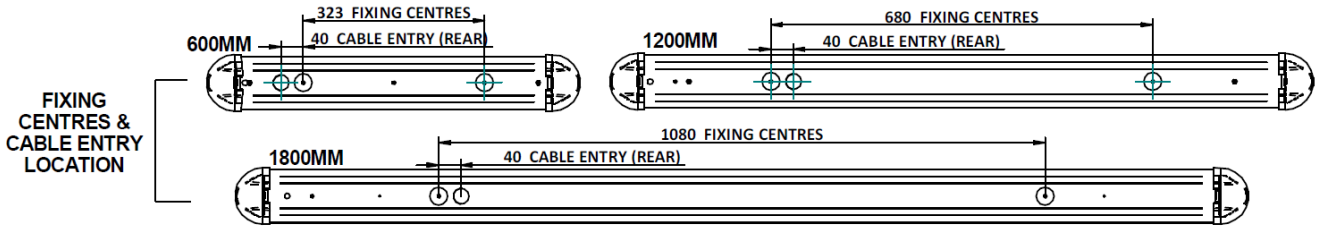

- 1** Disassemble diffuser/gear tray assembly from the canopy by working the canopy out at both ends first and then along length (remove safety retention chords from the gear tray if necessary) and put the diffuser/gear tray assembly in a safe location

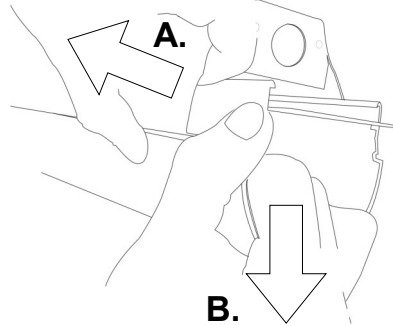

- A.** Ease one corner of the canopy away from the diffuser – Avoid touching the LEDs
B. Pull down with reasonable force to remove

IMPORTANT! WHEN INSTALLING VERTICALLY 2 PEOPLE ARE REQUIRED FOR EASE OF INSTALLATION

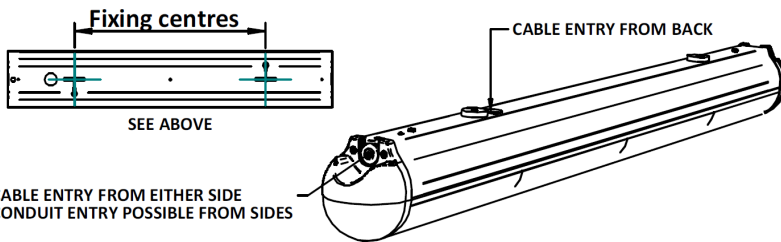

- 2** Use the canopy as a template to mark the mounting positions. Cable entry can be either from the sides or through the back of the fitting.

WARNING! DO NOT INSTALL ON SOFT TILES

IMPORTANT! THE POSITION OF THE CANOPY MUST ALLOW ACCESS FOR A SCREWDRIVER WHEN ATTACHING THE END CAPS IN STEP 6

- 3** Fix the canopy to the ceiling or wall using suitable screws for substrate material. Ensure the rubber spacers provided are used on the inside of canopy and the hard plastic spacers are used externally between canopy and substrate.

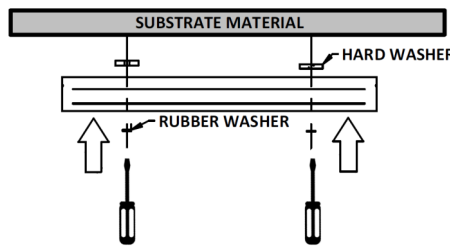

WARNING! ON A COM6 SENSOR PRODUCT DO NOT ATTEMPT TO REMOVE THIS ENDCAP OR SENSOR UNIT.

THE GEAR TRAY CAN BE DISCONNECTED USING THE GST PLUG FITTED. RECONNECT THE SENSOR PLUG WHEN ATTACHING GEAR TRAY

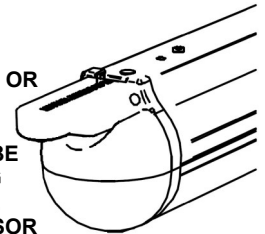

- 4** Reattach safety chords and earth lead to the canopy before connecting mains cable into terminals.

IMPORTANT! FOR EMERGENCY VERSIONS CONNECT BATTERIES

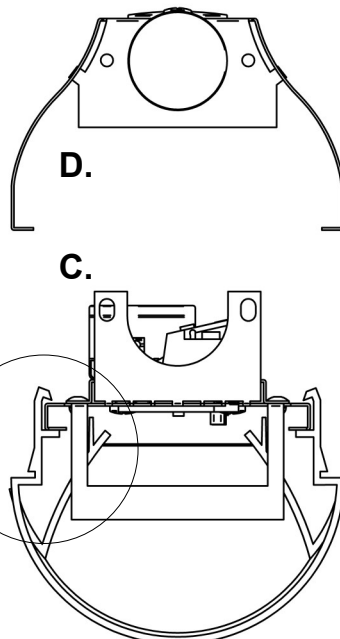
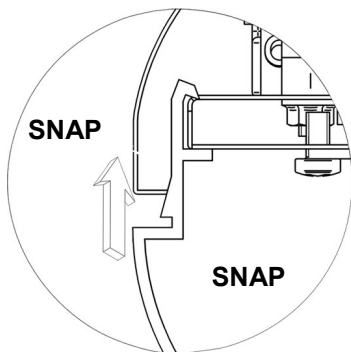

- 5** Push the diffuser/gear tray assembly into the canopy until you hear a 'SNAP'. DO NOT TRAP CABLES. Ensure the diffuser is engaged with the canopy along the full length of the fitting and that the gear tray upfold (C) is on the outside of the cable entry on the canopy (D), both sides - the diffuser will overhang the canopy at both ends of the canopy by approx. 15mm to prevent light spill.

- 6** Locate the end caps and fix to the canopy via two screw ports at both ends of the fitting to complete the installation. Screw fixings pass through the gear tray slots first and secure in the holes located in the end of the canopy.

IMPORTANT! WHEN INSTALLING VERTICALLY ATTACH BOTTOM END CAP FIRST!

X2

