

SPECIFICATION

Lamp type	LED
Finish	RAL 9003/9006
Materials	Polycarbonate / Zintec Steel / Aluminium
Weight	1206.4mm Fitting - Std 4.20kg, Emin 4.60kg. 1507mm Fitting - Std 5.4kg, Emin 5.8kg. 1807.6mm Fitting - Std 6.2kg, Emin 6.6kg.
Supply	220-240V AC, 50/60Hz
Output	High Output Fittings = 3800lm / 4750lm / 5700lm Low Output Fittings = 2800lm/ 3500lm / 4200lm
Operating temp	0-30C°
Connection	1.5mm ² input terminal block
Ingress protection	IP40

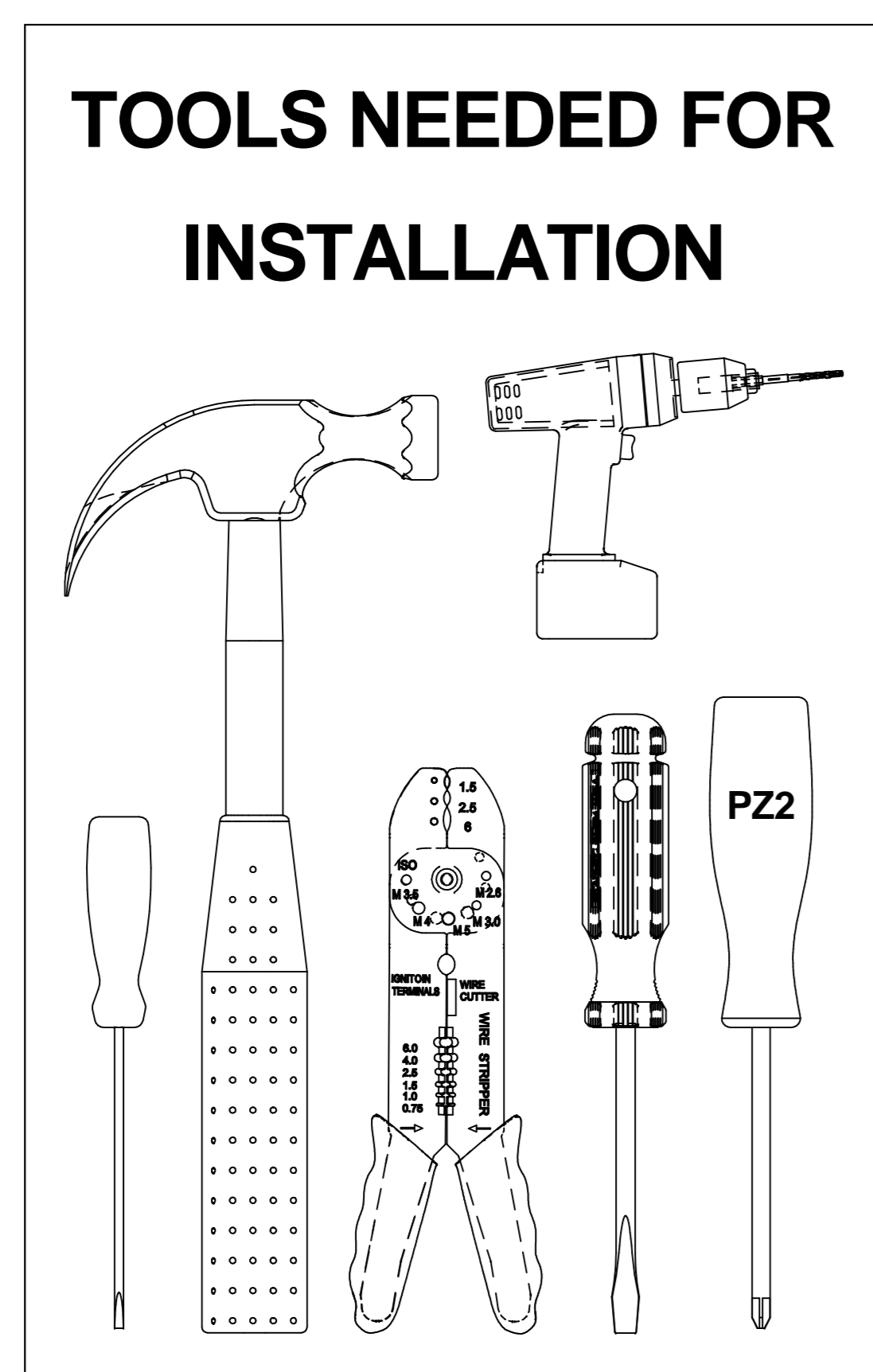

GENERAL INFORMATION

- 1) A qualified electrician, in accordance with IEE wiring regulations should carry out connection to mains wiring.
- 2) This unit must be EARTHED.
- 3) Ensure that the rated voltage and frequency requirements are compatible with the available mains supply.
- 4) Cleaning of reflectors and lenses should be carried out using clean, soft and lint free cloths and anti-static cleaning fluid
- 5) Do not carry out high voltage insulation test, i.e. 500/1000v this may damage internal components.

TECHNICAL SUPPORT

Telephone: 0161 331 5700

Email: technical@whitecroftlight.com

<http://whitecroftlighting.com/>

**Whitecroft
lighting**

Lance

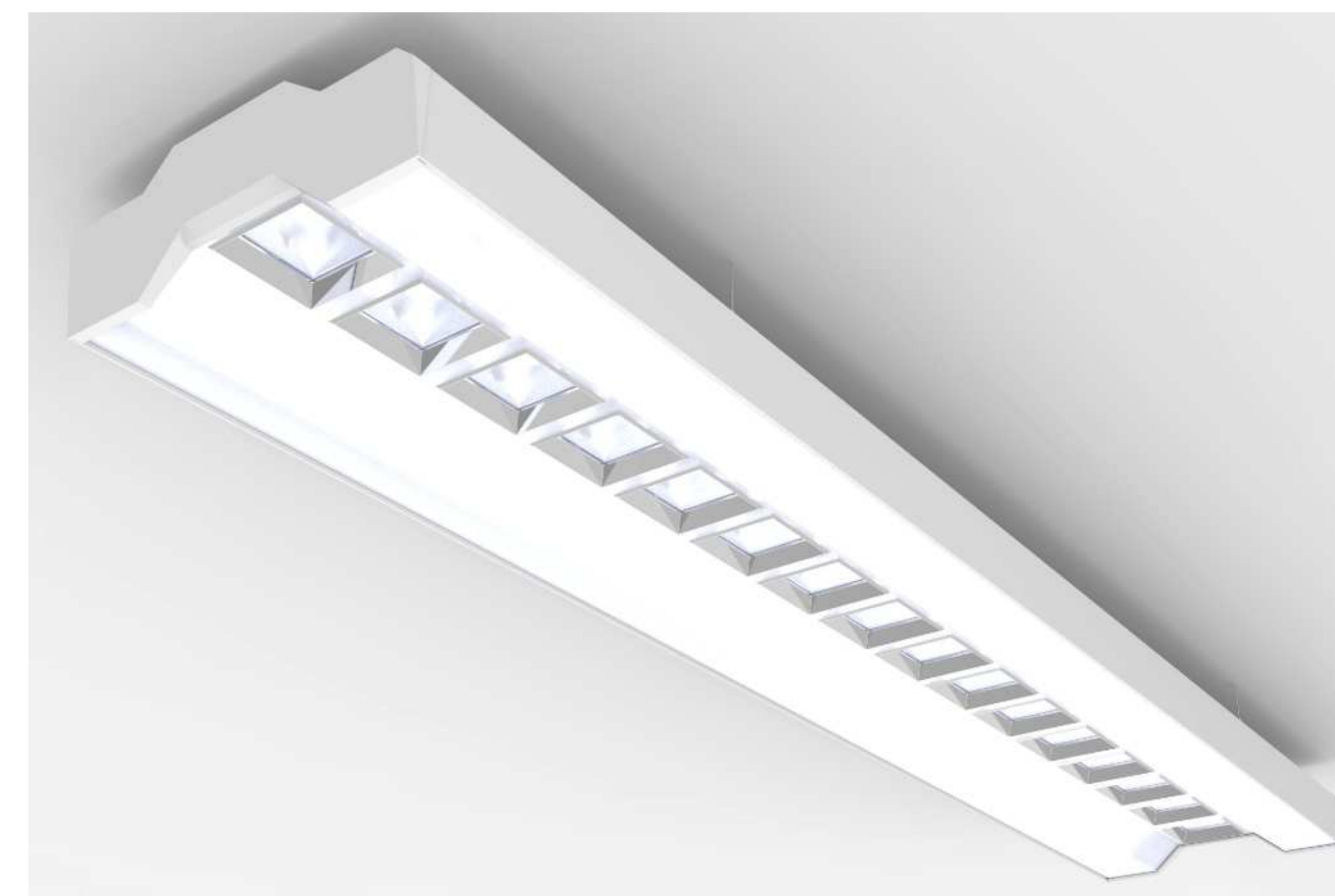

Installation Instruction

PK/NPD101-IL

June 2016 - Rev A

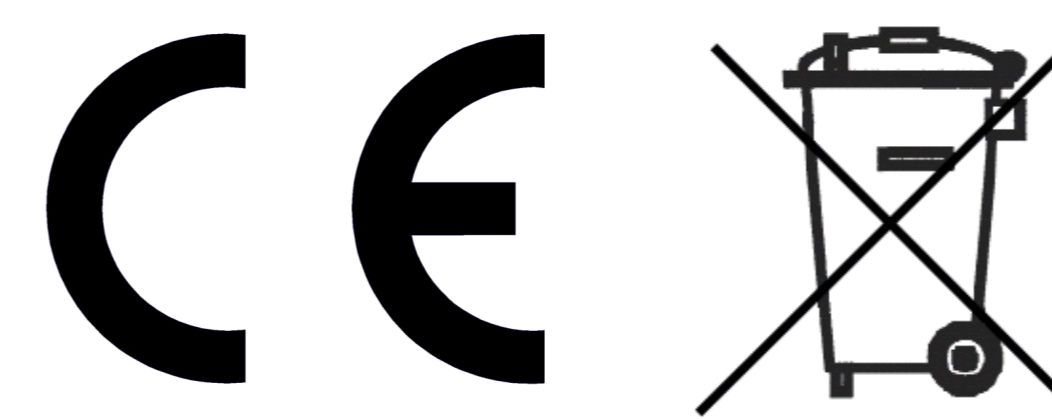

Whitecroft Lighting Limited

Burlington Street, Ashton-under-Lyne, Lancashire OL7 0AX
Telephone +44 (0)870 5 087 087 Facsimile: +44 (0)870 5 084 210
Registered No. 3848973 England Registered Office: As above

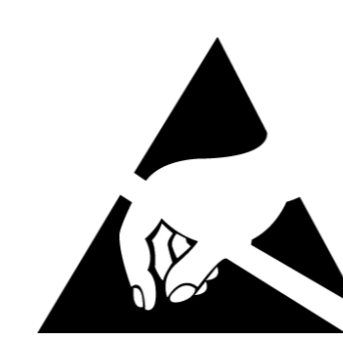
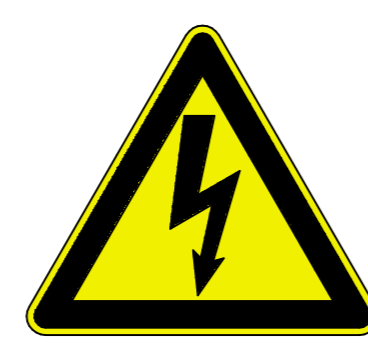

1 - Prepare Ceiling Suspension

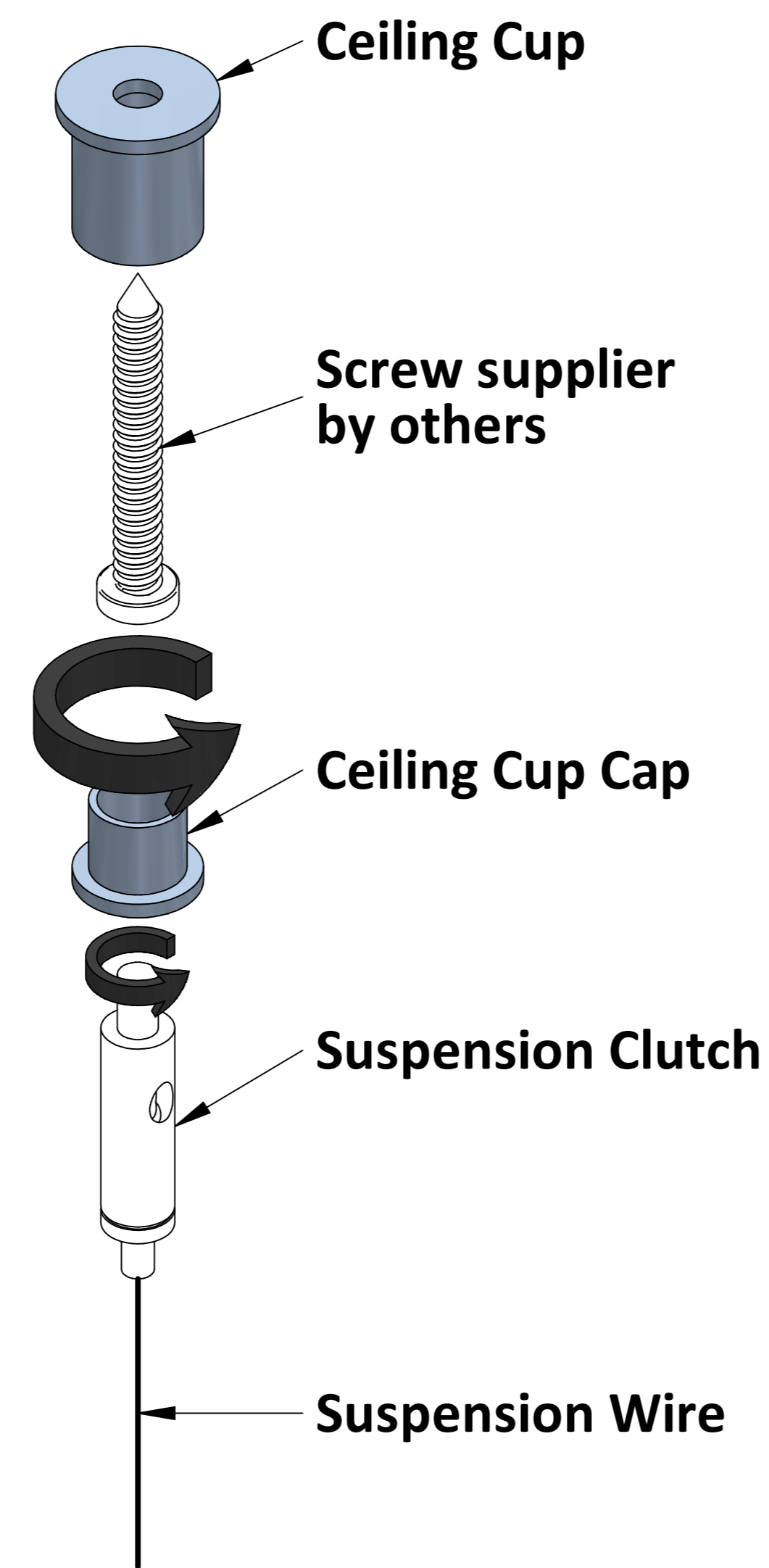
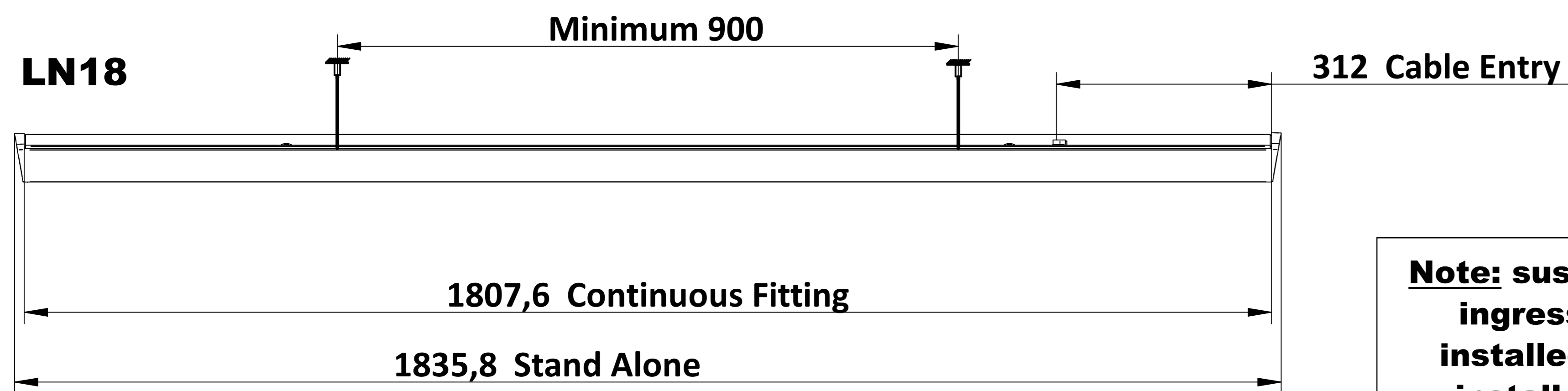
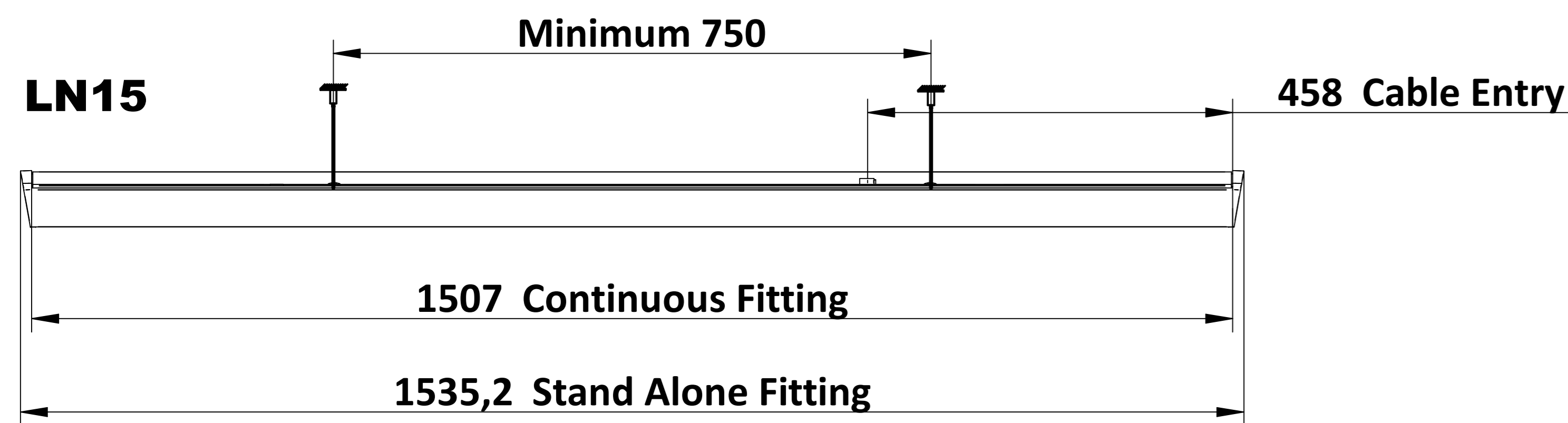
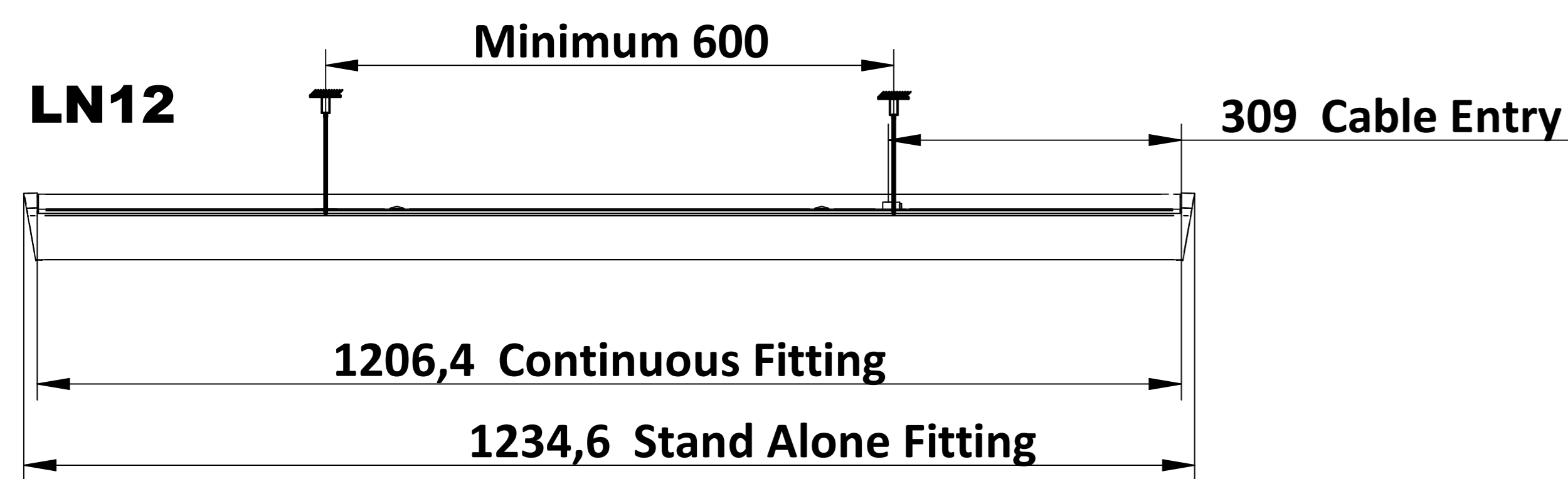

Note: susceptible to dust ingress when being installed, recommend installation in clean environment

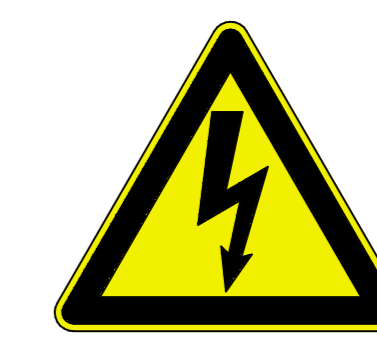
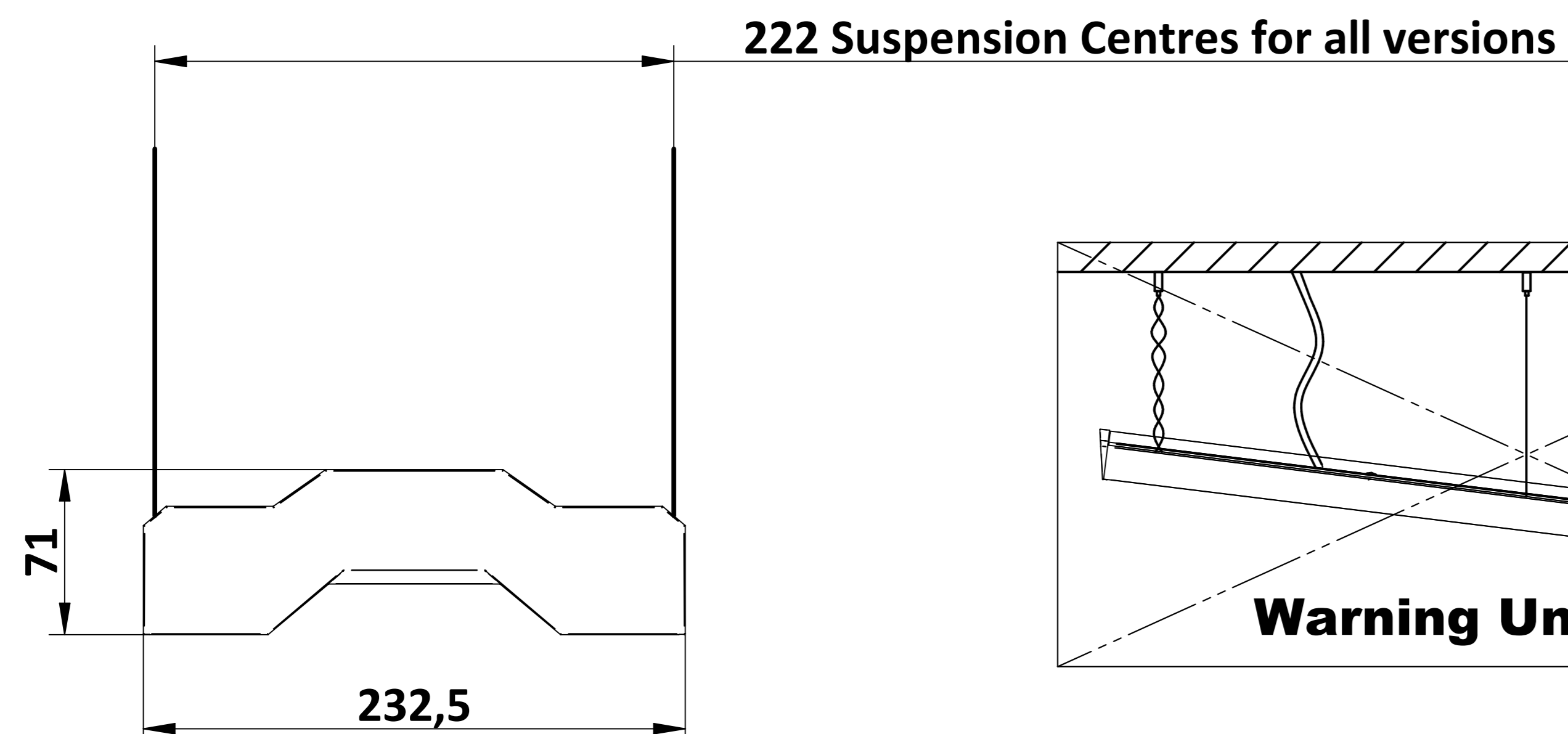

6 - Closing Luminaire

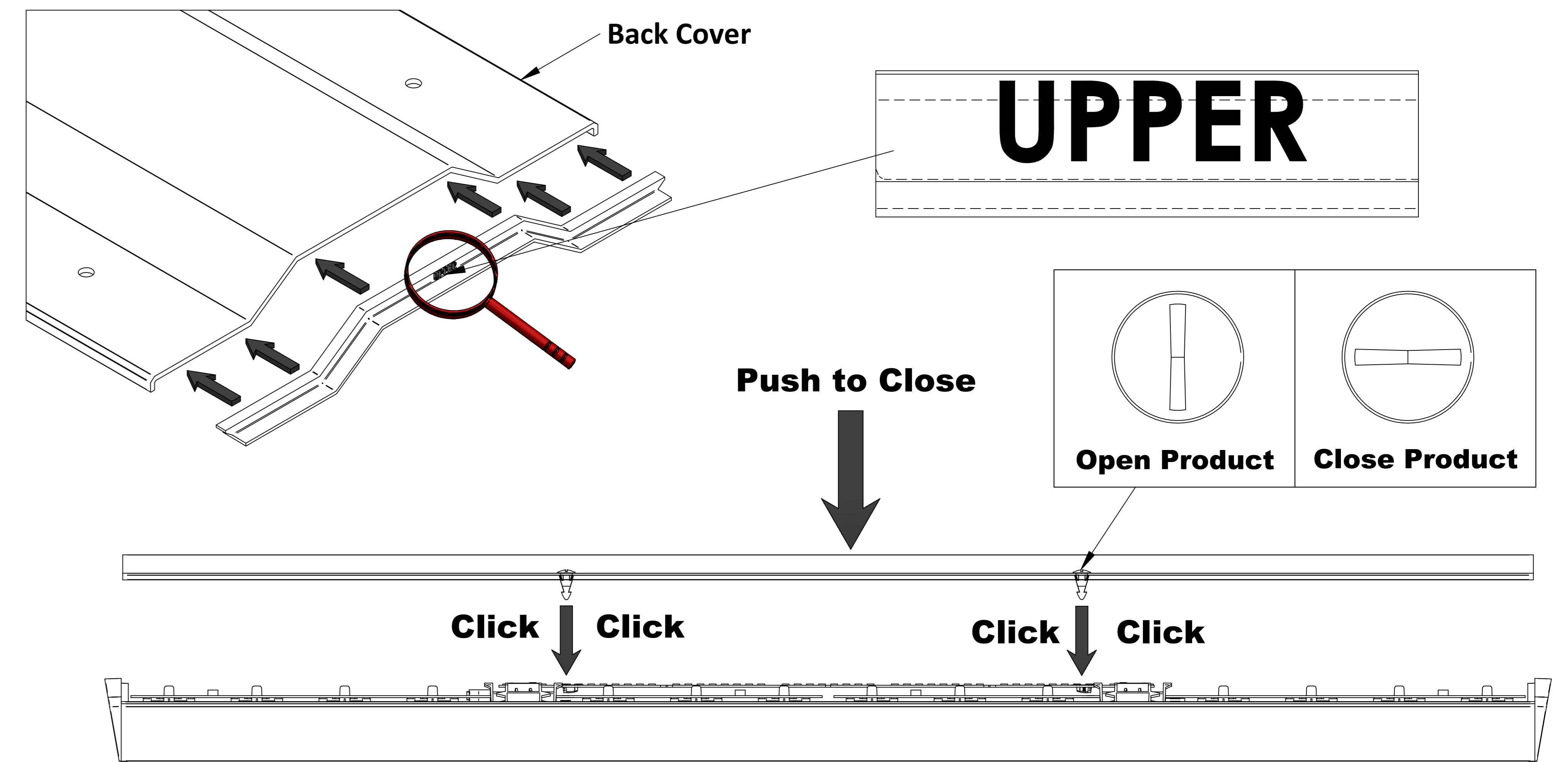

Product Parts

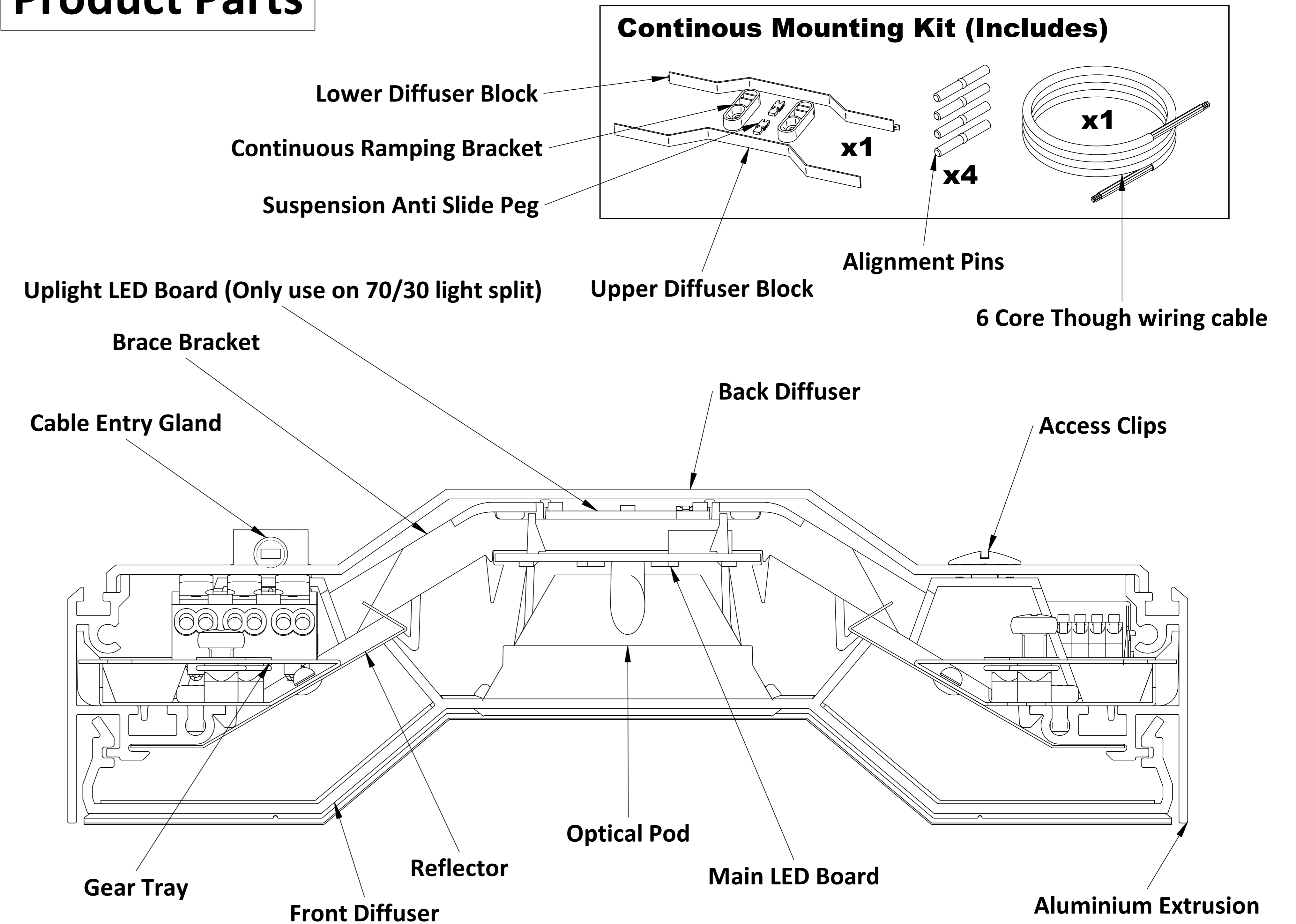

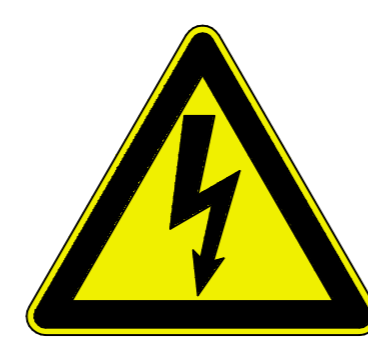

5 - Continuous Wire and Connect Supply

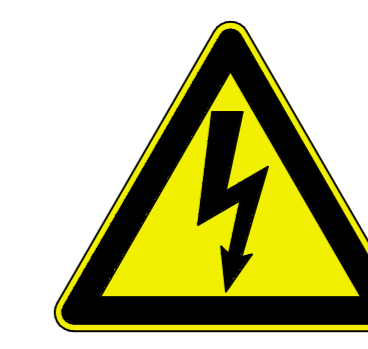
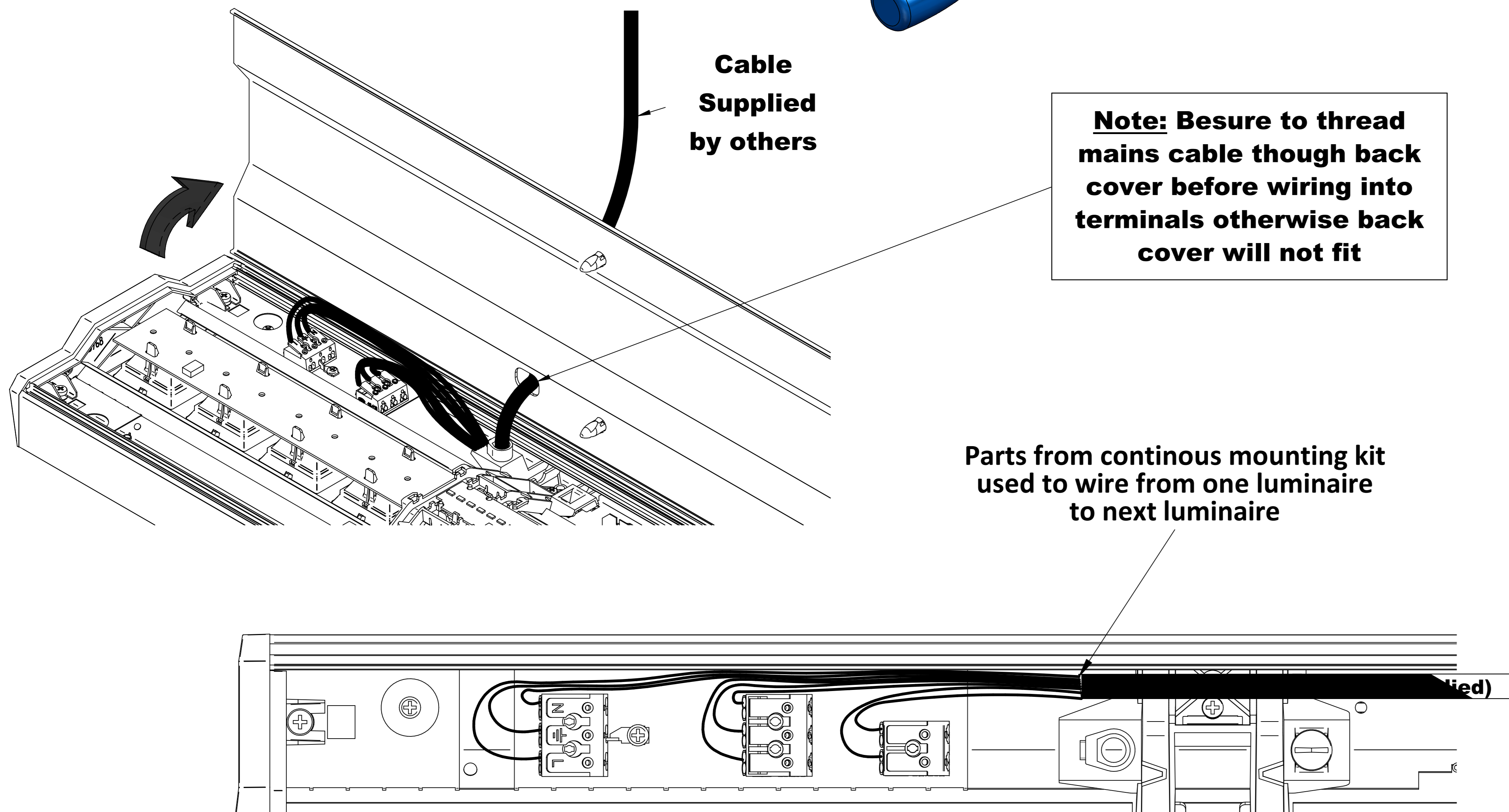
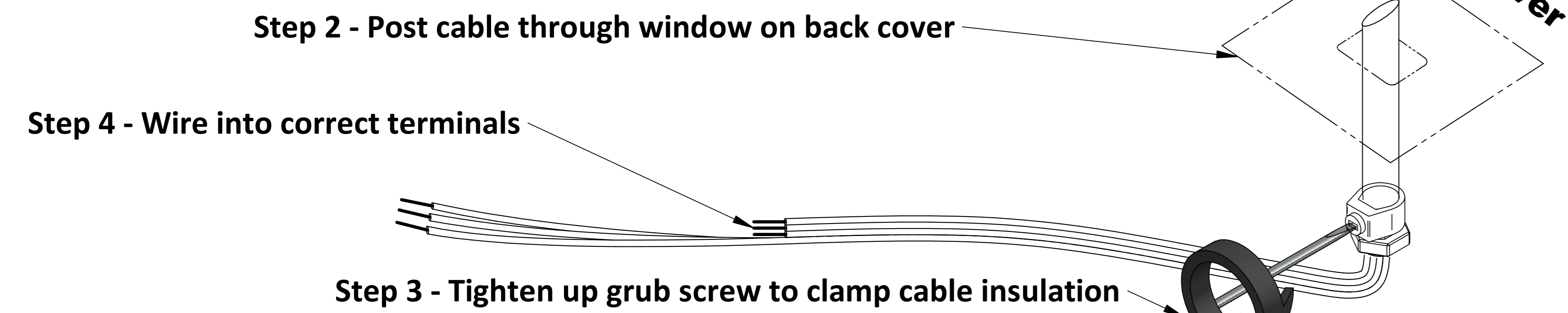
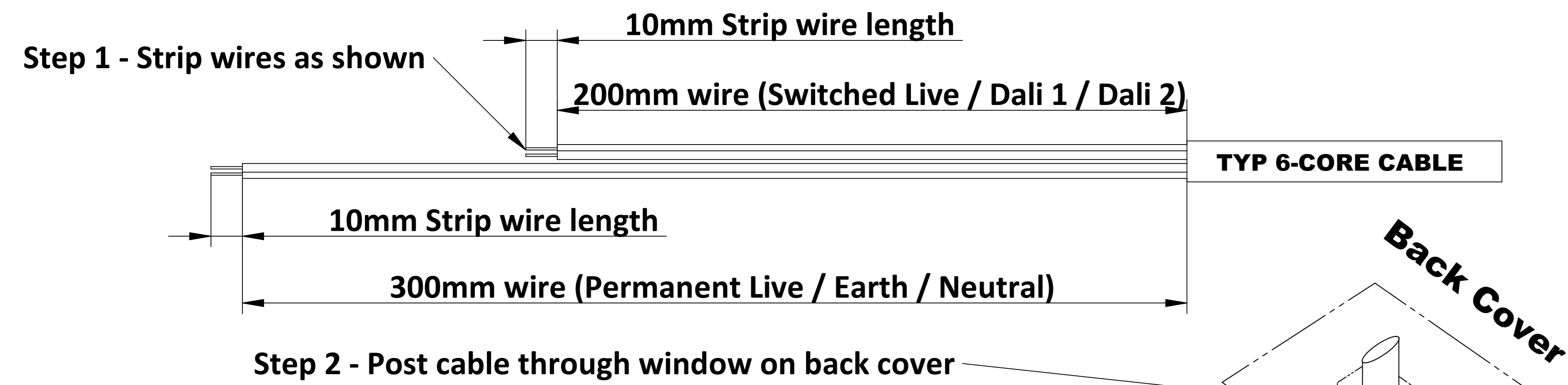
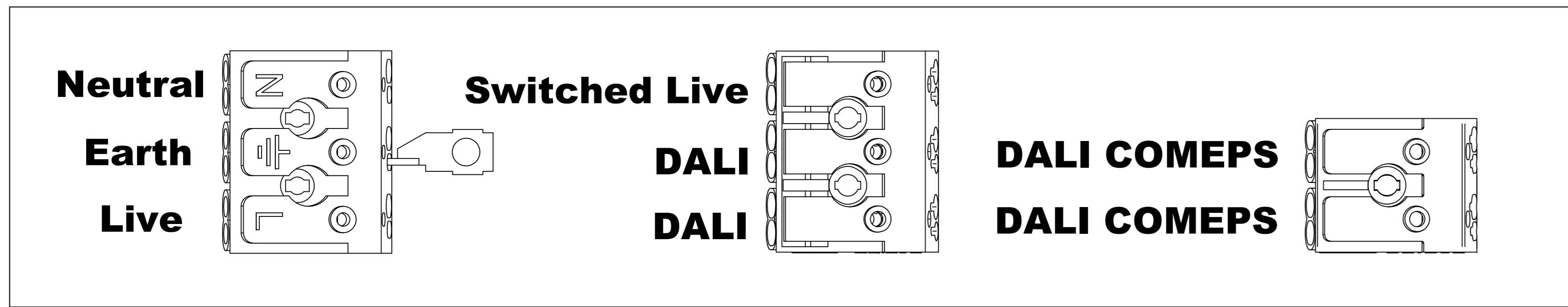

2 - Prepare Light Fitting

Step 1 - Release Gear Cover

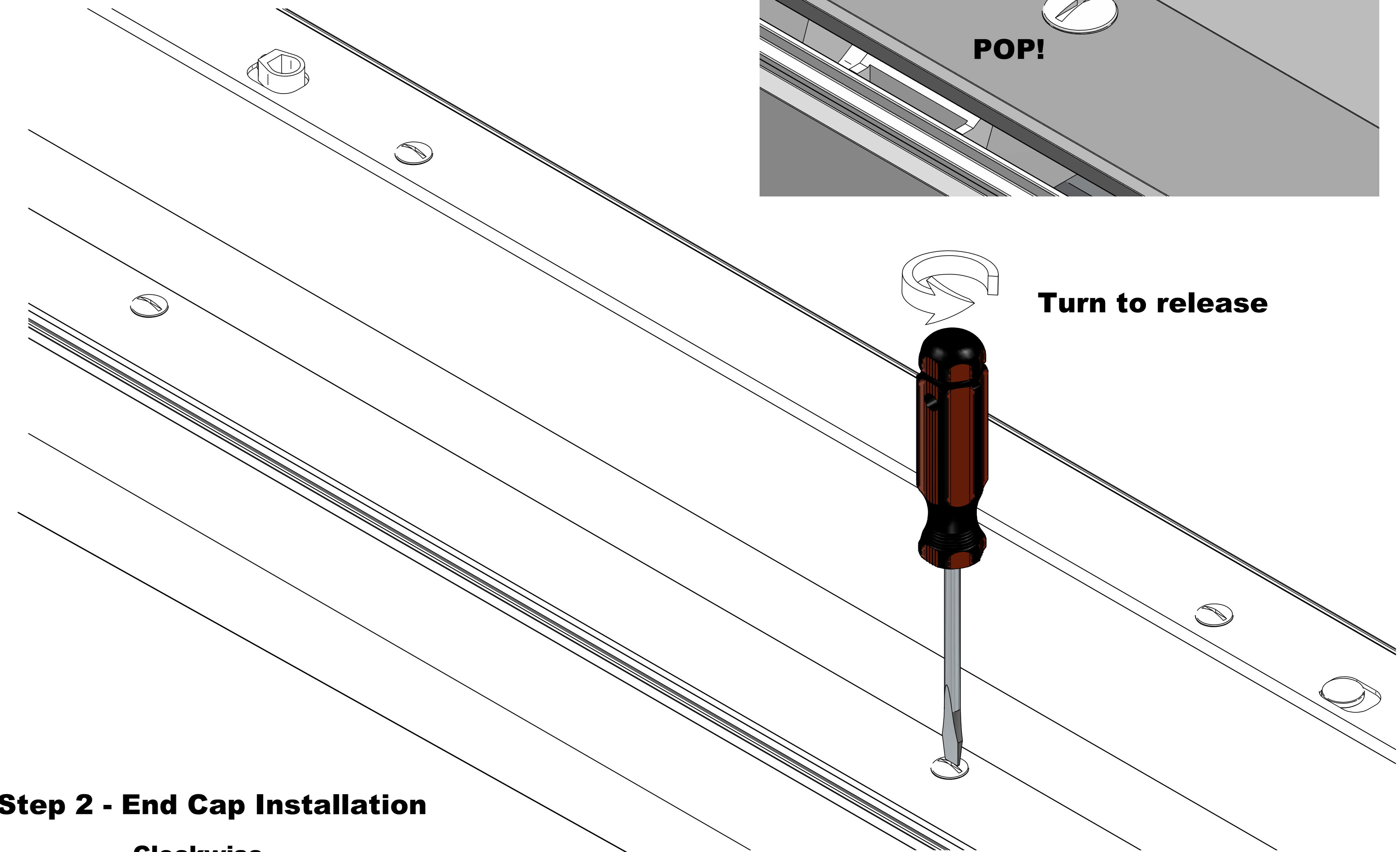
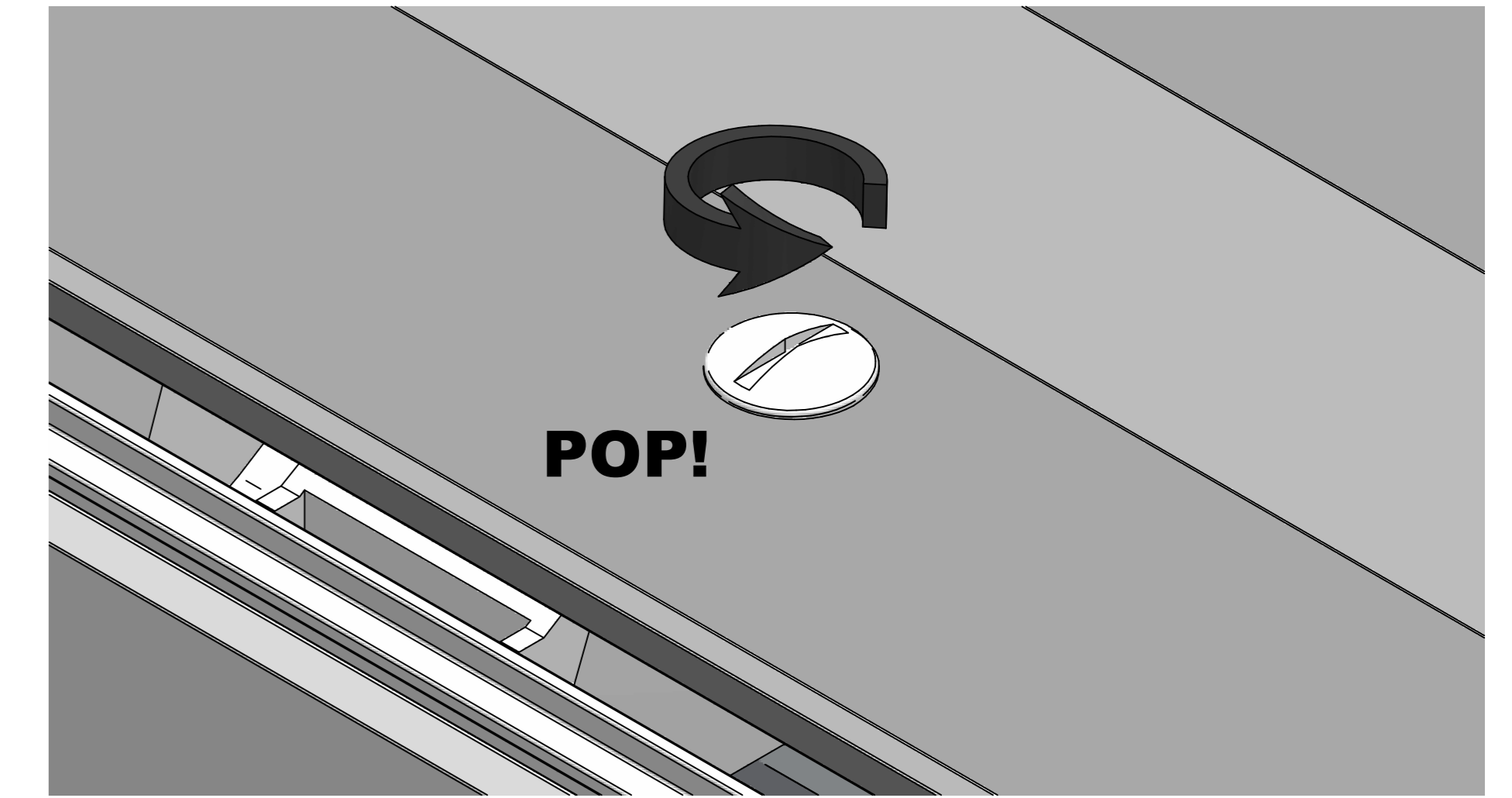

Step 2 - End Cap Installation

Clockwise
Turn to tighten (2 Locations)

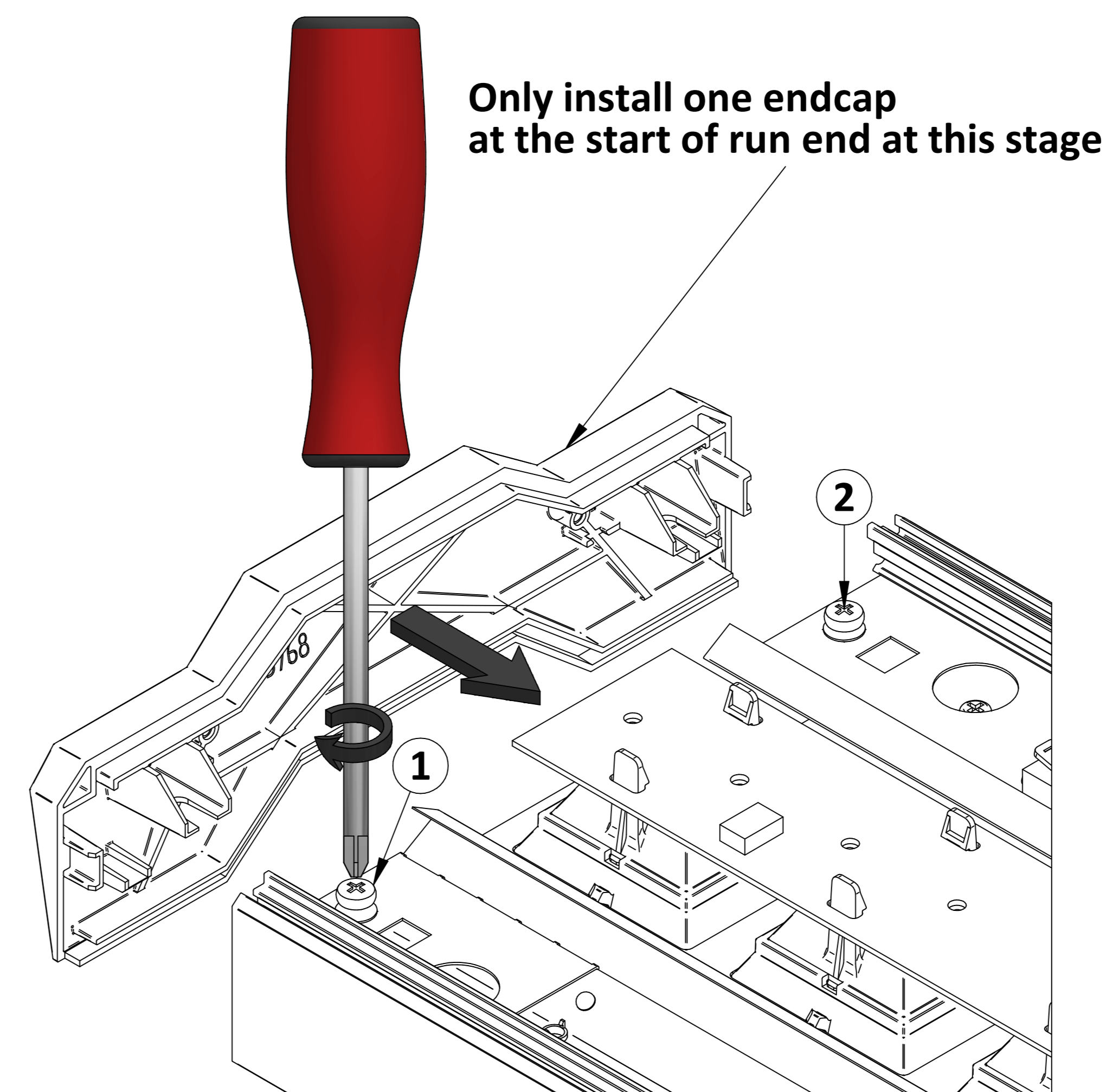

Step 3 - Install Alignment Pins (If Continuous fitting required)

Continuous Mounting Kit (Includes)

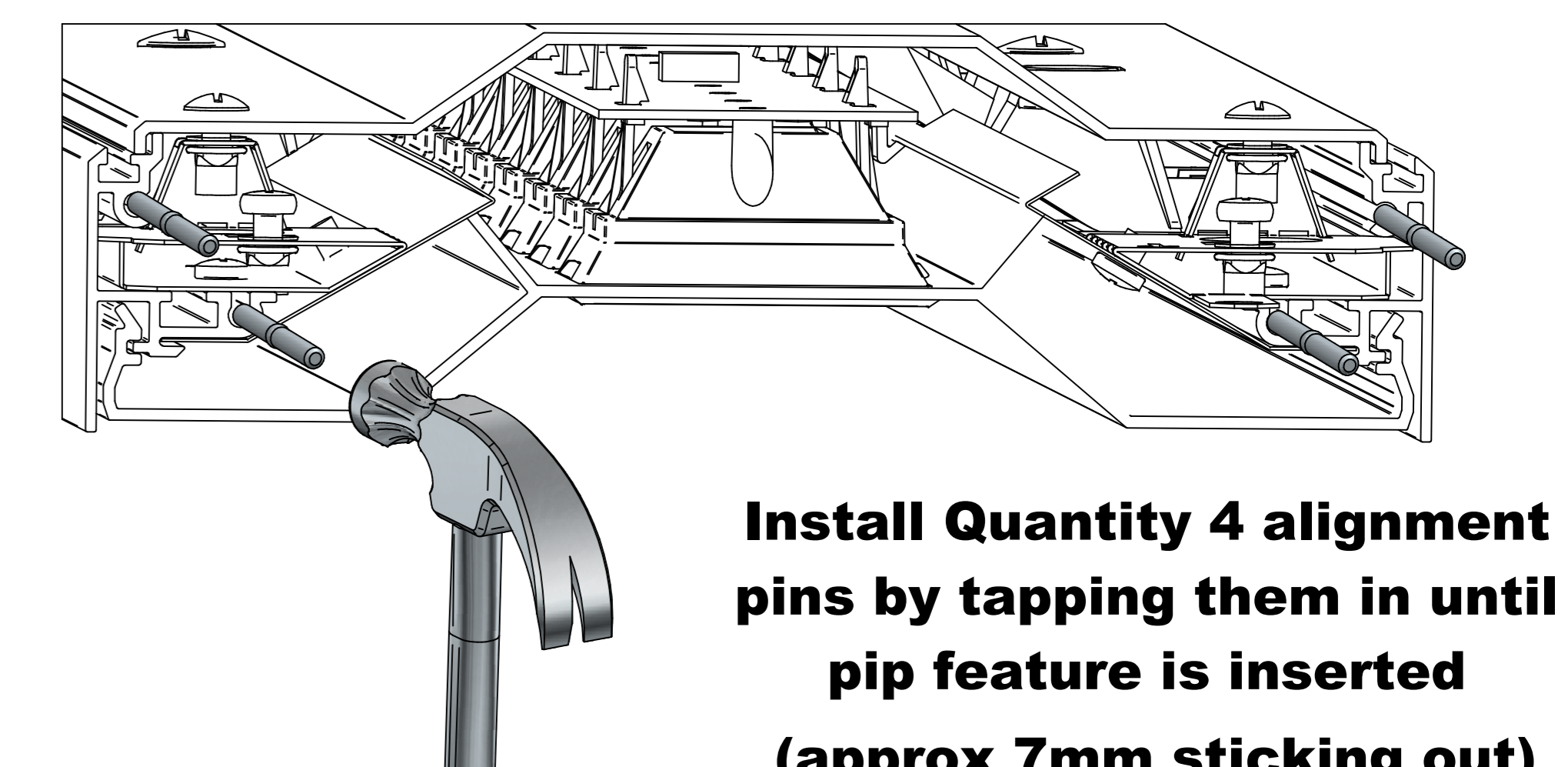
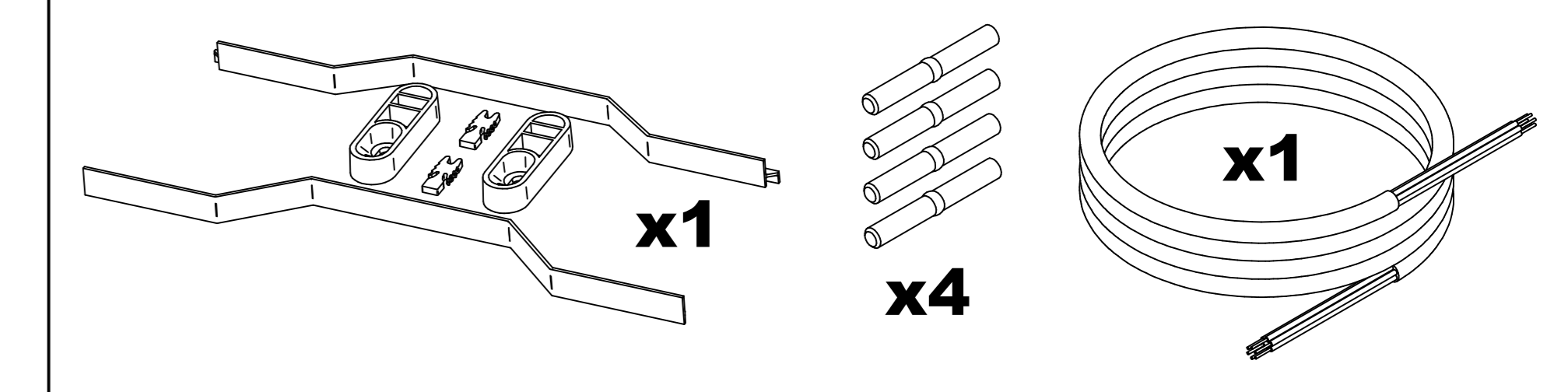

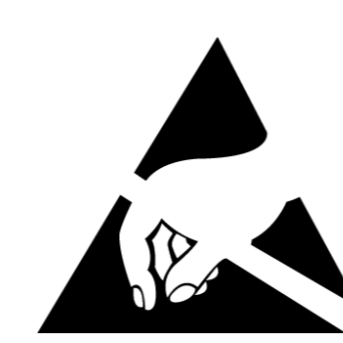
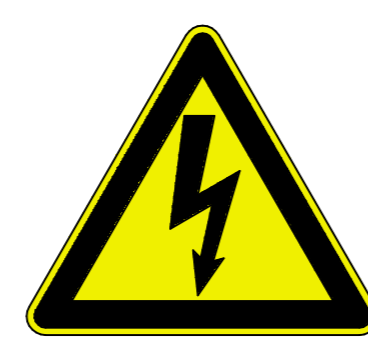

3 - Preparing Suspension

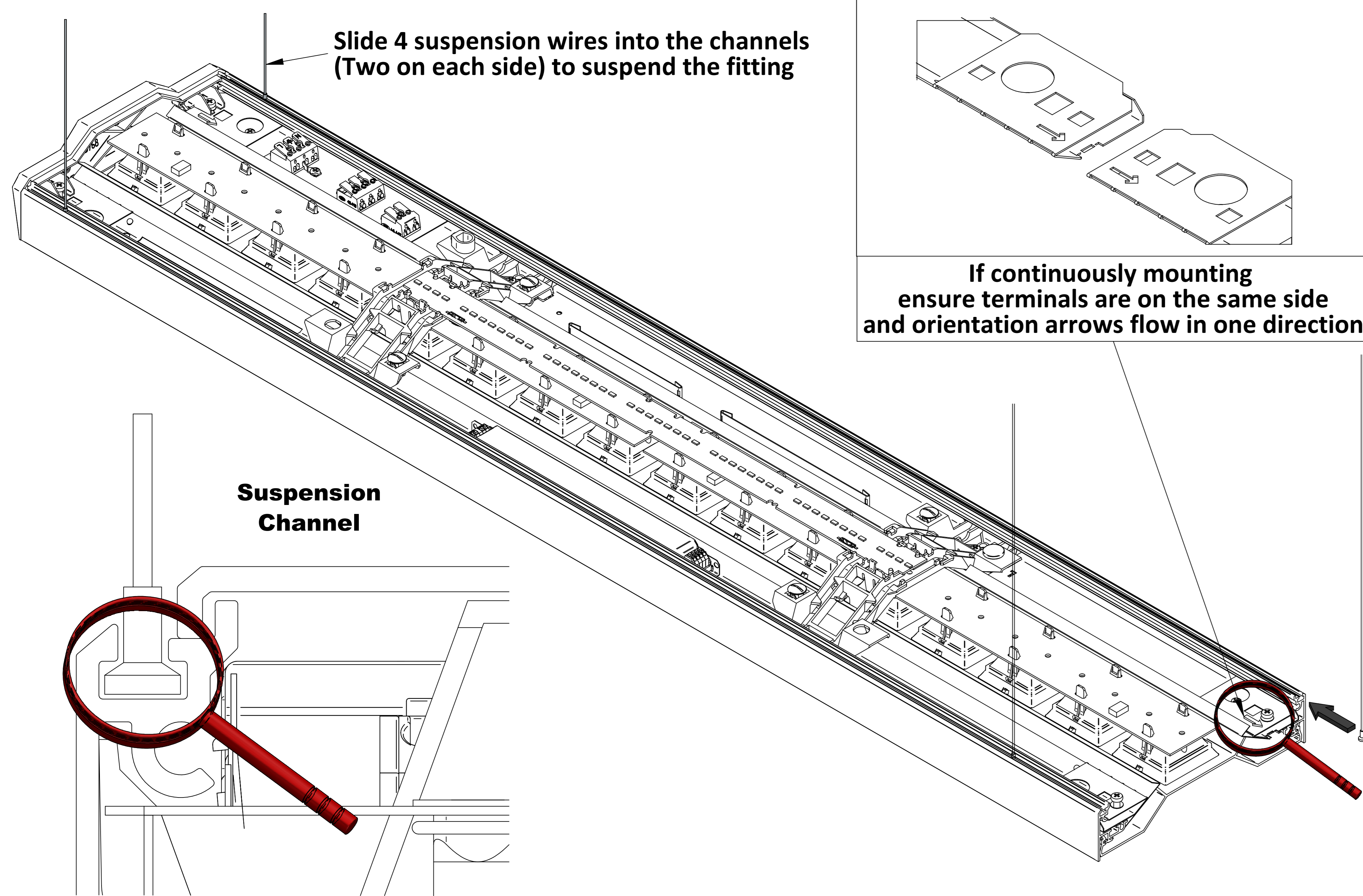

Stand Alone Luminaire

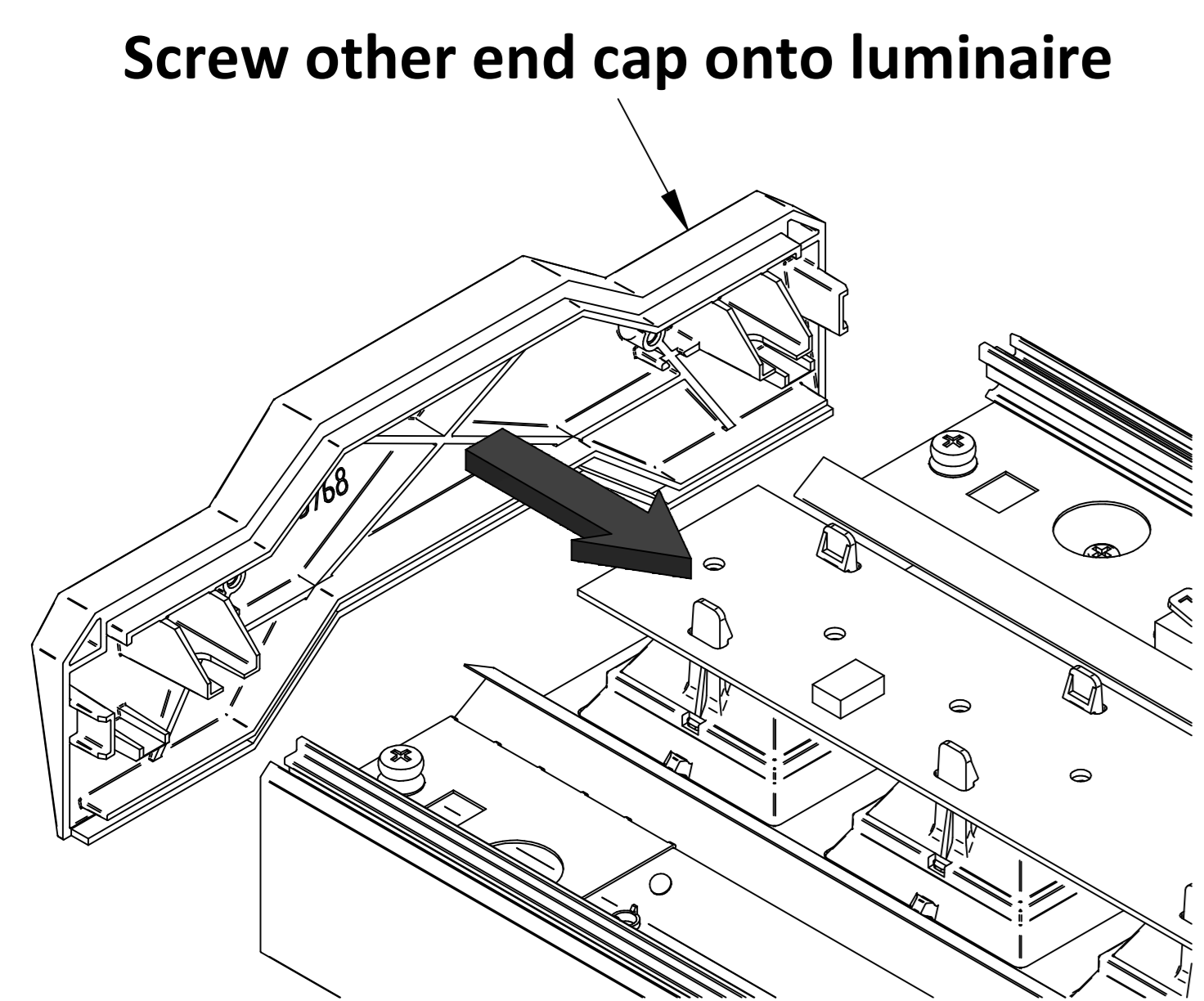

Continuous Luminaire

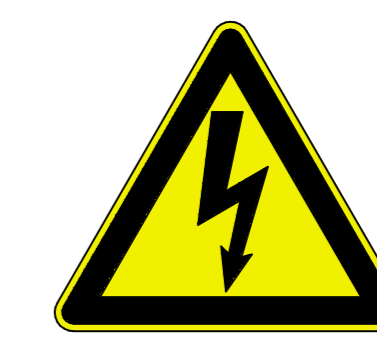
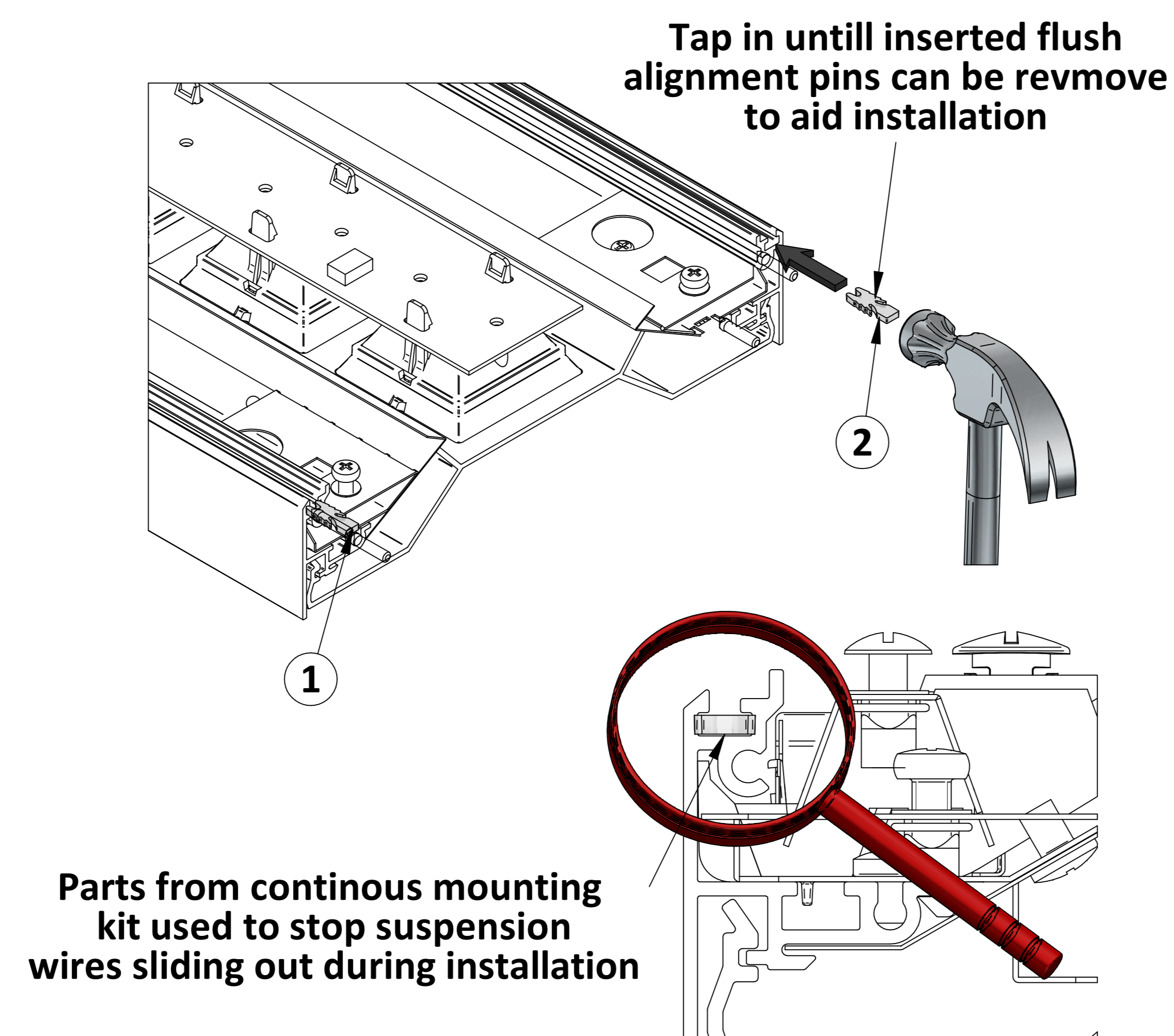

4 - Suspend and level luminaires

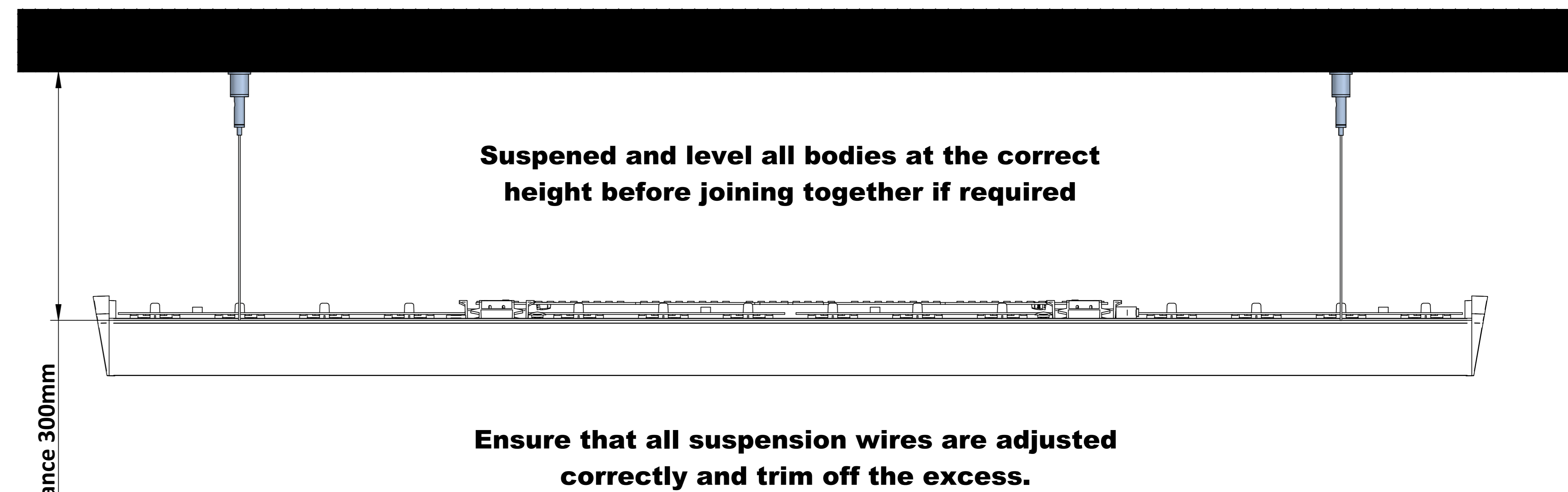

Connect Luminaire

