

Whitecroft  
lighting



# Installation sheet

## HELM

PK/LEAFLET/HELM

Rev D December 2017



### **Whitecroft Lighting Limited**

Burlington Street, Ashton-under-Lyne, Lancashire  
OL7 0AX

Telephone +44 (0)870 5 087 087 Facsimile: +44 (0)870 5 084 210

Registered No. 3848973 England

Registered Office: As above

# HELM

Whitecroft Lighting Ltd

## Product Dimensions

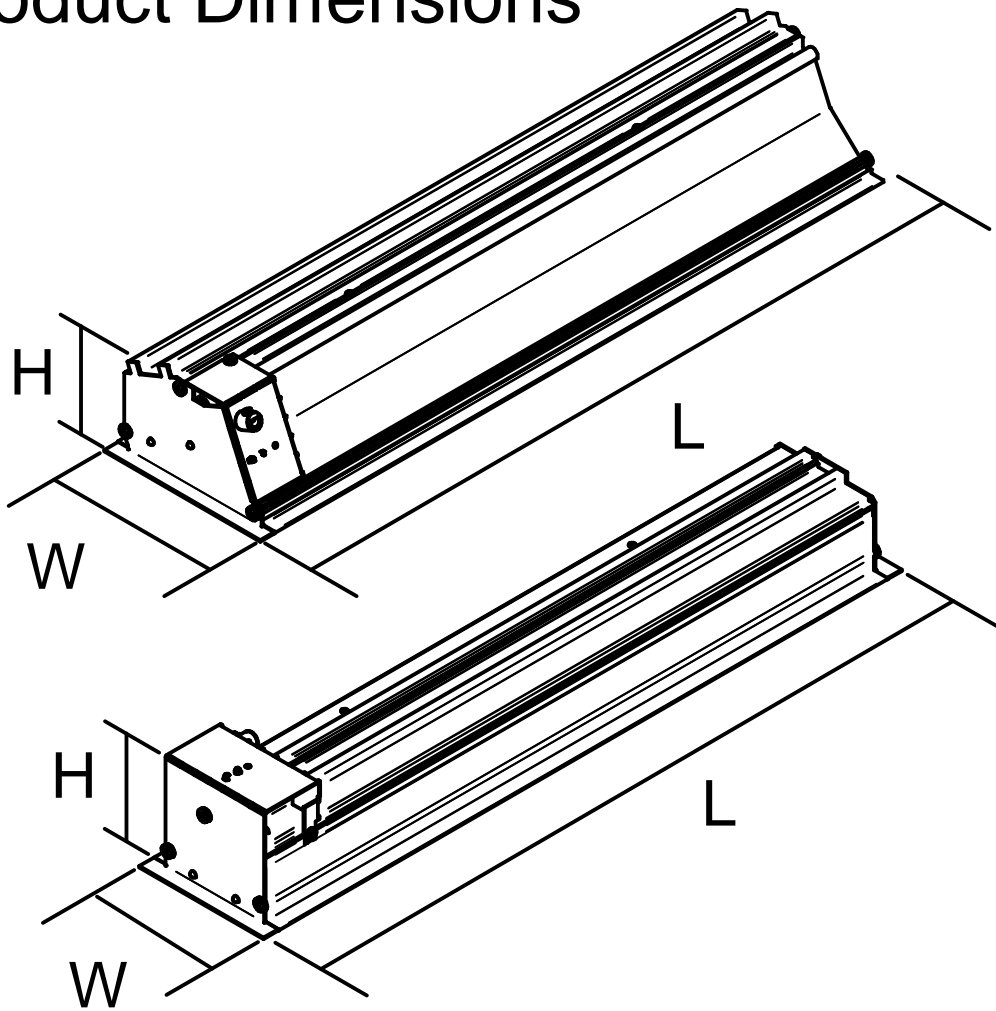

### SPECIFICATION:

Lamp type:	LED
Output:	1600lm /3000lm nominal.
Colour:	4000°K - Ra80 (840)
Materials:	
Body:	Aluminium/Steel
Reflector:	Aluminium
Diffuser:	Polycarbonate
Control gear:	Fixed output / Dali
Emergency:	Integral 3hr / COMECS
Supply:	240v 50Hz AC
Ambient Temperature:	0-25°C
Supply flex:	0.5 - 2.5mm <sup>2</sup>
Terminal block type:	Push-wire (non-EM) piano-key (EM)
Ingress protection:	IP40 (from below)

Version	L	W	H	KG	KG EM
ASYMMETRIC, 1600lm	595	146	87	1.85	2.85
SYMMETRIC, 1600lm	595	117	103	1.6	2.6
ASYMMETRIC, 3000lm	1196	146	87	3.4	4.4
SYMMETRIC, 3000lm	1196	117	103	2.9	3.9

## Ceiling Integration

### Exposed T: Lay in

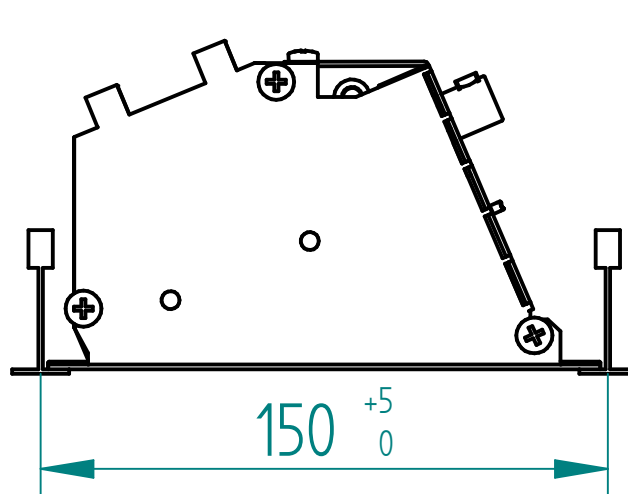
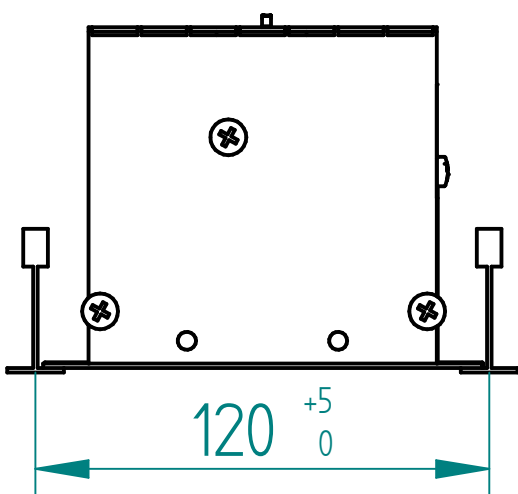

### Pull up T15/T25

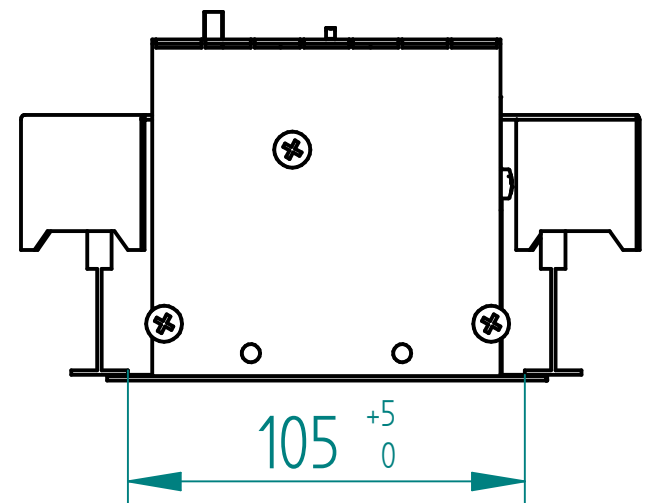

### Prepared Aperture

plasterboard should be lined with battens

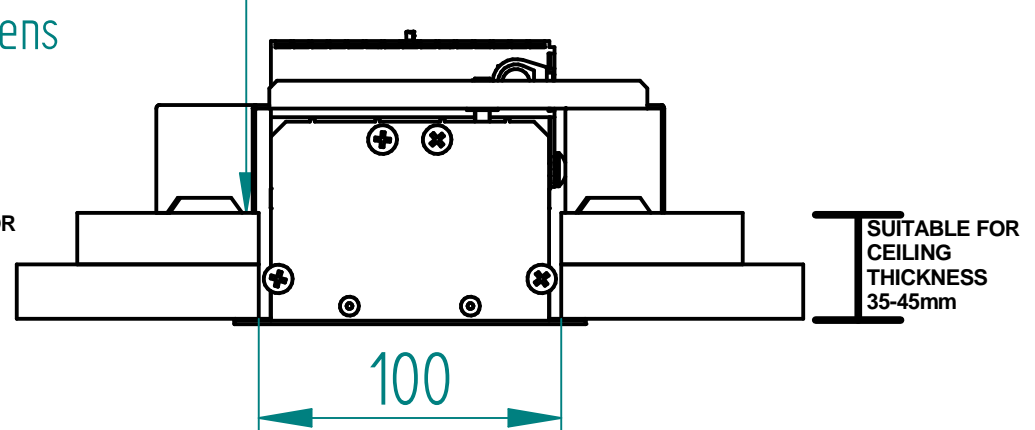
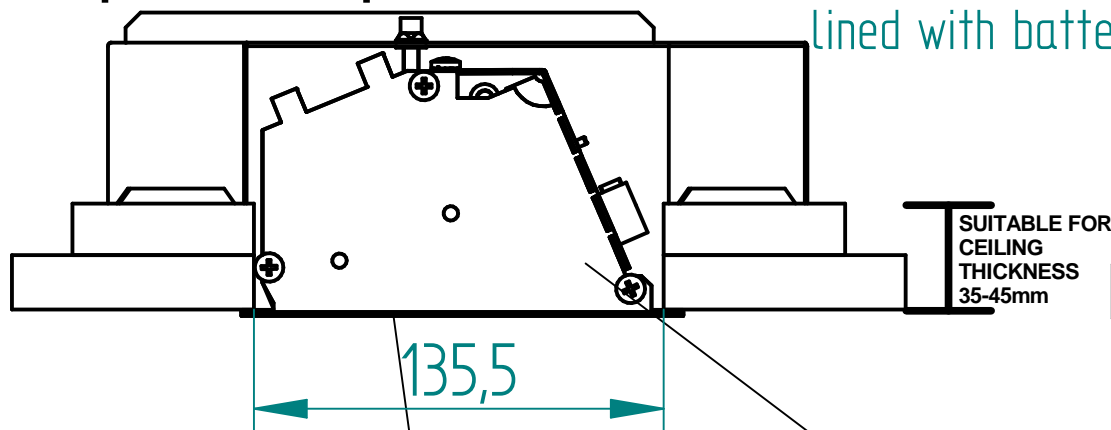

For asymmetric products ensure correct orientation

Aperture length:  
1600lm Products - 578 +5/-0mm  
3000lm Products - 1179 +5/-0mm

# HELM

Whitecroft Lighting Ltd

## Wire Product

### Fixed Output and Dali

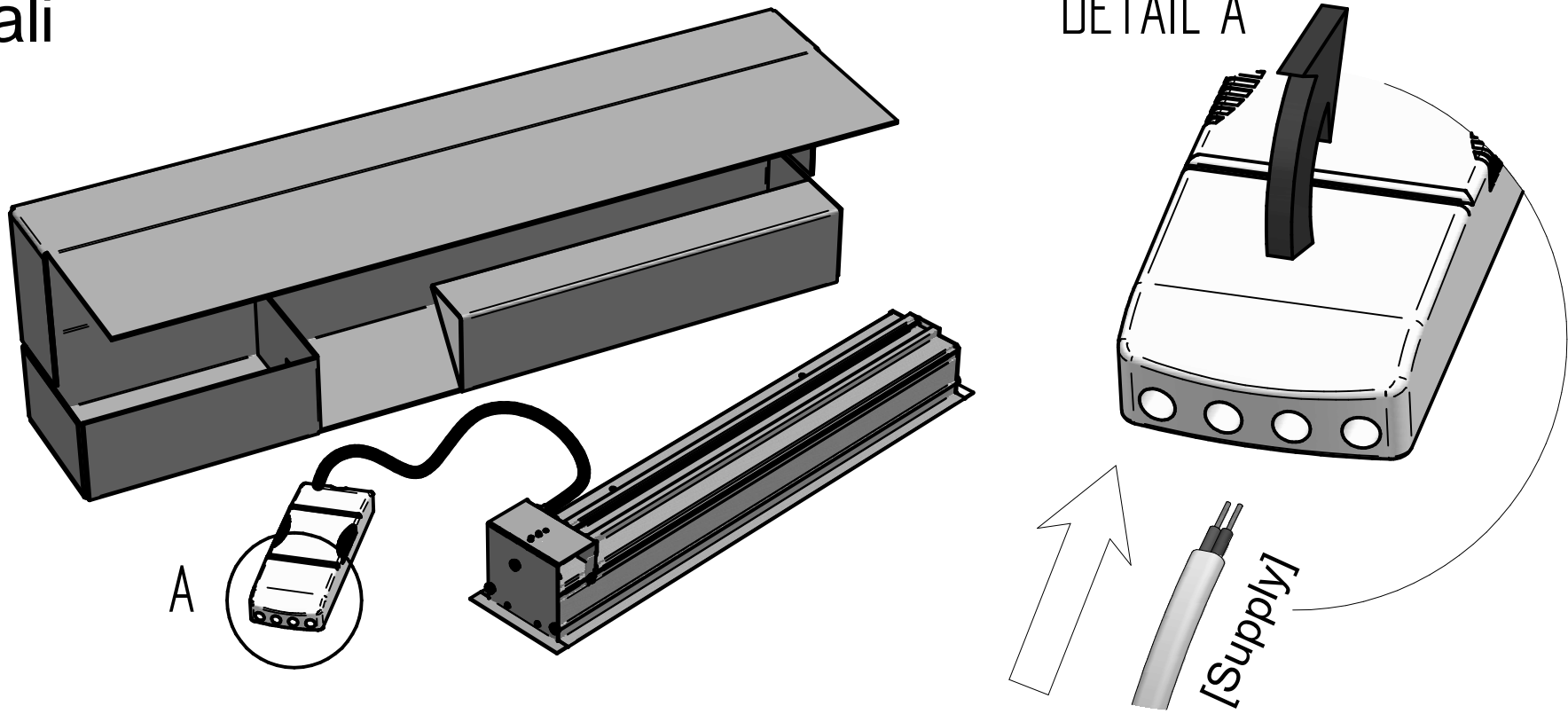

## 3hr EM and COMEPS

open driver and fit cable with gland

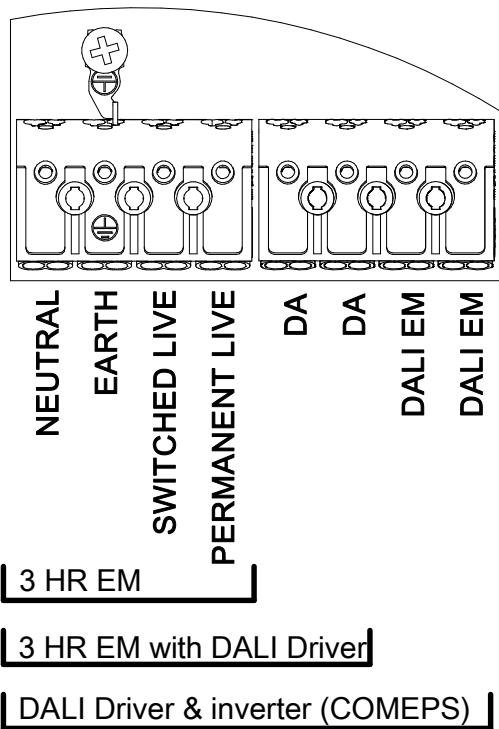
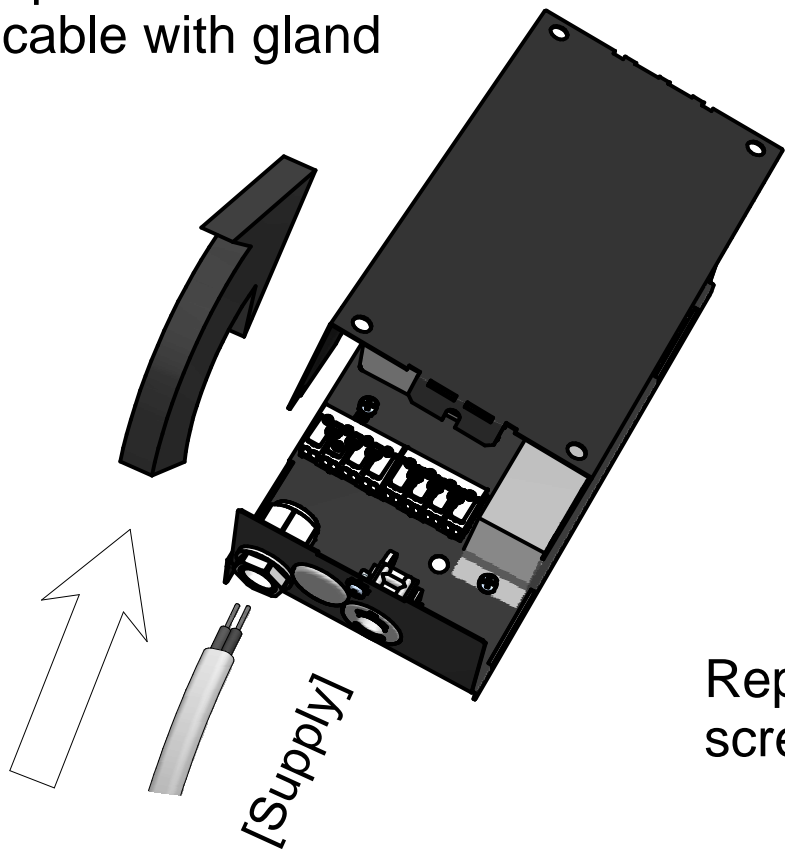

connect battery

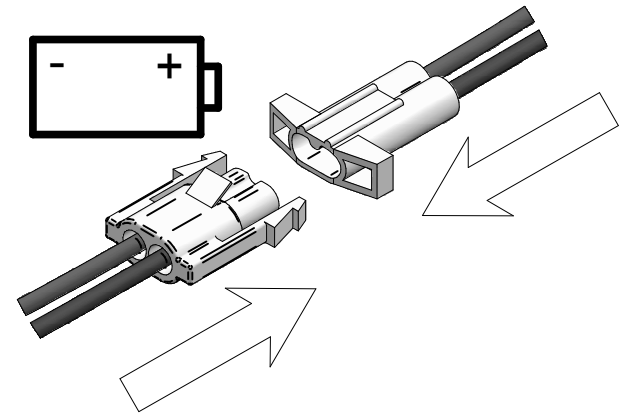

Replace lid and tighten retaining screw

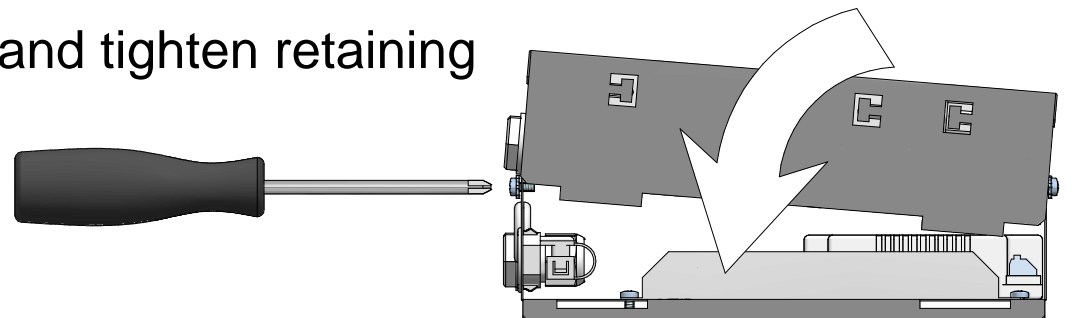

## Fitting Product

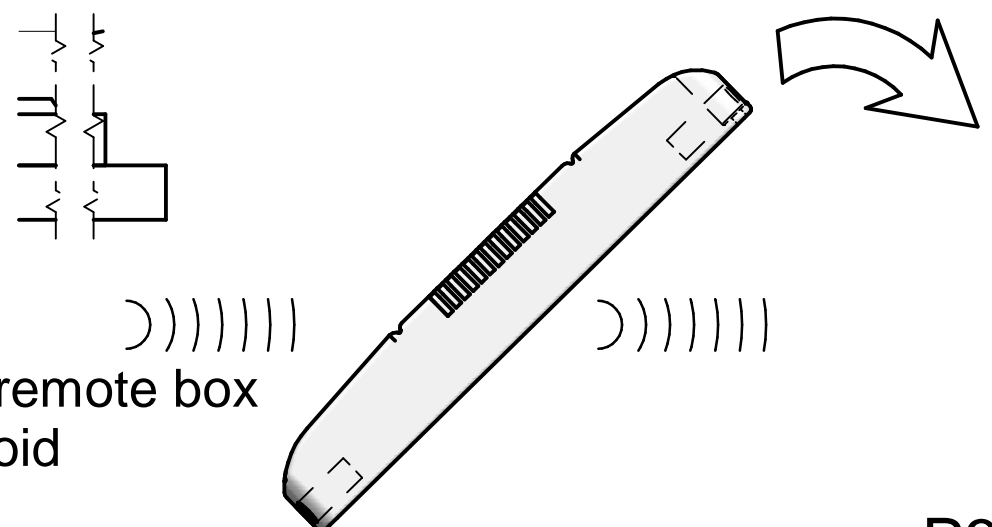
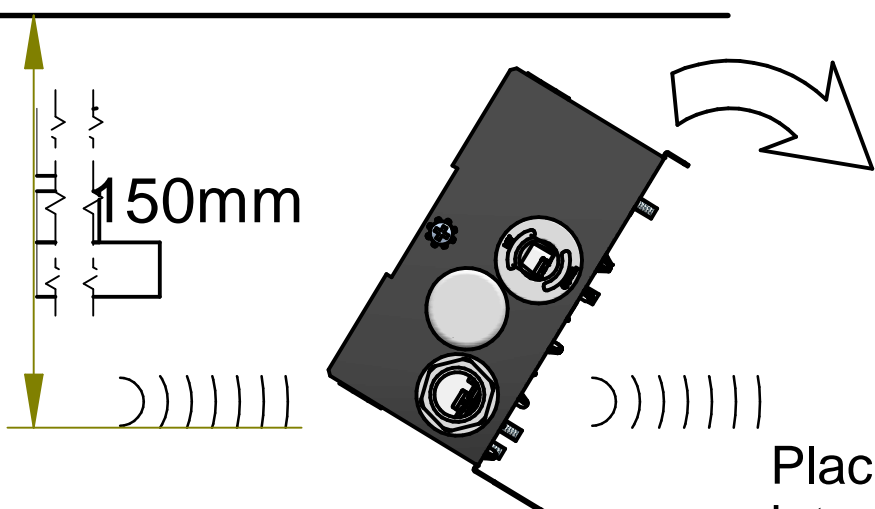

Place driver/remote box into ceiling void

## T15/T25 Lay in

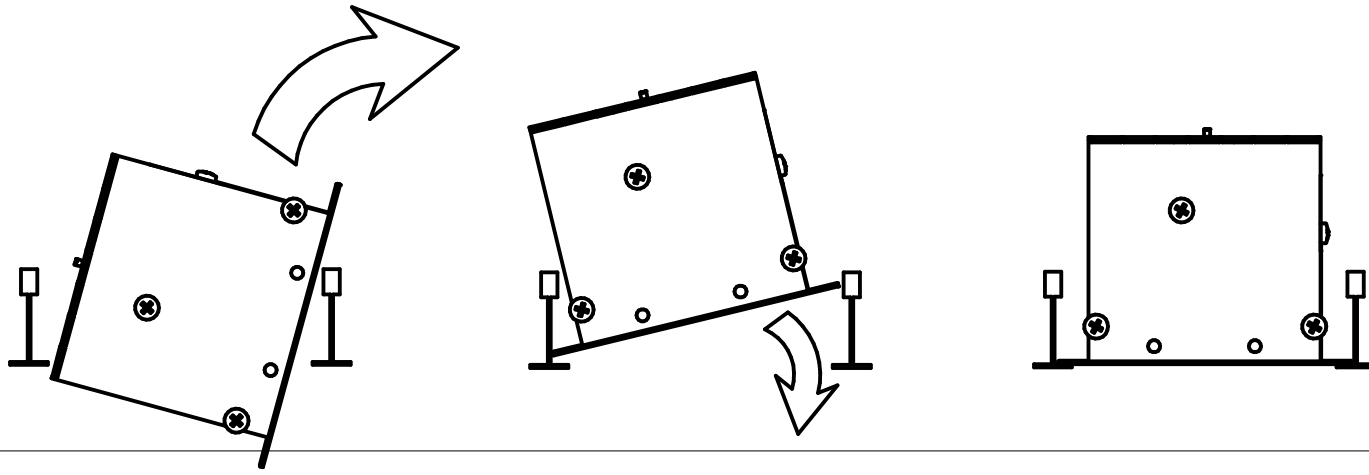

Ensure product is centered and parallel in grid

## T15/T25 Pull Up/Prepared Aperture

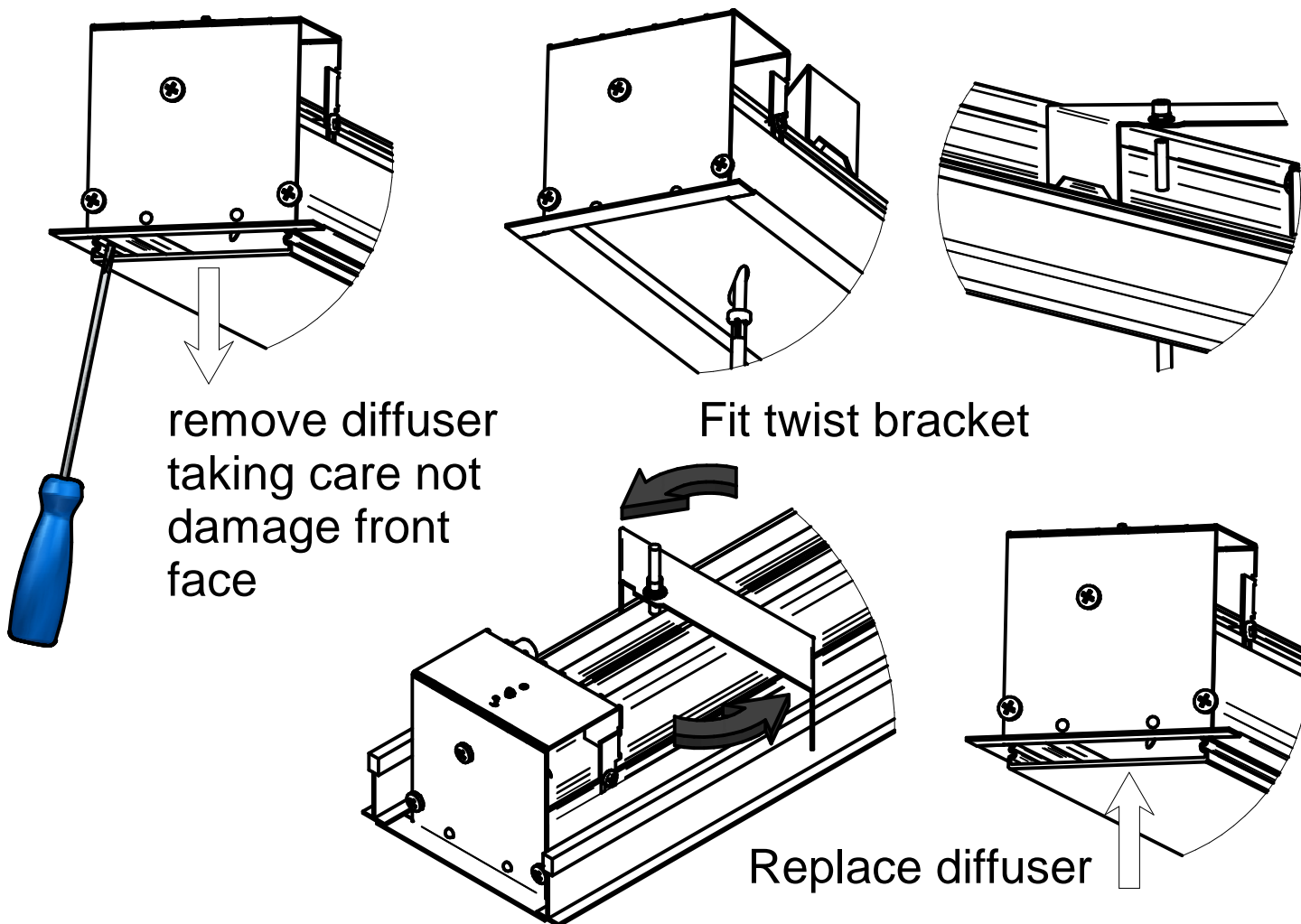

remove diffuser taking care not damage front face

Fit twist bracket

Push fitting into aperture and tighten screw

Replace diffuser

NB: Ensure pressure on screw head and product is pressed tight against ceiling

## GENERAL INFORMATION

1. A qualified electrician, in accordance with IEE wiring regulations should carry out connection to mains wiring.
2. Observe ESD precautions during installation.
3. This unit must be EARTHED.
4. Ensure that the rated voltage and frequency requirements are compatible with the available mains supply.
5. Cleaning of reflectors and lenses should be carried out using clean, soft and lint free cloths and anti-static cleaning fluid.
6. Do not carry out high voltage insulation test, i.e. 500/1000v this may damage internal components.
7. All emergency versions are 3 hour duration.

The Mains supply and the Battery connection must be disconnected before servicing or maintenance.

### VERY IMPORTANT

The battery must be left disconnected during installation until there is a stable site supply. Isolating the un-switched supply to the luminaire with the batteries connected on a daily basis will damage the fitting.

TECHNICAL SUPPORT  
Telephone: 0161 331 5700  
E-mail: [technical@whitecroftlight.com](mailto:technical@whitecroftlight.com)  
<http://www.whitecroftlighting.com/>