

## SPECIFICATION

Lumen packages:	4800lm/6000lm/7200lm	
Finishes:	Body	Silver RAL 9006 30% gloss polyester powder-coat
		White RAL 9003 30% gloss polyester powder-coat
	Geartray	White Reflective gloss polyester powder-coat
Materials:	Main body	- 0.9mm micro perforated mild steel
	Canopy/Gear Tray	- 0.7mm mild steel.
	Diffuser	- Extruded polycarbonate
	Acoustic absorbers	- 80Kg/m <sup>3</sup> Tissue wrapped compressed fibreglass
Control Gear:	Fixed Output/DALI control gear as specified	
Operating Temp:	25°C	
Supply:	220-240v 50/60hz AC	
Connection:	Unfused 2.5mm terminal block (10mm wire strip length)	
IP Rating:	IP20	

## GENERAL INFORMATION

1. A qualified electrician, in accordance with IEE wiring regulations, should carry out connection to mains wiring.
2. Ensure that the rated voltage and frequency requirements are compatible with the available mains supply.
3. Cleaning of reflectors and lenses should be carried out using clean, soft and lint free cloths and anti-static cleaning fluid.
4. Do not carry out high voltage insulation test, i.e. 500/1000v this may damage internal components.
5. Electrically isolate this luminaire during maintenance.
6. Replacing the light source within this luminaire shall only be carried out by the manufacturer, service agent or a similar qualified person.

### TECHNICAL SUPPORT

Tel: 0161 331 5700

e-mail: [technical@whitecroftlight.com](mailto:technical@whitecroftlight.com)

[www.whitecroftlighting.com](http://www.whitecroftlighting.com)

Whitecroft  
lighting

## Foil SRD Installation Leaflet

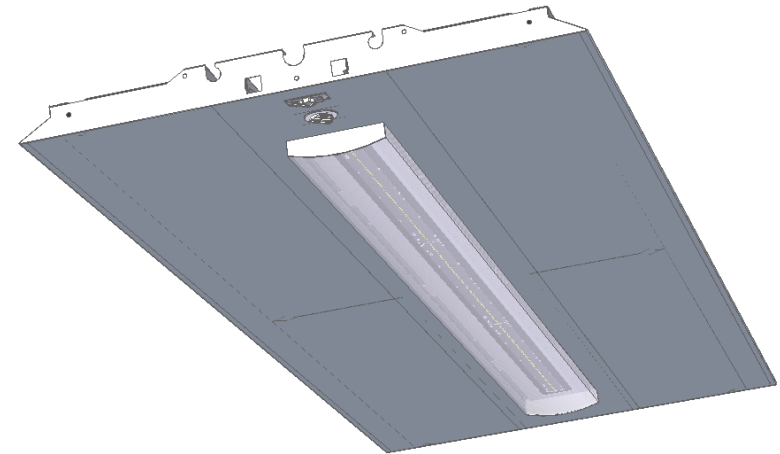

PK-LEAF-FOILSRD

May 2018 - Rev2



## Whitecroft Lighting Limited

Burlington Street, Ashton-under-Lyne, Lancashire OL7 0AX

Telephone +44 (0)870 5 087 087 Facsimile: +44 (0)870 5 084 210

Registered No. 3848973 England

Registered Office: As above

**Luminaire Package contains:**

- Foil SRD Luminaire
  - Continuous mounting kit
- Suspension kit (supplied separately)**

**contains:**

- 4x Clutches
- 4x suspension wires
- 4x ceiling cup sets.

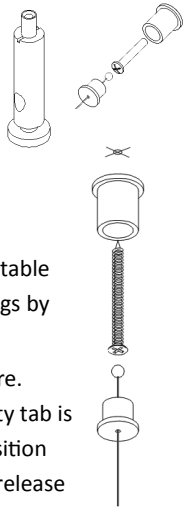

**Installation procedure:**

1. Mark out and install suspension wires. See table for fixing centers (fixings by others).
2. Fit clutches to luminaire. Ensure that the security tab is returned to a level position to prevent accidental release of the clutch.

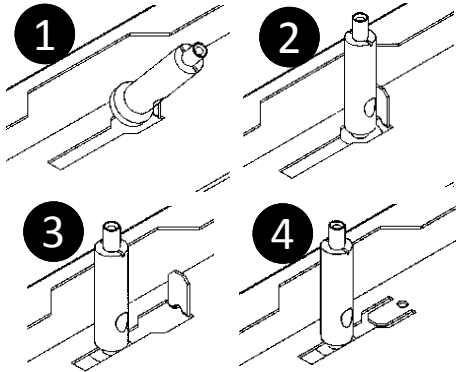

3. Offer up the luminaire and feed wires into clutches. NB Check body orientation—arrows must be aligned to each other.

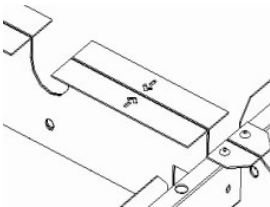

4. Level to final position.
5. Fix to wall if required at start of run: (fixings by others).

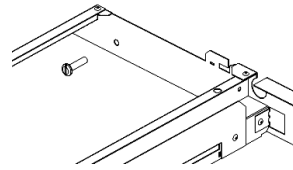

6. Fix to adjacent luminaires or infills using connecting screws supplied.

- For 400 and 800mm infills fold securing tabs to support the body on adjacent luminaires during fixing.
- For 1200, 1800 and 2200mm infills, use wire suspension kit as with luminaires.

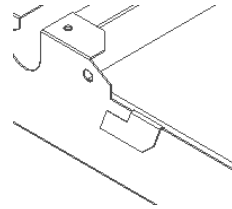

- Do not remove acoustic pads—move aside to access fixings.
7. Remove the terminal access screw and bend up the tab to access terminal blocks. If luminaire is equipped with EM or EP, remove 5 screws to release entire geartray.
  8. Make electrical connections. Add supply to next luminaire as required (Flex and additional gland by others). Connect battery wires on EM/EP fittings (see dia)
  9. Re-fit the terminal access screw. For EM/EP luminaires, refit 5 screws to secure geartray. Ensure serrated washer is re-fitted for earth continuity.
  10. Fit endcap at end of row using nuts supplied.

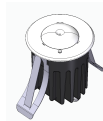
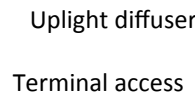
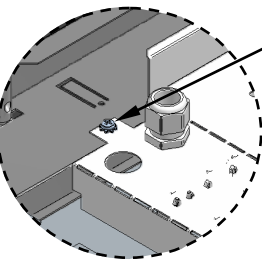

Florin with open area lens

	Product length (A)	Suspension centers (B)	Suspension centers (C)	Weight (Kg)	Weight with EM (Kg)
<b>luminaires</b>	2200	2000	250	23.4	23.6
<b>Infill 400</b>	400	200	250	4	-
<b>Infill 800</b>	800	600	250	8	-
<b>Infill 1200</b>	1200	1000	250	12	-
<b>Infill 1800</b>	1800	1600	250	18	-
<b>Infill 2200</b>	2200	2000	250	22	-

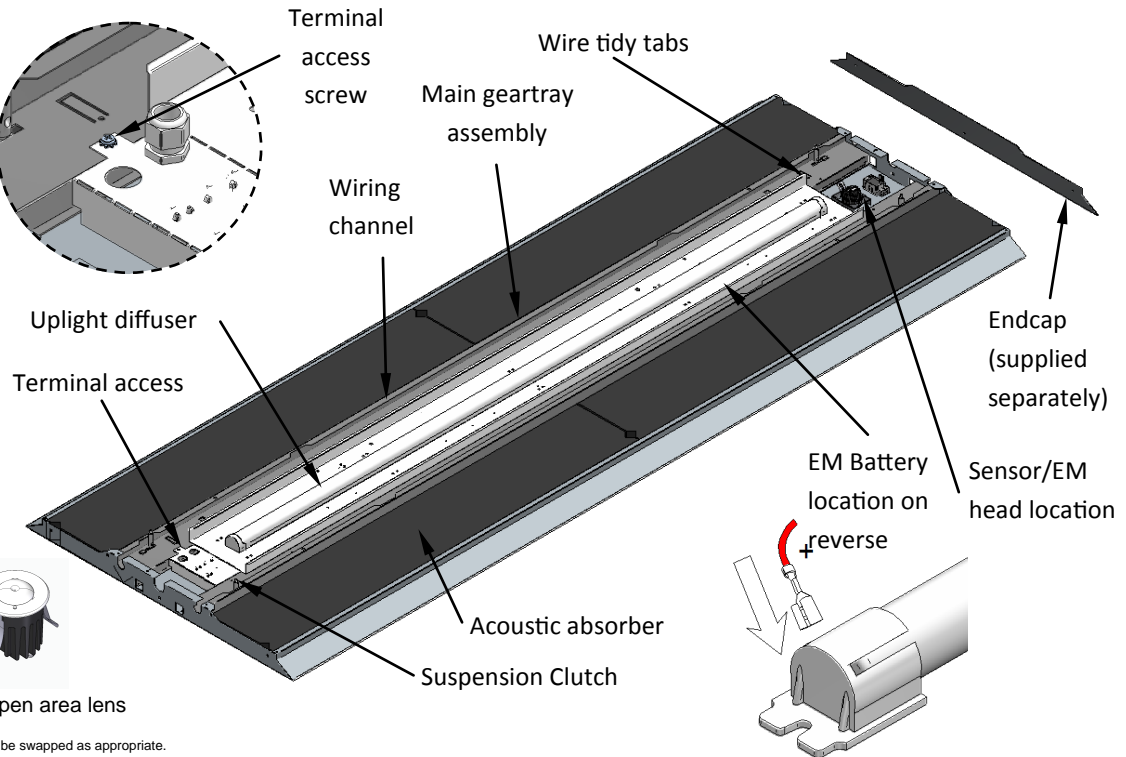
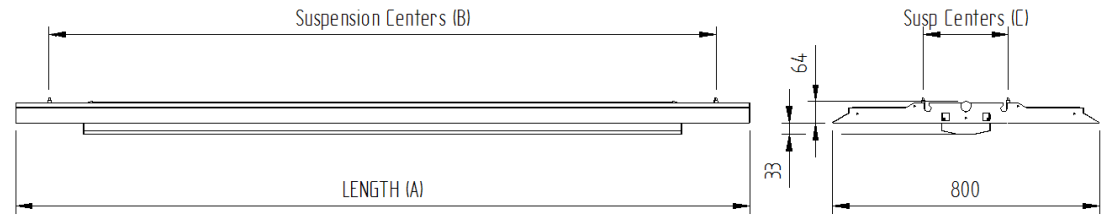

For emergency fittings the Florin downlight will be supplied with an "open area" lens, the "escape route" lens (corridor) will be packaged separately and can be swapped as appropriate.