

Vepps

# We know washrooms

## Installation Instructions

# Recommendations for Solid Grade Laminate (SGL)

## Machining

- Use tungsten carbide tipped blades/cutters or metal cutting tools.

## Cutting

- For a clean cut, use carbide tipped saw blades with trapezoidal & as many teeth as possible or jigsaw with metal cutting blade.
- Alternating teeth may be suitable, but the cut will not be as clean.
- For best results, use horizontally fixed saws.

## Precision Cutting

- A clean edge without flaking can be obtained.
- For best quality cut:
  1. Saw the panel slightly oversize
  2. Re-cut edge to precise measurement using a tungsten carbide tipped router cutter of required profile at 18,000 to 22,000 rpm.

## Grooving

- SGL can be grooved; use a saw blade or router cutter with tungsten carbide tips.
- Groove depth must not exceed 1/3 of SGL thickness.

## Drilling

- For best results use carbide bits with 3 prongs (helical bits) in preference to high-speed steel drills.
- Holes can be drilled through part or whole of thickness
- For stopped holes, minimum thickness of 1.5mm to 2mm of laminate must remain (maximum depth of hole = 11mm). Minimum of 1mm space must remain between tenon, screw tip or insert & bottom of hole (otherwise, risk of laminate cracking when fitting)

- Pilot hole diameters for screw fixing to SGL to be 0.5mm less than diameter of screw.

- Generally;
- No 6 screw - 3.5mm
  - No 8 screw - 4mm
  - No 10 screw - 4.5mm
  - No 12 screw - 5mm

- ALL pilot hole diameters should be screw tested before finalising.

## Cut-Outs

- Square cut-outs:

Drill four corners (at least a 10mm diameter hole), start from one of the holes, use a jigsaw with metal cutting blade, cut the holes & square into the corners. Finish with metal file (semi-soft), ensure all sharp arrises are removed to avoid injury.

- Oval or circular cut-outs:

E.g, cutting a basin hole into a vanity top. Drill one 10mm diameter hole, start from the hole, cut according to template, use a jigsaw with metal cutting blade. Finish with metal file (semi-soft), ensure all sharp arrises are removed to avoid injury.

## Resizing & re-edging previously finished panels

- We recommend the panel is cut as previously described, trim to size using a 'TREND' sunk bead router cutter running at 18,000 to 22,000 rpm, finish with 300 grit sand paper.
- Polish as described below.

## Finish edges

- To eliminate machine-cutting imperfections at edges, sand with 300 grit sand paper to fine finish.
- To obtain darker edges, rub edge with cloth soaked in linseed oil or wax. Leave to dry for 30 minutes & wipe off.
- Sharp edges must be smoothed to avoid injury.

# Introduction

## Safety

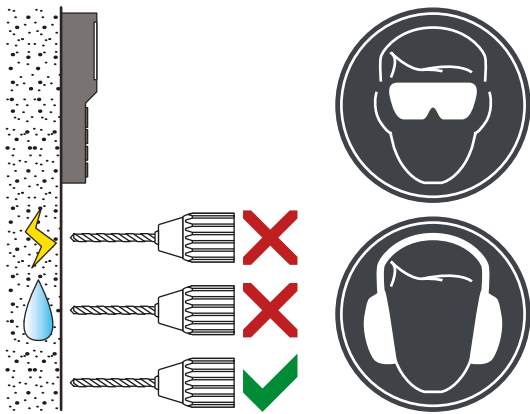

## Panel Storage & Conditioning

- To ensure panels and doors remain flat ambient site conditions must be stable prior to delivery. Variable temperature and humidity can cause panels to bow and twist irreversibly.
- Before, during and after installation, temperature and humidity must be maintained between 18 - 25°C.
- Panels should not be stored outside or in areas where they may be exposed to water or humidity.
- Wet trades and forced-drying procedures should be complete and the building fully dried out.
- Use supports and spacers to elevate panels off the floor and keep space between panels; air must be able to circulate around each panel evenly.
- The ideal base is a slatted pallet with base board; however, if these are not available, panels should be carefully stacked on bearers suitably spaced to maintain flatness. Spacing of bearers should not exceed 400mm.
- Avoid storage conditions where extremes of temperature and humidity can occur.
- Panels must be allowed to equalise to levels approximating to those that will prevail during building use.
- BS EN438 recommendations should be adhered to:

Temperature – 18 to 25°C

Air humidity – 40 to 60%

BS 4965 Flatness: Flatness to BS 4965 can only be guaranteed at the time of delivery.

## Toolbox

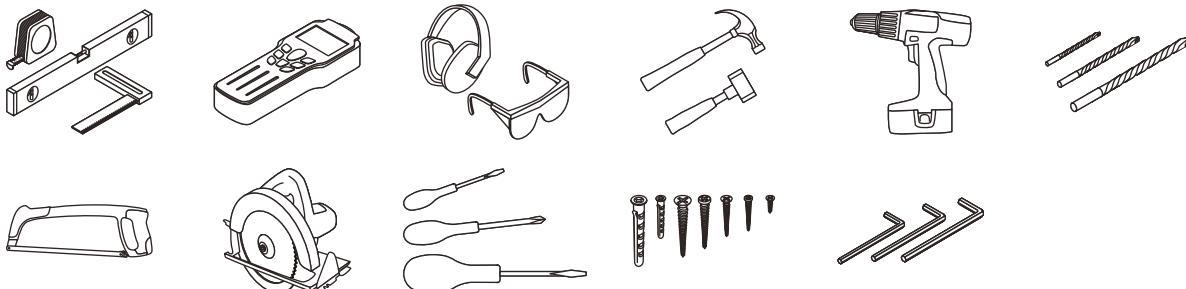

## Prerequisites

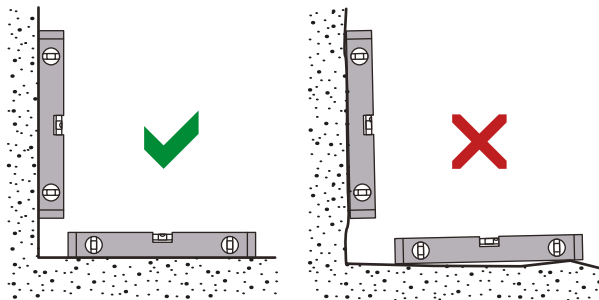

## Secure Fixing

It is vital that the structural integrity of walls, ceilings and floors is capable of taking the dynamic and static loads imposed by the fixings to support the product. Insufficient structural integrity will invalidate guarantees and cause product instability.

The surfaces being fixed into should be firm and stable, without deflection and have good fixing retention properties over the length and width of the bearing surface.

Particular care should be taken with studwork walls and suspended ceilings which will usually require the inclusion of a pattress to sufficiently strengthen the structure.

Poor security of fixings will compromise performance and could lead to failure of the product.

Screws and Fixings supplied to fix components to the floor or wall structural material should be tested to ensure they are suited and have sufficient holding power to accept the static and dynamic loads required to support our products. Due to the multitude of floor and wall constructions, it should not be assumed that the fixings supplied are suitable for all installations. If you are uncertain contact your local specialist fastening supplier.

Do NOT overtighten fasteners, if using power drivers make sure that the torque settings are correct.

## Cleaning & Maintenance

Please consult our cleaning & maintenance guide.

# Contents

<b>1</b>	<b>Layout &amp; Levelling</b>	page 5
<b>2</b>	<b>Baserail Fixing</b>	page 6
<b>3</b>	<b>Corner Channel Fixing</b>	page 7
<b>4</b>	<b>Headrail &amp; Tie-Back Preparation</b>	page 8
<b>5</b>	<b>Headrail Fixing: Suspended Ceiling Option</b>	page 9 - 10
<b>6</b>	<b>Headrail Fixing: Solid Ceiling Option</b>	page 11 - 12
<b>7</b>	<b>Headrail Fixing: Shelf Height Option</b>	page 13 - 14
<b>8</b>	<b>Return End &amp; Top Flashgap Fixing</b>	page 15
<b>9</b>	<b>Headrail Tie-Back to Wall/Ceiling Fixing</b>	page 16
<b>10</b>	<b>End Flashgap and Return End Panel Fixing</b>	page 17
<b>11</b>	<b>Subframe Preparation</b>	page 18 - 20
<b>12</b>	<b>Subframe Connection</b>	page 21 - 22
<b>13</b>	<b>Flashgap to Subframe Fixing</b>	page 23
<b>14</b>	<b>Secondary Subframe Fixing</b>	page 24
<b>15</b>	<b>Plumbing</b>	page 25
<b>16</b>	<b>Panel Fixing</b>	page 26
<b>17</b>	<b>Shelf Fixing</b>	page 27

# 1 Layout & Levelling

- ⚠ Installers should be highly experienced and be qualified to a carpentry joiner level.
- ⚠ Before installation, if in any doubt about how to install these products please contact our technical department.
- ⚠ PPE: Wear personal protection equipment at all times.
- ⚠ Setting Out: Use layout drawings.
- ⚠ Unit Dimensions:  
Refer to layout drawings.  
Any tolerances can be made up with the flashgaps.

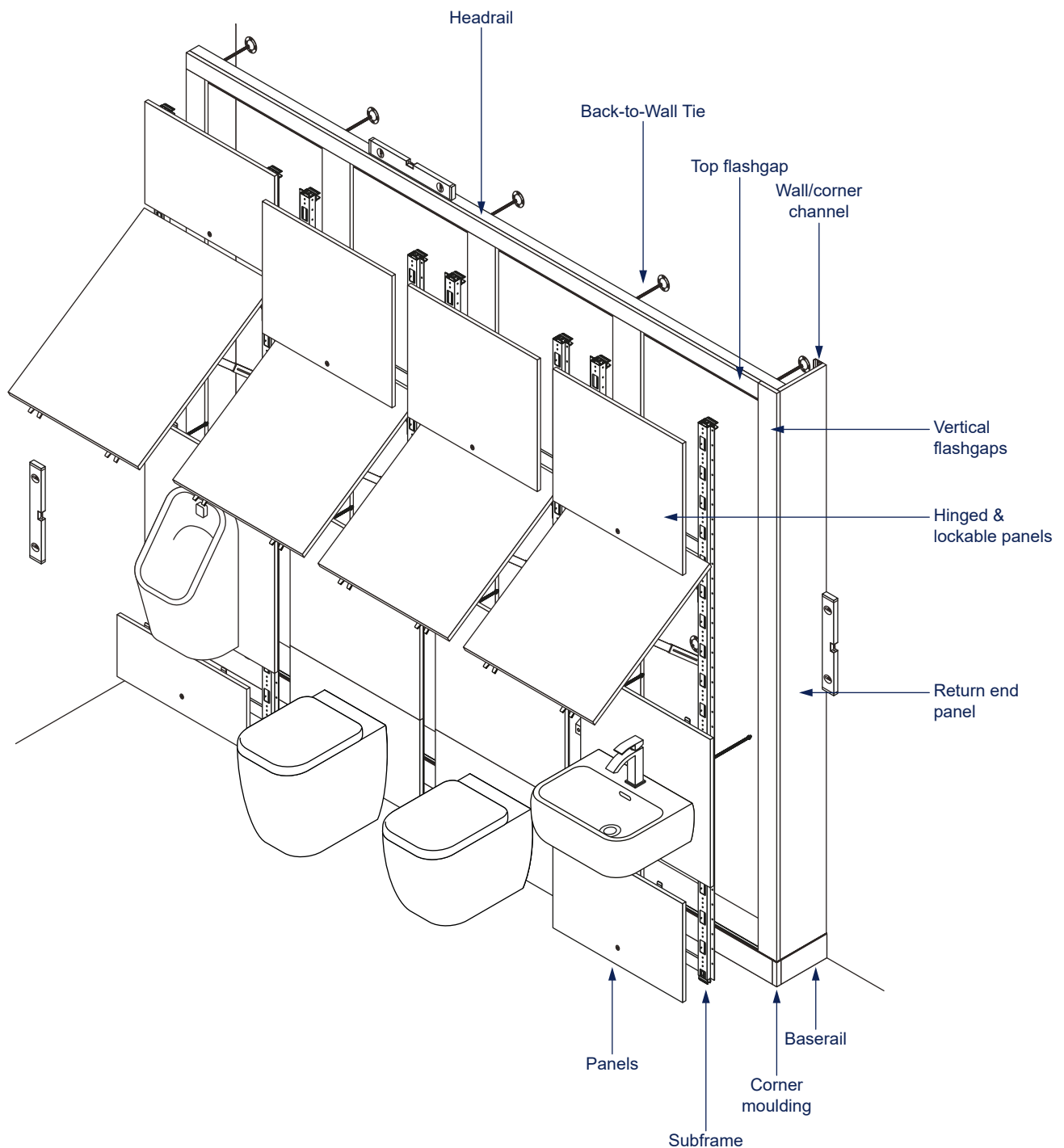

# 2 Baserail Fixing

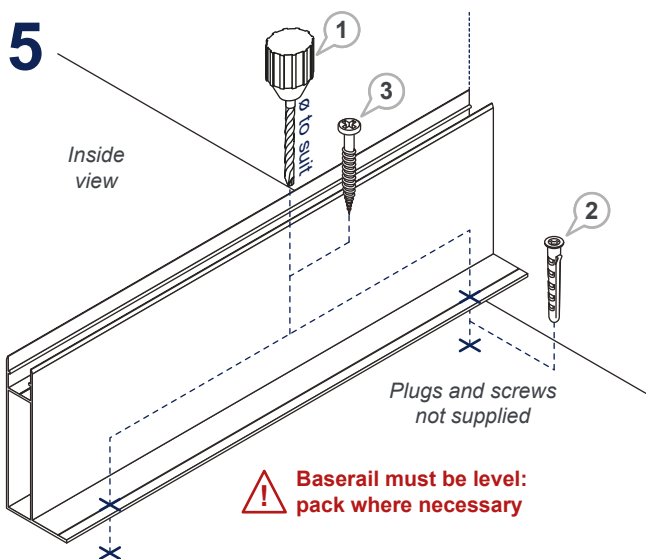
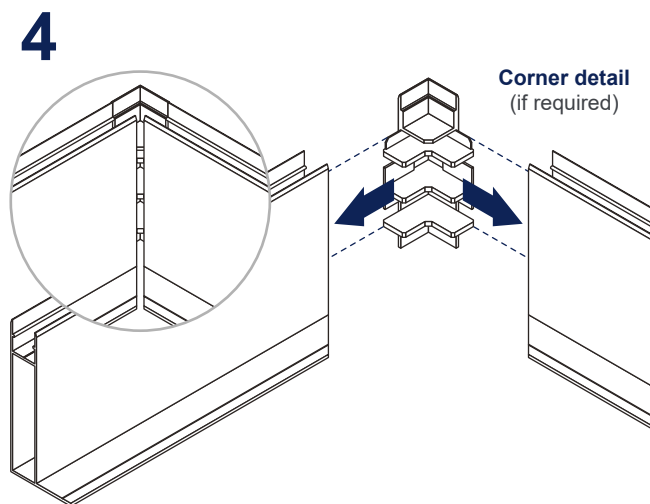
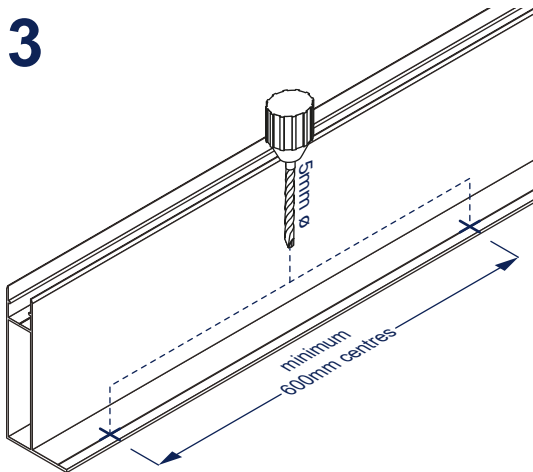
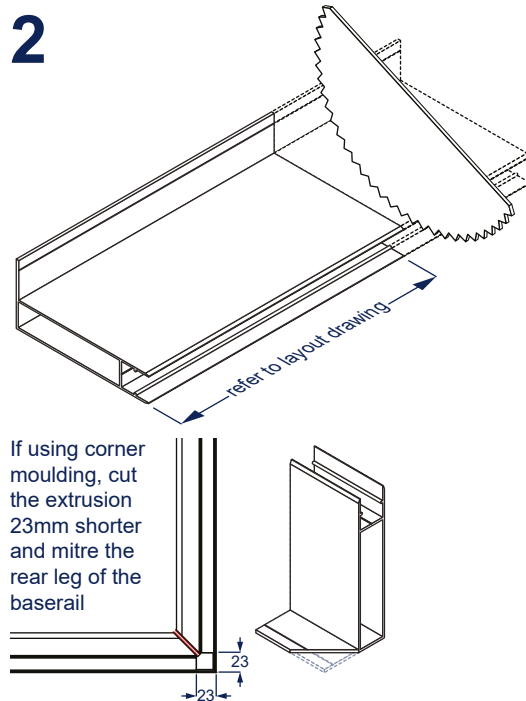
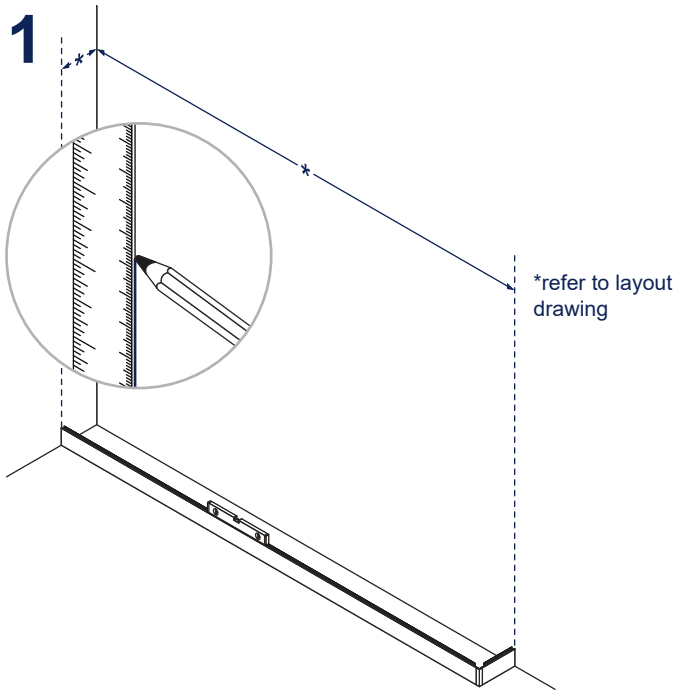

# 3 Corner Channel Fixing

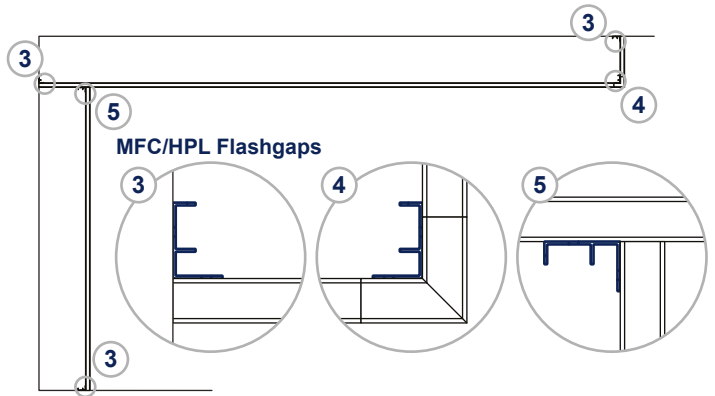
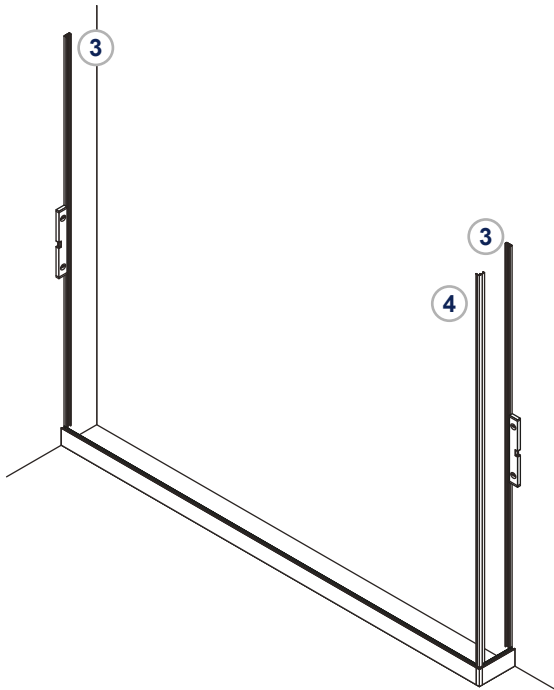

**\*SGL Flashgaps** can be fixed to the corner channel before fixing to the wall /positioning return ends. The corner channel will sit above the baserail. (see 10, page 17)

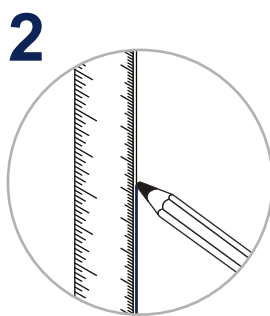
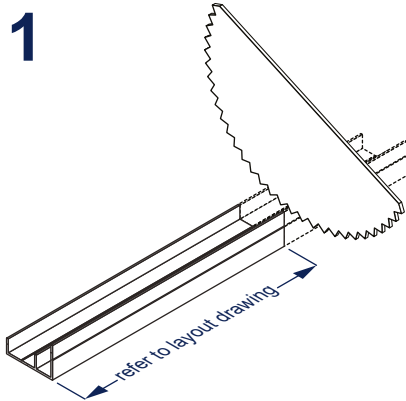
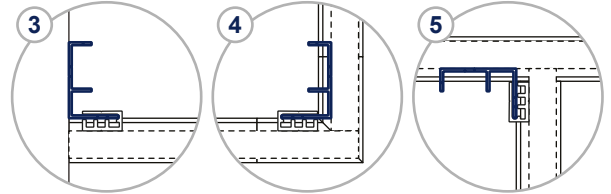

## 3 Wall end detail

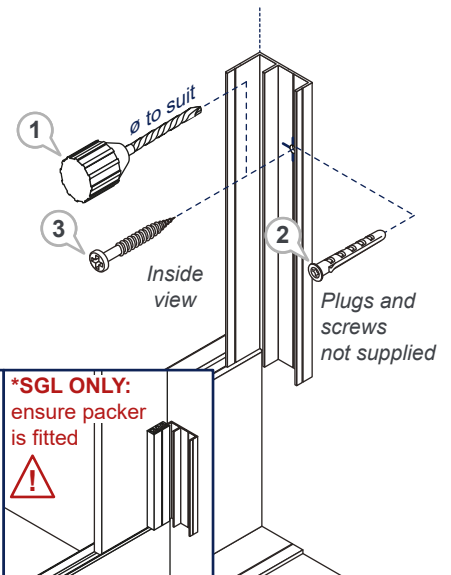

## 4 Corner detail (if required)

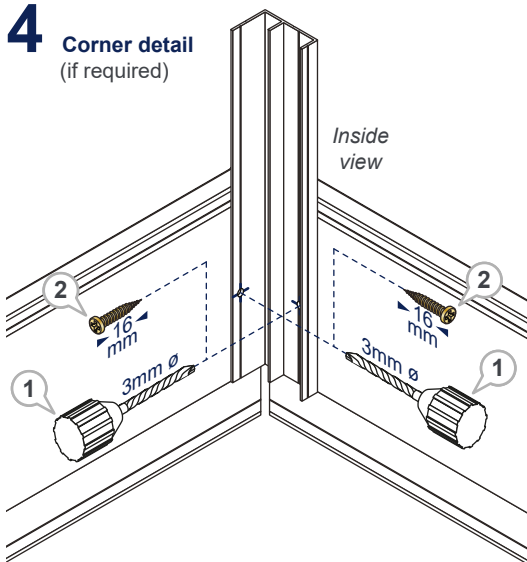

## 5 Internal corner detail (if required)

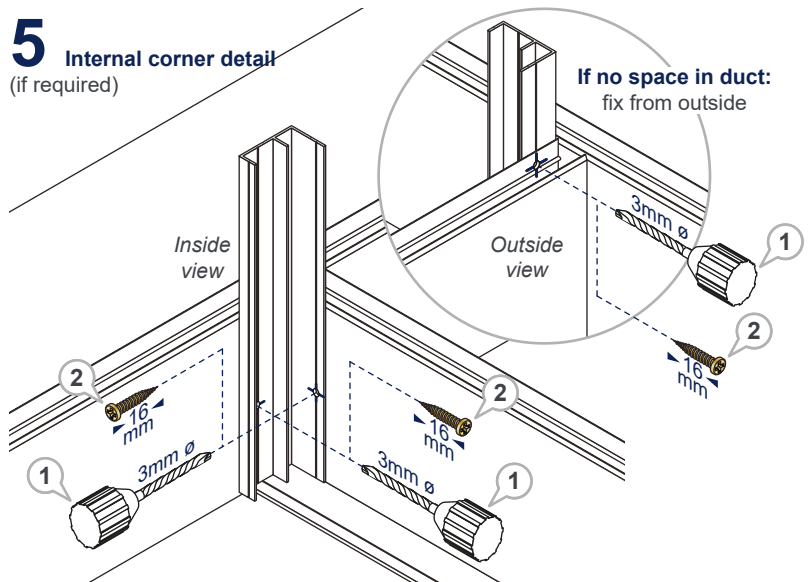

# 4 Headrail & Tie-Back Preparation

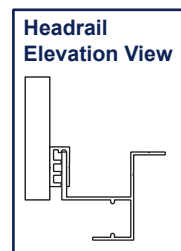
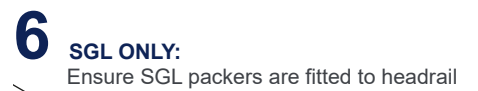
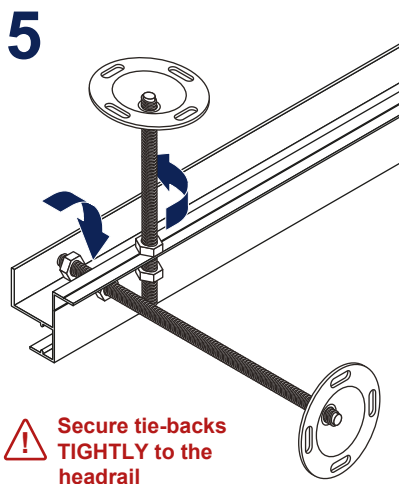
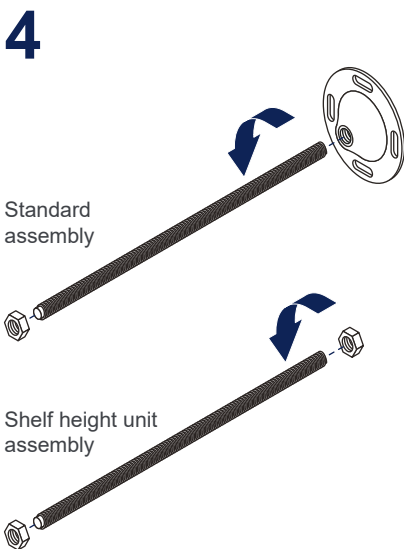
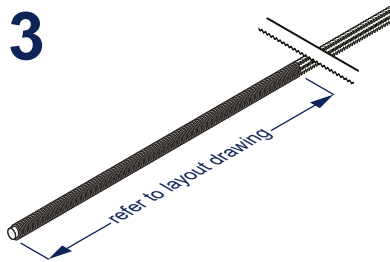
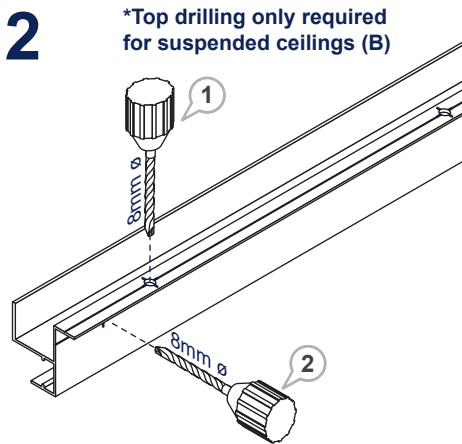
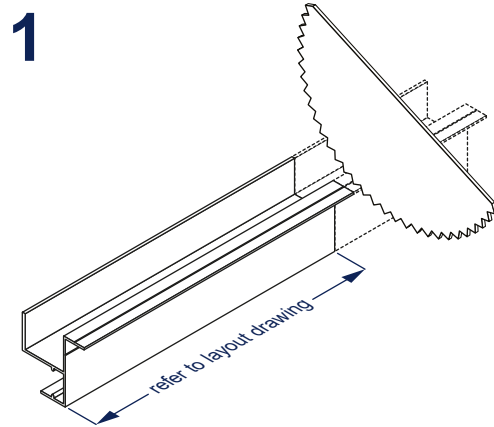
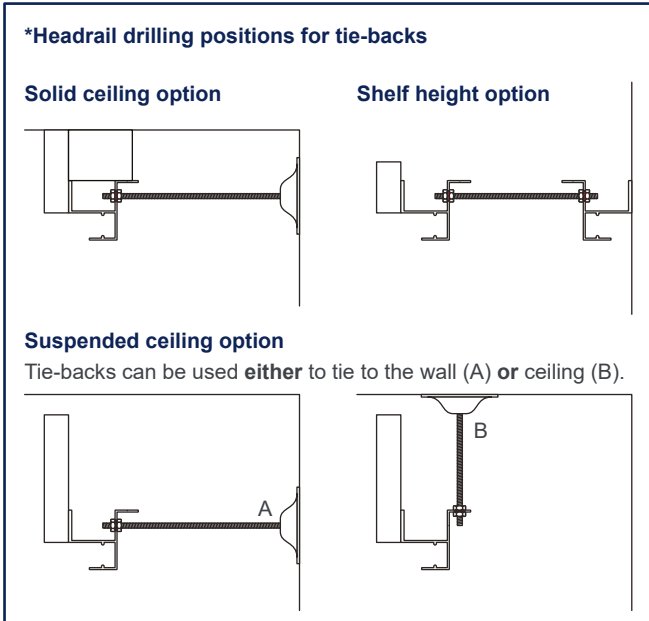

# 5 Headrail Fixing: Suspended Ceiling Option

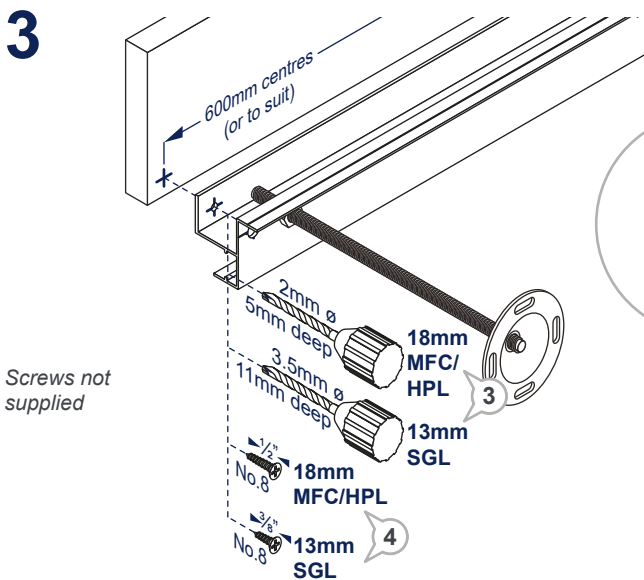
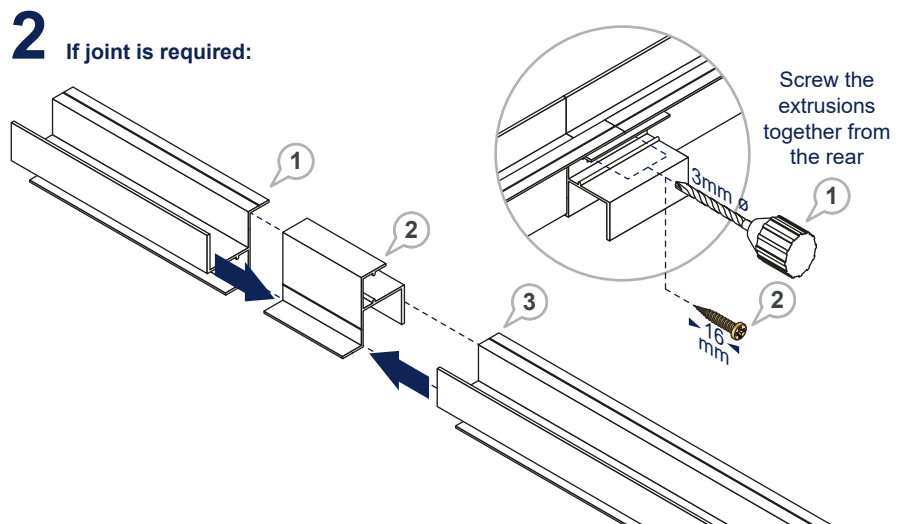
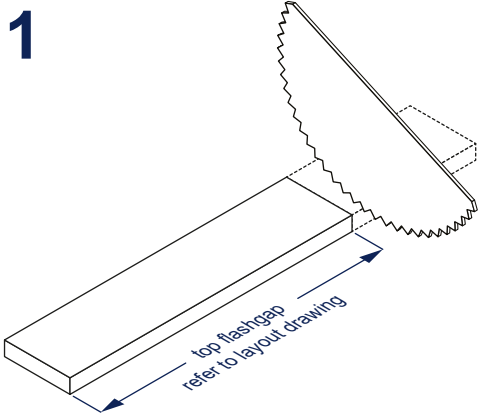
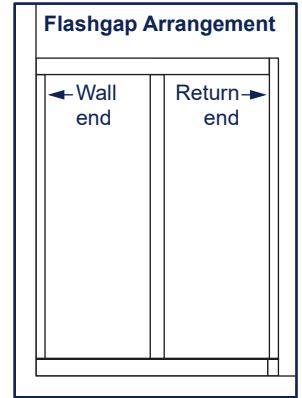
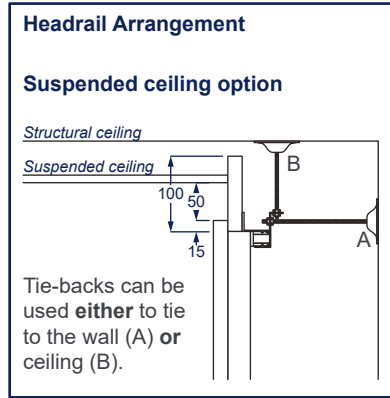
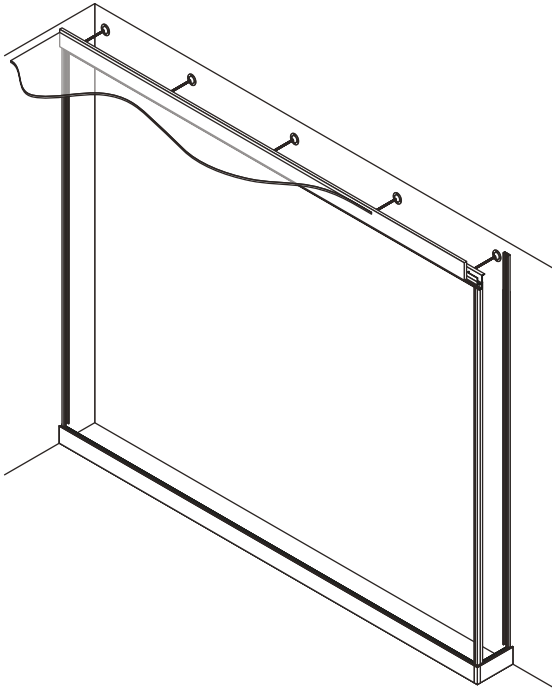

Screws not supplied

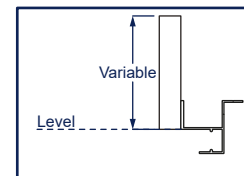
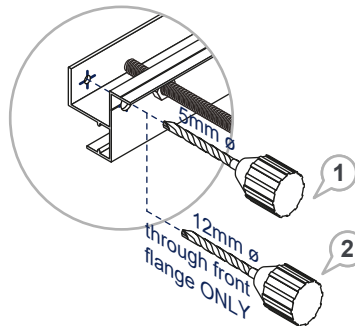

# 5 Headrail Fixing: Suspended Ceiling Option (Continued)

## 4 Wall End Fixing

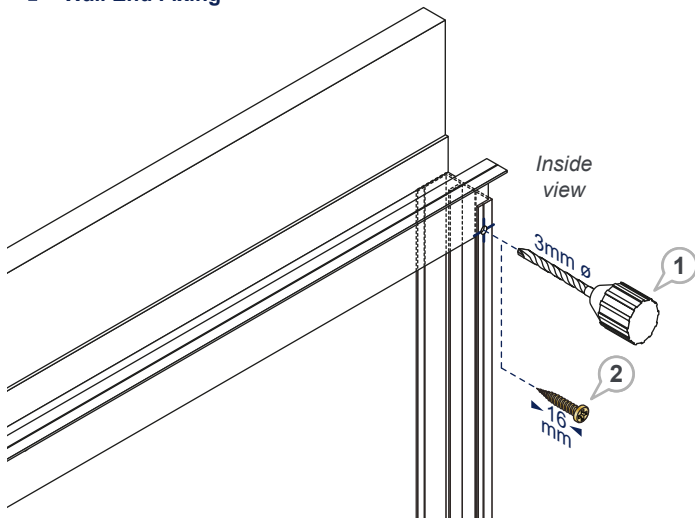

## 5 Return End Fixing

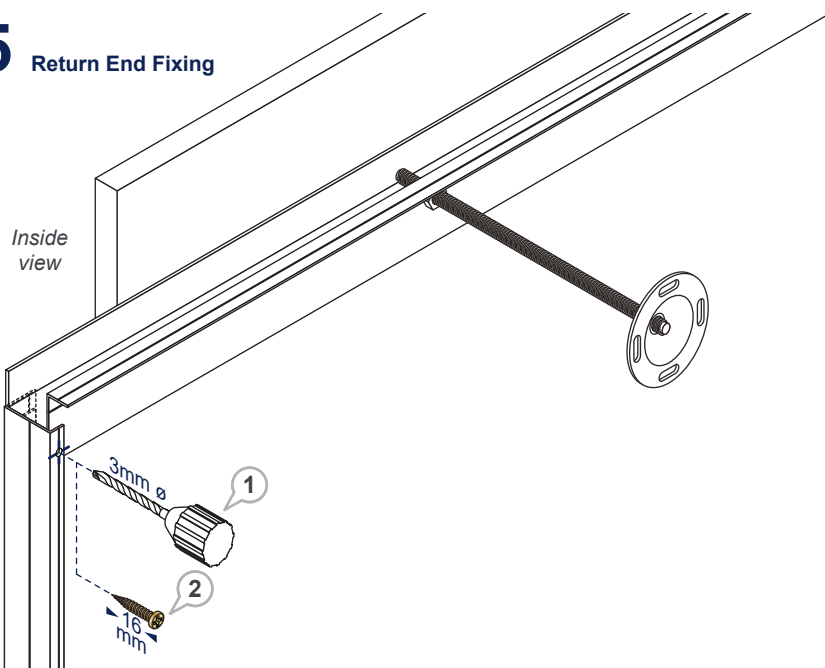

# 6 Headrail Fixing: Solid Ceiling Option

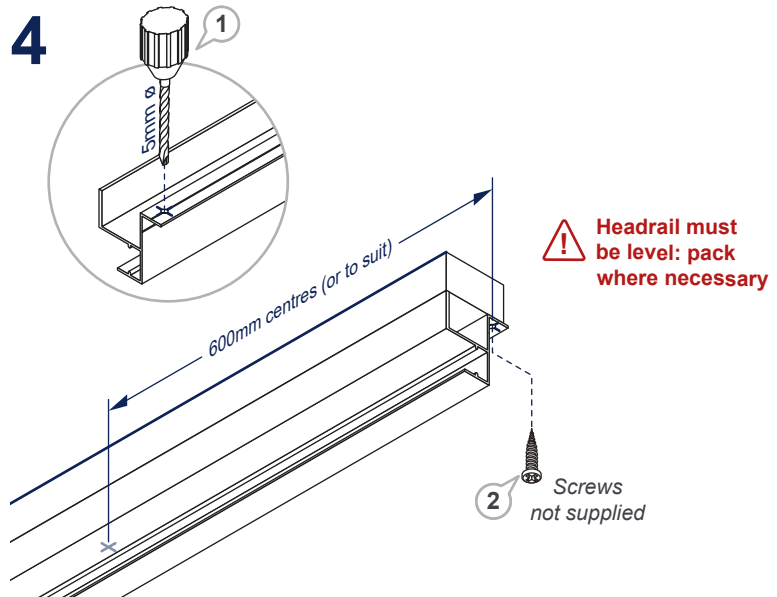
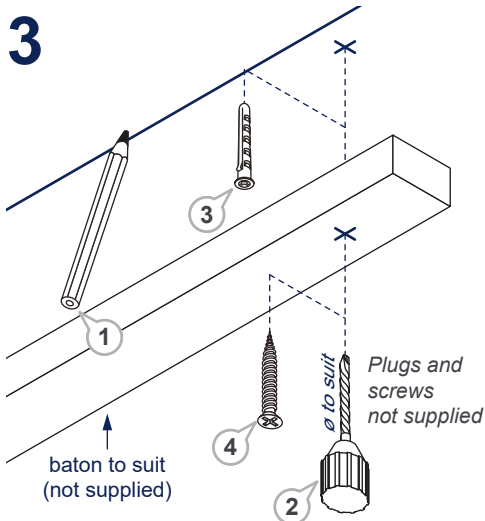
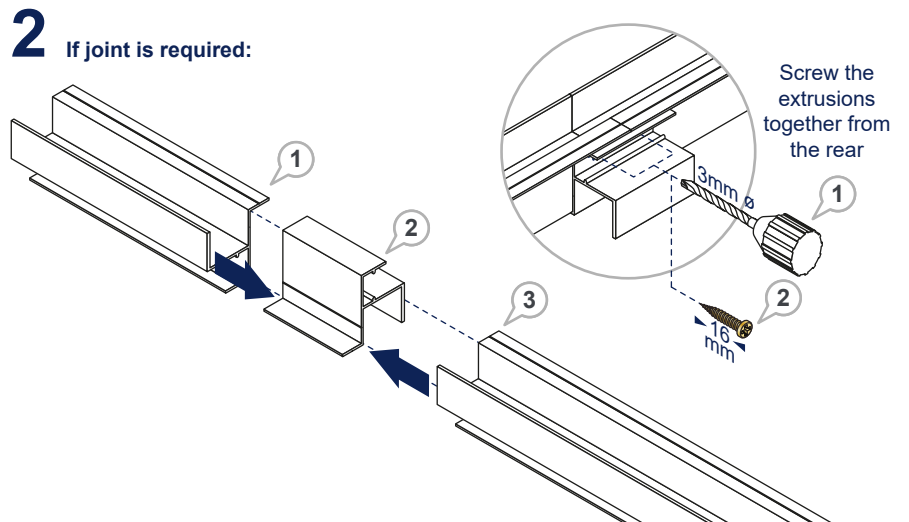
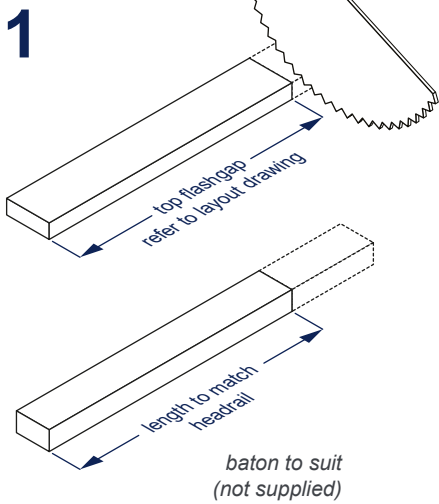
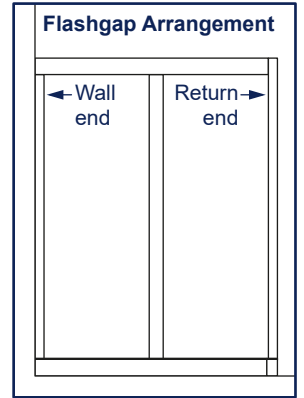
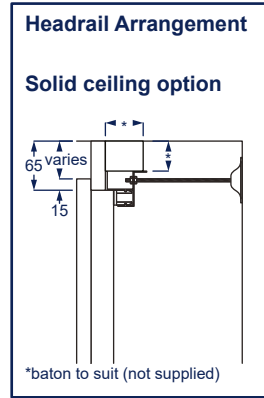
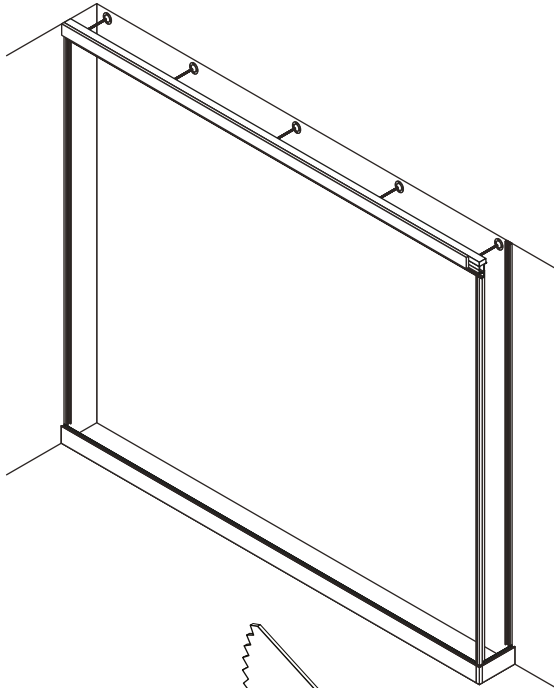

# 6 Headrail Fixing: Solid Ceiling Option (Continued)

5

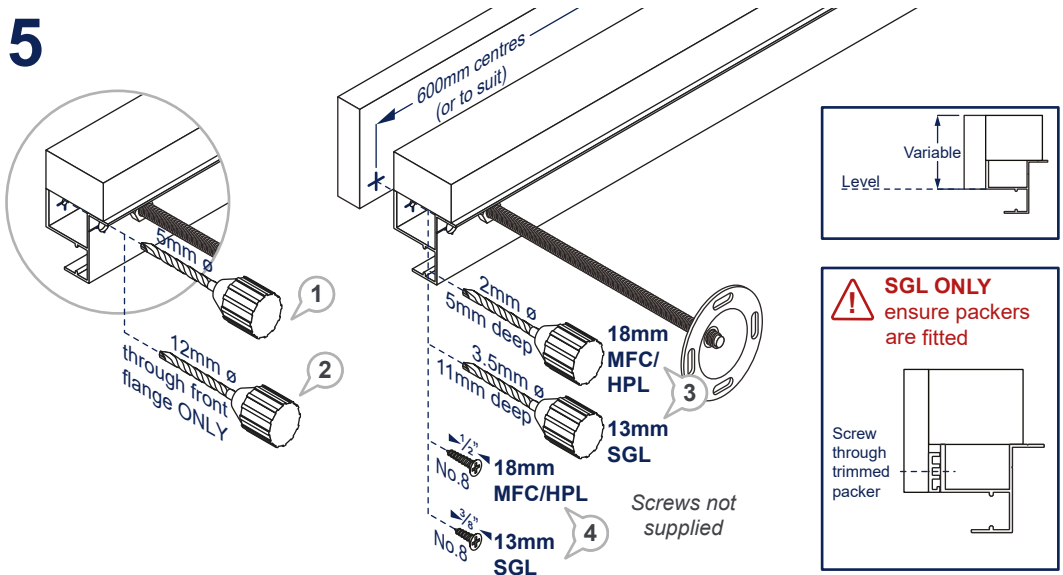

## 6 Wall End Fixing

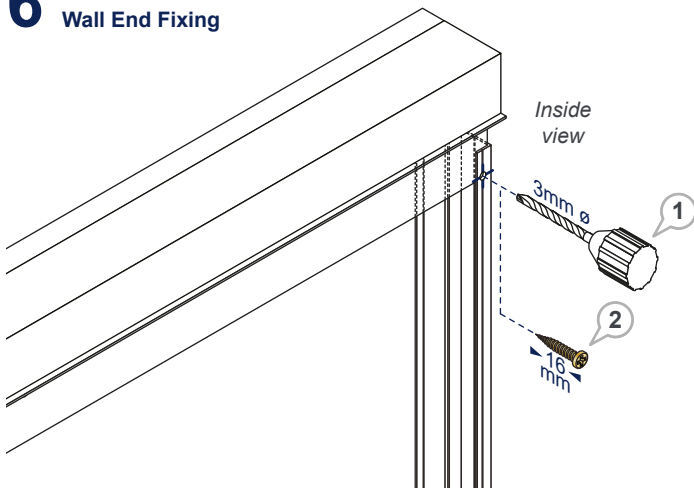

## 7 Return End Fixing

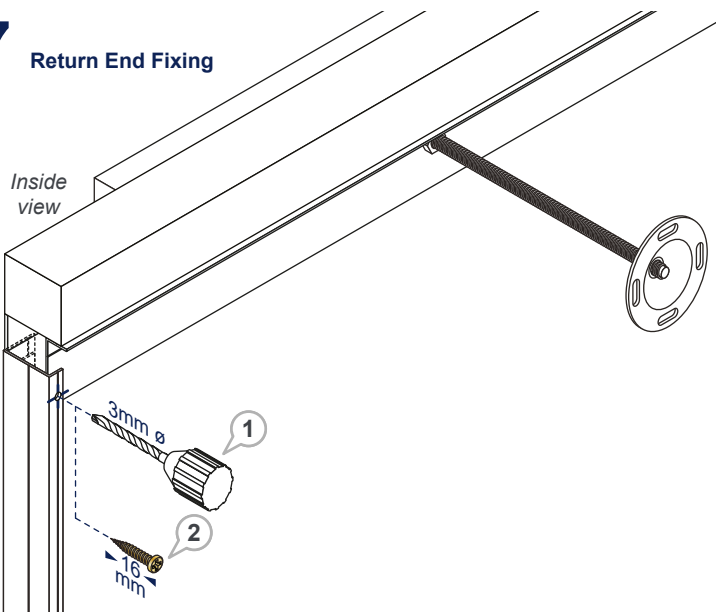

# 7 Headrail Fixing: Shelf Height Option

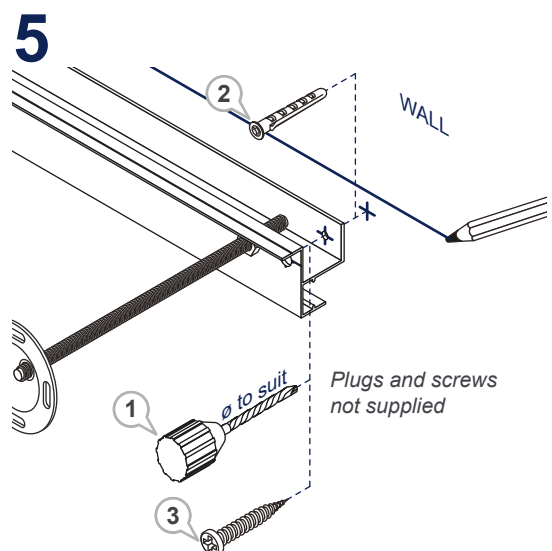
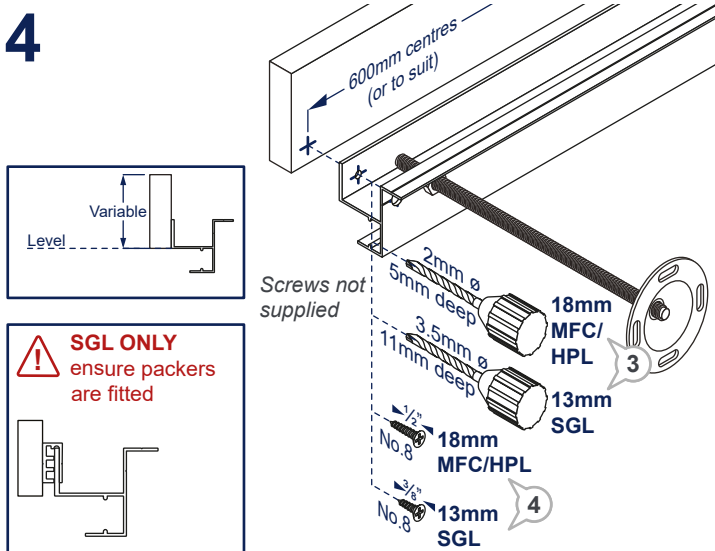
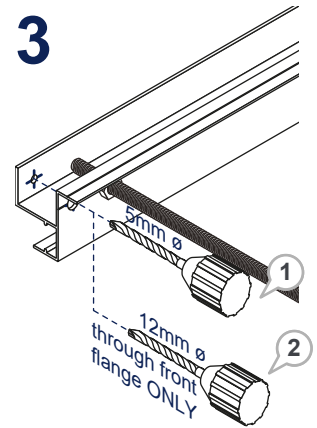
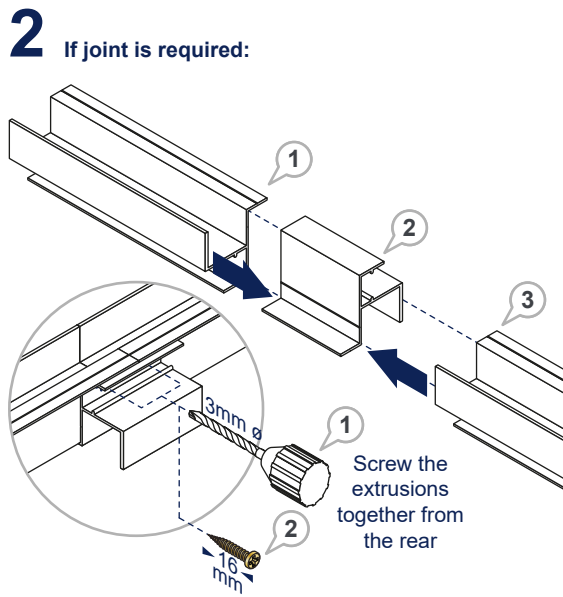
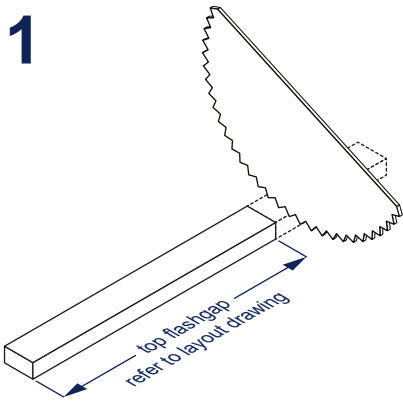
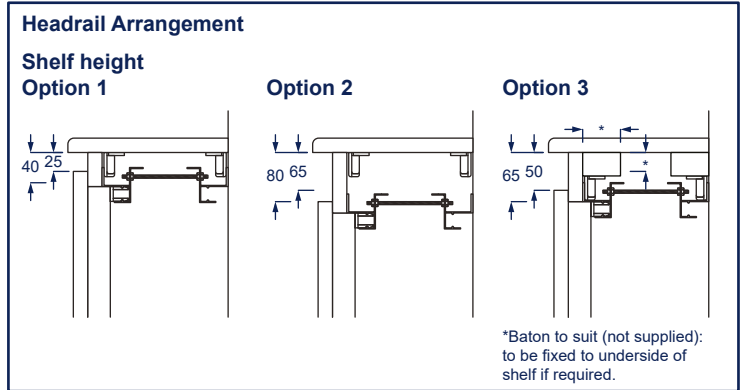
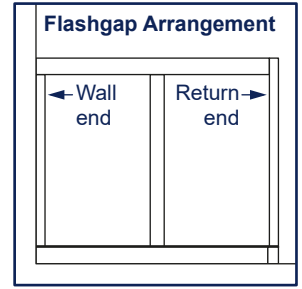
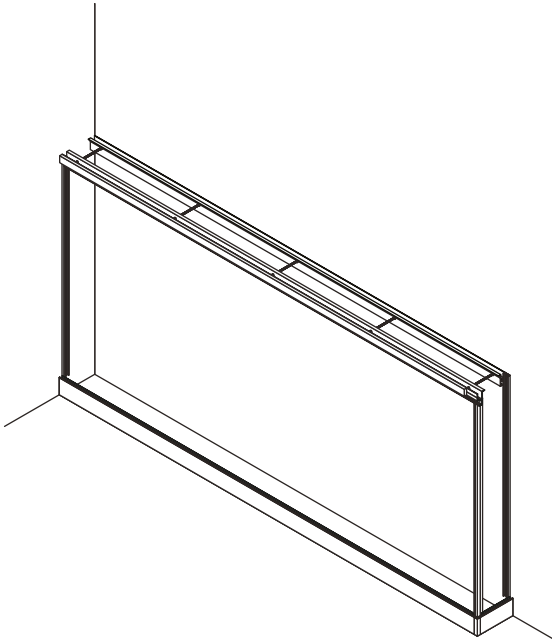

**! SGL ONLY**  
ensure packers are fitted

# 7 Headrail Fixing: Shelf Height Option (Continued)

## 6 Wall End Fixing

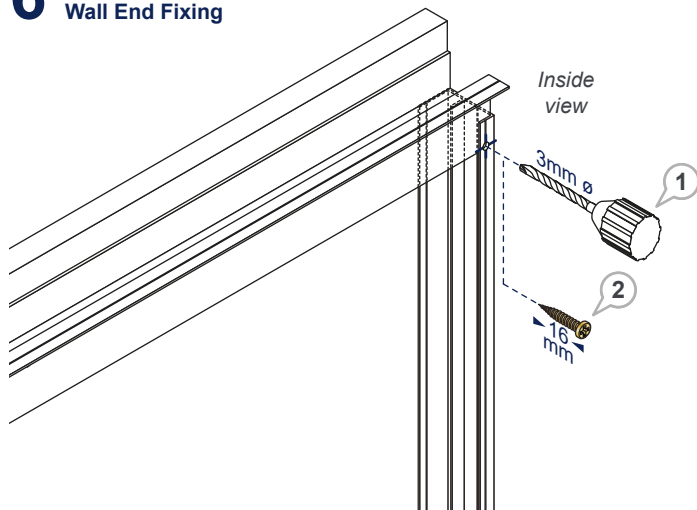

## 7 Return End Fixing

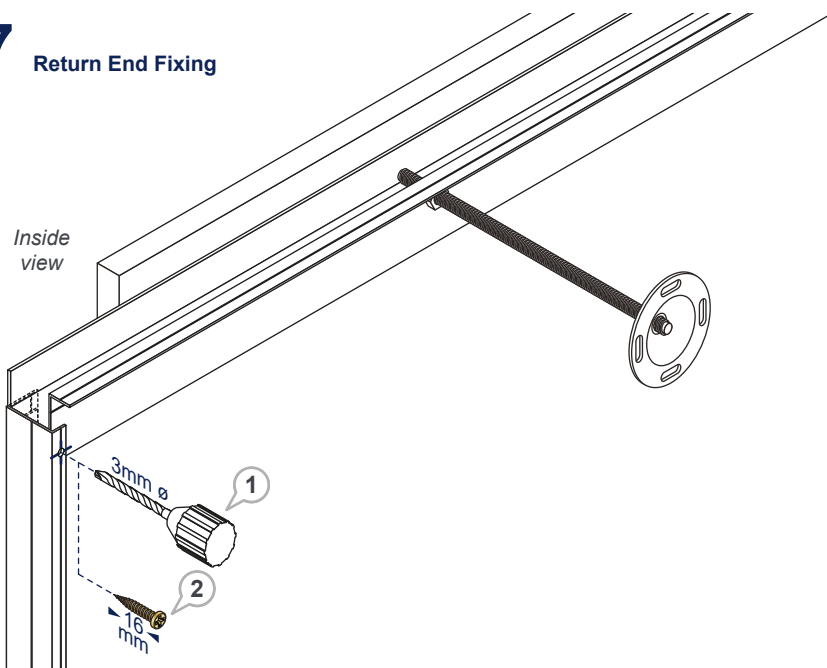

# 8 Return End & Top Flashgap Fixing

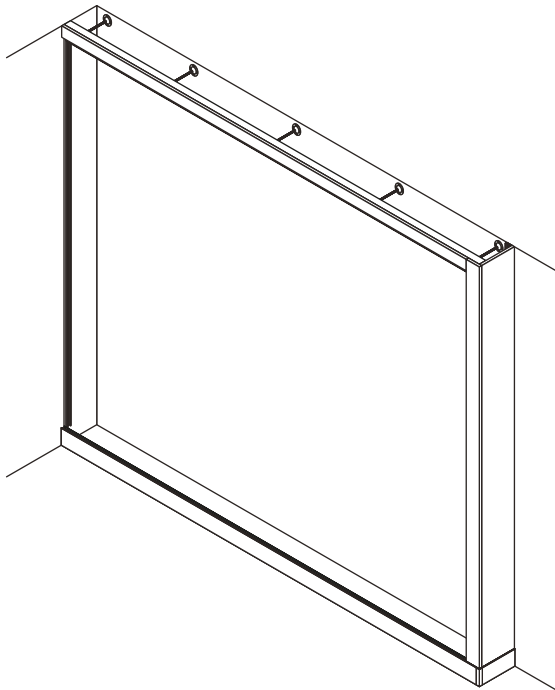

## 1 Return end flashgaps

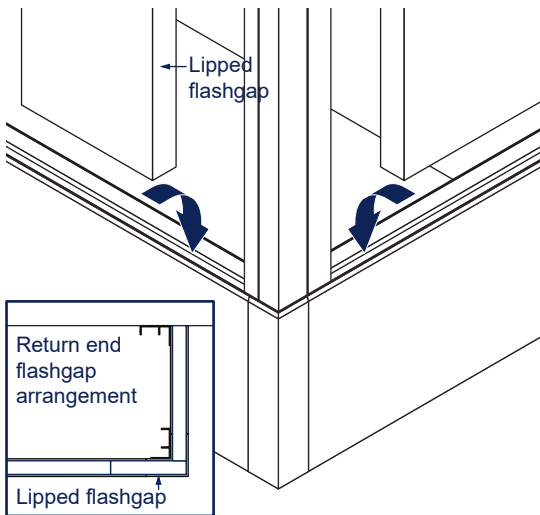

## 2 Return End Fixing

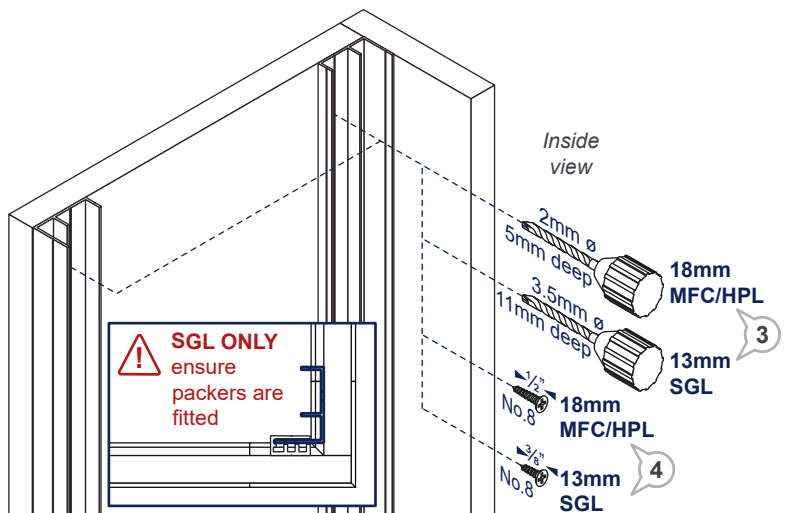

## 3 Return end & top flashgap fixing

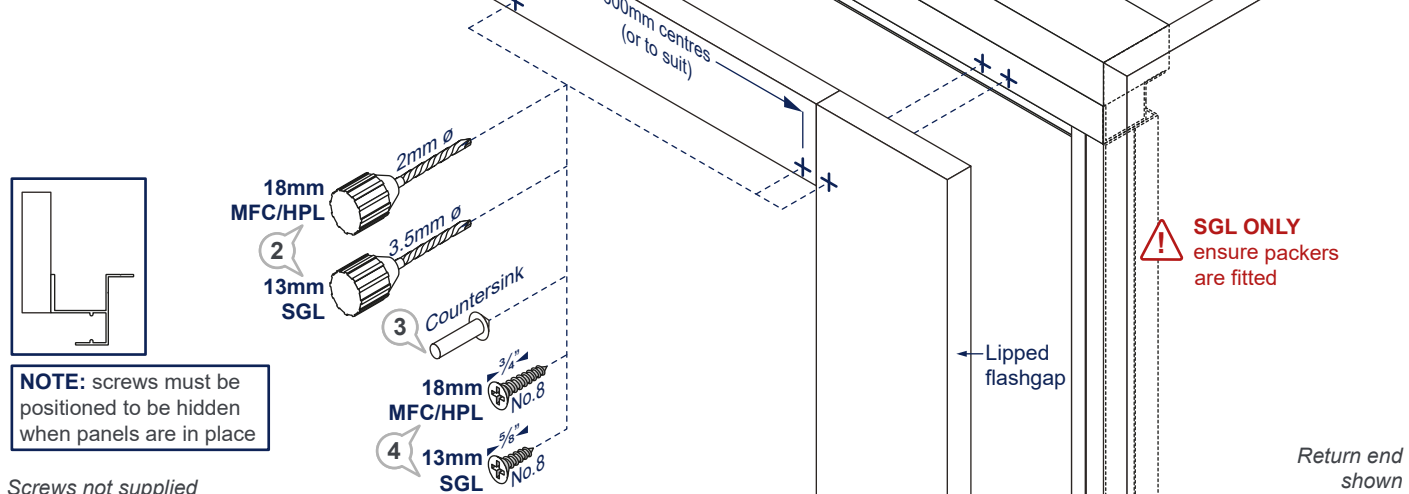

# 9 Headrail Tie-Back to Wall/Ceiling Fixing

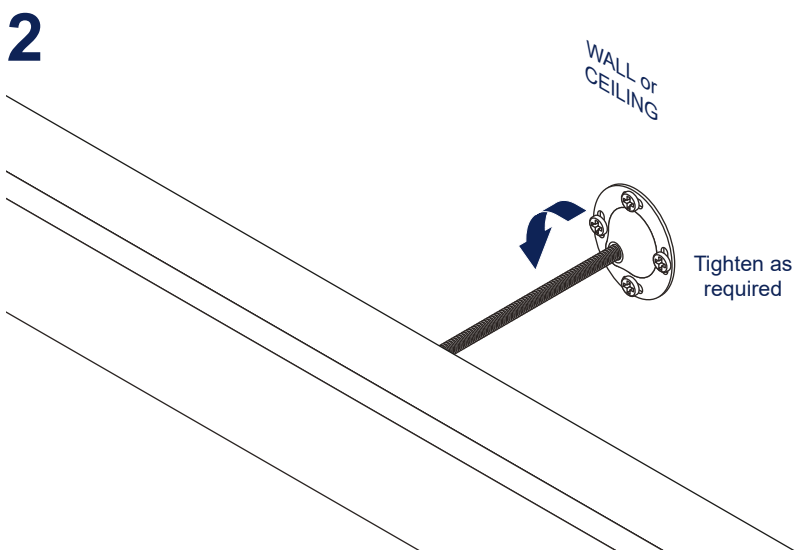
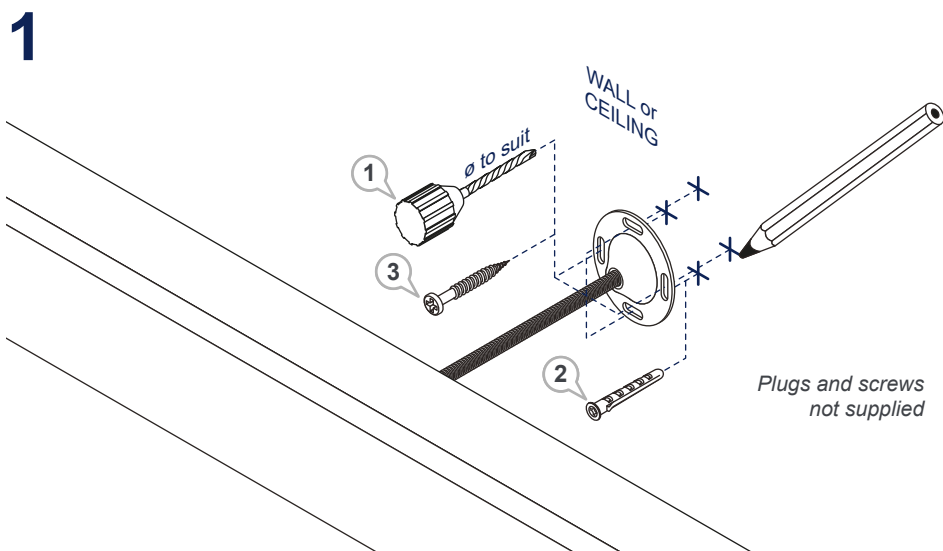
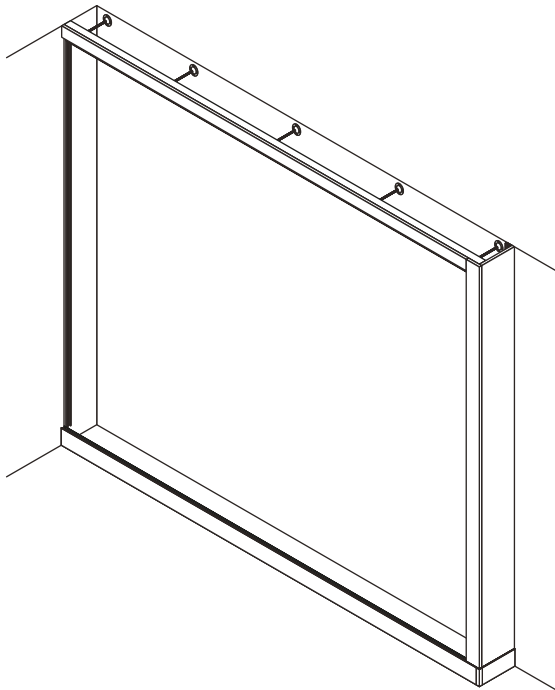

# 10 End Flashgap & Return End Panel Fixing

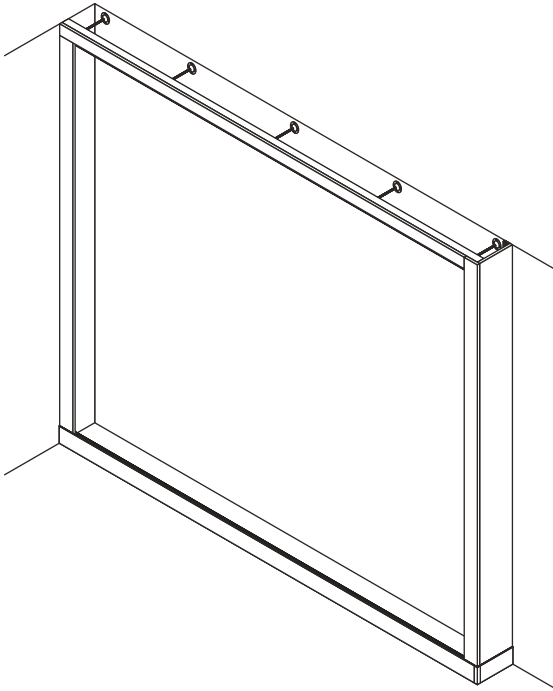

1

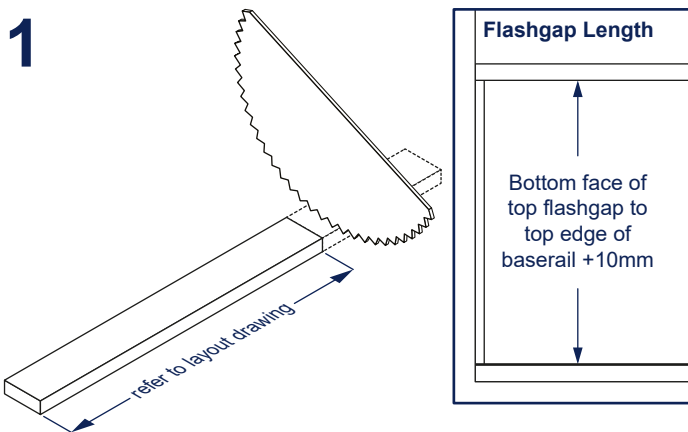

2

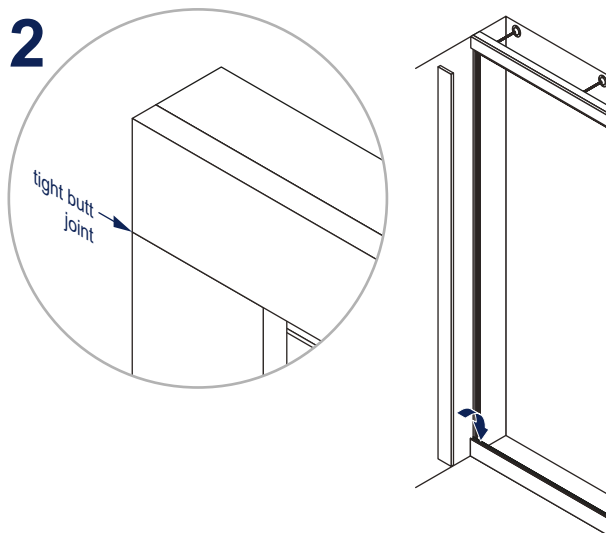

3

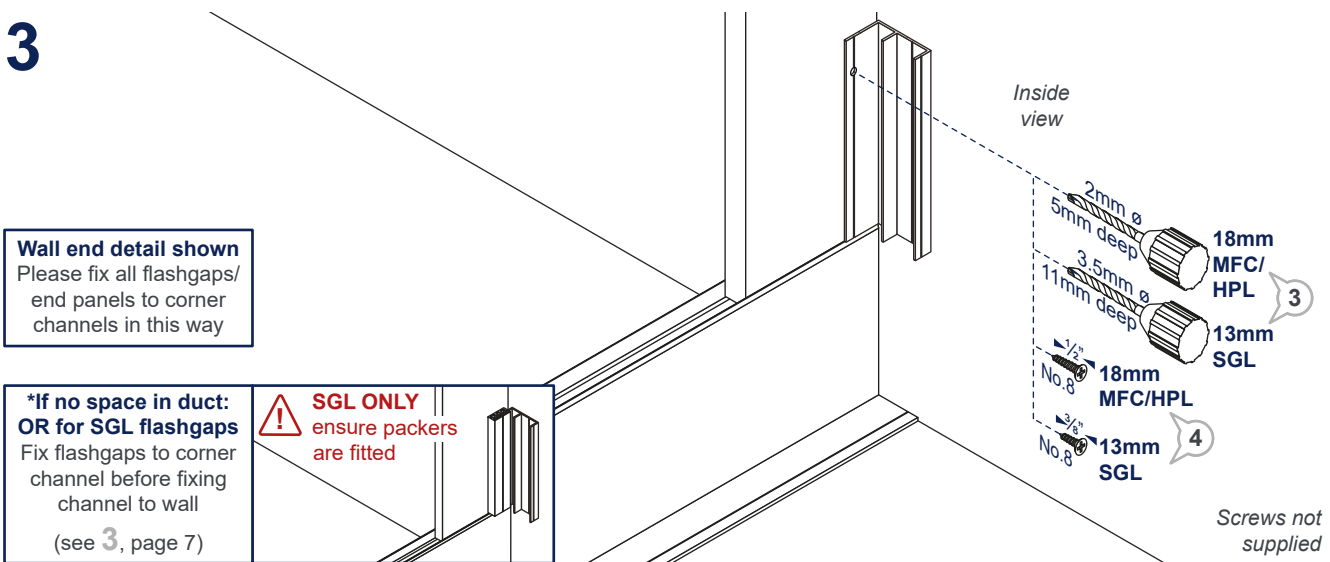

# 11

## Subframe Preparation

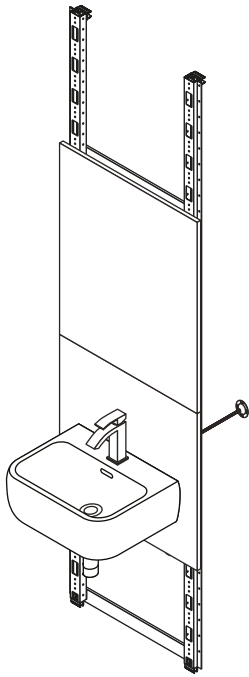

**For Multi-Panel units** subframes are supplied in two pieces to be joined when connecting subframe - see step 12, page 21

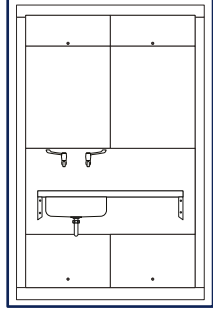

Urinal	Back-to-Wall WC	Wall Hung WC	Fixed
Lift-off (sliding)	Lift-off (sliding)	Lift-off (sliding)	Lift-off (sliding)
Hinged	Hinged	Hinged	Hinged
Fixed	Lift-off	Lift-off	Fixed
Push/pull (or lift <sub>u</sub> down if lockable)	Fixed	Lift-off	Push/pull (or lift <sub>u</sub> down if lockable)

### 1

1 Unlock panels



2 Lift off top panel (if applicable)

3 Pull off lower lift-off and push/pull panels (if applicable)

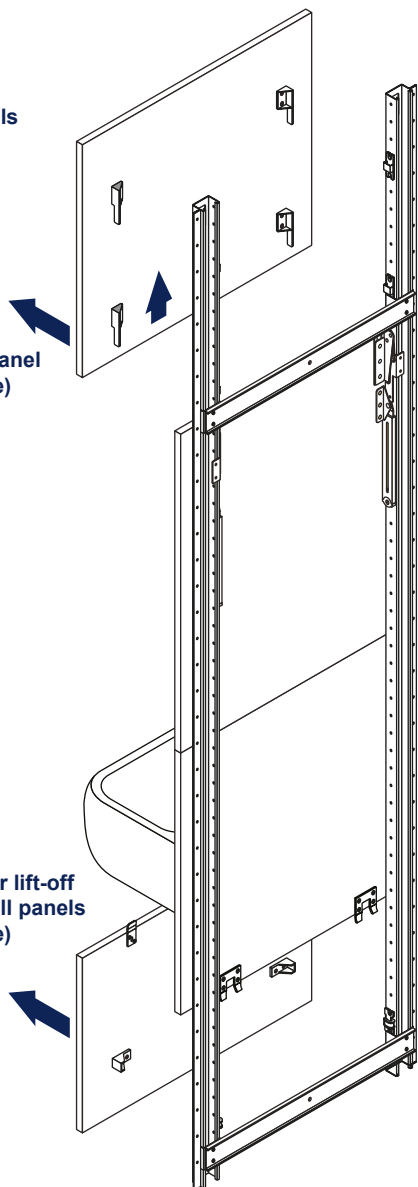

### 2

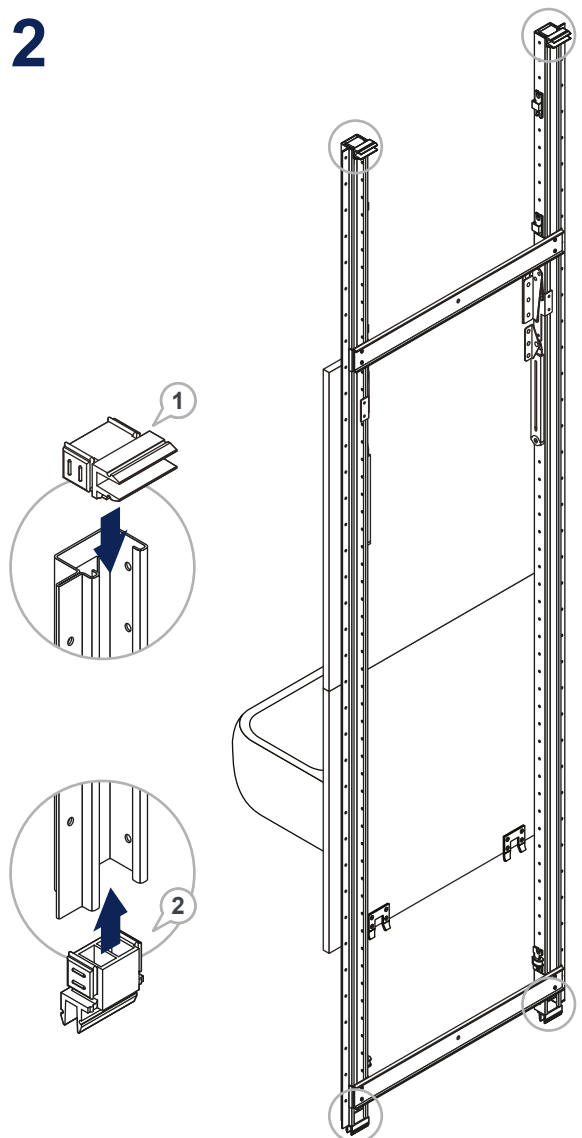

# 11

## Subframe Preparation (Continued)

1

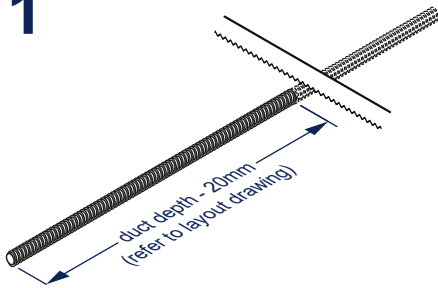

2

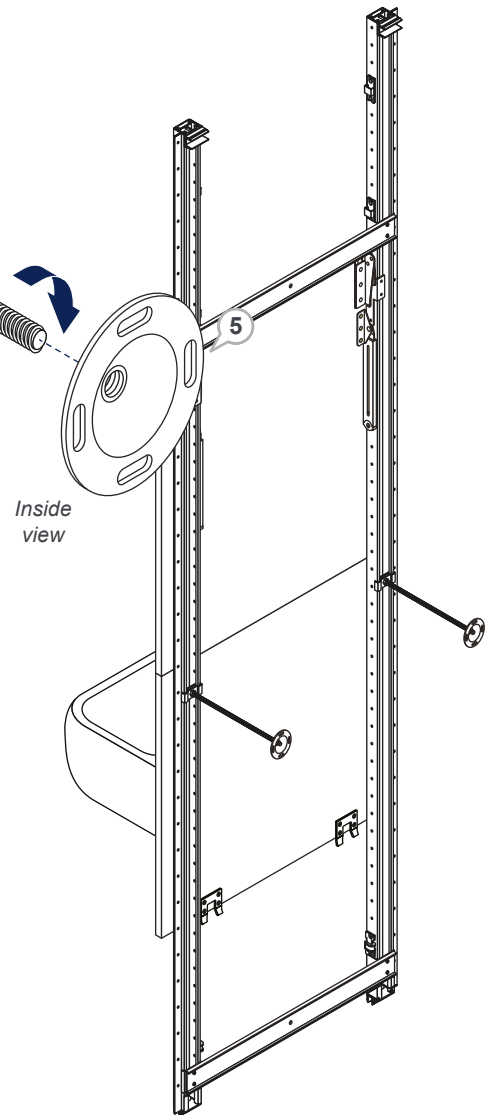
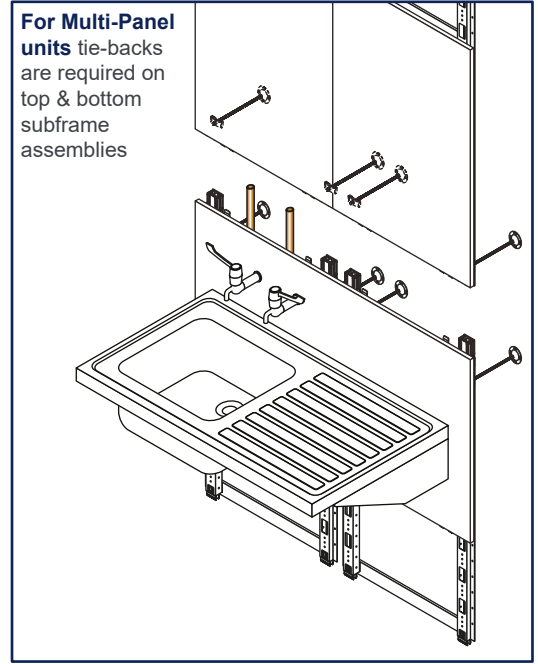
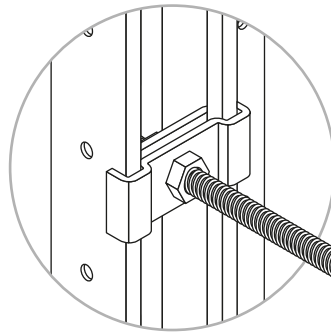
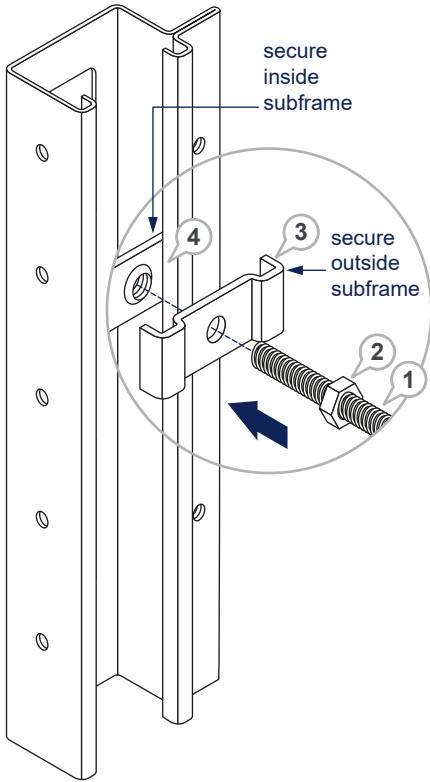

# 11

## Subframe Preparation (Continued) FOR WALL HUNG WCs ONLY

1

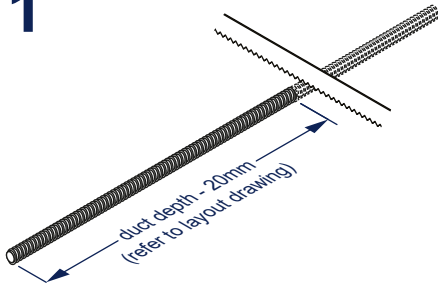

2

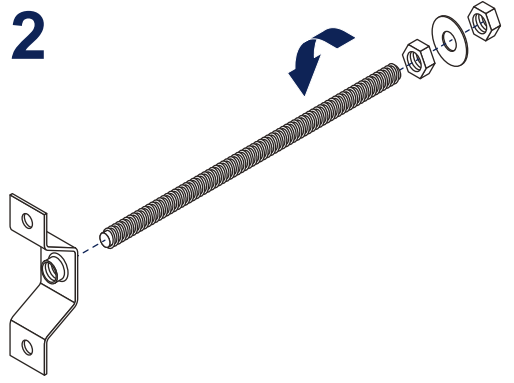

3

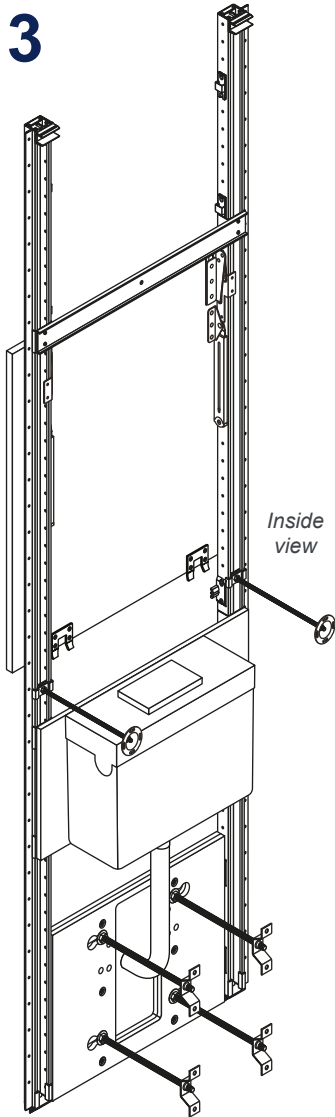

⚠ Secure threads  
**TIGHTLY** to the  
carrier

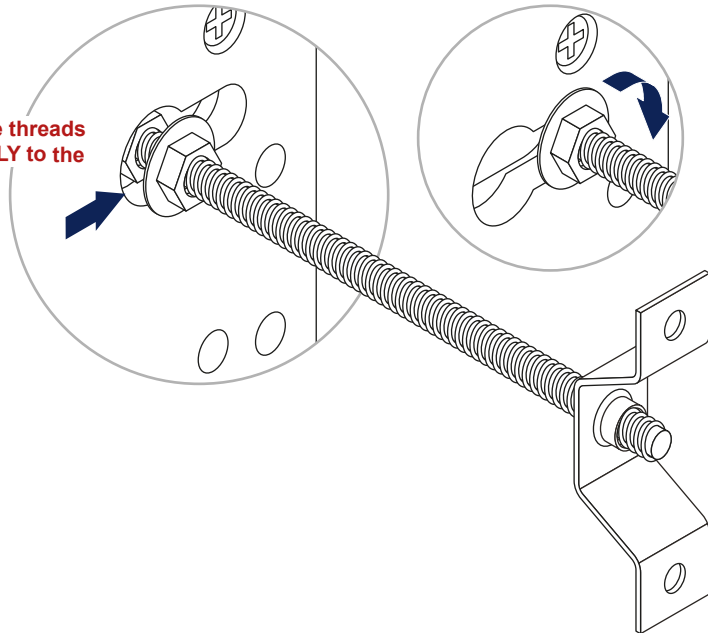

# 12 Subframe Connection

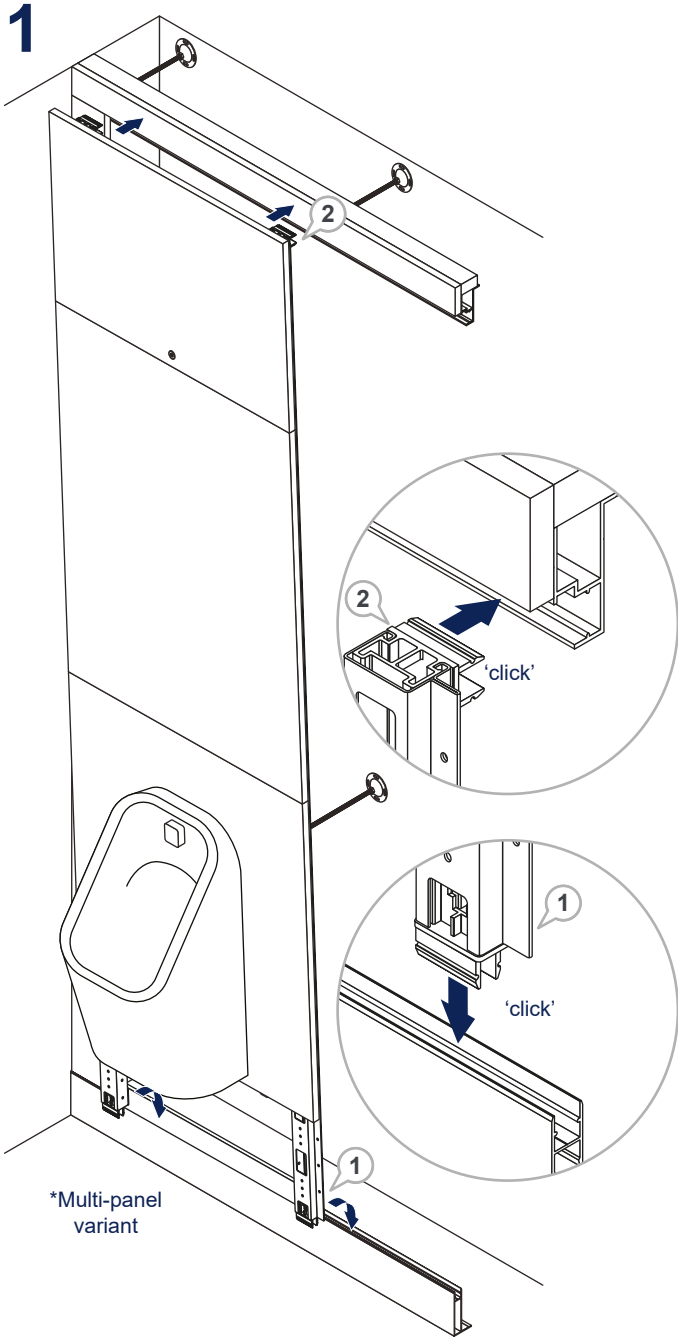

**\*For Multi-Panel units:**

**1a** Fix bottom subframe assembly to baserail and **HOLD IN PLACE**

**1b** Slot upper subframe into lower subframe

**1c** 'click' into headrail

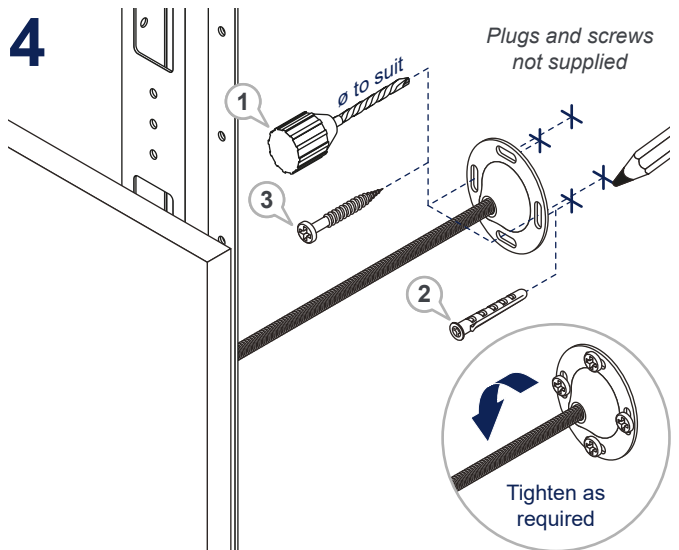
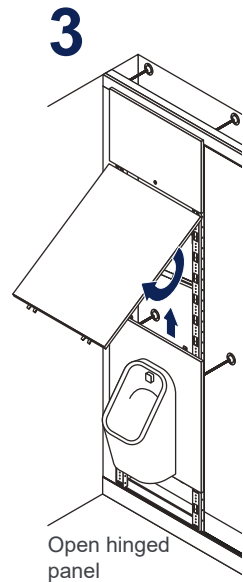
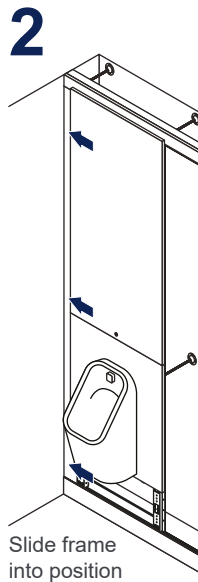
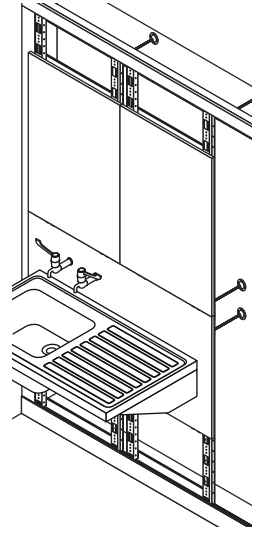
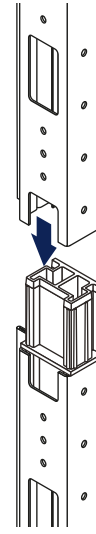
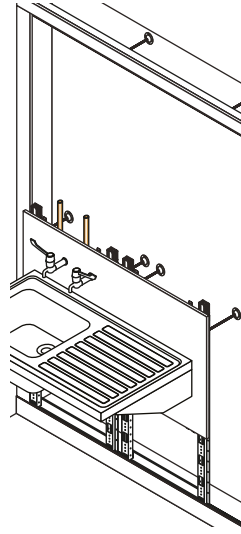

# 12 Subframe Connection (Continued) FOR WALL HUNG WCs ONLY

1

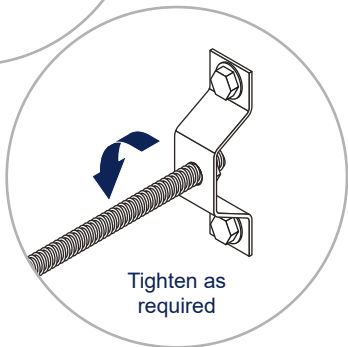
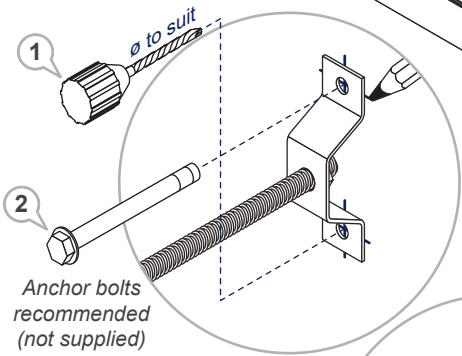
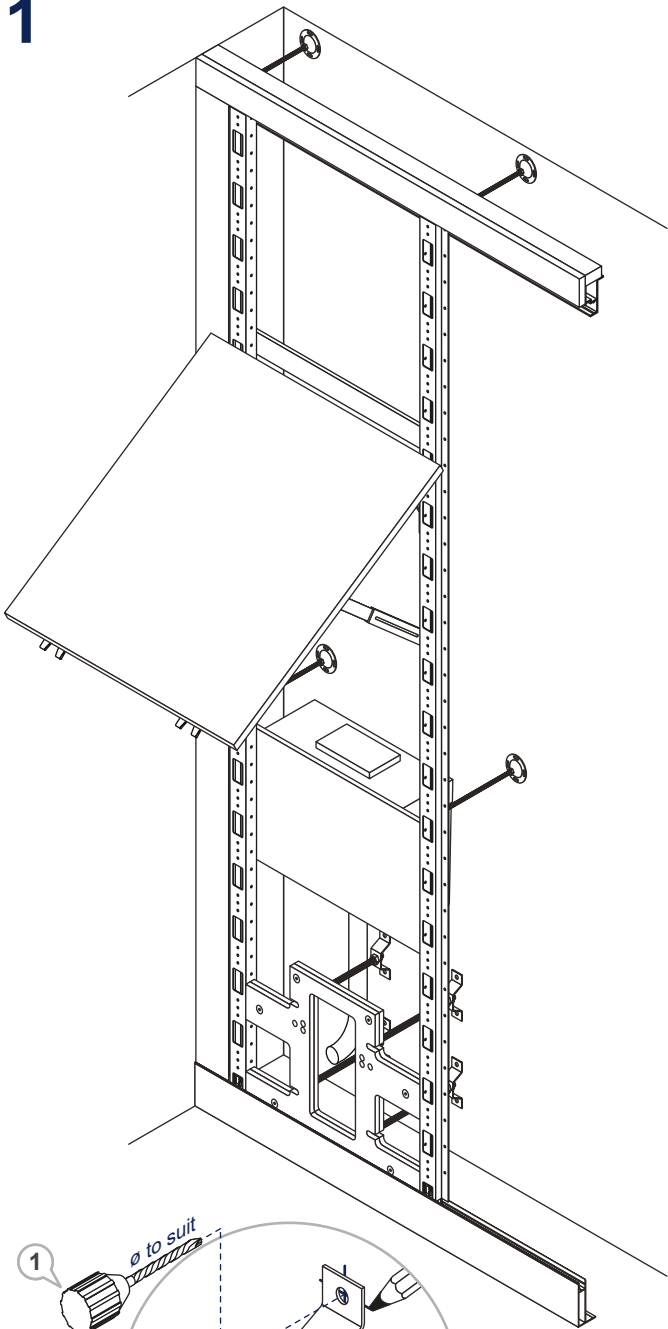

2

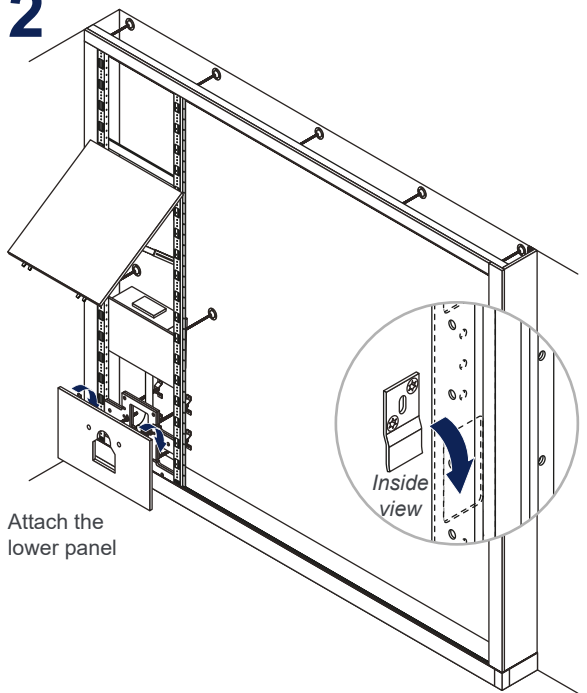

Attach the lower panel

3

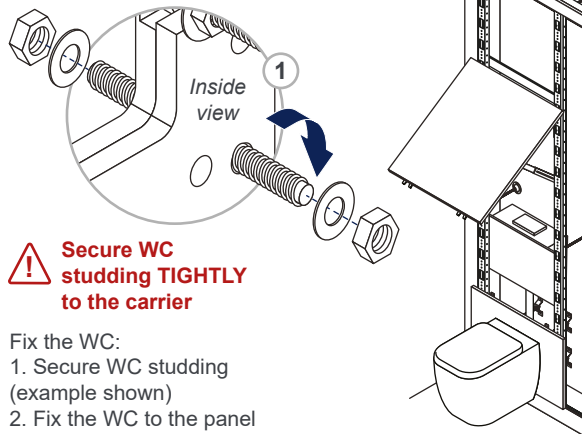

**Secure WC studding TIGHTLY to the carrier**

- Fix the WC:
1. Secure WC studding (example shown)
  2. Fix the WC to the panel

Please follow WC installation instructions

# 13 Flashgap to Subframe Fixing

1

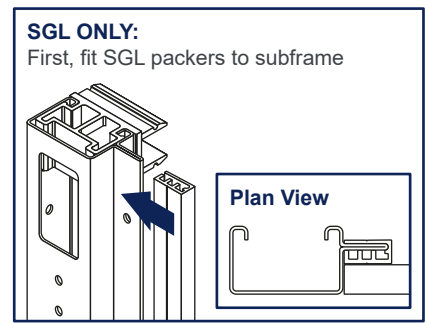
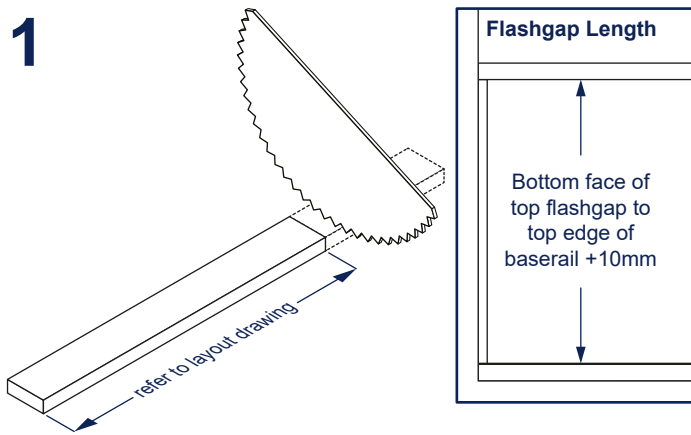

2

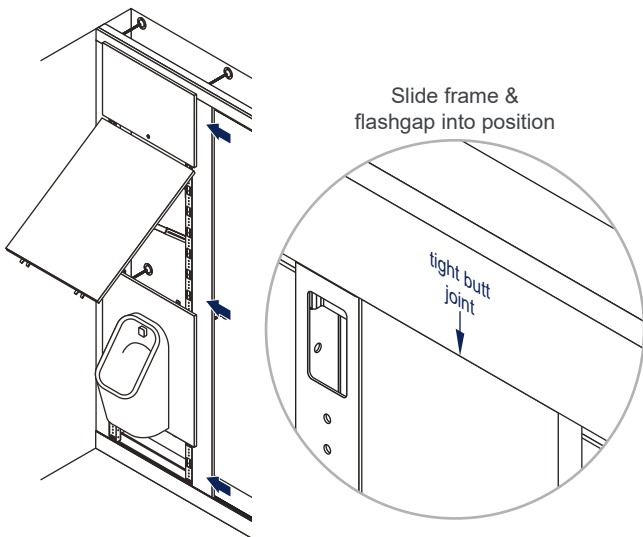

3

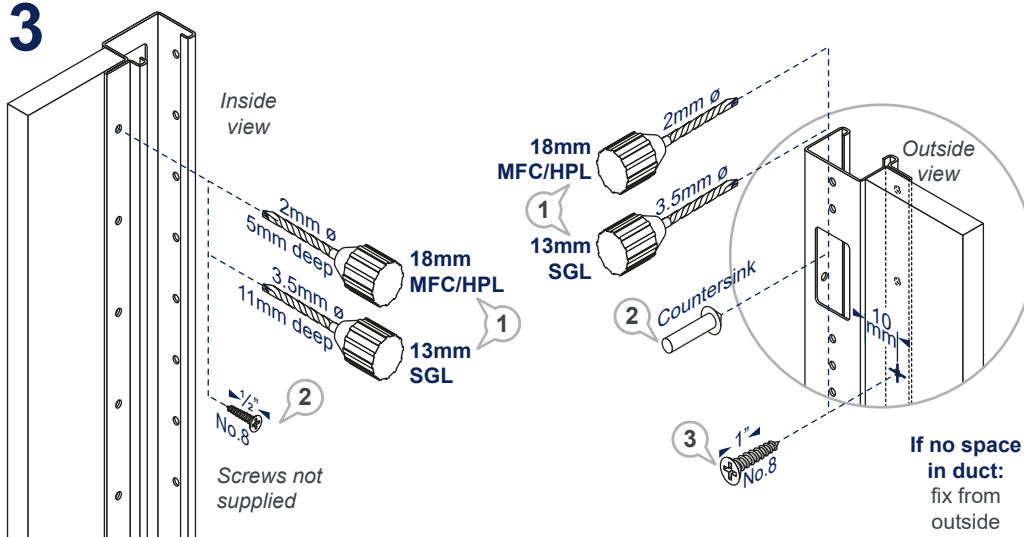

4

Repeat steps 12 and 13 until all subframes and flashgaps are fixed

# 14 Secondary Subframe Fixing

1

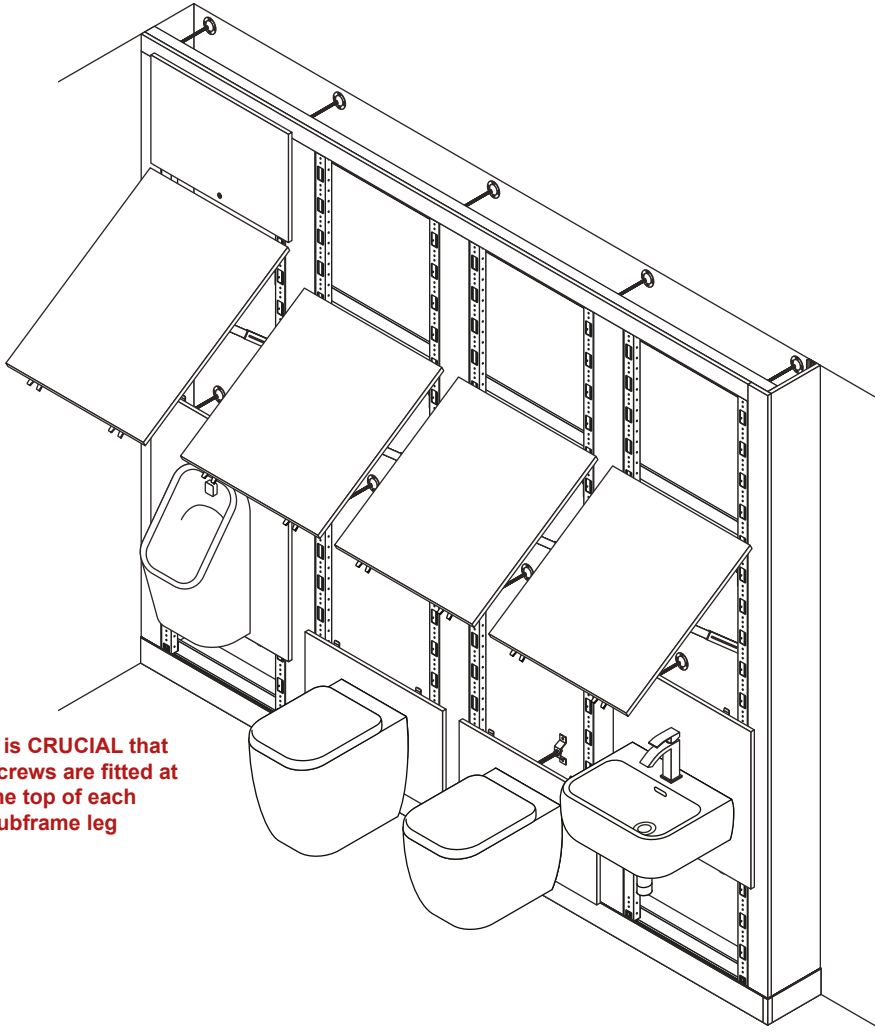

**!** It is **CRUCIAL** that screws are fitted at the top of each subframe leg

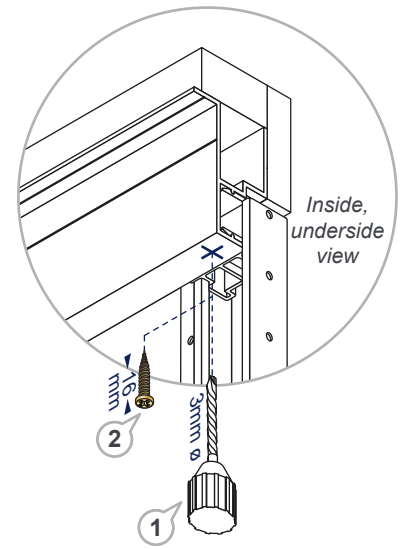

# 15 Plumbing

## 1 Ensure all IPS units are securely installed

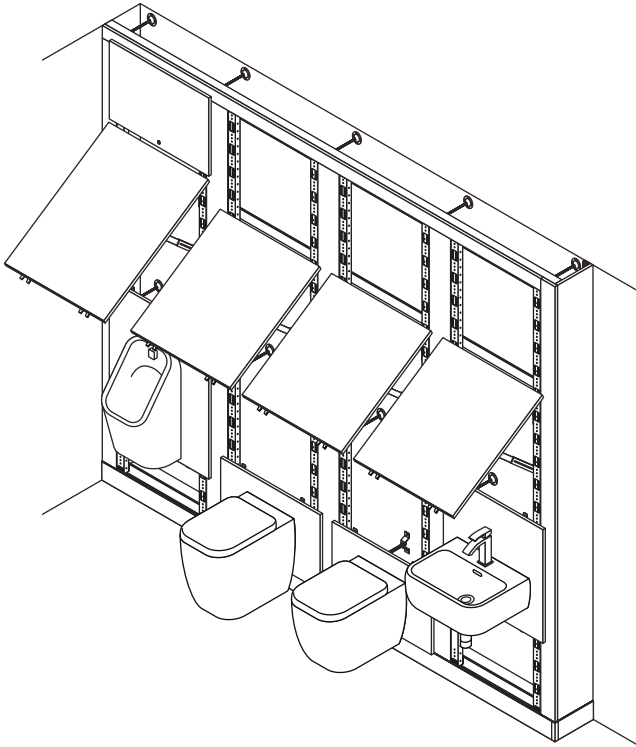

## 2 Connect copper supply pipes



⚠ Ensure olives/seals are in position

*Iso valves not supplied*

## 3 Connect waste

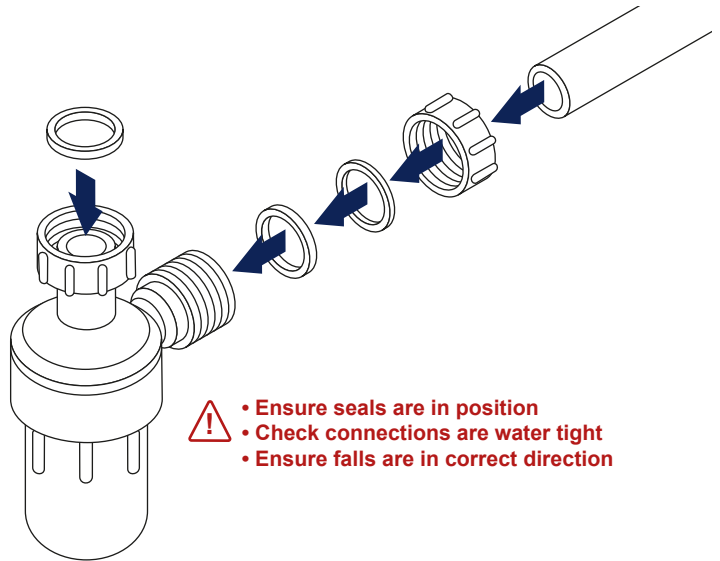

⚠ • Ensure seals are in position  
• Check connections are water tight  
• Ensure falls are in correct direction

# 16 Panel Fixing

1

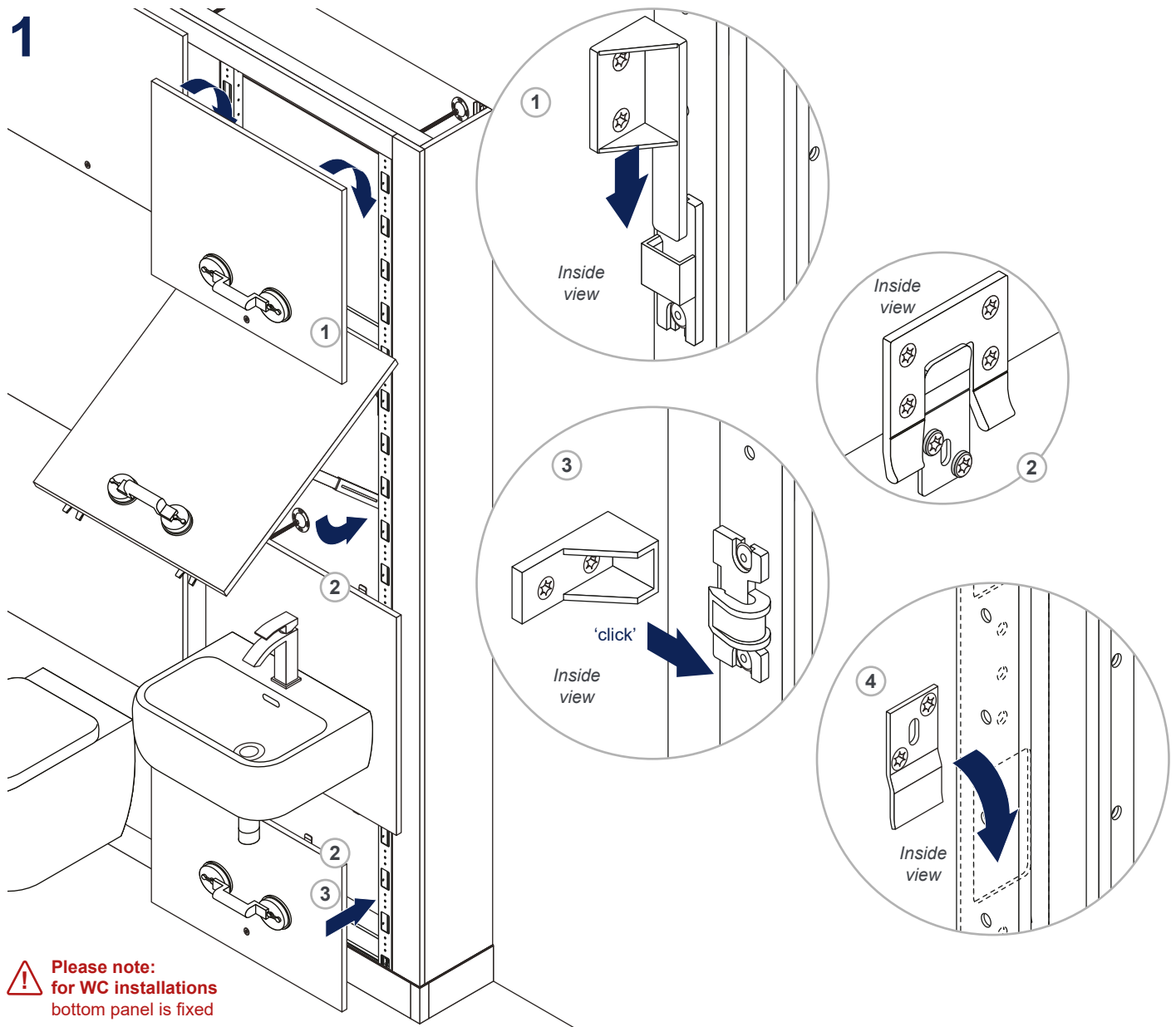

 Please note:  
for WC installations  
bottom panel is fixed

# 17 Shelf Fixing

## 1 Fix clips around shelf height unit & on shelf underside

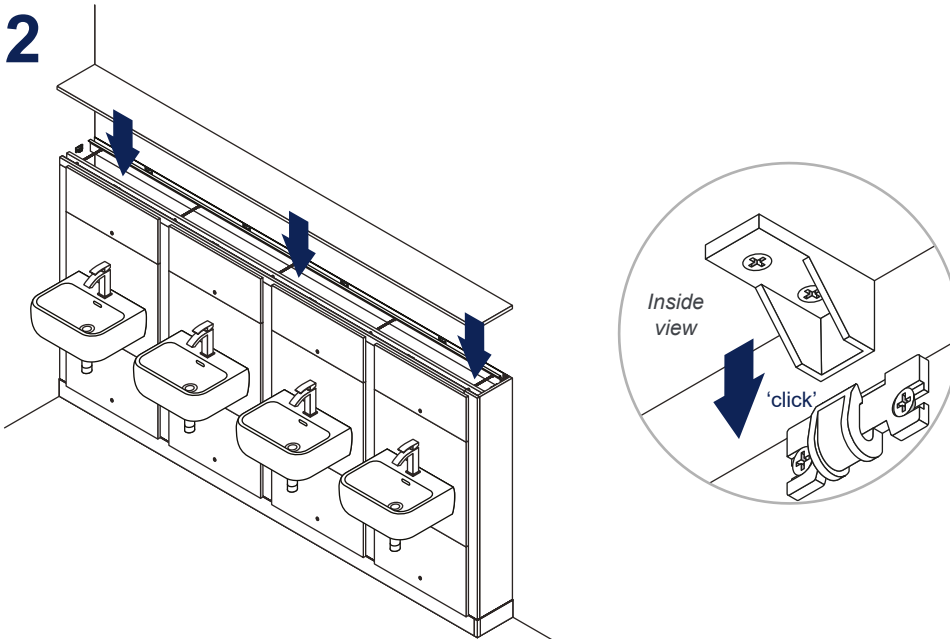
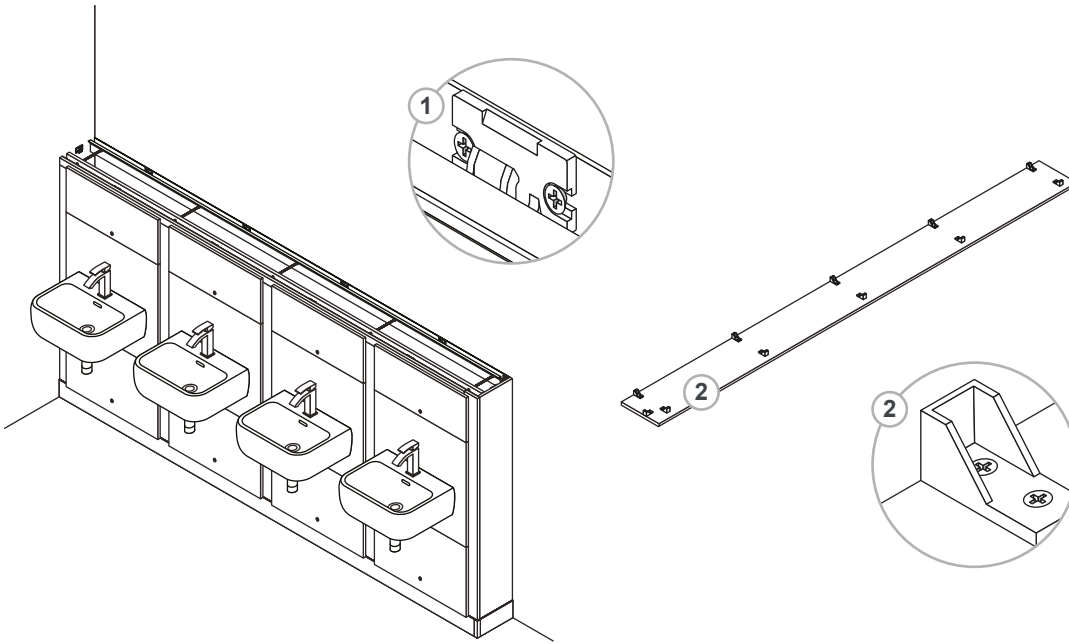

# 18 Vepps Hinged Panel Operation

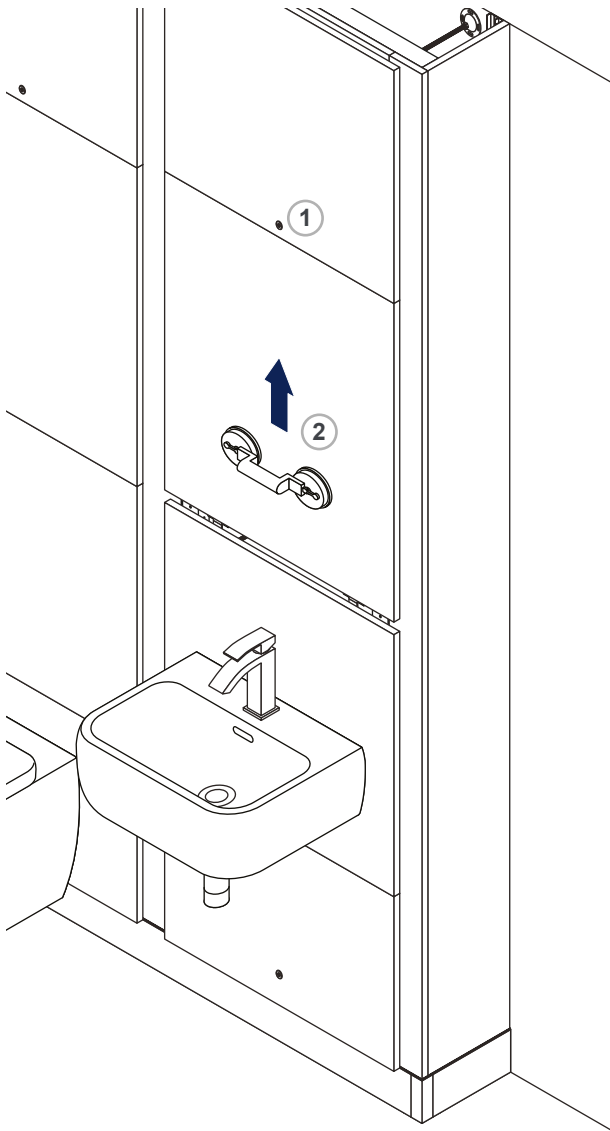

1 Unlock top panel



2 Lift hinged panel

**!** DO NOT remove top panel, the top panel is designed to lift up with the hinged panel

3 Open hinged panel

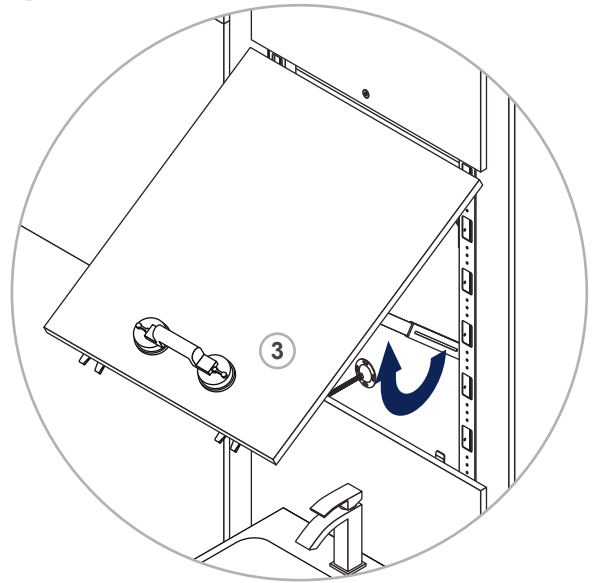

# 19 Shower Panels

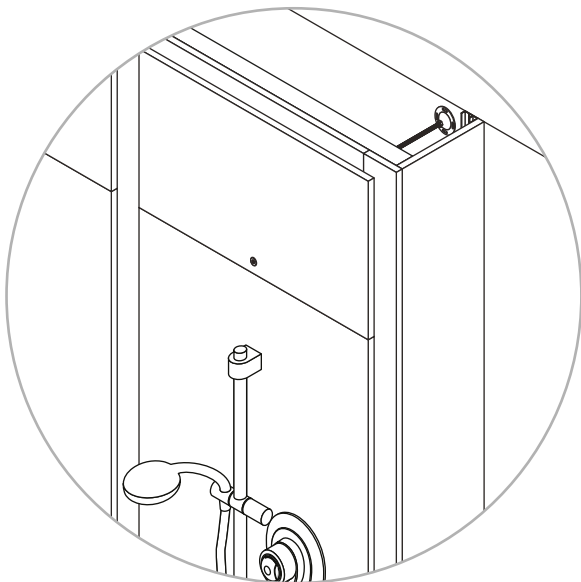

We recommend that all panels are sealed around the perimeter with a suitable sealant after installation and after every subsequent removal for maintenance.