

169MHz Telecare Devices

Smoke Detector (10 Year)



- Optical sensing technology
- 85dB @ 3m sounder & red operating light
- Long life Lithium battery
- Low battery warning
- Test button
- Complies with BS EN 14604: 2005
- Dimensions: 115mm x 45mm
- Weight: 221 grams
- Tynetec Part No. ZXT484



Where should Smoke Detectors be fitted?

Smoke detectors should be ceiling mounted near the centre of the room, at least 300mm from any light fitting and 300mm away from any wall or corner. Do not fit smoke detectors in the kitchen, bathroom or garage.

Try and avoid areas out of reach (e.g. top of the stairs) where it will be difficult to reach the TEST button.

Typical Tools Required

Be careful when using step ladders – always face the direction you are working. Always make sure the correct drill bits and screwdrivers are used. A drill and screwdriver are not required if the self adhesive pads are used.



Installation using Screw Fixings

1. Locate the best position and fix the base plate to the ceiling using the screws & plugs provided.
2. Align the detector body and base plate and twist clockwise to clip into place. This action also connects the battery.
3. The red light will blink once every 40 seconds when the detector is fitted correctly.

1. LOCATE BEST POSITION AND FIX BASE PLATE TO CEILING

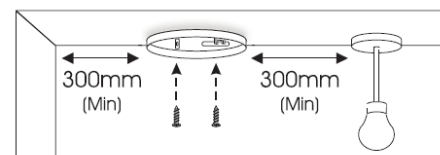

ALARM SHOULD BE CEILING MOUNTED AT LEAST 300MM FROM WALLS & OBSTRUCTIONS, IDEALLY CENTRALLY IN ROOM/AREA

Installation using Self Adhesive Pads

1. Locate the best position and fix the base plate to the ceiling using the 2 adhesive pads provided. Press firmly to ensure it is stuck securely.
2. Align the detector body and base plate and twist clockwise to clip into place. This action also connects the battery.
3. The red light will blink once every 40 seconds when the detector is fitted correctly.

2. PLACE DETECTOR AND TWIST ONTO BASE PLATE

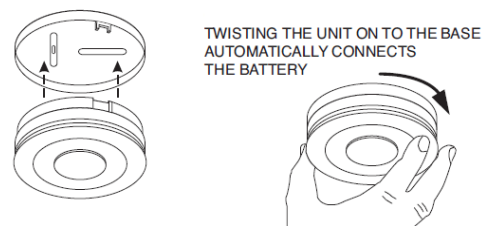

TWISTING THE UNIT ON TO THE BASE AUTOMATICALLY CONNECTS THE BATTERY

Removing the Smoke Detector

1. Use a small flat bladed screwdriver to push-up on the safety locking catch.
2. Twist the body of the detector anti-clockwise to remove from the base plate.

3. REMOVAL: PUSH CATCH AND TWIST ANTI-CLOCKWISE

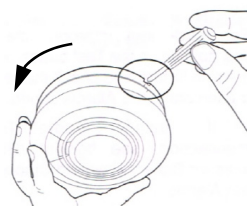

PUSH THE LOCKING CATCH AND TWIST ANTI-CLOCKWISE TO REMOVE THE DETECTOR FROM THE BASE PLATE

Testing the Smoke Detector

The **TEST** button must be pressed during installation to learn the smoke detector onto the SayPhone, Reach, Advent xt or Altec Response.

See the following page for how to put each of these products into "Learn Mode".

Press and hold the **TEST** button; the horn will sound, the **RED** light will flash and an alarm call will be transmitted.

PLEASE NOTE: the alarm call will only be transmitted ONCE and no further transmissions will occur for a **5 minute** period called the "mask time".

In normal operation this mask time prevents alarm calls re-reporting several times in succession should there be smoke in the room that keeps re-triggering the alarm.

A mask time reset button is provided if multiple test calls are required in quick succession during installation – see below.



The range of all radio devices can be affected by the working environment - always take care during installation and perform several test calls.

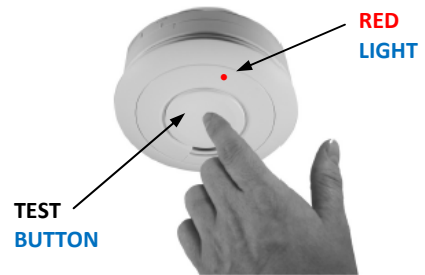

Mask Time Reset Button

To aid testing, the smoke detector has a Mask Time Reset button.

Remove the detector from its base plate, using a small flat bladed screwdriver press and hold the small button on the transmitter module for about **3 seconds** until the **RED** light comes on then release.

The **RED** light will flash several times to indicate the mask time is reset and the **TEST** button can be used again. Note: a transmission also occurs when the **RED** light is flashing.

The same button can be pressed once at any time to force an alarm transmission.

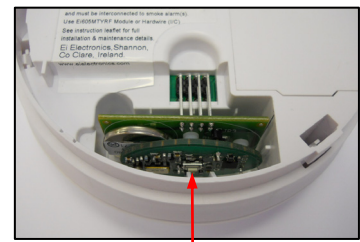

MASK TIME RESET BUTTON & RED LIGHT

Cleaning the Smoke Detector



The smoke detector may become less sensitive if air flow through its vents is restricted. Every 6 months use the nozzle attachment on a vacuum cleaner to remove dust, insects and cobwebs from the side slots.

The detector can be wiped clean with a damp cloth, never use detergents or polish etc.

Important Information when Decorating



Never paint the smoke detector itself.

During decorating the smoke detector should be removed or covered with a plastic bag to prevent contamination.

Remember, whilst covered the smoke detector cannot operate.

PUSH-UP CATCH AND TWIST ANTI-CLOCKWISE TO REMOVE DETECTOR

Smoke Detector Battery Life

If the alarm begins to chirp and flash the red light every 40 seconds the smoke detector battery power is running low.

Push-up the catch with a small screwdriver and twist the detector anti-clockwise to remove from its base plate and isolate the battery.

The complete detector must be replaced when the battery is exhausted.

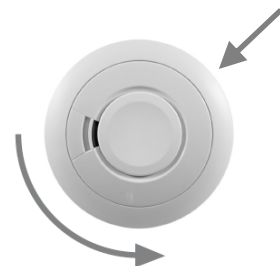

Tynetec Transmitter Battery Life

The Tynetec transmitter battery is checked once a day, if the voltage falls and stays below a preset level for 7 consecutive days a low battery call is automatically sent to the Control Centre or Local Manager.

Detailed information on battery management for all Tynetec products is available in a separate document.

Contact Tynetec's customer support dept and request a copy of Doc No. FM0630.

Learning the Smoke Detector onto a SayPhone V2...



1. Turn the SayPhone V2 off, re-apply power and the front light will flash **RED/AMBER/GREEN**.
2. When the light is flashing press the **RED ■** button once – the SayPhone V2 will announce “**Trigger Radio Device**” and the front light will go steady **AMBER**.
3. Press the **TEST** button* on the smoke detector – the SayPhone V2 will announce “**Smoke**”.
**If the TEST button has been pressed in the last 5 minutes you’ll have to reset the MASK TIME – see page 2.*
4. Press the **GREEN ■** button on the SayPhone V2 and wait for about 12 seconds until the front light goes steady **GREEN**.
5. Check with the Control Centre that it is convenient to perform a test call, press the **TEST** button on the smoke detector and confirm they receive the correct call type.
6. See the SayPhone V2 installation & programming guide (Tynetec Doc No. FM0546) for more information.

Learning the Smoke Detector onto a SayPhone 21...



1. Turn the SayPhone 21 off, re-apply power and the front light will flash **RED/AMBER/GREEN**.
2. When the light is flashing press the **GREEN ●** and **GREY ▼** buttons together, the display will show **Learn Trigger – Radio Learn**. Press the **RED ●** button to confirm.
3. Press the **TEST** button* on the smoke detector – the SayPhone 21 will announce “**Smoke**” and the display will prompt you for a **Device Location**.
**If the TEST button has been pressed in the last 5 minutes you’ll have to reset the MASK TIME – see page 2.*
4. Use the **GREY ▲▼** buttons to select the appropriate 2 digit device location code (listed in the SayPhone 21 installation manual) then press the **RED ●** button to confirm.
5. The display will change to show **Trigger Message** – press the **RED ●** button several times to exit this mode.
6. Press the **GREEN ●** button on the SayPhone 21 and wait for about 12 seconds until the front light goes steady **GREEN**.
7. Check with the Control Centre that it is convenient to perform a test call, press the **TEST** button on the smoke detector and confirm they receive the correct call type.
8. See the SayPhone 21 installation & programming guide (Tynetec Doc No. FM0450) for more information.

Learning the Smoke Detector onto a Reach or Reach Plus...



1. Press and hold the **GREEN ○** button until the Reach announces “**Trigger Radio Device**” and the front light starts flashing **GREEN**.
2. Press the **TEST** button* on the smoke detector – the Reach will announce “**Smoke**”.
**If the TEST button has been pressed in the last 5 minutes you’ll have to reset the MASK TIME – see page 2.*
3. Press the **GREEN ○** button to exit the learn mode.
4. Check with the Control Centre that it is convenient to perform a test call, press the **TEST** button on the smoke detector and confirm they receive the correct call type.
5. See the Reach installation & programming guide (Tynetec Doc No. FM0621) or the Reach Plus installation & programming guide (Tynetec Doc No. FM0662) for more information.

Learning the Smoke Detector onto an Advent xt...



1. Press the **LINE** key on the Managers DECT telephone and wait for the “**Ready**” prompt.
2. Enter **5 0 0 0** followed by the ***** key.
3. Enter the flat number the smoke detector is being installed in followed by the ***** key.
4. Press the **TEST** button* on the smoke detector and wait for the “**Enter Location Code**” prompt.
**If the TEST button has been pressed in the last 5 minutes you’ll have to reset the MASK TIME – see page 2.*
5. Enter the appropriate 2 digit location code (listed in the Advent xt user guide) or press **#** and wait for the “**Pendant Enabled – Enter Flat**” prompt.
6. Press the **#** key to exit the mode followed by the **LINE** key to clear the connection.
7. Press the **TEST** button on the smoke detector and check the correct call type is reported.
8. See the Advent xt user guide (Tynetec Doc No. FM0420) for more detailed information.

Learning the Smoke Detector onto an Altec Response...



1. From the main menu display select **→ Radio Devices ←** and press the **ENTER** key.
2. Press **ENTER** again and the display will prompt you to “**Trigger the Sensor**”.
3. Press the **TEST** button* on the smoke detector – the display will show the device type and its 8 digit ID No.
**If the TEST button has been pressed in the last 5 minutes you’ll have to reset the MASK TIME – see page 2.*
4. Press the **▼** key to select **→ Accept ←** then press **ENTER**.
5. The display will show **← Flat →**, use the **◀ ▶** keys to choose the dwelling type from the list.
6. Press the **▼** key to select **→ No: 000000 ←** then press the **ENTER** key. Use the **▲ ▼** keys to select each digit of the flat number and the **◀ ▶** keys to move between digits then press the **ENTER** key.
7. Press the **▼** key and the display will show **← No Location →**, use the **◀ ▶** keys to choose the device location from the list.
8. Press the **▼** key several times to select **→ Exit ←** then press the **ENTER** key.
9. Press the **TEST** button on the smoke detector and check the correct call type is reported.
10. See the Altec Response user guide (Tynetec Doc No. FM0548) for more detailed information.

Tynetec operates a policy of continuous improvement and reserves the right to change product specifications without notice.
If any variation to the details contained in this document are suspected please contact Tynetec’s customer support dept on 01670 352371.