



TIMÓLEON INSTALLATION GUIDE TI5012

Pressure Testing Guide

PRESSURE TESTING FOR UNDERFLOOR HEATING PIPE

Timoleon supplies compression fittings for its 16mm and 12mm pipe. This is also the same type of connection used at the manifold.

The fittings use either a straight, elbow or tee body.

To these bodies a pre-assembled fittings unit for either 16mm or 12mm pipe are added to make up the fitting.

The fitting units can be added to the pipe first and then presented to the fitting body.

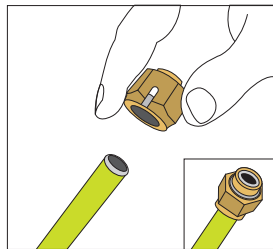

The pipe should be inserted fully within the fitting unit before tightening the connection.

The fitting should be done up hand tight with a further half to full turn (until resistance is felt) to complete the joint using the supplied spanner (attached to the manifold).

A pressure test must be conducted once all the fittings on the circuit have been installed

GENERAL GUIDANCE

All underfloor heating circuits, with or without fittings, must be pressure tested in the following way:

Pressure test using water to 6 bar, wait 5 minutes for stabilisation, top up if necessary and then at keep the circuit at 6 bar for over 60 minutes. Joint security can be checked visually and by tugging at the joints.

The pressure test should be witnessed and recorded as passed on the supplied pressure test sheet.

Complete installations including appliances should be tested with water to the maximum test pressure allowed by manufacturers of the appliances and fittings.

Timoleon does not recommend air testing of its systems.

Special precautions are necessary if the pressure testing is to take place in sub-zero temperatures. It is advisable to drain the under floor central heating system once testing and screeding has been completed.