

Step 1

The ThermoRoof panels should be installed with the tongue facing away from you. Starting with the first panel, remove the tongue from the edge and align the panel so the edge of the panel is flush with the outside of the gable (1) wall.

Step 2

Use an adhesive foam to glue the underside of the panel to the top of the gable to prevent slippage during the fitting/tamping of further panels.

Step 3

Screw fix (dia. 8 x 275mm) through each "C" section (on the "V" line) at each support point allowing for 50mm embedment of the screw into the support beams.

(Figure 1 &2)

Step 4

Once fixed, apply a bead of an adhesive foam along the full length of the inner, vertical face of the female groove and insert the tongue of the next roofing panel, tamp into position, align and screw fix as before and continue in this fashion until you reach the far gable (2) at the opposite end.

(Figure 1)

This is a short overview of the roof construction. For further information, details and diagrams please consult the Thermohouse Technical Manual.



Step 5

Cut the panel in width, along its length to ensure a flush finish with the outside line of the gable (2).

Step 6

Start on the opposite side of the roof from gable (2) and continue in the same fashion finishing at gable (1).

Step 7

Screw fix the primary battens (running from wall plate to ridge) to the top of each “C” section.

(Figure 2)

Step 8

Fix on a breathable membrane layer, followed by counter battens centred to suit the chosen roof finish.

(Figure 2)

This is a short overview of the roof construction. For further information, details and diagrams please consult the Thermohouse Technical Manual.



Figures 1-3

Fixing Screw
CTP 6 x 280 (See Table A-THR-018)
Min. Embedment = 50mm

To achieve an airtight seal between the panels
After fixing a panel into position, a "low expansion"
- "adhesive" foam should be applied into the groove
(as indicated), before fitting next panel. Allow no more
than 2 - 3 mins for foam to settle before joining panels

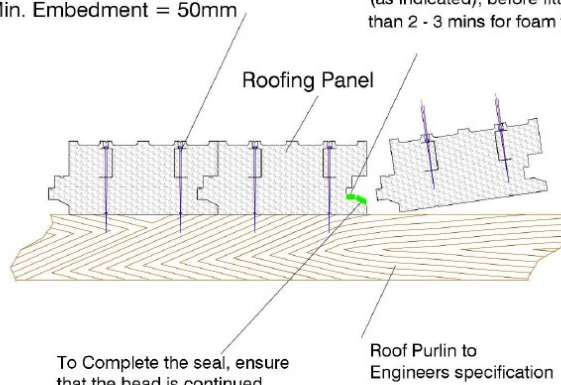

To Complete the seal, ensure
that the bead is continued
down to the edge of the groove
at both ends of each panel as
indicated.

1

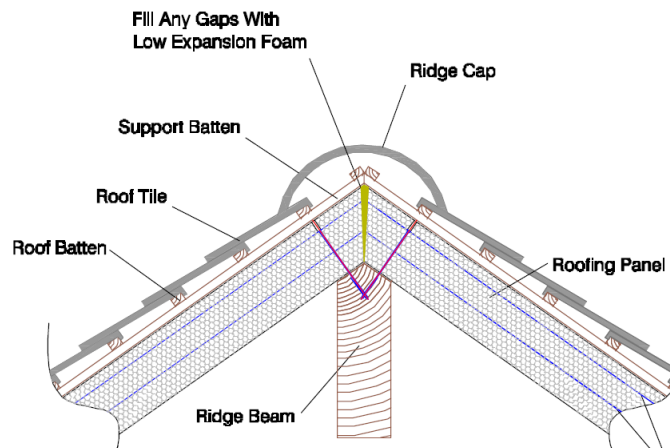

2

This is a short overview of the roof construction. For further information, details and diagrams please consult the Thermohouse Technical Manual.



Figures 1-3

Thermohouse ICF– Roof Eaves Detail – Standard

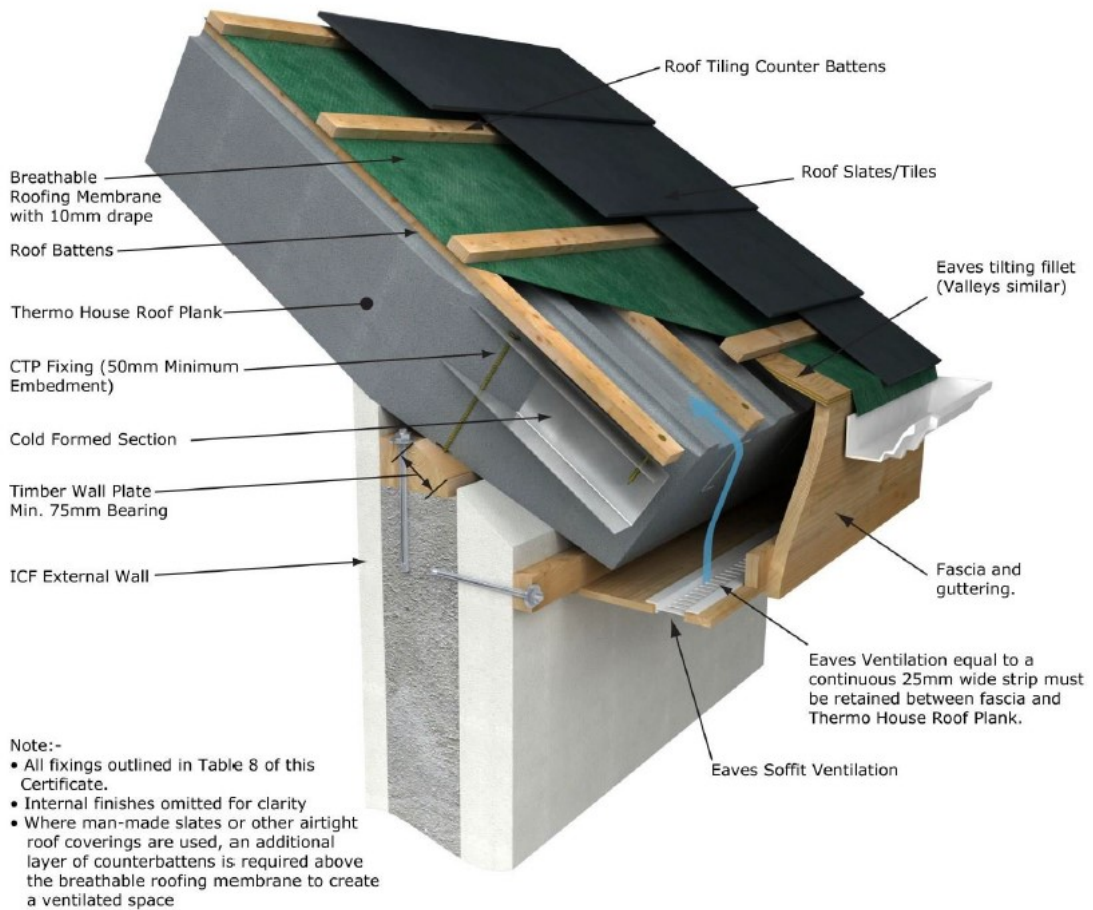

3

This is a short overview of the roof construction. For further information, details and diagrams please consult the Thermohouse Technical Manual.

