

A Professional's Guide

Trusted to deliver high performing, elegant rooflights.

Spring / Summer 2022



Pitched Rooflights

- The Conservation Rooflight
- The Studio Conservation Rooflight
- neo®
- The Studio neo® Rooflight
- Bespoke Design Service

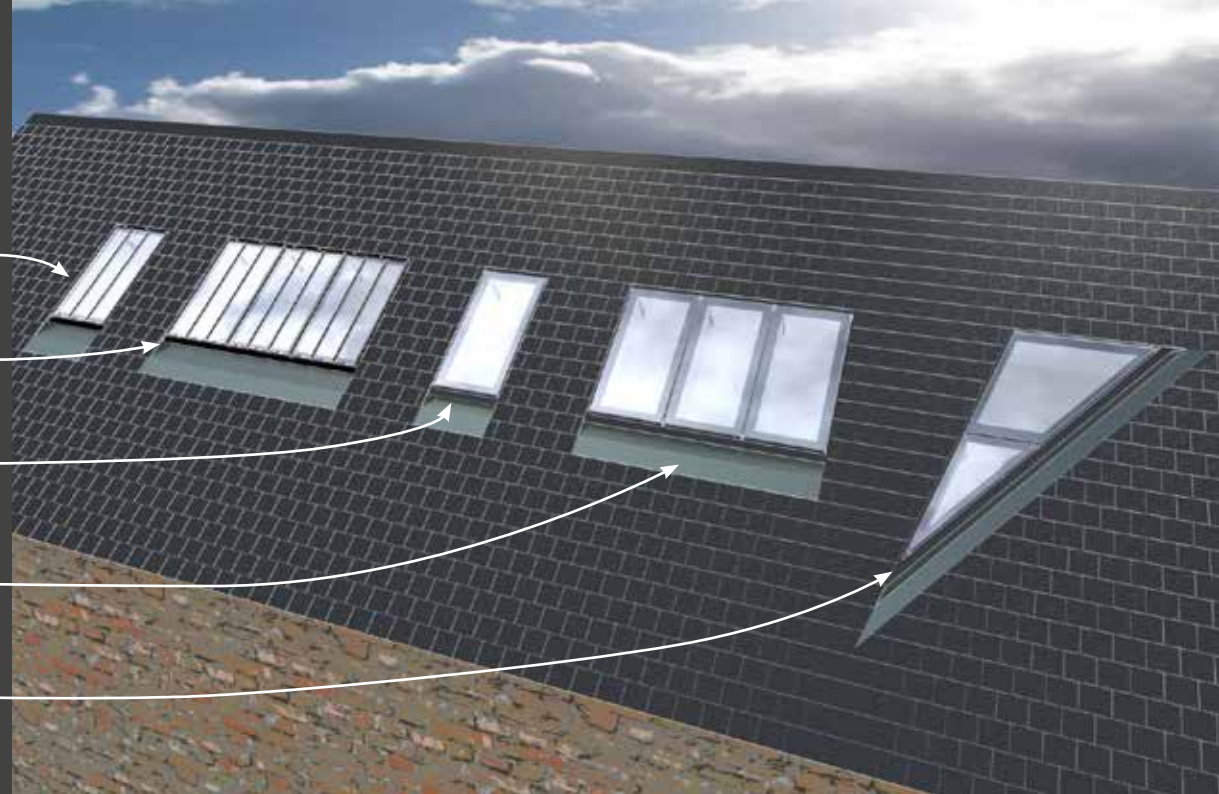

Flat Rooflights

- The Lantern Rooflight
- The Pyramid Rooflight
- Bespoke Design Service
- The Conservation Plateau Rooflight
- neo Advance®
- neo Advance Skywalk®



Contents

- 3 / **How to use this brochure**
- 4 / **About the Rooflight Company**
- 6 / **The Conservation Rooflight**
- 10 / **The Conservation Plateau Rooflight**
- 14 / **neo® Rooflight**
- 18 / **neo Advance® Flat Rooflight**
- 22 / **neo Advance Skywalk® Rooflight**
- 25 / **Bespoke Rooflights**
- 29 / **The Studio Range**
- 33 / **The Conservation Lantern Rooflight**
- 35 / **The Conservation Pyramid Rooflight**
- 39 / **Secured by Design Rooflight**
- 44 / **The Added Security Rooflight**
- 45 / **Ironmongery**
- 46 / **Blinds**

How to use this guide

This brochure is designed to inspire you to want to work with us. We have provided you with some basic information to help you decide which rooflight or roof window products might be able to enhance your project.

Within each rooflight section you will notice some or all of the below icons:



Access the specification for the rooflight on the NBS Plus website

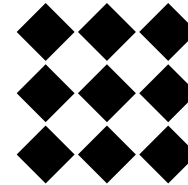

A variety of case studies available on our website



Technical drawings and installation materials available on our website



BIM Objects in Revit format can be downloaded from our website

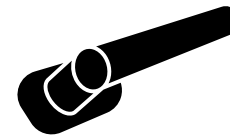

Find out more about opening options on our website

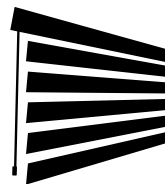

Find out more about our selection of blinds online



This rooflight range is available to buy from our online Shop

Our Heritage

The Rooflight Company was founded by architect Peter King, RIAS, in 1993. At the time Peter was practising in London's Hampstead Garden Suburb and finding a roof window for loft conversions that met the needs of Planning Officers proved an impossible task.

Peter set about designing a copy of the Victorian cast iron skylights that would meet modern building standards as well as appease the Planning Officers. The original Conservation Rooflight was developed and the Rooflight Company was born.

Peter developed a range of sizes from original Victorian patterns. The Conservation Rooflight was made from steel and incorporated a glazing bar, thermal linings, draught strips and glazing clips.

Since then, the Rooflight Company have expanded their rooflight offering to include a contemporary roof window, neo® and the energy efficient and easy to install neo Advance® flat rooflight.

The Rooflight Company are an established, trusted, family-run British company employing over 70 people. We are committed to designing, producing and providing the best products and services to our customers. We are proud to have our rooflights specified and installed on award-winning landmark buildings and cherished properties.

Our Customers

We provide products and services that architects, builders and home owners value. They value them because they display strong design, manufacturing excellence and the highest levels of service. Our commitment to sustainability and energy efficiency provides the foundation from which we have developed our range of rooflights. Catering for pitched or flat roofs for heritage or contemporary properties, we are your trusted advisor when it comes to adding or replacing rooflights in cherished buildings.

Our People

Purchasing rooflights through our brand is an assurance of quality, not only of our products but also in our service.

Our quality of service and product is reliant on our people. As such we have defined four key areas that ensure our customers experience this quality, through the performance of our people:



Our people display honesty and professionalism at all times, meaning our customers can trust us and our brand.



Our people have pride in their work and support each other, so our customers receive seamless service, and manufacturing with attention to detail.



Our people respect each other and are working towards the same goals, resulting in efficient guidance and clear answers for customers.



Our people feel involved in the company and that their achievements directly impact the business. As such, every team member strives for success and this effort is evident in our products.



The above unique approach to business led to us winning the West Oxfordshire Employer of the Year Award at the 2020 West Oxfordshire Business Awards.

The Benefit of Experience

Over 20 years' knowledge, testing and design skill goes into every rooflight that we design and manufacture. Built in our West Oxfordshire workshop by our highly skilled team of craftsmen, every step of the build process is closely monitored to ensure our high standards are met.

All of our ranges benefit from the following:

- All frames can be colour-matched to any RAL or BS paint colour
- A patented Thermoliner® technology made from UPVC ensures condensation control
- Moisture resistant linings which sit flush to the reveal and can be finished to blend with the internal décor
- Glazing options that include self-cleaning, privacy and solar-control
- Designed and assembled in the UK
- Built to ISO9001 in our UK Factory
- A bespoke design service to tailor each range to any shape, colour or size
- All our pitched roof windows are UKCA/UKNI marked as per UK legislative requirements. Effective 1 January 2021, this replaces CE marking which is no longer recognised by EU members for UK manufactured products. Please note this is of critical importance for customers planning to export our products to EU27 countries, who are responsible for ensuring compliance with relevant local export rules. This does not apply to our flat roof windows.

If you would like to see the build process for yourself, we are happy to accommodate factory tours. Speak to one of our Commercial Team on 01993 833155 to arrange a convenient date.



The Conservation Rooflight



Why specify the Conservation Rooflight?

The Conservation Rooflight has been continually specified by architects for over 25 years. Architects specify this range because:

- It meets modern building standards including Conservation, English Heritage and the National Trust
- Our founder, and architect, Peter King designed it. The Conservation Rooflight is the original and still the most authentic design available
- With 15 standard sizes and a made to measure service, we will always have a size to fit your project. This means you can preserve the integrity of any historic building and avoid cutting existing rafters. You can also create practically unlimited arrays
- The linings on the inside go right up to the glass, giving a clean internal finish

For more technical information visit www.therooflightcompany.co.uk/all-products/conservation/
or call 01993 833155

Suitable for pitched roofs between 17.5° and 65°



The Conservation Rooflight

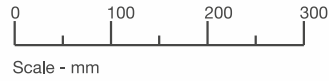

Maximum installed height from top of soaker extrusion to top of structural support is 75mm for ALL tile types.

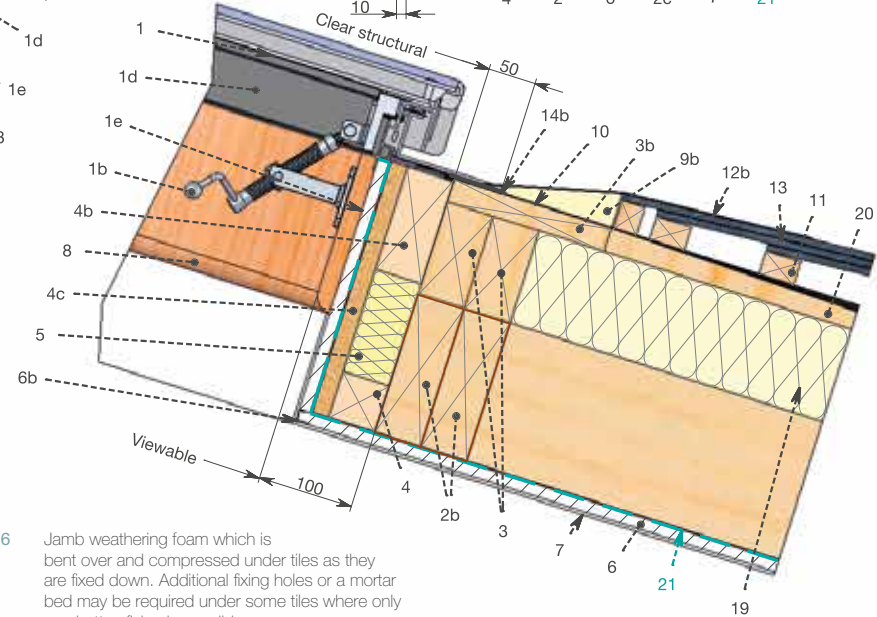
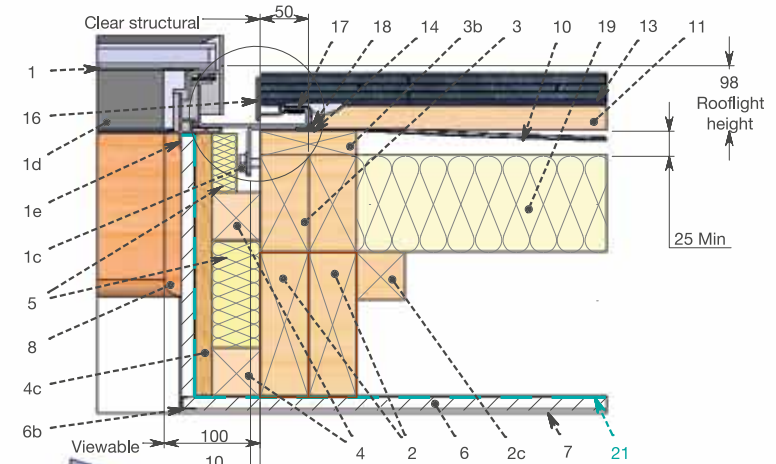
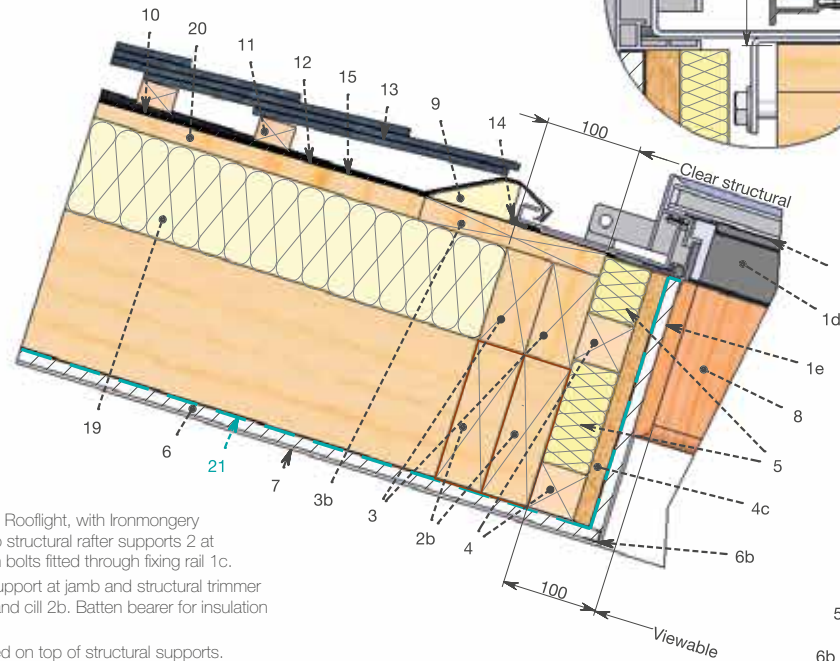
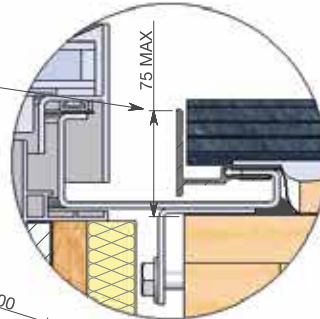

Key:

- 1 The Conservation Rooflight, with Ironmongery Option 1b fixed to structural rafter supports 2 at jamb using coach bolts fitted through fixing rail 1c.
- 2 Structural rafter support at jamb and structural trimmer support at head and cill 2b. Batten bearer for insulation 2c.
- 3&3b Timber bearer fixed on top of structural supports. Adjust height to create a flush installation with the roof tiles.
- 4 Fix timber packers to structural support 2&2b at the top and the base of the roof build up. The cill timber packer 4b at the top of the roof build up should be larger to provide a secure fixing point for the ironmongery. Fix 18mm ply packer to the timber packers.
- 5 Insulation fitted between timber packers 4.
- 6 Plasterboard lining with plasterboard stop 6b to project the corner. Plasterboard fitted behind the thermoliner 1e.
- 7 Plaster skim
- 8 Timber reveal to align with rooflight linings 1d to provide 'frameless' internal appearance. Rooflight linings 1d MUST BE PAINTED with a timber finishing paint once the rooflight is installed to ensure longevity of this component. If the linings 1d have been factory painted, they do not require an additional paint finish. Please refer to label attached to Roof Window frame.
- 9 Head hardwood tilting fillet.
- 9b Cill hardwood tilting fillet - to provide minimum 5 degree fall for shedding rain water.

- 10 Line of breathable membrane. Roof membrane must be allowed to 'sag' between rafters.
- 11 Softwood battens.
- 12 Code 3 (consider using code 4 and clipping down roof tiles in severer exposures) lead flashing at head. Carry flashing up the roof and lap UNDER general roofing membrane 10 and UNDER head membrane 15.
- 12b Code 4 (consider clipping flashing and roof tiles down in severer exposures) lead flashing at cill over tilting fillet 9b. Make the flashing long enough to give triple lap to the tiles below.
- 13 Roofing tiles.
- 14 Perimeter silicone seal. Seal perimeter of rooflight 1 JUST PRIOR TO installation of the rooflight using a thick continuous bead of low modulus neutral cure silicone sealant. Ensure sealant to cill 14b is located in a position where it will be covered by the cill flange of the rooflight.
- 15 Roofing membrane to rooflight head. Dress UNDER general roofing membrane.

- 16 Jamb weathering foam which is bent over and compressed under tiles as they are fixed down. Additional fixing holes or a mortar bed may be required under some tiles where only one batten fixing is possible.
- 17 Jamb weathering foam which is bent over and compressed under tiles as they are fixed down. Additional fixing holes or a mortar bed may be required under some tiles where only one batten fixing is possible.
- 18 Jamb flashing aprons, part of the jamb flashing assembly (supplied as part of the Flashing Kit). They pass UNDER the battens but OVER the general roofing membrane. The battens are tacked in position at the rooflight jambs only until the Flashing Kit is installed and the jamb aprons are slid under them. Then they are fixed home.

- 19 Insulation fitted on top of structural supports.
- 20 Counter batten.
- 21 Vapour barrier (Blue)

Please Note: These sectional details are provided as an installation suggestion. Due to the differing nature of installations we strongly advise you to consult your rooflight installer to verify fitness for purpose. This drawing does not constitute a structural proposal. Sufficiency of structural supports to be checked by rooflight purchaser's structural consultant.

The Conservation Rooflight Sizes



Pitch Guide

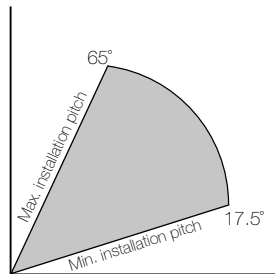

www.therooflightcompany.co.uk/all-products/conservation/



<p>Structural dimensions (W) 412mm x (L) 520mm</p> <p>Viewable dimensions (W) 212mm x (L) 320mm CR06-1</p>	<p>Structural dimensions (W) 463mm x (L) 622mm</p> <p>Viewable dimensions (W) 263mm x (L) 422mm CR07-2</p>	<p>Structural dimensions (W) 565mm x (L) 725mm</p> <p>Viewable dimensions (W) 365mm x (L) 525mm CR01-2</p>	<p>Structural dimensions (W) 565mm x (L) 1028mm</p> <p>Viewable dimensions (W) 365mm x (L) 828mm CR03-2</p>
<p>Structural dimensions (W) 615mm x (L) 875mm</p> <p>Viewable dimensions (W) 415mm x (L) 675mm CR08-2</p>	<p>Structural dimensions (W) 717mm x (L) 1028mm</p> <p>Viewable dimensions (W) 517mm x (L) 828mm CR09-2</p>	<p>Structural dimensions (W) 717mm x (L) 1180mm</p> <p>Viewable dimensions (W) 517mm x (L) 980mm CR10-2</p>	<p>Structural dimensions (W) 717mm x (L) 1333mm</p> <p>Viewable dimensions (W) 517mm x (L) 1133mm CR14-2</p>
<p>Structural dimensions (W) 717mm x (L) 1635mm</p> <p>Viewable dimensions (W) 517mm x (L) 1435mm CR15-2</p>	<p>Structural dimensions (W) 1021mm x (L) 725mm</p> <p>Viewable dimensions (W) 821mm x (L) 525mm CR01-3</p>	<p>Structural dimensions (W) 869mm x (L) 1028mm</p> <p>Viewable dimensions (W) 669mm x (L) 828mm CR11-3</p>	<p>Structural dimensions (W) 1021mm x (L) 1180mm</p> <p>Viewable dimensions (W) 821mm x (L) 980mm CR13-3</p>
<p>Structural dimensions (W) 1021mm x (L) 1333mm</p> <p>Viewable dimensions (W) 821mm x (L) 1133mm CR14-3</p>	<p>Structural dimensions (W) 1021mm x (L) 1635mm</p> <p>Viewable dimensions (W) 821mm x (L) 1435mm CR15-3</p>	<p>Structural dimensions (W) 888mm x (L) 1114mm</p> <p>Viewable dimensions (W) 537mm x (L) 848mm E1LG</p>	<p>Structural dimensions (W) 888mm x (L) 1114mm</p> <p>Viewable dimensions (W) 537mm x (L) 848mm E1RG</p>

Please see sections opposite for viewable and structural dimensions.



Egress Conservation Rooflights®

The Conservation Plateau Rooflight



Why specify the Conservation Plateau Rooflight?

- It is the only Heritage flat rooflight available due to the authentic skirt design. It is regularly specified by the National Trust, English Heritage and featured on Landmark buildings such as Somerset House
- With over 20 years' experience, the Conservation Plateau Rooflight is tried and tested meaning there is nothing to worry about once it's installed
- We are the only rooflight company with a unique Thermoliner® detail which manages condensation and mould
- Features our unique Thermoliner detail to minimise the risk of condensation and mould

For more technical information visit
www.therooflightcompany.co.uk/all-products/crplateau
or call 01993 833155

Suitable for pitched roofs between 3° and 20°



The Conservation Plateau Rooflight

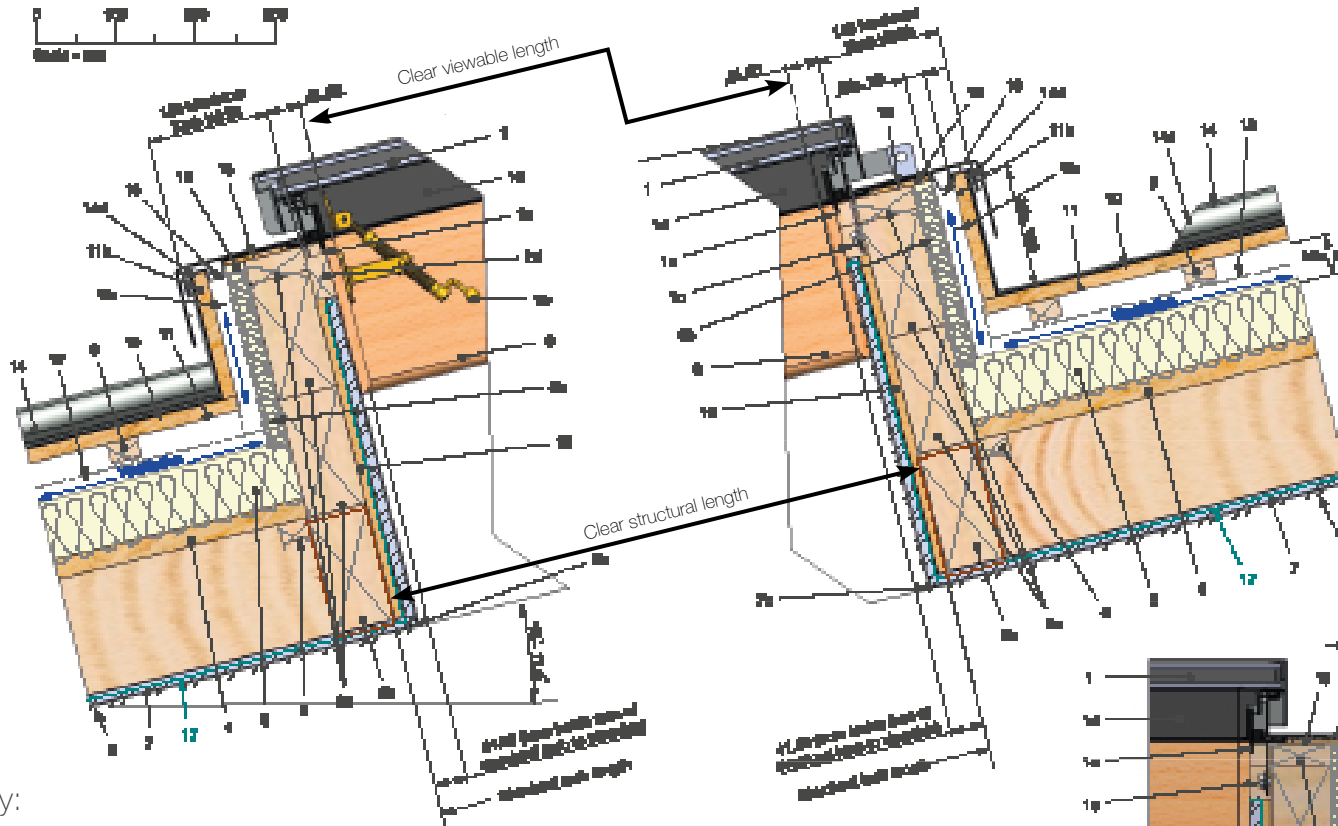

Please Note: These sectional details are provided as an installation suggestion. Due to the differing nature of installations we strongly advise you to consult 'Rolled Lead Sheet - The Complete Manual' published by The Lead Sheet Association (www.leadsheet.co.uk) and your roof window installer to verify fitness for purpose. This drawing does not constitute a structural proposal. Sufficiency of structural supports to be checked by roof window purchaser's structural consultant.

Key:

- 1 The Plateau Rooflight, with Manual Opening Option 1b fixed to structural kerb 2c using coach bolts fixed through fixing lugs 1c around the perimeter of the roof window.
- 2 Structural rafter support at jamb and structural trimmer support at head and cill 2b. Structural kerb upstand 2c to be a minimum of 150mm high. Ironmongery supportive packer 2d at the cill, fitted around the fixing lugs.
- 3 Batten Bearer to provide support for the roof deck.
- 4 WBP Plywood roof deck.
- 5 Insulation fitted above structural supports and around the perimeter of the kerb upstand 5b.
- 6 Timber reveal to align with the roof window linings 1d to provide 'frameless' internal appearance. If the roof window linings are not already factory painted, 1d MUST BE PAINTED with a timber finishing paint once the roof window is installed to ensure longevity of this component.
- 7 Plasterboard lining with plasterboard stop 7b to protect the corner. Plasterboard fitted behind the themoliner of the roof window 1e.
- 8 Plaster skim.
- 9 Softwood roofing battens. Battens 9b clad the perimeter of the kerb upstand, with sufficient breaks along the lengths to provide ventilation for the roof cavity. (hidden for clarity)
- 10 Underlay.
- 11 Structural boards installed above insulation and around the perimeter of the kerb upstand 11b.
- 12 Softwood counter batten to provide support for roofing battens. Ensure there is unobstructed ventilation through the roof structure and up the kerb upstand. (hidden for clarity)
- 13 Minimum 60mm raised section at the head of the rooflight to deflect the water away for the head of the rooflight.
- 14 Lead sheet roofing. Rolls 14b to run with the angle of Roof pitch. The rolls must be spaced 300mm apart and abut the kerb at the cill. Head rolls 14c to be splayed at least 150mm from the kerb upstand to allow water to flow freely around the perimeter and prevent water pooling. Run the main sheet up the kerb upstand and create a lap with a secondary formed piece 14d to 'cap' the top of the plywood 11b, and insect mesh 16.

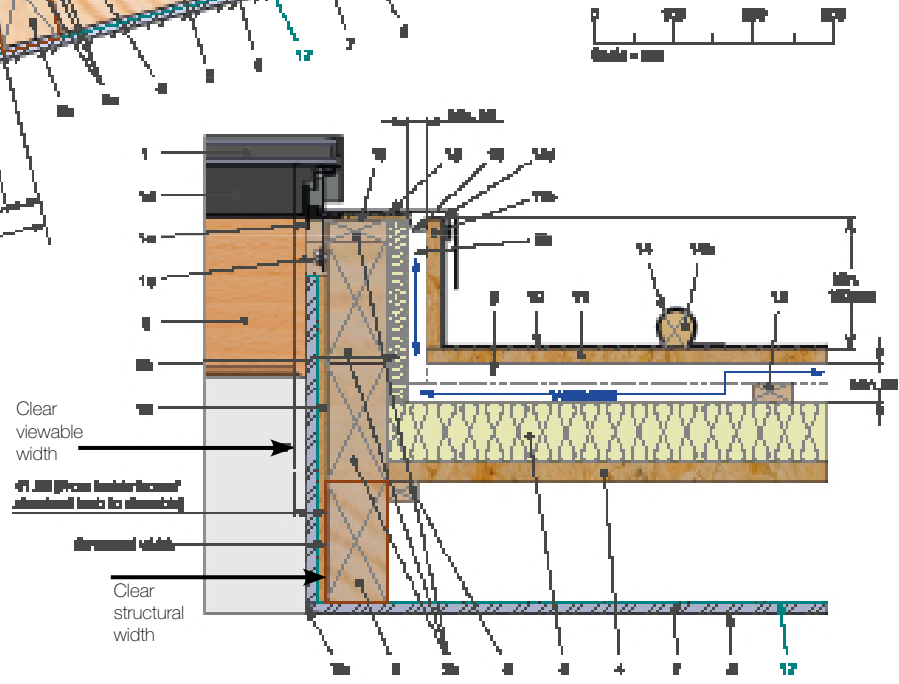

- 15 WBP plywood packers.
- 16 Insect mesh to protect the ventilated cavity. Lap this under the lead cap 14b and plywood rooflight packers 15.
- 17 Vapour barrier (Blue)
- 18 Perimeter silicone seal. Seal perimeter of roof window 1 JUST PRIOR TO installation, using a thick continuous bead of low modulus neutral cure silicone sealant.
- 19 Ply packer fitted to structural rafter supports 2 & 2c.

The Conservation Plateau Rooflight Sizes

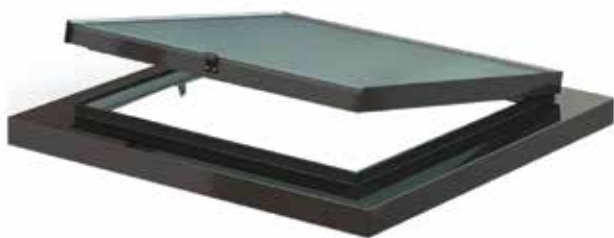

Pitch Guide

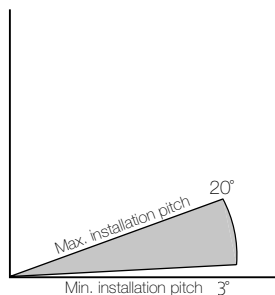

<p>Internal Structural dimensions (W) 625mm x (L) 625mm</p>  <p>Viewable dimensions (W) 542mm x (L) 542mm</p> <p>PL01</p>	<p>Internal Structural dimensions (W) 925mm x (L) 625mm</p>  <p>Viewable dimensions (W) 842mm x (L) 542mm</p> <p>PL07</p>	<p>Internal Structural dimensions (W) 925mm x (L) 925mm</p>  <p>Viewable dimensions (W) 842mm x (L) 842mm</p> <p>PL02</p>	<p>Internal Structural dimensions (W) 1225mm x (L) 625mm</p>  <p>Viewable dimensions (W) 1142mm x (L) 542mm</p> <p>PL08</p>	<p>Internal Structural dimensions (W) 1225mm x (L) 925mm</p>  <p>Viewable dimensions (W) 1142mm x (L) 842mm</p> <p>PL09</p>
<p>Internal Structural dimensions (W) 1225mm x (L) 1225mm</p>  <p>Viewable dimensions (W) 1142mm x (L) 1142mm</p> <p>PL03</p>	<p>Internal Structural dimensions (W) 1525mm x (L) 925mm</p>  <p>Viewable dimensions (W) 1442mm x (L) 842mm</p> <p>PL10</p>	<p>Internal Structural dimensions (W) 1525mm x (L) 1225mm</p>  <p>Viewable dimensions (W) 1442mm x (L) 1142mm</p> <p>PL11</p>	<p>Internal Structural dimensions (W) 1525mm x (L) 1525mm</p>  <p>Viewable dimensions (W) 1442mm x (L) 1442mm</p> <p>PL04</p>	<p>Internal Structural dimensions (W) 2025mm x (L) 1025mm</p>  <p>Viewable dimensions (W) 1942mm x (L) 942mm</p> <p>PL18</p>
<p>Internal Structural dimensions (W) 2025mm x (L) 1525mm</p>  <p>Viewable dimensions (W) 1942mm x (L) 1442mm</p> <p>PL12</p>	<p>Internal Structural dimensions (W) 925mm x (L) 1525mm</p>  <p>Viewable dimensions (W) 842mm x (L) 1442mm</p> <p>PL22</p>	<p>Internal Structural dimensions (W) 1025mm x (L) 2025mm</p>  <p>Viewable dimensions (W) 942mm x (L) 1942mm</p> <p>PL24</p>	<p>Internal Structural dimensions (W) 625mm x (L) 625mm</p>  <p>Viewable dimensions (W) 476mm x (L) 476mm</p> <p>PL05</p>	<p>Internal Structural dimensions (W) 925mm x (L) 925mm</p>  <p>Viewable dimensions (W) 776mm x (L) 776mm</p> <p>PL06</p>
<p>Internal Structural dimensions (W) 925mm x (L) 625mm</p>  <p>Viewable dimensions (W) 776mm x (L) 476mm</p> <p>PL13</p>	<p>Internal Structural dimensions (W) 1225mm x (L) 625mm</p>  <p>Viewable dimensions (W) 1076mm x (L) 476mm</p> <p>PL14</p>	<p>Internal Structural dimensions (W) 1225mm x (L) 925mm</p>  <p>Viewable dimensions (W) 1076mm x (L) 776mm</p> <p>PL15</p>		

Please see sections opposite for viewable and structural dimensions.

Hinged on shorter section

Egress/Access Plateau Rooflights



Why specify neo[®] Rooflight?

- We are the pitch roof experts; the first to perfect the look of a pane of a glass inside and out, including concealed jamb motors which no one else offers
- With 14 standard sizes and a made to measure service, we will always have a size to fit your project and we can create almost unlimited arrays with our different linking options
- neo[®] has the feel of a bespoke product for standard pricing; every detail of the design is there for a reason
- Produced from high quality materials with optional concealed electric openings to complement the architectural concept of thoughtful building design.
- We state the whole unit U-Value of our product (rather than the glass centre pane value).



Concealed jamb motors



Concealed cill motor

For more technical information visit
www.therooflightcompany.co.uk/all-products/neo/
or call 01993 833155

Suitable for pitched roofs between 20° and 60°



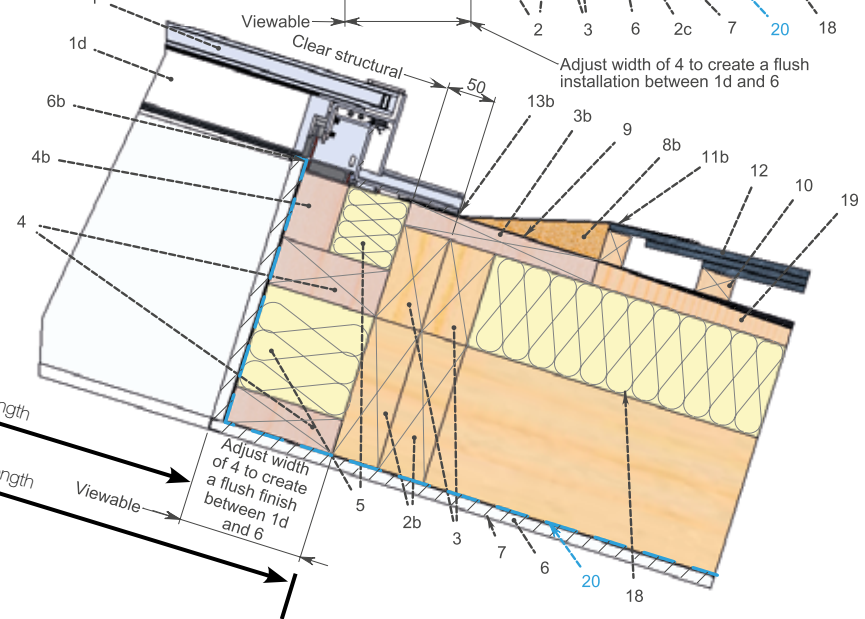
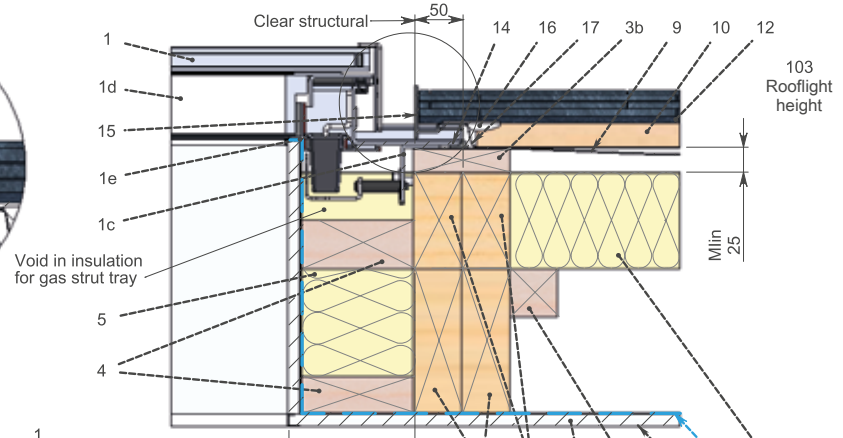
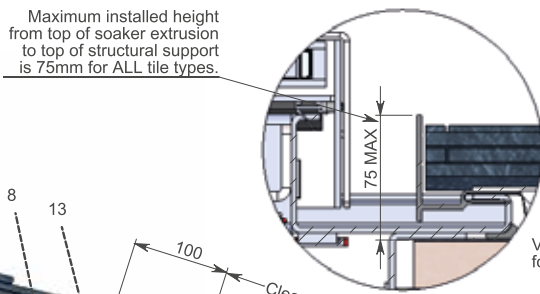
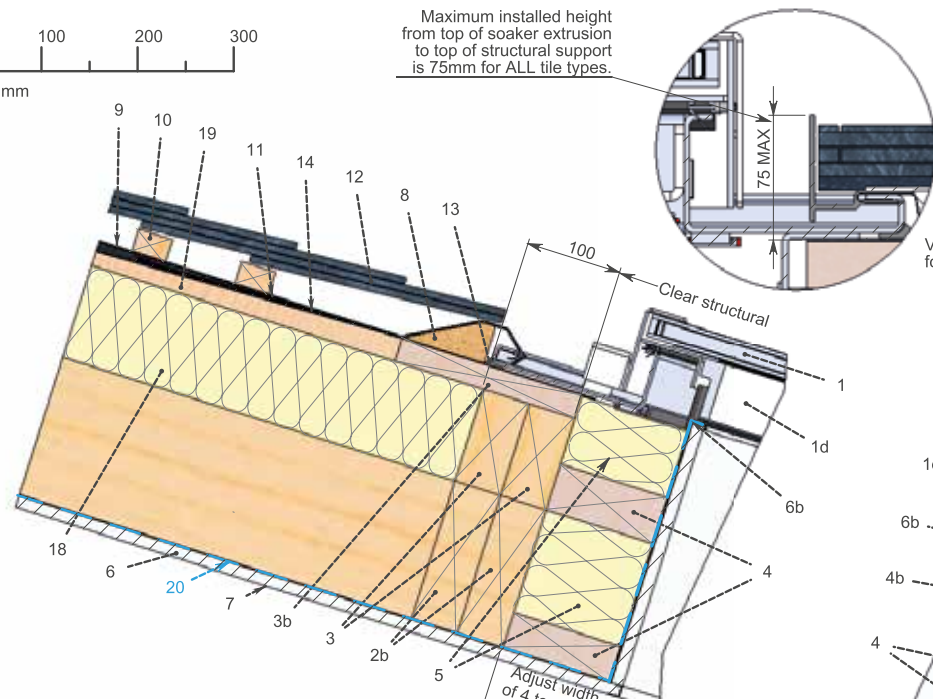
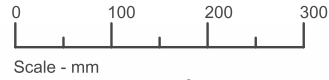

Key:

- 1 The neo® Rooflight, fixed to structural rafter supports 2 at jamb using coach bolts fitted through fixing rail 1c.
- 2 Structural rafter support at jamb and structural trimmer support at head and cill 2b. Batten bearer for insulation 2c.
- 3&3b Timber bearer fixed on top of structural supports. Adjust height to create a flush installation with the roof tiles.
- 4 Fix timber packers to structural support 2&2b at the top and the base of the roof build up. The cill timber packer 4b at the top of the roof build up should be larger to provide a secure fixing point for the ironmongery.
- 5 Insulation fitted between timber packers 4.
- 6 Plasterboard lining with plasterboard stop 6b.
- 7 Plaster skim
- 8 Head hardwood tilting fillet.
- 8b Cill hardwood tilting fillet - to provide minimum 5 degree fall for shedding rain water.
- 9 Line of breathable membrane. Roof membrane must be allowed to 'sag' between rafters.
- 10 Softwood battens.
- 11 Code 3 (consider using code 4 and clipping down roof tiles in severer exposures) lead flashing at head. Carry flashing up the roof and lap UNDER general roofing membrane 9 and UNDER head membrane 15.

- 11b Code 4 (consider clipping flashing and roof tiles down in severer exposures) lead flashing at cill over tilting fillet 8b. Make the flashing long enough to give triple lap to the tiles below.
- 12 Roofing tiles.
- 13 Perimeter silicone seal. Seal perimeter of rooflight 1 JUST PRIOR TO installation of the rooflight using a thick continuous bead of low modulus neutral cure silicone sealant. Ensure sealant to cill 13b is located in a position where it will be covered by the cill flange of the rooflight.
- 14 Roofing membrane to rooflight head. Dress UNDER general roofing membrane 9, UNDER lead flashing 11 and OVER general roofing membrane 9 to ensure suitable lap.
- 15 Jamb flashing assembly - uPVC soaker up stand. Maximum installed height from top of soaker to top of structural support is 75mm. Trim soaker to accommodate thinner tile types. Refer to the flashing kit installation guide for more information.

- 16 Jamb weathering foam which is bent over and compressed under tiles as they are fixed down. Additional fixing holes or a mortar bed may be required under some tiles where only one batten fixing is possible.
- 17 Jamb flashing aprons, part of the jamb flashing assembly (supplied as part of the Flashing Kit). They pass UNDER the battens but OVER the general roofing membrane. The battens are tacked in position at the rooflight jambs only until the Flashing Kit is installed and the jamb aprons are slid under them. Then they are fixed home.

- 18 Insulation fitted on top of structural supports.
- 19 Counter batten.
- 20 Vapour barrier (blue)

Please Note: These sectional details are provided as an installation suggestion. Due to the differing nature of installations we strongly advise you to consult your rooflight installer to verify fitness for purpose. This drawing does not constitute a structural proposal. Sufficiency of structural supports to be checked by rooflight purchaser's structural consultant.



Pitch Guide

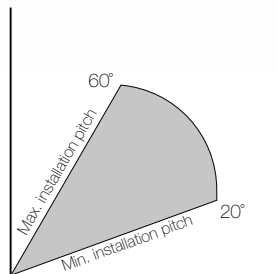

<p>Structural dimensions (W) 645mm x (L) 805mm</p>  <p>Viewable dimensions (W) 373mm x (L) 539mm neo-02</p>	<p>Structural dimensions (W) 645mm x (L) 1108mm</p>  <p>Viewable dimensions (W) 379mm x (L) 842mm neo-03</p>	<p>Structural dimensions (W) 727mm x (L) 1027mm</p>  <p>Viewable dimensions (W) 461mm x (L) 761mm neo-04</p>	<p>Structural dimensions (W) 727mm x (L) 1422mm</p>  <p>Viewable dimensions (W) 461mm x (L) 1156mm neo-05</p>
<p>Structural dimensions (W) 797mm x (L) 1108mm</p>  <p>Viewable dimensions (W) 531mm x (L) 842mm neo-06</p>	<p>Structural dimensions (W) 882mm x (L) 1222mm</p>  <p>Viewable dimensions (W) 616mm x (L) 956mm neo-07</p>	<p>Structural dimensions (W) 882 x (L) 1717mm</p>  <p>Viewable dimensions (W) 616mm x (L) 1451mm neo-08</p>	<p>Structural dimensions (W) 1101mm x (L) 1413mm</p>  <p>Viewable dimensions (W) 835mm x (L) 1147mm neo-09</p>
<p>Structural dimensions (W) 1207mm x (L) 1802mm</p>  <p>Viewable dimensions (W) 941mm x (L) 1536mm neo-10</p> <p style="writing-mode: vertical-rl; transform: rotate(180deg);">Fixed shut only</p>	<p>Structural dimensions (W) 882mm x (L) 882mm</p>  <p>Viewable dimensions (W) 616mm x (L) 616mm neo-14</p>	<p>Structural dimensions (W) 1207mm x (L) 1207mm</p>  <p>Viewable dimensions (W) 941mm x (L) 941mm neo-15</p>	<p>Structural dimensions (W) 1222mm x (L) 882mm</p>  <p>Viewable dimensions (W) 956mm x (L) 616mm neo-11</p>
<p>Structural dimensions (W) 1717mm x (L) 882mm</p>  <p>Viewable dimensions (W) 1451mm x (L) 616mm neo-S12</p>	<p>Structural dimensions (W) 1802mm x (L) 1207mm</p>  <p>Viewable dimensions (W) 1536mm x (L) 941mm neo-S13</p> <p style="writing-mode: vertical-rl; transform: rotate(180deg);">Fixed shut only</p>	<p>Please see sections opposite for viewable and structural dimensions.</p>	

neo Advance®



Why specify the neo Advance® Rooflight?

Our patented thermal shield design blocks heat passing through the aluminium frame.

- Free from unsightly fixings inside and out with easy installation
- No condensation and mould problems thanks to our unique thermal shield technology
- Achieves whole window U-value of $1.06 \text{ W/m}^{-2}\text{K}$ for a double glazed rooflight
- Aluminium frame is ideal for coastal locations
- 6 sizes available from stock

For more technical information visit
www.therooflightcompany.co.uk/all-products/neo-advance
or call 01993 833155



Suitable for flat roofs

www.therooflightcompany.co.uk/all-products/neo-advance

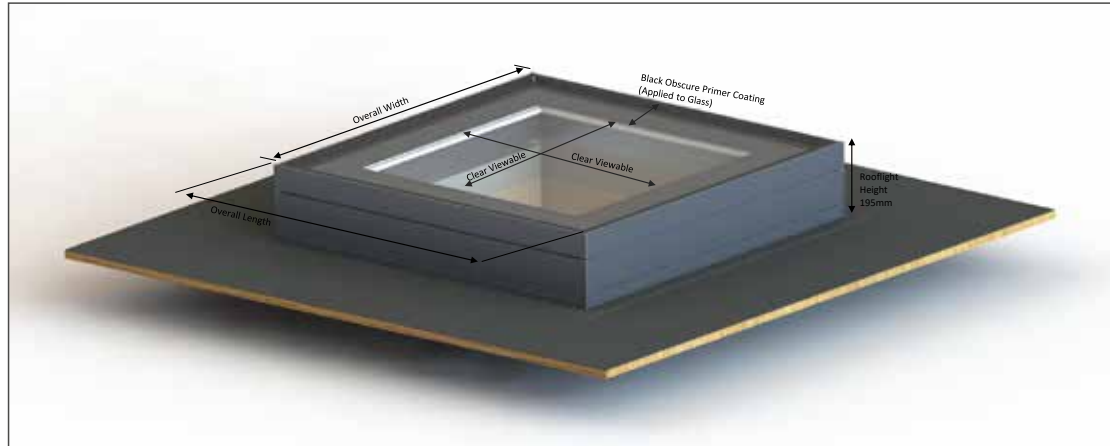

neo Advance® Opening Option

<p>Finished External Kerb (W) 1000mm x (L) 1000mm</p> <p>Viewable dimensions Opening NFO-01 (W) 734mm x (L) 734mm</p>	<p>Finished External Kerb (W) 1200mm x (L) 1000mm</p> <p>Viewable dimensions Opening NFO-02 (W) 934mm x (L) 734mm</p>	<p>Finished External Kerb (W) 1200mm x (L) 1200mm</p> <p>Viewable dimensions Opening NFO-03 (W) 934mm x (L) 934mm</p>
<p>Finished External Kerb (W) 1500mm x (L) 1500mm</p> <p>Viewable dimensions Opening NFO-04 (W) 1234mm x (L) 1234mm</p>	<p>Finished External Kerb (W) 1500mm x (L) 1000mm</p> <p>Viewable dimensions Opening NFO-05 (W) 1234mm x (L) 734mm</p>	<p>Finished External Kerb (W) 2000mm x (L) 1000mm</p> <p>Viewable dimensions Opening NFO-06 (W) 1734mm x (L) 734mm</p>

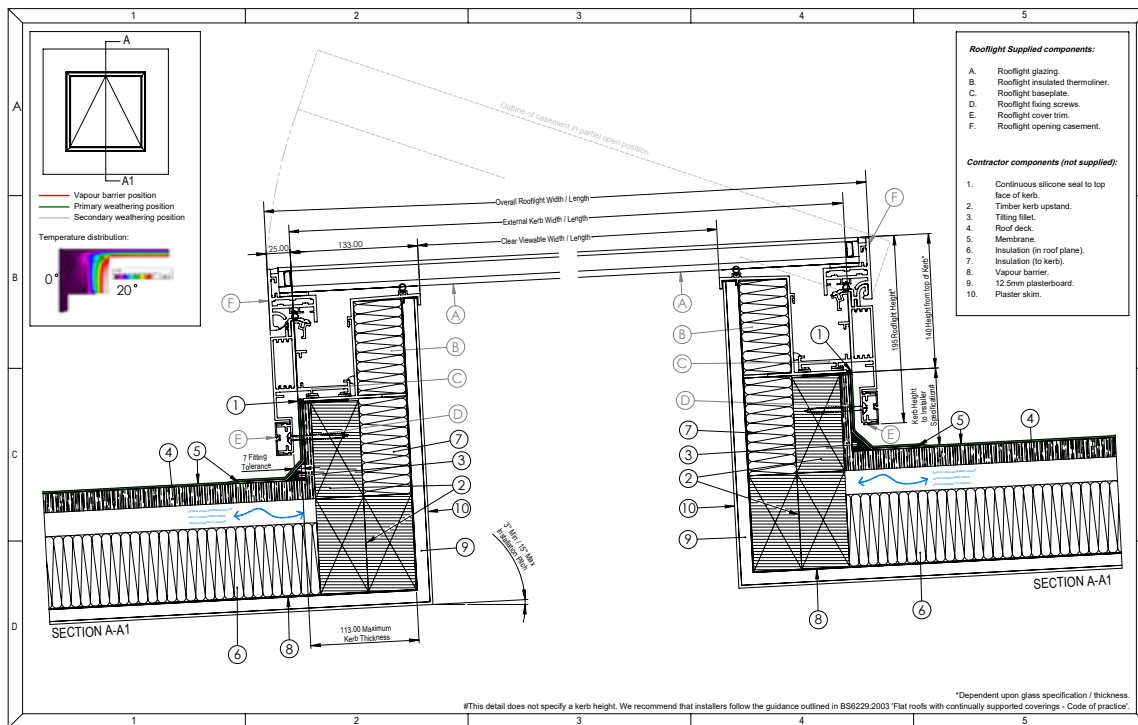

Pitch Guide

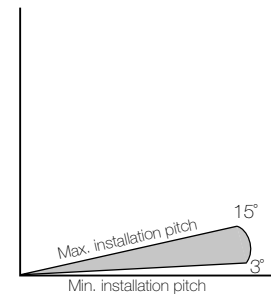

<p>TITLE: neo Advance</p> <p>> A rooflight range suitable for flat roofs between 3° and 15°</p> <p>> Detail applicable ONLY to flat roof models with opening casement</p> <p>Flat Roof Membrane 'Kerb upstand' installation detail</p>	<p>DWG NO.: DP0030_100INST_B</p> <p>SCALE: 1:3 @ A3 DO NOT SCALE</p> <p>QUESTIONS / COMMENTS: W: www.therooflightcompany.co.uk T: 01993 833 108 E: info@therooflightcompany.co.uk</p>	<p>SHEET NO.: 1 OF 1</p> <p>DATE: 26/07/2019</p> <p>REVISION DETAILS: R - General adjustments to detailing. A - New at first issue.</p>	<p>REVISION: B</p> <p>QC: DB: PD CB: PK</p>	<p>IMPORTANT NOTES:</p> <p>This is a suggested installation detail which may not be exactly applicable to all situations and constructions. It is not a detailed or constructional proposal. Installers and designers are advised to check their own details for compliance with all currently applicable Local Authority by-laws, Acts of Parliament and British / ISO standards.</p> <p>All information contained within this drawing is copyright © and design right of the Rooflight Company. The intellectual property rights of the products detailed within this drawing and embedded 3D models are owned by the Rooflight Company.</p>
---	---	---	---	---





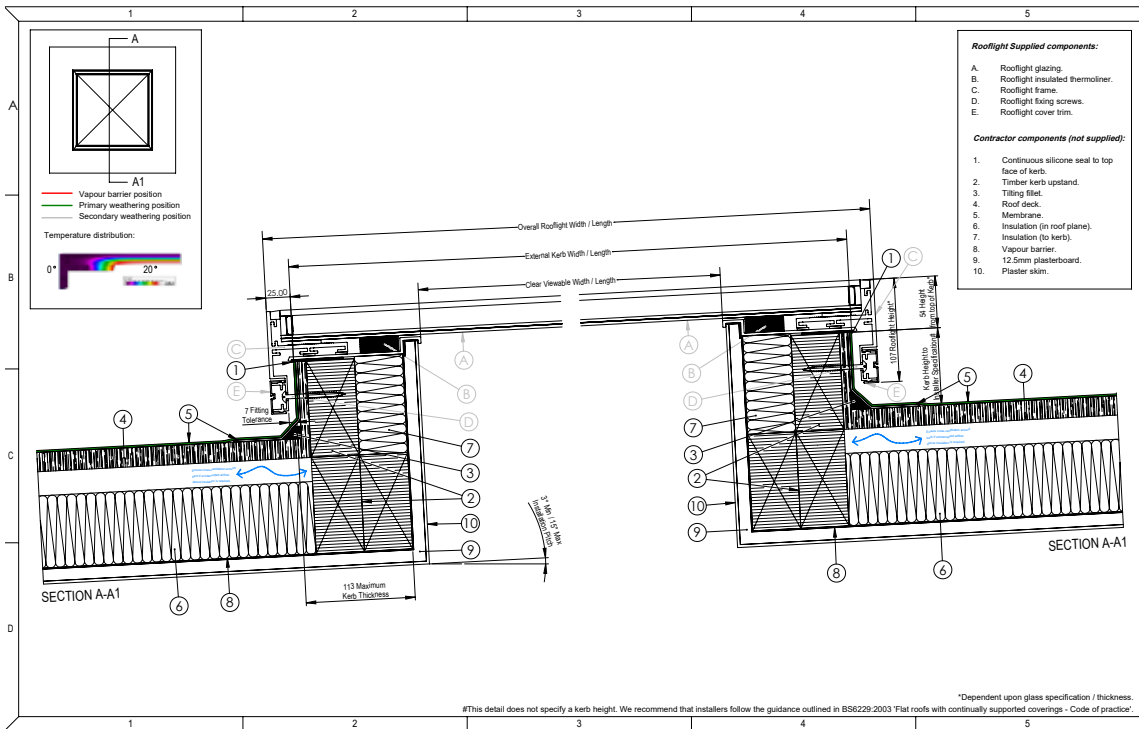
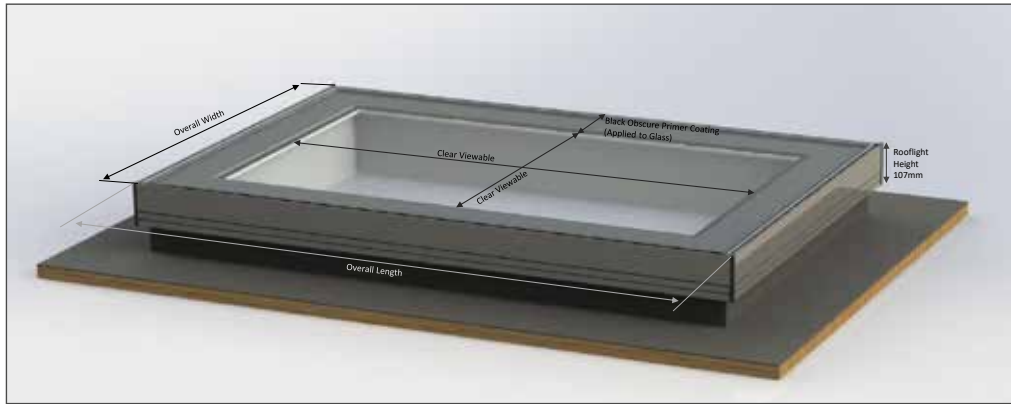

www.therooflightcompany.co.uk/all-products/neo-advance

neo Advance® Fixed Shut Option



TITLE: neo Advance A rooflight range suitable for flat roofs between 3° and 15° > Detail applicable ONLY to flat roof modes without opening casement Flat Roof Membrane 'Kerb upstand' installation detail	DWG NO.: DP0027_100INST_B SCALE: 1:3 @ A3 QUESTIONS / COMMENTS: www.therooflightcompany.co.uk t: 01953 833 108 e: info@therooflightcompany.co.uk	SHEET NO.: 1 OF 1 DATE: 25/10/2019 REVISION DETAILS: B - Reference dimension removed. A - New at first issue.	REVISION: B QC: DB: PD CB: PK	IMPORTANT NOTES: This is a suggested installation detail which may not be exactly applicable to all situations and constructions. It is not a detailed or constructional proposal. Installers and designers are advised to check their own details for compliance with all currently applicable Local Authority by-laws, Acts of Parliament and British / ISO standards. All information contained within this drawing is copyright © and design right of the Rooflight Company. The intellectual property rights of the products detailed within this drawing and embedded 3D models are owned by the Rooflight Company.
	#This detail does not specify a kerb height. We recommend that installers follow the guidance outlined in BS6229:2003 'Flat roofs with continually supported coverings - Code of practice'.			

neo Advance® Rooflight Sizes

Finished External Kerb (W) 1000mm x (L) 1000mm  Viewable dimensions Fixed shut NFF-01 (W) 731mm x (L) 731mm	Finished External Kerb (W) 1200mm x (L) 1000mm  Viewable dimensions Fixed shut NFF-02 (W) 931mm x (L) 731mm	Finished External Kerb (W) 1200mm x (L) 1200mm  Viewable dimensions Fixed shut NFF-03 (W) 931mm x (L) 931mm
Finished External Kerb (W) 1500mm x (L) 1500mm  Viewable dimensions Fixed shut NFF-04 (W) 1231mm x (L) 1231mm	Finished External Kerb (W) 1500mm x (L) 1000mm  Viewable dimensions Fixed shut NFF-05 (W) 1231mm x (L) 731mm	Finished External Kerb (W) 2000mm x (L) 1000mm  Viewable dimensions Fixed shut NFF-06 (W) 1731mm x (L) 731mm
Finished External Kerb (W) 3000mm x (L) 1000mm  Viewable dimensions Fixed shut NFF-07 (W) 2731mm x (L) 731mm		

Pitch Guide

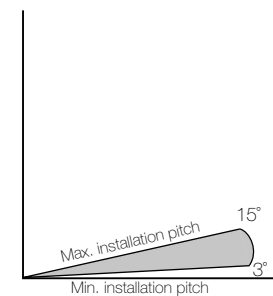

www.therooflightcompany.co.uk/all-products/neo-advance

neo Advance Skywalk®



Why specify the neo Advance Skywalk® Rooflight?

SETTING THE STANDARD FOR WALK ON ROOFLIGHTS.

- Transparent whole window low U values of 1.19
- Anti-slip coating enhancement as standard so you stay safe even when it's wet
- Triple ply laminate glass guarantees safety and strength
- Available in four sizes to suit your needs

For more technical information visit

www.therooflightcompany.co.uk/all-products/neo-advance-skywalk

or call 01993 833155

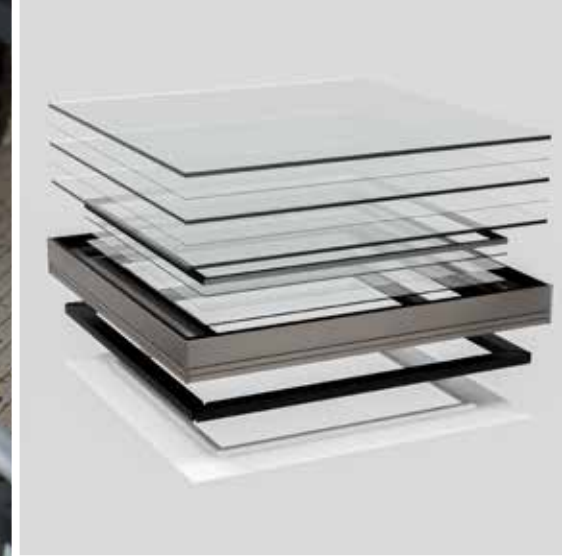

Suitable for flat roofs



www.therooflightcompany.co.uk/all-products/neo-advance

Bespoke Design Service



Why specify our Bespoke Rooflight range?

- We agonise over the detail; after-all we were founded by an architect. This means that architects end up with a sound, reliable solution. In fact, we are instrumental in setting industry test standards
- We sort out all the complicated detailing and draw up the installation each time

Contemporary Projects

- Our designers have the technical expertise to create the wow-factor for your clients

Historic Projects

- As inventors of the original Conservation Rooflight® our experience with historic buildings is second to none
- We have worked with many architects on Landmark buildings such as Somerset House, the Natural History Museum and Kensington Palace

For more technical information visit
www.therooflightcompany.co.uk/bespoke
or call 01993 833155



How we make your Vision a Reality

No two projects are the same but most follow similar paths.
Our process is well-defined and aims to make your experience as easy as possible.

Enquiry

Send us your enquiry



Our designers will review it



We will discuss your needs with you by telephone



A design solution will be created



You will be able to provide feedback on the design



A revised enquiry including lead time and costs will be sent to you

Order

Accept quotation



A technical file for CE marking will be created



Drawings, simulations and calculations for the roof window will be made



A 3D model will be overlaid onto the drawings



You will receive drawings / plans (DWG)



Client acceptance drawings will be sent to you within 1-10 days



You sign the drawings and send back to us

Over to us

Fabrication drawings will be created



The roof windows are manufactured



The roof window arrives on-site



An experienced contractor should install the roof window



We are at the end of the phone for further advice on installation or maintenance

For more information visit www.therooflightcompany.co.uk/bespoke

Mottisfont Visitors Centre

Mottisfont Abbey is a National Trust owned site in Hampshire with over 250,000 visitors per annum. Burd Haward Architects were appointed to the scheme in 2010 after winning an invited design competition

"We specified the Rooflight Company because we were impressed by the attention to details and quality of construction of their rooflights. We also needed a company that could supply a bespoke product and so worked closely with their design department to develop a rooflight that would dovetail with the rest of our design."

Buddy Haward, Burd Haward Architects



Michael Baker Boathouse

This innovative new boathouse in Worcester was designed by Associated Architects. A bespoke curved Plateau measuring just over eighteen meters long, provides a dramatic continuous run of light to the second story of the building.

"We are delighted with the seamless integration of the rooflights into the building and the quality of light they achieve. The Rooflight Company was able to respond to a complex set of design constraints and technical requirements, to enable us to realise our vision"

Stephen Townsend, Associated Architects

Tin House

Tin House is an innovative design solution to maximising suburban City space whilst maintaining privacy. Six openable bespoke trapezoidal rooflights were specified for this award-winning house by Henning Stummel Architects.

"The positive collaboration that I had with the Rooflight Company was essential. We couldn't have created the rooflight feature that we did without them."

Henning Stummel, Henning Stummel Architects



The Studio Range



Maximising Natural Light and Ventilation

With all the qualities and advantages offered by the Conservation Rooflight® and neo®, the Studio Range is designed for projects requiring a run of finely detailed, low-profile roof windows.

- Almost limitless runs of openable roof windows
- Designed with slim clean lines to maximise daylight
- White internal linings that sit flush to the reveal
- Three different linking options providing an option to suit every budget
- Flexible opening options (manual or electric) offer adjustable ventilation – not every casement needs to have the same opening option

For more technical information visit
www.therooflightcompany.co.uk/all-products/studio
or call 01993 833155

Pitch Guide

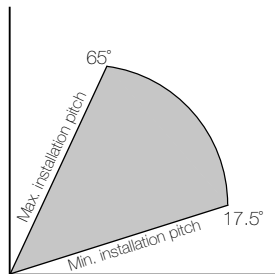

Suitable for pitched roofs up to 65°



Grange Street Mews

Award-winning architects Briffa Phillips Architects set out to create a spacious feel to the conversion of a constricted warren of commercial properties into seven mews houses.

There were strict planning requirements set down by local conservation and planning officers.

Max Briffa explained: "Planning negotiations could have been a problematic issue, particularly the use of roof windows. But it turned out to be fairly straightforward, as both the conservation officers and I were keen that the project used the Conservation Rooflight® from the Rooflight Company.

Its slim profile and authentic period appearance made it the best - indeed the only suitable - option in this particular case.

Having incorporated roof windows from the company on a number of other developments, I was more than happy to do so again."

12 x Studio-Designer Conservation Rooflights® were installed on the scheme.





Summer House

Acanthus Clews Architects were briefed to design a summer house situated by an outdoor swimming pool on the grounds of an Oxfordshire property. While on holiday in Europe the property owner saw a building featuring roof windows that ran continuously along the roof. She wanted to replicate this style on her summer house, ensuring that as much natural light as possible would fill the space.

Architect Steven Myhill approached the Rooflight Company regarding **neo**[®] due to its fine lines, flush fitting and the choice of opening options.

The Rooflight Company talked the Architect through the different linking options available. After consultation with the Rooflight Company's Design Team, Steven chose linking option one as the smaller internal distances between the casement would best suit his client's needs.

Another benefit of selecting linked roof windows was the uncluttered internal finish due to the concealed actuation and blind motors.

Three **neo**[®] roof windows were linked together for this project with a single **neo**[®] situated either side. The roof windows were fitted with concealed actuation and an integral, motorised blind system. As they were positioned on the South facing elevation, Pilkington Eclipse Advantage glazing was specified to reduce the level of heat transferred into the space.

Project Architect, Steven Myhill said: "**neo**[®] is a fantastic roof window, it complimented our project perfectly. I especially like the effect the linked **neo**[®] has on the amount of natural light that fills the property."



The Conservation Lantern Rooflight



Why specify the Conservation Lantern Rooflight?

Best suited for Victorian Architecture, the Lantern Rooflight is a versatile way to enhance many different types of building.

- Flexible opening options (manual or electric) offer adjustable ventilation
 - Six standard sizes available
 - Bespoke sizes available from our Bespoke Design Service
- Can be specified with or without parapets depending on the style of building



For more technical information visit
www.therooflightcompany.co.uk/all-products/lantern
or call 01993 833155

Suitable for flat roofs



The Conservation Pyramid Rooflight



Why specify the Conservation Pyramid Rooflight?

Best suited for Victorian Architecture, the Pyramid Rooflight is a versatile way to enhance many different types of building.

- Flexible opening options (manual or electric) offer adjustable ventilation
- Four standard sizes available
- Bespoke sizes available from our Bespoke Design Service
- Can be specified with or without parapets depending on the style of building



For more technical information visit
www.therooflightcompany.co.uk/all-products/pyramid
or call 01993 833155

Suitable for flat roofs



The Conservation Lantern Rooflight

The Conservation Pyramid Rooflight

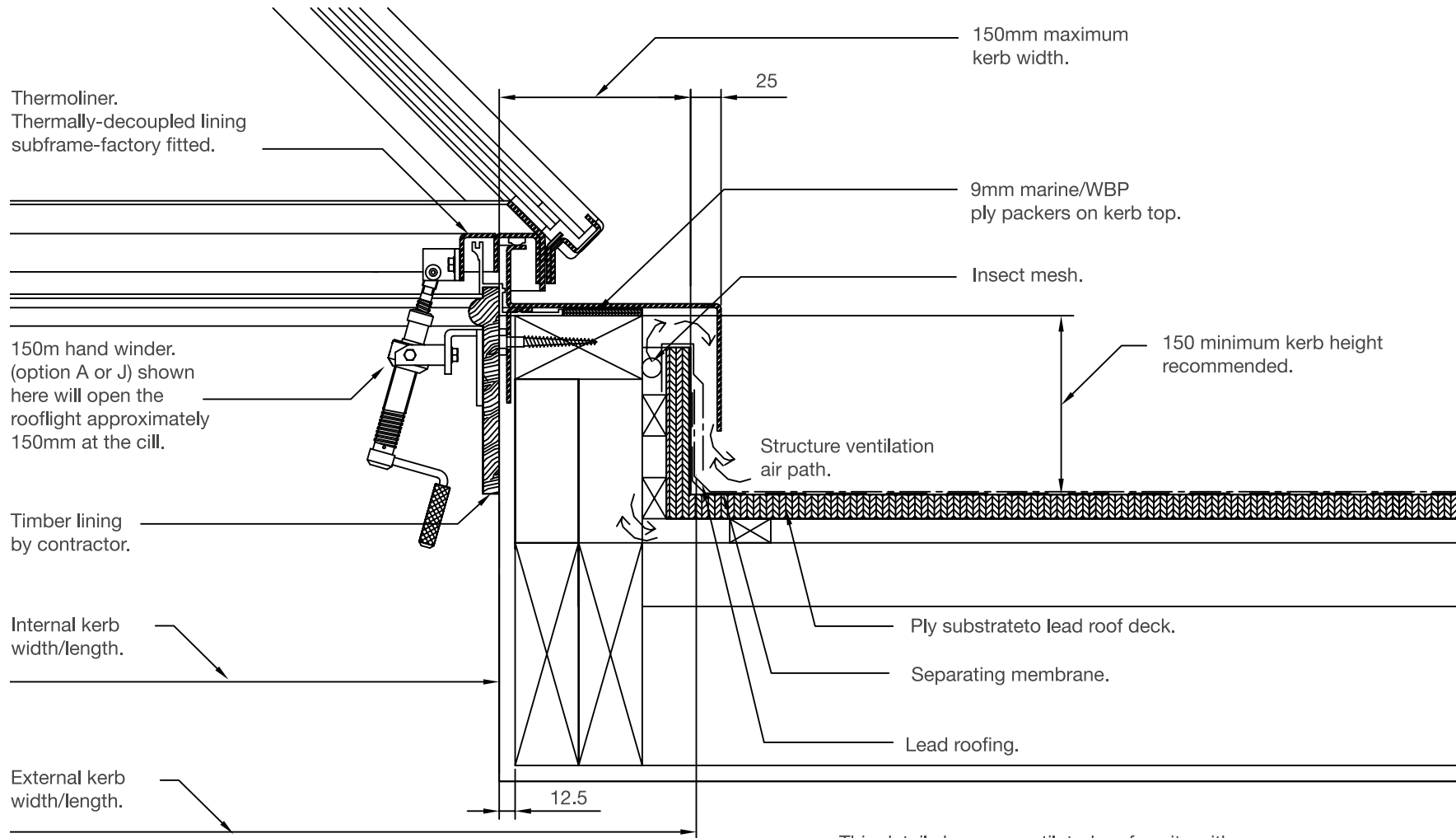

This detail shows a ventilated roof cavity with a lead/sheet covering over.

The Conservation Lantern Rooflight Sizes

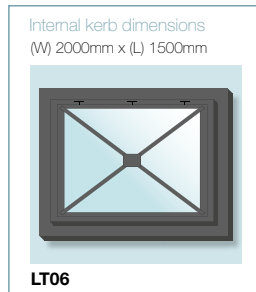
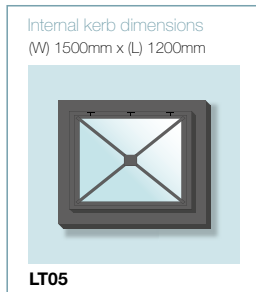
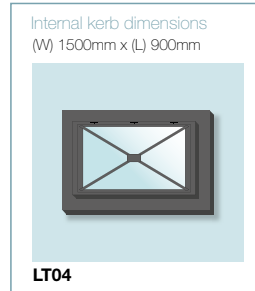
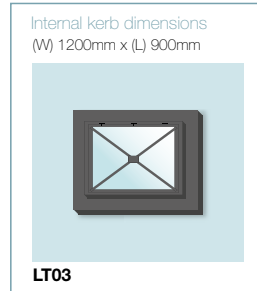
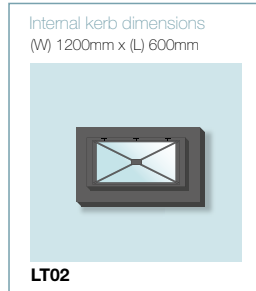
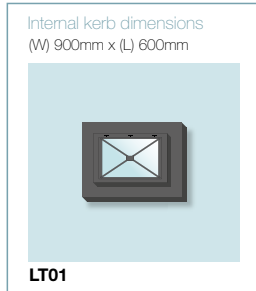

Please see sections opposite for viewable and structural dimensions.

Structural Area

The internal perimeter of the aperture - the frame for the Rooflight.
Please measure the width and length of the edge of the rafters.

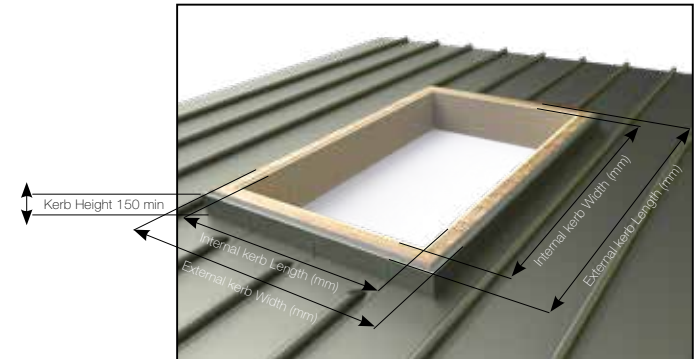

These are non-stocked items and are therefore Custom Made to your specification for glass, finish and colour. Bespoke sizing is available - please contact us to discuss your requirements.

www.therooflightcompany.co.uk/all-products/pyramid

The Conservation Pyramid Rooflight

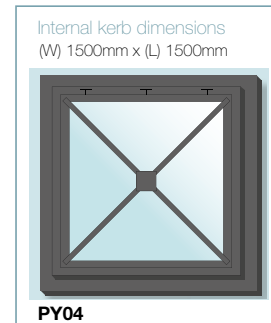
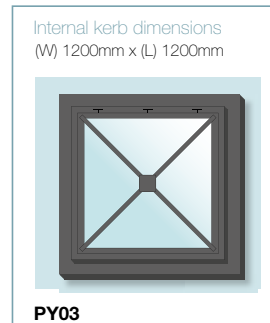
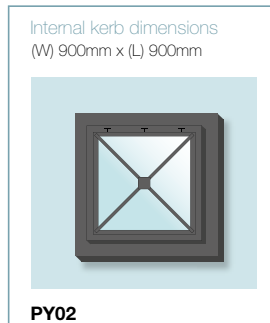
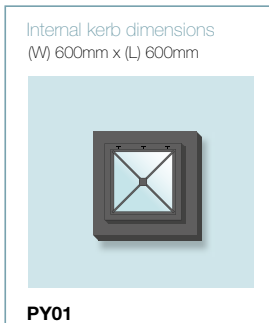

Please see sections opposite for viewable and structural dimensions.

Structural Area

The internal perimeter of the aperture - the frame for the Rooflight.
Please measure the width and length of the edge of the rafters.

These are non-stocked items and are therefore Custom Made to your specification for glass, finish and colour.
Bespoke sizing is available - please contact us to discuss your requirements.

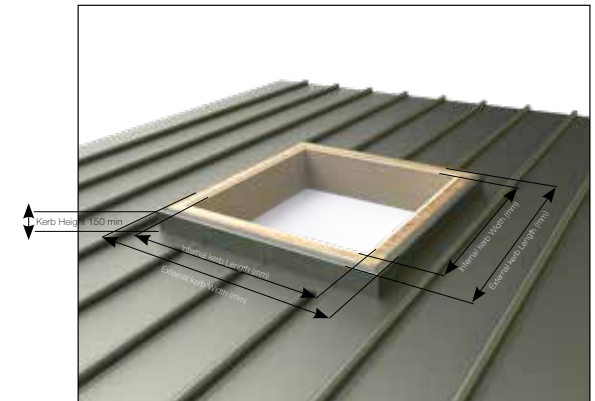

Secured by Design



Why specify Security Rooflights?

For when security is paramount, the Added Security and Secured by Design upgrades to our Plateau Rooflight ranges provide complete peace of mind for your project.

Added Security

A flexible menu of Added Security options available on all Plateau Rooflight sizes – see page 40

The Conservation Plateau Secured by Design Rooflight – see page 38

- ✎ The first rooflight to be Secured by Design certified to Loss Prevention Standard 1175 issue 7 (categories SR2 and SR3)
- ✎ Approved for installation into either a concrete or hardwood structural kerb

The neo® Plateau Secured by Design Rooflight – see page 39

- ✎ Certified to LPS 2081 Issue 1 Level A and B as standard.
- ✎ Certified to LPS 1175 Issue 7 SR1
- ✎ Perfect for 'Low Risk' category buildings
- ✎ Complies with Part Q Building Regulations

For more technical information visit

www.therooflightcompany.co.uk/bespoke/securedbydesign/

www.therooflightcompany.co.uk/bespoke/addedsecurity/

or call 01993 833155



Suitable for pitched roofs between 3° and 20°

Secured by Design Rooflights - Part Q

Which level of security is right for me?

If you require a rooflight that has been security tested, there are a number of factors you should consider before deciding which level of security is right for your project. This includes location of the property, value of the property, where the rooflight is located, the value of goods within the property and if the property has additional security features such as CCTV.

The table below will help you understand the testing requirements for each certification, however please call us if you would like to discuss your needs.

Application		Minimum Performance Required	The Rooflight Company	Notes
HIGH RISK LPS 1175 SR5 Testing is generally applicable to very high security doorsets.		LPS 1175 SR6 LPS 1175 SR5		Doorsets tested to LPS 1175 SR5 and SR6 have been designed to resist a professional attack using powerful mains operated tools for up to 30 minutes.
MEDIUM RISK A medium risk building requires a minimum security certification of LPS 1175 SR3 for doors, shutters and windows (including easily accessible rooflights).		LPS 1175 SR4		Rooflights tested to a medium risk certification have been designed to resist a professional attack using a variety of battery operated tools. The duration of attack varies for each level of testing as shown below.
		LPS 1175 SR3	The Conservation Plateau Secured by Design Rooflight	Tested to withstand an attack up to 20 minutes
LOW RISK A low risk building requires a minimum security certification of LPS 1175 SR1 or BS. PAS 24 for doors, security grilles, shutters and windows (including easily accessible rooflights).		LPS 1175 SR2	The Conservation Plateau Secured by Design Rooflight	Rooflights tested to a low risk certification have been designed to resist a professional attack using a variety of hand tools such as hammers, crowbars, chisels and hacksaws. All low risk certifications are deemed acceptable for Part Q building regulations however the duration of attack varies for each level of testing as shown below.
		LPS 1175 SR1 LPS 2081 Level B LPS 2081 Level A	The neo™ Plateau Secured by Design The neo™ Plateau Secured by Design The neo™ Plateau Secured by Design	Tested to withstand an attack up to 10 minutes Tested to withstand an attack up to 3 minutes Tested to withstand an attack up to 1 minute

Why would I need a security rooflight?

Within the Part Q Building Regulation document, it defines easily accessible as:

- A window within 2m vertically of a flat or sloping roof (with a pitch of less than 30 degrees) that is within 3.5m of ground level
- A window or doorway, any part of which is within 2m vertically of an accessible level surface such as ground or basement level, or an access balcony

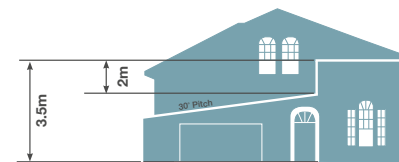

If you have a rooflight deemed as easily accessible to get into the building from the outside, you will need to ensure that it is proven to resist criminal attack or incorporate features that are proven to reduce crime.

The Conservation Plateau

Secured by Design

Rooflight Sizes

LPS 1175 SR1 + SR3

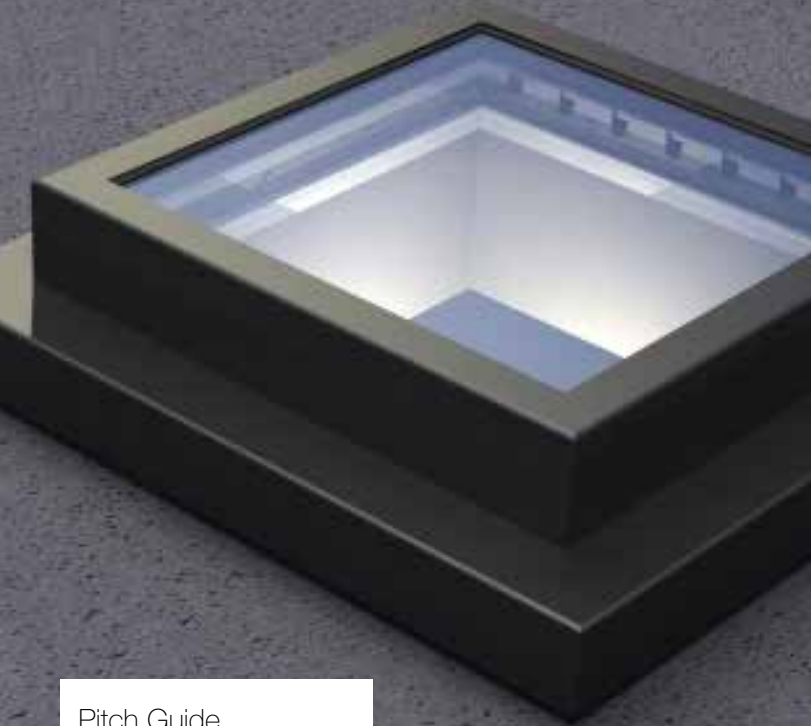

Secured by Design Rooflights are available with obscure glazing, intruder bars and a wide range of security features. All enquiries will need to be discussed with our Bespoke Design Team to ensure the correct level of security is applied to your project.

The Rooflight Company's Secured by Design Rooflights are accredited to Loss Prevention Standard 1175 issue 7 (categories SR2 and SR3).



Internal Structural Dimension
(W) 690mm x (L) 690mm



SBD 01
Stainless Steel

Internal Structural Dimension
(W) 690mm x (L) 690mm



SBD 02 Mild Steel with
Hot Zinc Pre-Treatment

Internal Structural Dimension
(W) 690mm x (L) 690mm

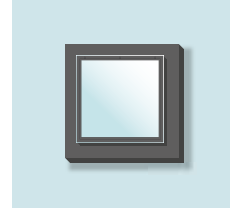

SBD 03
Stainless Steel 304

Internal Structural Dimension
(W) 690mm x (L) 690mm



SBD 04
Stainless Steel 316

Internal Structural Dimension
(W) 1115mm x (L) 1115mm



SBD 05
Mild Steel

Internal Structural Dimension
(W) 1115mm x (L) 1115mm



SBD 06 Mild Steel with
Hot Zinc Pre-Treatment

Internal Structural Dimension
(W) 1115mm x (L) 1115mm



SBD 07
Stainless Steel 304

Internal Structural Dimension
(W) 1115mm x (L) 1115mm

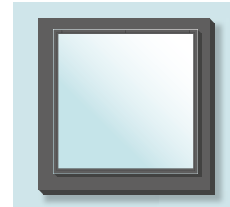

SBD 08
Stainless Steel 316

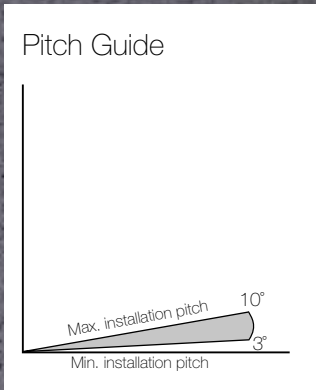

Please note sizes are based on Besoke sizes only.

The neo[®] Plateau
 Rooflight Sizes
 LPS2081 A+B
 LPS1175 - SR1

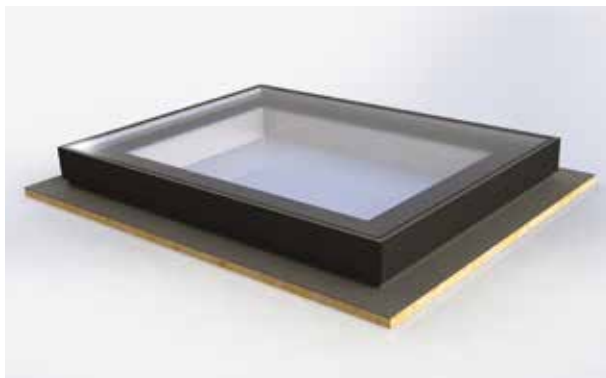

Pitch Guide

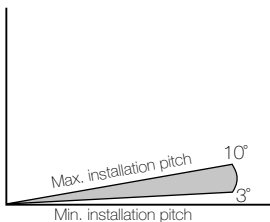

Finished External Kerb
 (W) 750mm x (L) 750mm

Viewable dimensions
 (W) 500mm x (L) 500mm
NP01 - LPS2081
NP01 - LPS1175

Finished External Kerb
 (W) 1000mm x (L) 1000mm

Viewable dimensions
 (W) 750mm x (L) 750mm
NP02 - LPS2081
NP02 - LPS1175

Finished External Kerb
 (W) 1200mm x (L) 900mm

Viewable dimensions
 (W) 950mm x (L) 650mm
NP03 - LPS2081
NP03 - LPS1175

Finished External Kerb
 (W) 1200mm x (L) 1200mm

Viewable dimensions
 (W) 950mm x (L) 950mm
NP04 - LPS2081
NP04 - LPS1175

Finished External Kerb
 (W) 1500mm x (L) 1500mm

Viewable dimensions
 (W) 1250mm x (L) 1250mm
NP05 - LPS2081
NP05 - LPS1175

Finished External Kerb
 (W) 1500mm x (L) 1000mm

Viewable dimensions
 (W) 1250mm x (L) 750mm
NP06 - LPS2081
NP06 - LPS1175

Finished External Kerb
 (W) 2000mm x (L) 1000mm

Viewable dimensions
 (W) 1750mm x (L) 750mm
NP07 - LPS2081
NP07 - LPS1175

Sections for viewable and structural dimensions can be found on our website. All prices exclude VAT and delivery.

Also available:
The Added Security Rooflight
Sizes



The Added Security Rooflights are available with a flexible choice of upgrades to suit your project.
All security requirements should be discussed with our Bespoke Design Team.

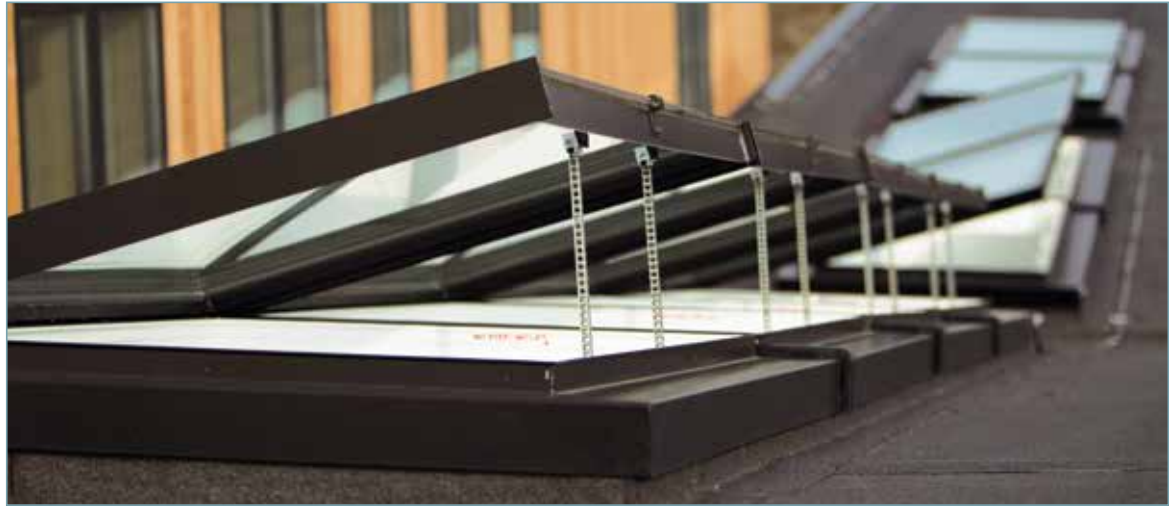

Internal Structural Dimension
(W) 690mm x (L) 690mm

SBD 01
Mild Steel

Internal Structural Dimension
(W) 690mm x (L) 690mm

SBD 02 Mild Steel with
Hot Zinc Pre-Treatment

Internal Structural Dimension
(W) 690mm x (L) 690mm

SBD 03
Stainless Steel 304

Internal Structural Dimension
(W) 690mm x (L) 690mm

SBD 04
Stainless Steel 316

Internal Structural Dimension
(W) 1115mm x (L) 1115mm

SBD 05
Mild Steel

Internal Structural Dimension
(W) 1115mm x (L) 1115mm

SBD 06 Mild Steel with
Hot Zinc Pre-Treatment

Internal Structural Dimension
(W) 1115mm x (L) 1115mm

SBD 07
Stainless Steel 304

Internal Structural Dimension
(W) 1115mm x (L) 1115mm

SBD 08
Stainless Steel 316

Pitch Guide

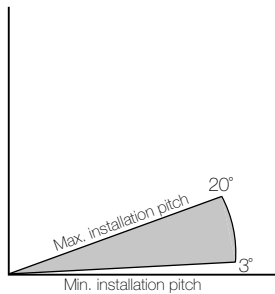

Please note sizes are based on Bespoke sizes only.

Ironmongery

Manual Opening Options for the Conservation Rooflight®, the Conservation Plateau Rooflight, the Conservation Lantern Rooflight, the Conservation Pyramid Rooflight and the Studio Range.



Poles are available in four lengths:

OPTF	Aluminium 1.0m length
OPTG	Aluminium 1.5m length
OPHT	Aluminium 2.0m length
OPTI	Aluminium 1.75m - 3.0m telescopic

Manual Opening Options for neo®



Motors for the Conservation Rooflight, the Plateau Rooflight, the Lantern Rooflight, the Pyramid and the Studio Range



Motors for neo®



Please note, cill and jamb motors are concealed within the frame.

Blinds

Available as both roller and pleated styles, offering an attractive and practical solution to light control, all blinds incorporate easy manual operation with motorised upgrades available in the pleated blind ranges. Blinds are available for the Conservation Rooflight and neo®.

Roller Blinds

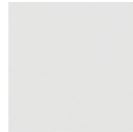

White



Ivory



Taupe



Silver



Dark Grey

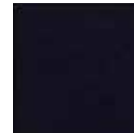

Navy

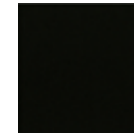

Black

Pleated Blinds



White



Ivory



Taupe



Silver

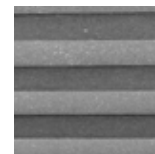

Dark Grey

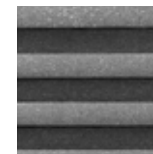

Black

Colour Options

More information can be found on our website, within the product pages.
Material swatches can also be sent to you via post. Call 01993 833155 to speak to an advisor.

You can also buy blinds via our online shop. Visit www.therooflightcompany.co.uk/all-products/blinds-and-ironmongery



Additional Resources

A Homeowner's Guide



Client Presentations



Plateau
Rooflights



Bespoke Design
Service



The Conservation
Rooflight



neo®

Contact tomarketing@therooflightcompany.co.uk to request copies

The Rooflight Company

Wychwood Business Centre,

Milton Road,

Shipton-under-Wychwood,

Oxfordshire OX7 6XU

Tel: 01993 833155

email: info@therooflightcompany.co.uk

www.therooflightcompany.co.uk



Scan the QR code to leave us a review



bsi.
The Rooflight Company
Shipton-under-Wychwood
Insulating Glass Units
No. KM 93754
BS EN 1279-2: 2002
BS EN 1279-3: 2002



Disclaimer

Images and diagrams used in this Rooflight brochure are used for illustrative purposes only. Due to occasional changes in product specification and material prices always check with the Rooflight Company Customer Services Department on **01993 833155** or online at www.therooflightcompany.co.uk for the exact specification, appearance and current prices prior to placing your order.