

Vasche in ClearStone

Istruzioni di montaggio

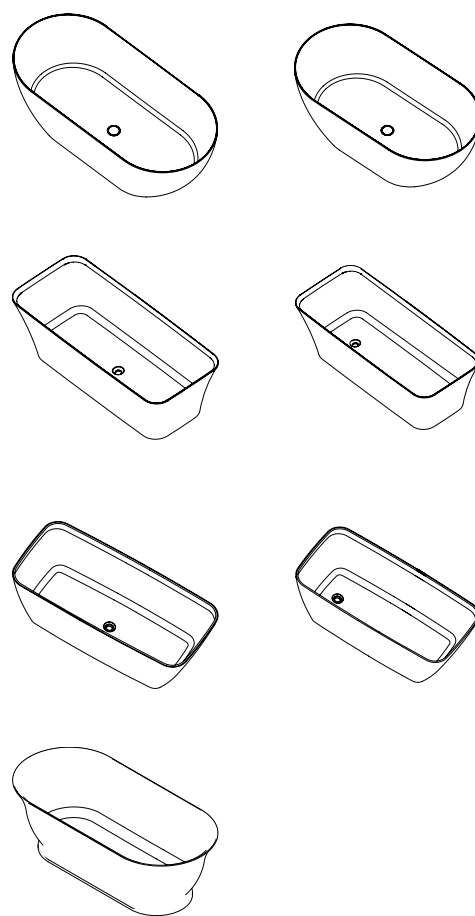

teuco

A1G- - - D-

A1P- - - D-

A2G- - - D-

A2P- - - D-

A3G- - - D-

A4G- - - D-

A4P- - - D-

Importante

- Si prega di togliere dall'imballo la vasca e controllare con attenzione per assicurarsi che non abbia subito danni durante la movimentazione o il trasporto.
- Si prega di controllare che tutte le parti siano state fornite.
- Assemblare la vasca su un telo protettivo per evitare danni alla superficie.
- Si prega di non rimuovere il vecchio prodotto prima di essersi assicurati che il nuovo sia integro.
- Conservare la vasca in un luogo sicuro finché non si inizia l'installazione per evitare danni.
- Ogni installazione deve essere effettuata da un tecnico qualificato con conoscenza dei requisiti igienico-sanitari di legge in vigore.
- Sono richieste due persone per sollevare la vasca, utilizzare tecniche di sollevamento idonee.
- Questa guida all'installazione non include i dettagli sul collegamento degli scarichi; la decisione finale sull'installazione del collegamento degli scarichi deve essere assunta da una persona qualificata.



Non stringere troppo lo scarico in quanto ciò potrebbe causare danni a lungo termine alla vasca. Si consiglia di utilizzare una chiave dinamometrica per stringere lo scarico utilizzando una forza di coppia tra 25 Nm e 50 Nm.

Cura e manutenzione

Riparazione di un graffio: Se i graffi si verificano durante l'installazione, possono essere rimossi strofinando con una carta abrasiva impermeabile (1500+) e acqua. In seguito rilucidare la superficie utilizzando una pasta abrasiva neutra o il polish universale. Per ottenere migliori risultati limitare la levigatura il più possibile intorno all'area graffiata.

È possibile levigare graffi molto piccoli senza dover utilizzare carte abrasive: strofinare delicatamente con una spazzola morbida o spugna di plastica (non la parte metallica) e un detergente crema leggermente abrasivo. Successivamente sfregare l'intera area con abbondante acqua pulita e levigare nuovamente.

Pulizia giornaliera: Si consiglia un detergente non abrasivo.

Avvertenze

Non utilizzare detersivi/prodotti a base di candeggina, soda caustica e/o alcol etilico (ad esempio Lysoform o altri appositamente realizzati per la pulizia del WC) in quanto potrebbero danneggiare la vostra vasca. In caso di contatto risciacquare immediatamente con acqua.

In aggiunta si consiglia vivamente di non applicare la colorazione dei capelli all'interno della vasca in quanto può macchiare la superficie.

Important

- Please unwrap the bath and check it carefully to ensure it has not been damaged in handling or transport.
- Please check that all parts have been supplied.
- Assemble bath on a mat to protect against damage to bath surface.
- Please do not remove the old fixture before you unpack and inspect the new unit.
- Store the bath in a safe place until you begin installation to avoid damage.
- Any installation should be carried out by a qualified tradesman with knowledge of statutory plumbing requirements in your area.
- This product requires a two person lift – use proper lifting techniques.
- This installation guide does not include details of waste connection; final decision about installation of waste connection should be taken by a suitably qualified person.



Do NOT overtighten the waste as this may cause long term damage to the bath. We recommend to use a torque wrench to tighten the waste by using a torque force between 25 Nm and 50Nm.

Care and Maintenance

Repairing a scratch: If any scratches occur during installation these can be removed by rubbing with a 1500+ grit waterproof abrasive paper and water.

Re-polish the surface afterwards using a neutral automotive colour restorer or household metal polish. For best results limit sanding to the smallest possible area around the scratch.

It may be possible to polish very fine scratches away without using abrasive papers: scrubbing gently with a soft brush or plastic pad (not metal scouring pad) and a mildly abrasive cream cleaner. Afterwards scrub the whole area with plenty of clean water and re-polish as before.

Everyday cleaning: We recommend a non-abrasive bathroom cleaner.

Warning

Never use cleaners / bleach products, soda caustic and or ethyl alcohol (for example Lysoform or others specifically manufactured for WC bowl cleaning) as they may damage your bath. In case of contact rinse immediately with water.

In addition to these we strongly recommend that applying hair colouring is also not used over the bath as it may de-colour the bath.

IT SIMBOLOGIA
EN SYMBOLS



Operare con attenzione
Caution

IT SACCHETTO (viterie e accessori)
EN BAG (fasteners and accessories)

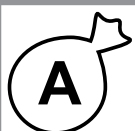

x4

IT UTENSILI PER IL MONTAGGIO
EN TOOLS REQUIRED FOR ASSEMBLY

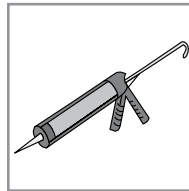
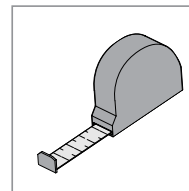
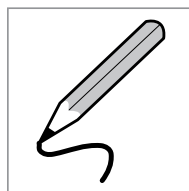

Per la siliconatura dei vari elementi
utilizzare silicone non acetico.

Don't use acetic silicone sealant for
waterproofing gaps and joints.

IT MODELLI VASCHE IN CLEARSTONE
EN CLEARSTONE MODELS BATHTUBS

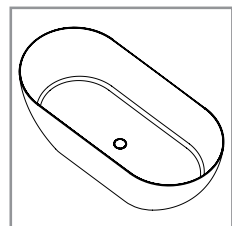

AREZZO
A1G 170x80cm

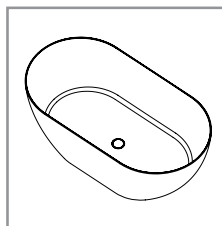

AREZZO
A1P 150x80cm

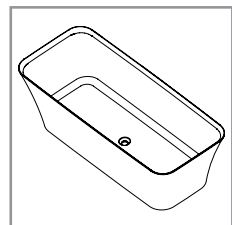

SIENA
A2G 180x75cm

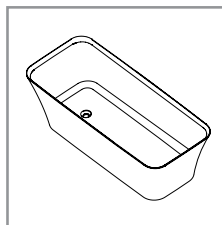

SIENA
A2P 150x75cm

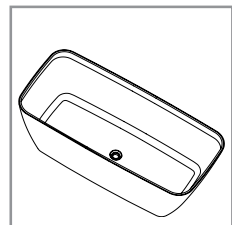

LUCCA
A4G 180x80cm

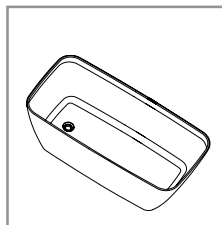

LUCCA
A4P 150x80cm

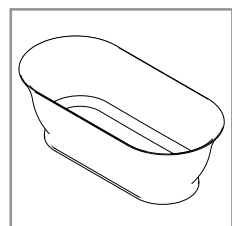

VOLTERRA
A3G 180x85cm

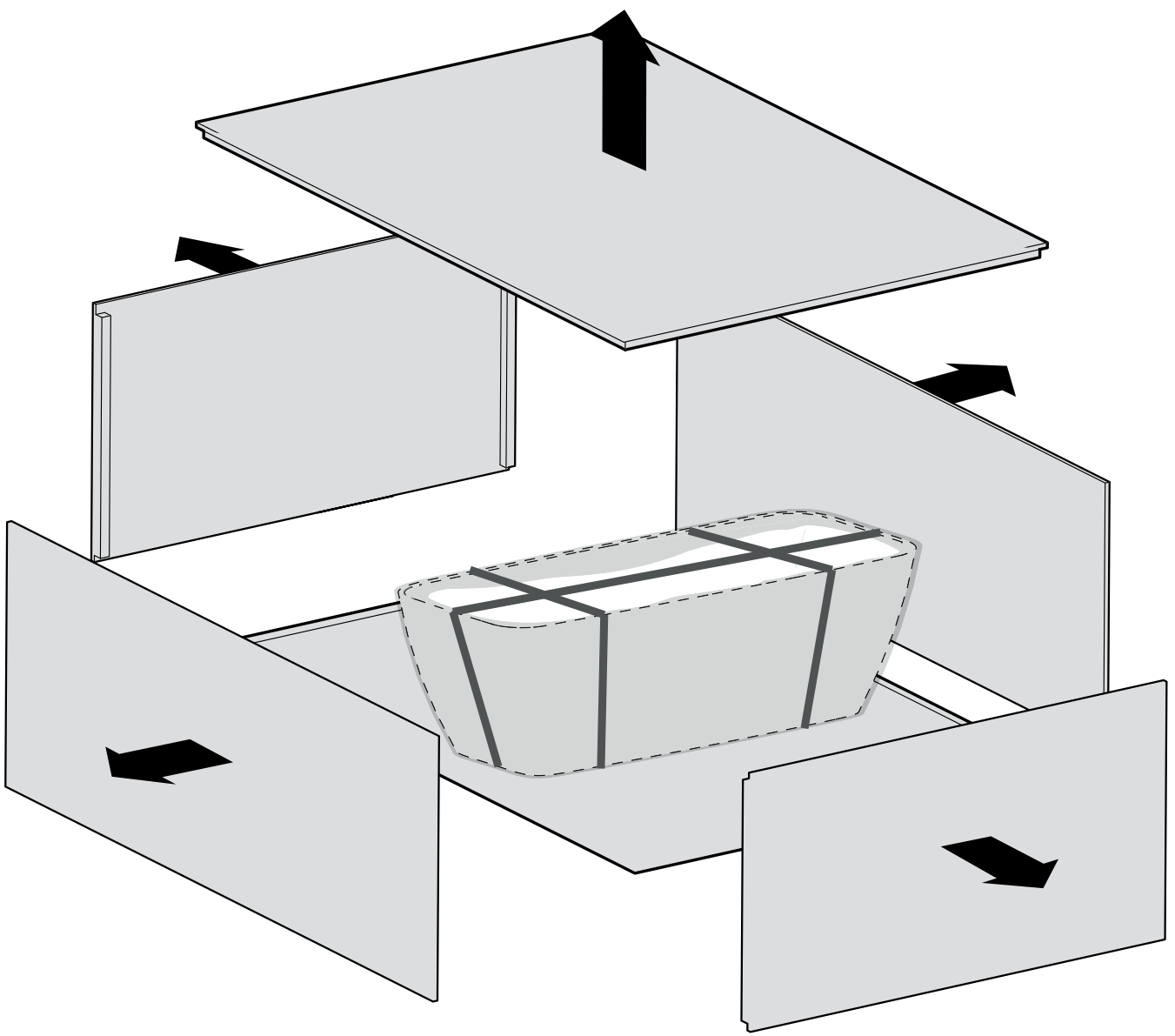
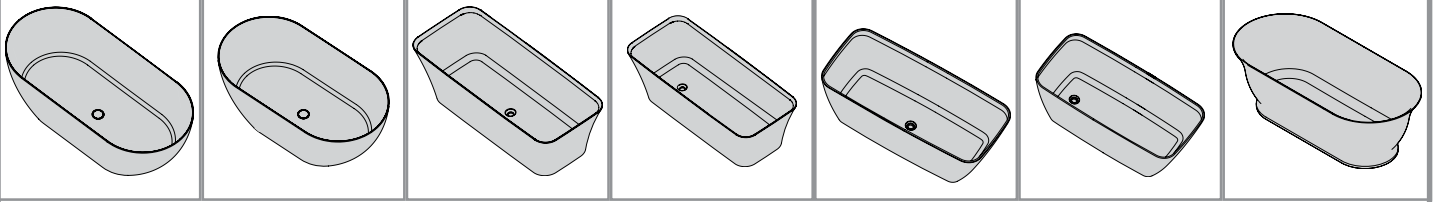

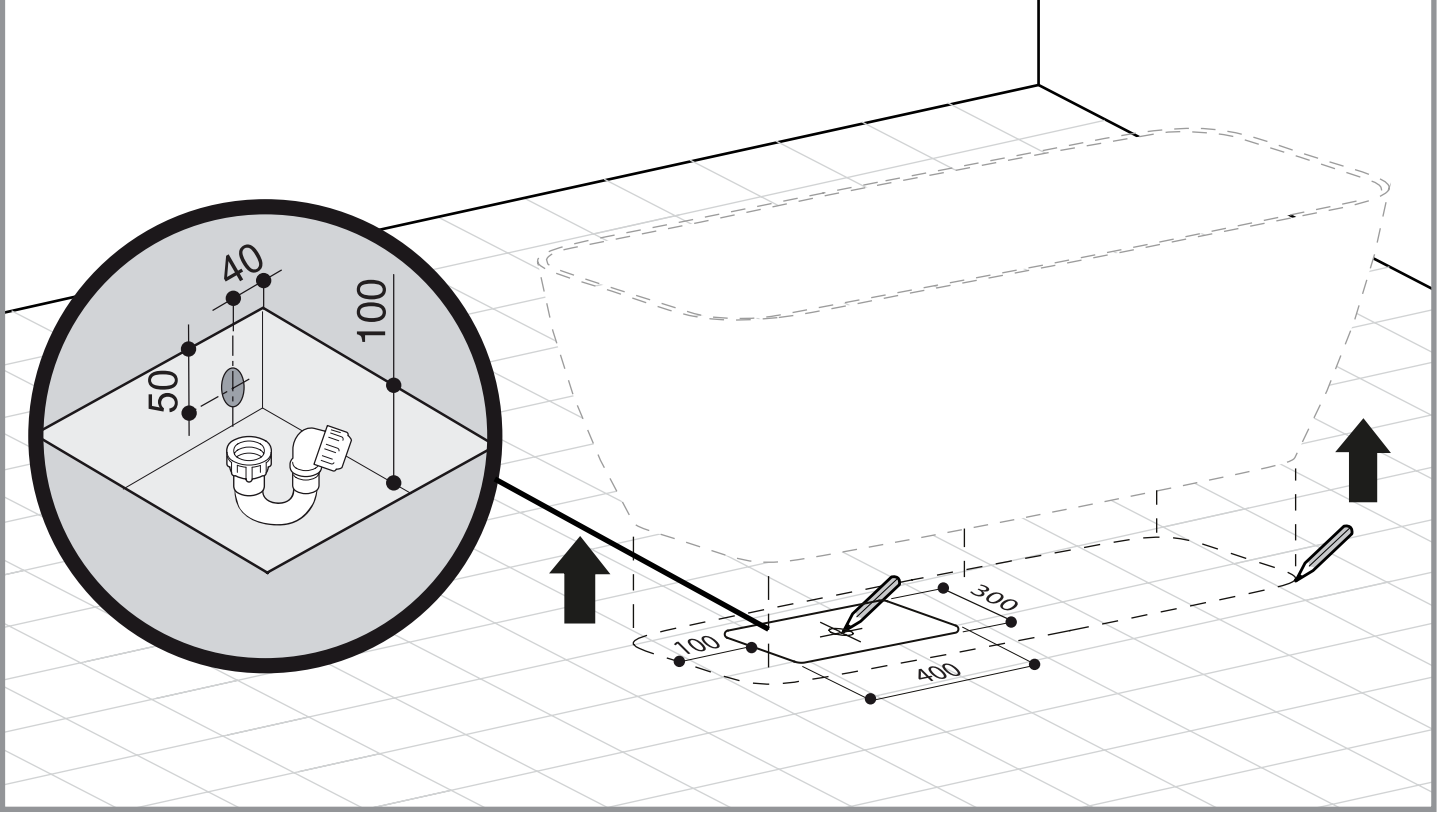
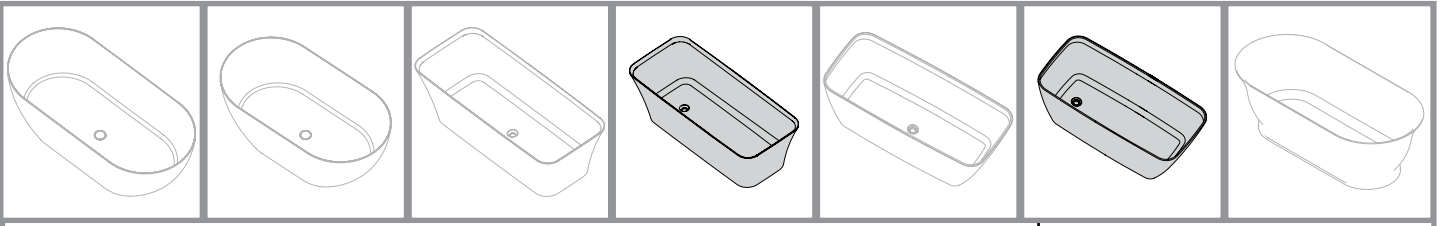
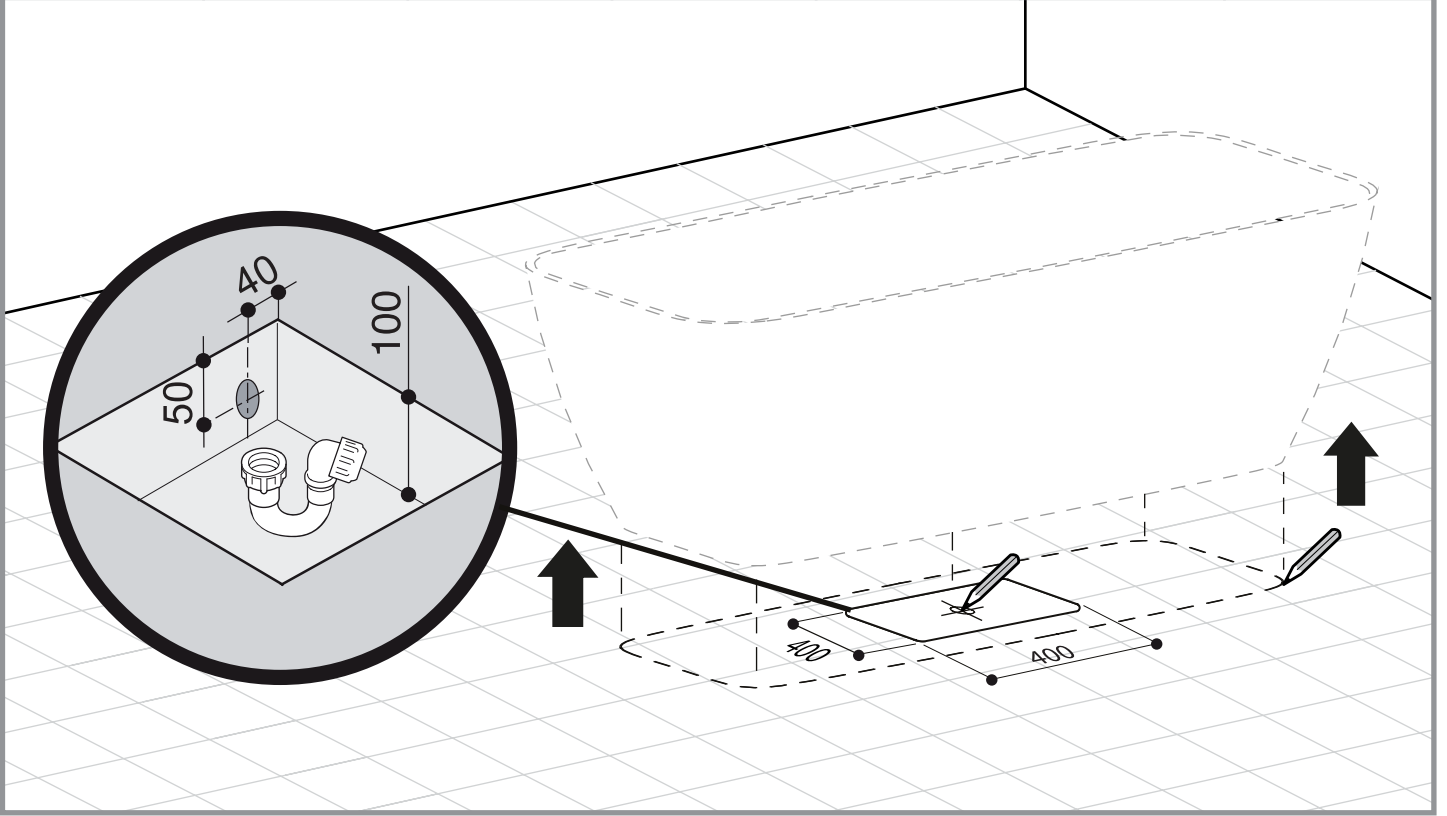
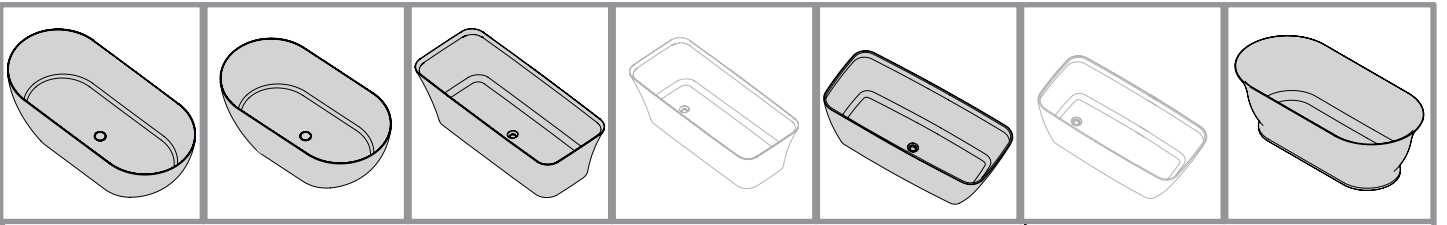

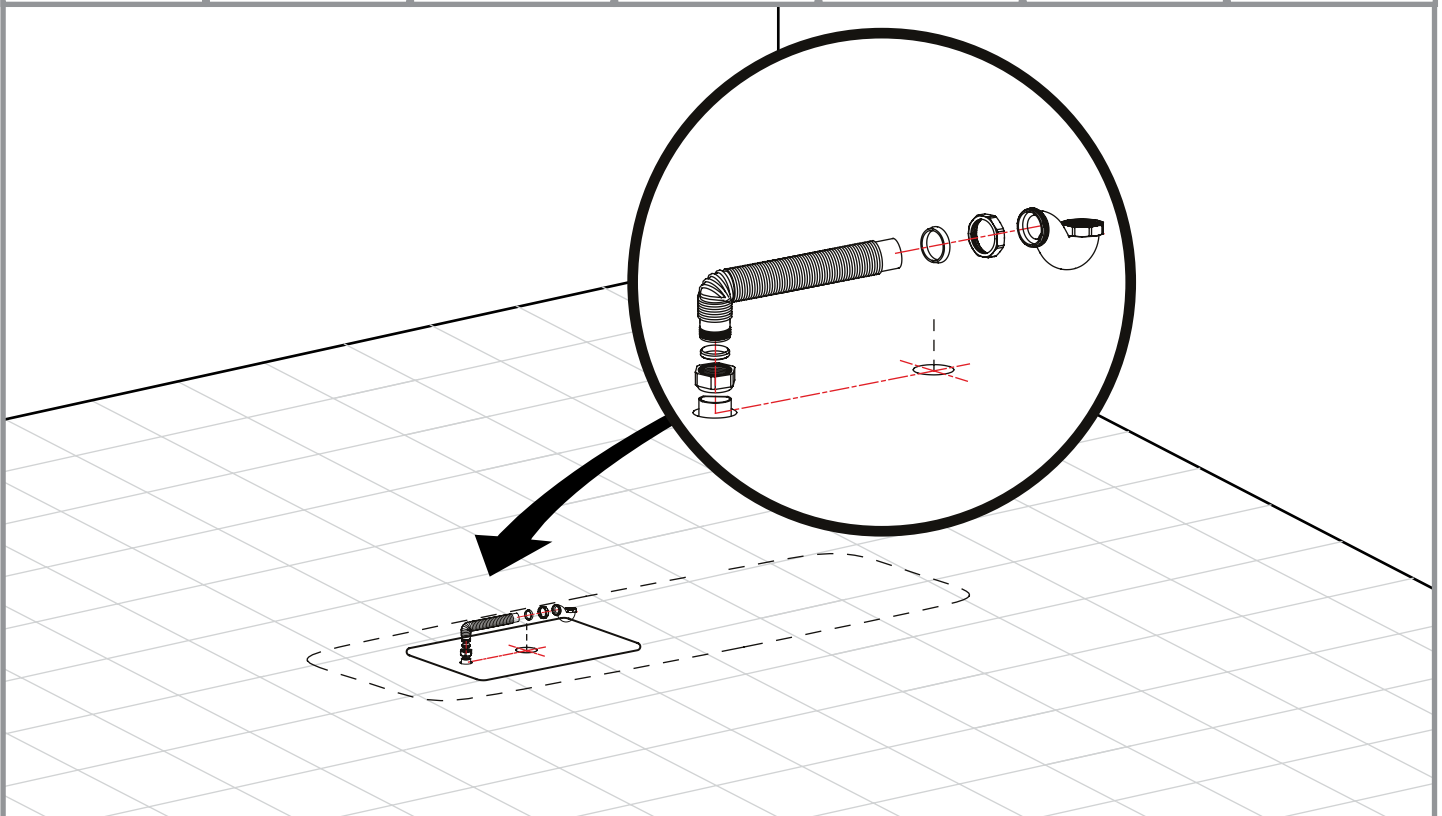
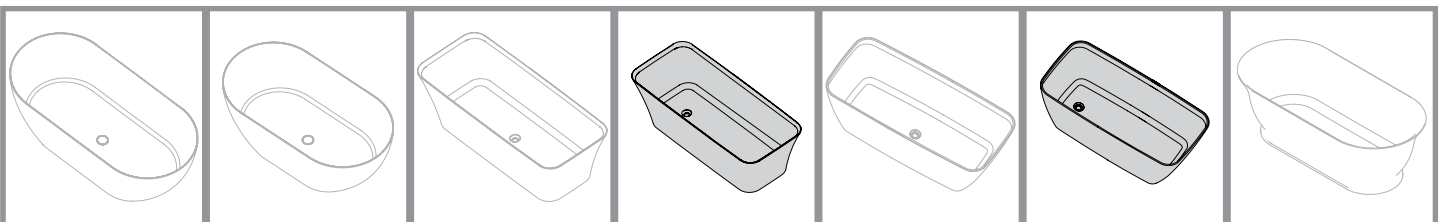
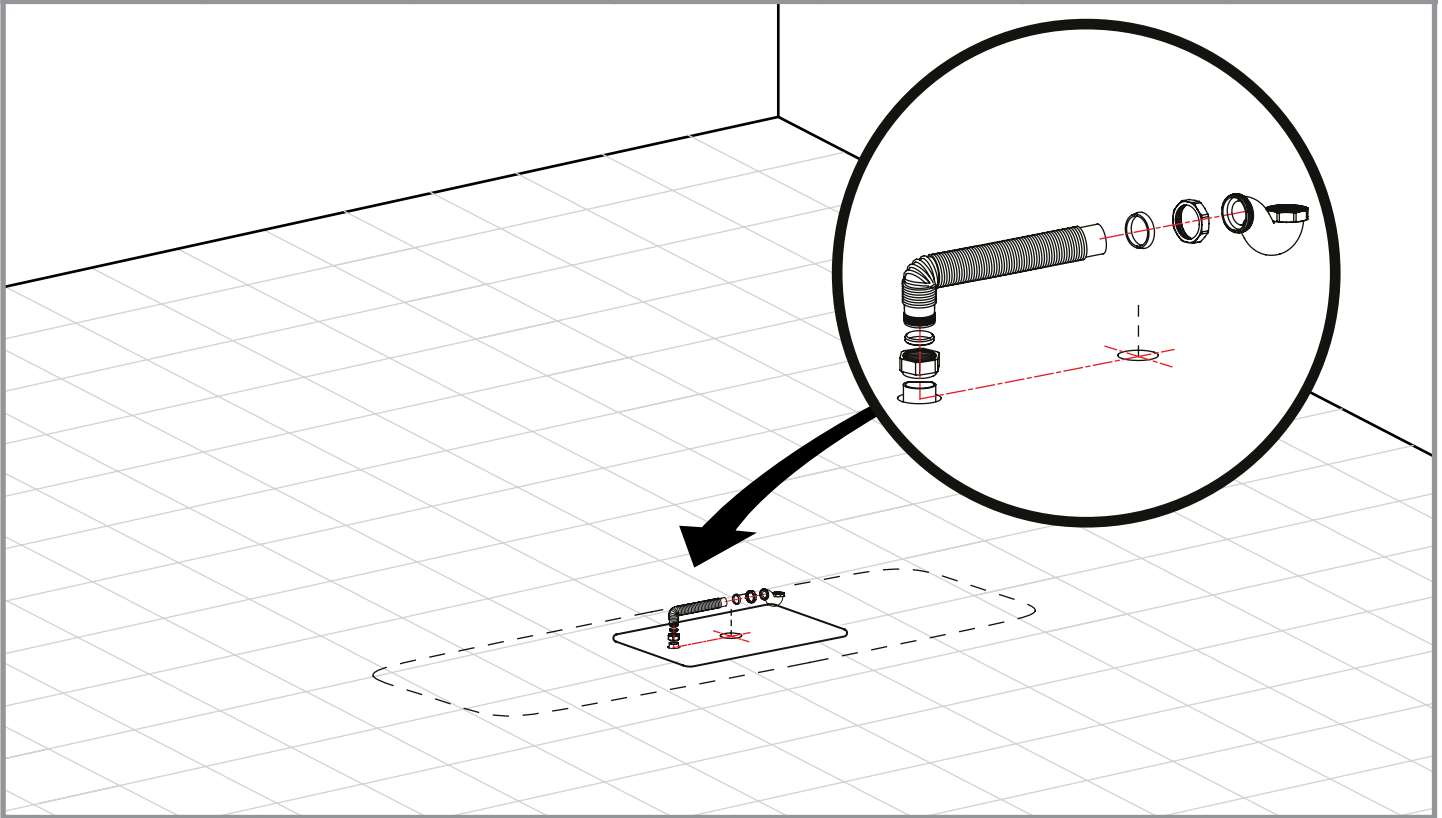
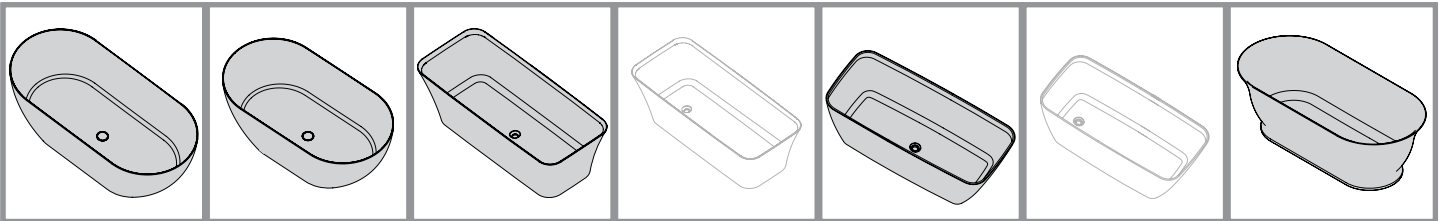

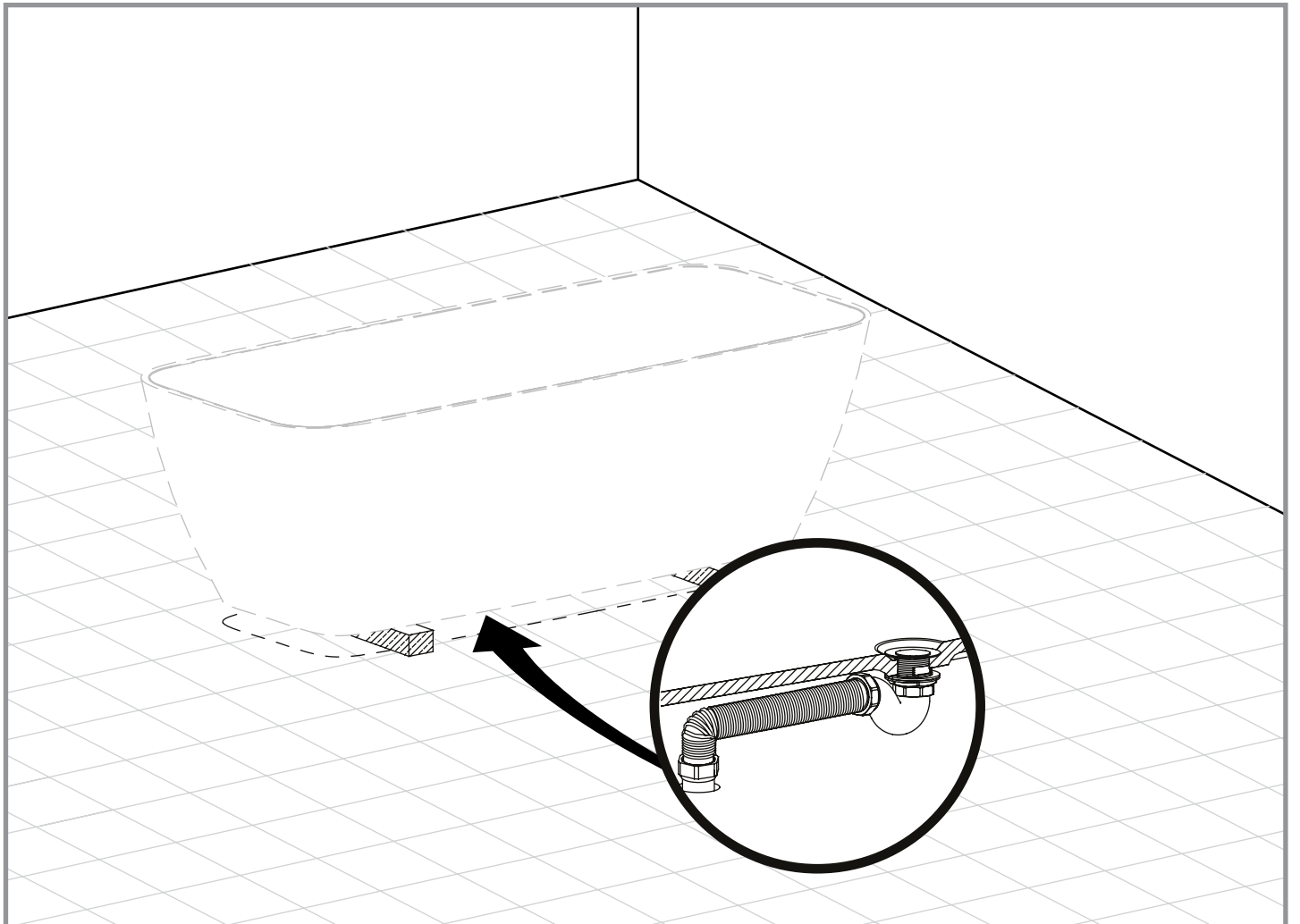
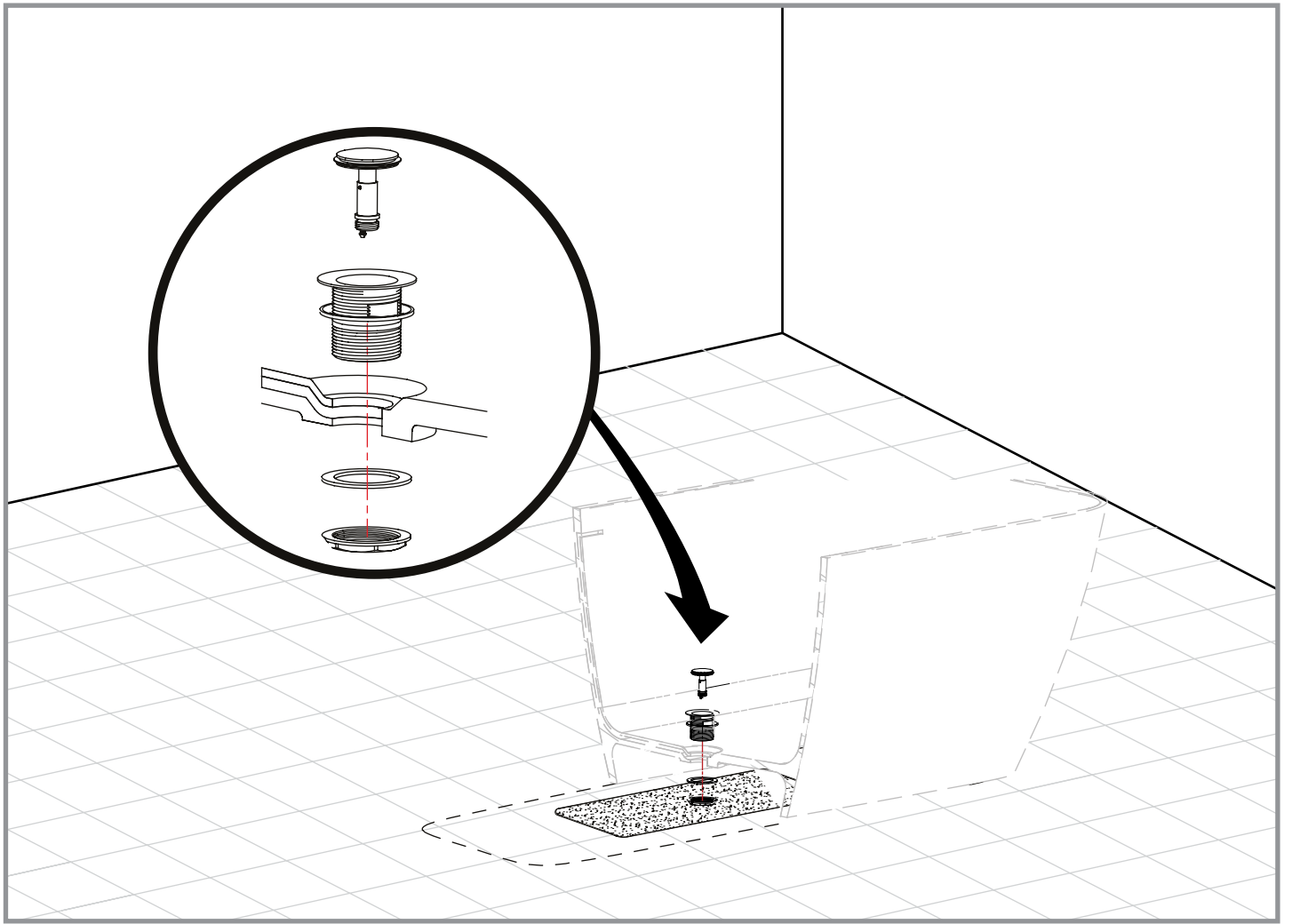

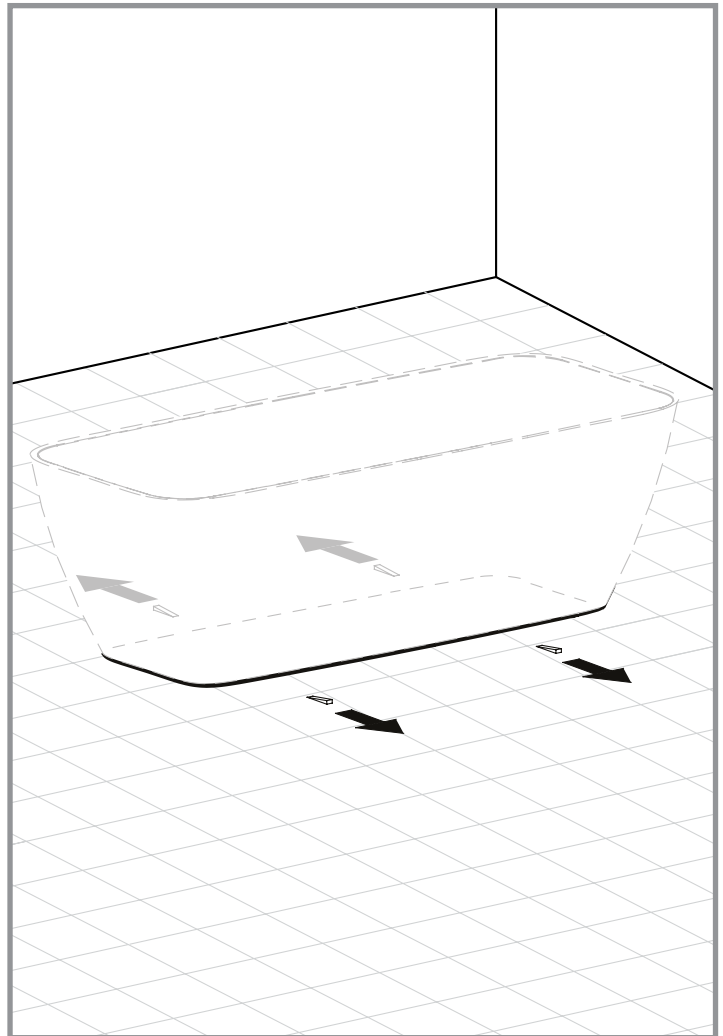
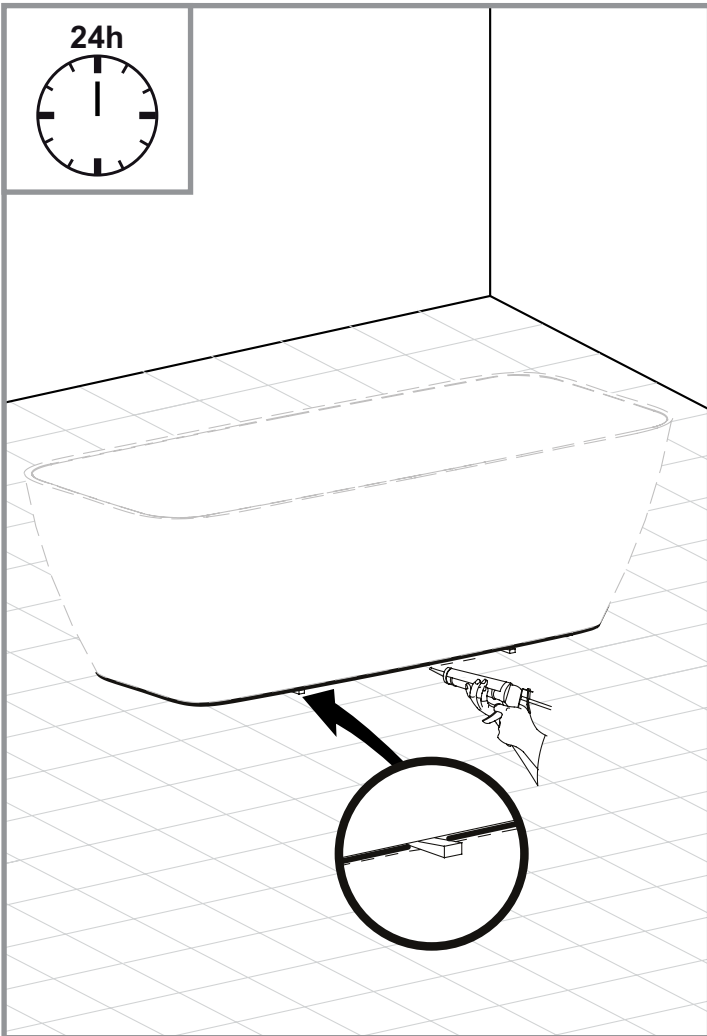
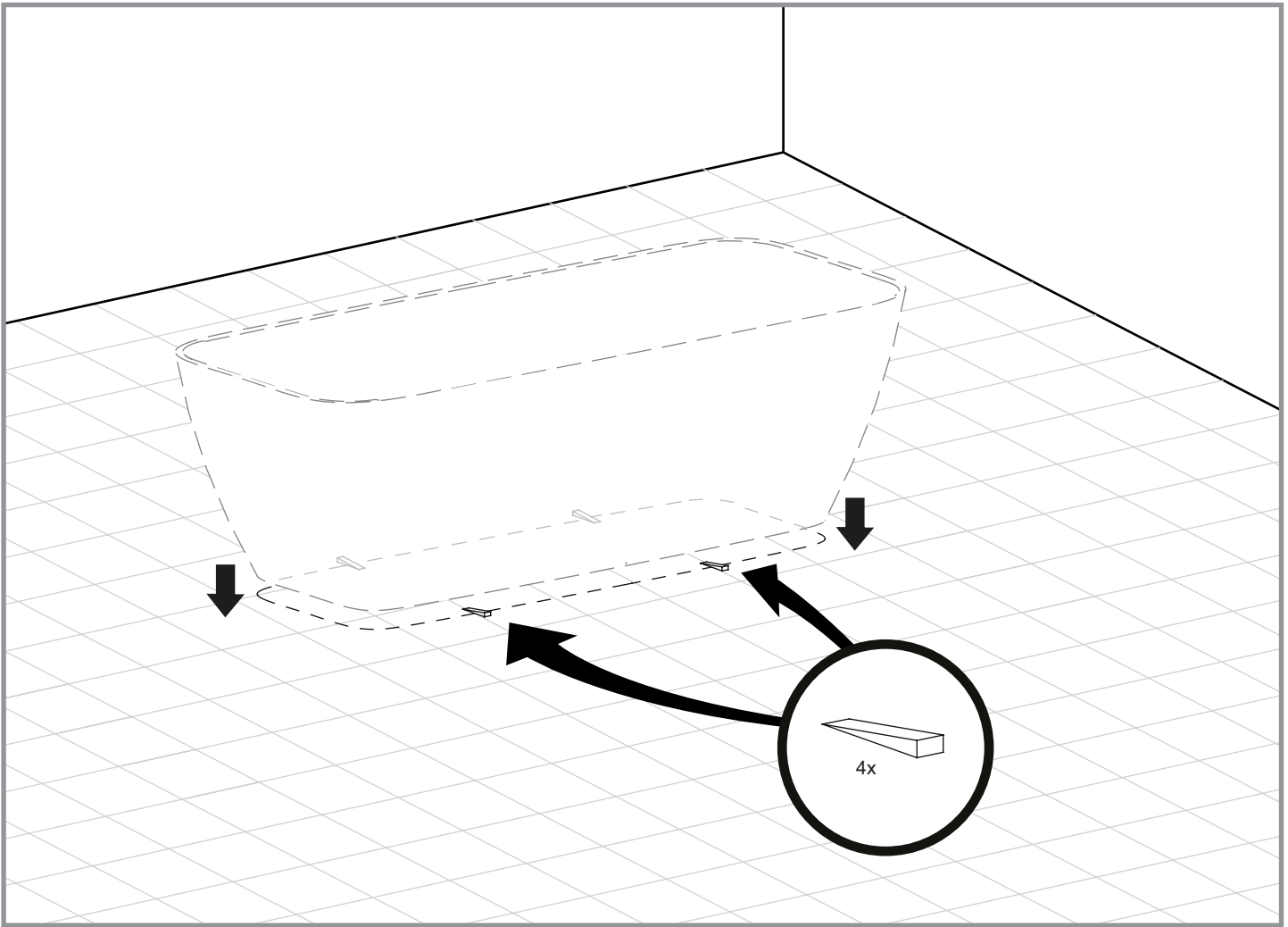

67101716700 (2016.01)

Teuco S.p.A.
Via Virgilio Guzzini, 2
62010 Montelupone (MC) - Italy
T. 0039-0733-2201
F. 0039-0733-220391
www.teuco.com
teuco@teuco.it

teuco