

ANGLE BEAD ABG, ABS, PABG & PB

Angle Bead is used to provide a true, straight corner which protects and reinforces a 2 or 3 coat plaster or render application in its most vulnerable area. In external applications and where there is regular exposure to moisture, heavy condensation, persistent damp or concern that drying out times may be extended, stainless steel or uPVC should be used.

- Larger wings are available for unusually thick plaster / render.
- Available in galvanised, stainless steel or uPVC.

MINI MESH MMG

Galvanised Mini Mesh Beads for internal thin-coat plaster application. Mini Mesh Bead is used to reinforce and protect one-coat finish of plaster on corners at its weakest point on internal walls and plasterboard. The Mini Mesh bead has a greater area of expanded metal therefore gives a better mechanical key.

- Available in galvanised only.

SKIM BEAD SBG

Skim Bead for use on plasterboard or aerated blocks. Designed for standard single coat plasterwork for internal thin-coat plaster application, used to reinforce and protect plaster on corners and reveals at its weakest points.

- Available in galvanised only.

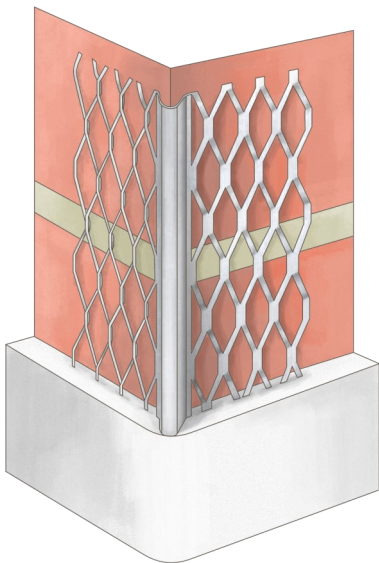

Please see the product table on the following page.



ABG



PB 2/3



PB 6/10

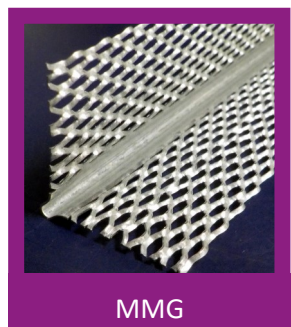

MMG



SBG

Code	Product	Product Dimensions		Plaster Depth (mm)	Box Qty.
		Bead Length (m)	Size (mm)		
Pre Galvanised Mild Steel					
STANDARD ANGLE BEAD					
ABG2.4	Standard Angle Bead	2.4	43 x 43	10	50
ABG3	Standard Angle Bead	3	43 x 43	10	50
WIDE WING ANGLE BEAD					
PABG2.4	Wide Wing Angle Bead	2.4	48 x 48	13	50
PAB3	Wide Wing Angle Bead	3	48 x 48	13	50
MINI MESH					
MMG2.4	Mini Mesh	2.4	27 x 27	3	50
MMG3	Mini Mesh	3	27 x 27	3	50
SKIM BEAD					
SBG2.4	Skim Bead	2.4	22 x 22	2 to 3	50
SBG3	Skim Bead	3	22 x 22	2 to 3	50
Stainless Steel					
STANDARD ANGLE BEAD - STAINLESS					
ABS3	Standard Angle Bead	3	50 x 50	16 to 20	50
uPVC					
UPVC ANGLE BEAD					
PB2/3	Angle Bead	2500	24 x 24	2 to 3	50
PB6/10	Angle Bead	2500	40 x 40	6 to 10	50
PB8/12	Angle Bead	2500	40 x 40	8 to 12	40
PB13/19	Angle Bead	2500	40 x 40	13 to 19	30

Plaster Stop provides a precise, clean edge to render where it butts up to other materials such as a door or window frame, reinforcing the edges of the plaster. In external applications and where there is regular exposure to moisture, heavy condensation, persistent damp or concern that drying out times may be extended, stainless steel or uPVC should be used.

- Available in galvanised or stainless steel.

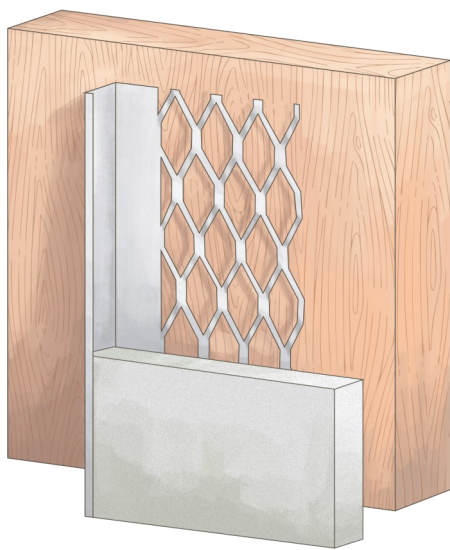

PSTC



PSG



PBPS 10/12

Code	Product	Product Dimensions		Plaster Depth (mm)	Box Qty.
		Bead Length (m)	Size (mm)		
Pre Galvanised Mild Steel					
THIN COAT PLASTER STOP					
PSTCG2.4	Thin Coat Plaster Stop	2.4	3	3	50
PSTCG3	Thin Coat Plaster Stop	3	3	3	50
PLASTER STOP					
PSG2.4X10	Plaster Stop	2.4	10	10	50
PSG2.4X13	Plaster Stop	2.4	13	13	50
PSG3X10	Plaster Stop	3	10	10	50
PSG3X13	Plaster Stop	3	13	13	50
PSG3X19	Plaster Stop	3	19	19	50
Stainless Steel					
PLASTER STOP - STAINLESS					
PSS3X13	Plaster Stop	3	13	13	50
PSS3X16	Plaster Stop	3	16	16	50
PSS3X20	Plaster Stop	3	20	20	50
uPVC					
UPVC PLASTER STOP					
PBPS6/8	Plaster Stop	2.5	45	6 to 8	50
PBPS10/12	Plaster Stop	2.5	45	10 to 12	50
PBPS15/17	Plaster Stop	2.5	45	15 to 17	50
PBPS20/22	Plaster Stop	2.5	45	20 to 22	50

Plasterboard Edge Bead is used to reinforce plasterboard edges by enclosing them in a protective steel enclosure. It is reversible therefore can be used with thin coat plaster or drylining paper tape.

- It is reversible therefore can be used with thin coat plaster or drylining paper tape.
- Available in galvanised only.

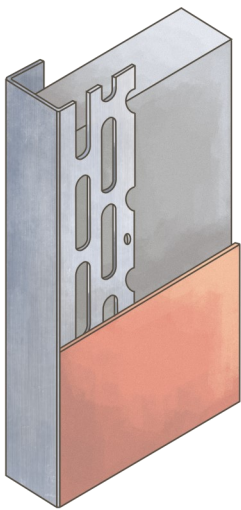

Code	Product	Product Dimensions		Plaster Depth (mm)	Box Qty.
		Bead Length (m)	Size (mm)		
Pre Galvanised Mild Steel					
EB3X10	Plasterboard Edge Bead	3	10	2 to 3	50
EB3X13	Plasterboard Edge Bead	3	13	2 to 3	50
EB3X15	Plasterboard Edge Bead	3	15	2 to 3	50

External Render Stop Bead is predominantly used to form a neat bell shaped edge at the bottom of an external render finish, thus protecting the edge and acting as a run-off for when rainfall occurs. Use on traditional wet 2 or 3 coat plaster application. Galvanised product to be used in sheltered areas only, stainless steel for all other areas including coastal.

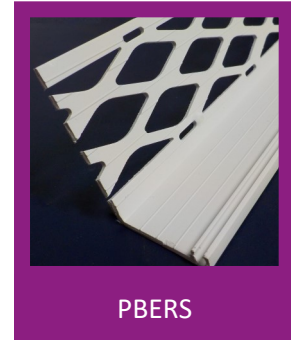
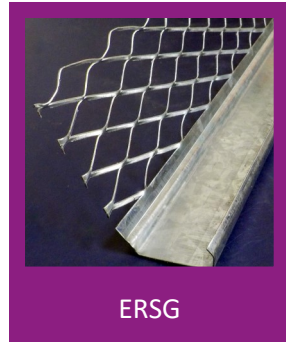
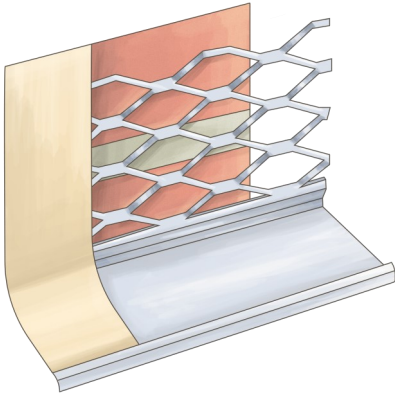

Code	Product	Product Dimensions		Plaster Depth (mm)	Box Qty.
		Bead Length (m)	Size (mm)		
Pre Galvanised Mild Steel					
EXTERNAL RENDER STOP					
ERSG2.4	External Render Stop	2.4	25	16 to 20	50
ERSG3	External Render Stop	3	25	16 to 20	50
Stainless Steel					
EXTERNAL RENDER STOP - STAINLESS					
ERSS3	External Render Stop	3	25	16 to 20	50
ERSS3x20	External Render Stop	3	20	16 to 20	50
uPVC					
UPVC EXTERNAL RENDER STOP					
PBERS6/12	External Render Stop	2.5	12	6 to 12	50
PBERS12/22	External Render Stop	2.5	25	12 to 22	50

Movement Bead is used to overcome movement tolerances in plaster and render finishes thus minimising cracking in finished coat. It can also be used to act as a stop barrier for when a change in finish is required or type of render finish.

- Available in galvanised or stainless steel.

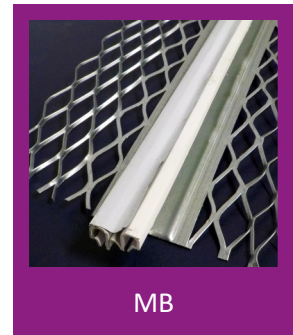
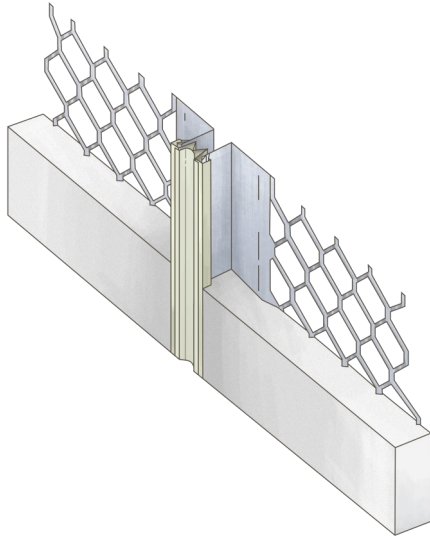

www.tecoproducts.co.uk

Code	Product	Product Dimensions		Plaster Depth (mm)	Box Qty.
		Bead Length (m)	Size (mm)		
Pre Galvanised Mild Steel					
MB3X12	Movement Bead	3	12	12	10
Stainless Steel					
MBS3X16	Movement Bead	3	16	16	10

ARCHITRAVE FEATURE BEAD ARFB

Architrave Feature Bead is for use on traditional wet 2 / 3 coat plaster application. It is used to form a decorative shadow line at plaster edge, at door and window reveals and other joinery features. It can also be used to act as a neat divide between differing wall finishes.

- Available with or without a return flange - (engaging or abutting).
- Available in galvanised only.

Code	Product	Product Dimensions		Plaster Depth (mm)	Box Qty.
		Bead Length (m)	Size (mm)		
Galvanised Steel					
ARCHITRAVE FEATURE BEAD - ENGAGING					
ARFB3X13E	Architrave Feature Bead - Engaging	3	13	13	50
ARCHITRAVE FEATURE BEAD - ABUTTING					
ARFB3X13A	Architrave Feature Bead - Abutting	3	13	13	50

DRYWALL FEATURE BEAD DWFB

Drywall Feature Bead is used to form a decorative shadow line at plaster edge, at door and window reveals and other joinery features on thin coat plaster application only.

- Available with or without a return flange - (engaging or abutting).
- Available in galvanised only.

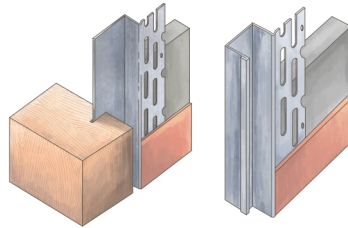

Code	Product	Product Dimensions		Plaster Depth (mm)	Box Qty.
		Bead Length (m)	Size (mm)		
Galvanised Steel					
DRYWALL FEATURE BEAD - ENGAGING					
DWFB3E	Drywall Feature Bead - Engaging	3	20	2 to 3	50
DRYWALL FEATURE BEAD - ABUTTING					
DWFB3A	Drywall Feature Bead - Abutting	3	15	2 to 3	50

ARCH BEAD PBAR

Arch Bead is a flexible dry lining bead used for reating decorative plaster curves and arches.

Code	Product	Product Dimensions		Plaster Depth (mm)	Box Qty.
		Bead Length (m)	Size (mm)		
uPVC					
ARCH BEAD					
PBAR	Arch Bead	2.5	24	2 to 3	50

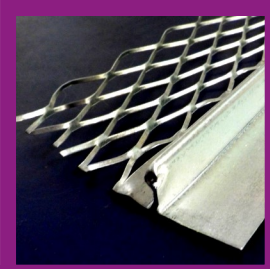

ARFB Engaging

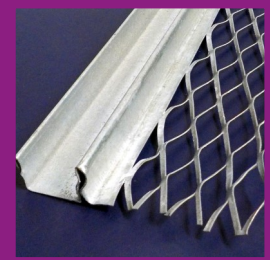

ARFB Abutting

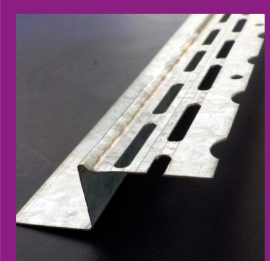

DWF Engaging

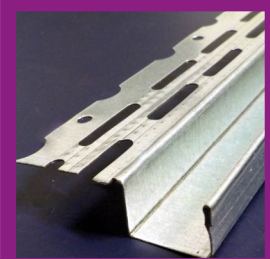

DWF Abutting



PBAR