

- OPERATING DATA -

ELECTRIC PUMP TYPE	MOTOR RATING	R.P.M.	DELIVERY	CAPACITY m ³ /h													
				CAPACITY l/sec													
				HEAD m													
				0	36	54	72	90	108	144	180	216	252	288	324		
PTS 2.2 - 80	2.2	1450	80	0	10	15	20	25	30	40	50	60	70	80	90		
PTS 3 - 80	3			10.5	9.2	8.1	6.8	5.1									
PTS 4 - 80	4			12.8	11.3	10.4	9.1	7.4	5.3								
PTS 15 - 80	15	2900	100	0	10	15	20	25	30	40	50	60	70	80	90		
PTS 18.5 - 80	18.5			40	37.3	36.1	34.7	32.7	30.7	25.2							
PTS 4 - 100	4			45.4	43	41.5	40.2	38.4	36.2	30.8							
PTS 5.5-100	5.5	1450	100	0	10	15	20	25	30	40	50	60	70	80	90		
PTS 7.5-100	7.5			9.8	9.5	9	8.4	7.3	5.8								
PTS 9-100	9			12	11.6	11.2	10.6	9.7	8.3	3.7							
PTS 11 - 150	11	150	150	0	10	15	20	25	30	40	50	60	70	80	90		
PTS 15 - 150	15			14.7	14.3	14	13.4	12.6	11.3	6.7							
PTS 18.5 - 150	18.5			16.1	15.7	15.4	14.9	14.1	12.7	8.7							
				0	10	15	20	25	30	40	50	60	70	80	90		
				15.2	14.7	14.4	14	13.7	13.3	12.3	11.1	9.4	7.1	4.2			
				18.6	18.1	17.8	17.4	17	16.7	15.6	14.2	12.8	10.8	8	4.8		
				21.5	20.9	20.7	20.2	19.9	19.4	18.5	17.1	15.7	13.7	11	8		

- PERFORMANCES RANGES -

"PTS.. 80 "

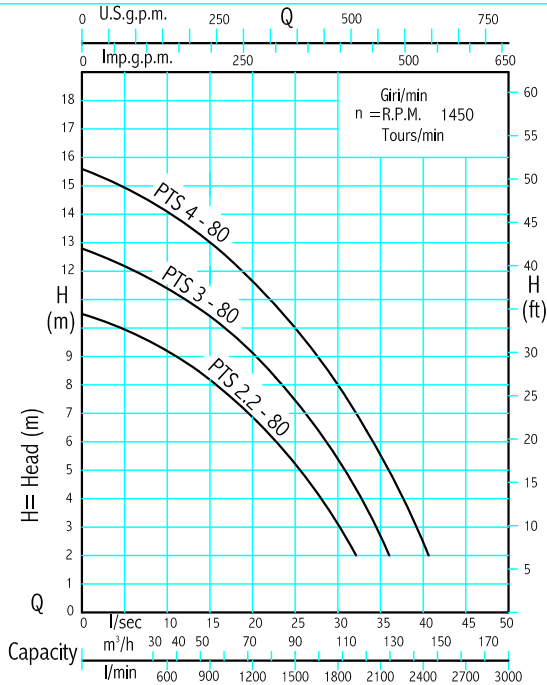

"PTS.. 80 "

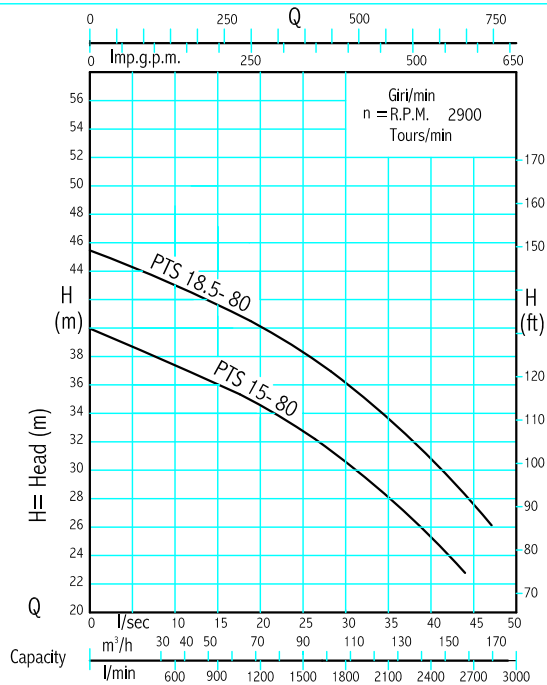

"PTS.. 100 "

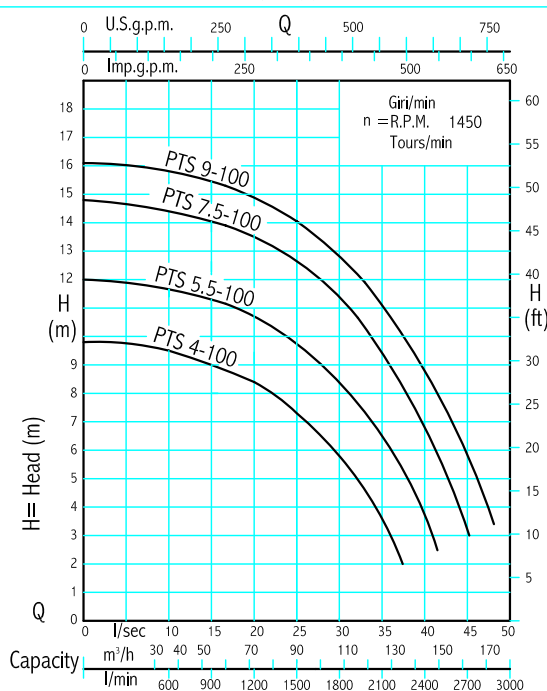

"PTS.. 150 "

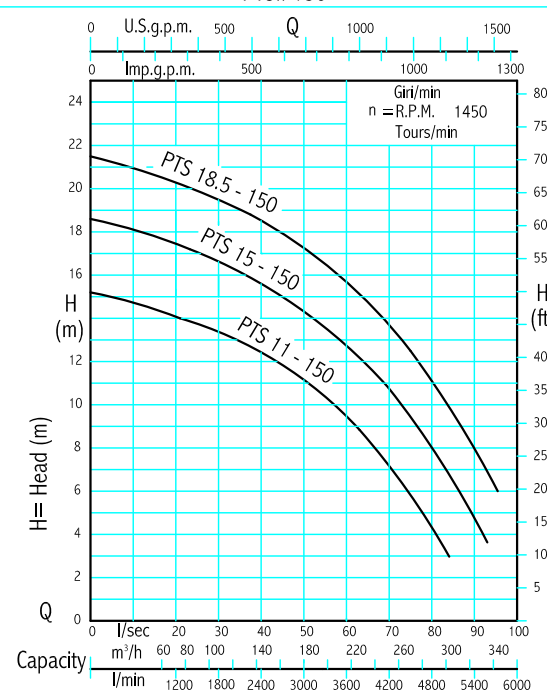

Curves established for liquid density 1 - viscosity 1 mm²/s- temperature 20° C.

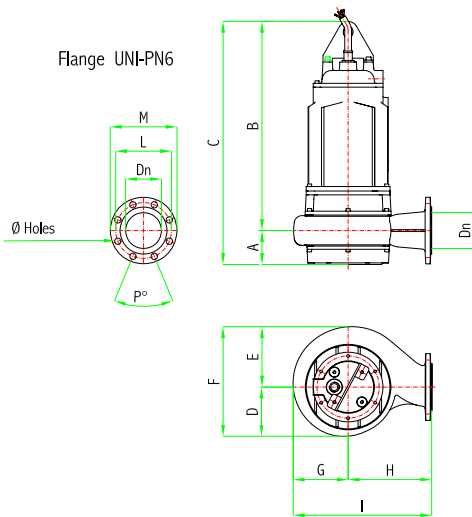

PTS 5.5 - 100
 PTS 7.5-100
 PTS 9-100
 PTS 11 - 150
 PTS 15 - 150
 PTS 18.5 - 150

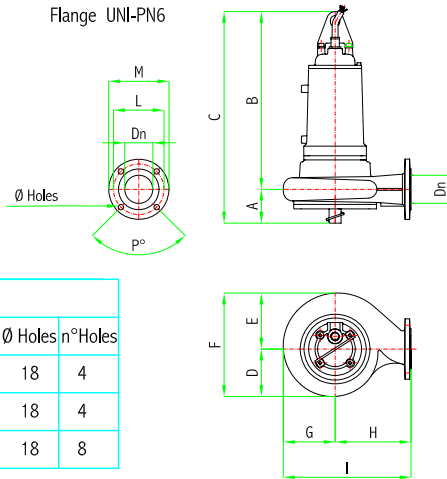

PTS 2.2 - 80
 PTS 3 - 80
 PTS 4 - 80
 PTS 4 - 100
 PTS 15 - 80
 PTS 18.5 - 80

Flange					
Dn	L	M	P°	Ø Holes	n°Holes
80	150	190	90°	18	4
100	170	210	90°	18	4
150	225	265	45°	18	8

ELECTRIC PUMP TYPE	OVERALL DIMENSIONS mm.										Weight kg
	Dn	A	B	C	D	E	F	G	H	I	
PTS 2.2 - 80	80	107	564	671	150	177	327	163	239	402	73
PTS 3 - 80			75								
PTS 4 - 80			76								
PTS 15 - 80											
PTS 18.5 - 80											
PTS 4 - 100	100	108	570	677	155	190	345	173	263	436	87
PTS 5.5-100			121								
PTS 7.5-100			127								
PTS 9-100			132								
PTS 11 - 150	150	150	805	955	197	257	454	226	340	566	206
PTS 15 - 150			219								
PTS 18.5 - 150			225								

ELECTRIC PUMP TYPE	50 Hz - THREE-PHASE- MOTOR FEATURES - VOLTAGE RATING 400 V ±10%	MOTOR RATING	WINDINGS	ABSORPTION	R.P.M.	CAVO ALIMENTAZIONE	FEEDING CABLE	CABLE D'ALIMENTAZIONE	START
		kW	V	A (400V)	n	n° cables	n° of wires x size - mm²	cable length (m)	direct Δ-Δ
PTS 2.2 - 80		2.2	230-400	5.3	1420	1	9 x 1.5	8	Δ
PTS 3 - 80		3		6.8	1420				Δ
PTS 4 - 80-100		4		9.1	1405				Δ Δ-Δ
PTS 15 - 80		15	400-690	31.2	2920		9 x 4		Δ Δ-Δ
PTS 18.5 - 80		18.5		36.5	2930				Δ Δ-Δ
PTS 5.5-100		5.5		12.5	1430		9 x 2.5		Δ Δ-Δ
PTS 7.5-100		7.5		15.8	1440				Δ Δ-Δ
PTS 9-100		9	19	1440	Δ Δ-Δ				
PTS 11 - 150		11	23.5	1450	9 x 4		Δ Δ-Δ		
PTS 15 - 150		15	30	1450			Δ Δ-Δ		
PTS 18.5 - 150		18.5	36	1450			Δ Δ-Δ		



STANDARD FEATURES

Asynchronous threephase electric motors with squirrel cage rotor.
 N.3 thermic probes installed in the stator winding.
 In case the temperature exceeds 132°C to cut out power.
 Protection" IP 68".
 "F" class insulation.
 Max submergence depth: 20 m.
 Max solid content in the liquid: 12%.
 Submersible H07-RN-F neoprene cable.
 Fluid pH 5 - 12.
 Max temperature of pumped fluid: 40°C.
 Continuous service.

ACCESSORIES

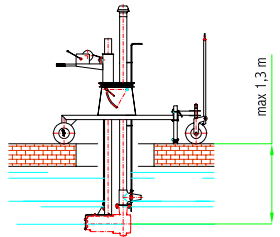
ELECTRIC PUMP TYPE	Support frame	Support frame	Duck-Foot pedestal	Duck-Foot pedestal	Trolley
	TSV	TSO	FCH	FCV	
PTS 2.2 - 80	TSV 80	TSO 80	FCH 80-80	FCV 80-80	CRP 100
PTS 3 - 80					
PTS 4 - 80					
PTS 4 - 100	TSV 100	TSO 100	FCH 100-100	FCV 100-100	CRP 100
PTS 5.5-100					
PTS 7.5-100					
PTS 9-100	TSV 80	TSO 150	FCH 80-80	FCV 80-80
PTS 15 - 80					
PTS 18.5 - 80					
PTS 11 - 150					
PTS 15 - 150	TSV 150		FCH 150-150	FCV 150-200
PTS 18.5 - 150					

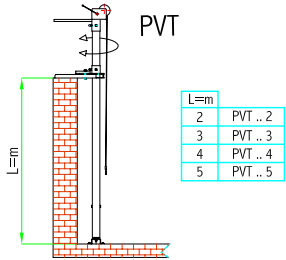
ELECTRIC PUMP TYPE	Motor bracket	Motor bracket	Spacer	Hoist winch and rail pipe	Hoist and winch
	SFO	SFV	PT	PVT	PV
PTS 2.2 - 80	SFO 80	SFV 80	PT 80		PV 80
PTS 3 - 80					
PTS 4 - 80					
PTS 4 - 100	SFO 100	SFV 100	PT 100	PVT 100 /..	PV 100
PTS 5.5-100					
PTS 7.5-100					
PTS 9-100	SFO 150	SFV 150	PT 150	PVT 150 /..	PV 150
PTS 15 - 80					
PTS 18.5 - 80					
PTS 11 - 150					
PTS 15 - 150					
PTS 18.5 - 150					

HORIZONTAL

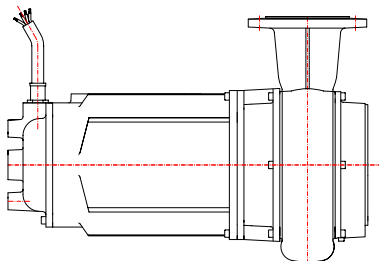

VERTICAL

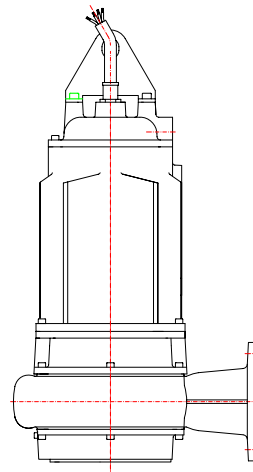

POSSIBLE INSTALLATIONS

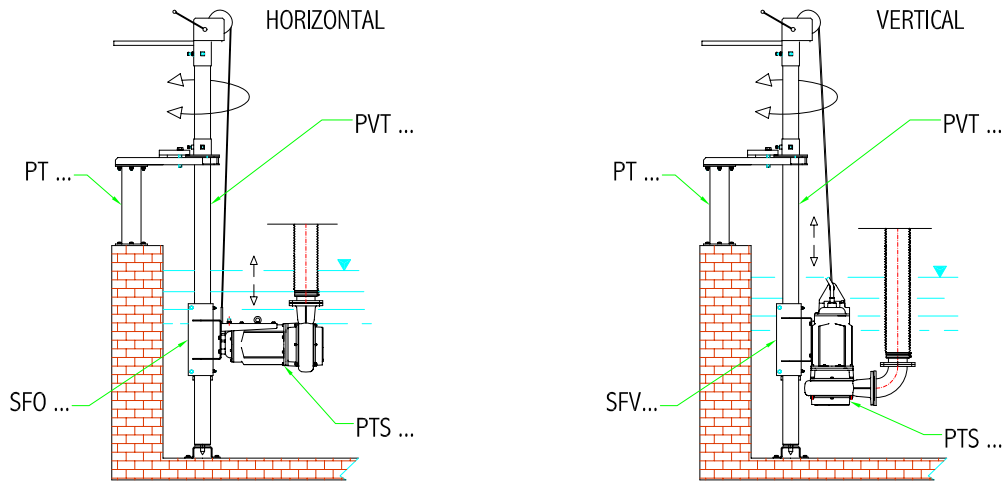

DUCK-FOOT PEDESTAL FOR AUTOMATIC COUPLING

