

ROLLING DOOR SYSTEM



SKD



R type

Door Weight	Max. 30 kg/Door
Door Thickness	28.4-36 mm
Door Width	695 mm or 790 mm
Door Height	1940 mm

Features

- Minimum opening clearance - 1/3 of ordinary swing doors.
- Easy use for the disabled: No need to step back to open the door.

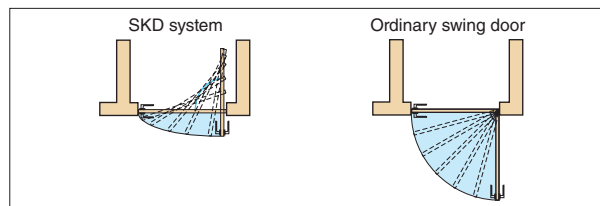

ARCHITECTURAL DOOR HARDWARE

ROLLING DOOR SYSTEM

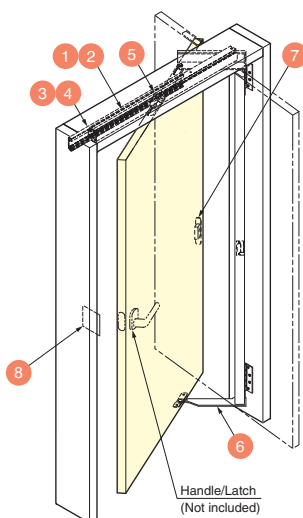

Adjustment of Door Height

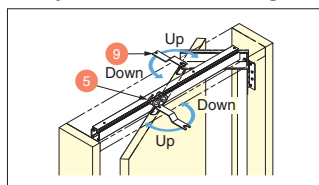

Adjustable height: ± 6 mm

Adjustment of Arm Parts

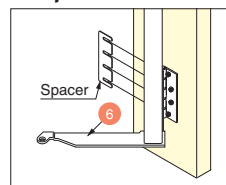

Adjustable length: 2 mm off from Frame

Adjustment of Retaining Force

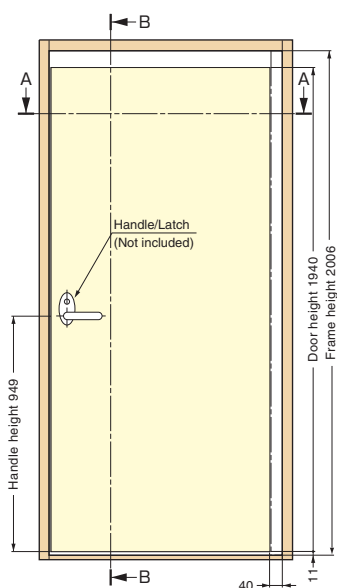
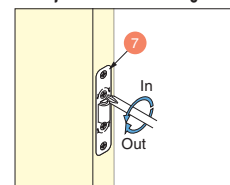

A-A Section

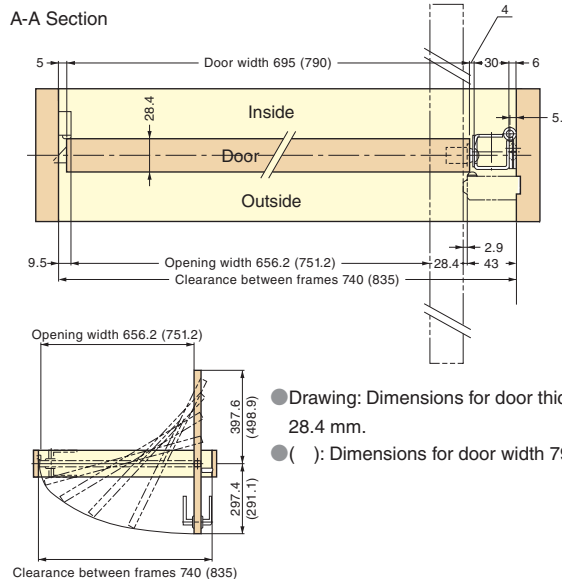

- Drawing: Dimensions for door thickness 28.4 mm.
- (): Dimensions for door width 790 mm.

B-B Section

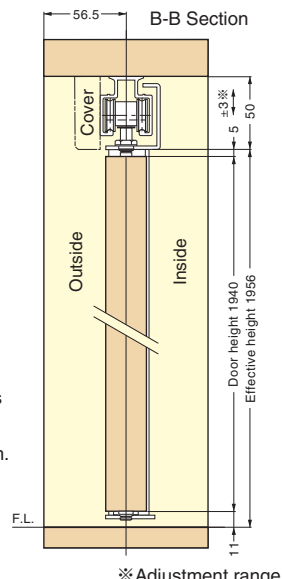

※ Adjustment range