

Maintenance-friendly foundations with
Steni Terra

FOUNDATION PANEL

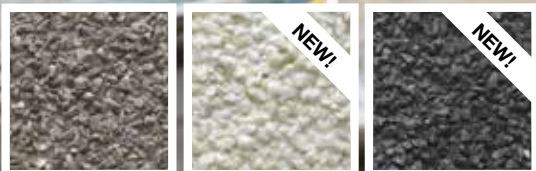

Building knowledge

steni[®] Terra



Steni Terra foundation panels have a surface of natural stone, making them both attractive and durable – year after year. The natural hues also harmonise well with other colours and surfaces.

The unique stone core construction of Steni Terra foundation panels makes them the most robust and easy to clean panels on the market.

These fibreglass-reinforced polymer composite panels will last for many years and give you the best value for money.

Steni Terra panels are installed as ventilated cladding, which has obvious advantages:

- Foundation walls stay dry
- Frost weathering and the formation of mould and fungus are reduced
- The foundation wall's insulating capacity is enhanced



Corrosion-resistant, stainless steel screws (A4) and EPDM joint tape are available in three colours (grey, white and black).

Product description

Panel size: 595/1,195 x 2,395 mm
Thickness: approx. 5 mm
Weight per m²: approx. 9.5 kg
Standard colours:



Grey

White

Black

NOTE! Panels with different production dates/batch numbers may vary slightly in colour. We therefore recommend that orders are not split up. If you need to order additional panels, make sure you finish an entire wall.

Areas of use

Foundation walls, garages, outbuildings, windbreaks, and more!

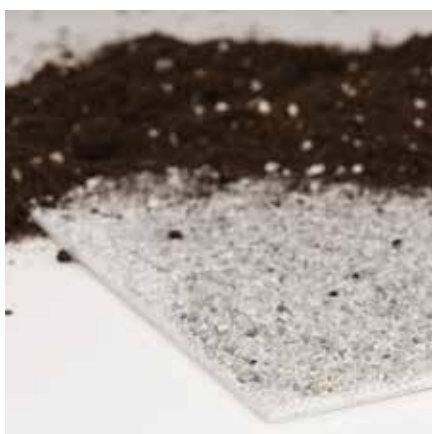

LIGHT: Only 9.5 kg per m²

EASY TO CLEAN: You can use a pressure washer.

VENTILATED FAÇADE: Foundation walls stay dry!

ADVANTAGES

100% IMPERMEABLE

Can be submerged in water.

FROST-PROOF

Our panels can withstand extreme outdoor temperatures.

LONG LIFESPAN

25-year warranty.

STURDY AND IMPACT RESISTANT

Suitable for exposed locations.

EASY TO CLEAN

You can use a pressure washer. Read more about cleaning Steni panels at www.steni.co.uk

EASY INSTALLATION

Mounted horizontally on your existing foundation wall.

LIGHT

Only 9.5 kg per m²

YOU NEED:

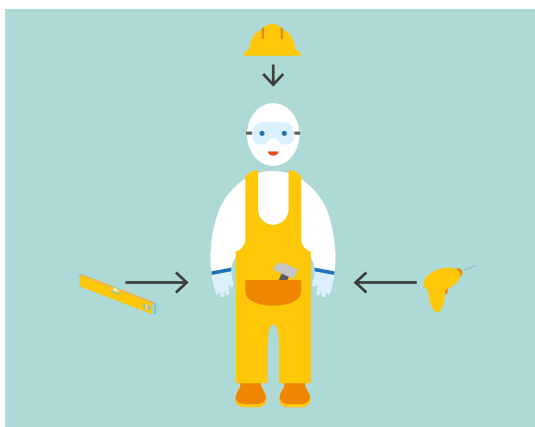

Recommended protective equipment: Safety glasses, gloves, ear defenders, dust mask, safety shoes and helmet.

Other materials: Pressure-treated battens (23 x 73 mm), proper fixing materials for your foundation wall, diamond drill bit (Ø5 mm) diamond-coated cutting disc, EPDM joint tape, staples and Steni Terra screws.

INSTALLATION

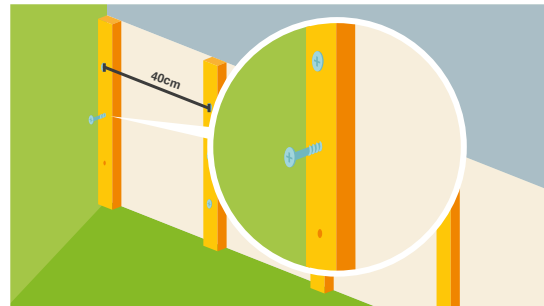

Screw battens directly on the foundation wall 40 cm apart, measured from centre to centre of the battens.



Staple the EPDM joint tape to the battens. The joint tape should cover the entire batten.

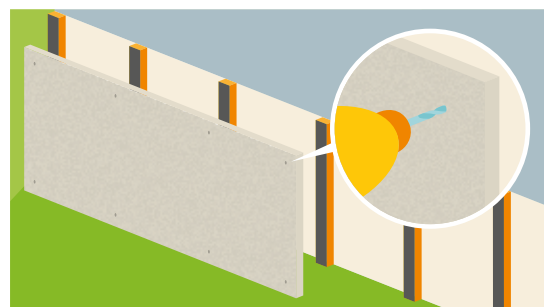

Cut and pre-drill the panel from the back.

Screw distance min. 15 mm from the edge of the panel, max. 300 mm between the screws on the battens.

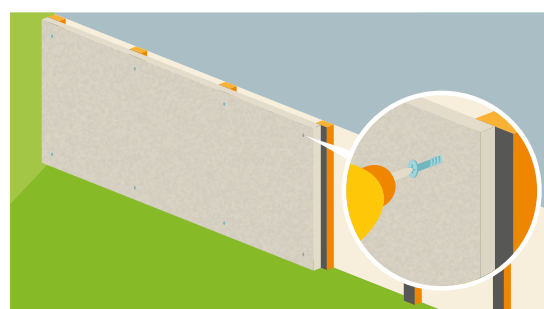

Use Steni Terra screws to fasten the panel to the EPDM-covered battens.



Leave 4-6 mm of space between the panels.

For good ventilation, ensure that there is a sufficient opening at the top and bottom, with an 8-10 mm air gap.

Watch our installation film on www.steni.co.uk

40^y

DURABILITY



EXPRESSION



ENVIRONMENT



SUPPORT

Façade panels since 1965

The original Steni façade panel was developed in Sandefjord, and introduced in the Norwegian market in 1965. Since then, the company has grown at a remarkable rate, and has developed a wide range of products for both exterior and interior applications. To date, Steni has delivered more than 30 million m² of façade panels.

www.steni.co.uk



Building knowledge