

Fixing instructions

Steni Colour, Steni Nature and Steni Imago

The facade panels are fixed as ventilated cladding on impregnated, wooden laths.

Product information on pallet

The panels must be stored on pallets in a dry place, under cover and on firm level ground.

Documents, product information and fixing instructions are attached to the pallet.

Steni Colour can be delivered in 3 different gloss levels. The pallet will be marked with the type of gloss level.

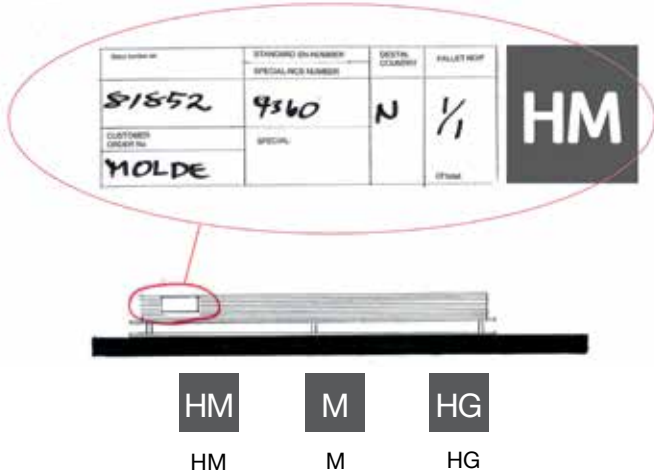

Special documentation

Reaction to fire:
EN 13501-1, B-s1,d0

Steni reserves the right to make changes/additions to the fixing instructions without further notice.

Control of measurements and tolerances

Make sure to control the measurements of the wall and panels before fixing. The panels have a tolerance of +/- 2 mm, on width and length. Edge straightness of 1 mm, and a diagonal tolerance of max 3 mm.

Minor differences in measurements should be spread over several panels to achieve nice and even gaps between the panels.

Handling of panels

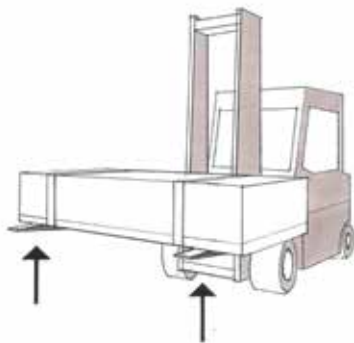

When transported on building site the pallets must always be strapped.

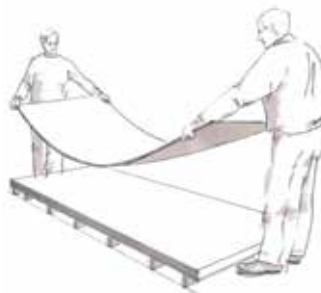

Lift the panels straight up from the pallets to avoid scratches.

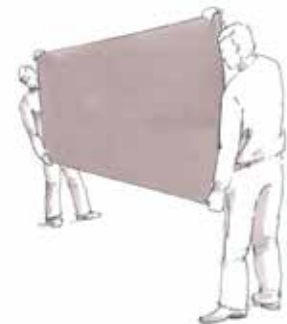

Carry the panels vertically.

Wooden laths

The fixing of **Steni** facade panels are done as ventilated cladding on impregnated, wooden laths in accordance with Nordic standard AB (NS-INSTA 141). It is important that the laths are levelled vertically and horizontally to ensure the best result.

Standard lath dimensions:

- Underneath panel joint: 23 x 73 mm
- Underneath centre of panel: 23 x 48 mm

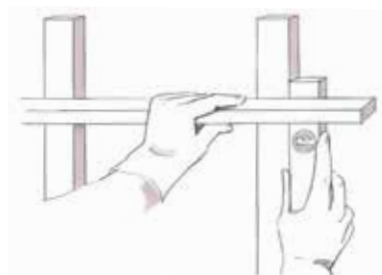

Steni-UK-203-0813



Fixing of Steni Colour

Vertical

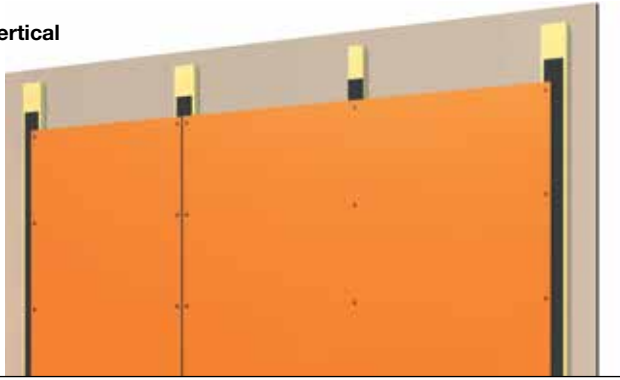

Horizontal

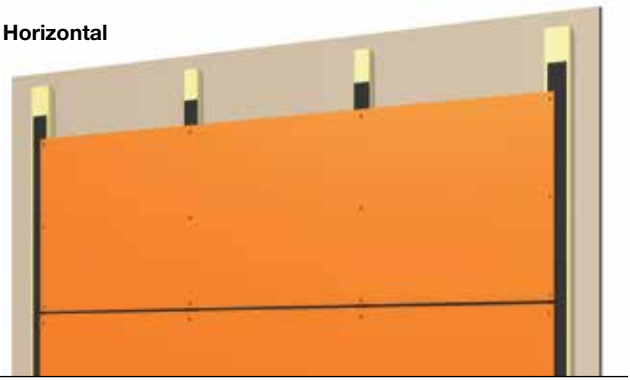

Distance between screws:

The distance between the screws alongside long edge and center of panel shall be between 220 mm (minimum) and 300 mm (maximum).

Open joints:

Normally the panels are fixed with a 5 mm open joint, vertically and horizontally. When using joint profiles, use a distance of 8-10 mm. The panels must never be fixed "edge-to-edge".

Horizontal cross section - vertical fixing:

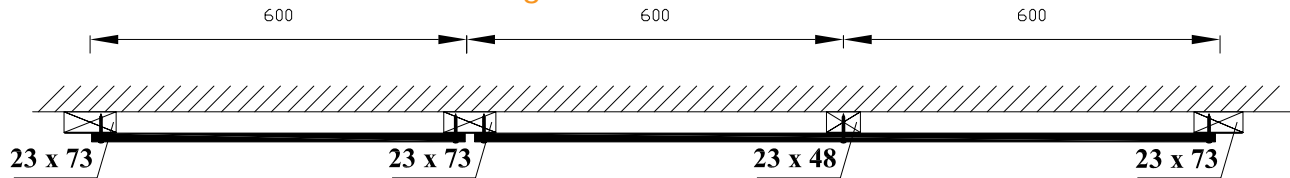

Horizontal cross section - horizontal fixing:

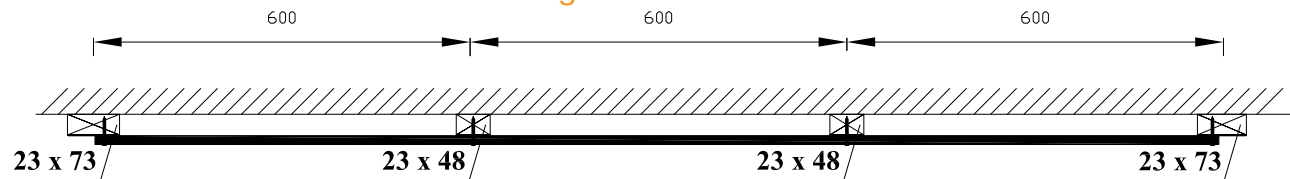

Rubber membrane:

Use approved rubber membrane strips between the laths and the Steni panels. (See pricelist for specifications).

Screws:

The facade panels are fixed with standard **Steni** screw.



Screw dimension: 4,0 x 28 mm

Material: Stainless steel A4 – ISO 3506

Colour: Polyester powder coated heads.

Square bit - R1

Samples of facade patterns that can be obtained with vertical laths fixed with c/c 600 mm.

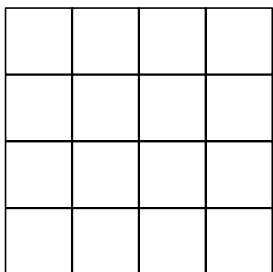

Square format

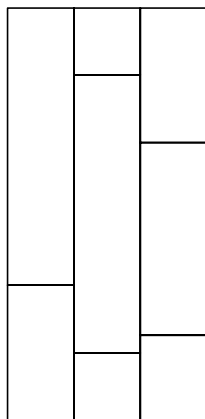

Vertical format

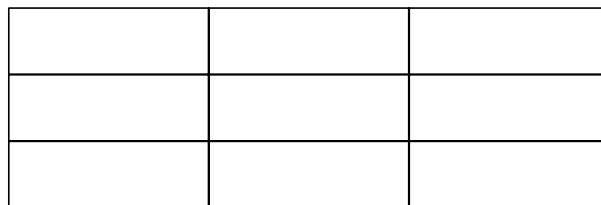

Horizontal format

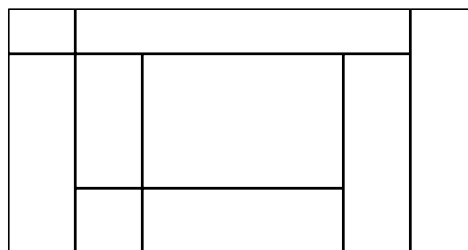

Combinations of formats

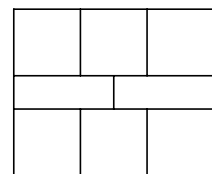

Fixing of Steni Nature and Steni Imago



When fixing **Steni Nature** and **Steni Imago**, use an extra lath (c/ c300) underneath all horizontal joints. Use at least one short lath, (see ill.), or use one whole lath. Half format (595 mm width) needs a full length lath as mid-support.

Horizontal cross sections - vertical fixing:

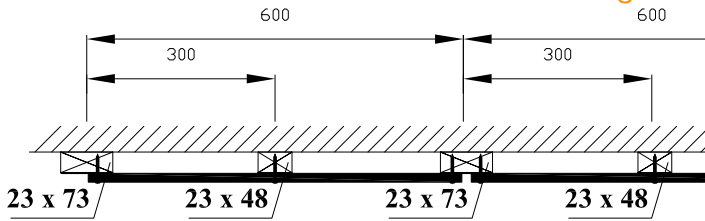

Fixing advice

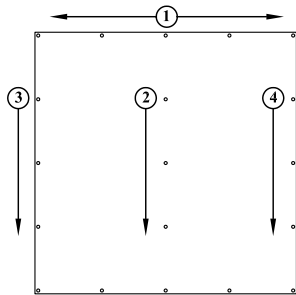

Screw pattern

Use a measuring tool to set reference lines vertically and horizontally before starting the fixing of panels. The illustration shows a sample of screw pattern.

Distance tool
When fixing with joint profile it is wise to use a distance tool.

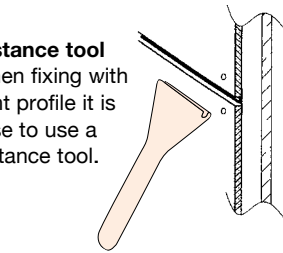

"Vacuum tool for glass"
This makes handling of **Steni** panels easier.

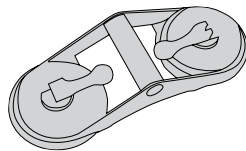

Cutting and drilling

Steni Colour is cut on the front side. Use straight edge. (Cutting disc 1). Speed: min. 3000 r/min.

Steni Nature and **Steni Imago** is cut from the back side. (Cutting disc 2).

Drilling is done with a drill for tiles. Diameter of panel holes: 5 mm for **Steni** standard screw.

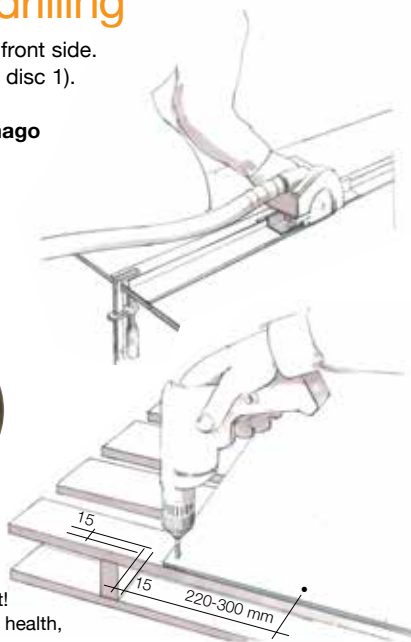
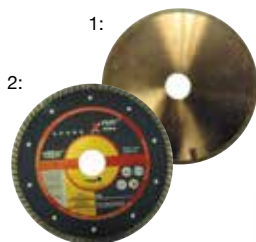

NB! Use protective equipment! See our documentation about health, environment and safety.

Fixing with open joint



Open joints:

Normally the panels are fixed with a 5 mm open joint, vertically and horizontally.

Fixing with joint profiles

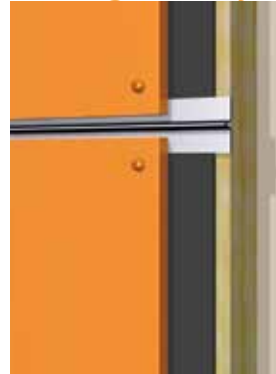

When using joint profiles use a distance of 8-10 mm. The panels must never be fixed edge-to-edge.

Remember to fix the profiles with at least 5 mm open joints between each length.

1. Vertical profile: 4941 F, M or G
2. Horizontal profile: HP 7-30
3. Vertical/horizontal profile: FP 6-30

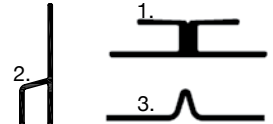

Fixing with corner or u-element

Corner element:

As corner solutions we recommend to use corner or corner profiles in order to ensure straight and nice solutions.

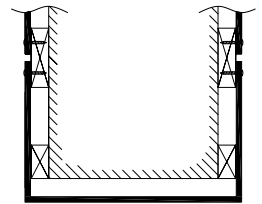
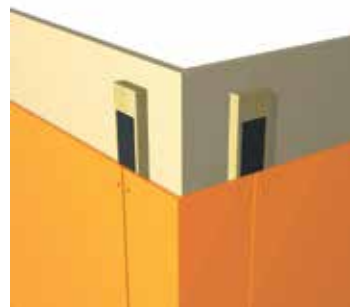

Outside corner with u-element.

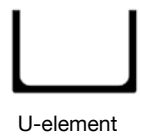
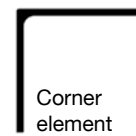
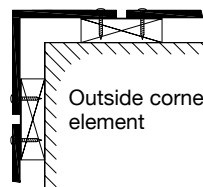

Fixing with corner profile



Remember to fix the profiles with at least 5 mm open joints between each length.



Corner profile

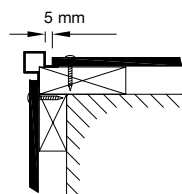

Corner with corner profile

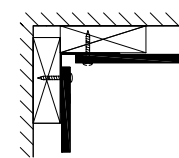

Inside corner

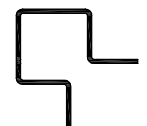

Corner profile

FIXING SYSTEMS

TIBE Drammen



Window fixing

Steni facade panels fixed as ventilated cladding

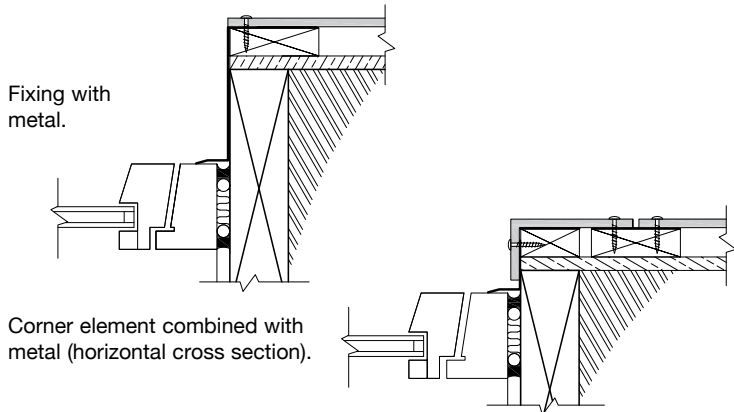
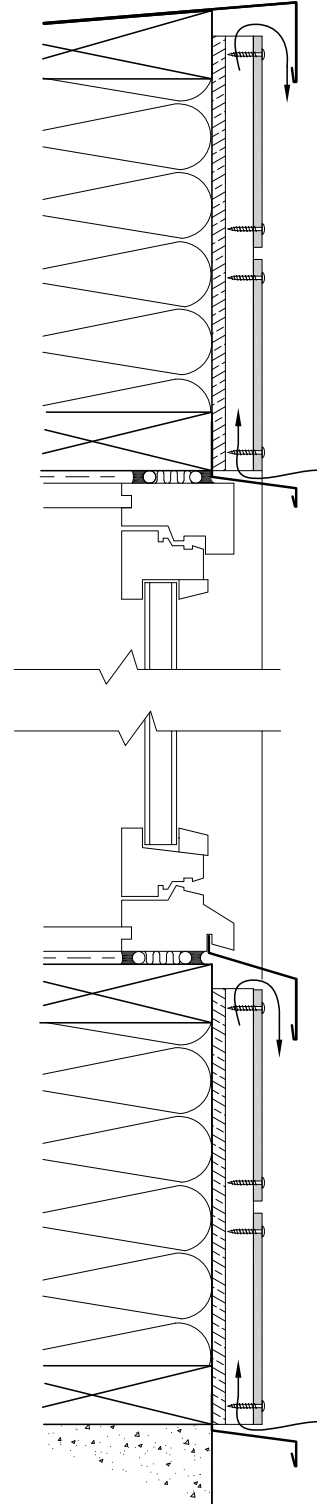

Fixing with metal.

Corner element combined with metal (horizontal cross section).

Steni-UK-203-0813

Steni UK

Units 1-4, Vauxhall Industrial Estate,
 Ruabon LL14 6HA, UNITED KINGDOM
 Tel.: +44 (0) 1978 812111
 Fax: +44 (0) 1978 810399
 E-mail: info@steni.co.uk



Building knowledge