



# ULTIMATE A1 MINERAL

## External Wall Insulation System

*THE ULTIMATE NON-COMBUSTIBLE FIRE SAFE SOLUTION*



# ULTIMATE A1 SYSTEM

Soltherm introduce the only British Board of Agreement (BBA) Certified, European Technically Approved (ETA) and A1 non-combustible external wall insulation system in the world.

Ultimate A1 Mineral has been designed with fire performance its top priority, achieving a classification of A1 non-combustible in accordance with BS EN 13501-1:2018 fire classification of construction products and building elements.

Fire regulation compliance is 100% guaranteed when specifying the Ultimate A1 Mineral System on buildings anywhere in the United Kingdom, including within boundaries and/or on high rise.

Utilisation of specialist A1 components and materials are what allow this system to achieve this industry leading A1 fire classification.

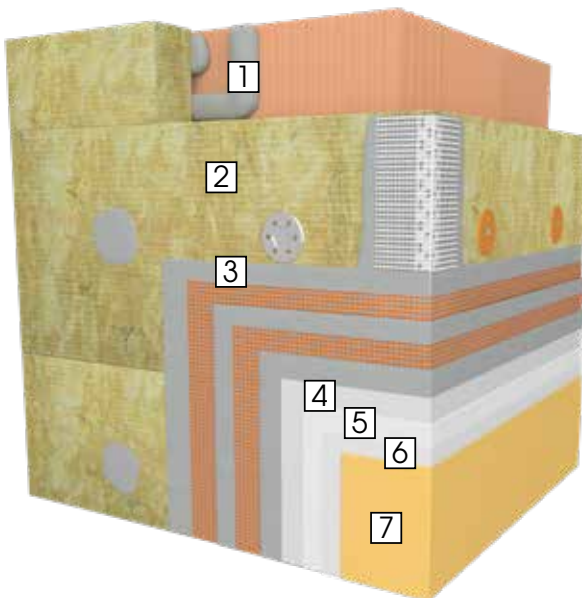
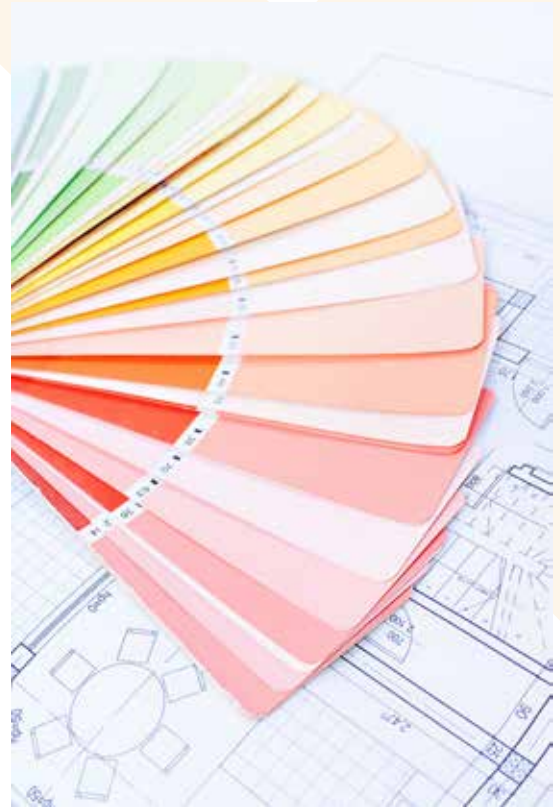

## 1. Soltherm MA

A1 Insulation adhesive designed specifically for use with mineral wool insulation.

## 2. Dual Density Mineral Wool

A1 insulation utilising two different densities, providing improved impact resistance and thermal performance.

## 3. Soltherm MB

A1 basecoat designed to encapsulate the reinforcement mesh, providing the system with water resistivity, breathability and impact protection.

## 4. Soltherm AP Colour

Primer designed to aid the adhesion of the mineral topcoat to the basecoat whilst still allowing the system to achieve A1.

## 5. Soltherm MTC

A1 textured mineral topcoat available in different grain sizes depending on the projects aesthetic requirements.

## 6. Soltherm SNP

Primer designed to aid the adhesion of silicone paints to the mineral topcoats.

## 7. Soltherm STC-P

Industry leading silicone paint formulated so as to complement the Ultimate A1 Mineral System by providing a hydrophobic decorative protection layer that is available in hundreds of colours according to Soltherm Spectrum Colour Chart as well as RAL and NCS colour palettes.

## WHY SPECIFY A1?

To achieve an A1 classification, EWI systems and their component parts are tested and evaluated to intensified levels ensuring that the system, nor any of its components, will provide fuel for the fire;

1. Non-combustibility test (EN ISO 1182) - This test identifies products that will not, or not significantly, contribute to a fire, regardless of their end use.
2. Heat of combustion test (EN ISO 1716) - This test determines the potential maximum total heat release of a product when completely burning, regardless of its end use.

**An A1 system will not contribute to the spread of fire in any circumstance.** Most mineral wool based EWI systems will achieve an A2 limited combustible fire rating but very few will achieve A1 non-combustibility. Therefore, an A1 system is the safest option on the market when specifying external cladding for your building.



CLASSIFICATION	DEFINITION	DESCRIPTION
A1	Non-combustible	No contribution to fire
A2	Limited combustibility	Very limited contribution to fire
B	Combustible	Limited contribution to fire
C		Minor contribution to fire
D		Medium contribution to fire
E		High contribution to fire
F		Easily flammable

## WHY ULTIMATE A1 MINERAL?

Soltherm have employed the use of an A1 mineral topcoat based on white cement (SOLTHERM MTC) as opposed to industry standard silicone or acrylic topcoats due to its superior fire performance and quick drying times, a perfect workable application that every installer loves. The system is the only BBA certified system of its type.

To ensure the Ultimate A1 Mineral System does not sacrifice aesthetics, weather resitivity and algae resistance, it has been tested with a specially formulated paint, SOLTHERM STC-P. This paint guarantees that the system out performs any of

the competition as the only A1 system approved and tested with this paint technology ensuring excellent water-vapour permeability of the full EWI system. Other systems on the market claiming to be A1 have not been tested with such paints, meaning the mineral topcoat is exposed to the environment, leading to unsightly mould and fungal growth in very short periods of time and discolouration when the mineral topcoat is tinted in bulk. It is industry best practice to always paint mineral topcoat renders to prevent this and ensure longevity of the EWI system.





Soltherm External Insulation Ltd  
Challenge House, Sherwood Drive  
Bletchley, Milton Keynes MK3 6DP  
Tel : 01908 533 444  
[www.ewi-soltherm.com](http://www.ewi-soltherm.com)

