

## Insula Louvre Systems

### Typical Insulated Louvre System

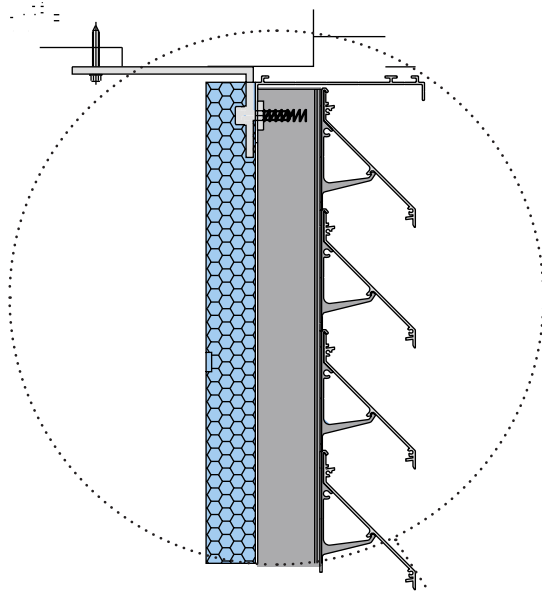

The isometric and cross section drawings below show a typical setup, in company with our AQ-100 Louvre systems.

Most insulated panels fit snug between our vertical mullions, which creates a rigid framework. Fixing details are dependant on site specifics and insulated panel sizes.

All panels are sealed with silicone on the back wing of the mullions to create an airtight seal.

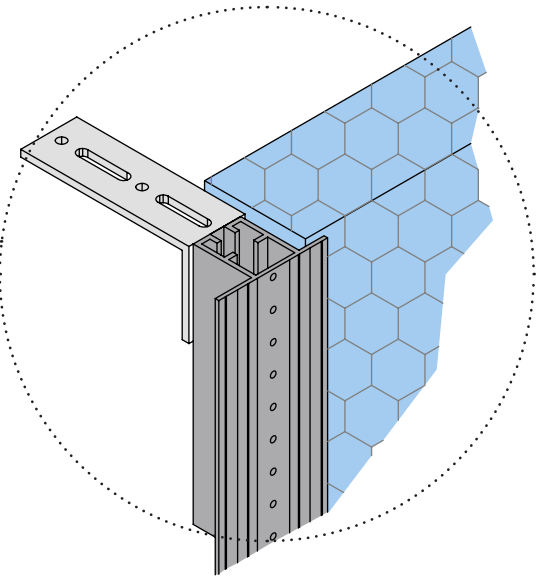
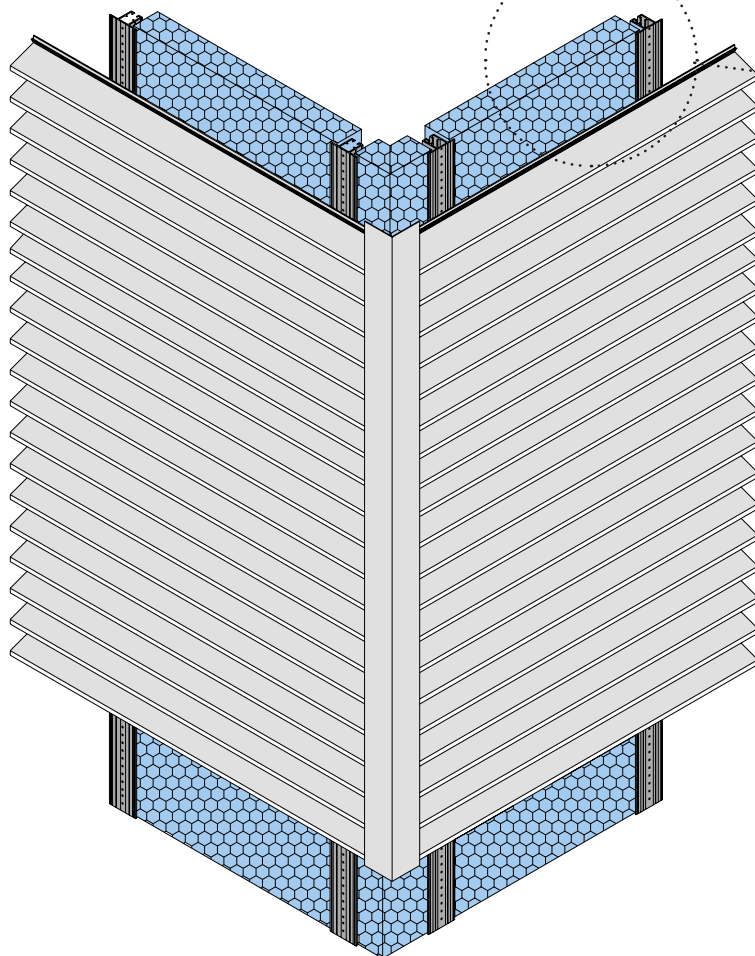

Other Insular products in this range, come as blanking panels of 2mm thick aluminium sheet. These are coated to job specific colours.

# Insula Louvre Systems

## Composite Panels

Our typical composite panel consists of a sandwich construction of two 0.5mm steel sheets with a styrofoam insulated centre, these are bonded together using a two part polyurethane adhesive.

The steel sheets have a 200 micron topcoat, which features a leathergrain emboss in a wide choice of colours to suit.



The styrofoam centre comes in a range of thicknesses and materials available upon request, standard sizes specified in the table below.

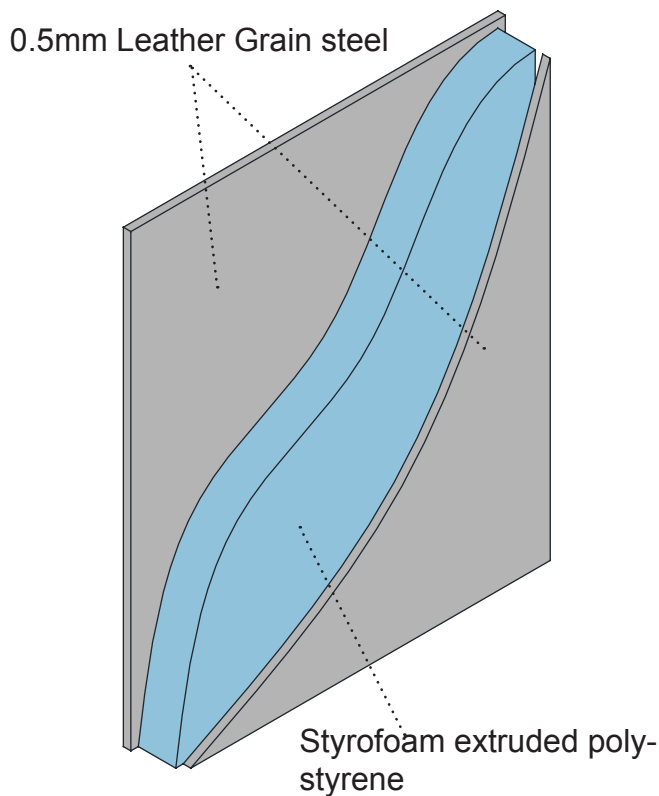

<b>Panel Code</b>	<b>INS- 75</b>	<b>INS- 62</b>
<b>U-value</b>	0.31 w/m2k	0.35 w/m2k
<b>Outer face</b>	0.5mm Leather Grain steel (coloured)	0.5mm Leather Grain steel (coloured)
<b>Core material</b>	75mm Styrofoam extruded polystyrene	62mm PIR (Polyisocyanurate)
<b>Inner face</b>	0.5mm Pre-finished steel balancer	0.5mm Pre-finished steel balancer
<b>Panel Code</b>	<b>INS- 80</b>	<b>INS- 73</b>
<b>U-value</b>	0.30 w/m2k	0.30 w/m2k
<b>Outer face</b>	0.5mm Leather Grain steel (coloured)	0.5mm Leather Grain steel (coloured)
<b>Core material</b>	80mm Styrofoam extruded polystyrene	73mm PIR (Polyisocyanurate)
<b>Inner face</b>	0.5mm Pre-finished steel balancer	0.5mm Pre-finished steel balancer
<b>Panel Code</b>	<b>INS- 100</b>	<b>INS- 88</b>
<b>U-value</b>	0.24 w/m2k	0.25 w/m2k
<b>Outer face</b>	0.5mm Leather Grain steel (coloured)	0.5mm Leather Grain steel (coloured)
<b>Core material</b>	100mm Styrofoam extruded polystyrene	88mm PIR (Polyisocyanurate)
<b>Inner face</b>	0.5mm Pre-finished steel balancer	0.5mm Pre-finished steel balancer

## Insula Louvre Systems Stand Alone Louvre Panels

This Panel type comes delivered to site as a single unit with the insulated panels attached to the back of the louvre frame.

The composite panel is attached with M10 bolts through the frame. The two are sealed with a rubber gasket between the frame and composite panel.

