

CLEVERTOUCHPRO



So advanced you'll only ever
touch the surface

The Intuitive Digital Experience Made for Business



► Manufacturer of the Year 2015

CLEVERTOUCHPRO

What you can't see inside a **Clevertouch Pro** touch screen is the innovative, rich technology that sets it apart. Technology powered by Android that creates a truly unique and immersive user experience. Available in sizes 65", 75" and 84".

Email out function. Allowing you to send files and images from the unit.

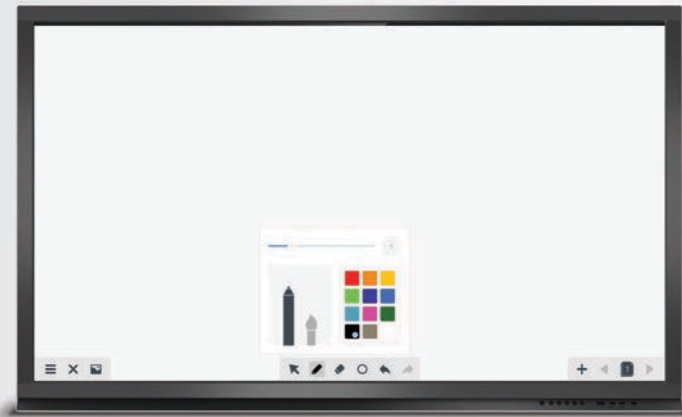

LynxPro is a pre-installed annotation app, allowing you to instantly bring up a whiteboard to brainstorm and capture ideas. Choose from an array of brushes, colours and backgrounds. Save to a USB, email out your notes, or edit them later.

Narrow bezel and modern design.

Touch-menu. Gives instant access to files & folders, apps, and settings.

Connectivity. Includes HDMI, VGA, RS232 and USB.

4K Resolution

Widget. Lets you annotate over any app, document, or external source.

4mm toughened safety glass.

Peace of mind ownership
Clevertouch Pro comes with a 5 year on-site de-install/re-install warranty (UK mainland)

Integrated 10-point touch Android. Purpose built operating system and intelligent user interface. Powered by Android and designed to be fast and functional with the latest specification, 2GB RAM and 16GB ROM.



USB ports and key function buttons on the front of the screen make it easy for anyone to enter the room and present. Simply switch on and go with the ability to access files easily. The Pro has 2 Android front ports and one PC front port.

Browser. Browse the web straight from the Android system without a PC.

Included with the Clevertouch Pro:

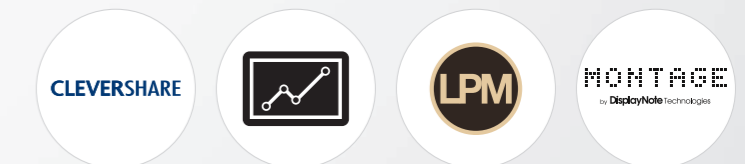

All Clevertouch Pro models feature:

- HDMI, VGA, RS232 and USB Connectivity
- 10-point touch
- Integrated Speakers
- Integrated Android OS
- Integrated 16GB storage
- No PC required
- No Shadow
- Five Year Warranty
- High Definition
- Anti Glare Glass
- Integrated Wi-Fi
- Low Power Consumption

CLEVERSHARE

Revolutionary New Ways to Collaborate



Wirelessly transmits Video, Audio and Touch

With the **CleverShare wireless device** you can control the **Clevertouch Pro** from anywhere in the room, without the need for any wires. Simply plug the **CleverShare** into your laptop's USB port and you can show and edit

your laptop's content on the Clevertouch screen. You can instantly display your desktop and control from your computer or **Clevertouch** – your pen or finger becomes your mouse.

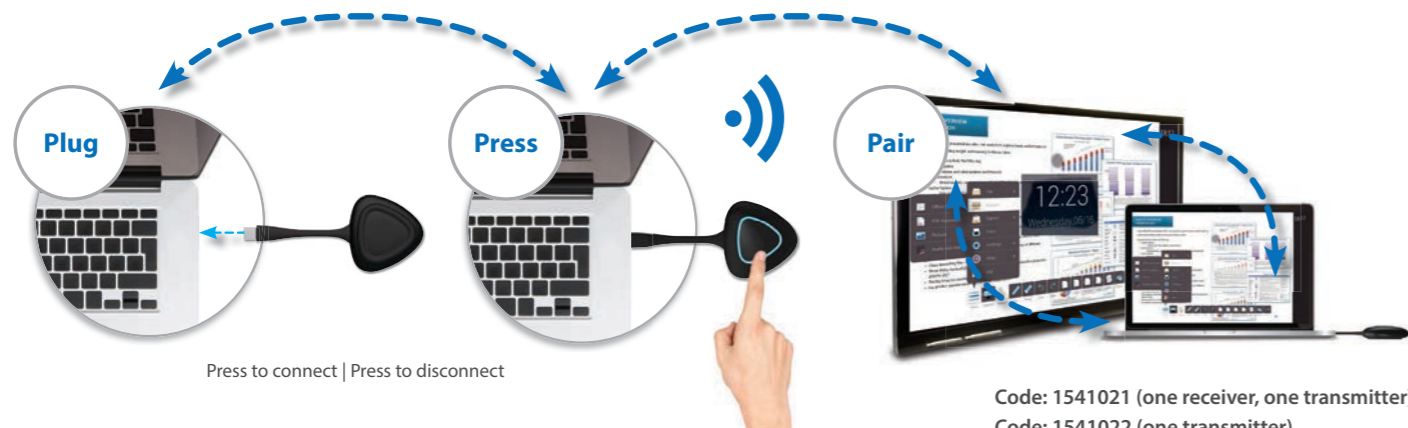

Press to connect | Press to disconnect

Code: 1541021 (one receiver, one transmitter)
Code: 1541022 (one transmitter)

MONTAGE

by DisplayNote Technologies

Capture, Contribute, Share Content, Collaborate

Montage is a solution that helps you meet smarter, see clearer and decide better - bringing together wireless presentation, communication & collaboration and designed to make meetings as productive and effective as possible.

Using Montage in meetings allows you to save time and keep everyone on the same page by letting up to 4 key contributors and decision makers fully participate, whether they're across the room or across the world. All attendees can stream what's on their devices, all at the same time and without the need to fight IT problems and struggle with cables.

- 4 Attendee Screens**
Up to 4 devices connected and shown simultaneously
- File Share**
No need to leave Montage to share content directly
- In-room & Remote**
Join from across the room or across the world
- Secure**
Password protected access
- Annotation**
Add emphasis to content and expand on ideas
- Active Display**
Any attendee can go full screen on the main display
- Need more connections, video and audio?** Upgrade to the Montage box.
- Multi-Platform.** No matter what device you have, now you can wirelessly stream to your large format display.



LynxPro Meeting



Comprehensive tools

With multiple pens, colours, and gestures getting your message across has never been easier.

Meeting templates

A selection of templates are available, so you can easily brainstorm, plan, and exchange ideas, without the need for lots of pre-meeting prep.

Choose and annotate over your files

You can import files including video, pdfs, office documents, and images, and annotate and make notes over them. You can also switch to desktop mode, to annotate over any software that you have on your PC.

Personalised custom settings

Users can customise brushes and background canvas settings to fully meet the demands of the activity.



CLEVERTOUCHPRO

Why Choose Clevertouch Pro?

Combine functionality and simplicity...

Re-invent your boardroom, office, or meeting room with **Clevertouch Pro**

- It works just like a flipchart or whiteboard, but it's digital – simply turn it on and start writing.
- Pre-installed apps make it easy to open and edit most file types – office documents, pdfs, audio, 4K video, and images.
- Connect mobile devices in the room, or globally.
- Share notes instantly when you're finished using email, save and Cloud functions... all without a computer.



Want to start a meeting?

It's as simple to use as a tablet – just turn on and go. All your apps and files are just one click away. Open a document from the internal memory, from a USB stick, or wirelessly upload to the **Clevertouch Pro**.



Want to wirelessly connect or BYOD?

- Use the **CleverShare** device to connect your PC without wires.
- View images, play a video, or share documents from your PC, tablet or phone, by downloading the **E-share** app on to your mobile device.
- Using the **Montage** app connect your PC, iOS, or Android device and collaborate, annotate and share documents.

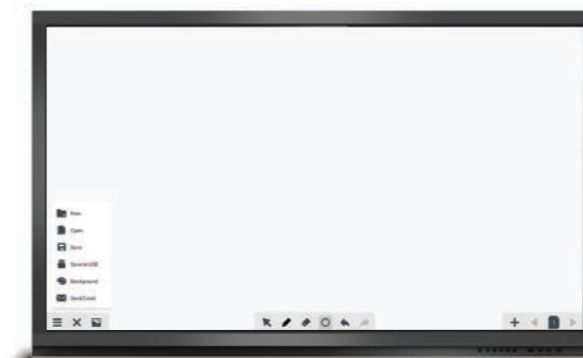

Want an electronic flipchart?

Use the LynxPro app to bring up a whiteboard. Simple to use with built-in gesture control allowing the user to add pages, roam and expand with a swipe. Send out the notes to all meeting attendees via email instantly, or save them directly onto USB.

PLANNING

ANALYSIS

Product Code	1541029	1541030	1541031
Description	65" Pro	75" Pro	84" Pro

Display

Touch points	10	10	10
Screen type	LED	LED	LED
Aspect ratio	16:9	16:9	16:9
Resolution	UHD 4K	UHD 4K	UHD 4K
Brightness (cd/m2)	450	450	350
Audio	2x10w	2x10w	2x10w
Android	✓	✓	✓
Glass	Anti Glare	Anti Glare	Anti Glare

Connectivity

CVBS	✓	✓	✓
VGA input	3	3	3
HDMI	4	4	4
PC-Audio	✓	✓	✓
R/L (CVBS)	With video IP	With video IP	With video IP
VGA output	✓	✓	✓
WAN (RJ45)	✓	✓	✓
RS232	✓	✓	✓

Warranty & Power

Power consumption	<250W	<370W	<520W
Power consumption in standby	<0.5W	<0.5W	<0.5W
Warranty (on-site de/re)	5 year	5 year	5 year

Physical Specs

Dimensions W x H x D (mm)	1544 x 942 x 94	1775 x 1056 x 101	1979 x 1193 x 98
Weight	66kg	82kg	95kg
VESA (mm)	600 x 400	600 x 600	600 x 600

Android Capabilities

System Version	4.4 KitKat	4.4 KitKat	4.4 KitKat
Android Chipset	RK3288	RK3288	RK3288
Android Resolution	1080p	1080p	1080p
CPU	ARM Cortex A17 Quad Core	ARM Cortex A17 Quad Core	ARM Cortex A17 Quad Core
GPU	Quad Core	Quad Core	Quad Core
RAM	2GB(DDR3)	2GB(DDR3)	2GB(DDR3)
Flash Memory	16GB	16GB	16GB
WiFi Enabled	✓	✓	✓

Apps and Android features

Lynx Pro	✓	✓	✓
Email Out	✓	✓	✓
Widget	✓	✓	✓

Software

Montage	✓	✓	✓
LynxPro Meeting	✓	✓	✓

Accessories

Ability to use USB camera	✓	✓	✓
Magnetic Pen	3	3	3
VGA, Audio cables	✓	✓	✓
HDMI, USB cables	✓	✓	✓
Clevershare	2	2	2