

DRIVE

Electromechanical multi-point lock GENIUS 2.2

AS 2xxx EA / EB / CA / CB

Window systems

Door systems

Comfort systems

Table of contents

1	ABOUT THIS DOCUMENTATION	4
1.1	Read the instructions	4
1.2	Producer	4
1.3	Notice on gender	4
1.4	Target group	4
1.5	Applicable information	4
1.6	Symbols used	4
1.6.1	LED	4
1.6.2	Other symbols	5
2	SECURITY	6
2.1	Intended use	6
2.2	Requirements for the target group	6
2.3	Safety notes	6
3	PRODUCT SPECIFICATIONS	7
3.1	Structure	7
3.2	Operating and display elements	7
3.2.1	LED button	7
3.2.2	Status LED	8
3.3	Operation	8
3.3.1	Automatic door lock	8
3.3.2	Changeover day / night operation	8
3.3.3	Comfort function	8
3.4	Menu	9
4	COMMISSIONING	10
4.1	Install the SIEGENIA Comfort app	10
5	OPERATION	11
5.1	Lock the door automatically	11
5.2	Lock the door with the key	11
5.3	Release the door with access control system .	12
5.4	Release the door with the key	12
5.5	Release the door with the lever handle (comfort function)	12
6	CARE AND MAINTENANCE	13
6.1	Check the functions of the multi-point lock .	13
7	TROUBLESHOOTING	14
8	DISPOSAL	15
9	CERTIFICATES	16
9.1	EU declaration of conformity	16

1 About this documentation

1.1 Read the instructions

These instructions are an important document and part of the product. Only the defined procedures are safe. Persons can be injured or material damage could occur if these instructions are not observed.

Read and observe the instructions completely before using the product.

Retain these instructions, keep them available and pass them on to subsequent users.

1.2 Producer

KFV Karl Fliether GmbH & Co. KG
Siemensstraße 10
42551 Velbert
Germany

You can find the addresses of our worldwide locations here:
<https://www.siegenia.com/en/company/locations>

1.3 Notice on gender

The linguistic form used serves for easier readability and always means all genders as long as nothing else is explicitly mentioned.

1.4 Target group

This information is aimed at all persons who carry out the following activities:

- operation and maintenance of KFV products
- operation and maintenance of door elements that are equipped with KFV products

1.5 Applicable information

Note the following applicable information prior to operation.

- Operating instructions SIEGENIA access control system:
<https://link.si/td/elek029/1023>



- Operating instructions IO module/IO module smart:
<https://link.si/td/elek028/1023>



1.6 Symbols used

1.6.1 LED

- LED off
- LED lights up
- ⚡ LED flashes in 1 colour
- ⚡ LED flashes alternately in 2 colours

1.6.2 Other symbols

 Changeover day / night operation

2 Security

2.1 Intended use

- GENIUS 2.2 is a hardware system that locks and unlocks entrance doors automatically.

2.2 Requirements for the target group

The following persons may only operate the product if they have understood the dangers involved in handling the product or if they are supervised during operation:

- children
- persons with diminished physical, sensory or mental capabilities
- persons with a lack of experience and knowledge

2.3 Safety notes

Material damage due to simultaneous use of lever handle and key

You can damage the lock if you move the lever handle and turn the key at the same time.

- Never activate the key and the lever handle simultaneously.

Material damage due to overloading the lever handle

You can damage the lock if you load the lever handle excessively.

- Do not load the lever handle with more than 15 kg.

Material damage due to projected locking elements

You can damage the door if the locking elements are projected when the door is open.

- Do not extend the locking elements when the door is open.

3 Product specifications

3.1 Structure

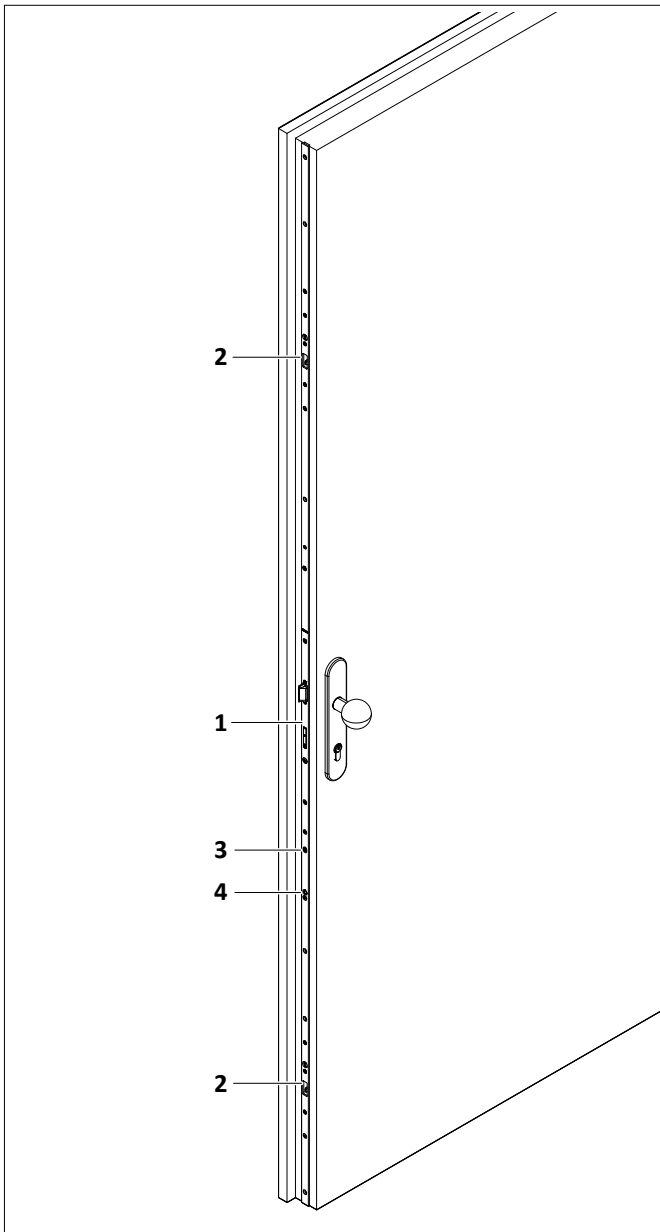

Item	Name
1	Main lock
2	Auxiliary box
3	LED button
4	Status LED

3.2 Operating and display elements







3.2.1 LED button

LED	status
○	The multi-point lock is in day mode.
●	The multi-point lock is in night mode.

DRIVE – Operating and care instructions

Electromechanical multi-point lock GENIUS 2.2, AS 2xxx EA / EB / CA / CB

3.2.2 Status LED

LED	status
	The product is now ready for operation.
	The opening signal is present.
	There is a product fault, the product is not ready for operation.
	The contact of the connecting clamp is faulty. The magnetic sensor is not working.
	The locking elements are extended when the door is open.
	There is a general fault. The product is not ready for operation.
	The motor is driven on block.

3.3 Operation

3.3.1 Automatic door lock

The electromechanical multi-point lock locks the door automatically.

The door unlocks automatically if an access control system or a clock timer is connected. As soon as the

multi-point lock receives an opening signal, the door unlocks for 7 seconds. A signal is emitted during this period. The signal switches off as soon as the door opens. If the door does not open, the multi-point lock locks the door again after the 7 seconds.

3.3.2 Changeover day / night operation

The electromechanical multi-point lock offers 2 locking modes:

The switchover between the locking modes is possible via a button is possible for all variants.

day mode	The door closes. It does not lock automatically. This means the latch only extends when the door closes. All other locking elements remain retracted. Manual locking is possible via the cylinder lock.
Night mode	The door closes and locks automatically. This means that all locking elements extend when the door closes.

3.3.3 Comfort function

The electromechanical multi-point locks versions CA and CB have a comfort function. The comfort function

is a mechanical quick release. The mechanical quick release enables the door to be opened via the lever handle from the inside at any time.

3.4 Menu

Operating mode switchover

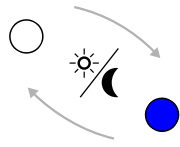

Button pressed on LED button	Description
→ 1 second	Switchover between Day and Night mode

4 Commissioning

4.1 Install the SIEGENIA Comfort app

1. Install the SIEGENIA Comfort app.



App store



Google Play Store



5 Operation

5.1 Lock the door automatically

Prerequisite

- The door is open.

1. Switch the door to night mode. If necessary, press the LED button 1x, until it lights up blue.

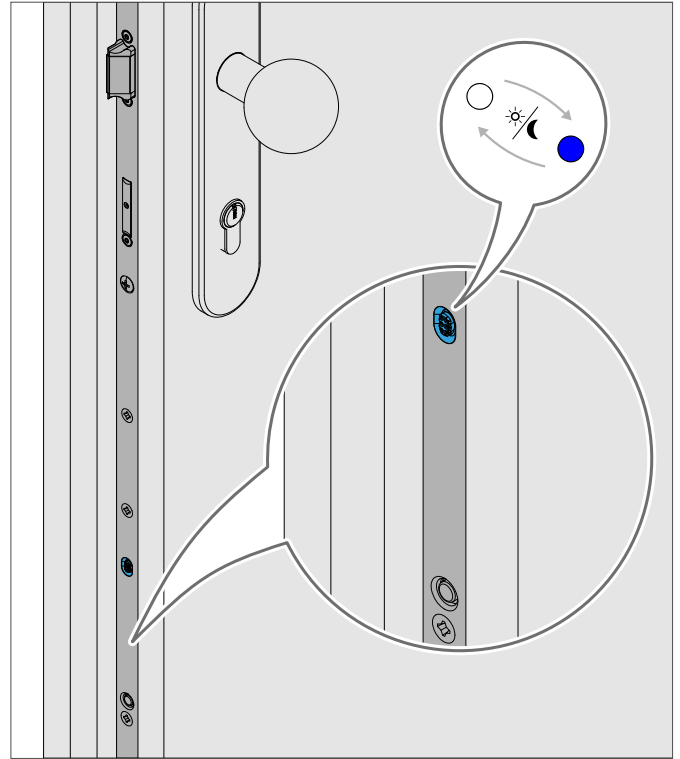

2. Close the door.

→ This locks the door.

5.2 Lock the door with the key

Only lock the door with the key in day mode or in event of a power failure. The door locks automatically in night mode.

! NOTICE

Material damage due to opening the door manually

If you open the door manually during the automatic process, this will lead to functional disturbance of the drive.

- Do not open the door manually during the automatic process.

Prerequisite

- The door is open.

1. Switch the multi-point lock to day mode. If necessary, press the LED button 1x until it lights up white.
2. Close the door and turn the key in the locking direction as far as the end position.

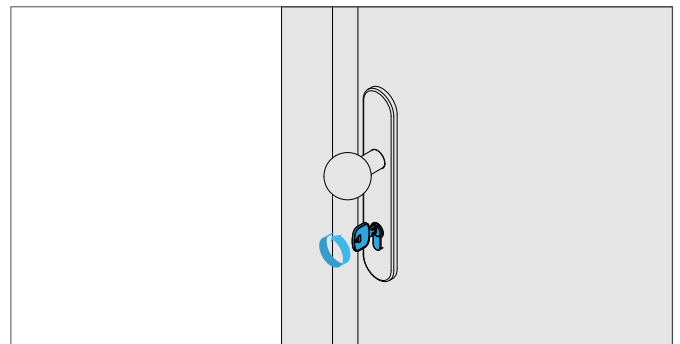

→ This locks the door.

5.3 Release the door with access control system

Prerequisites

- The door is closed and locked.
- A SI-BUS access control system is connected to the multi-point lock, coupled and commissioned.
- An external access control system is connected and commissioned.

1. Trigger the unlocking signal via the access control system. Further information can be found in the operating instructions for the installed access control system.

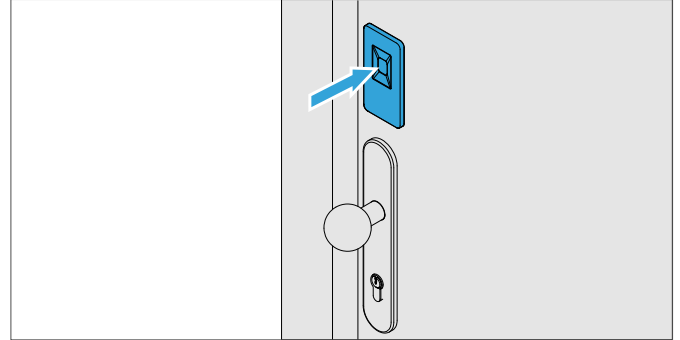

2. Wait 2 seconds until the door releases.
3. Open the door.

→ If the door is not opened within 7 seconds, it will automatically lock again.

5.4 Release the door with the key

NOTICE

Material damage due to opening the door manually

If you open the door manually during the automatic process, this will lead to functional disturbance of the drive.

- Do not open the door manually during the automatic process.

Prerequisite

- The door is closed and locked.

1. Turn the key until the door is released.

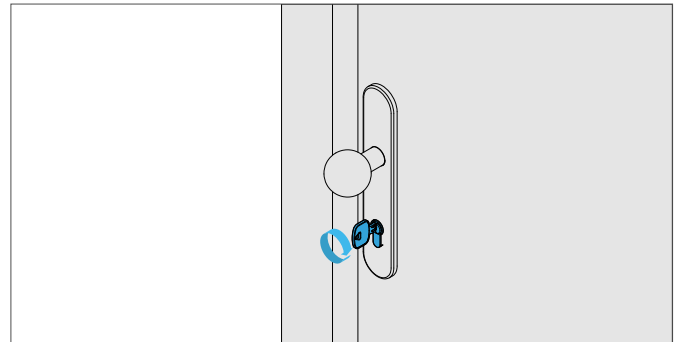

2. Open the door.

5.5 Release the door with the lever handle (comfort function)

NOTICE

Material damage due to opening the door manually

If you open the door manually during the automatic process, this will lead to functional disturbance of the drive.

- Do not open the door manually during the automatic process.

Prerequisites

- The door is closed and locked.
- The door is equipped with the comfort function and has a lever handle on the inside.

1. Press the lever handle downwards from the inside to the stop, until the door releases.
2. Open the door.

6 Care and maintenance

6.1 Check the functions of the multi-point lock

Work equipment	Intended use
	<p>Recommended lubricant:</p> <ul style="list-style-type: none"> • Staloc PTFE-Spray • Presto PTFE Lubrifiant • Ballistol Universal Öl • Nigrin PTFE • Bauhaus Profi DEPOT • HIGH-TEF Oil INNOTEK • E-COLL PTFE SPRAY with NSF H1 approval

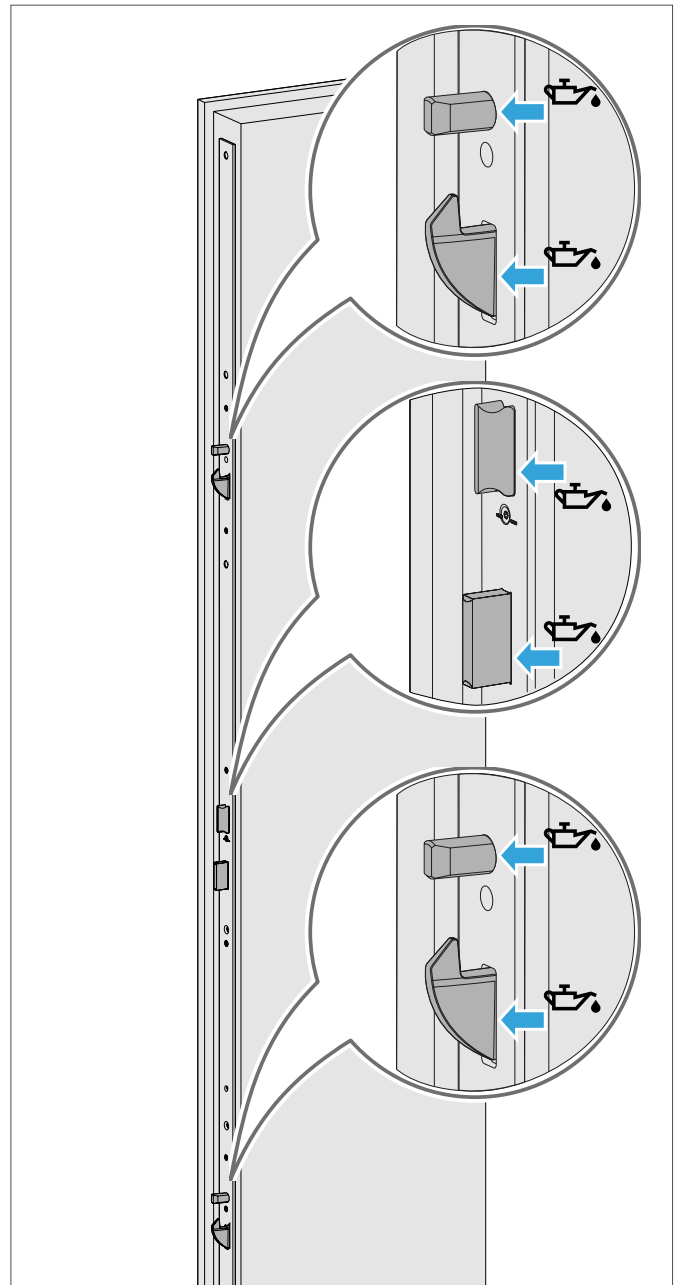

Locking point of the multi-point lock

1. Check the mechanical functions of the multi-point lock at least once a year. The motor is maintenance-free.
2. If the moving parts of the multi-point lock move sluggishly, lubricate the respective locking points with one of the recommended lubricants.



7 Troubleshooting

Contact the producer (see page 4) if this table does not describe the error.

Problem	Possible cause	Solution
The door does not lock automatically.	The multi-point lock is in day mode.	<ul style="list-style-type: none"> Adjustment of night mode.
	The supply voltage to the multi-point lock is interrupted.	<ul style="list-style-type: none"> Check the supply voltage.
	The multi-point lock is defective.	<ul style="list-style-type: none"> Contact your service partner.
The door does not unlock automatically.	The supply voltage to the multi-point lock is interrupted.	<ul style="list-style-type: none"> Check the supply voltage.
	With connected SIEGENIA access control system: the pulse control is deactivated in the SIEGENIA app.	<ul style="list-style-type: none"> Activate the pulse control in the app.
	With connected SIEGENIA access control system: the pulse duration in the app is set too long ($t > 1s$).	<ul style="list-style-type: none"> Adjust the pulse duration to $t = 1s$ in the app.
	The multi-point lock is defective.	<ul style="list-style-type: none"> Contact your service partner.
The LED button does not light up.	The multi-point lock is in idle mode.	<ul style="list-style-type: none"> Press the LED button.
The LED button and the status LED do not light up.	The multi-point lock is in idle mode.	<ul style="list-style-type: none"> Press the LED button. The status LED lights up green. The LED button lights up white or blue.
	The supply voltage to the multi-point lock is interrupted.	<ul style="list-style-type: none"> Check the supply voltage.
	The multi-point lock is defective.	<ul style="list-style-type: none"> Contact your service partner.
	The locking elements are extended when the door is open.	<ul style="list-style-type: none"> Retract the locking elements prior to closing the door.
	The supply voltage is defective.	<ul style="list-style-type: none"> Check the supply voltage.
	There is an error in the control unit.	<ul style="list-style-type: none"> Contact your service partner.

8 Disposal

- The product must be removed by a qualified specialist only.

DRIVE – Operating and care instructions

Electromechanical multi-point lock GENIUS 2.2, AS 2xxx EA / EB / CA / CB

9 Certificates

9.1 EU declaration of conformity

We, the producer, hereby declare that our product complies with the following directives.

Producer	Product	
KFV Karl Fliether GmbH & Co. KG Siemensstraße 10 42551 Velbert	Device type:	Type designation:
	Electromechanical drive for multi-point locks	GENIUS 2.2 A / B / PANIC

Directives		Harmonised standards
EMC Directive	2014/30/EU	EN 61000-3-2:2014 EN 61000-3-3:2013 EN 61000-6-2:2005/AC:2005 (only test mode ICI3+4, ICS, VDI) EN 61000-6-3:2007/A1:2011 class B
RoHS Directive	2011/65/EU	EN 50581:2012

Underlying test reports in accordance with EMC Directive: Nemko GmbH & Co. KG, Test and Certification Authority; test report identification number: FS-1306-238552-002



Velbert, 2019-08-28 Uwe Ziewers
(Site Manager)

www.siegenia.com



SIEGENIA®
brings spaces to life