

# Defender Door Lock General Free Mode User Instructions

This door has been fitted with the Securistyle Defender Door Lock in General Free mode and the following instructions will explain how to operate it so you can utilise the benefits of the product. Further information on this product can be found at [www.securistyle.co.uk](http://www.securistyle.co.uk)

## FIRE & RESCUE SERVICE ADVICE

Create an escape plan. To help you do this contact your local fire and rescue service and ask about the free fire and safety check or visit [www.fireservice.co.uk/safety/hfsc](http://www.fireservice.co.uk/safety/hfsc)

### To enter a locked property

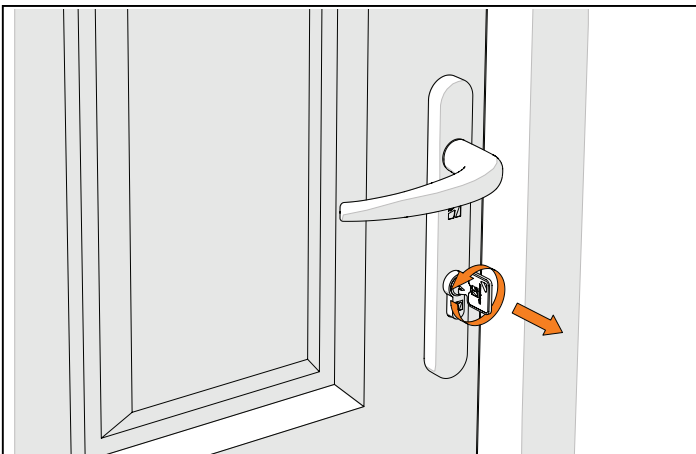

1. Turn key one complete turn to disengage deadbolt. Remove key.

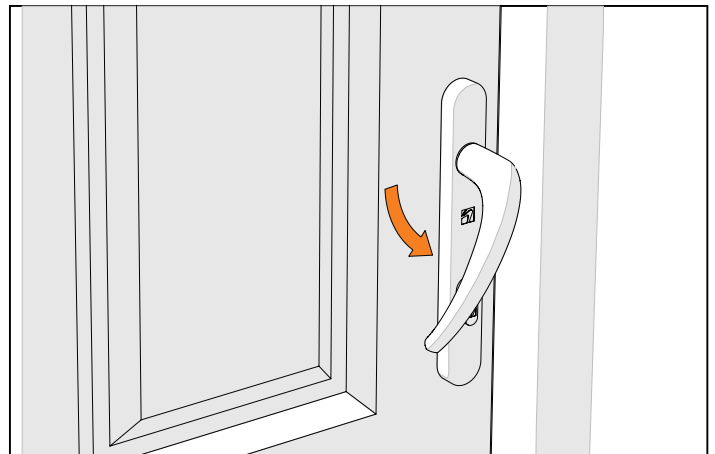

2. Pull down outside handle to open door and enter property.

### To secure the property from inside



1. With the door closed, lift inside handle.

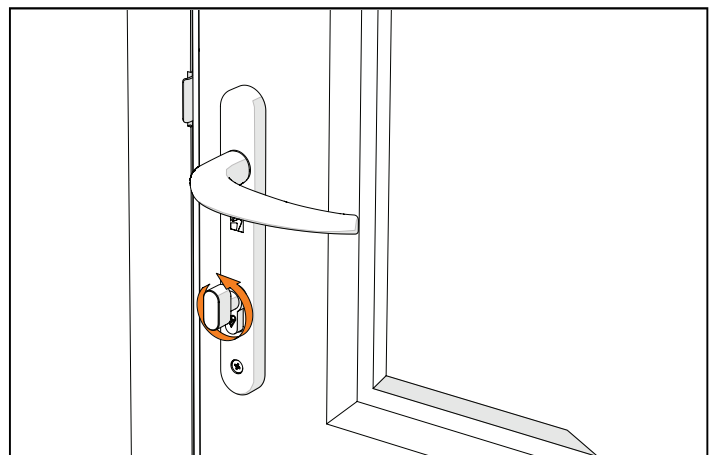

2. Turn knob (or key) until it stops to engage deadbolt. (**Warning!** Door is not secure until this is done).

**Note:** Where a keyed cylinder is fitted in place of a thumb turn version, it is strongly advised that the key is accessible at all times in case of emergency escape.

**To exit property**

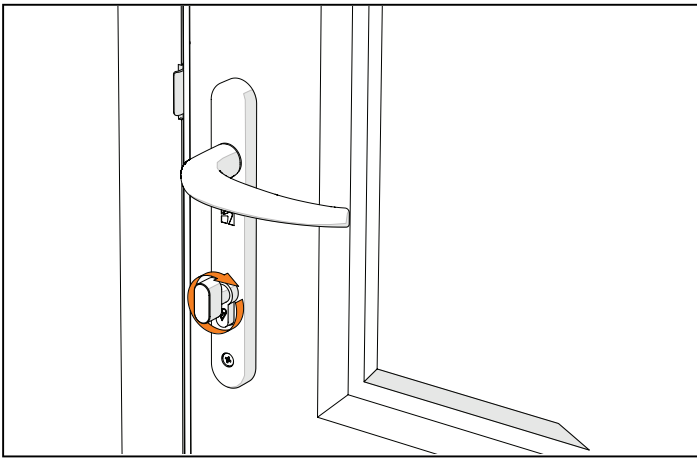

1. Turn knob (or key) one complete turn to disengage deadbolt.

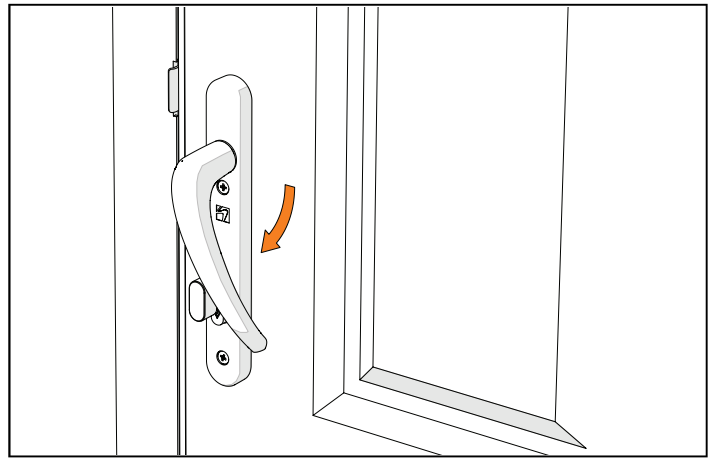

2. Pull down inside handle to open door and exit property.

**To secure the property from outside**

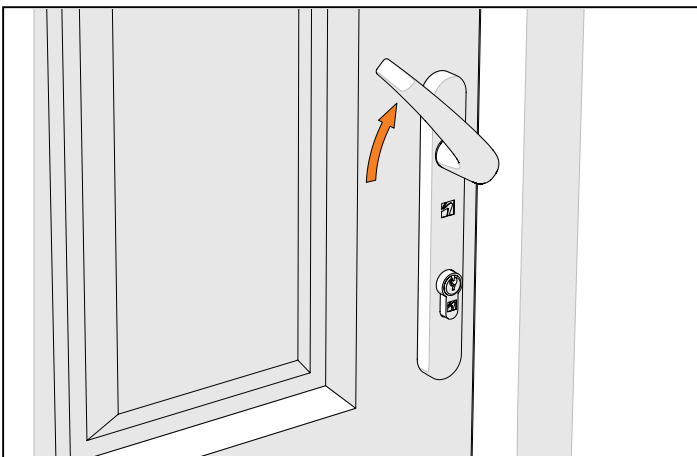

1. With door closed, lift outside handle.



2. Turn key until it stops to engage deadbolt.  
**(Warning!** Door is not secure until this is done).