



ACCESS BLOCK

For DM Block Chimneys. Suitable for use in negative pressure (Dry Chimney) applications. CE Designation (T450 N1 D 3 G(00))

Features / Benefits

Pumice Concrete

Highly Insulated

Lightweight

Pre Drilled Hole

Quick & easy to build

Better performance

Possible 0 distance to combustibles

Easy access for flue pipe

Categories: [DM36 Components](#), [Isokern Pumice](#), [DM44 Components](#), [DM54 Components](#)

VARIATIONS

SKU	INT MM	A	B	C	D
130717	180	600	305	212	126.3



SKU	INT MM	A	B	C	D
127682	200	600	305	212	126.3
126368	150	500	250	177	103.6

GALLERY IMAGES

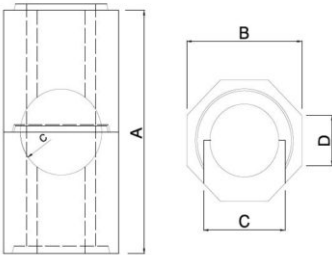

PRODUCT DESCRIPTION

Pumice is a natural insulator; this is the unique property that separates pumice from all other chimney material.

Schiedel Isokern is noteworthy for its flue and chimney products manufactured using high quality pumice which is recognised throughout Europe and USA.

SCHIEDEL ISOKERN OFFERS:

- The unique feature of Schiedel Isokern against other chimney systems is that pumice is known for its natural insulating properties.
- Pumice allows the flue gases in the chimney to quickly reach their optimum temperature enabling the heating appliance to reach its optimum performance shortly after lighting.
- It keeps the chimney warmer longer as the heat output of the appliance decreases, once again aiding performance and reducing the likelihood of condensation and soot build-up.
- ISOKERN is a well reputed brand known for its durability, reliability and long lasting, robust performance, under the Schiedel product portfolio.
- We have the Largest collection of masonry chimney & fire chest products
- Our products are CE marked
- Our products are tested to the appropriate EN standards



Isokern Pumice Double Module DM is CE Certified to EN1858 TÜV Cert no. 0036 CPR 90219 001

Isokern Pumice Chimney Liner is CE certified to EN1857 TÜV Cert no. 0036 CPR 90219 002

Isokern Magnum Firechest has been tested at the Fraunhofer Institut, Stuttgart, Cert no. P8-094/2006

CE Designation

- Double Module DM System Chimney* T450 N1 D 3 G(00)
- Pumice Chimney Liner T450 N2 D 3 G

* Zero distance to combustibles on straight chimney systems with ventilated terminal.
38mm distance to combustibles on offset systems. and non-ventilated systems.