

Place SAM 04T1 profile block on side spindle 2.
 Place SAM 04T2 profile block on side spindle 3.
 Place 8mm-15mm adjustable diamond groover on the last bottom spindle set to produce 9.5mm x 4.00mm groove.

PRINTED COPY UNCONTROLLED

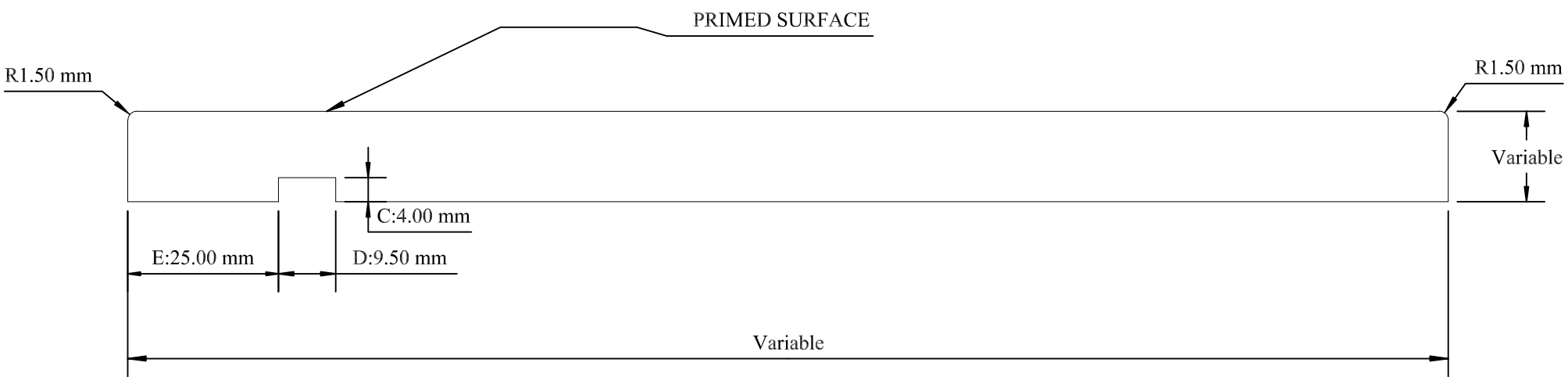

Manufactured from Tricoya boards

AREA MACHINED AWAY 38.96 SQMM.

| | |
|----------|---------------------|
| MOULDER | 1,4 |
| PASSES | 1 |
| DRAWN BY | C McKinley |
| DATE | 20/06/14 |
| SCALE | 1:1 |
| REV: | AUTH: |
| | TOLERANCE +/- 0.5MM |

SAM MOULDINGS

Newpark Industrial Estate Greystone Road Antrim BT41 2RU
 Tel : (028) 9442 8288 Fax : (028) 9442 8244
 Website: www.sammouldings.co.uk Email: info@sammouldings.co.uk

| | |
|----------|----------|
| PROFILE | SAM 3454 |
| DRAWN BY | |
| DATE | |
| SCALE | 1:1 |