

Bow Front Quad (Offset)

Instruction Manual

V8BQ1113S

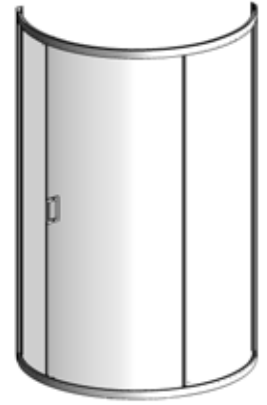

IMPORTANT INFORMATION

- Toughened glass is completely safe for use in our shower enclosures and bath screens; providing our products are installed according to our guidelines.
- It is important to note that the glass must not be mounted or 'pinched' in such a way that would cause a stress point to develop in the glass. In addition, it must not be subject to any sharp impact or severe temperature fluctuation which may also cause a stress point to develop in the glass.
- Toughened glass is physically and thermally significantly stronger than standard glass. During the toughening process the stresses contained within any glass are balanced so if in the unlikely event situation any of the above occurs and the glass breaks, the glass will shatter safely into small thumbnail sized blunt fragments.

PRE-INSTALLATION CHECKS

1. Check you have the correct product. Please look at the labels on the side of the product packaging.
2. Check all the product components are in the box and the fixing kits.
3. Unpack your product and handle it with care.
4. Please check the product for defects or damage, once the installation has commenced we cannot accept responsibility for any defects or damage.
5. Please take time to read these instructions prior to installing your product.
6. Before you commence any drilling check there are no hidden electrical cables and/or water pipes.
7. No attempt should be made to re-work the toughened safety glass.
8. The installation of the product should be performed by two persons.
9. It is strongly recommended that the walls the product is going to be installed on are vertical.
10. It is strongly recommended the product is fitted on a tiled surface or similar waterproof surface.
11. It is strongly recommended the walls are tiled and grouted before the product is installed.
12. If the walls and/or the tray are not level you will not achieve maximum adjustment of the product.
13. Pictures used are for illustration purposes only, product designs may alter slightly as a result of continuing product development.
14. We do not stipulate where the European Standard Kite Mark should be positioned on the glass when being factory assembled.
15. Please note that some natural misting may occur when you remove this product from its packaging, due to the addition of the glass protection pre-coating. If this does occur this can easily be removed with a soft, dry cloth.

Fixing Kit Components

Description	Quantity
2.5mm Drill Bit	1
Wall Plugs	6
40mm Screws	6
9mm Screws	6
Screw Bases	12
Screw Covers	12
25mm Frame Fixing Screws	8
Universal Caps	2
2.5mm Allen Key	1
3mm Allen Key	1
Branding Badge (if applicable)	1

Component Check List: Supplied

Description	Quantity
Large Curved Panel Assembly	1
Small Curved Panel Assembly	1
Curved Door Glass	1
Horizontal Curved Rail Assemblies	2
Angled Wall Profile 1	1
Angled Wall Profile 2	1
Handle Assembly	1
Vertical Panel Seal (Long Flipper)	1
Vertical Door and Panel Seal (Short Flipper)	1 of each
Rail Panels Seals (Long and Short)	2 of each
Bearing Assemblies (Top)	2
Bearing Assemblies (Btm)	2

Equipment Check List: Not Supplied

Description
Mains or Battery Drill
6mm Masonry Drill Bit
Spirit Level
Pozi Screwdriver
Sealant Gun / Bathroom Sealant
Tape measure
Pencil
4.5mm Drill Bit

CONSUMER GUARANTEE

Please make sure the purchaser/end user completes and returns the guarantee card which is enclosed with this product. Failure to validate the Guarantee will mean only the 1 Year Statutory Guarantee will apply.

Step 1 - Pre-Installation Checks

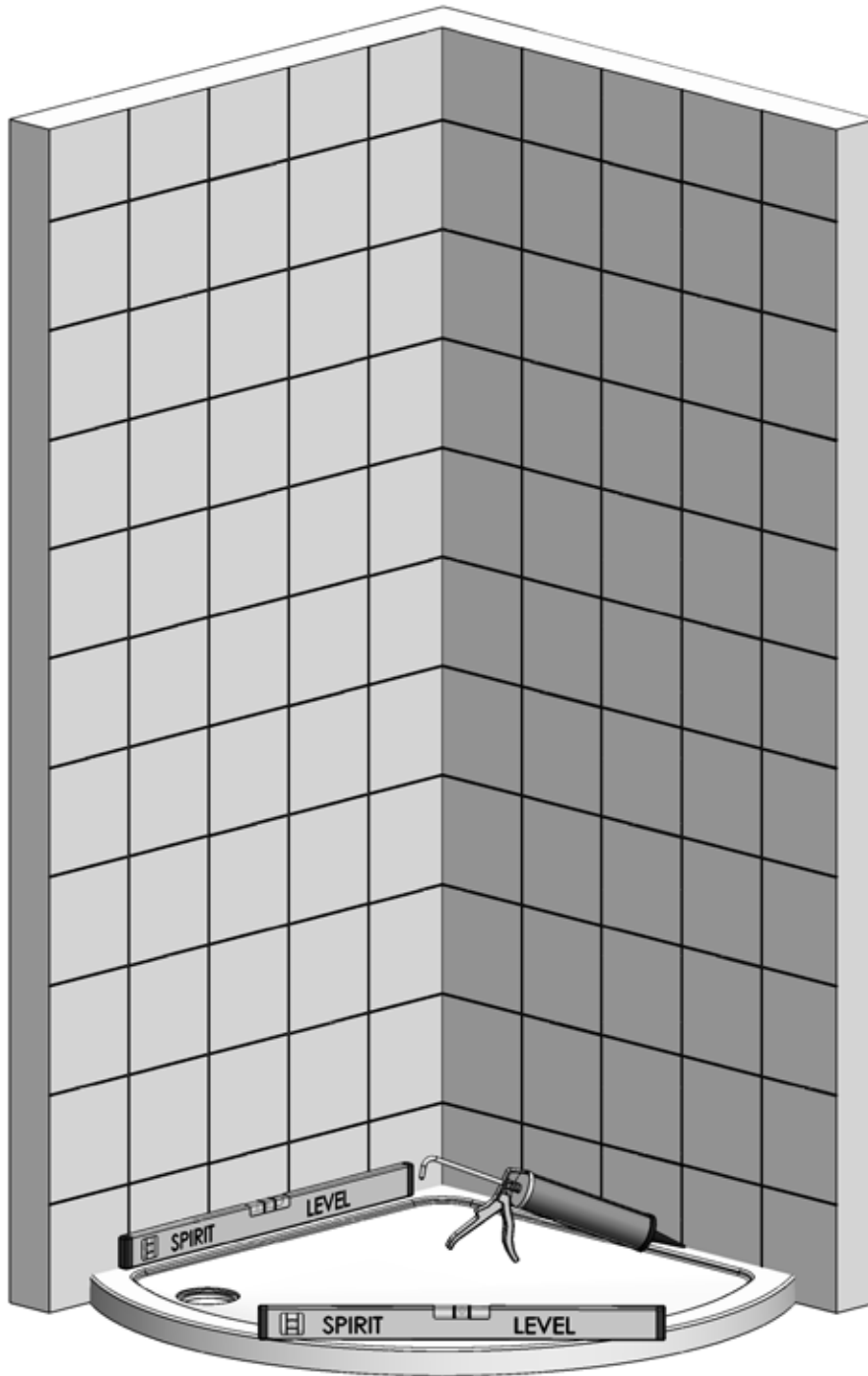

SPIRIT



LEVEL

1. Check the tray is level on all sides (the bubble on the spirit level must be in the centre of the 2 lines).
2. Stand in the tray and check that there is no adverse movement (correct if necessary).
 - **Please ensure the tray is installed as per the manufacturer's instructions.**
3. Using a Bathroom Sealant, seal the tray fully along the tiled walls prior to installing your product.
 - **Prior to fitting the enclosure spray the seal the joints with the shower head and check for leaks when the silicon has cured.**
 - **Check the plumbing for leaks.**
 - **DO NOT plasterboard over the tray.**
 - **DO NOT grout the tiles when the enclosure has been fitted, the grout may discolour the aluminium profiles.**
 - **When all of the above has been completed please proceed to the Step 2.**

Step 2 - Fitting the Wall Profiles

IMPORTANT: Wall Profiles 1 and 2 have a different angle. You must ensure that the correct Wall Profile is placed at the correct side of the tray (See images ② below).

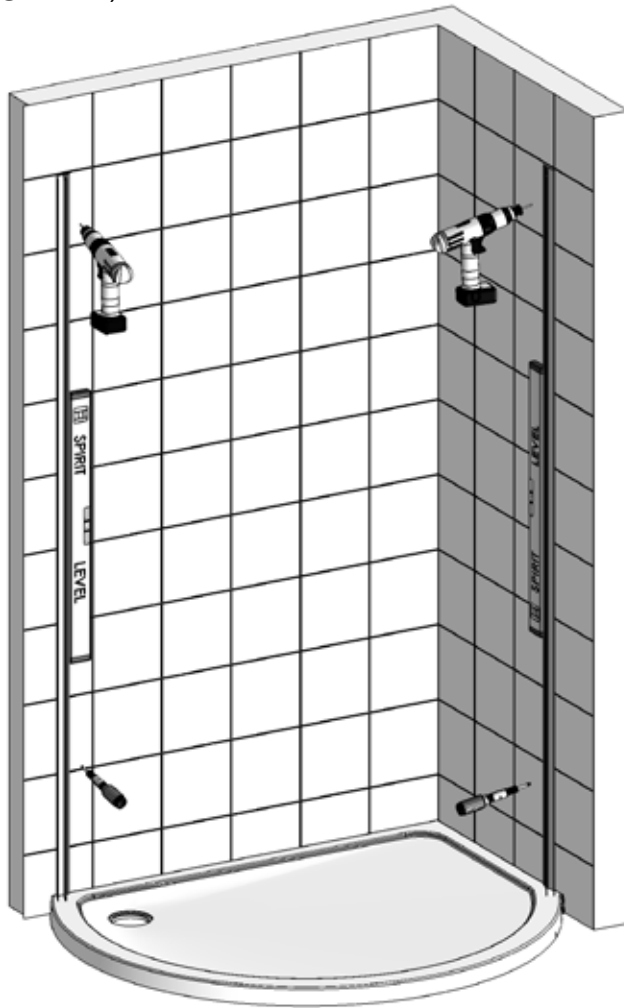
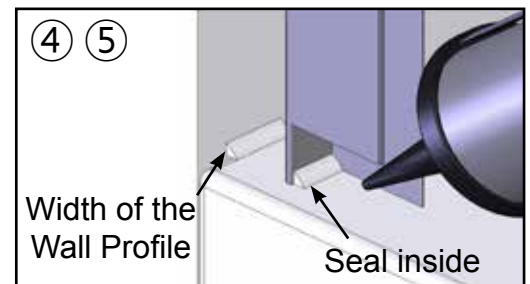
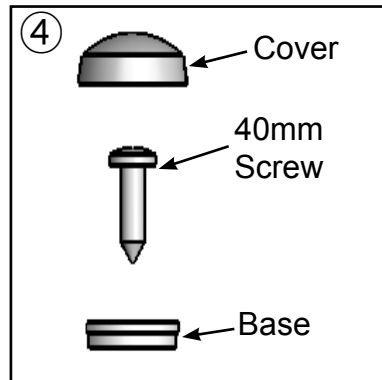
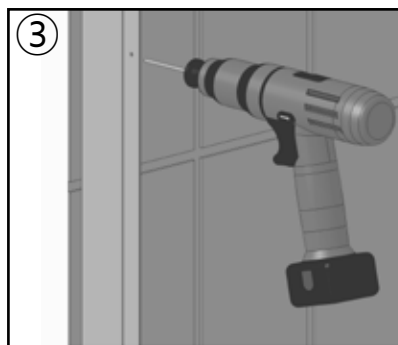
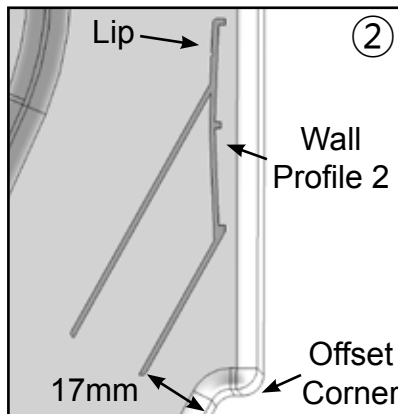
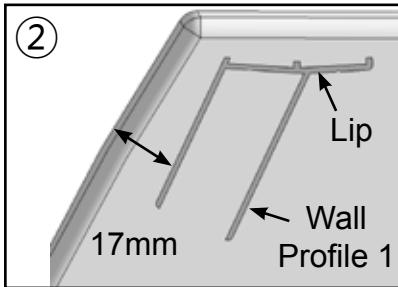
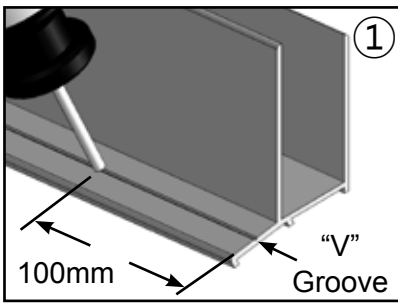

1. Drill three 4.5mm holes into the Lip Part of both Wall Profiles at the "V" groove, approximately 100mm from each end and the last one positioned in the centre.
2. Place the Wall Profiles (1 and 2) 17mm in from the outside of the tray, the lip section of the wall profile must face inward towards the shower. Make sure the wall profile is completely vertical using a spirit level and mark the wall through the drill holes with a pencil.
3. Drill the wall with a 6mm Masonry Drill Bit (not supplied) where the Wall Profiles are to be positioned. Fit the Wall Plugs supplied (if going in to a brick or block wall). If going into a plasterboard wall you will need to purchase appropriate wall fixings. Wipe clear all debris from the Tray before referring to the next stage.
4. Where both Wall Profiles are to be positioned on the Tray, place a bead of Bathroom Sealant (not supplied) the width of the Wall Profile along the tiled wall. Fit the Wall Profiles using the 40mm Screws and Caps (supplied). Ensure the Wall Profiles stay completely vertical throughout this procedure using a Spirit Level.
 - **No sealant should be present between the Wall Profiles and the tiled walls vertically prior to screw fixing.**
5. Seal the gap between the Tray and Wall Profiles with a Bathroom Sealant (not supplied).
 - **Failure to carry out procedures 4 and 5 correctly can result in serious water damage and is not covered by the Guarantee.**

Step 3 - Assemble the Frame

NOTE: 2 people will be required to carry out the following procedures.

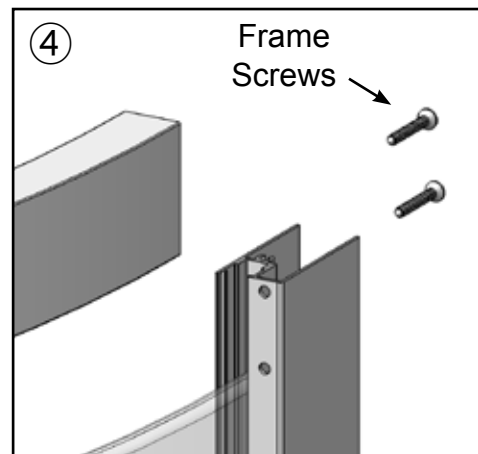
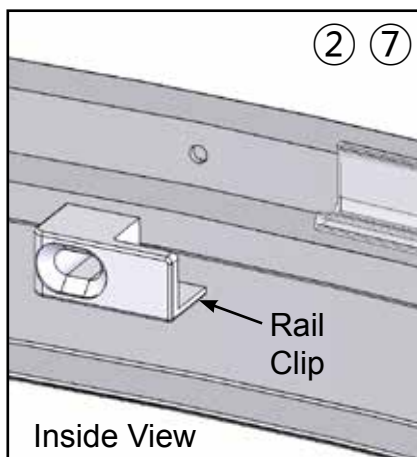
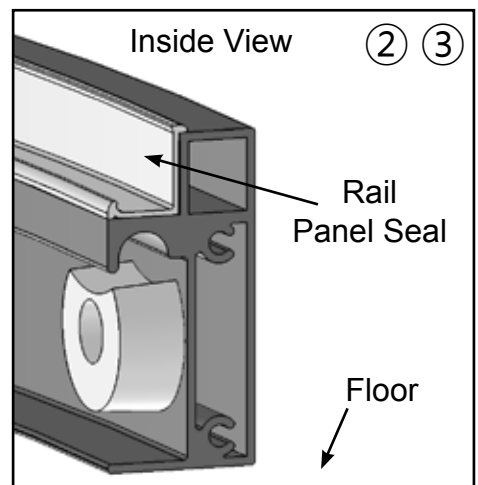
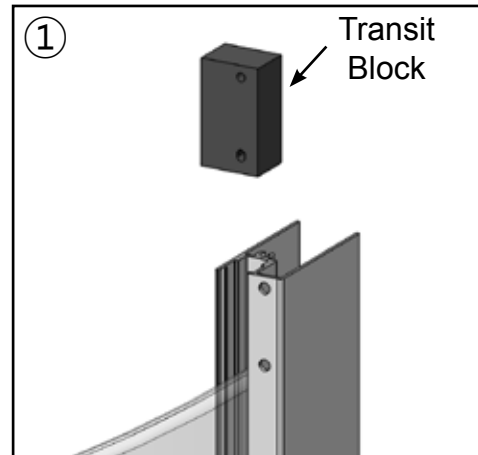
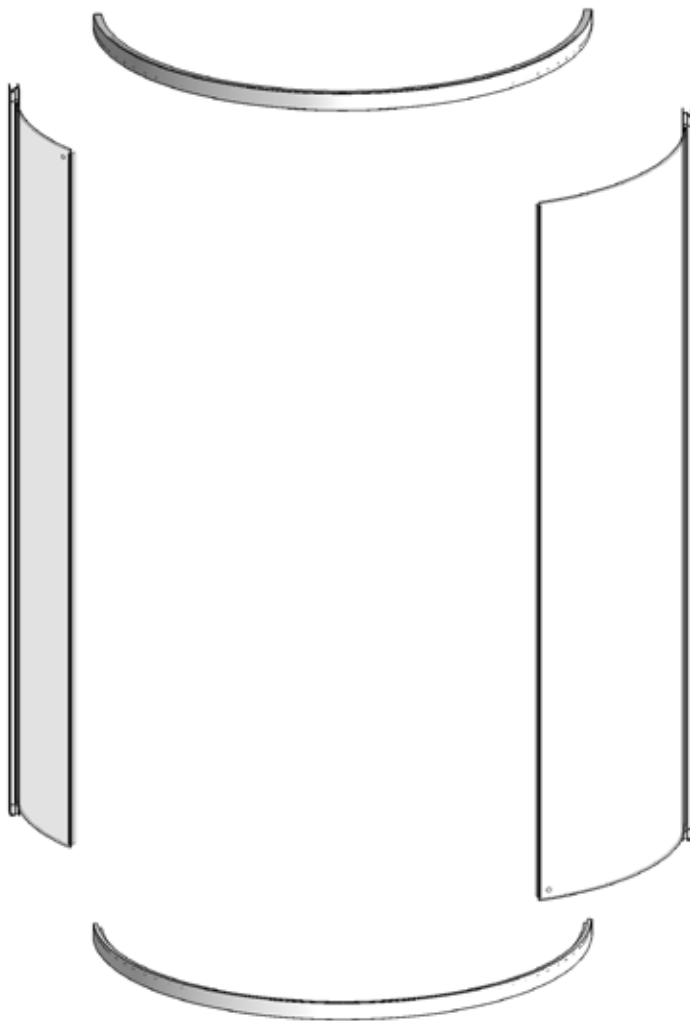

1. Remove the Red Transit Blocks from each end of the Vertical Aluminium on the Curved Panel Assemblies.
2. Place one of the Horizontal Rails onto the floor and loosen the Glass Clips.
3. Place the Rail Panel Seals onto the Horizontal Rail. Lift the Curved Panel Assembly onto the Rail ensuring the glass goes behind the Glass Clip.
4. Screw the Horizontal Rail and the Large Curved Panel Assembly together using the Frame Fixing Screws.
 - **Make sure the Horizontal Rail and Vertical Profile on the Curved Panels butt up together.**
5. Position the Small Curved Panel assembly at the other end of the Horizontal Rail and fix as per procedure 4.
6. Place the other Horizontal Rail onto the Curved Panel Assemblies ensuring you fit the Rail Panel Seals repeating procedures 3, 4 and 5.
7. Tighten all the Rail Clips to secure the glass to the horizontal rails.
 - **Push the Rail Clips up to the Glass edge as close as they will go (a small gap is normal).**

Step 4 - Fitting the Frame

NOTE: 2 people will be required to carry out the following procedures.

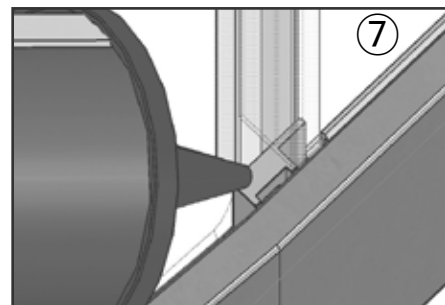
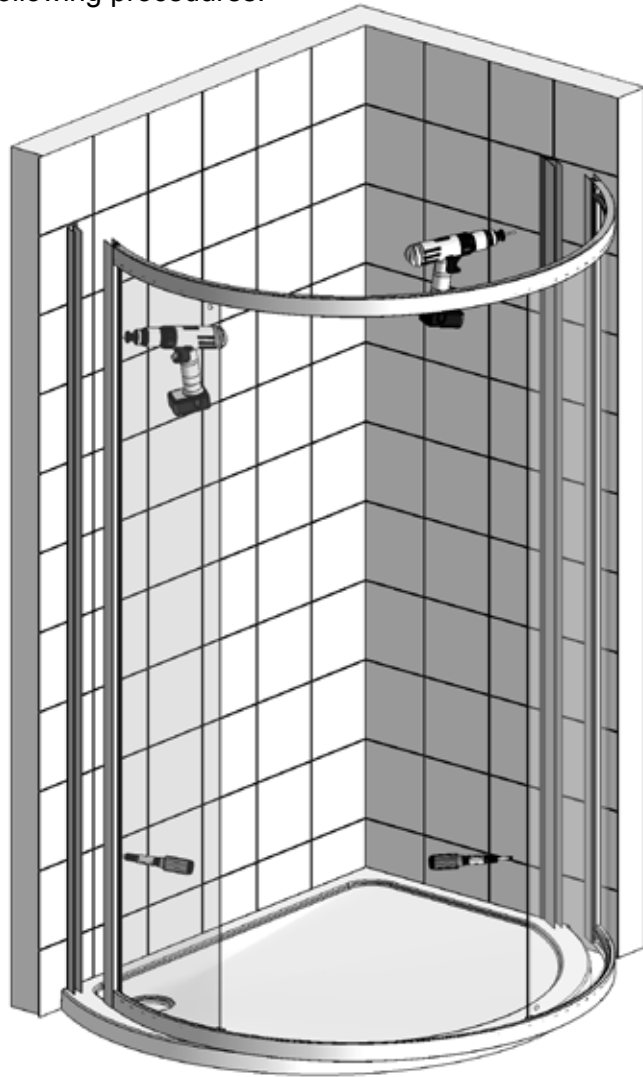
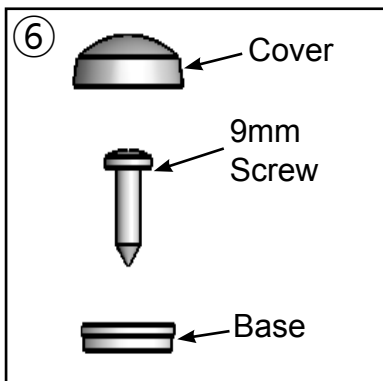
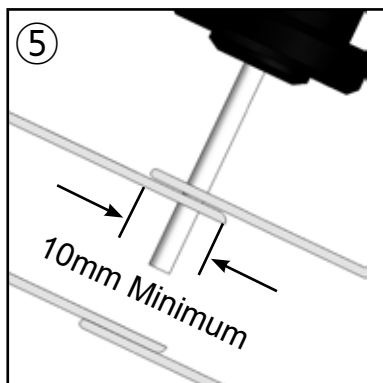
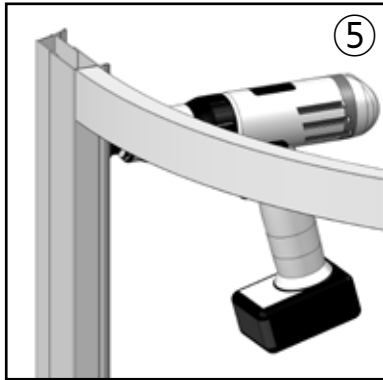

1. Carefully lift the assembled Frame onto the tray and over one Wall Profile.
2. Push the other side of the Frame over the remaining Wall Profile being careful that it doesn't come off the first Wall Profile.
3. Adjust the Frame between the Wall Profiles until it is evenly spaced.
 - **IMPORTANT: Check that the Curved Glass has NOT moved from behind the Glass Clip, correct as required.**
4. Ensure that the Frame is completely vertical and level using a Spirit Level.
 - **Check the Frame is completely vertical and level (the bubble on the spirit level must be in the centre of the 2 lines).**
5. Drill 3 holes through the Vertical Aluminium and into the Wall Profiles approximately 100mm from the top and bottom and the other in the centre with the 2.5mm drill (supplied).
NOTE: There must be a minimum of 10mm left for fixing.
6. Place the bases onto the 9mm screws and fix the Frame to the Wall Profiles, push on the Screw Cover caps.
7. Seal the gap in the rail clips with silicon sealant to prevent leaking from this area.

Step 5 - Fitting the Door and Handle

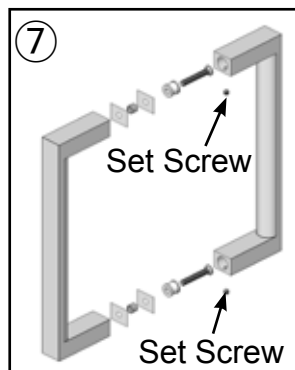
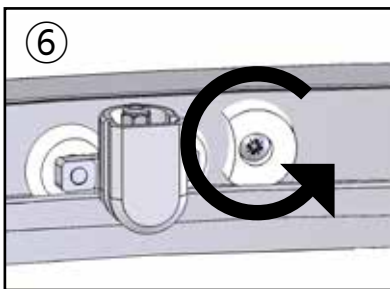
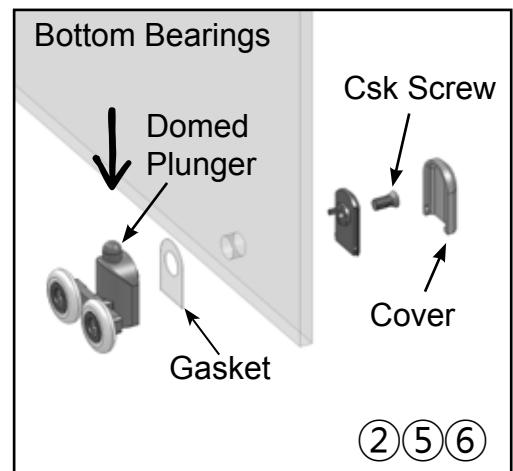
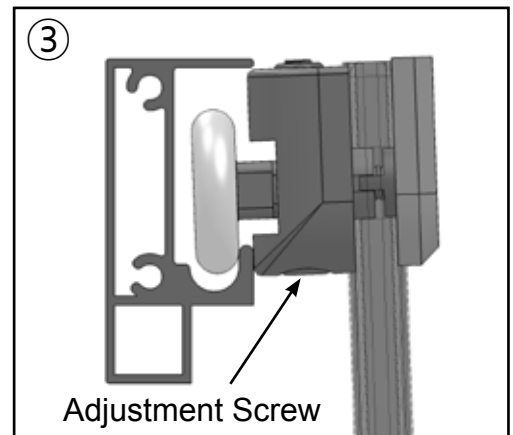
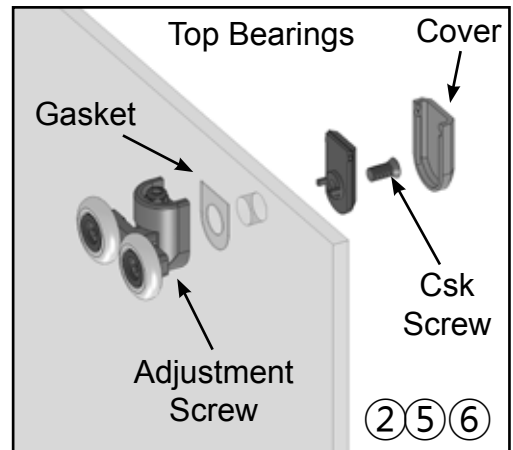
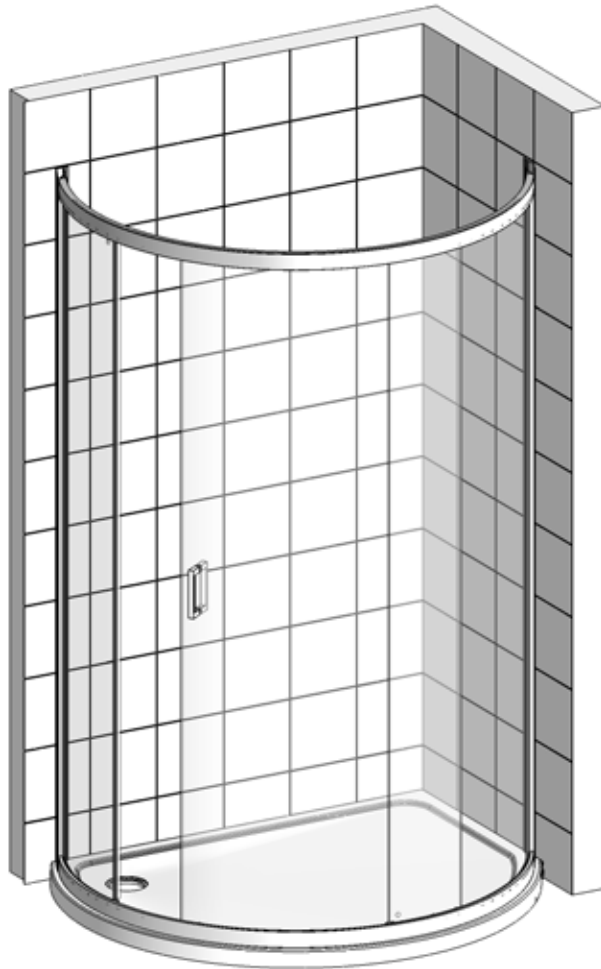

1. Place the Door Glass onto a level scratch free surface.
2. Carefully dismantle the Bearing Assemblies, place the gasket on the outside of the glass (Bearing Side) then re-assemble onto the Door Glass. Make sure you have the correct bearings at the top and bottom and that the wheels are on the outside of the glass.
 - **NOTE: The bottom bearings have a domed plunger.**
3. Carefully place the assembled door inside the tray. With the Door the correct way round offer the Top Bearings into the top Horizontal Rail, when in position lower the Door and press the plungers down on the Bottom Bearing assemblies so that the Door can be placed into the Bottom Horizontal Rail.
 - **NOTE: When fitting to the top offering the door at a slight angle will make it easier to fit into the rail.**
4. Check that the door is parallel. If the door is not parallel there is a screw in the Top Bearings for adjustment purposes, adjust as necessary to align the Door.
 - **DO NOT overtighten the adjustment screw (there is 5mm of adjustment on each bearing assembly).**
5. When satisfied with the fitting of the Door fit the Inner Bearing Covers.
6. Ensure the Door closes over the Frame Seal (rotating the Door Stops can improve how the Door closes).
7. Remove the handle from it's packaging, using the Allen Keys (supplied) remove the screws and split the handle assemblies. Fit onto the door glass ensuring the Set Screws are on the inside of the enclosure.

Step 6 - Fitting Trims and Sealing

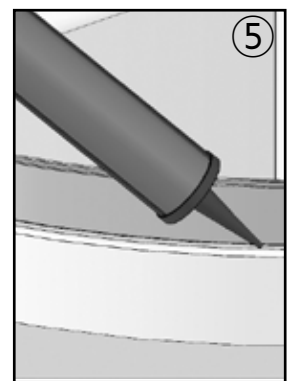
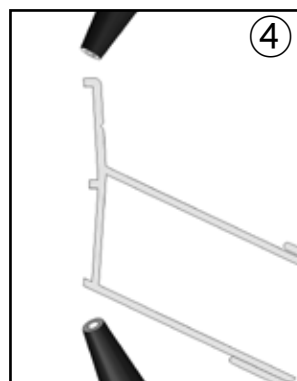
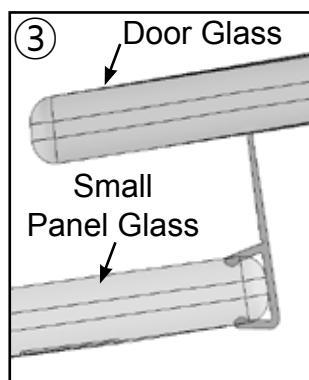
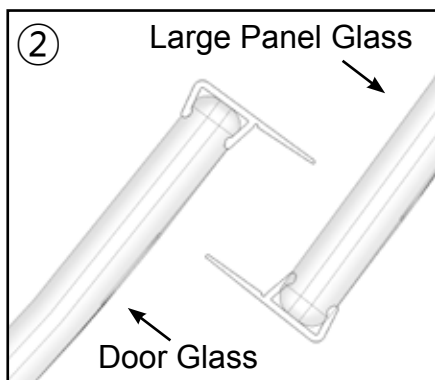
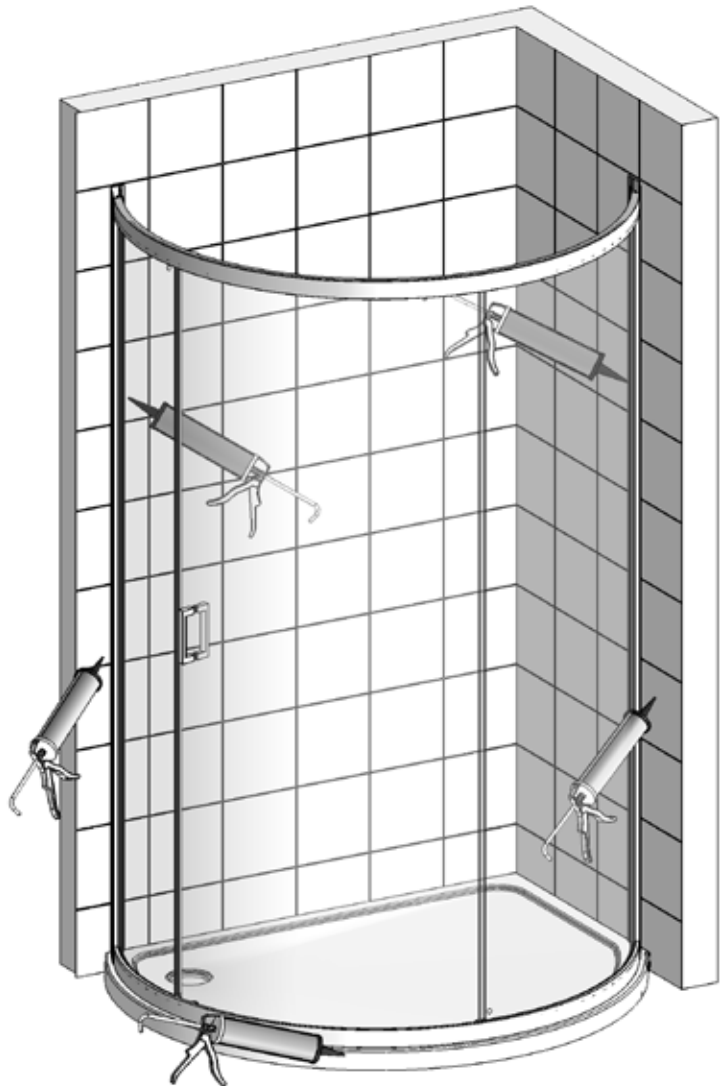
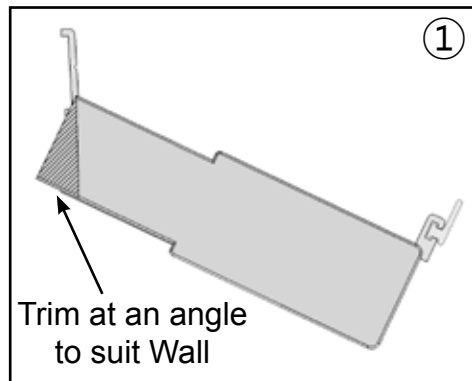
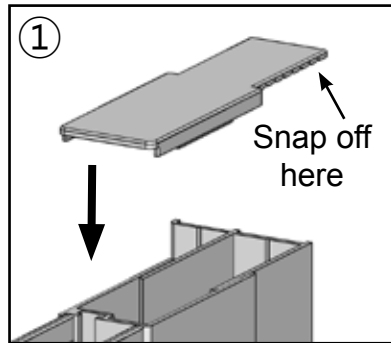
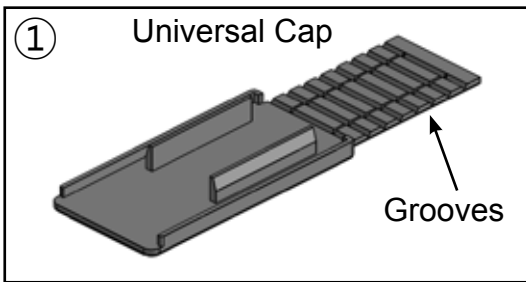

1. The Universal Caps have grooves and can be shortened by snapping off at these points. The Caps can also be trimmed to follow the angle of the Wall using a sharp pair of Snips. Fit the Caps over the Profiles.
 - **Adding a small amount of silicon between the faces will help keep them in place.**
2. Take the Vertical Seals (Short Flippers) and fit onto the edges of the Panel and Door Glass (at the opposite end to the Handle) making sure the flippers face towards each other, trim to length as necessary.
3. Take the Vertical Seal (Long Flipper) and fit it onto the Small Panel Glass with the Flipper facing the Door.
 - **Cut all the seals to length if required using snips, a Stanley knife or similar (Take care when cutting).**
4. Using a good quality sealant, seal both sides of the wall profiles vertically inside and outside where they meet the tiled walls.
5. Seal the base of the enclosure to the tray fully from wall to wall on the outside only.
6. Place the branding badge in a prominent position on a none moving part of aluminium.
 - **IMPORTANT: Failure to carry out stages 4 and 5 may result in serious water damage and will not be covered under the terms of the guarantee.**
 - **Please allow 24 hours for the sealant to fully cure before using the enclosure.**

Spare Parts

If you need to replace any damaged parts please see illustration below for parts list then call Customer Relations on 01325 328033

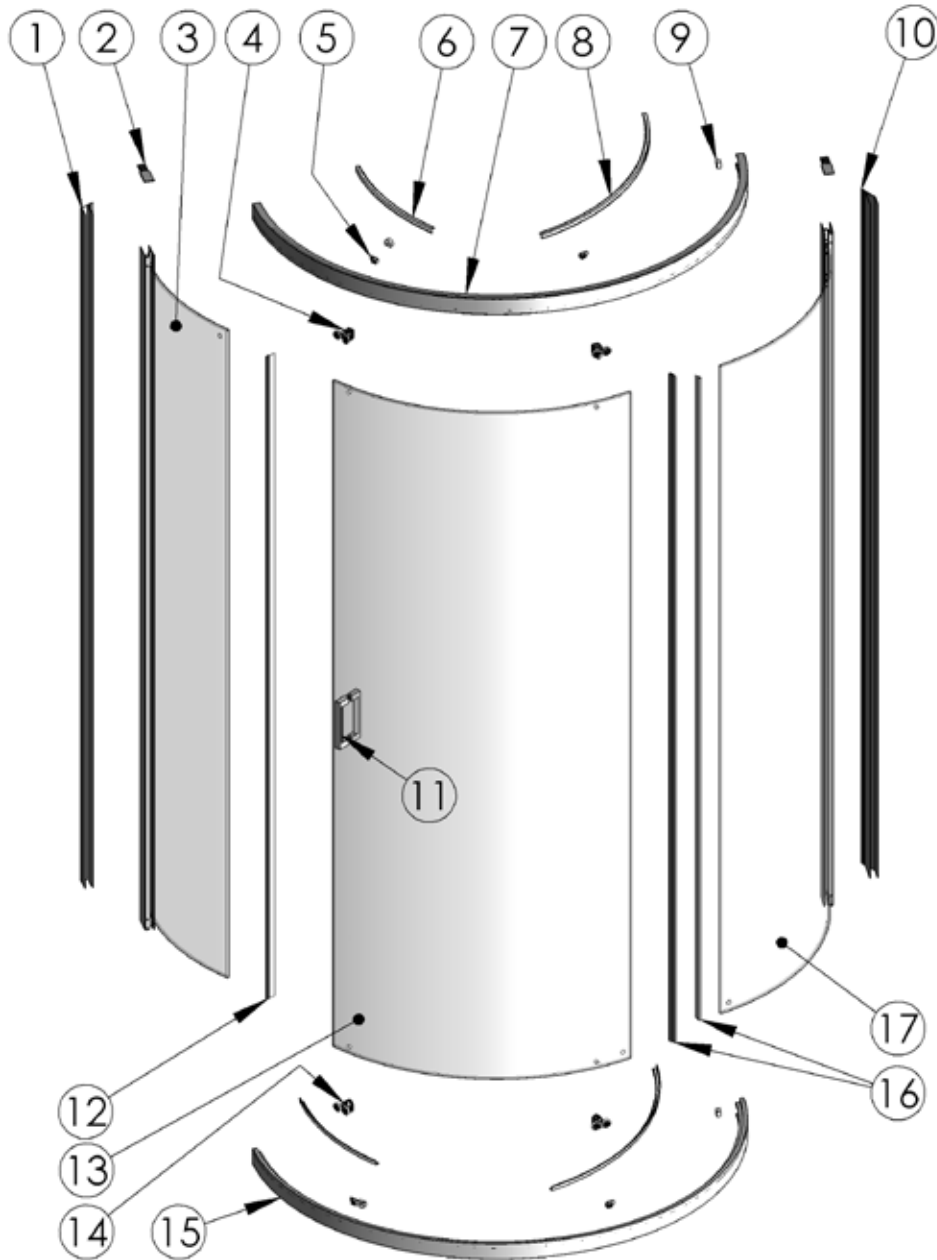

Part No.	Description	Qty	Part No.	Description	Qty	Part No.	Description	Qty
1	Wall Profile 1	1	11	Handle Assembly	1	21		
2	Universal Caps	2	12	Vertical Panel Seal (Long)	1	22		
3	Small Curved Panel Assy	1	13	Door Glass	1	23		
4	Top Bearing Assemblies	2	14	Bottom Bearing Assemblies	2	24		
5	Glass Clips	4	15	Horizontal Rail (Type B)	1	25		
6	Rail Panel Seal (Small)	2	16	Vertical Panel/Door Seals	2			
7	Horizontal Rail (Type A)	1	17	Large Curved Panel Assy	1			
8	Rail Panel Seal (Long)	2	18					
9	Door Stops	4	19					
10	Wall Profile 2	1	20					

TROUBLE SHOOTING GUIDE

Problem	Solution
Leaking	<ol style="list-style-type: none">1. Check that the inside gap between the Tray and Wall profiles has been sealed correctly.2. Ensure the tray is sealed along the tiled walls prior to installation.3. If the inside joint between the enclosure and the tray top is sealed, this will cause leakage - sealant must be removed.4. Ensure the Wall Profiles on the tiled walls are sealed both vertically inside and outside.5. Ensure the joint between the enclosure and tray top is sealed.6. Ensure the gap around the Glass Clips has been sealed. <p>Important: This enclosure should be water tested conforming to BS EN 14428</p>
Enclosure Alignment on the Tray	<ol style="list-style-type: none">1. Is the enclosure fitted onto a tiled wall?2. Are both Wall Profiles fitted 17mm from the front outside edge of the tray?3. Are the Wall Profiles completely vertical?
Door not running Smoothly	<ol style="list-style-type: none">1. Ensure both Wall Profiles are completely vertical.2. Ensure the tray is completely level.3. Ensure the enclosure has an equal gap around the tray.
Door Alignment	<ol style="list-style-type: none">1. Ensure Both Wall profiles are completely vertical.2. Ensure the tray is completely level.3. If the door is not aligned correctly, you have some adjustment in both wheel assemblies

Some important information to help you Maintain your product.

The following information is all you need to keep your product looking new.

Clean your product using a mild detergent diluted in water and then polished off using a soft cloth.

If you live in a hard water area, periodically clean your product using a 50/50 solution of white vinegar and water. The solution should be left on the enclosure for approximately 5 minutes then rinsed off using warm water. This method of cleaning should remove lime scale residue.

Simple Maintenance

Our products are generally maintenance free, however it may be necessary to lubricate wheel assemblies and other moving parts from time to time.

It is strongly recommended that a quality silicone spray is used.

A list of Don't's:

1. Don't use acidic based products which are unsuitable for cleaning enamel surfaces.
2. Don't use abrasive cleaners or cleaners using bleach or solvents, these products will adversely affect the finish of the aluminium profiles.
3. Don't use scouring pads, powder or any sharp instruments when cleaning the enclosure.

Should you experience any problems during installation please refer to the Trouble Shooting Guide or contact Customer Relations on:

+44 (0) 1325 328033

To enable customer relations to provide you with an excellent level of service it is important that you quote your product Code and Reference Number - these can be found on the Guarantee card.