

Walk-In

Instruction Manual

ESPD



IMPORTANT INFORMATION

- Toughened glass is completely safe for use in our shower enclosures and bath screens; providing our products are installed according to our guidelines.
- It is important to note that the glass must not be mounted or 'pinched' in such a way that would cause a stress point to develop in the glass. In addition, it must not be subject to any sharp impact or severe temperature fluctuation which may also cause a stress point to develop in the glass.
- Toughened glass is physically and thermally significantly stronger than standard glass. During the toughening process the stresses contained within any glass are balanced so if in the unlikely event situation any of the above occurs and the glass breaks, the glass will shatter safely into small thumbnail sized blunt fragments.

PRE-INSTALLATION CHECKS

1. Check you have the correct product. Please look at the labels on the side of the product packaging.
2. Check all the product components are in the box and the fixing kits.
3. Unpack your product and handle it with care.
4. Please check the product for defects or damage, once the installation has commenced we cannot accept responsibility for any defects or damage.
5. Please take time to read these instructions prior to installing your product.
6. Before you commence any drilling check there are no hidden electrical cables and/or water pipes.
7. No attempt should be made to re-work the toughened safety glass.
8. The installation of the product should be performed by two persons.
9. It is strongly recommended that the walls the product is going to be installed on are vertical.
10. It is strongly recommended the product is fitted on a tiled surface or similar waterproof surface.
11. It is strongly recommended the walls are tiled and grouted before the product is installed.
12. If the walls and/or the tray are not level you will not achieve maximum adjustment of the product.
13. Pictures used are for illustration purposes only, product designs may alter slightly as a result of continuing product development.
14. We do not stipulate where the European Standard Kite Mark should be positioned on the glass when being factory assembled.
15. Please note that some natural misting may occur when you remove this product from its packaging, due to the addition of the glass protection pre-coating. If this does occur this can easily be removed with a soft, dry cloth.

Component Check List: Supplied

Description	Quantity
Fixed Panel Glass	1
Door Glass	1
Wall Profile	1
Brace Bar Panel Joint	1
Expanding Joint	1
25mm Brace Bar	1
Brace Bar Wall Joint	1
Hinge	2
Vertical Seal	1
Handle	1
Branding Clip	1

Equipment Check List: Not Supplied

Description
PZ2 Pozidrive Screwdriver
Bathscreen Sealant Gun
Spirit Level (large)
Drill and 6mm Masonry Bit
Tape Measure
Pencil
Hacksaw

Fixing Kit Components

Description	Quantity
40mm Screws	4
Wall Plugs	4
9mm Screws	3
Allen Keys	2
3mm Drill Bit	1
Profile Cover Caps	2
Coloured Caps and Bases	3

CONSUMER GUARANTEE

Please make sure the purchaser/end user completes and returns the guarantee card which is enclosed with this product. Failure to validate the Guarantee will mean only the 1 Year Statutory Guarantee will apply.

Step 1 - Fixing the Wall Profile

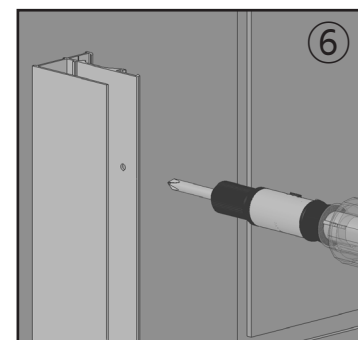
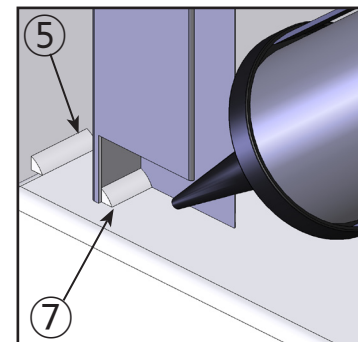
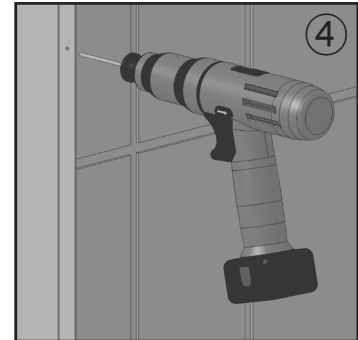
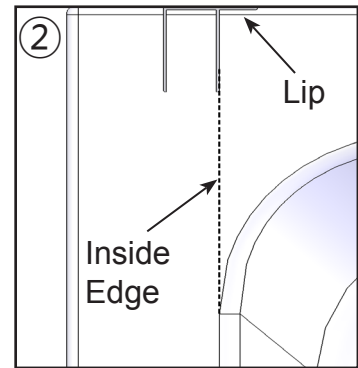
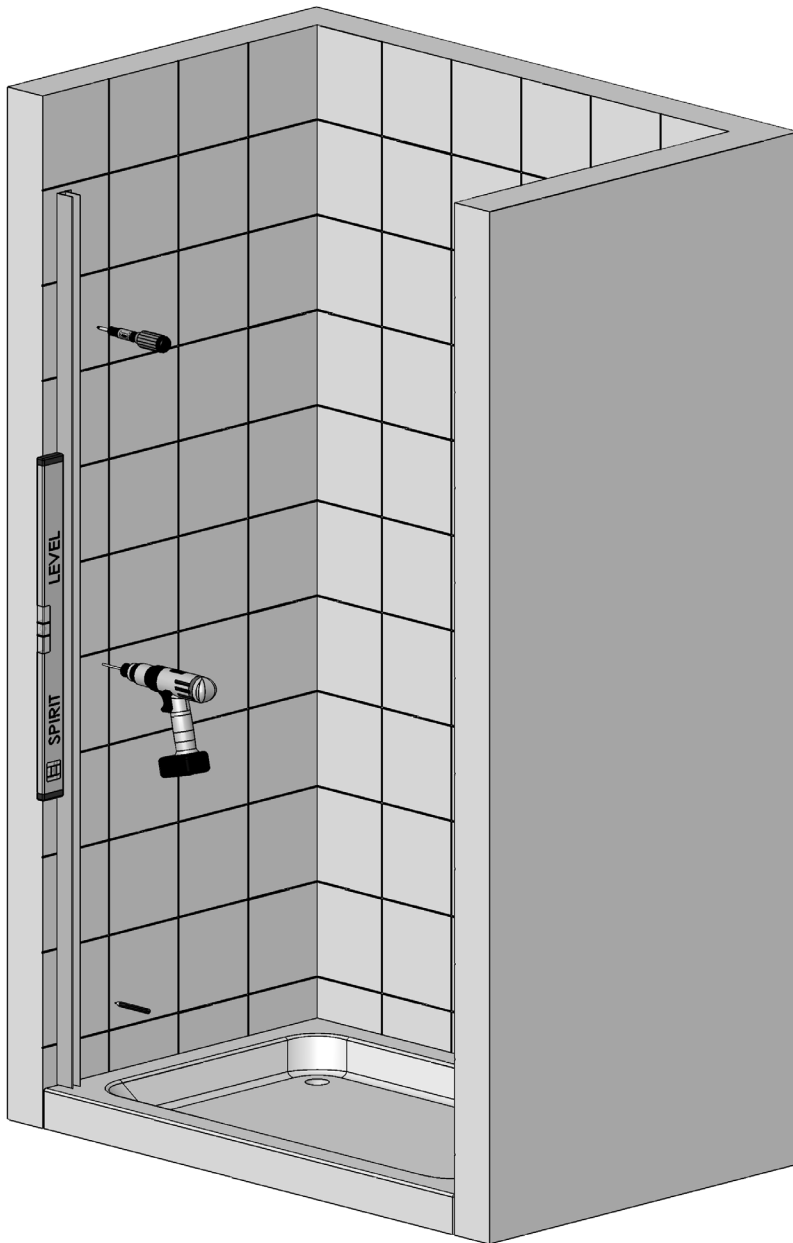

1. Decide which side of the tray the wall profile is going to go on.
2. Place the wall profile so that it lines up with the inside edge of the tray and that it is completely vertical. The lip should be positioned so that it is on the inside of the tray.
 - **The wall profiles must be completely vertical (the bubble should be in the centre of the 2 lines on the spirit level).**
3. Using a pencil, mark through the slots in the “U” section of the wall profile onto the wall.
4. Drill the holes using a 6mm masonry drill bit (not supplied) and then push fit the wall plugs (supplied).
5. Remove any debris and apply a bead of silicon the width of the wall profile at the bottom where it meets the tray.
6. Screw fix the wall profile using the 40mm screws (supplied) making sure that it is completely vertical.
 - **The wall profiles must be completely vertical (the bubble should be in the centre of the 2 lines on the spirit level).**
7. Apply a bead of silicon the inside of the wall profile at the bottom where it meets the tray.
 - **IMPORTANT: Failure to carry out stages 5 and 7 can result in serious water damage and is not covered under the terms of the guarantee.**

Step 2 - Fitting the Fixed Panel

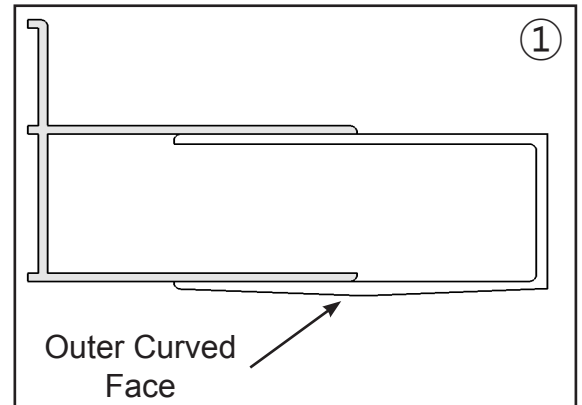
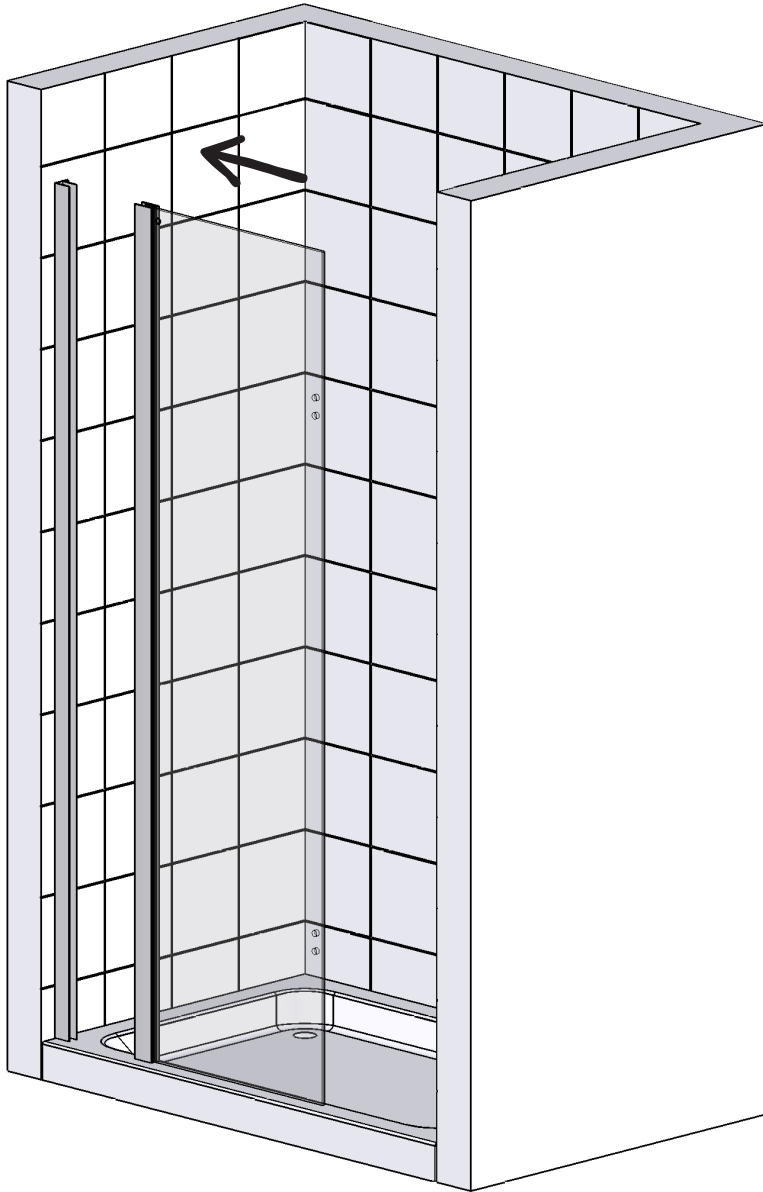

Outer Curved Face

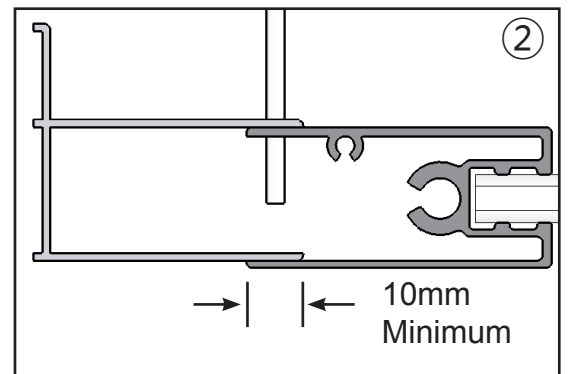

10mm Minimum

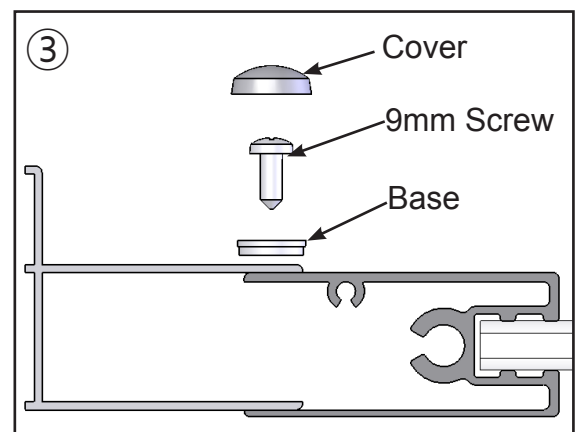

Cover

9mm Screw

Base

1. Offer the Fixed Panel into position on the tray and into the Wall Profile. Ensure the glass is parallel to the front of the tray.
 - **NOTE: The Fixed Panel vertical straddles the Wall Profile with the curved face on the outside.**
2. With the 2.5mm drill bit (supplied) drill through the Wall Profile into the vertical profile approximately 100mm from the top and bottom and one in the centre. A minimum of 10mm for the screws is required.
 - **The wall profiles must be completely vertical (the bubble should be in the centre of the 2 lines on the spirit level).**
3. Fit the bases to the 9mm screws and screw fix the panel to the Wall Profile. Push fit the covers.

Step 3 - Fitting the Door Glass, Handle

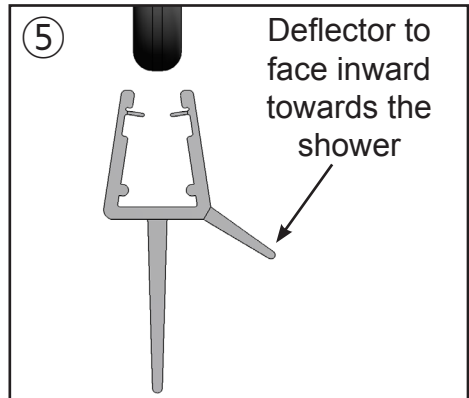
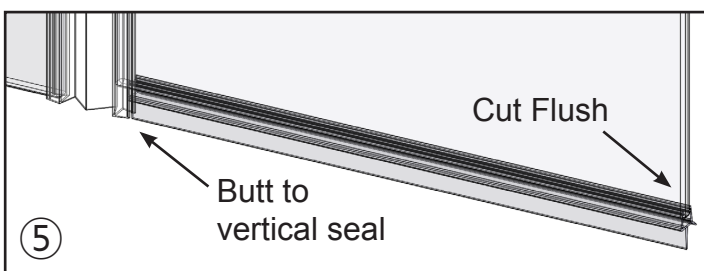
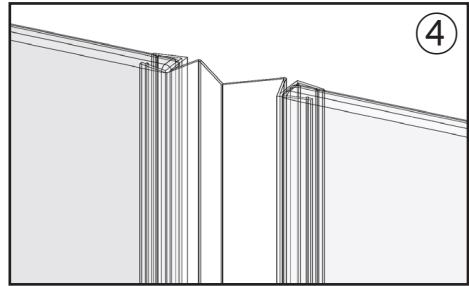
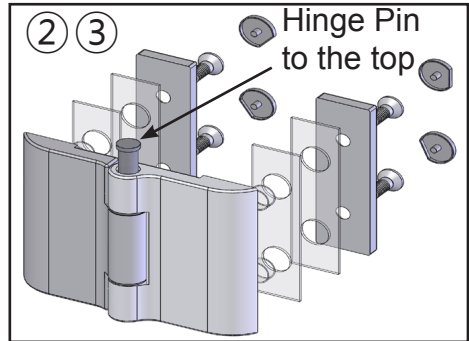
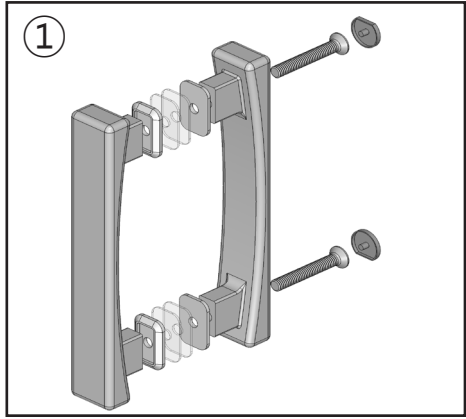
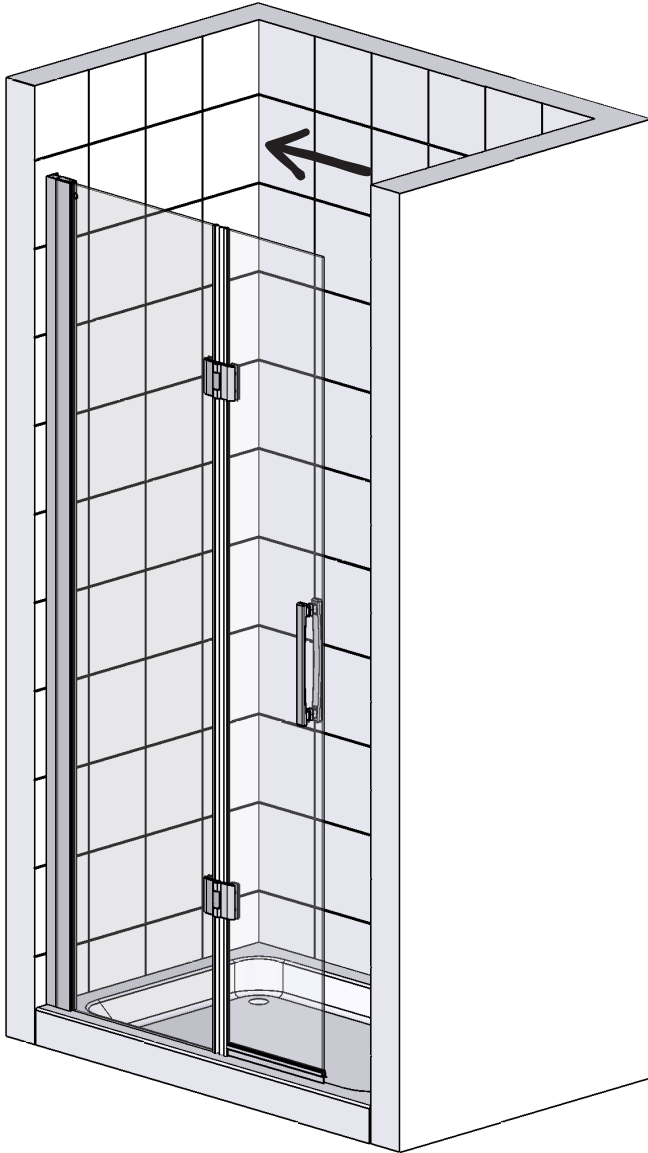

1. Dismantle the handle and reassemble it onto the door glass ensuring the soft gaskets go between the glass and handle.
2. Dismantle the hinges and reassemble them onto the fixed panel glass ensuring the soft gaskets go between the glass and the hinges.
 - **IMPORTANT: Ensure that the hinges are fitted the correct way up, the head of the hinge pin should be at the top of the hinge only.**
3. Lift the door glass into position and assemble the hinges onto it ensuring the soft gaskets go between the glass and the hinges.
4. Fit the vertical seal between the panel and door glass making sure that the web part is on the outside of the product.
5. Fit the bottom seal onto the door glass making sure that it butts up to the vertical seal and the deflector part is facing inward, cut to length so that the other end is flush with the end of the door glass.
6. Check that the hinges are aligned 90° To the top of the glass and adjust if necessary. Once satisfied tighten all the screws and fit the screw cover caps.

Step 4 - Fitting the Bracing

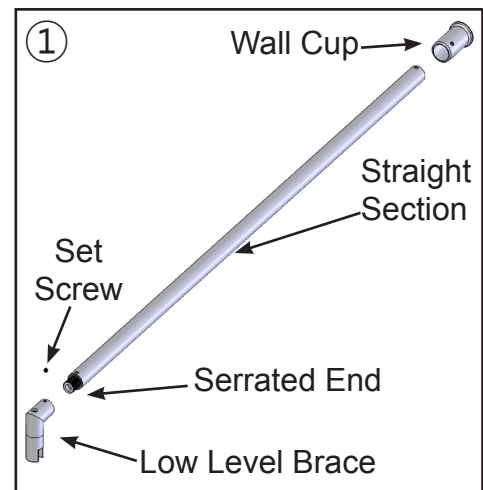
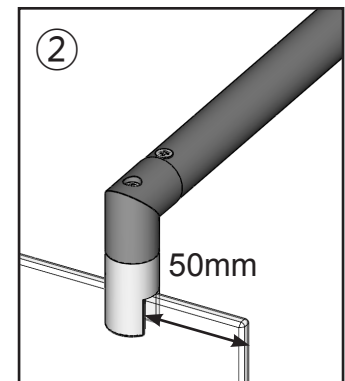
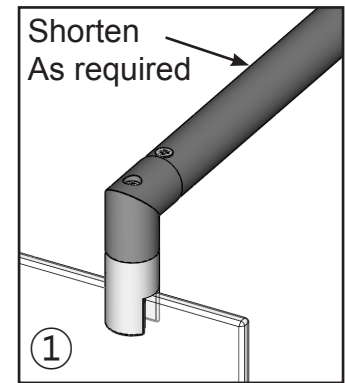
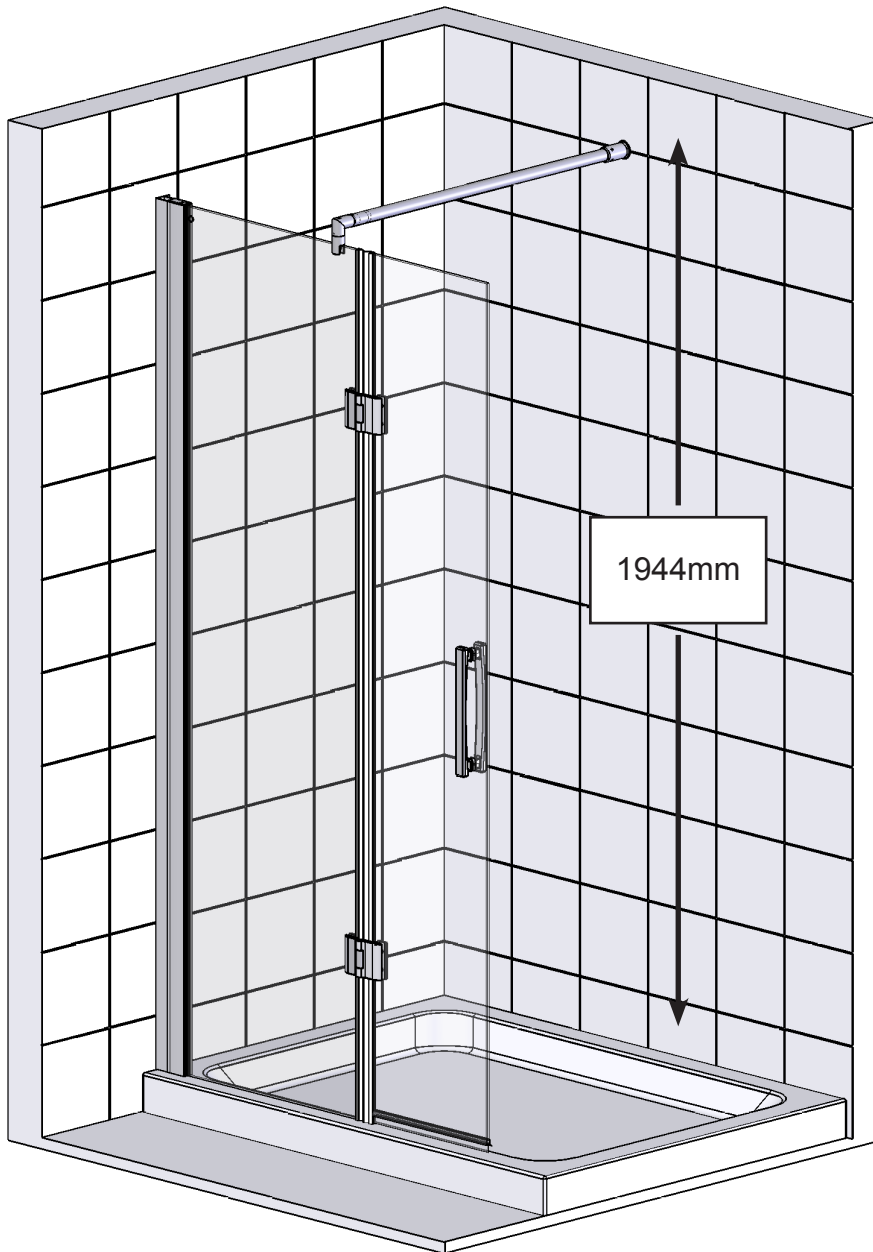

1. Assemble the brace bar components together and dry fit between the panel and wall. Cut down the straight section of the brace bar to the required length if required.
2. Measure and drill a hole in the wall parallel to the fixed panel at a height of 1944mm from the base of the glass panel (top of the tray). The bracing must be set in from the end of the panel by a minimum of 50mm.
3. After drilling the wall with a 6mm masonry drill bit (not supplied) fit the wall plug (supplied).
4. With a 40mm screw (supplied) fit the wall cup assembly to the wall. Keep the slot in the wall cup vertical.
5. Fit the bracing onto the glass panel and into the wall cup, check that all is level and tighten all the screws.
 - **IMPORTANT: Ensure the spacers are between the glass and metal parts before tightening.**

Step 5 - Fit Top Cap and Seal

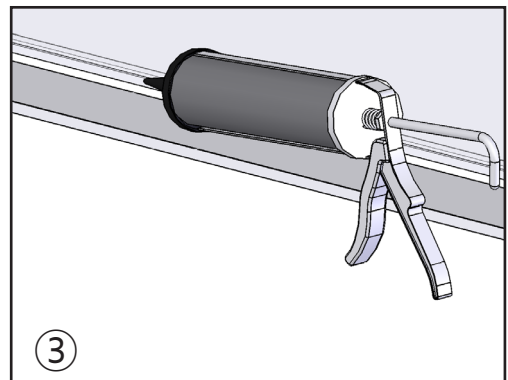
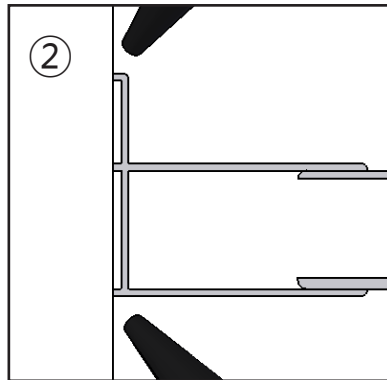
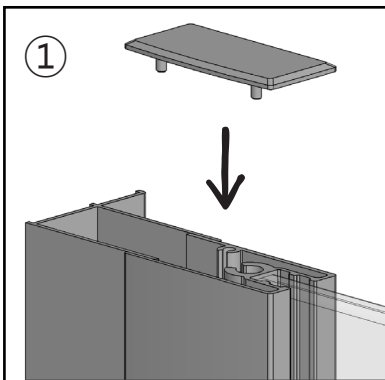
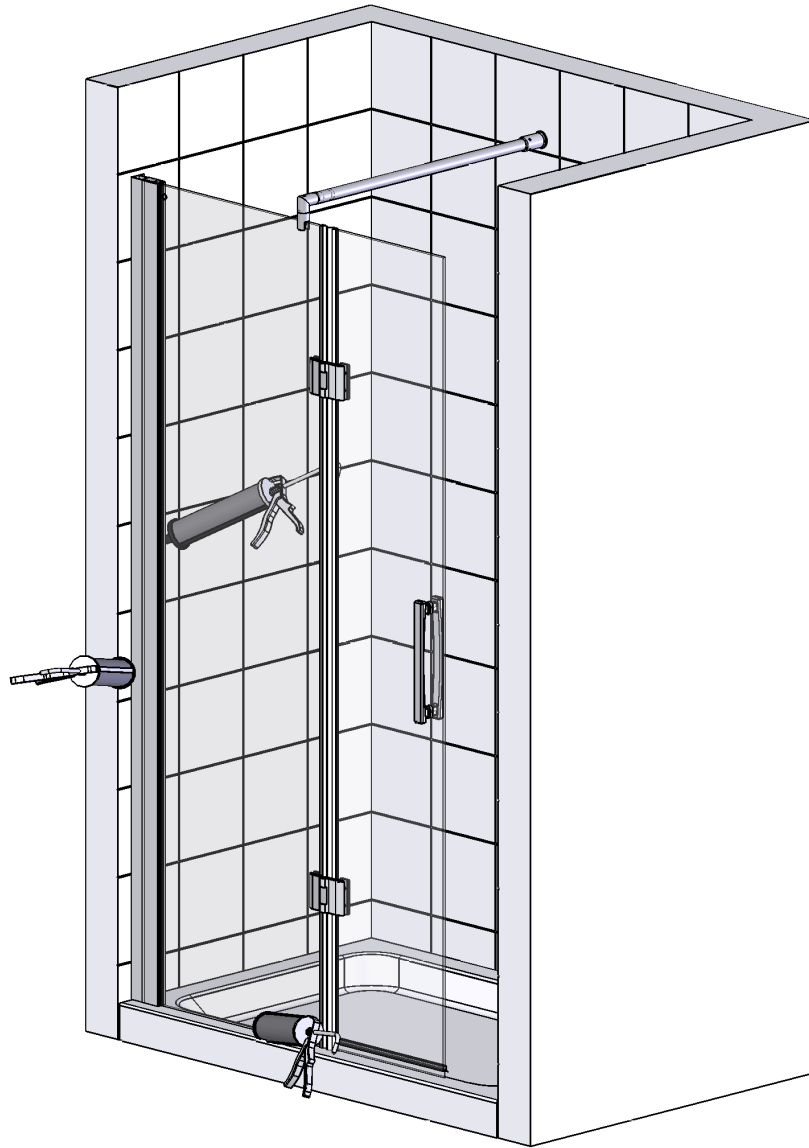

1. Fit the top cap to the top of the vertical on the fixed panel (adding a small amount of silicon will help keep it in place).
2. Seal the wall profile vertically, both internally and externally where it meet the tiles.
3. Seal the base of the fixed panel to the top of the tray on the outside only.
 - **IMPORTANT: Failure to carry out stages 2 and 3 may result in serious water damage and is not covered under the terms of the guarantee.**
 - **DO NOT seal the base of the product to the inside, failure to comply may result in the product leaking.**
 - **Allow 24 hours for the sealant to fully cure prior to using the shower.**
4. Place the branding badge in a prominent position on a none moving part of aluminium.

Spare Parts

If you need to replace any damaged parts please see illustration below for parts list then call Customer Relations on 01325 328033/328034

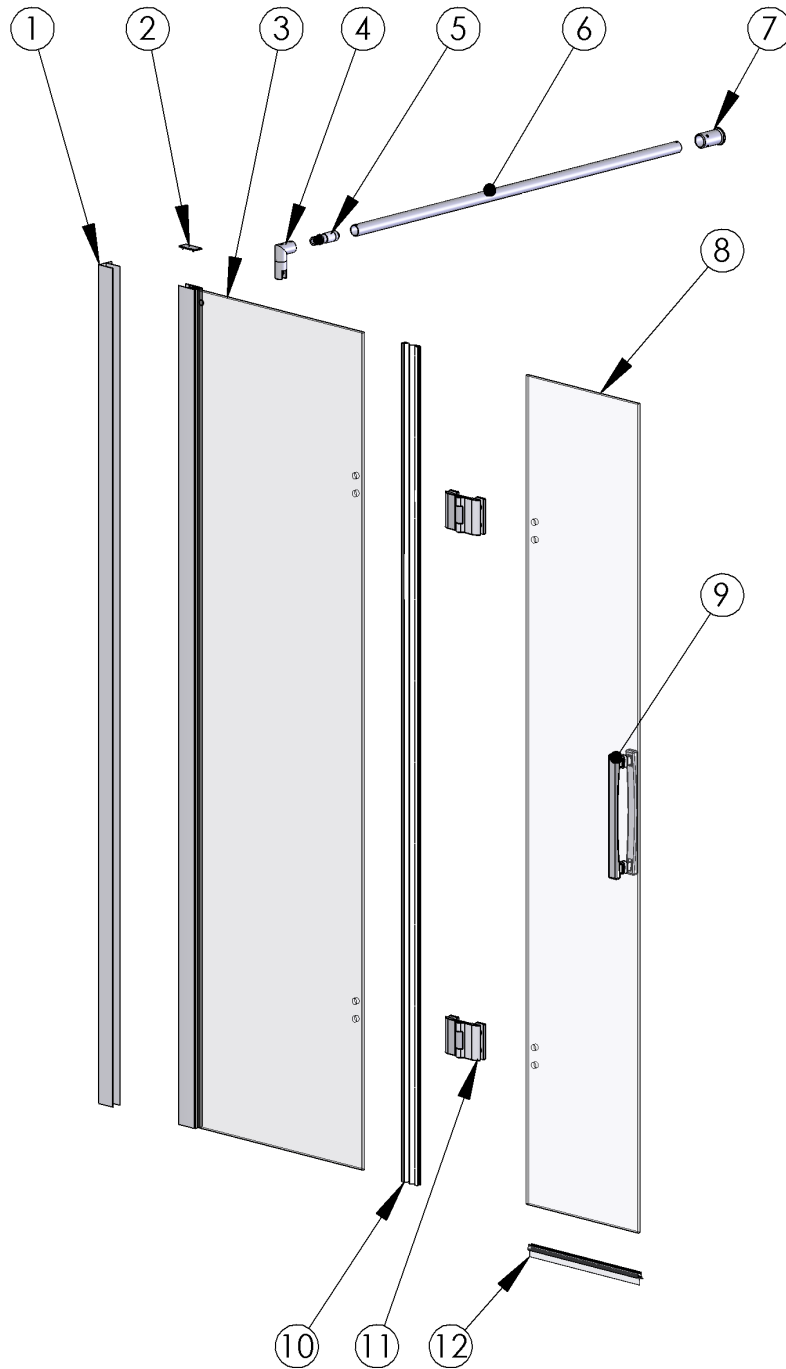

Part No.	Description	Q'ty	Part No.	Description	Q'ty	Part No.	Description	Q'ty
1	Wall Profile	1	11	Hinge Assembly	2	21		
2	Top Cap	1	12	Bottom Seal	1	22		
3	Fixed Panel	1	13			23		
4	Brace Bar Panel Joint	1	14			24		
5	Expanding Joint	1	15			25		
6	25mm Brace Bar		16					
7	Wall Cup Assembly	1	17					
8	Door Glass	1	18					
9	Door Handle	1	19					
10	Vertical Seal	1	20					

TROUBLE SHOOTING GUIDE

Problem	Solution
Leaking	<ol style="list-style-type: none">1. Check that the inside gap between the Tray and Wall profiles has been sealed correctly.2. Ensure the tray is sealed along the tiled walls prior to installation.3. If the inside joint between the enclosure and the tray top is sealed, this will cause leakage - sealant must be removed.4. Ensure the wall profiles on the tiled walls are sealed both vertically inside and outside.5. Ensure the joint between the enclosure and tray top is sealed. <p>Important: This enclosure should be water tested conforming to BS EN 14428</p>
Panel Moving	<ol style="list-style-type: none">1. Check the brace bar has been fitted correctly and all screws have been fully tightened.

Some important information to help you Maintain your product.

The following information is all you need to keep your product looking new.

Clean your product using a mild detergent diluted in water and then polished off using a soft cloth. If you live in a hard water area, periodically clean your product using a 50/50 solution of white vinegar and water. The solution should be left on the enclosure for approximately 5 minutes then rinsed off using warm water. This method of cleaning should remove lime scale residue.

Simple Maintenance

Our products are generally maintenance free, however it may be necessary to lubricate wheel assemblies and other moving parts from time to time.

It is strongly recommended that a quality silicone spray is used.

A list of Don't's:

1. Don't use acidic based products which are unsuitable for cleaning enamel surfaces.
2. Don't use abrasive cleaners or cleaners using bleach or solvents, these products will adversely affect the finish of the aluminium profiles.
3. Don't use scouring pads, powder or any sharp instruments when cleaning the enclosure.

Should you experience any problems during installation please refer to the Trouble Shooting Guide or contact Customer Relations on:

+44 (0) 1325 328033/328034

To enable customer relations to provide you with an excellent level of service it is important that you quote your product Code and Reference Number - these can be found on the Guarantee card.