

Decem Sliding Door (Corner Fitting)

Instruction Manual

DXT



IMPORTANT INFORMATION

- Toughened glass is completely safe for use in our shower enclosures and bath screens; providing our products are installed according to our guidelines.
- It is important to note that the glass must not be mounted or 'pinched' in such a way that would cause a stress point to develop in the glass. In addition, it must not be subject to any sharp impact or severe temperature fluctuation which may also cause a stress point to develop in the glass.
- Toughened glass is physically and thermally significantly stronger than standard glass. During the toughening process the stresses contained within any glass are balanced so if in the unlikely event situation any of the above occurs and the glass breaks, the glass will shatter safely into small thumbnail sized blunt fragments.

PRE-INSTALLATION CHECKS

1. Check you have the correct product. Please look at the labels on the side of the product packaging.
2. Check all the product components are in the box and the fixing kits.
3. Unpack your product and handle it with care.
4. Please check the product for defects or damage, once the installation has commenced we cannot accept responsibility for any defects or damage.
5. Please take time to read these instructions prior to installing your product.
6. Before you commence any drilling check there are no hidden electrical cables and/or water pipes.
7. No attempt should be made to re-work the toughened safety glass.
8. The installation of the product should be performed by two persons.
9. It is strongly recommended that the walls the product is going to be installed on are vertical.
10. It is strongly recommended the product is fitted on a tiled surface or similar waterproof surface.
11. It is strongly recommended the walls are tiled and grouted before the product is installed.
12. If the walls and/or the tray are not level you will not achieve maximum adjustment of the product.
13. Pictures used are for illustration purposes only, product designs may alter slightly as a result of continuing product development.
14. We do not stipulate where the European Standard Kite Mark should be positioned on the glass when being factory assembled.
15. Please note that some natural misting may occur when you remove this product from its packaging, due to the addition of the glass protection pre-coating. If this does occur this can easily be removed with a soft, dry cloth.

Equipment Check List: Not Supplied

Description
Electric / Battery Drill
Pozi Screwdriver
Sealant
Sealant Gun
Spirit Level (Large)
7mm Masonry Drill Bit
Tape Measure
Pencil
Stanley Knife / Snips

Component Check List: Supplied

Description	Quantity
Wall Profiles	2
Wall Profile Covers	4
Large Panel and Thin Panel Assemblies	1 of each
Return Panel Assembly	1
Door Glass	1
Handle Assembly	1
Vertical Panel Seals	2
Door Bottom Rail (Sloped)	1
Wall Profile Top Caps	2
Bottom Rail (Long)	1
90° Corner Brackets	2
Blanking Ends	2
Bottom Rail (Return Panel)	1
Bearing Assemblies	2

Fixing Kit Components

Quantity

Description	DXT	DX2R
2.5mm Drill Bit	1	-
3mm Allen Key	1	-
4mm Allen Key	1	-
9mm long Cap Head Screws	10	10
9mm long Csk Head Screws	2	2
M4 x 10mm long Csk Head Screws	4	-
12mm long Csk Head Screws	1	1
40mm long Cap Head Screws	8	8
Wall Plugs (Brown)	8	8
Branding Clip	1	-

CONSUMER GUARANTEE

Please make sure the purchaser/end user completes and returns the guarantee card which is enclosed with this product. Failure to validate the Guarantee will mean only the 1 Year Statutory Guarantee will apply.

Step 1 - Pre-Installation Checks and Aperture Sizes

Door Code	Adjustment (Minimum)	Adjustment (Maximum)
DXT12	1165	1180
DXT14	1365	1380
DXT17	1665	1680

IMPORTANT: The above are finished tiled sizes

Panel Code	Adjustment (Minimum)	Adjustment (Maximum)
DX2R8	1165	1180
DX2R9	1365	1380

IMPORTANT: The above are finished tiled sizes

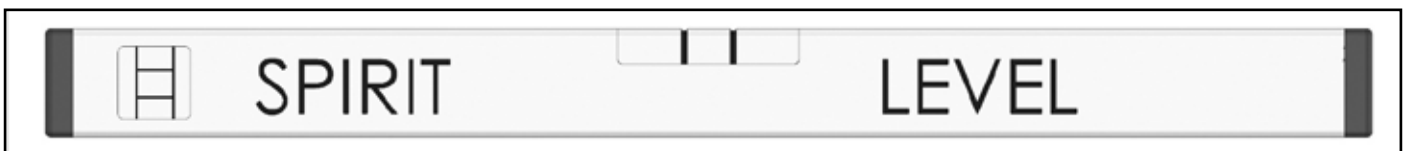
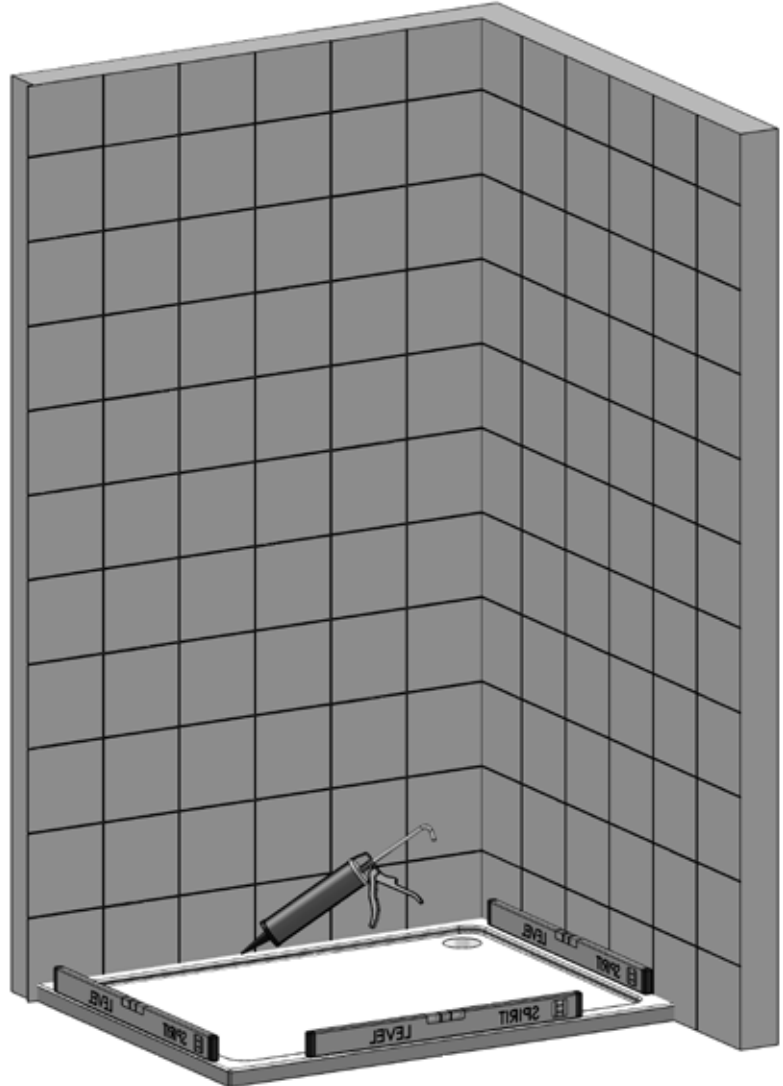
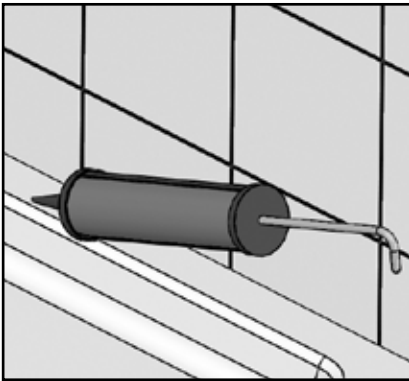

1. Check the tray is level on all sides (the bubble on the spirit level must be in the centre of the 2 lines).
2. Stand in the tray and check that there is no adverse movement (correct if necessary).
3. The walls should be tiled and grouted up to the tray.
4. The tiles and the tray should be sealed using a good quality bathroom sealant.
 - **Spray the seal and joints with the shower head and check for leaks when the silicon has cured.**
 - **Check the plumbing for leaks.**
 - **DO NOT plasterboard over the tray.**
 - **DO NOT grout the tiles when the enclosure has been fitted, the grout may discolour the aluminium profiles.**
 - **Make sure the tray is installed as per the manufacturer's instructions.**
 - **When all of the above has been completed please proceed to the Step 2.**

Step 2 - Wall Profiles

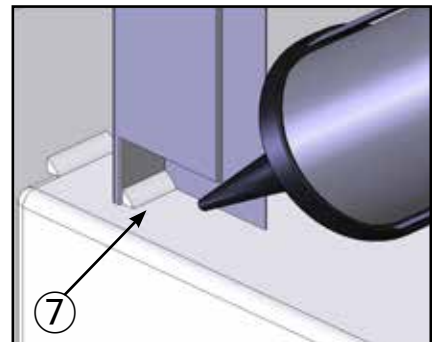
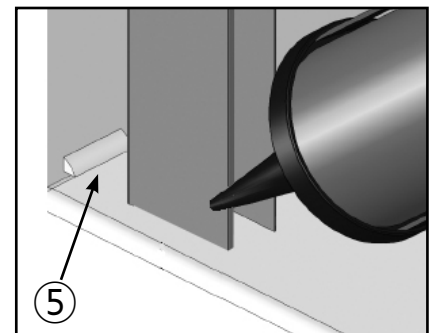
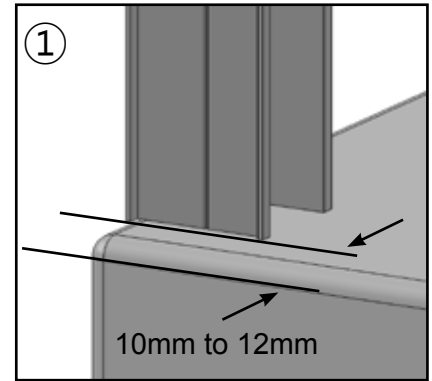
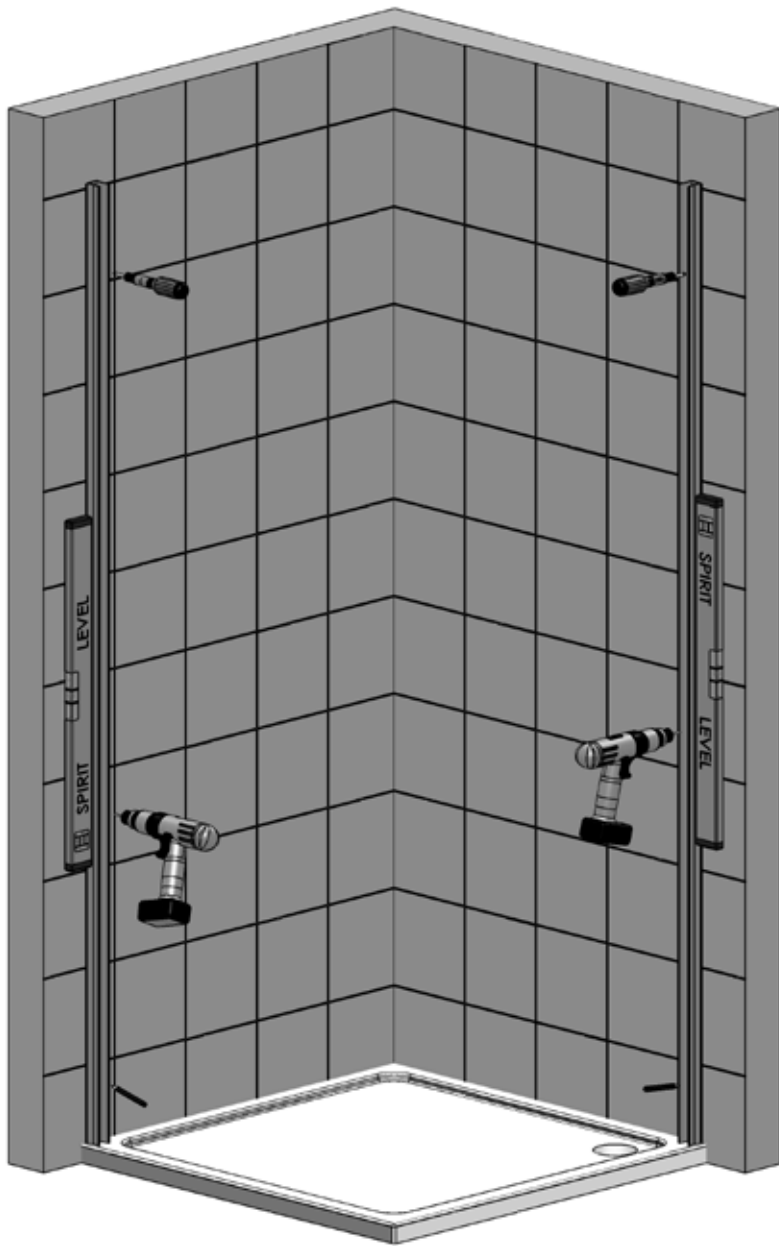

1. Take one of the Wall Profiles and position it 10mm to 12mm in from the front of the tray.
2. Ensure the Wall Profile is completely vertical using a Spirit Level then using a pencil mark the wall through the slots.
 - **Make certain the wall profile is completely vertical using a Spirit Level (the bubble should be in the centre of the two lines).**
3. Follow the same procedures for the other Wall Profile.
4. Drill the walls using a 7mm Masonry Drill Bit (not supplied) and fit the Wall Plugs.
5. Remove any debris and apply a bead of sealant the width of the Wall Profiles where they meet the top of the tray / wetroom floor and the tiled walls.
6. Screw fix both Wall Profiles to the walls using the 40mm Cap Head screws (supplied) ensuring they are kept completely vertical and are 10mm to 12mm in from the front of the tray.
7. Apply a bead of sealant to the inside of the Wall Profiles at the bottom where they meet the top of the tray / wetroom floor.
 - **IMPORTANT: Failure to comply with stages 5 and 7 may cause serious water damage and is not covered under the terms of the guarantee.**

Step 3 - Fitting the Panels

Note: Two people will be required to do the following operations.

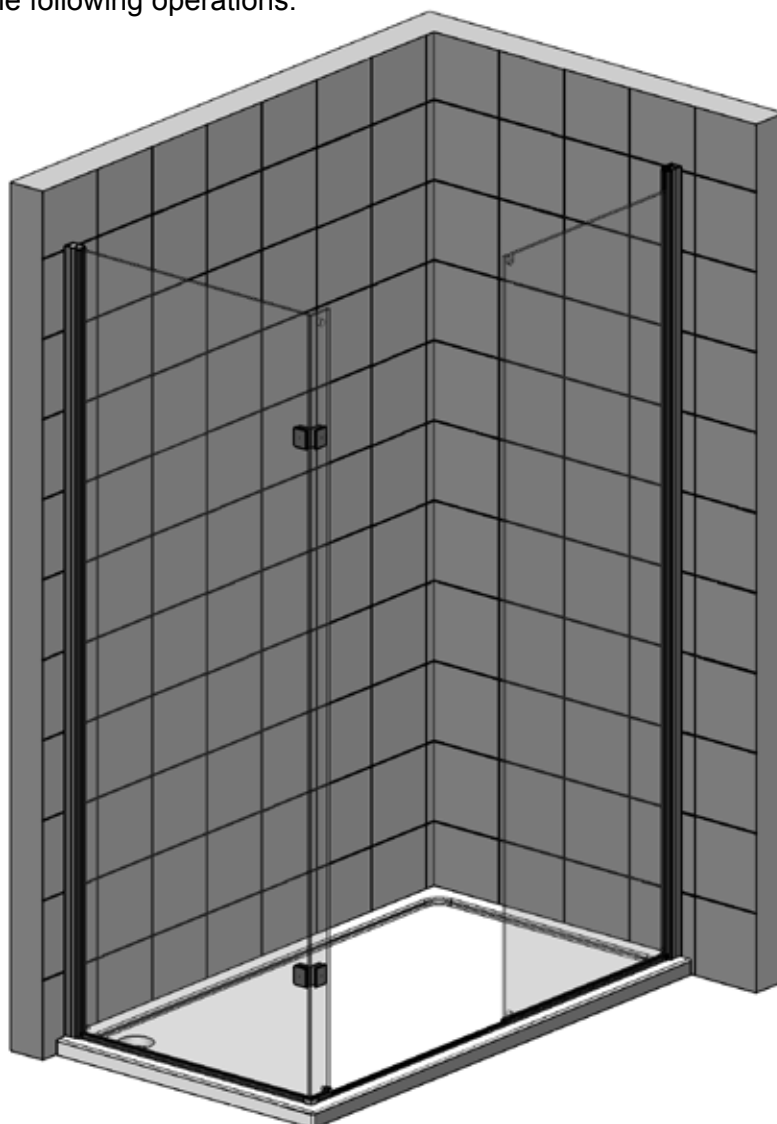
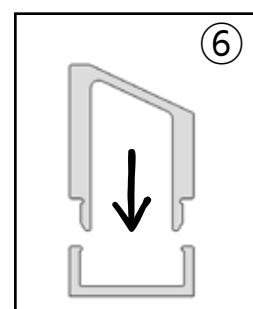
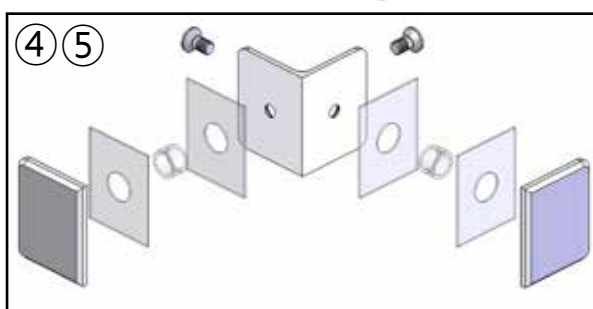
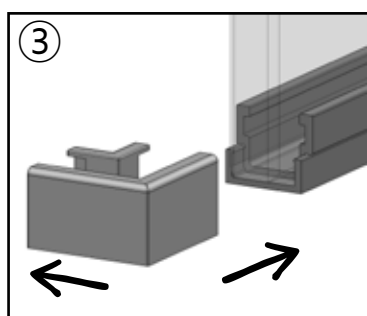
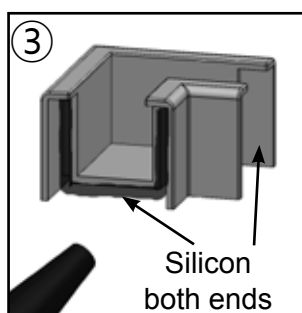
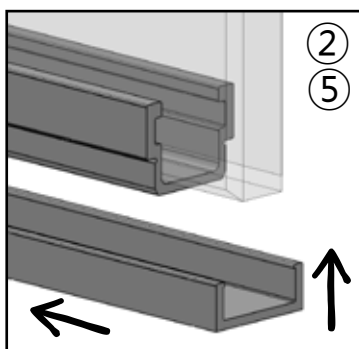
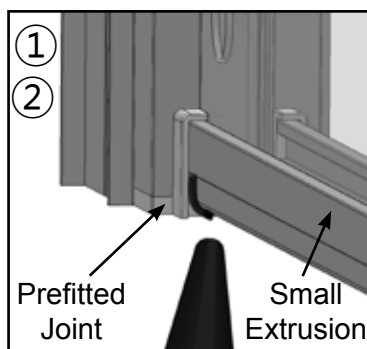

1. At the bottom of both Panel Assemblies where the small extrusion meets the prefitted Bottom Rail Panel Joints place a small bead of silicon on the underside all the way around.
 - **NOTE: Carefully remove excess silicon if required.**
2. Slide the Long Bottom Rail over the bonded profile that is on the Large Panel belonging to the Door, push into the siliconed prefitted joint, then place fully into it's Wall Profile. Repeat the same for the end Panel.
3. Add a small bead of silicon to the underside of the Bottom Rail Corner Joint (both ends) and slide onto the end of the Return Panel and Long Bottom Rail.
4. Dismantle the 90° Corner Brackets and fit onto the Thin Panel making sure the gaskets are fitted and no metal touches the glass.
5. Align the bottom of the Thin Panel so that the bonded profile is above the Long Bottom Rail. Push the Thin Panel down fully into the Long Bottom Rail then fit the Corner Brackets to the Return Panel.
 - **NOTE: The edge of the Thin Panel Glass should be flush with the outer face of the Return Panel Glass.**
6. Place the Door Bottom Rail into the Bottom Rail and up to the Panel Glass (ensure the slope faces inward).
7. Align the Panels etc to be parallel to the outside of the Tray, move Panels as required.
 - **IMPORTANT: Make sure that no gaps are present between the Bottom Rails, Corner and Prefitted Joints.**

Step 4 - Fixing the Panels

Note: 2 people will be required to carry out the procedures below.

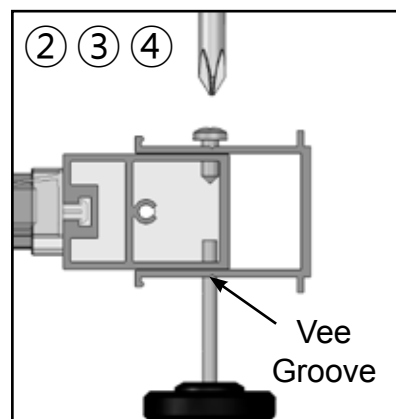
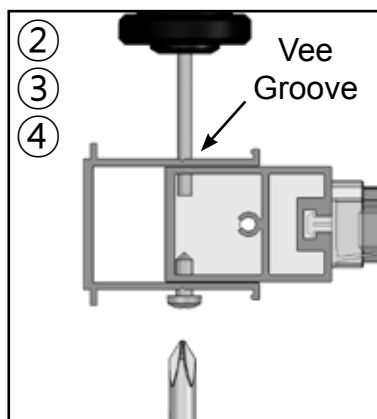
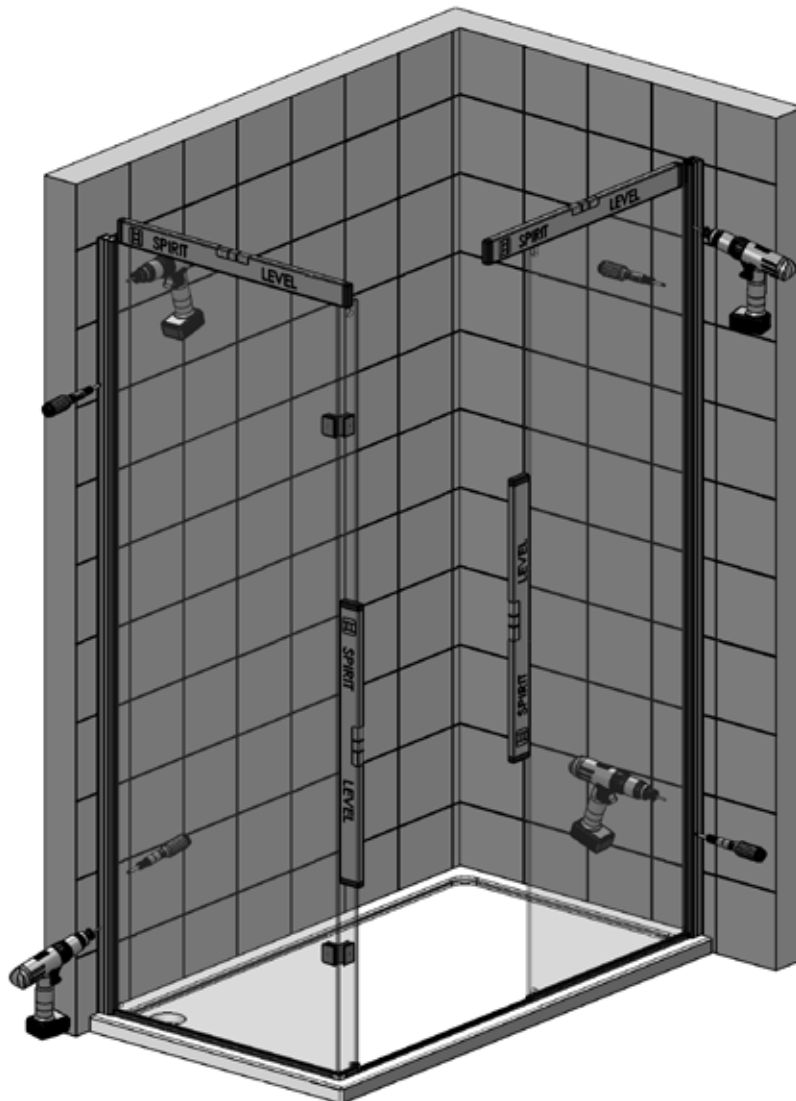

1. Using a Spirit Level keep the Panels completely vertical and horizontal and place them equally between both Wall Profiles (the framework must be kept level throughout the following operations).
2. On both Panels drill through the Vee grooves in the Wall Profiles using the 2.5mm drill bit (supplied). On both the inside and outside drill two holes approximately 50mm from each end, now drill a hole in the centre of those (3 holes), now drill two further holes between them (5 holes).
 - **IMPORTANT: The Wall Profiles are drilled and fixed inside and outside, 5 fixings on each side (20 in total).**
3. Fasten together using the 9mm long Cap Head Screws (supplied).

Step 5 - Fitting the Top Rail

Note: 2 people may be required to carry out the procedures below.

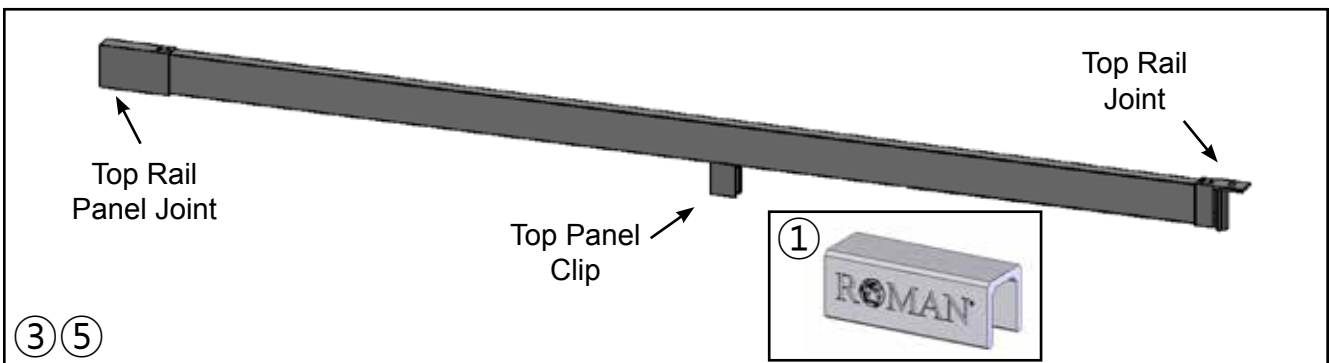
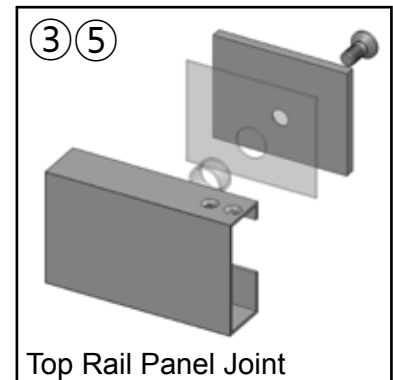
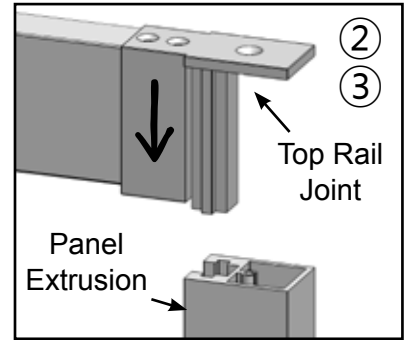
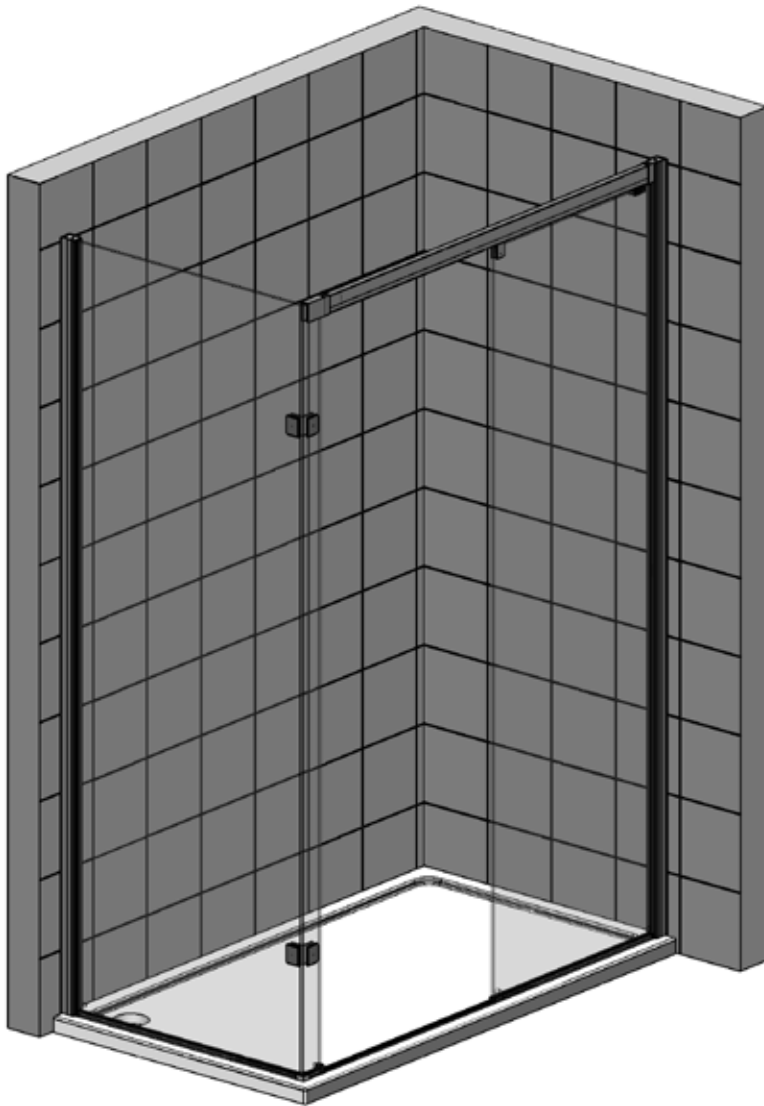

1. Place the Branding Clip on top of the Large Panel Assembly, position it near the vertical aluminium profile.
 2. On the top of the Large Panel Assembly remove the Top Rail Joint.
 3. Fit the Top Rail Joint and Top Rail Panel Joint to the Top Rail using the M4 x 10mm long countersink screws, remove the backplate and gasket from the Top Rail Panel Joint then loosen the Top Panel Clip to allow it to fit on the glass.
 4. Place the Top Rail above the Large Panel extrusion and the Thin Panel Glass and fully slide it down.
 5. Secure the Top Rail and extrusion together using the 12mm countersink screw, refit the back plate and gasket to the Top Rail Panel Joint and tighten onto the Thin Panel Glass. Tighten the Top Panel Clip.
- **IMPORTANT: Always use the gaskets between the glass and metal parts.**

Step 6 - Fitting the Door

Note: 2 people will be required to carry out the procedures below (ensure you have the door the correct way).

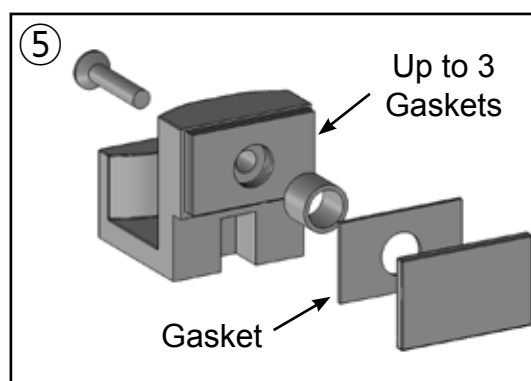
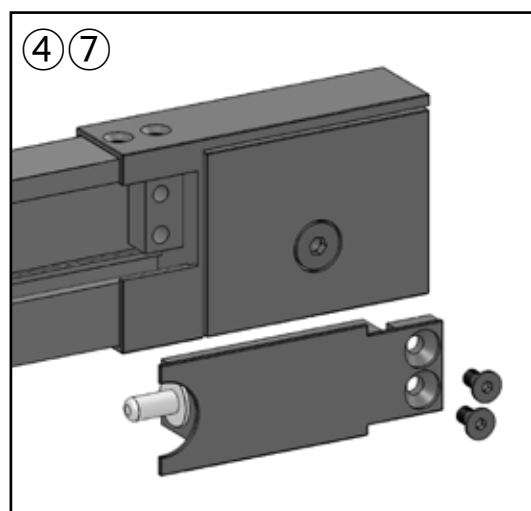
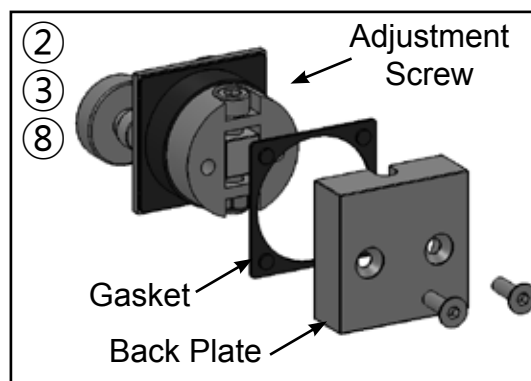
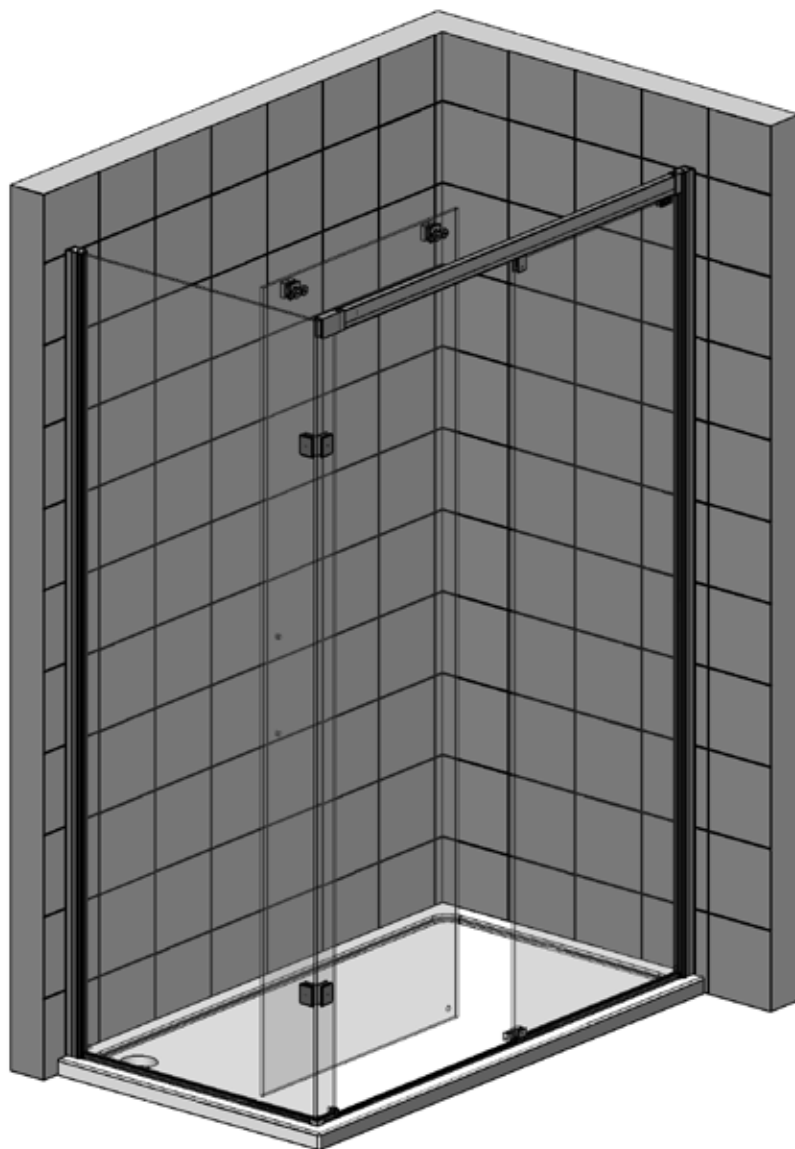

1. Place the Bearing Assemblies into the Top Rail ensuring that the Roller Bearings fit into the pre-fitted Rail Track (the adjustment screw must be at the top).
2. Remove the back plate and gasket from the Bearing Assemblies.
3. Carefully lift the glass and offer onto the Bearing Assemblies, with the glass placed on the Bearing Assemblies refit the gaskets and fully tighten (to make it easier for yourself have someone on the outside gripping the glass and bearings together while you tighten it up).
4. Remove the Soft Close Housing from the Top Rail Door Joint and then carefully close the door.
5. Dismantle the Bottom Guide Assembly and fit into the slot at the bottom of the Panel Glass.
 - **IMPORTANT: It is supplied with 4 gaskets, fit one gasket to the outside. A minimum of one gasket must be fitted to the inside, add the others as required to help with alignment and water integrity.**
6. Slide the Door open ensuring that the glass goes between the small rollers of the Bearing Assembly.
7. Refit the Soft Close Housing back into the Top Rail.
8. Adjust the level of the Door by turning the screws at the top of the Bearing Assemblies using the Allen Key.

Step 7 - Handle, Caps and Trims

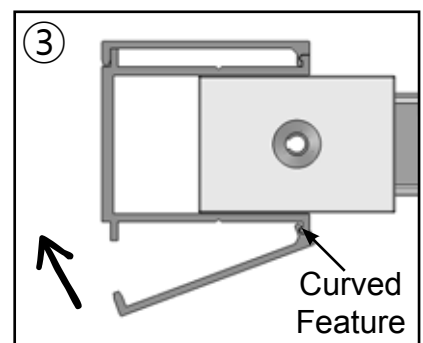
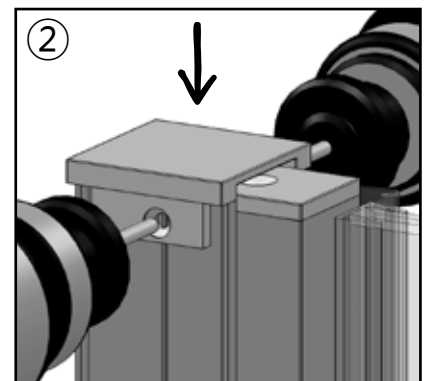
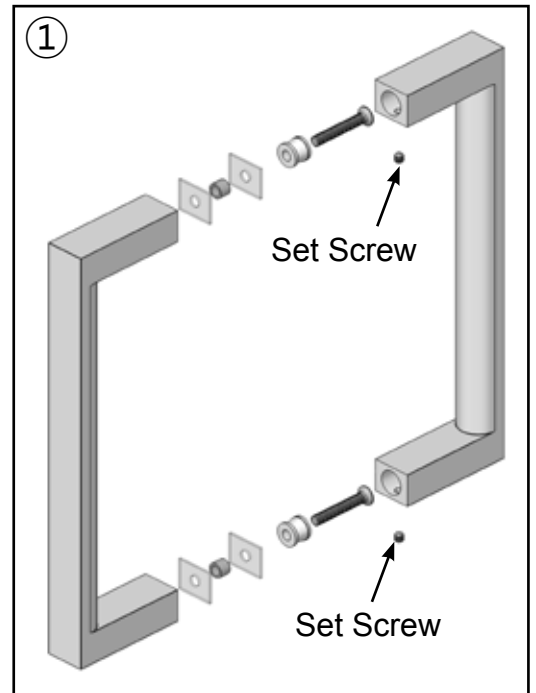
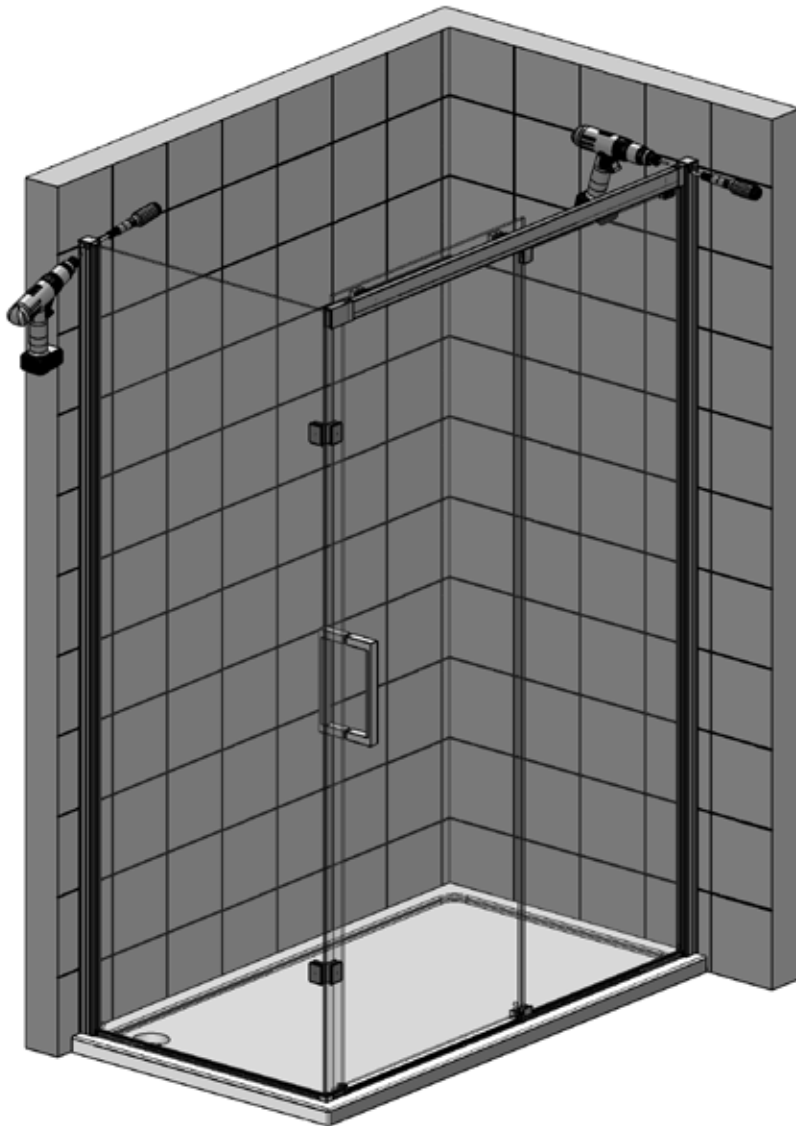

1. Remove the Handle Assembly from its packaging and reassemble onto the Door Glass, ensure that the set screws are fitted on the inside of the Door and all gaskets are used between the glass and metal parts.
2. Fit the Wall Profile Top Caps onto the Wall Profiles, hold in place and drill through the holes on both sides using the 2.5mm drill bit (supplied). Secure the Caps using the 9mm long Csk Head Screws (supplied).
3. Fit the Wall Profile Covers onto the Wall Profiles by locating the small curved feature onto the Wall Profile, hold in place and push until they are between the Wall Profiles and tiled Walls.
4. Fit the Vertical Panel Seal onto the edge of the Panel Glass with the flipper facing inward.
5. This is where you may need to add or remove gaskets from the Bottom Guide Assembly as mentioned in the previous Step to achieve the best alignment.

Step 8 - Sealing

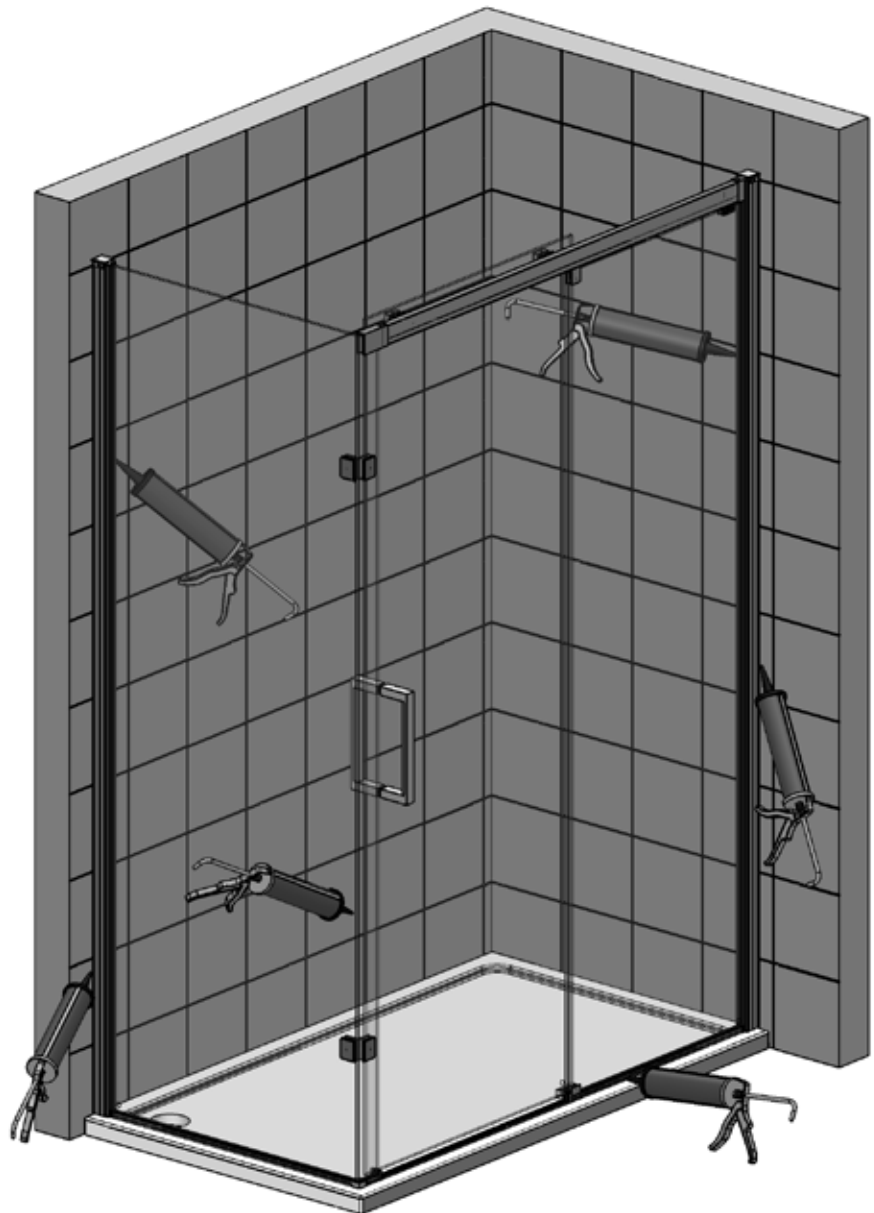
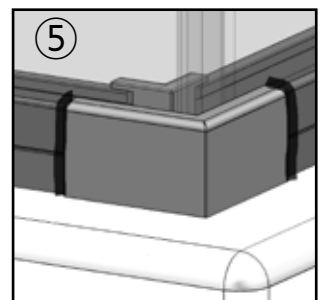
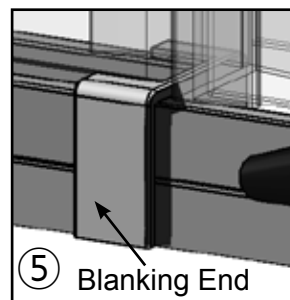
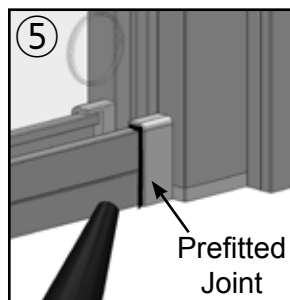
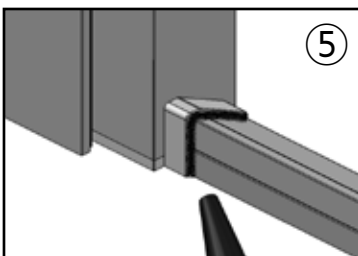
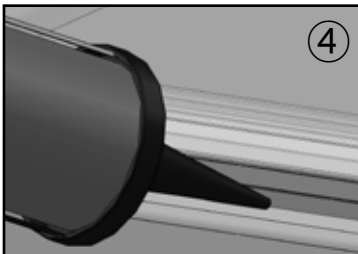
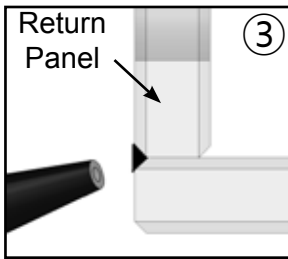
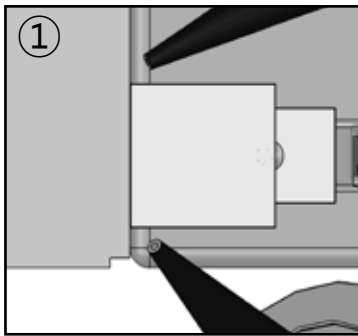
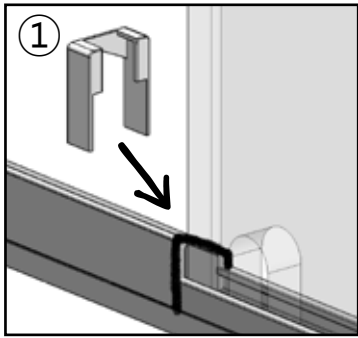

1. Place a bead of silicon around the end of the Panel Glass and the Bottom Rails then fit the Blanking ends over them carefully removing any excess silicon if required.
2. Seal all the Wall Profile Covers to the tiled walls vertically both inside and outside.
 - **IMPORTANT: Ensure that the Covers are place between the Wall Profiles and Tiled Walls.**
3. Seal the Return Panel Glass and the Thin Panel Glass together on the outside only (small bead only).
4. Seal the outside of the Enclosure horizontally on the outside only.
 - **IMPORTANT: Do not seal on the inside as this may cause serious water damage and is not covered under the terms of the guarantee.**
5. On the Blanking Ends, prefitted Bottom Rail Panel Joints and Bottom Rail Corner Joints carefully add a small amount of silicon at the gap between the Bottom Rails all the way from the front to the back.
 - **NOTE: Carefully remove excess silicon if required.**
 - **IMPORTANT: Failure to follow stages 1,2,3,4 and 5 may result in serious water damage and is not covered under the terms of the guarantee.**
 - **Please allow 24 hours for the sealant to fully cure before using the enclosure.**

Spare Parts

If you need to replace any damaged parts please see illustration below for parts list then call Customer Relations on 01325 328033

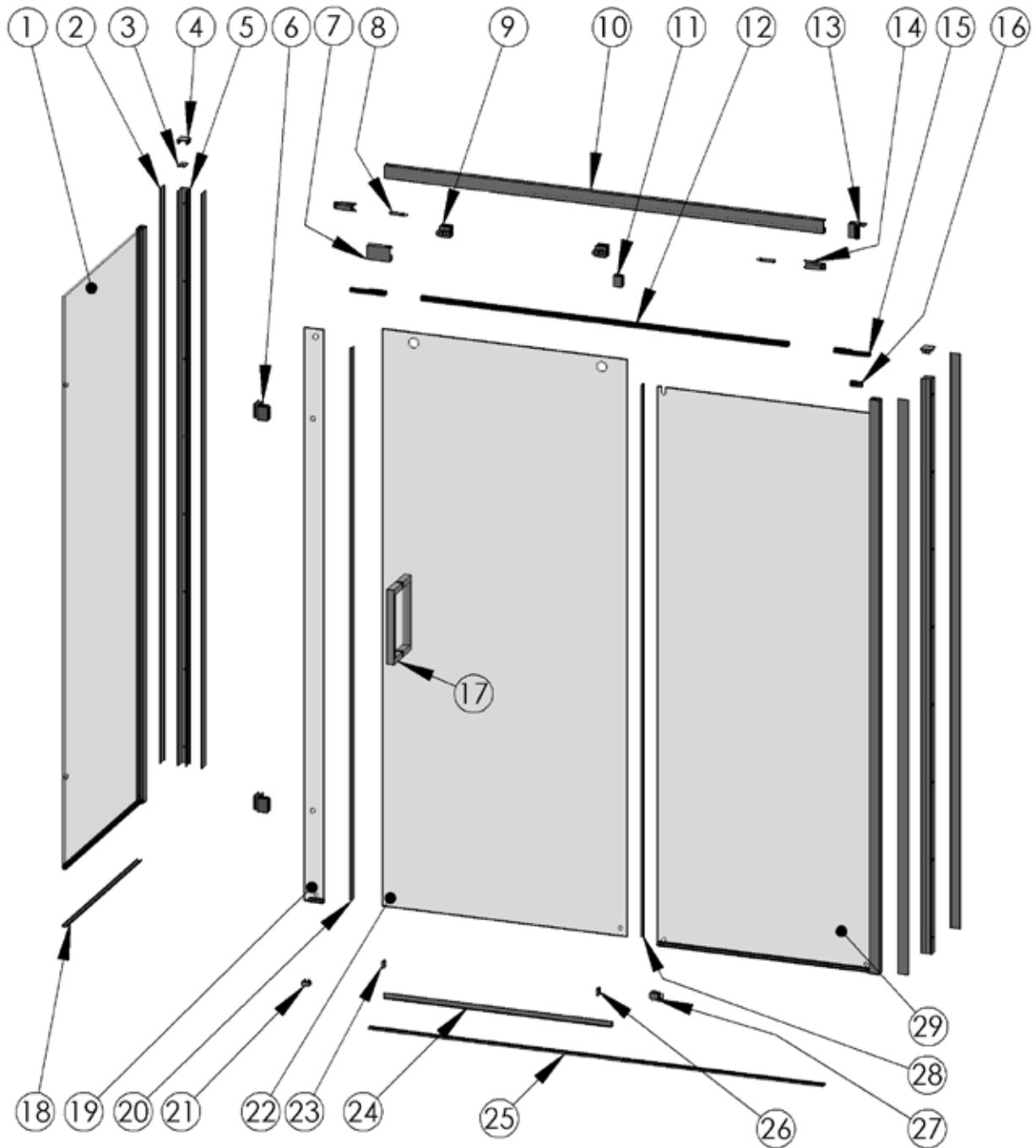

Part No.	Description	Qty	Part No.	Description	Qty	Part No.	Description	Qty
1	Return Panel Assembly	1	12	Rail Track	1	23	Blanking End (Left Hand)	1
2	Wall Profile Cover Trims	4	13	Top Rail Joint	1	24	Door Bottom Rail	1
3	Panel Top Cap	1	14	Soft Close Housing	2	25	Bottom Rail (Long)	1
4	Wall Profile Top Caps	2	15	Rail Ramp	2	26	Blanking End (Right Hand)	1
5	Wall Profiles	2	16	Branding Clip	1	27	Bottom Guide Assembly	1
6	90° Corner Brackets	2	17	Handle Assembly	1	28	Vertical Panel Seal	1
7	Top Rail Panel Joint	1	18	Bottom Rail (Return Panel)	1	29	Large Panel Assembly	1
8	Soft Close Buffer	2	19	Thin Panel Assembly	1	30		
9	Bearing Assemblies	2	20	Thin Panel Vertical Seal	1	31		
10	Top Rail	1	21	Bottom Rail Corner Joint	1	32		
11	Glass Clip	1	22	Door Glass	1	33		

TROUBLE SHOOTING GUIDE

Problem	Solution
Leaking	<ol style="list-style-type: none">1. Check that the inside gap between the Tray and Wall profiles has been sealed correctly.2. Ensure the tray is sealed along the tiled walls prior to installation.3. If the inside joint between the enclosure and the tray top is sealed, this will cause leakage - sealant must be removed.4. Ensure the wall profiles on the tiled walls are sealed both vertically inside and outside.5. Ensure the joint between the enclosure and tray top is sealed. <p>Important: This enclosure should be water tested conforming to BS EN 14428</p>
Enclosure Alignment on the Tray	<ol style="list-style-type: none">1. Is the enclosure fitted onto a tiled wall?2. Are the Wall Profiles fitted 10mm to 12mm from the front outside edge of the tray?3. Are the wall profiles completely vertical?
Door not operating correctly	<ol style="list-style-type: none">1. Ensure both wall profiles are completely vertical.2. Add or remove gaskets from the Door Guide Assembly.3. Ensure the tray is completely level.4. Check the bottom of the door is parallel to the top of the tray.
Door Alignment	<ol style="list-style-type: none">1. Ensure both wall profiles are completely vertical.2. Ensure the tray is completely level.3. Check the bottom of the door is parallel to the top of the tray.4. If the door is not aligned correctly, you have adjustment in the Bearing Assemblies
Panel Alignment	<ol style="list-style-type: none">1. Check the Wall Profile is 10mm to 12mm in from the front of the tray.2. Ensure the tray is completely level.

Some important information to help you Maintain your product.

The following information is all you need to keep your product looking new.

Clean your product using a mild detergent diluted in water and then polished off using a soft cloth.

If you live in a hard water area, periodically clean your product using a 50/50 solution of white vinegar and water. The solution should be left on the enclosure for approximately 5 minutes then rinsed off using warm water. This method of cleaning should remove lime scale residue.

Simple Maintenance

Our products are generally maintenance free, however it may be necessary to lubricate wheel assemblies and other moving parts from time to time.

It is strongly recommended that a quality silicone spray is used.

A list of Don't's:

1. Don't use acidic based products which are unsuitable for cleaning enamel surfaces.
2. Don't use abrasive cleaners or cleaners using bleach or solvents, these products will adversely affect the finish of the aluminium profiles.
3. Don't use scouring pads, powder or any sharp instruments when cleaning the enclosure.

Should you experience any problems during installation please refer to the Trouble Shooting Guide or contact Customer Relations on:

+44 (0) 1325 328033

To enable customer relations to provide you with an excellent level of service it is important that you quote your product Code and Reference Number - these can be found on the Guarantee card.