

NU

Wall-mounted bath spout

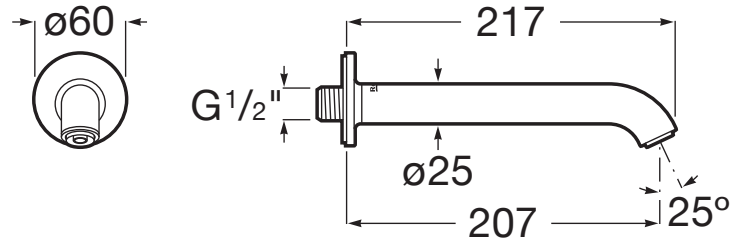

TECHNICAL DRAWINGS



FEATURES

Acoustic level (dB): Group 2 (20-30 dB)

Application: Bath

Flow rate (l/min - 3 bar): 50

Installation type: Wall-mounted



EverShine

## Nu

Nu faucet collection by Inma Bermúdez Studio is a timeless and fun collection that represents a purity of visual expression and a synthesis of essential design elements. Playing with colour and form in new and inventive ways, Nu allows for a whole personalization of the bathroom space.



### INSTALLATION AND USER MANUALS



[Installation manual](#)