



# multi-pro MoistSure

Tile Backer Board

NOW BBA  
CERTIFIED!

## WHY CHOOSE MOISTSURE TILE BACKER BOARD?

Multi-Pro MoistSure is the stronger, faster, safer building board for wall and floor tiling, developed by Resistant Building Products. MoistSure tile backer board is mould resistant, water resistant and extremely strong.



### STRONGER TILE BACKER

Proven to be extremely strong when fitted correctly and is suitable for hanging a combined weight of tile/adhesive of 100kg/m<sup>2</sup>.\*



### ENVIRONMENTALLY FRIENDLY

Resistant boards are environmentally friendly as they produce less CO<sub>2</sub> emissions due to a greener cold fusion manufacturing process.



### MOISTURE/WATER RESISTANT

MoistSure is an ideal tile backer as it will not deteriorate, swell or rot when used in a humid or moist environment.



### SAFER TILE BACKER

Some rival tile backers contain up to 50% crystalline silica, while MoistSure contains less than 0.5%, making it one of the safest boards on the market today.

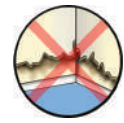

### MOULD RESISTANT

Unlike paper faced or wood-based products, MoistSure contains no cellulose and is therefore resilient to mould growth.



### EFFICIENT CUTTING METHOD

Can be easily scored and snapped with a standard blade or cut to shape using a small hand saw.



### EASY FIXING METHOD

Boards can be simply screw fixed without pre-drilling. Fitting instructions can be found at [www.resistant.co.uk](http://www.resistant.co.uk).



## BENEFIT YOUR PROJECT!

Multi-Pro MoistSure is Resistant's premium tile backer board. It is a cost effective solution for any project which requires high performance in a humid or moist environment. Resistant offer a 25 year guarantee with the MoistSure board where it will not rot, crack or delaminate over this period of time. To find out more, visit our website or contact a member of the sales team. Contact information on reverse.



## TESTING & CERTIFICATION

First BBA certified MgO board with extensive testing carried out by the accrediting body

Manufactured to EN 13501-1:2007 + A1:2009 for fire resistance and passed as **A1 non-combustible**

\*Shear tile test carried out in accordance with BS EN 1324:2007 & BS EN 1990:2002



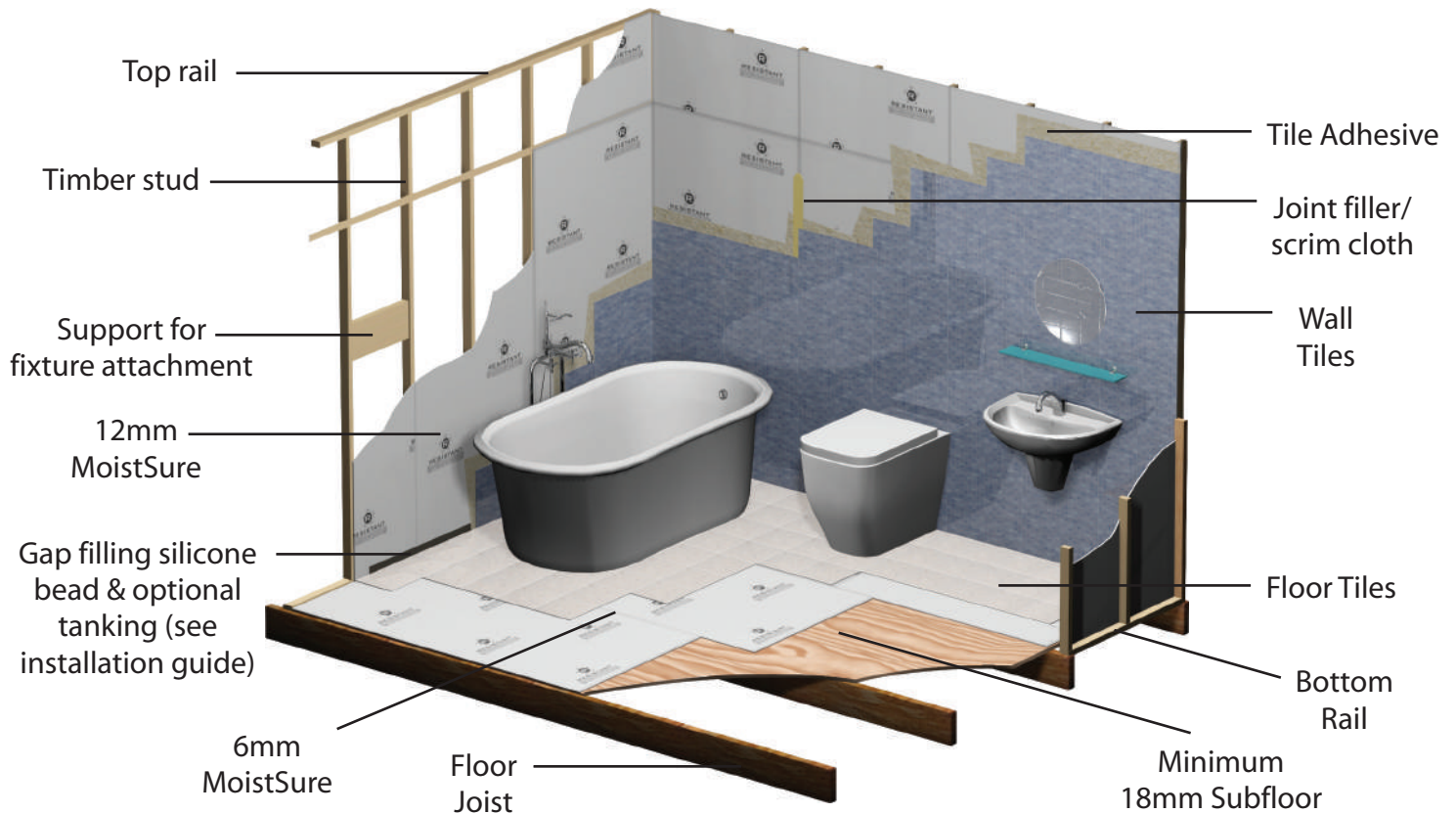

# USE OF MOISTSURE IN A HOME BATHROOM

The following diagram depicts an example layout of a bathroom fitted with Multi-Pro MoistSure Tile Backer board. For fully detailed fitting instructions and further information, please visit [www.resistant.co.uk](http://www.resistant.co.uk).



## MULTI-PRO MOISTSURE VS. INDUSTRY STANDARD

Gypsum and Plywood products are frequently used as tiling substrate in showers and bathrooms where stud walls are common. Both these substrates are susceptible to deterioration if moisture penetrates through a crack or joint on a tiled wall or floor. When MoistSure is used and installed as per the recommended guidelines, these problems should not occur.

<i>Metal Stud</i>		<i>Available Board Sizes</i>	<i>Weight Per Board</i>
Case hardened stainless steel		590 x 1195 x 6mm	4kg
Self tapping screw, countersunk head		1220 x 1220 x 6mm	9kg
		1200 x 2400 x 6mm	18kg
		800 x 1200 x 12mm	12kg
		1200 x 2400 x 12mm	36kg
<i>Timber Stud</i>			
Wood screw (Stainless steel)			
Hot Dipped Galvanised			
Self tapping screw, countersunk head			

