

6000 series

Circular Access Panel

Standard Circular Access Panel for jointless plasterboard/plaster ceilings

NON FIRE RATED 

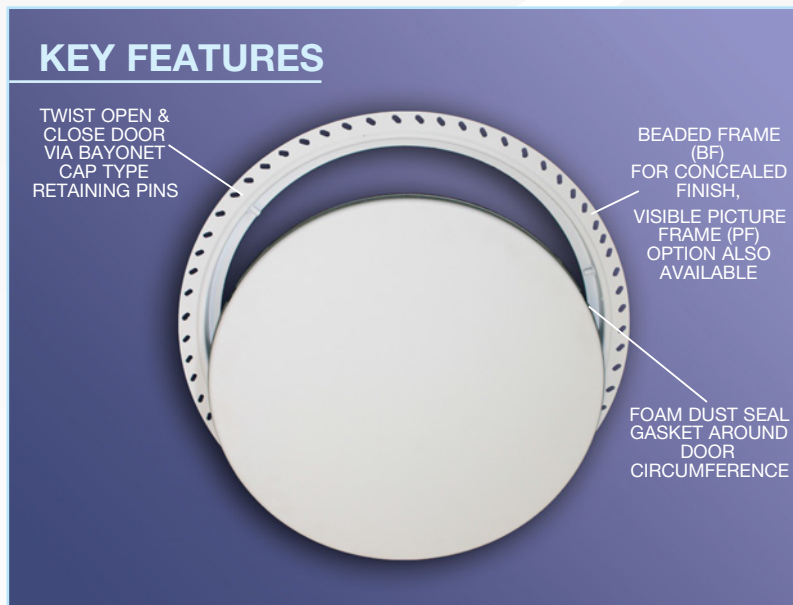

FRAME OPTIONS



Beaded Frame (BF)



Picture Frame (PF)

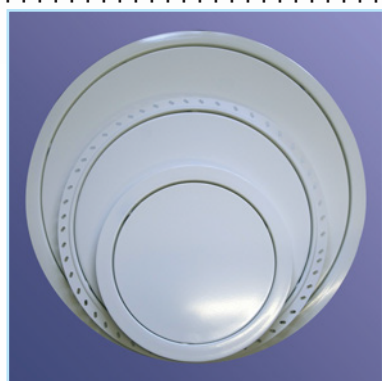

Retaining Mechanism

INTRODUCTION

The PROFAB 6000 series range of steel lockable access panels provides access into jointless plaster/plasterboard ceilings, where access to mechanical and electrical services is required

DESCRIPTION

COMPOSITION & MANUFACTURE

The metal frame holds a flush metal faced door (MD) or a plasterboard lined (PD) door through a bayonet lock retaining system. The bayonet lock retaining system allows the door to be removed during installation or if damage occurs. Panel frames are manufactured either as fully concealed (BF) or alternatively, manufactured for retrofitting where the 25mm picture frame is visible (PF). Panels with simulated drywall beaded frames (BF) are supplied powder coated white primer all over as standard for decoration on site to match the adjacent finish. Panels with visible picture frame (PF) are supplied powder coated semi-gloss white as standard.

6000/BF/BL

Frame: 1.2mm thick aluminium incorporating a simulated edge bead profile (BF) finished white powder coated primer.

Door: Flush metal 1.2mm thick aluminium (MD) finished etch white powder coated primer.

6000/PF/MD

Frame: 1.2mm thick aluminium incorporating a 25mm visible picture frame (PF) finished white powder coated semi-gloss.

Door: Flush metal 1.2mm thick aluminium finished white powder coated semi-gloss.

6000/BF/PD

Frame: 1.2mm thick electro galvanised steel incorporating a simulated edge bead profile (BF) finished white powder coated primer.

Door: 9.5mm plasterboard lined 1.2mm thick electro galvanised steel finished white powder coat primer.

TYPICAL SIZES & WEIGHTS

Diameter Dim y	Kgs
200	0.3
300	0.5
450	1.0
600	1.5

All dimensions in millimetres.

All panels are single door.

6000 series access panels are available in sizes from 200mm diameter to x 900mm diameter.

KEY POINTS TO NOTE

1. Diameter dimensions is outside rear frame.
2. Overall frame depth is 35mm.
3. Structural opening required for installation is (diameter+5).
4. Clear available access when installed, with door in the open position is (diameter -40).

FIRE PERFORMANCE



The 6000 series panel is a non-fire rated product.

TYPICAL CEILING DETAILS (MF ceiling)

All support angles, channels and fixings by contractor unless stated otherwise.

Fig.1

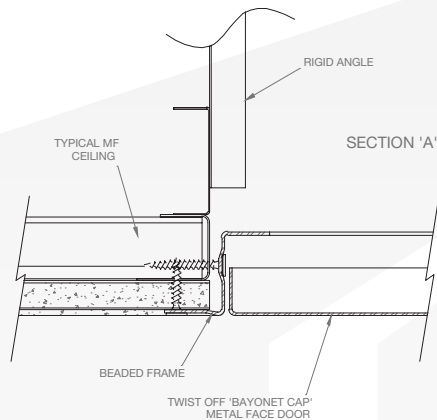

Fig.2

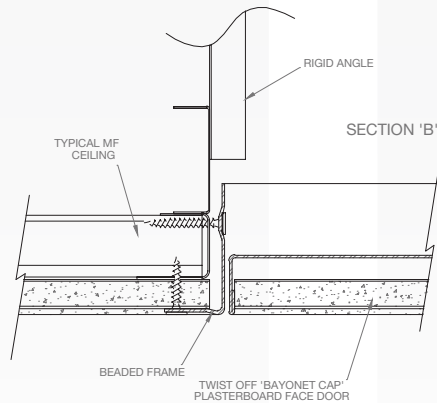

Fig.3

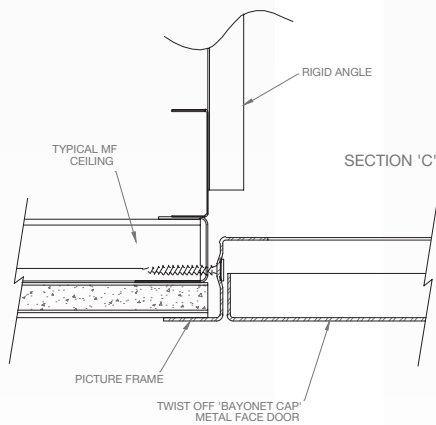
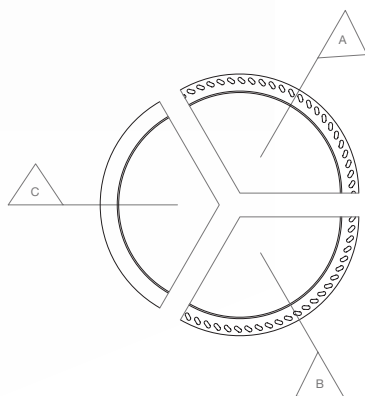

Fig.4



APPLICATIONS & USES

All standard panels are for internal use and only in areas of normal humidity

6000/BF/MD and PD is suitable for horizontal use where the panel is being installed prior to any tape and jointing or skim-coat plastering.

6000/PF/MD is suitable for horizontal use where the panel is being installed after all finishing work has been completed. The panel is factory finished semi-gloss white so needs no further decoration.

SPECIFICATIONS

EXAMPLE:

Access panel type 6000/BF Size 600mm diameter single door unit supplied by Profab Access Ltd.

OTHER OPTIONS

The 6000 series is an entry-level access panel designed to provide a simple, economic means of accessing building services, so only limited modifications are available with this product. However, Profab's manufacturing flexibility provides for alternative sizes, locks and paint colours. Discussions with Profab should take place at the earliest opportunity if specification changes are being considered.

INSTALLATION

Apertures formed in dry lined ceilings should be adequately supported to take the additional weight and operating forces exerted during operation. Typical fixing details are shown on this data sheet.

OPERATION

The panel is fitted with a concealed bayonet retaining mechanism operated by rotating the door within the frame.

SUPPLY

Available through a network of distributors. Refer to Profab for guidance.

TECHNICAL SERVICES

ADVISORY

If there is any doubt about the information given in this data sheet or the intended product usage, then Profab should be consulted. We are only too pleased to advise on the use of our products. Technical representation is available at all stages of a project. In house manufacturing enables us to offer full flexibility in product design for projects that need to meet specific design criteria.

QUALITY & DEVELOPMENT

Profab access panels are manufactured under strictly controlled quality systems and so we reserve the right to amend any of our published information and specification.



6000 series

continued . . .

PLEASE CONTACT PROFAB ACCESS OR YOUR NEAREST DISTRIBUTOR FOR FURTHER INFORMATION & SALES

AIS fpdc



Our products are now available to download as objects...

NBS National BIM Library



Distributor:

Profab Access Ltd.
Unit C-D
Riversdale House
Riversdale Road
Atherstone
Warwickshire
UK
CV9 1FA

TEL: +44 (0) 1827 718 222
FAX: +44 (0) 1827 818 680
sales@profabaccess.com
www.profabaccess.com

