

P7401 Telescopic Kit FITTING INSTRUCTIONS

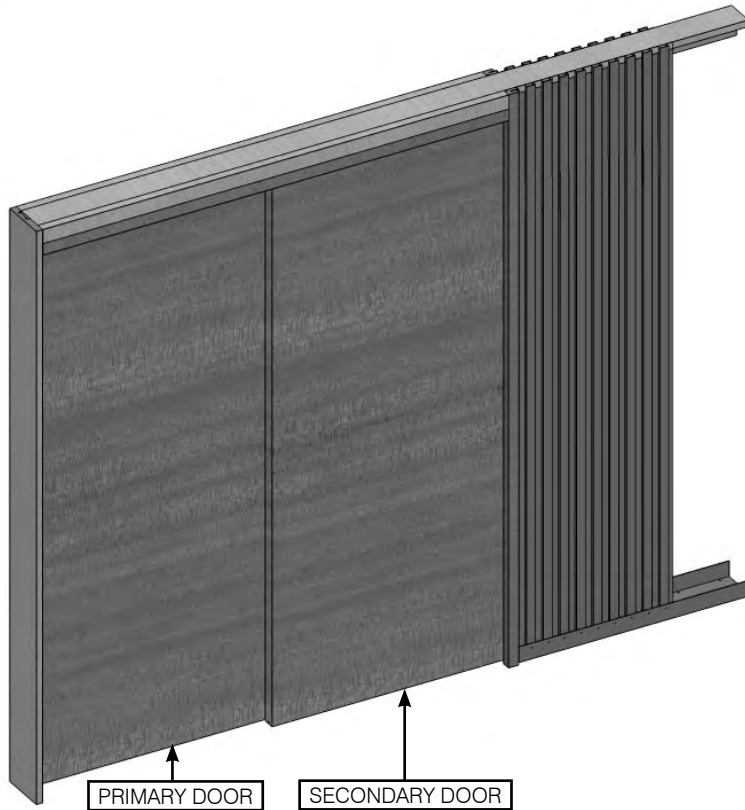

(Image for reference only)

SUGGESTED TOOLS



DRILL



G-CLAMP



TAPE MEASURE



HACKSAW



PLUMB LINE



HANDSAW



SPIRIT LEVEL



PROTECTIVE EQUIPMENT

COMPONENTS

POCKER DOOR KIT

- SHORT / LONG 'Z' SECTION
- LONG 'Z' SECTION
- L-SHAPED TRACK PACKER
- PLYWOOD TRACK MOUNT
- ALUMINIUM TRACK
- DOOR BOTTOM CHANNEL
- SOLE PLATE
- RUBBER SEAL
- BRUSH SEAL

DOOR JAMB SET

- HEAD SECTION
- FRONT EDGE JAMB
- CASSETTE EDGE JAMB

SLIDING MECHANISM

- TROLLEY CATCH
- TROLLEY ASSEMBLY
- FLOOR GUIDE

FIXING ITEMS

- END BLOCK
- PROTECTIVE EDGE CLIP
- CHOCK LARGE
- CHOCK SMALL
- SET A
- SET B
- SET C
- SET D
- SET E
- SET F

*
*
*
*
*
*
*
*
*
*

2
2
2

2
2
1

1
*
*
*
*
*
*

* Quantities are dependant on type of kit ordered

POCKET DOOR KIT

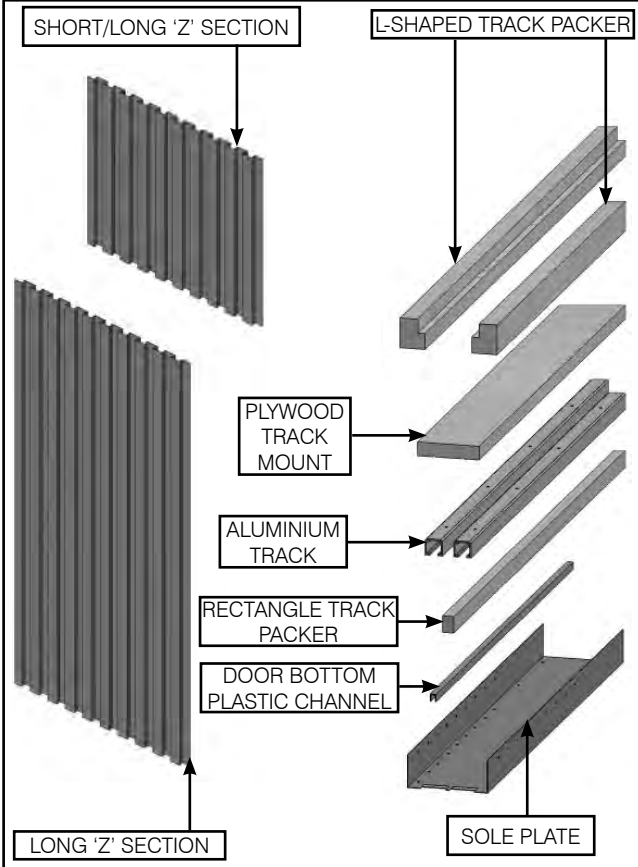

SLIDING MECHANISM

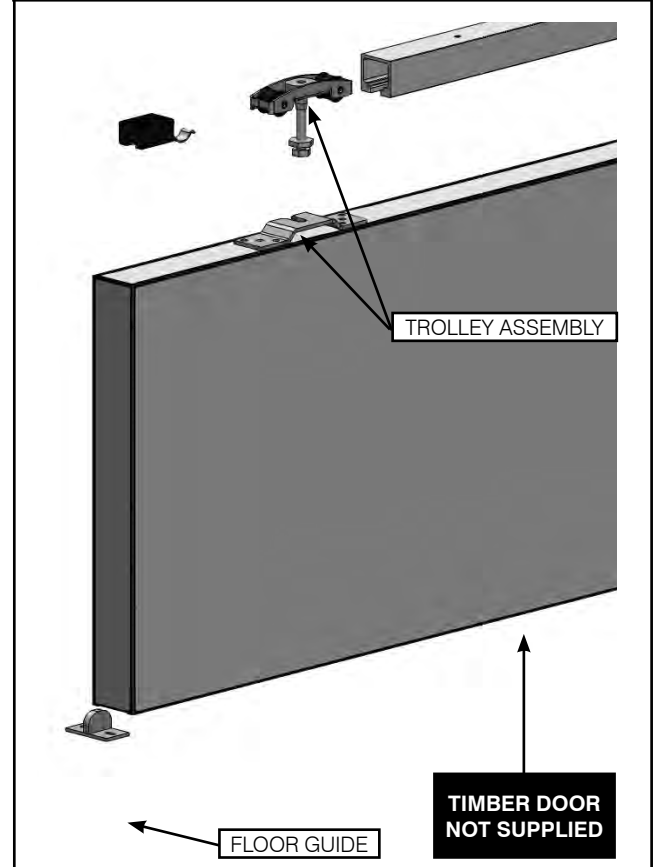

OPTIONAL DOOR JAMB SET

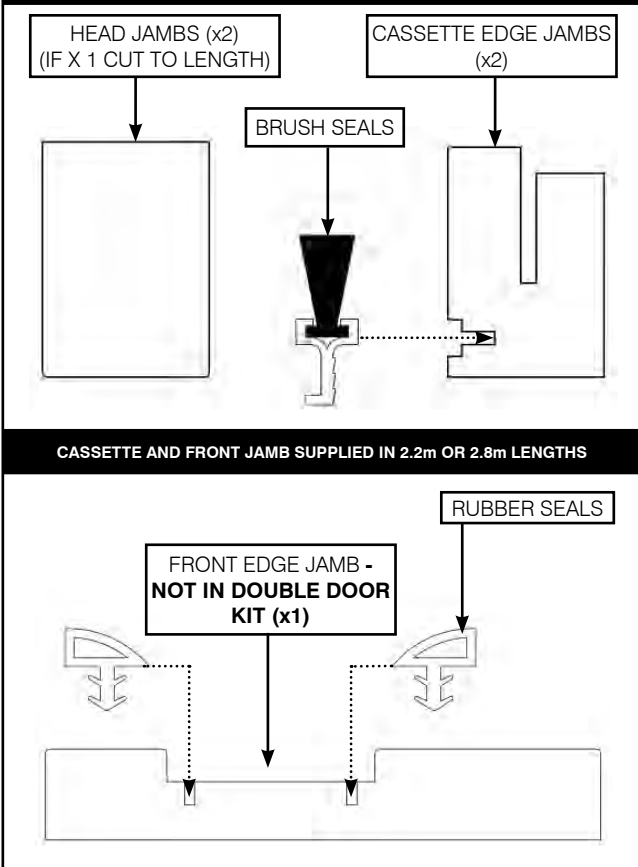

FIXING ITEMS SET

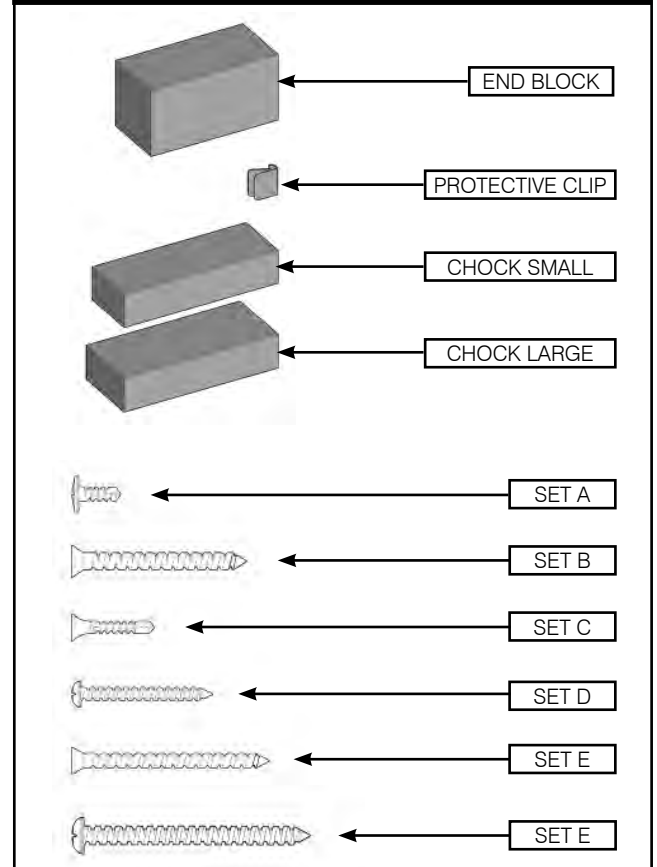

TOP RAIL COMPONENTS

ADJUSTABLE PULLEY

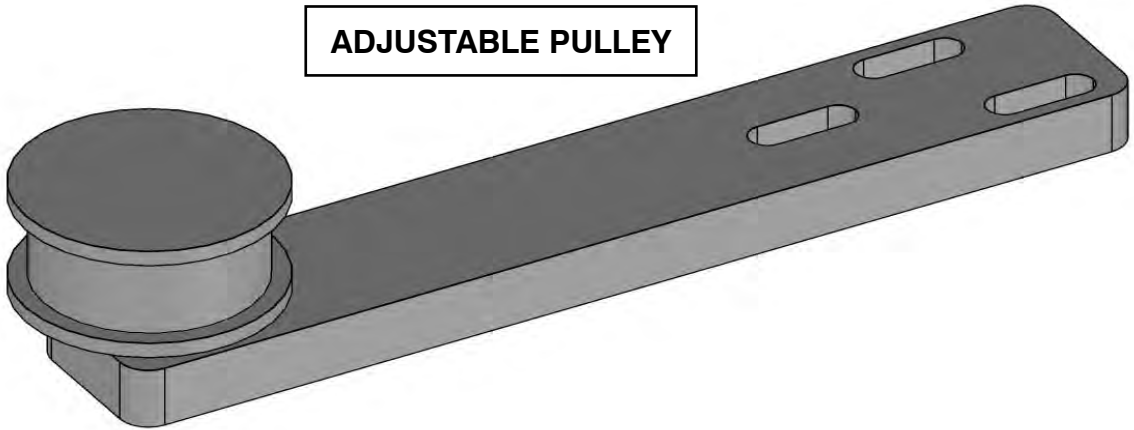

LOWER FLOOR GUIDE

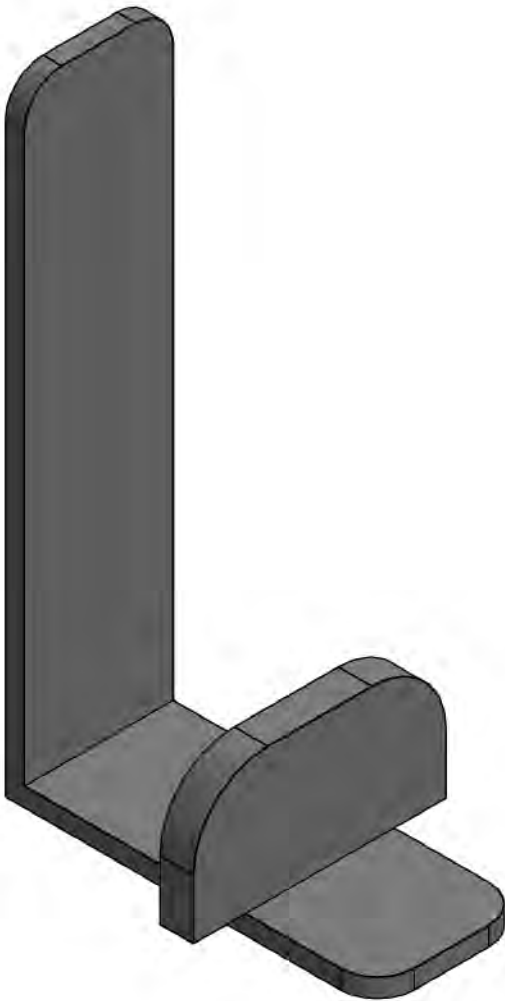

FIXED PULLEY

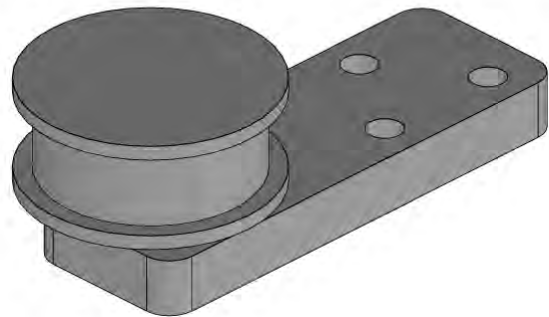

MOVING CONNECTOR

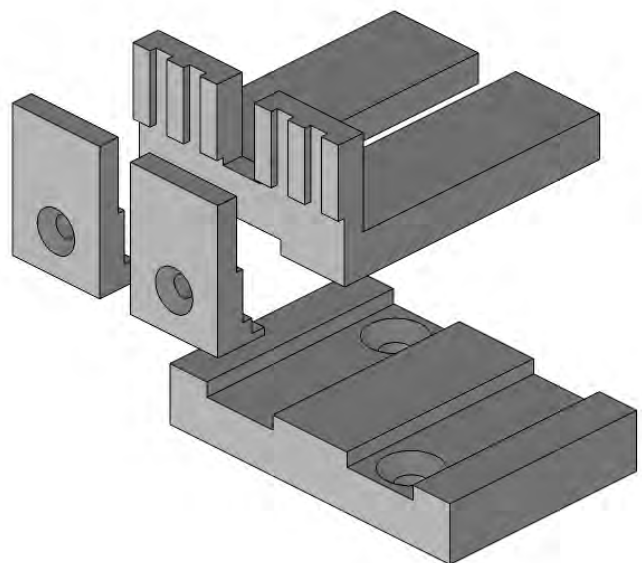

PRE-DOOR FITTING INFORMATION

Firstly construct a studwork frame on which to affix the pocket door system.
For correct operation, it is crucial that the frame is constructed square and plumb.

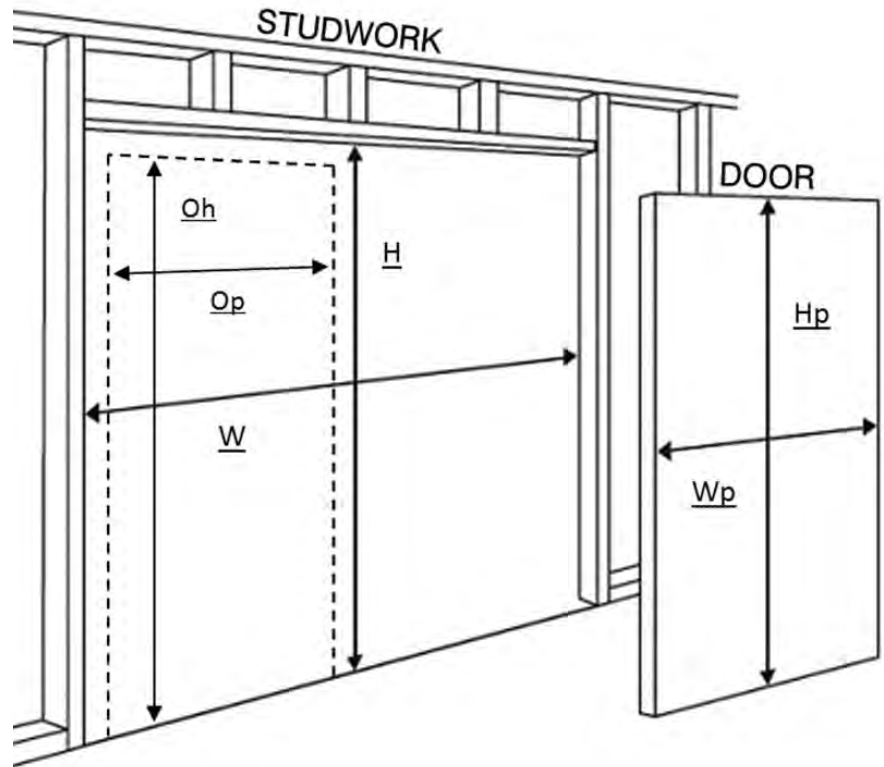

Abbreviations

W = STUDWORK WIDTH

H = STUDWORK HEIGHT

Op = DOOR OPENING WIDTH

Oh = DOOR OPENING HEIGHT

Wp = DOOR WIDTH

Hp = DOOR HEIGHT

SIZES CAN BE CALCULATED AS FOLLOWS (FOR SINGLE STANDARD DOOR WITH A DOOR THICKNESS OF 44mm)

1. To calculate **studwork** width and height from known **door dimensions**:

$$\text{Studwork width (W)} = 3 \times \text{Door width (Wp)} + 7\text{mm}$$

$$\text{Studwork height (H)} = \text{Door height (Hp)} + 95\text{mm}$$

2. To calculate **door size** from known **studwork dimensions**:

$$\text{Door width (Wp)} = (\text{Studwork width (W)} - 7\text{mm}) / 3$$

$$\text{Door height (Hp)} = \text{Studwork height (H)} - 95\text{mm}$$

3. To calculate **door size** from known door **opening dimensions**:

$$\text{Door width (Wp)} = \text{Door opening width (Op)} + 58\text{mm} / 2$$

$$\text{Door height (Hp)} = \text{Door opening height (Oh)} + 7\text{mm}$$

4. To calculate **door opening** width and height from known **door dimensions**:

$$\text{Door opening width (Op)} = \text{Door width (Wp)} - 58\text{mm}$$

$$\text{Door opening height (Oh)} = \text{Door height (Hp)} - 7\text{mm}$$

1. TRACK MOUNT

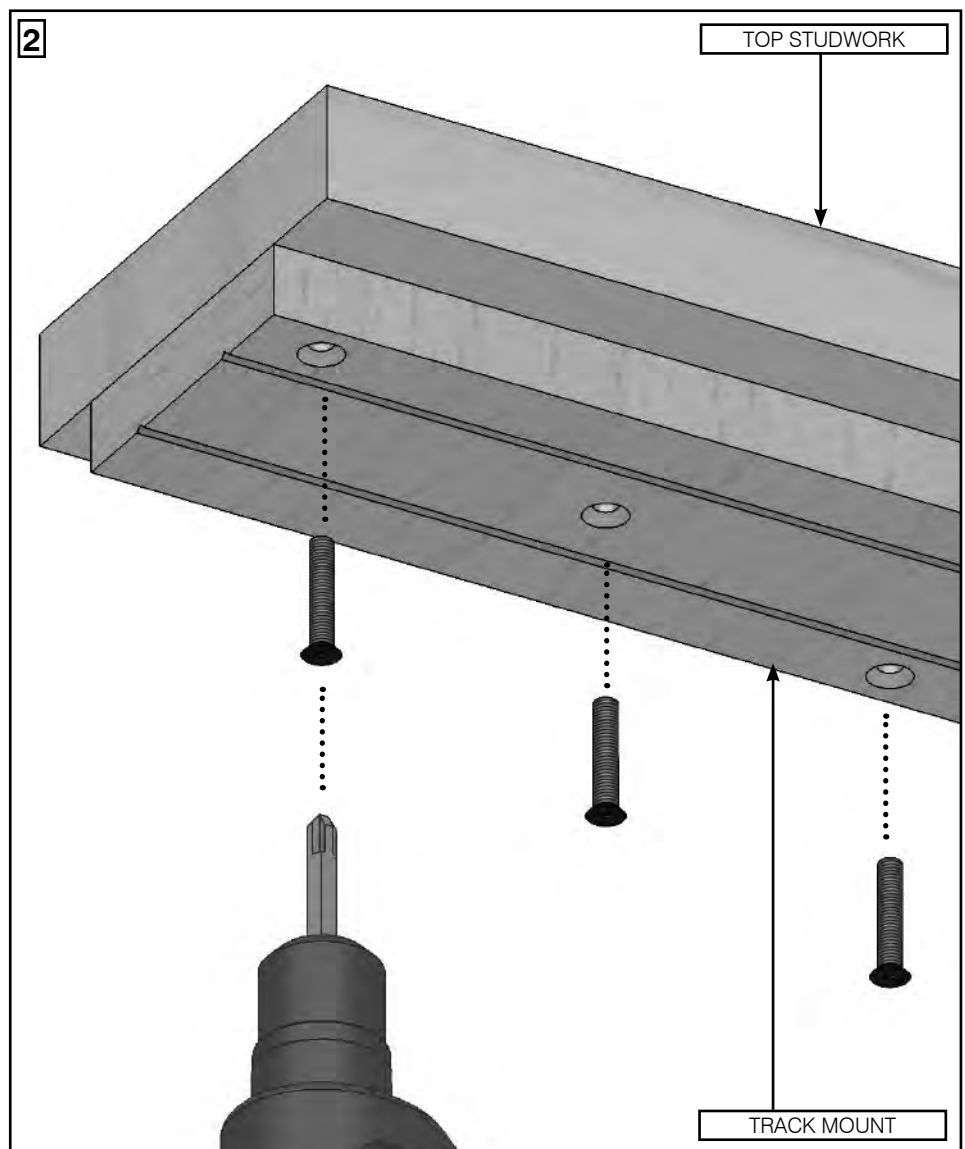
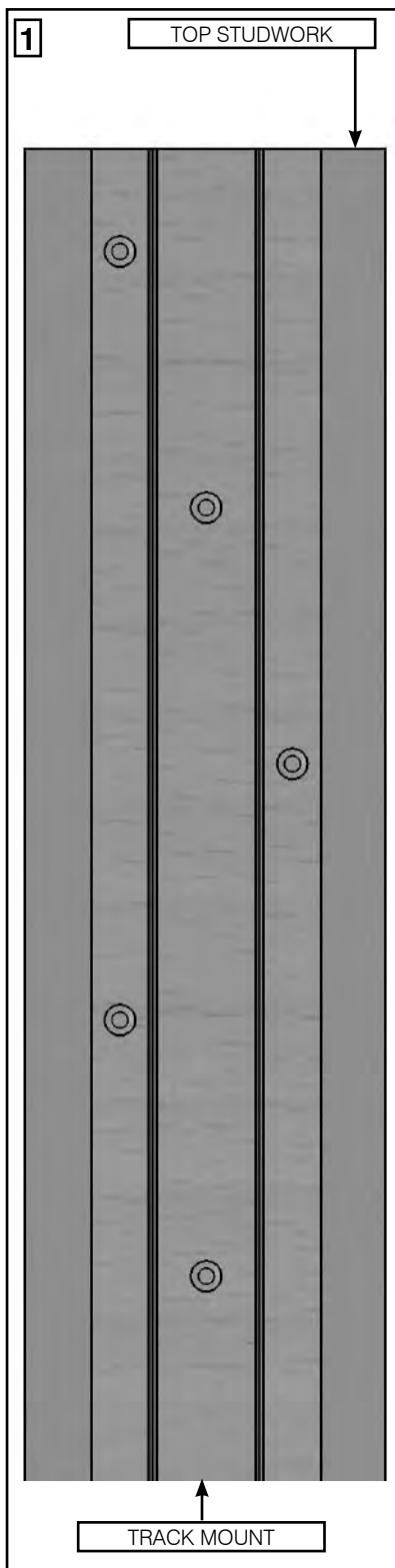

1. Cut the plywood track mount to the width of your horizontal studwork / support frame.
2. Position the track mount in the centre of the top horizontal studwork timber / support frame.
3. Pilot drill and screw through both sides of 'V' Shaped Groove and ensure screw heads are fully sunk into the wood **(Screws not supplied)**.

2. ALUMINIUM TRACK

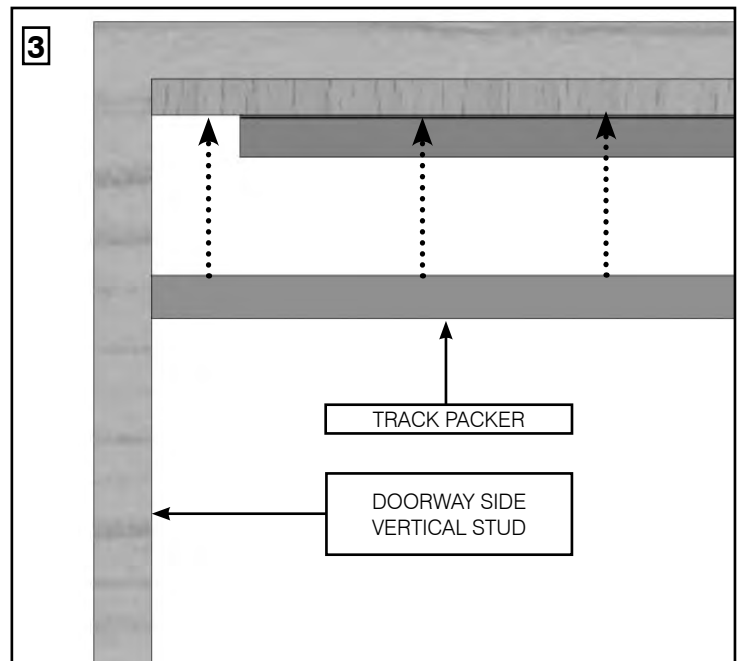
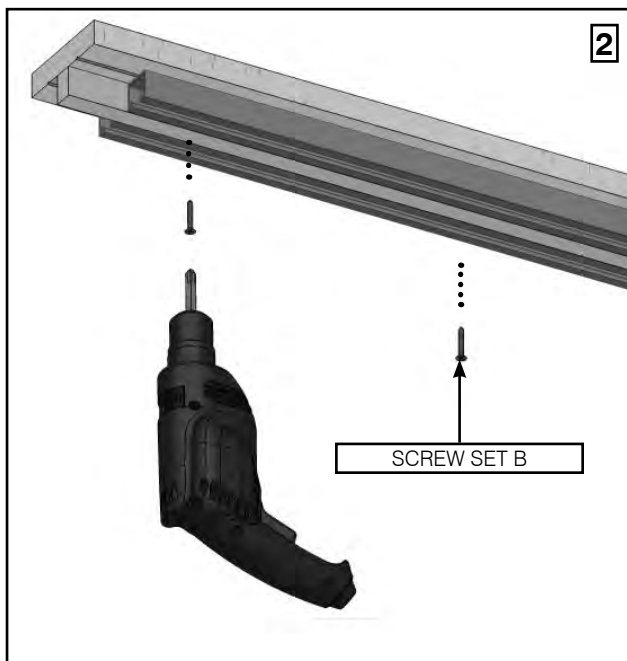
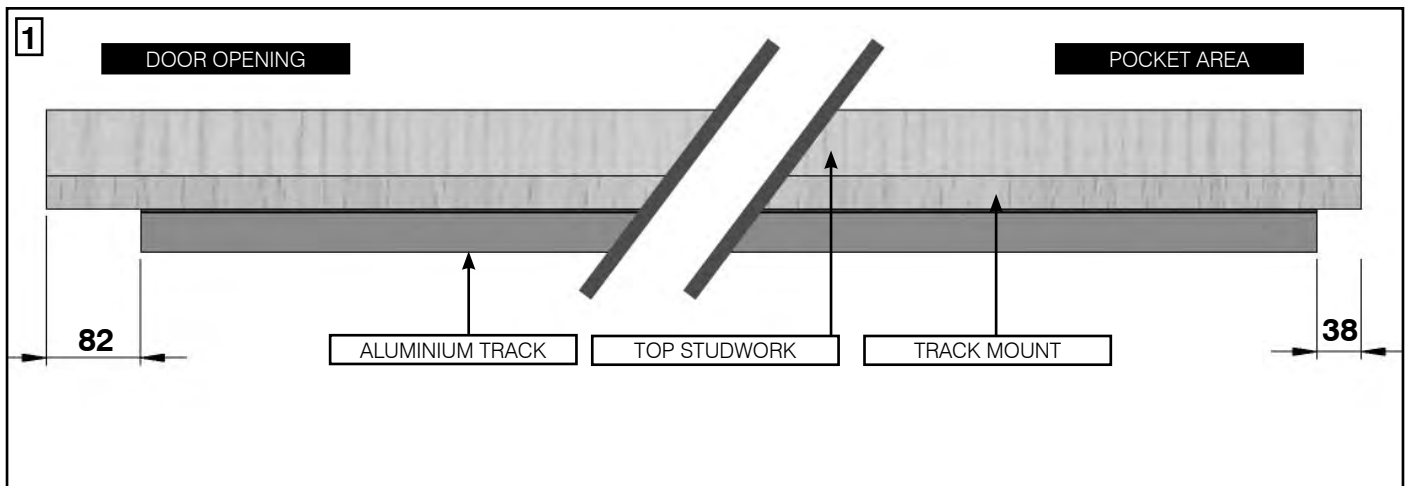

1. Cut the aluminium tracks to the width of your horizontal studwork, minus 120mm. Position 82mm in from doorway vertical stud to allow for the end block.
2. Pilot drill through the holes in the tracks into the 'V' Shaped grooves in the plywood track mount. Screwfix using **'Screw Set B'**.
3. Butt the rectangular track packer to the doorway side vertical stud - inbetween both top rails and fix to the track mount using screws or pins (**not supplied.**)

TRACK SHOULD BE WIPED CLEAN TO REMOVE ANY CONTAMINANT

3. SOLE PLATE

1. Position the leading edge of the sole plate (Door panel width minus 9mm) away from the inside face of the rear studwork

Sole Plate may need cutting down depending on door size.

2. Butt the sole plate centrally to the studwork at the back edge of the pocket.
3. Plumb true to the aluminium track above and secure the plate to the floor with appropriate fixings (**not supplied**).

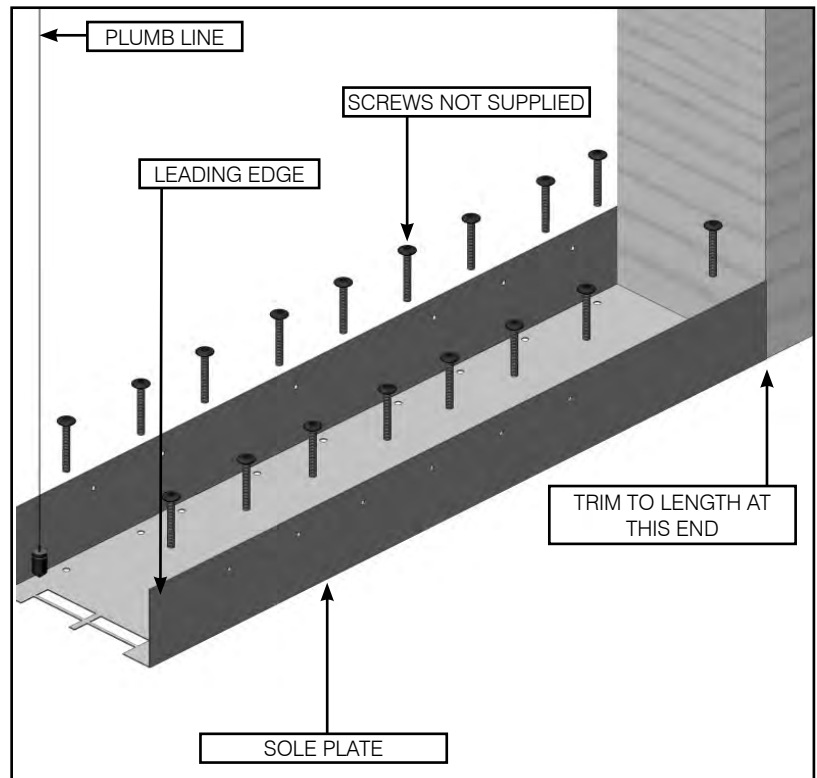

4. 'Z' PANELS

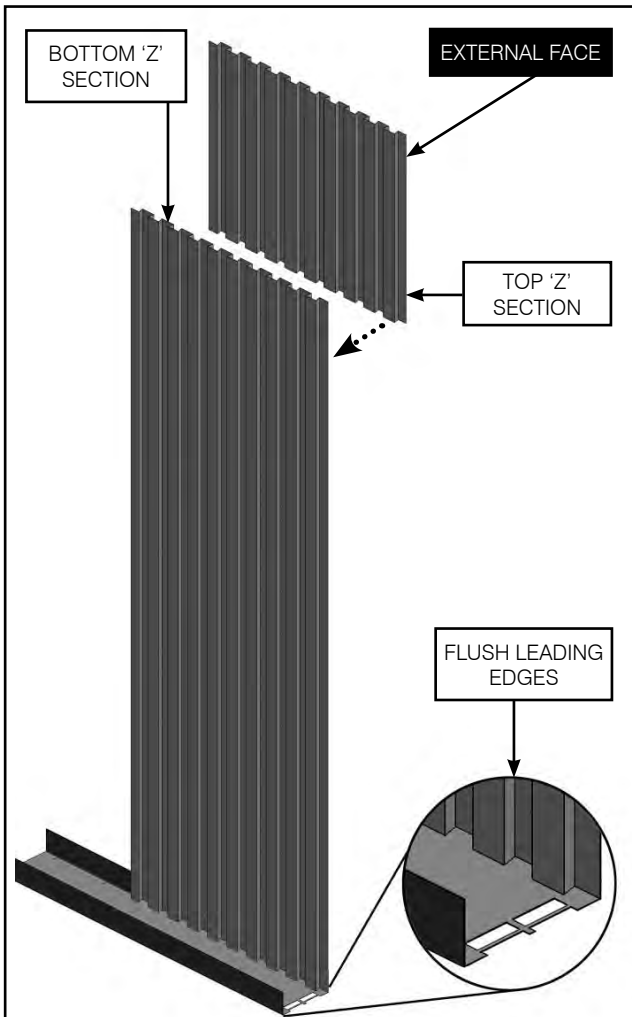

1. Adjust the 'Z' Panels to desired height (inside surface of sole plate to underside of top studwork).
2. Position the bottom 'Z' Panel inside the sole plate so that both leading edges are flush.

Make sure the top 'Z' section is on the outside of the pocket.

Please Note: With wide and intermediary kits a second set of metal 'Z' panels are supplied. The second set should be installed level with the rear of the sole plate. On the intermediary kits the narrow sheets should be to the rear of the pocket

IF YOU ARE USING A REINFORCING KIT - PLEASE REFER TO INSTRUCTIONS 003-285 AND INSTALL IT AT THIS POINT BEFORE SCREW FIXING THE 'Z' PANELS

PLEASE NOTE: TOP 'Z' SECTION IS ON THE OUTSIDE OF THE POCKET

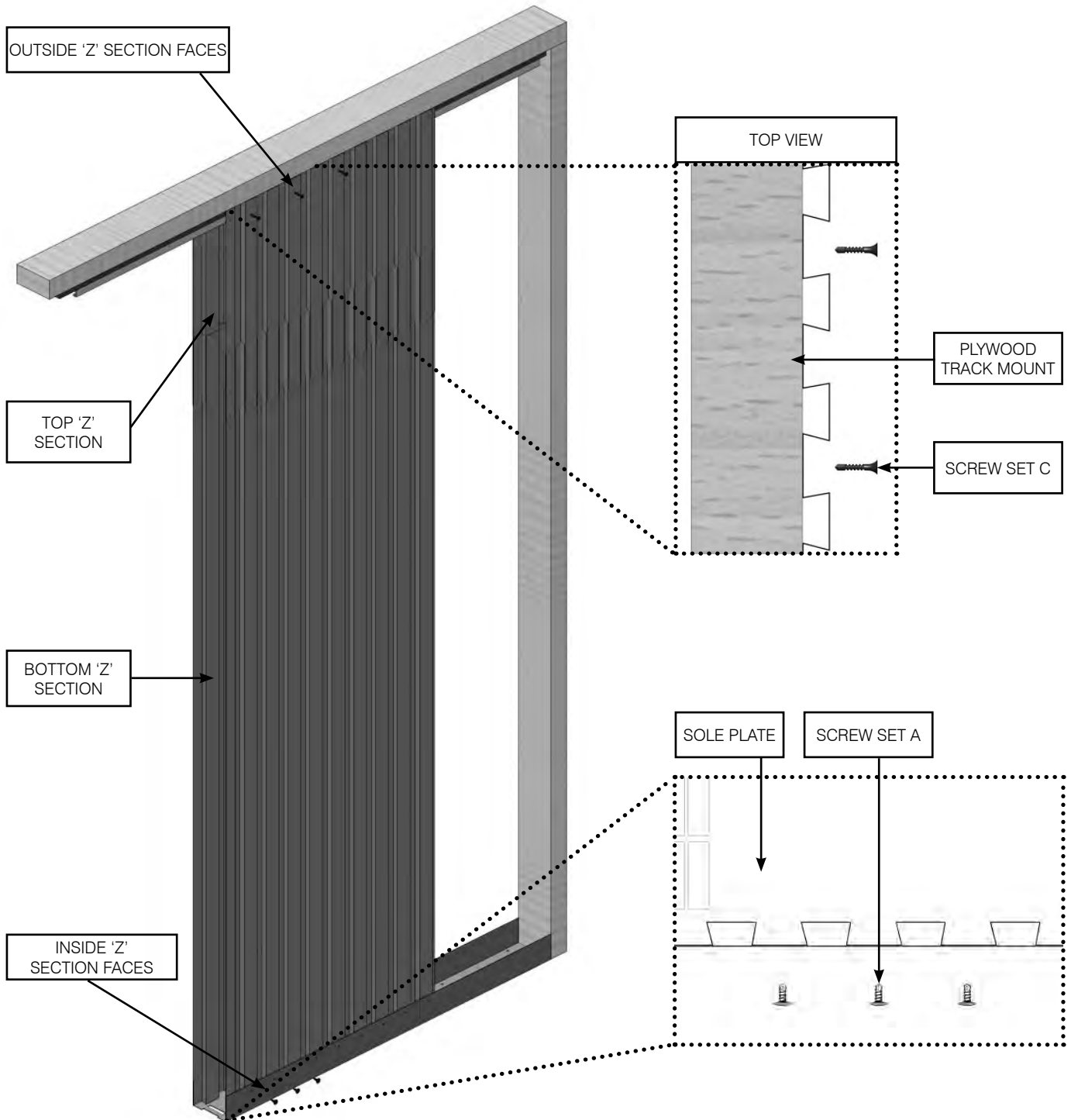

Ensure panels are level and then fix with screws.

1. Fix top 'Z' Section to plywood track mount with **'Screw Set C'**.
2. Fix bottom 'Z' section to sole plate with **'Screw Set A'**.

5. PANEL JOINING

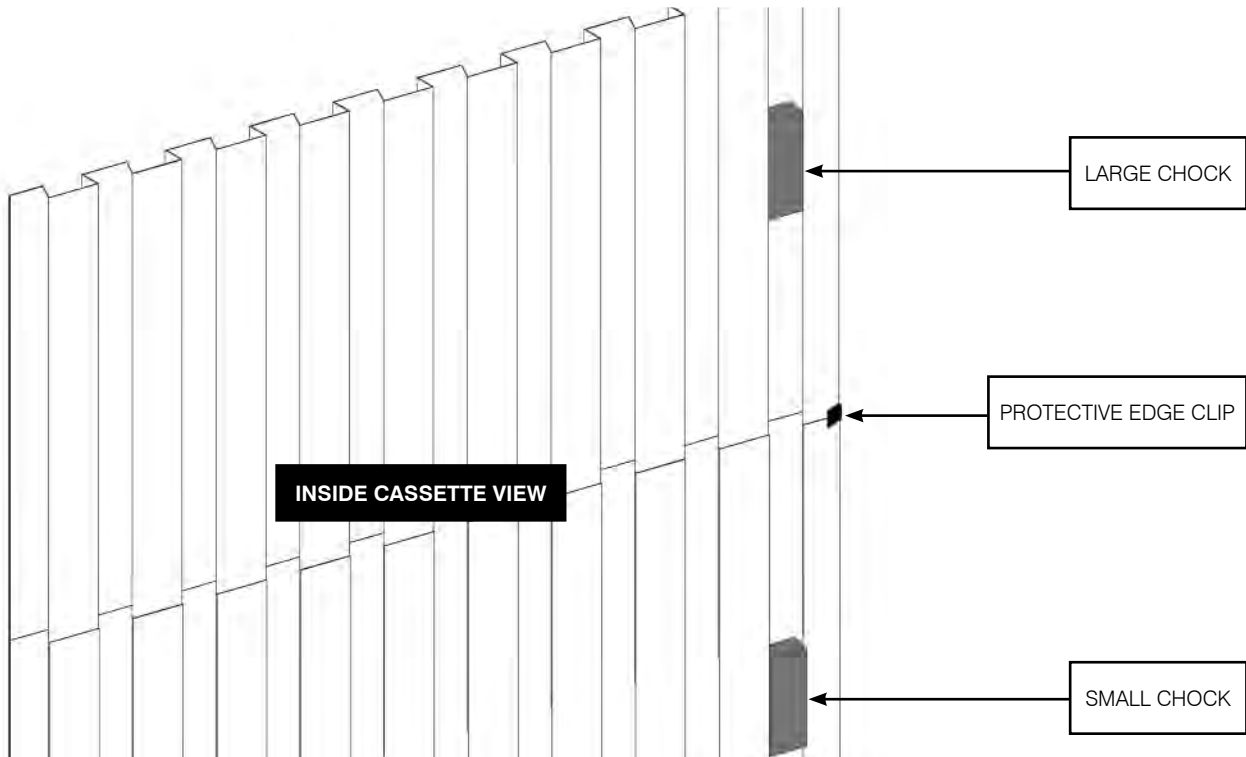

At the back of the pocket, place the protective edge clip onto the 'Z' section, covering where the panels join.

In the last 'Z' section slot towards the back of the inside pocket, push the large chock into the top 'Z' section and the two small chocks into the bottom 'Z' section.

This pushes the edge outwards so the door does not snag on it when closing.

For intermediary and wide kits, fit the chocks in the first and last slot in the rear 'Z' sections as detailed above. Fit protective edge clips to all joints on rear panels.

Repeat stages 4 - 5 on the other side of the pocket.

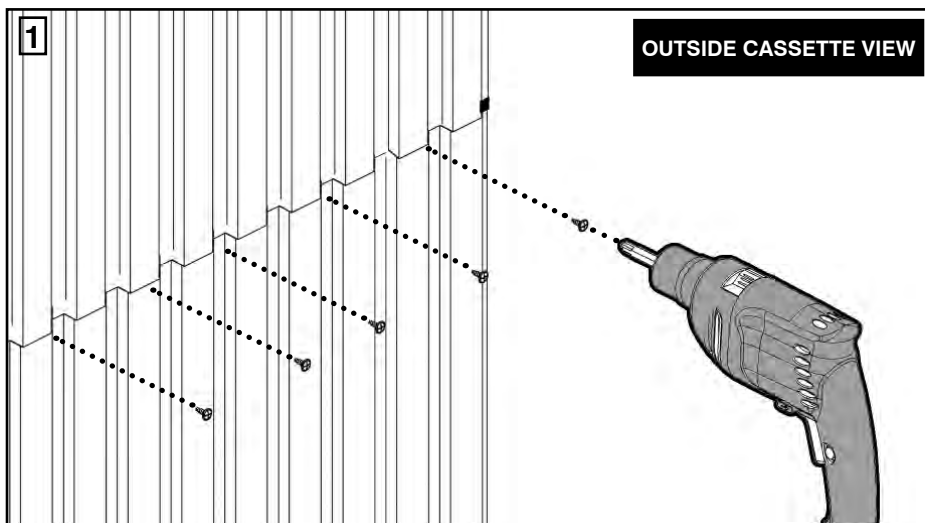

1. Screw through from outside to join panels together in five locations using '**Screw Set A**' (pilot holes not required).

ENSURE WHEN SCREWING THE TWO SHEETS THEY ARE STRAIGHT AND DO NOT BECOME BOWED AS THE SCREW PUSHES THROUGH

6. TROLLEY MOUNTING

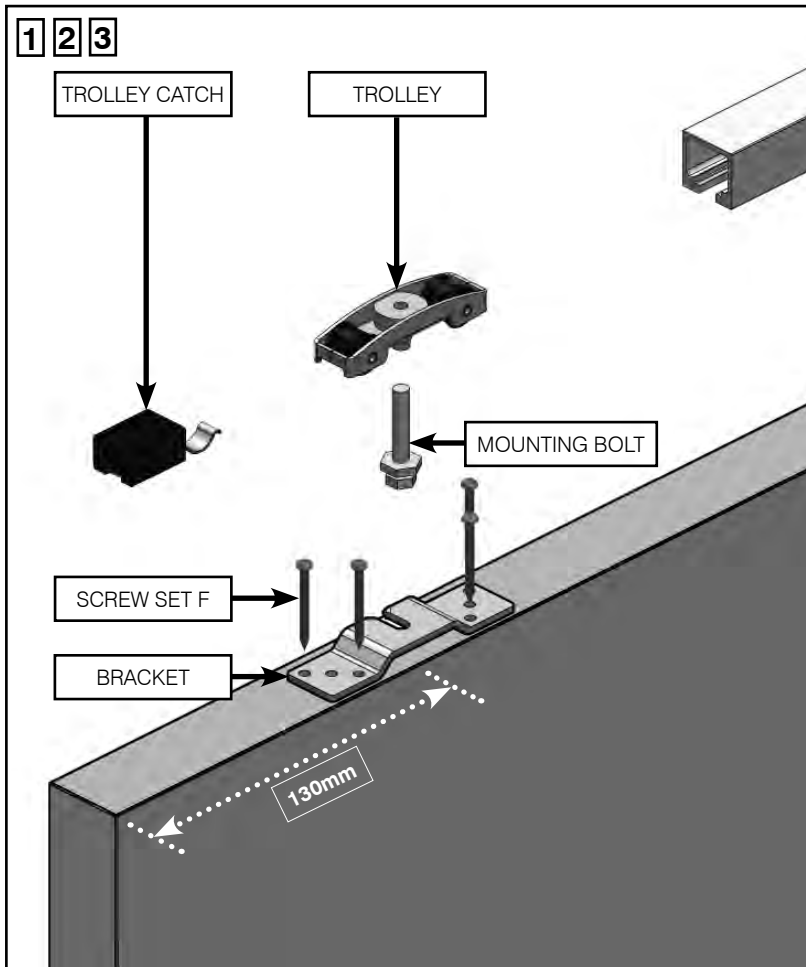

1. Fit the bracket centrally to the top edge of the door using **'Screw Set F'**. Ensure the bracket centre is 130mm away from the door edge. Repeat the procedure for the other bracket.
2. Screw the mounting bolts into the trolleys. Ensure both bolts are screwed in the same amount on both trolleys to ensure the door is level and make adjustment easier.
3. Slide both assembled trolleys into the top rail.
4. Slide the trolley catches into the front of the track. Do this for both primary and secondary doors. Do not fix them in place until the door has been hung (This is explained in Stage 19 of the instructions)

7. DOOR GUIDE

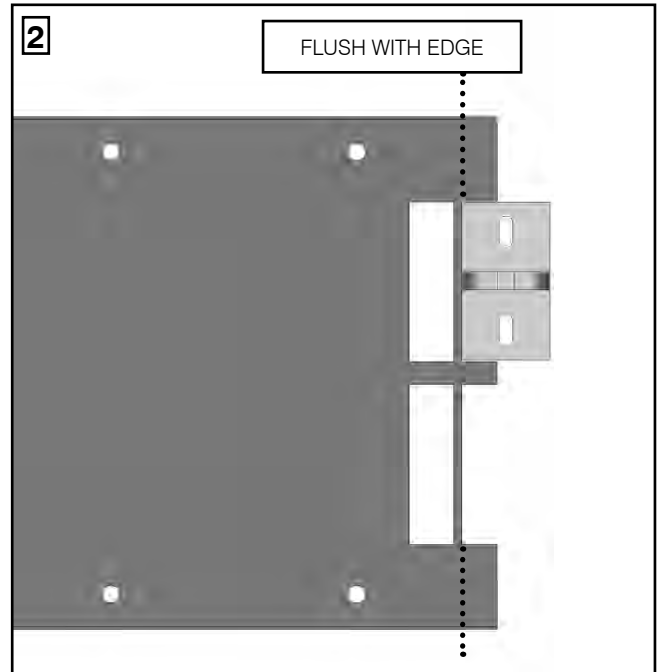
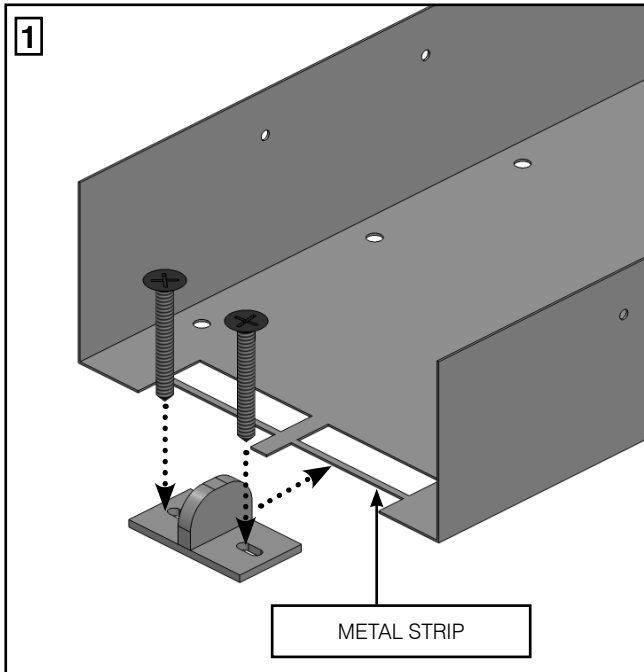

1. Fix the metal floor guide into the sole plate by inserting it into the right pre-cut area.
2. Ensure it is flush against the metal strip and then scew fix firmly into the floor **(screws not included)**.

8. BOTTOM DOOR GROOVE

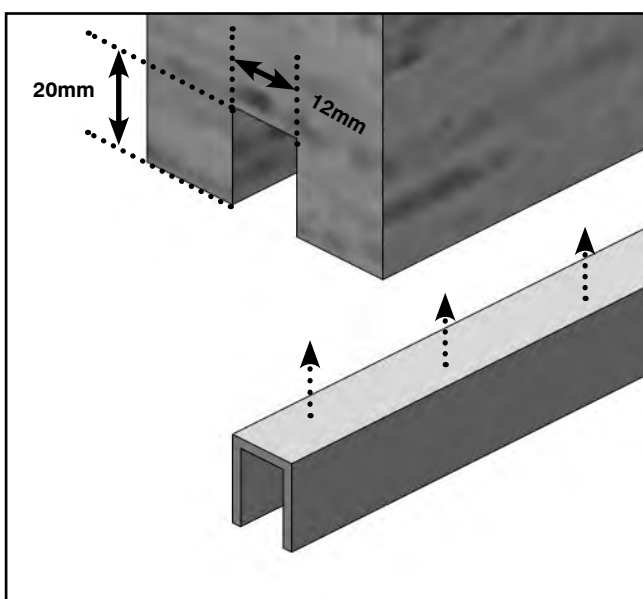

1. Cut a groove in the bottom face of the doors to suit the plastic channel which the floor guide runs in.

Ensure when cutting the groove it is centralised along the width of the doors.
2. Bond or Pin the channel into the cut groove ensuring the metal floor guide can move freely within it.

9. PULLEY FITTING - SECONDARY DOOR

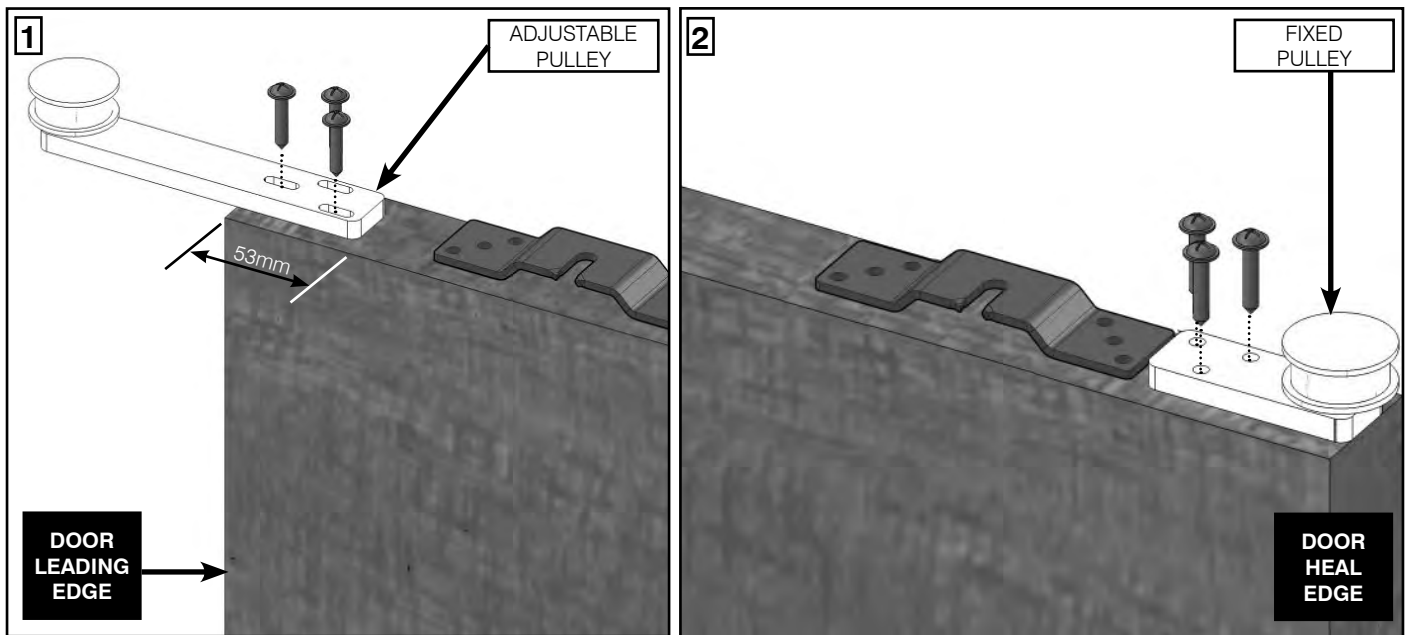

1. Position the adjustable pulley centrally onto the top face of the secondary door, 53mm in from the leading edge. Screw into the door with appropriate fixings **(screws not included)**.
2. Position the fixed pulley centrally onto the top face of the secondary door. Make sure it is flush with the heel edge of the door. Screw into the door with appropriate fixings **(screws not included)**.

10. MOUNTING BRACKET - PRIMARY DOOR

1. Nearest the heel edge, position mounting bracket flush with the front face onto the top of the primary door. Make sure it is butted up against the bracket.

Screw into the door with appropriate fixings **(screws not included)**.

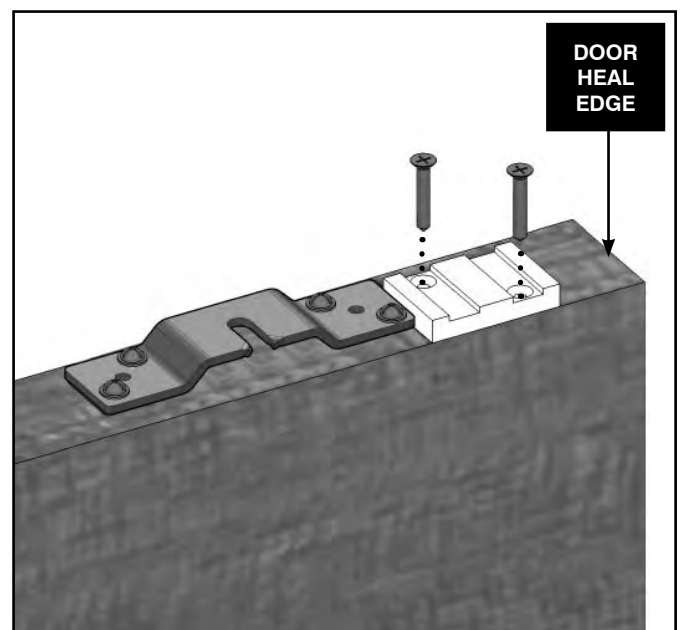

11. LOWER GUIDE - SECONDARY DOOR

1. Position the lower guide 6.5mm in from the leading edge and 4mm down from the bottom of the secondary door. Fix it to the front face of the door using appropriate fixings (screws not included).

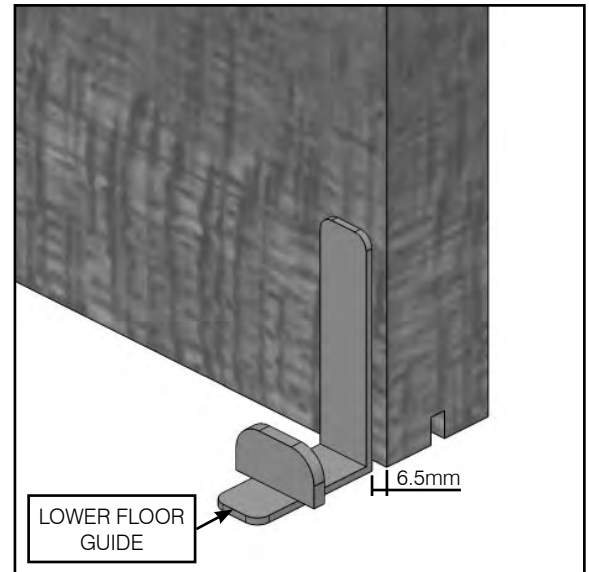
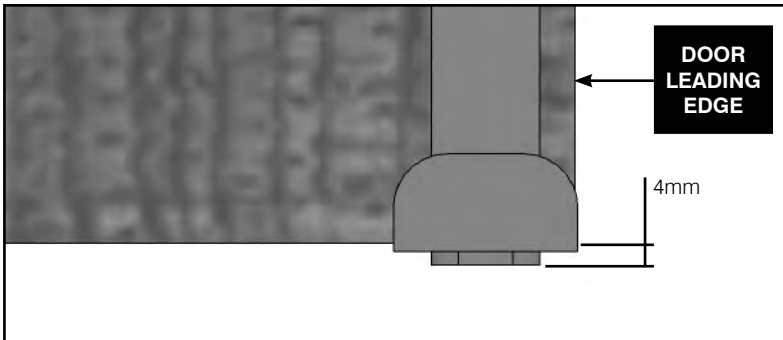

12. COG BELT FITTING - SECONDARY DOOR

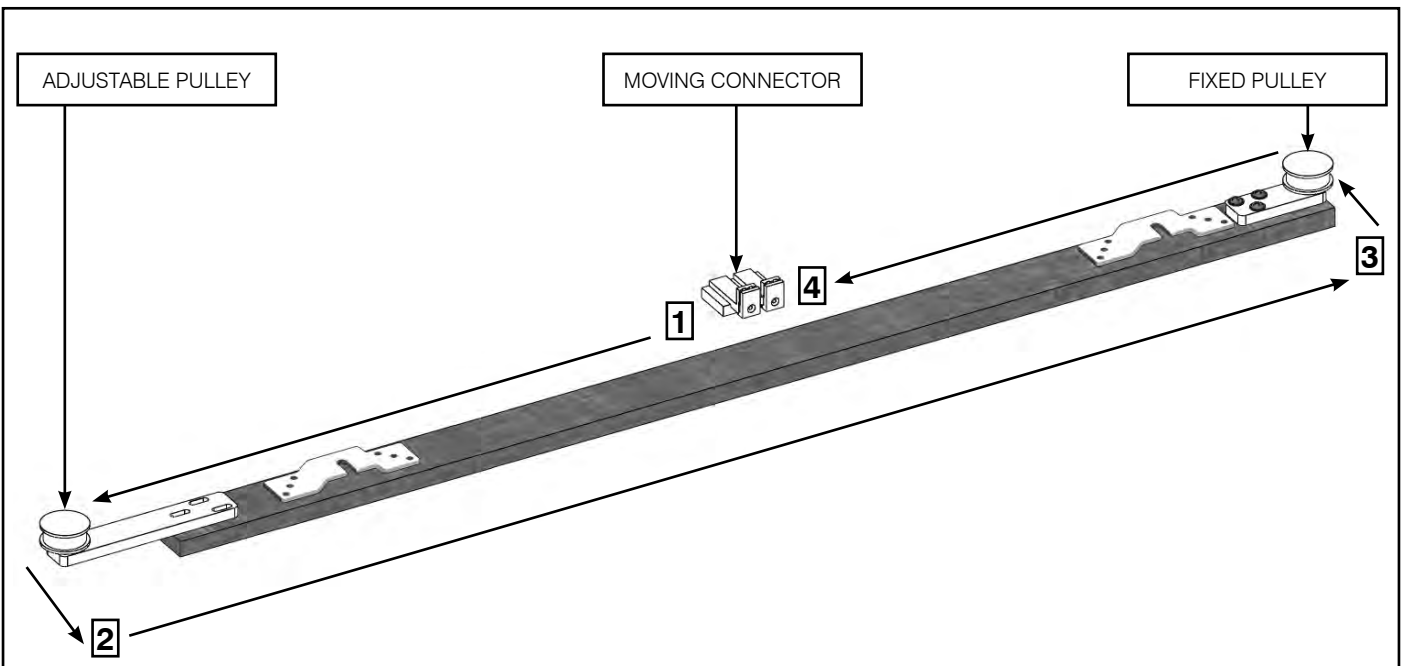

1. Lock one end of the cog belt into the moving connector.
2. Pass it around the adjustable pulley
3. Pass it around the fixed pulley
4. Clamp taught into the other side of the moving connector.

Cut any excess belt off, leaving about 20-30mm.

PLEASE NOTE: PARTIALLY UNSCREW THE ADJUSTABLE PULLEY AND ALTER THE POSITION TO ACHIEVE THE DESIRED BELT TENSION, AND THEN TIGHTEN SCREWS TO FIX IN PLACE.

13. SECONDARY DOOR HANGING

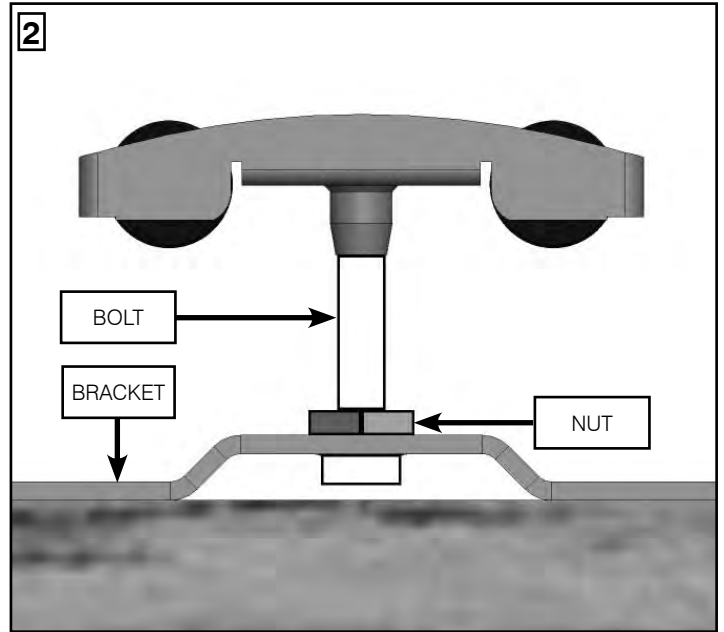
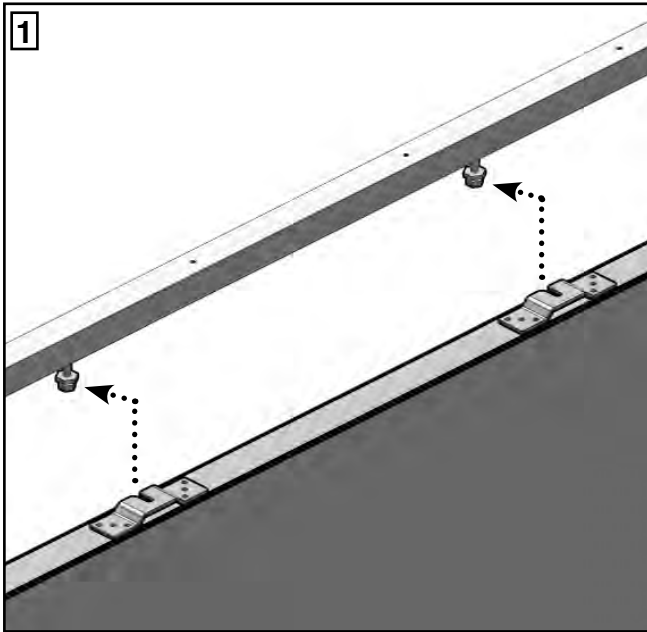

1. Hang secondary door by sliding the brackets onto the bolts, taking care not to damage the belt or door on the door guide.
2. Tighten the top nuts onto the brackets.

14. PRIMARY DOOR HANGING

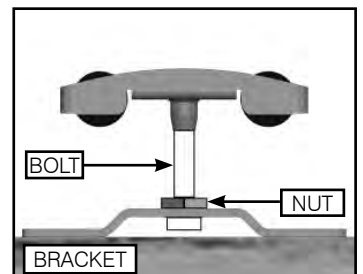
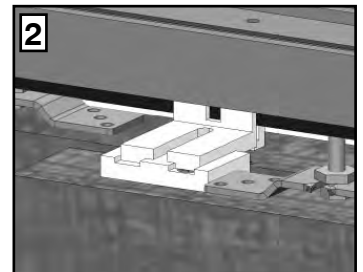
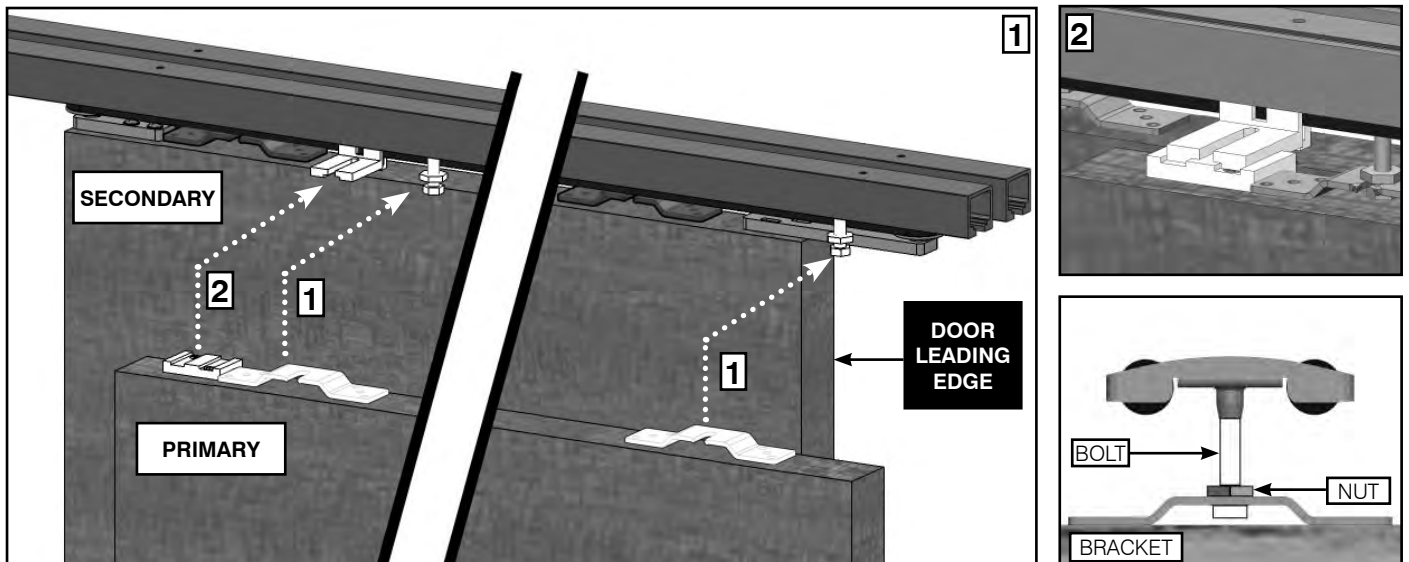

1. Hang primary door by sliding the brackets onto the bolts.
2. Make sure the moving connector is placed into the mounting bracket.
3. Tighten the top nuts onto the brackets.

TEST TO SEE IF DOOR RUNS SMOOTHLY AND IS PLUMB. IF NOT, CORRECT WHERE NECESSARY BY ADJUSTING THE NUTS AND BOLTS USING SPANNERS PROVIDED.

15. JAMB FITTING - CASSETTE EDGE JAMB

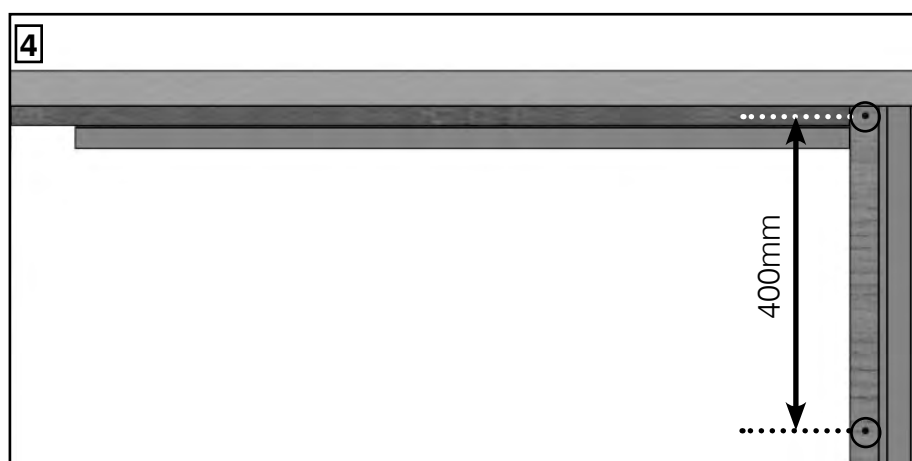
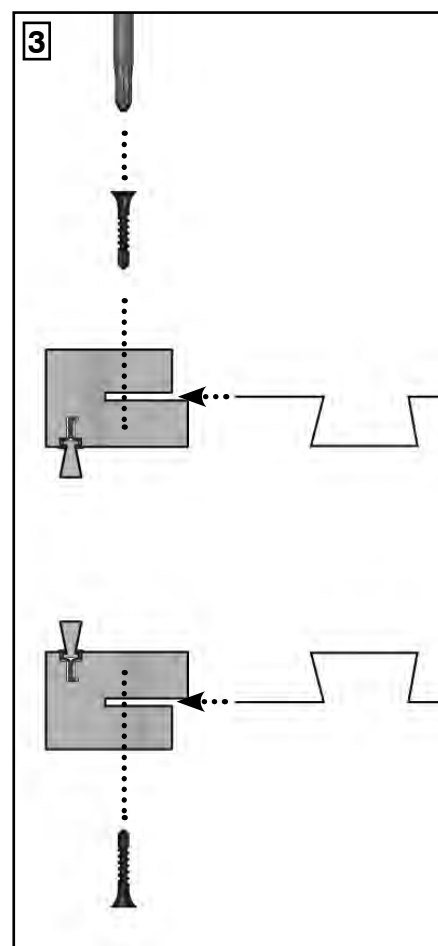
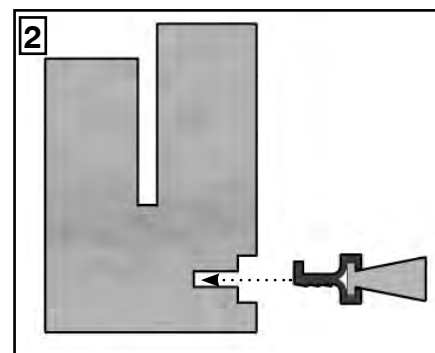
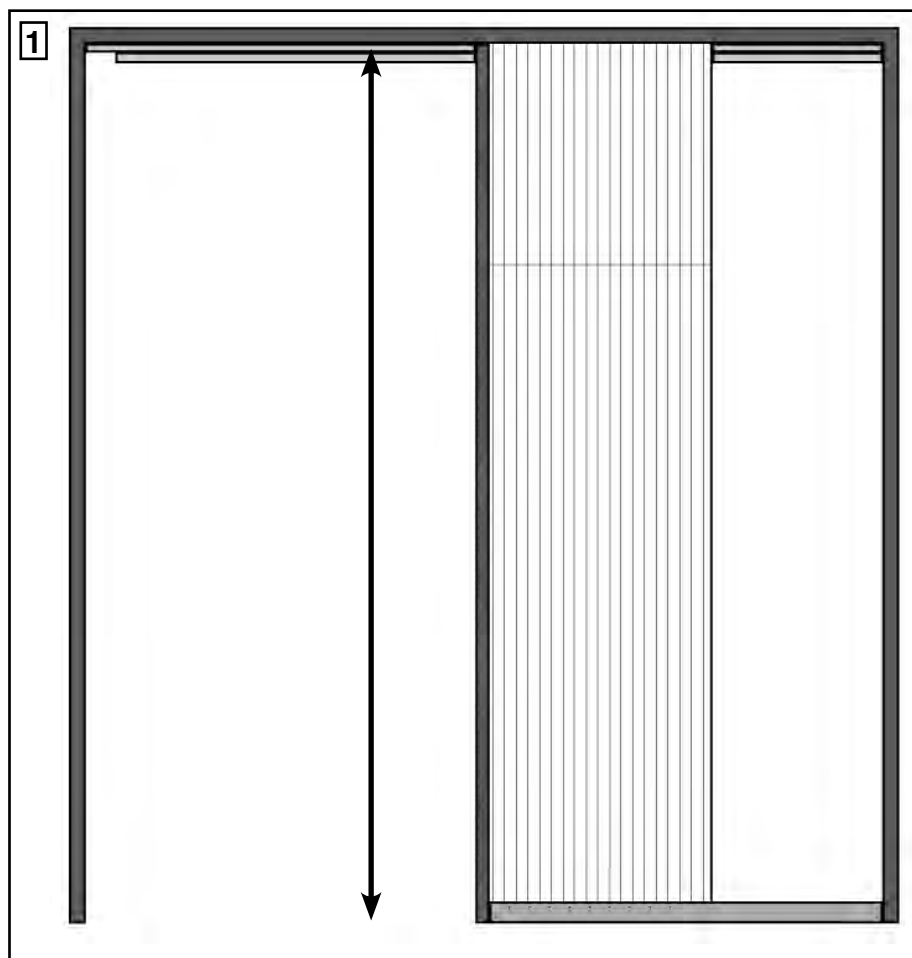

1. Cut the cassette jambs to the aperture height from floor to underside of stud.
2. Push fit the brush seals into both cassette jambs.
3. Press the jambs onto the edge of the 'Z' Sections and secure with 'Screw Set C'.
4. Screw at the top and bottom and then approximately every 400mm.

16. 'L' SHAPED TRACK PACKERS

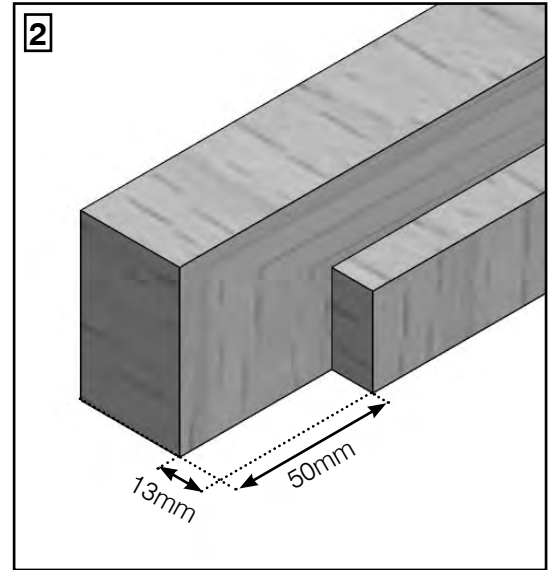
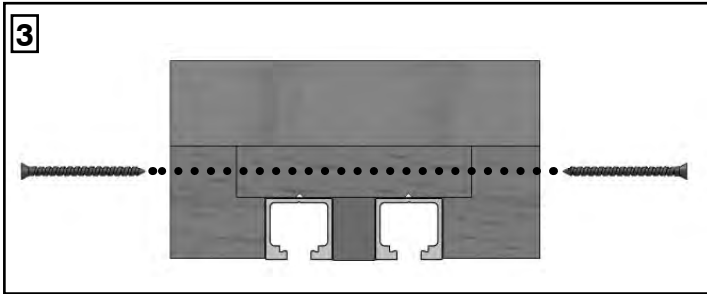
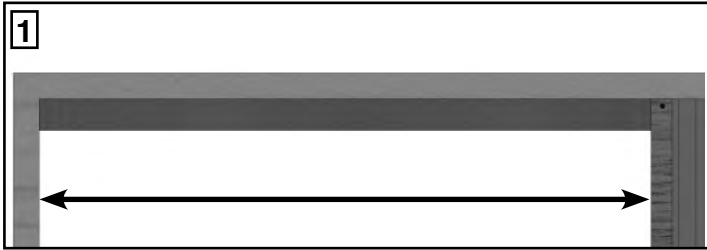

1. To cut the 'L' Shaped track packers, measure remaining door opening width.
2. Cut a notch in 1 'L' Shaped Track Packer as shown in image (50mm x 13.5mm). This is to be placed at the pocket end on the **secondary door side**.
3. To secure the 'L' shaped packers, first pilot and countersink a series of holes at 300mm intervals along their length. Screw surely through into the plywood track mount using **'Screw Set E'**.

17. CONNECTOR FITTING

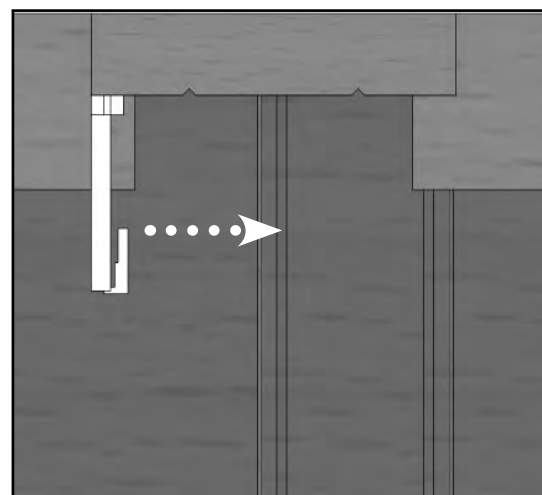
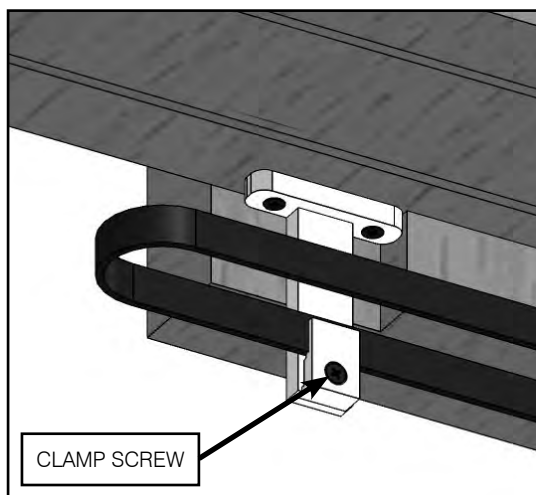

1. Screw fix the fixed connector into the space cut away in the 'L' Shaped Track Packer using the screws provided.

Close both doors fully out of the pocket and affix the clamp to the belt by loosening and re-tightening the clamp screw.

MAKE SURE THE CLAMP IS FACING INWARDS SO THAT THE BELT CAN BE POSITIONED CORRECTLY.

18. JAMB FITTING - FRONT EDGE JAMBS

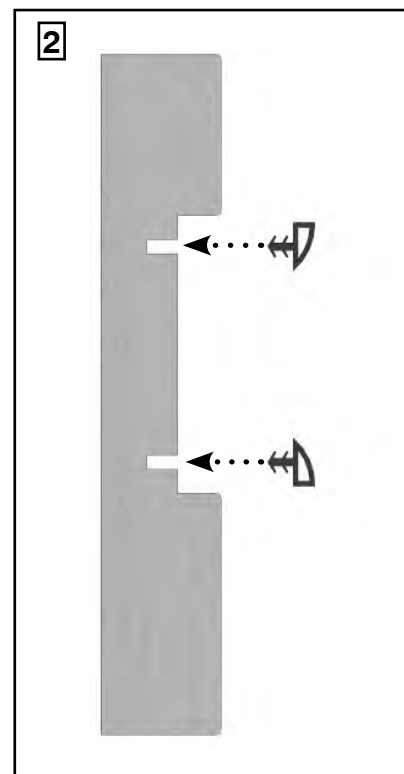
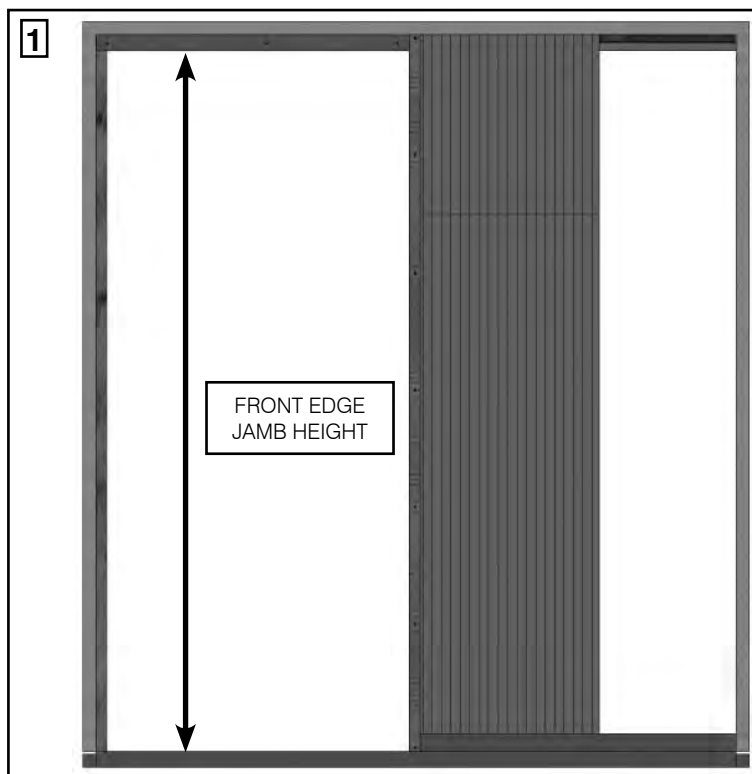

1. Using a sawing or cutting tool, cut the front edge jamb lengths to fit from the the floor to the underside of the 'L' Shaped Track Packers. Slide the door to its closed position to test fit. Secure to studwork with appropriate fixings.
2. Cut the rubber seals to the front edge jamb length and press into the pre-made grooves.

19. TROLLEY CATCHES

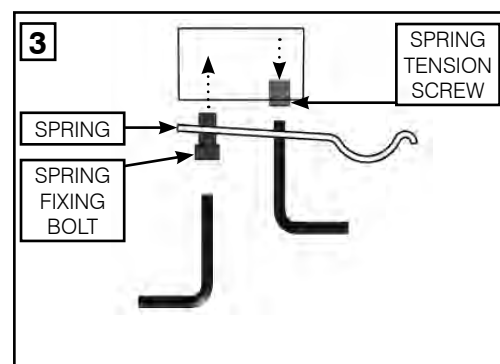
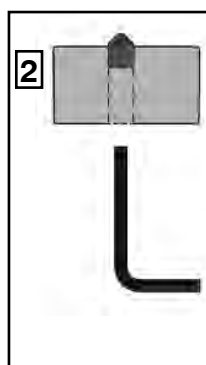
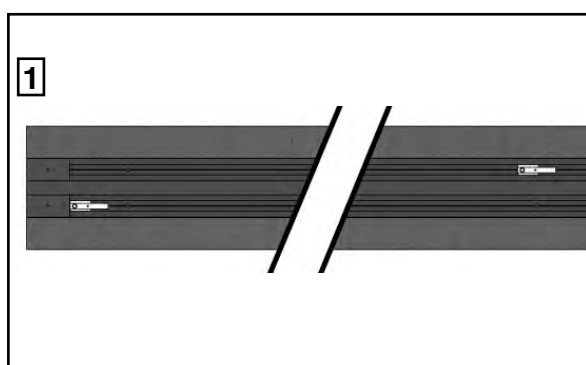

1. Fix one trolley catch into each aluminium top rail at the front only (door opening side).
2. Fix trolley catches in required positions within the aluminium track by removing the spring giving access to the centre hole locking grub screw. A 3mm allen key is required.
3. Replace the spring and adjust the clamping bolt to the desired tension to hold the trollies in place using an M5 allen key.

TEST THE DOOR TO ENSURE THE CATCHES ALLOW THEM TO CLOSE FULLY.

20. JAMB FITTING - HEAD JAMB

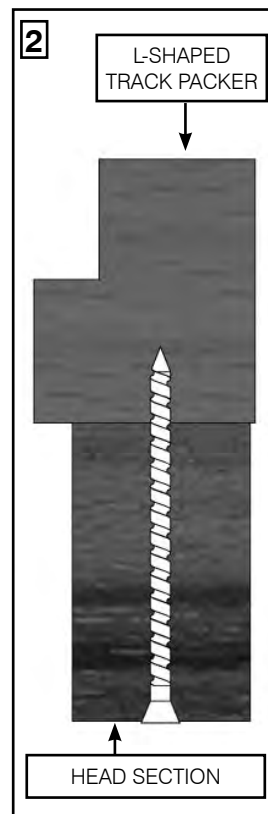
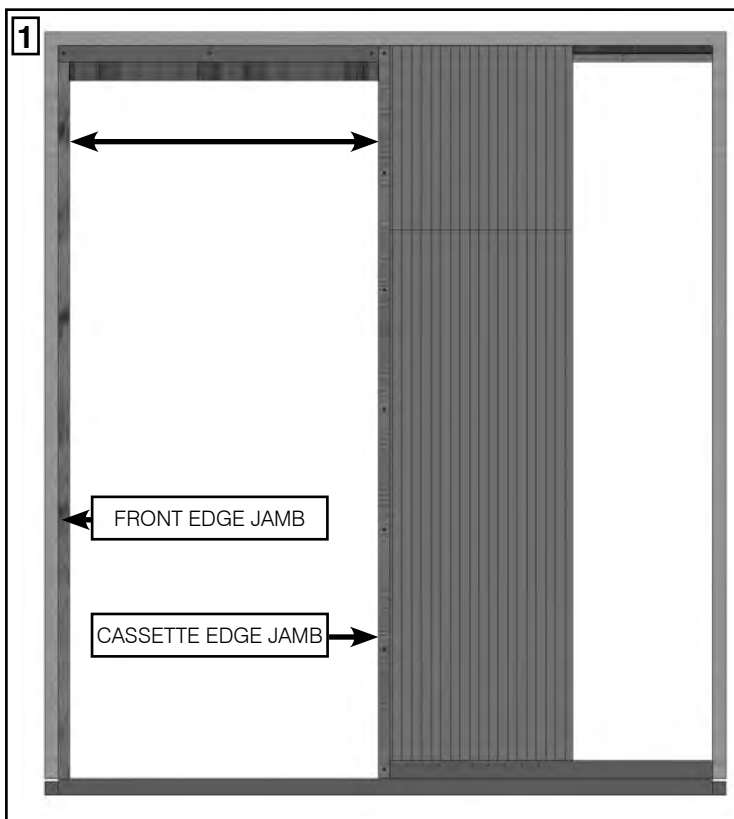

1. Cut the head section to fit between the front edge jamb and the cassette edge jamb.
2. The head sections can be secured to the L-Shaped Track packers using 80mm woodscrews to screw through the head jamb fixing into the L-Shaped Track Packers

Screws are not supplied

21. END BLOCKS

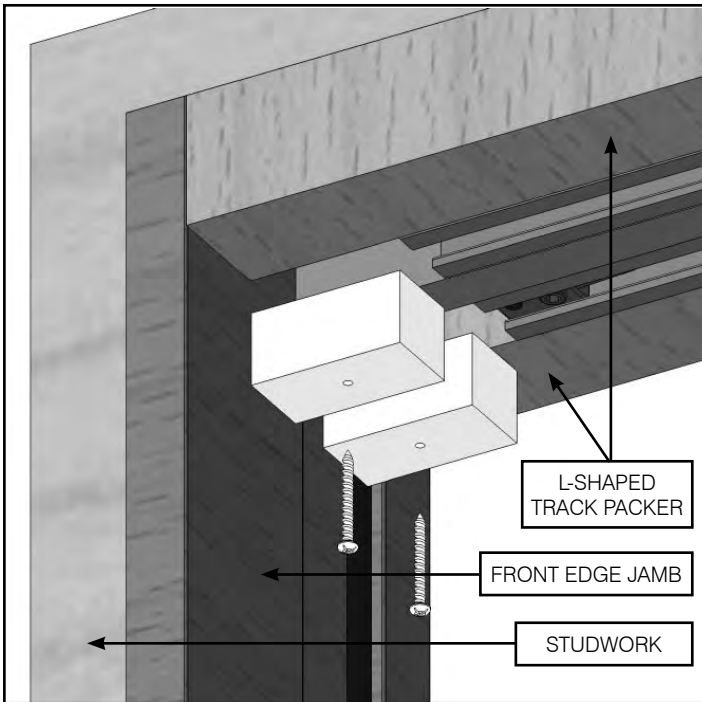

1. Pilot drill a hole in the wooden end blocks using a 2mm drill bit. Drill the hole in the centre of each block.
2. Using the newly made holes, with **'Screw Set D'**, screw into the 82mm spacing left between the aluminium track and the studwork. Make sure each end block is butted against the track.

22. PLASTERBOARD

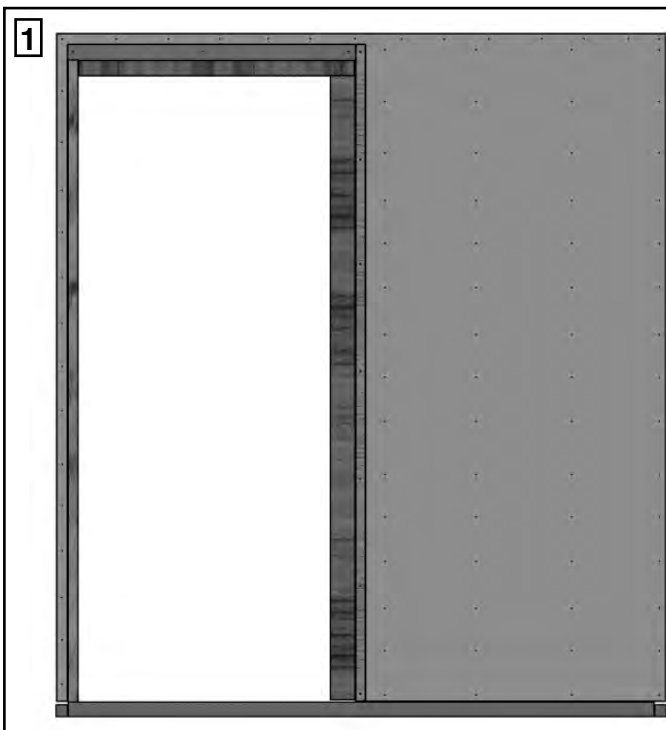

1. Clad the kit in 12.5mm of plasterboard. Ensure it butts up tight against the outside of all jambs.

Screw the plasterboard into place through the wooden frame and plasterboard.

Take care that any screws do not protrude into the pocket cavity.

FIXINGS FOR THIS STAGE ARE NOT SUPPLIED