

SPIRAL

STANDARD

Model reference: 0352014

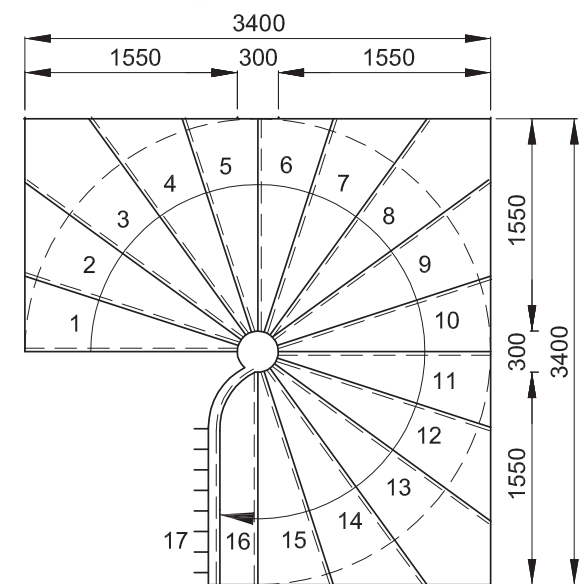

Diameter	300 mm	Max Stair Width	1550 mm
Angle	18°	Weight (max)	2600 kg
Risers	from 160 to 190 mm	Rotation	Right or Left
Nosing	20 mm		

BY SEGMENT

Model reference: 0353013

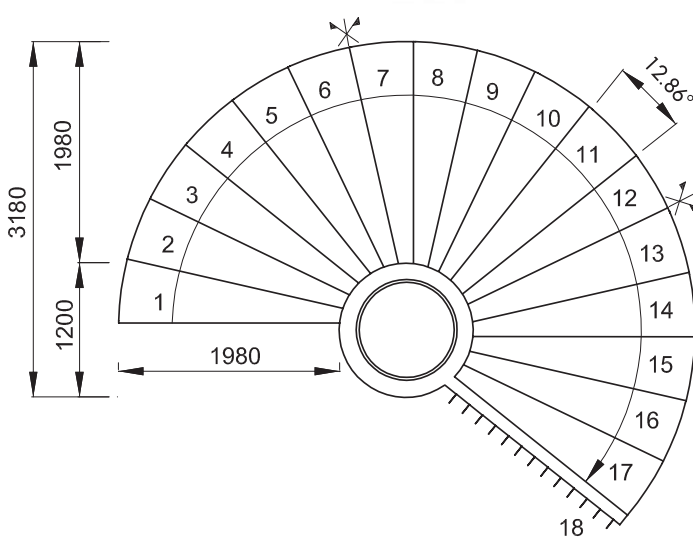

Diameter	1200 mm	Max Stair Width	1980 mm
Risers	from 160 to 170 mm	Weight (max)	2400 kg
Nosing	20 mm	Rotation	Right or left

WITH OVOID SHAFT

Model reference: 0351012

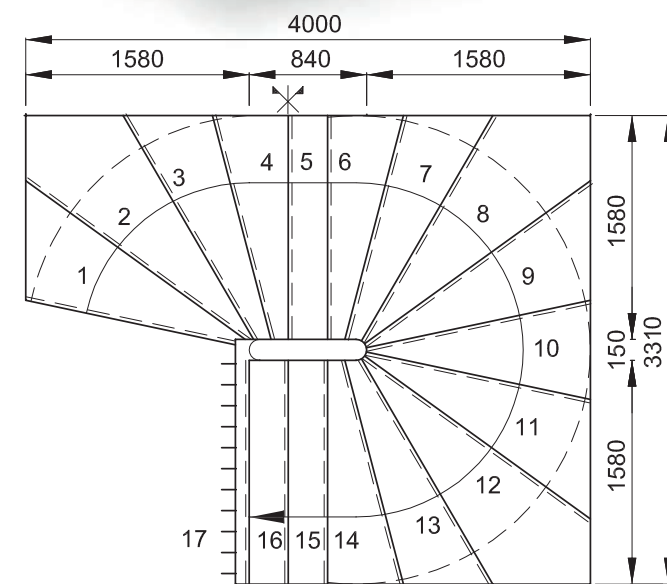
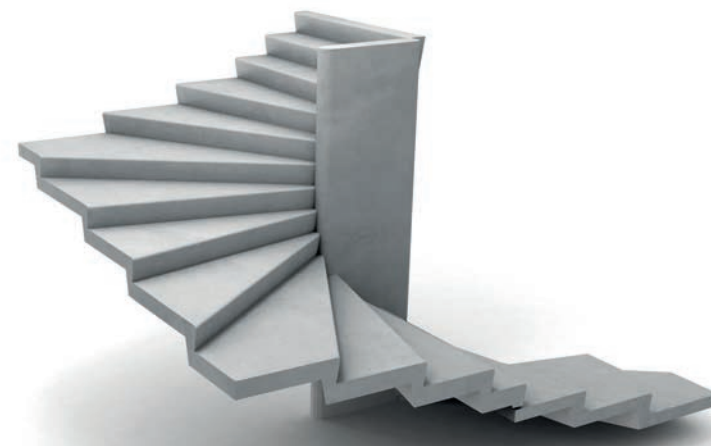

Shaft	length 840 mm width 150 mm	Max Stair Width	1580 mm
Risers	from 160 to 190 mm	Weight (max)	3000 kg
Nosing	20 mm	Rotation	Right or Left

HELICAL

ELLIPTICAL

Model reference: 0334010 to 0334015

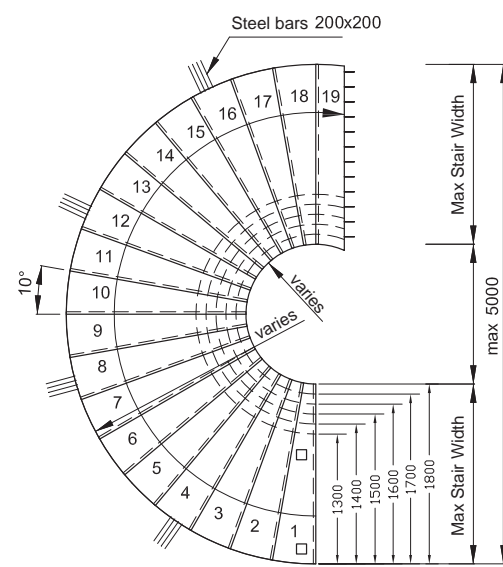

Diameter	from 700 to 1200 mm	Max Stair Width	1800 mm
Angle	10°	Weight (max)	3300 kg
Risers	from 160 to 170 mm	Rotation	Right or Left
Nosing	20 mm		

WINDING STAIRCASE

DOUBLE WINDER

Model reference: 0375009

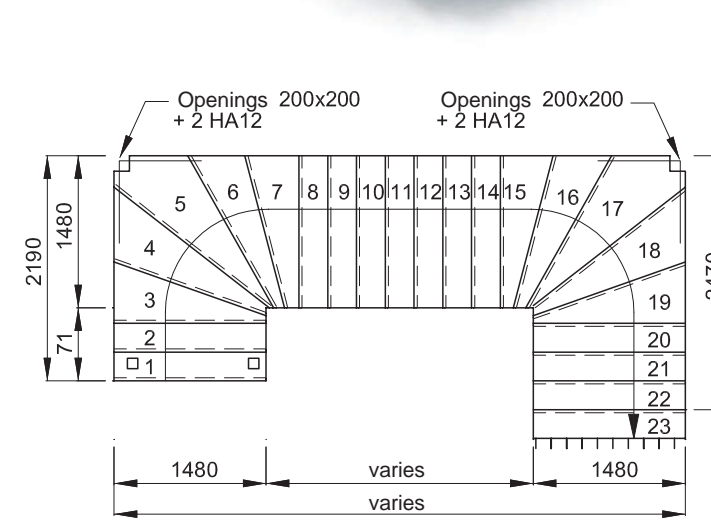

Risers	from 160 to 170 mm	Max Stair Width	1480 mm
Nosing	20 mm	Weight (max)	5400 kg
		Rotation	Right or Left

CENTRAL VOID

Model reference: 0374009

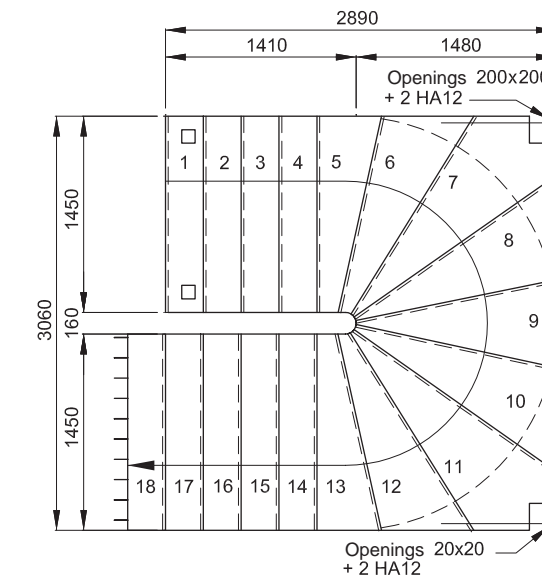

Risers	from 156 to 164 mm	Max Stair Width	1450 mm
Nosing	20 mm	Weight (max)	4600 kg
		Rotation	Right or Left

STRAIGHT

STANDARD

Model reference: 0314001 / 0314003 / 0314004 / 034005 / 0315001

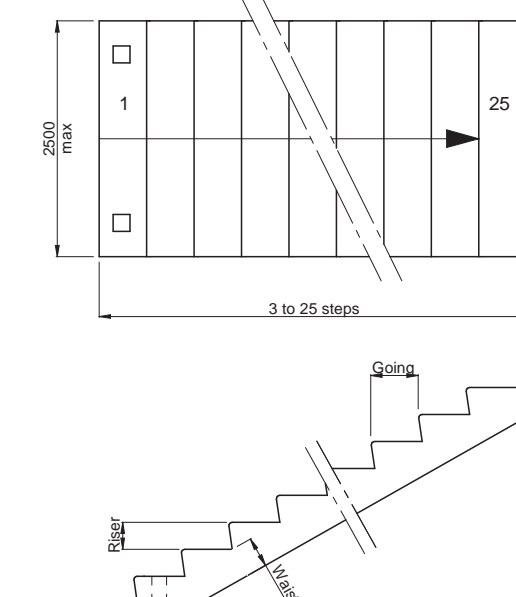

Risers	from 150 to 180 mm	Max Stair Width	2500 mm
Going	from 220 to 350 mm	Waist	from 140 to 240 mm

CARRIER VEIL

Model reference: 0313004

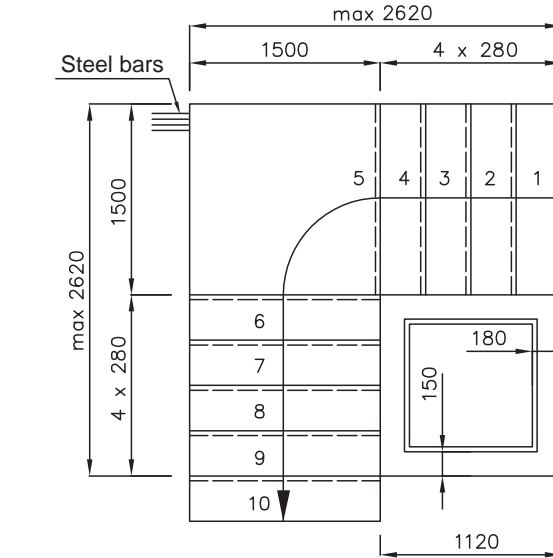
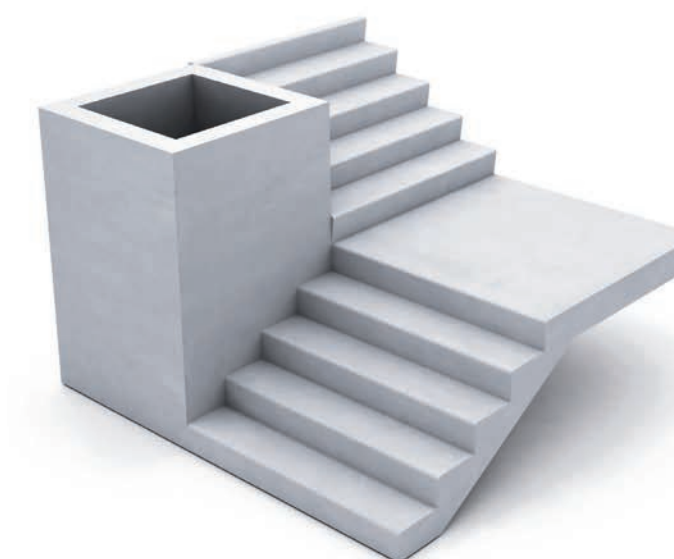

Risers	from 150 to 180 mm	Max Stair Width	1500 mm
Going	≥ 280 mm	Weight (max)	4800 kg
Rotation	Left		