

installation guide

CUTPILE CARPETS

Planning and securing cut pile carpets

The method described below is provided for guidance only, we cannot accept responsibility for workmanship and problems arising from improper installation. The method follows the stages for bonding the carpet before making the seams and trimming the edges. In all cases the floorcovering should be rolled out flat in a minimum room temperature of 18° C for 24 hours to acclimatise.

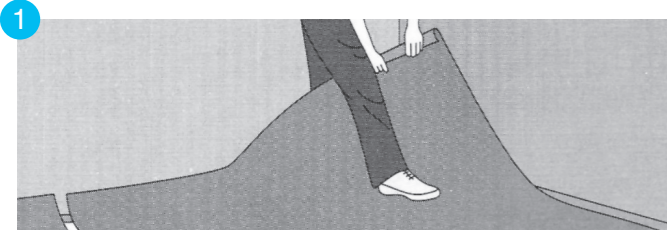

1 Wherever possible lay the carpet down the length of the room to minimise the number of joints. Avoid joints in doorways and high traffic areas. Measure the length of the room, and cut the first piece from the roll allowing an additional 75mm for trimming. Ensure an allowance is made for doorways, alcoves and any irregularities of the walls. Starting at the corner furthest from the door, lay the first piece into position lapping up the walls at both ends sufficient for trimming.

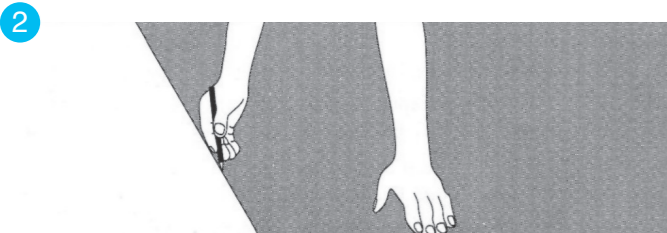

2 Run a pencil along the inner edge of the flooring making a guide line on the floor for the application of adhesive.

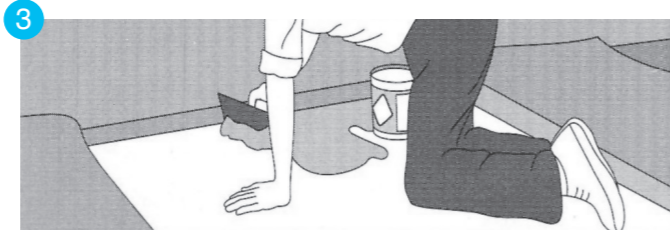

3 Fold the sheet half way back taking care not to disturb the positioning of the flooring. Apply the recommended adhesive onto the subfloor using the application technique recommended by the manufacturer, from 20cm inside the first guide line to 20cm inside the next. Replace the carpet carefully and accurately back into position and roll with a 68kg flooring roller to ensure overall contact with the adhesive. Repeat for the other end of the sheet. Successive lengths may be installed in this way.

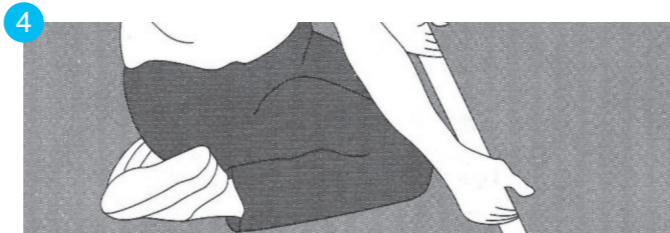

4 Measure and cut the second piece from the roll. Position the second piece with the edge overlapping the first by approximately 5cm and mark a guide line on the floor with a pencil at the next seaming edge.

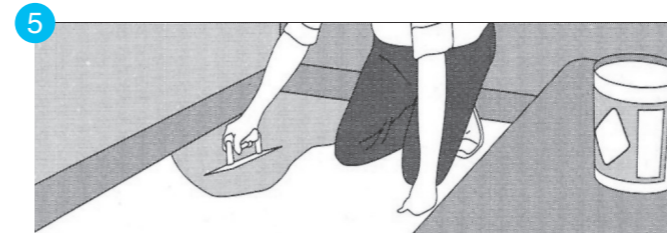

5 Fold the sheet half way back taking care not to disturb the positioning of the flooring. Apply the recommended adhesive onto the subfloor using the application techniques recommended by the manufacturer, from the wall to within 20cm of the guide line. Replace the carpet carefully and accurately back into position and roll with a 68kg flooring roller to ensure overall contact with the adhesive. Repeat for the other half of the sheet.

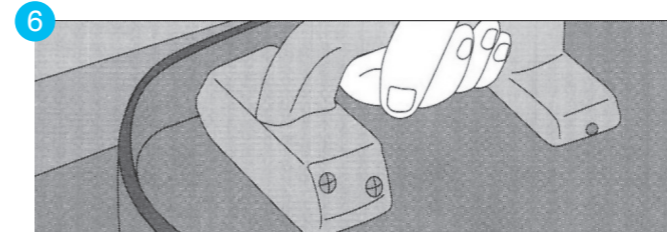

6 Using an Araseur or a sharp knife trim the carpet to fit against the perimeter walls. .

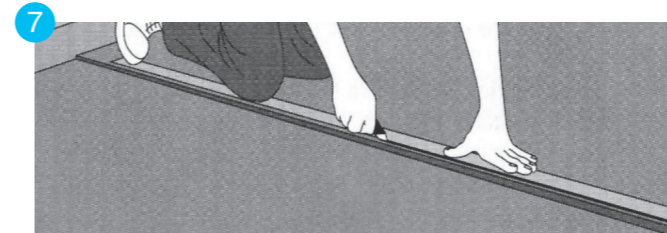

7 Position a straight edge along the middle of the overlap and cut through both pieces of carpet with a sharp knife and remove the surplus. Fold back the seam edges and apply adhesive onto the subfloor. Re-lay the carpet and roll with a 68kg flooring roller to ensure overall contact with the adhesive.

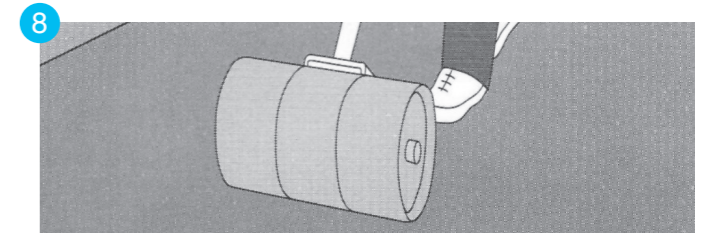

8 When the floor has been completely covered re-roll the area again to maintain good adhesive contact.



The method described is provided for guidance only, we cannot accept responsibility for workmanship and problems arising from improper installation. The method follows the stages for bonding the carpet before making the seams and trimming the edges. In all cases the floorcovering should be rolled out flat in a minimum room temperature of 18° C for 24 hours to acclimatise.



Farfield Park
Manvers
Wath-upon-Dearne
Rotherham, S63 5DB.

T. +44 (0) 1709 763 839
F. +44 (0) 1709 763 813
E. sales@paragon-carpets.co.uk
W. www.paragon-carpets.co.uk