

# installation guide

LOOP PILE CARPETS

# Planning and securing loop pile carpets

The method described below is provided for guidance only, we cannot accept responsibility for workmanship and problems arising from improper installation. In all cases the floorcovering should be rolled out flat in a minimum room temperature of 18° C for 24 hours to acclimatise.



Wherever possible lay the floorcovering down the length of the room to minimise the number of joints. Avoid joints in doorways and high traffic areas. Measure the length of the room and cut the carpet to suitable lengths allowing sufficient for trimming. Ensure allowance is made for doorways, alcoves and any irregularities in the walls. Position the first length, the perimeter edge lapping up the wall.

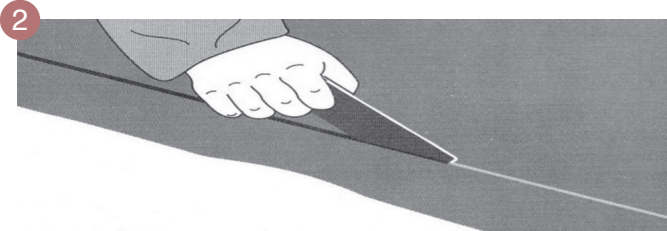

Trim the carpet down the opposite selvedge, between the rows of loops, using a carpet cutter or trimming knife to leave a clean straight edge.

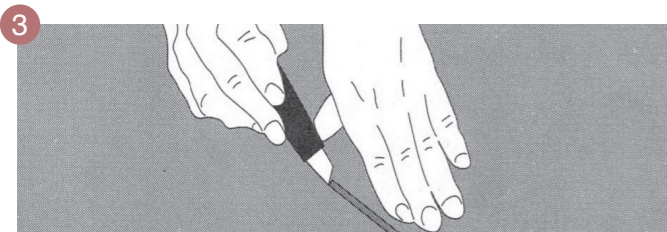

Position the second length of carpet, with the edge of the first length overlapping the second by approximately 50mm

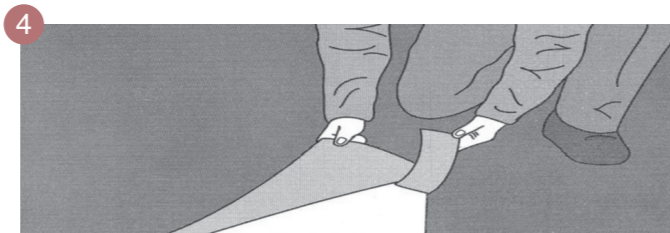

Using the trimmed edge of the first as a guide cut the edge, as above, and remove the surplus.

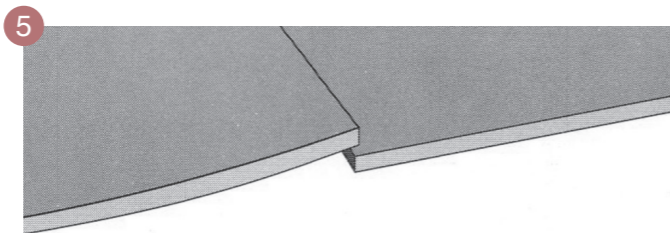

Prepare a compression seam joint by overlapping the edge of the first piece with the second piece by approximately 3mm.

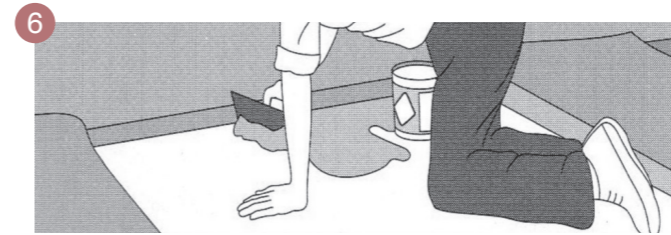

Fold back both edges by half the width of the carpet taking care not to disturb the positioning of the carpet. Apply the recommended adhesive to the subfloor using the application technique recommended by the manufacturer, then re-position the first piece of carpet and roll with a 68kg flooring roller to ensure overall contact with the adhesive.

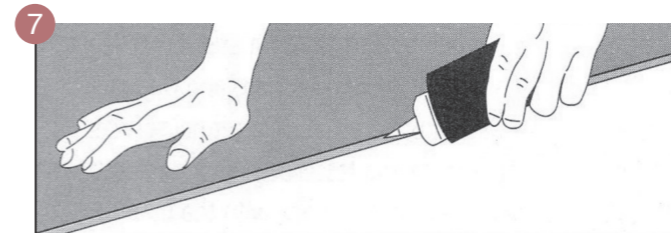

Squeeze seaming adhesive on the woven primary and secondary backings along the edge of the first piece, to prevent fraying and fibre loss. NB it is important to apply seam sealer to all cut edges.

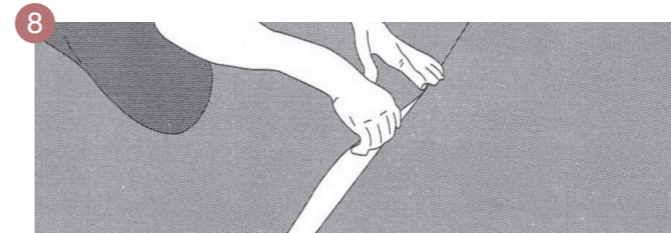

Immediately re-lay the second piece starting at the centre, press the edge into the seaming adhesive along the entire length. Any fullness of carpet should be dissipated away from the seam.

Successive lengths of carpet should be installed as previously described. Fold back the width of the first and last lengths adjacent to the perimeter and apply the adhesive to the subfloor as described, re-position the carpet and roll.

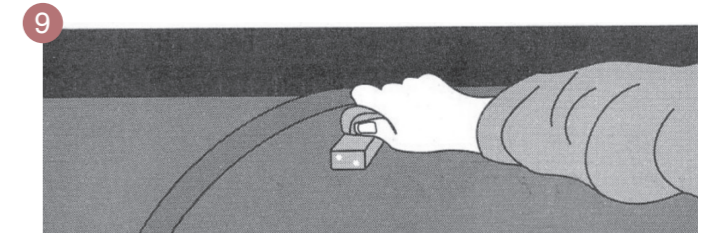

Using a sharp knife or Araseur trim the carpet to fit against the perimeter walls.

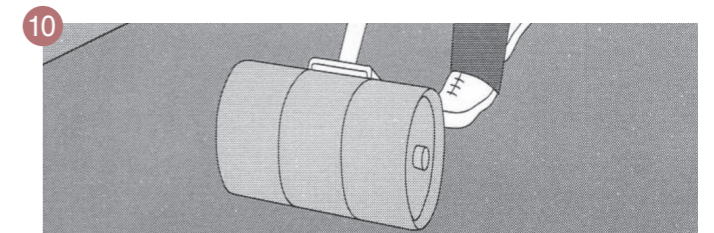

When the floor has been completely covered re-roll the area again to maintain good adhesive contact.





Farfield Park  
Manvers  
Wath-upon-Dearne  
Rotherham, S63 5DB.

T. +44 (0) 1709 763 839  
F. +44 (0) 1709 763 813  
E. [sales@paragon-carpets.co.uk](mailto:sales@paragon-carpets.co.uk)  
W. [www.paragon-carpets.co.uk](http://www.paragon-carpets.co.uk)