

# SIENNA

Elegant system for sliding, frameless wooden doors weighing up to 120kg



Sienna is an elegant sliding system that creates a minimalistic and stylish look. It is designed to accommodate wooden doors of 30 - 70mm thickness and a weight capacity of 120kg. The systems rollers are expertly engineered to effortlessly run along the brushed stainless steel tubular track and stops are positioned on the track to limit the amount of door travel.

## Product Information

Kit Order Code	No. of Doors	Min. Door Width	Max. Door Width	Door Thickness Range	Max. Door Weight
SN120T	1	700mm	2500mm	30 - 70mm	120kg

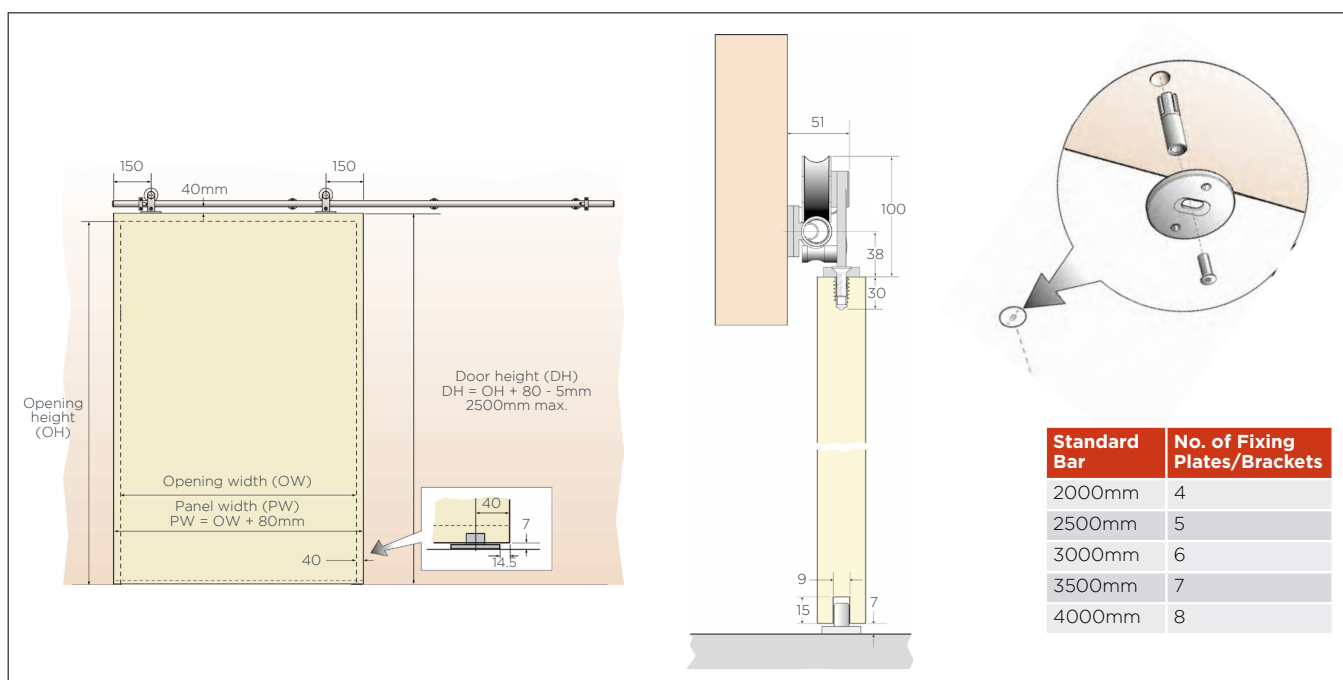

Track Specification - Must be purchased in addition to kit

Description	Short Code
25mm stainless steel tubular track available in 2000, 2500, 3000, 3500, 4000 and 6000mm length. Comes complete with correct number of brackets.	25/****T

\*\*\* Replace with door width for full short code

## Kit Contents

Component	Short Code
Hangers (x 2)	-
Door Stops (x 2)	25/UDS
Guide (x 1)	101SS
Bar End Caps (x 2)	25/EC

## Accessories

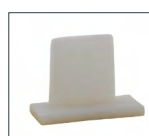

End Sleeve  
for Sienna Bar  
(25/SS)

**View our full range of door handles and flush pulls on pages 128 and 129.**