



Monolithic acoustic ceiling

OWAconsult® collection

OWA

System S 7 OWApplan | monolithic

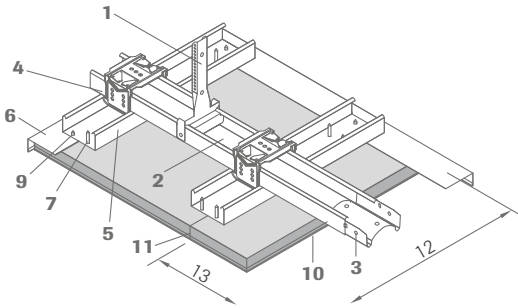

- 1 Nonius hanger no. 2001, distance ≤ 1000 mm
- 2 Support grid CD profile 60/27 no. 2003, distance ≤ 1000 mm
- 3 Coupling no. 2005
- 4 Cross connector no. 2004
- 5 Tile grid CD profile 60/27 no. 2003, distance ≤ 400 mm
- 6 Wall angle no. 51/22
- 7 Drywall screws no. 2007, distance ≤ 150 mm
- 8 Direct hanger no. 2002, distance ≤ 1000 mm, fixation: with 2 safety pins no. 76
- 9 Metal screw no. 2008
- 10 Glas fibre textile + textured acoustic plaster
- 11 Glue no. 99/24
- 12 Tile width
- 13 Tile length
- 14 Compression strip
- 15 OWApplan Plaster base tile

Section:

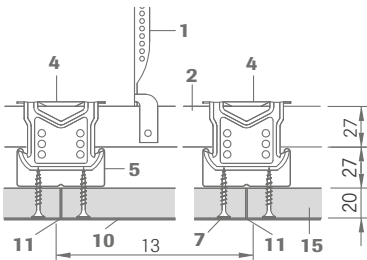

Cross-section:

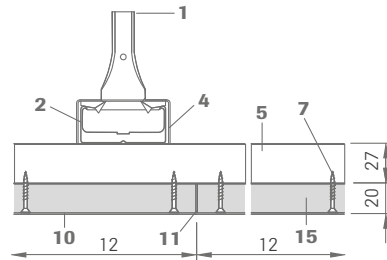

Direct fixing:

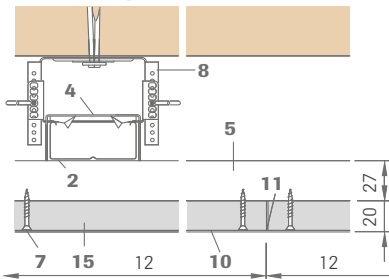

Technical data | mineral tiles

Dimensions	1200 mm x 800 mm 2400 mm x 1200 mm
Edge detail	3p OWA
Thickness	Approx. 20 mm (OWAcoustic® premium)
Reaction to fire	A2-s1,d0 in accordance with EN 13501-1
Resistance to fire	under reinforced concrete-ceiling up to F 120 (4102) up to REI 120 (EN 13501-2)
Metal suspensions	All metal components listed are zinc galvanized steel. For further details see Installation Guide OWApplan.
Installation depth	Minimum suspension depth 115 - 140 mm (from underside of soffit). Direct fixing approx. 90 mm.

Floating wall connection:

In general, connections to walls, pillars, posts and outside connectors are to be executed floatingly. Thus, a frame of L-profile no. 51/22 or no. 51/22 G-0 has to be used on the level of the tile grid. It needs to be connected to the grid using a no. 2008 metal screw. In addition, a CD-profile no. 2003 needs to be connected to the tile grid with maximum centers of 50 mm using a cross connector.

Floating perimeter/section:

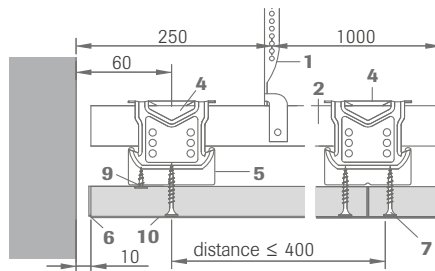

Floating perimeter/Cross-section:

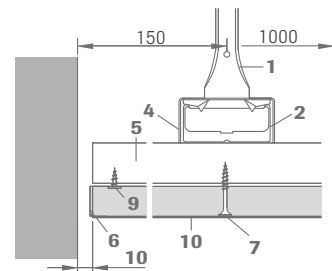

Expansion gaps:

Expansion gaps in the OWApplan ceiling are only necessary in areas where the building has existing expansion gaps. In execution it is necessary to separate the subconstruction and the mineral fibre tile accordingly. In the gap the mineral fibre tiles have to be finished with wall angle no. 51/22.

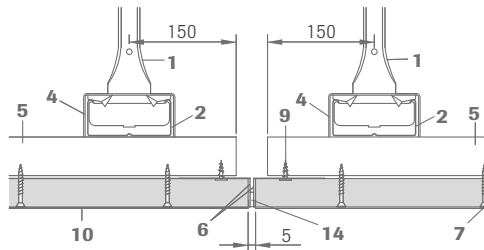

Installation - no gap perfect:

OWApplan ceilings consist of OWAcooustic® premium-tiles in the format 1200 x 800 mm or 2400 x 1200 mm. In combination with our coating system it turns into a smooth, gap free surface. The sharp edged tiles are installed with offset cross joints. They are attached to the CD-profiles of the supporting grid using no. 2007 drywall screws. All tile joints have to be glued together using a system conform glue. Then, the ceiling is covered with glass fibre mat and finally covered with our coating system. This results in a homogenous no gap surface.

Installation is trouble-free and can be executed quickly and accurately. All openings for down light fixtures, access panels, curtain rails, sprinklers, spot light and others can be incorporated during installation. When lots of built-ins are planned, as well as for smaller rooms, we suggest a tile format of 1200 x 800 mm.

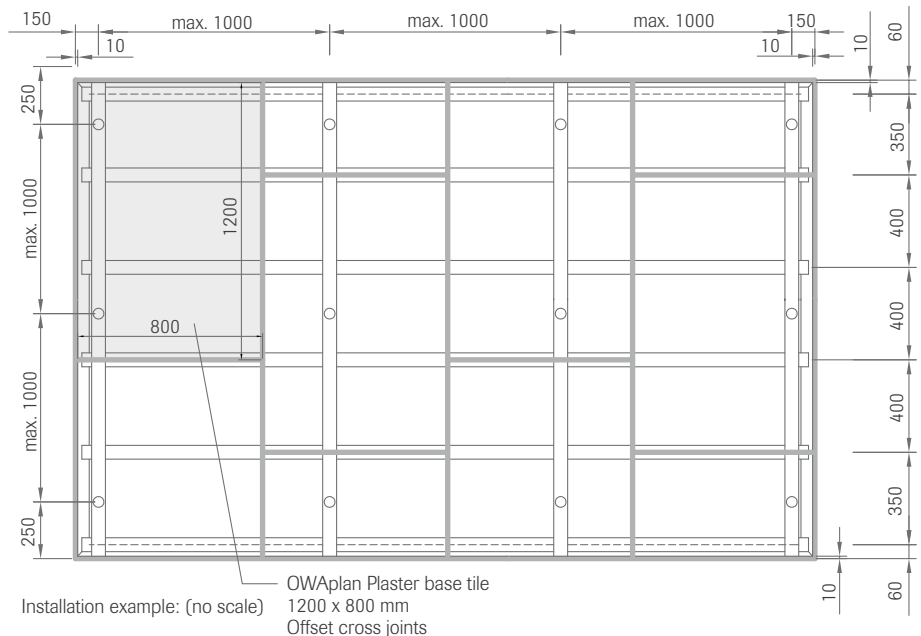

For further details see OWApplan Installation Guide.

OWAplan folding tiles:

Stepped edges, ceiling height variations and ceiling canopies can be executed using OWAplan folding tiles. The OWAplan folding tile is a 1200 x 300 x 100 mm OWAplan plaster base tile with a V-shaped cut out on the back side. Using OWA-glue no. 99/24, the flat tile can be folded into a L-shaped edge trim. The ceiling edge and vertical parts, just like the remaining ceiling, are then covered using the plaster system.

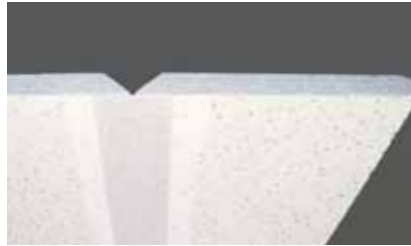

Cross-section OWAplan folding tile

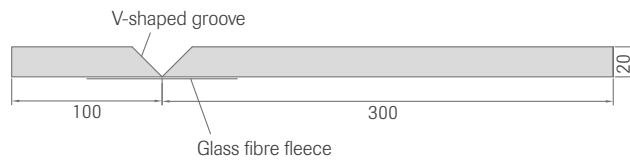

More information regarding installation of OWAplan folding tiles can be found in the OWAplan installation guide.

OWAplan comfort access flap:

For necessary accessibility to the ceiling void OWA offers OWAplan comfort access flaps in two sizes: 340 x 340 mm (no. 8031/4) and 540 x 540 mm (no. 8031/5). The lid of the flap consists of an OWAplan plaster base tile. After installation, the lid needs to be closed and covered with the same plaster system as the surrounding ceiling. The access flap is barely visible through a narrow gap between the lid and the frame. The

access flap can be opened and closed by applying light pressure on the lid. Upon request additional formats are possible.

For more information regarding installation of OWAplan comfort access flap please consult the OWAplan installation guide.



Cross-section through inspection flap no. 8031/5:

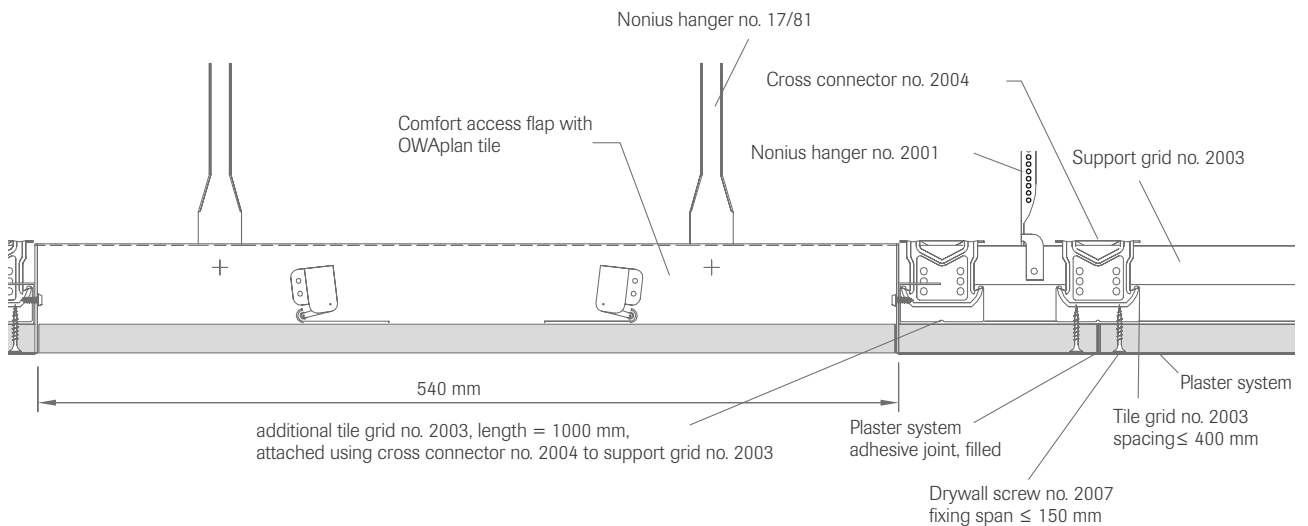

System S 7 OWAplan | monolithic

Material requirements per m² (approximations)

Grid parts

No.	Description	1200 x 800 mm 2400 x 1200 mm
16/ ...	Nonius hanger top, grid spacing 1000 mm	1 pce.
2001	Nonius hanger lower part for CD profile 60 x 27	1 pce.
76	Safety pin	2 pcs.
2002	Direct hanger (only for direct installation)	2.5 pcs.
2003	CD profile 60 x 27 mm, support grid spacing 1000 mm	1 m
2003	CD profile 60 x 27 mm, Tile grid spacing 400 mm	2.5 m
2004	Cross connector	2.5 pcs.
2005	Coupling	0.9 pce.
51/22	Wall angle	dependent on room size and shape
2007	Drywall screws, 150 mm – for tile size 1200 x 800 mm	27 pcs.
2007	Drywall screws, 150 mm – for tile size 2400 x 1200 mm	23 pcs.
2008	Metal screws for no. 51/22	6 pcs/m
99/24	Tile adhesive	0.15 pce

Accessories

No.	Description	1200 x 800 mm 2400 x 1200 mm
8069/6	Mounting frame for downlights, consisting of two pieces, length 340 mm	depending on the project
8031/4	Comfort access flap 340 x 340 mm	depending on the project
8031/5	Comfort access flap 540 x 540 mm	depending on the project
17/81	Nonius lower part for access panel in connection with nonius upper part no. 16/ ...	depending on the project
51/22 G-O	Wall angle, curved to the inside or outside	depending on the project
2012	U-hanger for direct and slanted mounting with no. 2003, length 170 mm	1 pce.
2013	Nonius hanger, lower part for slanted mounting compatible with no. 16/ ..., length 125 mm	1 pce.

OWAplan tiles

No.	Description	1200 x 800 mm 2400 x 1200 mm
	OWAplan tile 1200 x 800 x 20 mm, embossed, needle-punched, primed	1.0 m ²
	OWAplan tile 1200 x 800 x 20 mm, non-embossed, non-needle-punched, primed	depending on the project
	OWAplan tile 2400 x 1200 x 20 mm, embossed, needle-punched, primed	1.0 m ²
	OWAplan tile 2400 x 1200 x 20 mm, non-embossed, non-needle-punched, primed	depending on the project
	Folding tiles for ceiling grid systems, 1200 x 300 x 100 x 20 mm, embossed, needle-punched, primed	depending on the project

Kraft acoustic plaster system:

No.	Description	Packaging unit	Required per m ²
2011	Fibre glass glue for plaster Allegro M and Allegro S, sufficient for 70 – 90 m ²	Bucket 18 kg	0.26 kg
2010	Acoustic fleece G3/A2, white, for Allegro M and Allegro S, sufficient for 60 m ²	Roll 60 m	1 m
2009	Plaster Allegro M, white, dry product, sufficient for 22 m ²	Sack 25 kg	1.14 kg
2009/1	Plaster Allegro S, white, ready mixed, sufficient for 17 m ²	Bucket 25 kg	1.47 kg
	Acoustic fleece G3/A2 for Allegro M and Allegro S, Plaster Allegro M, and plaster Allegro S are available in all colors similar to RAL tones in accordance with the customers wishes	Roll 60 m	1 m
	Plaster Allegro M, colour similar to RAL according to customer's specification, dry product	Sack 25 kg	1.14 kg
	Plaster Allegro S, colour similar to RAL according to customer's specification, pre-mixed	Bucket 25 kg	1.47 kg

Plaster coating

Kraft Allegro M or Allegro S
Colour: white, others on request

Sound absorption

for suspension height 200 mm
Average value: $\alpha_w = 0.60$ | NRC = 0.65



Plaster coating

Fleece for plaster coating

Plaster base tile

Plaster system manufacturer:

Kraft Akustiksysteme
Sonnenhof 4
35440 Linden, Germany
tel +49 64 03.94 06 08

System description:

OWAconstruct® premium System S 7 OWAplan

Quality statement:

OWAacoustic mineral panels are free from harmful materials such as asbestos and formaldehyde. A statement from the German institute for Building Technology is available. The mineral wool used in these panels is biodegradable. The criteria of the zero-ranking as a carcinogenic material in the chemical prohibition ordinance (§ 1 appendix) section 23 bio-persistent fibres are complied with and therefore carries the "RAL-Seal of mineral wool" guarantees.

Mineral tiles according to EN 13964 and DIN 18177:

Air Permeability	Class PM 1
Formaldehyde	FH Class 1
TVOC	Class 1

Installation should be carried out in accordance with the information contained in brochure no. 1021 and OWA-Installation Guide 801. All components are CE labelled. **v**

Construction components:

OWAconstruct no. 2001 Nonius hanger lower part
OWAconstruct no. 16/... Nonius hanger upper part
OWAconstruct no. 51/22 wall angle
OWAconstruct no. 2003 CD profile, supporting grid, 60 x 27 x 0.6 mm
OWAconstruct no. 2004 cross connector
OWAconstruct no. 2005 coupling
OWAconstruct no. 2007 and no. 2008 – drywall and metal screws
OWAacoustic tile 2400 mm x 1200 mm or 1200 mm x 800 mm
OWAconstruct no. 99/24 tile adhesive
Additional parts are necessary to complete installation.

Product Warranties

The information provided in this leaflet is based on the standards and data available at the time of publication. Any performance, warranties or guarantees provided, expressed or implied, are subject to the exclusive use of OWA components and the installation of those components in accordance with our recommendations. Failure to adhere to these conditions will result in the invalidation of any performance claims, warranties or guarantees and rejection of any liability. OWA reserves the right to make any technical improvements to the products, systems or services without prior notice. **All goods and services are supplied in accordance with our current Terms and Conditions of Sale.** Errors excepted!



OWA

Odenwald Faserplattenwerk GmbH

Dr.-F.-A.-Freundt-Straße 3 | 63916 Amorbach
tel +49 93 73.2 01-0 | info@owa.de
www.owa-ceilings.com