

**KEY:**

- ① NORDAN HIGH PERFORMANCE NTECH 1.2 INWARD OPENING 3 HANDED TILT & TURN WINDOW ALUMINIUM CLAD
- ② SEALED GLAZING UNIT
- ③ GLAZING SYSTEM - THE SYSTEM IS SELF VENTILATING AND SELF DRAINING, THEREFORE NO MOISTURE IS IN CONTACT WITH THE WOOD. TO IMPROVE SECURITY, THE SEALED UNIT IS GLUED INTO THE SASH
- ④ VACUUM IMPREGNATED TIMBER - NORDAN PRODUCTS USE TIMBER SOURCED FROM SUSTAINABLE FORESTS, WITH PEFC FULL CHAIN OF CUSTODY. VACUUM IMPREGNATION PROTECTS THE TIMBER FROM ROT, FUNGAL AND INSECT ATTACK.
- ⑤ ALUMINIUM GLAZING BEADS - ALUMINIUM GLAZING BEADS REDUCE THE LEVEL OF MAINTENANCE AND CREATE A MORE SUBSTANTIAL DESIGN BY ALLOWING FULL VENTILATION AND DRAINAGE. THE ALUMINIUM IS SECURELY CLIPPED INTO PLACE THUS PREVENTING AND DAMAGE TO THE WINDOW
- ⑥ DECOMPRESSION ZONE - THE SPACE BETWEEN THE EXTERNAL SURFACE AND THE WEATHER SEAL HAS BEEN DESIGNED AS A DECOMPRESSION ZONE. THIS NEUTRALISES THE PRESSURE DIFFERENTIALS, AND IS SELF DRAINING AND SELF VENTILATING
- ⑦ GASKET - THE PROFILE OF THE WINDOW SECTIONS AND DESIGN FOR DRAINAGE DEPENDS ON THE WEATHER SEAL BEING ABLE TO PROVIDE THE REQUIRED RESISTANCE OF THE GAP BETWEEN SASH AND FRAME TO WEATHER
- ⑧ OPTIONAL ALUMINIUM CLADDING - THE OPTIONAL ALUMINIUM RAIN SCREEN CLADDING GREATLY IMPROVES THE LIFE-SPAN OF THE PRODUCT AND VASTLY REDUCES MAINTENANCE COSTS. IT CAN ALSO BE POWDER COATED TO ANY RAL COLOUR OF YOUR CHOICE

- ⑨ INSULATED WINDOW REVEAL
- ⑩ AIR TIGHTNESS TAPE AND SEALANT APPLIED TO BACK OF FRAME & RETURNED ONTO TIMBER KIT
- ⑪ COMPRESSIBLE FILL & SHIMS AS REQUIRED
- ⑫ SEALANT AT WINDOW FRAME
- ⑬ TIMBER FRAME KIT IN ACCORDANCE WITH ACCREDITED CONSTRUCTION DETAILS (SCOTLAND) 2010
- ⑭ 100mm THICK DENSE CONCRETE BLOCKWORK OUTER LEAF WITH ROUGHCAST FINISH
- ⑮ 50mm CAVITY
- ⑯ TIMBER WINDOW CILL
- ⑰ CONCRETE CILL WITH DPC BURNT ON
- ⑱ STAINLESS STEEL FIXING STRAP, BENT ACROSS & FIXED TO TIMBER KIT - ALL WITH SUITABLE FIXINGS PER STRUCTURAL ENGINEER'S RECOMMENDATIONS
- ⑲ OUTER BREATHER PAPER LAPPED WITH INNER VAPOUR BARRIER AT SILL INGOE. SS FIXING STRAPS (18) FITTED (UNLESS FIXED VIA FIRESTOPS) & THEN AIR TIGHTNESS TAPE (10) FITTED
- ⑳ NORDAN RAS 419 EXTENSION CILL (OTHER CILLS AVAILABLE - CONTACT NORDAN FOR FURTHER DETAILS)
- ㉑ GROOVE FOR EXTENSION CILL - A VARIETY OF ALUMINIUM EXTENSION CILLS ARE AVAILABLE FROM NORDAN TO MEET YOUR PARTICULAR DESIGN REQUIREMENTS

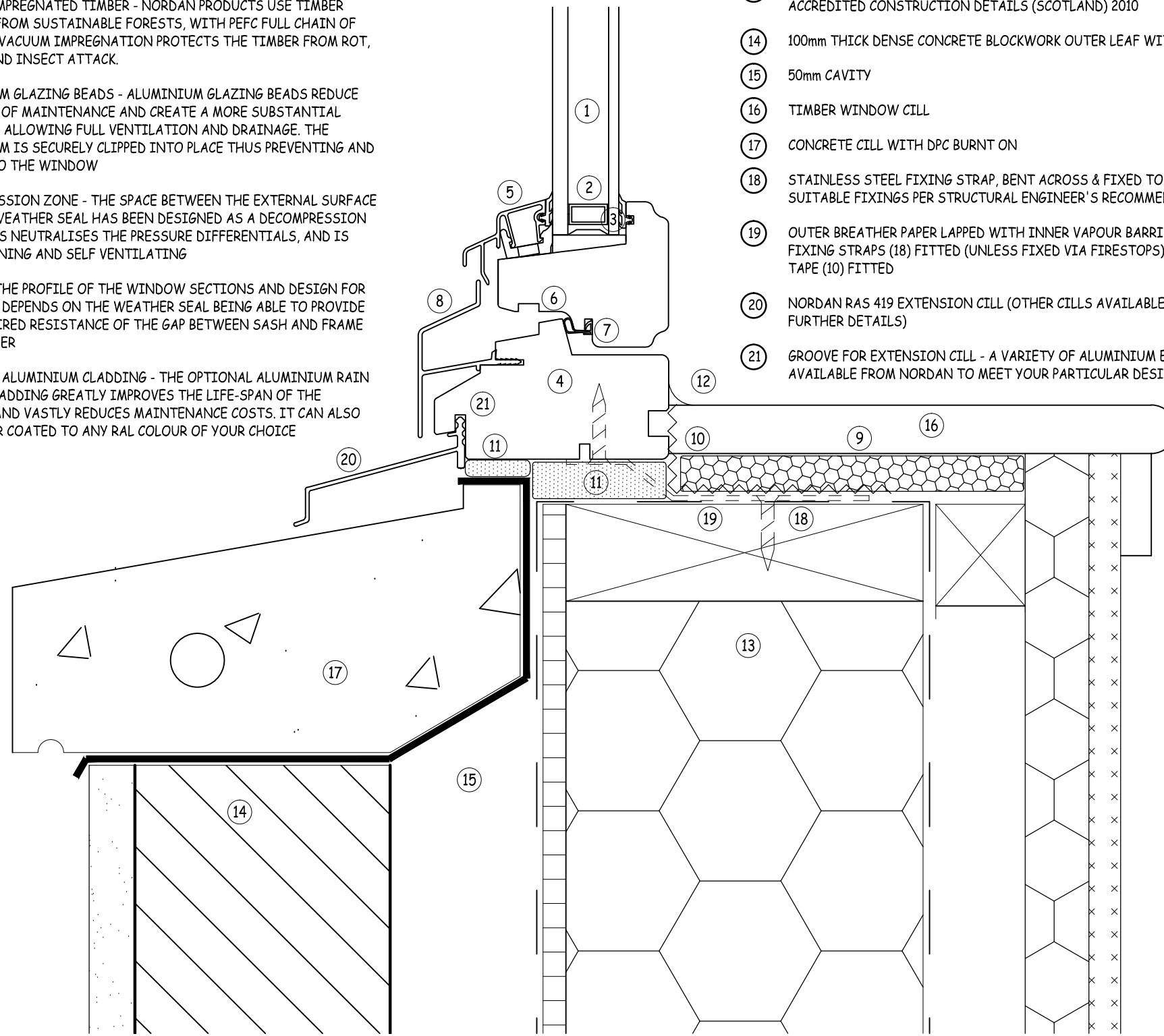

**Cill Detail**

Scale 1:2

**Timber Frame Kit with outer Blockwork cladding**

**DESIGN ADVICE**

DRAWING TO BE READ IN CONJUNCTION WITH NORDAN MEASURING & INSTALLATION LEAFLET. AVAILABLE AT [www.nordan.co.uk/uk/downloads](http://www.nordan.co.uk/uk/downloads)

ALL DETAILS ARE SUBJECT TO CHANGE BY PROJECT INSURER / CERTIFIERS LATEST REQUIREMENTS i.e NHBC

ALL DETAILS ARE SUBJECT TO CHANGE BY TIMBER FRAME KIT MANUFACTURERS REQUIREMENTS

ALL DETAILS MUST BE READ IN CONJUNCTION WITH THE LATEST ACCREDITED CONSTRUCTION DETAILS (SCOTLAND) & ALTERED ACCORDINGLY TO ENSURE AIR TIGHTNESS & THERMAL CONTINUITY

AIR TIGHTNESS GENERAL NOTES

- INSTALL WINDOW TO OVERLAP WITH OUTER LEAF OF WALL FINISH
- INSTALL AIR TIGHTNESS SEAL BETWEEN THE INSIDE FACE OF THE WINDOW AND THE STRUCTURAL FINISH OF THE WINDOW OPENING

THERMAL CONTINUITY GENERAL NOTES

- CHECK THAT THERE IS NO DEBRIS IN THE CAVITY
- INSTALL CAVITY BARRIER AROUND OPENING

TITLE:	WINDOW CILL DETAIL
DATE:	MAY 2011
SCALE:	1:2 @ A3
DWG NO:	NDUK ID 002



© NorDan AS



[www.nordan.co.uk](http://www.nordan.co.uk)