

KEY:

- ① NORDAN HIGH PERFORMANCE INWARD OPENING DOOR ALUMINIUM CLAD
- ② SEALED GLAZING UNIT
- ③ GLAZING SYSTEM - THE SYSTEM IS SELF VENTILATING AND SELF DRAINING, THEREFORE NO MOISTURE IS IN CONTACT WITH THE WOOD. TO IMPROVE SECURITY, THE SEALED UNIT IS GLUED INTO THE SASH
- ④ VACUUM IMPREGNATED TIMBER - NORDAN PRODUCTS USE TIMBER SOURCED FROM SUSTAINABLE FORESTS, WITH PEFC FULL CHAIN OF CUSTODY. VACUUM IMPREGNATION PROTECTS THE TIMBER FROM ROT, FUNGAL AND INSECT ATTACK.
- ⑤ ALUMINIUM GLAZING BEADS - ALUMINIUM GLAZING BEADS REDUCE THE LEVEL OF MAINTENANCE AND CREATE A MORE SUBSTANTIAL DESIGN BY ALLOWING FULL VENTILATION AND DRAINAGE. THE ALUMINIUM IS SECURELY CLIPPED INTO PLACE THUS PREVENTING AND DAMAGE TO THE FRAME
- ⑥ DECOMPRESSION ZONE - THE SPACE BETWEEN THE EXTERNAL SURFACE AND THE WEATHER SEAL HAS BEEN DESIGNED AS A DECOMPRESSION ZONE. THIS NEUTRALISES THE PRESSURE DIFFERENTIALS, AND IS SELF DRAINING AND SELF VENTILATING
- ⑦ GASKET - THE PROFILE OF THE DOOR SECTIONS AND DESIGN FOR DRAINAGE DEPENDS ON THE WEATHER SEAL BEING ABLE TO PROVIDE THE REQUIRED RESISTANCE OF THE GAP BETWEEN SASH AND FRAME TO WEATHER
- ⑧ OPTIONAL ALUMINIUM CLADDING - THE OPTIONAL ALUMINIUM RAIN SCREEN CLADDING GREATLY IMPROVES THE LIFE-SPAN OF THE PRODUCT AND VASTLY REDUCES MAINTENANCE COSTS. IT CAN ALSO BE POWDER COATED TO ANY RAL COLOUR OF YOUR CHOICE

- ⑩ AIR TIGHTNESS TAPE AND SEALANT APPLIED TO BACK OF DOOR THRESHOLD & RETURNED ONTO FLOOR
- ⑪ COMPRESSIBLE FILL & SHIMS AS REQUIRED
- ⑫ SEALANT AT DOOR FRAME THRESHOLD
- ⑬ INSULATED CONCRETE FLOOR IN ACCORDANCE WITH ACCREDITED CONSTRUCTION DETAILS (SCOTLAND) 2010
- ⑭ 100mm THICK DENSE CONCRETE BLOCKWORK OUTER LEAF
- ⑮ 50mm CAVITY (COULD BE PACKED WITH MORTAR)
- ⑰ CONCRETE DOOR SOLE ENCASED IN DPC MEMBRANE (BURNT ON)
- ⑱ FLOOR DAMP PROOF MEMBRANE RETURNED UP EDGE OF FLOOR AT CAVITY & RETURNED BACK INTO BUILDING BELOW DOOR SILL
- ⑳ PERIMETER INSULATION TO EDGE OF FLOOR TO AVOID ANY COLD BRIDGING

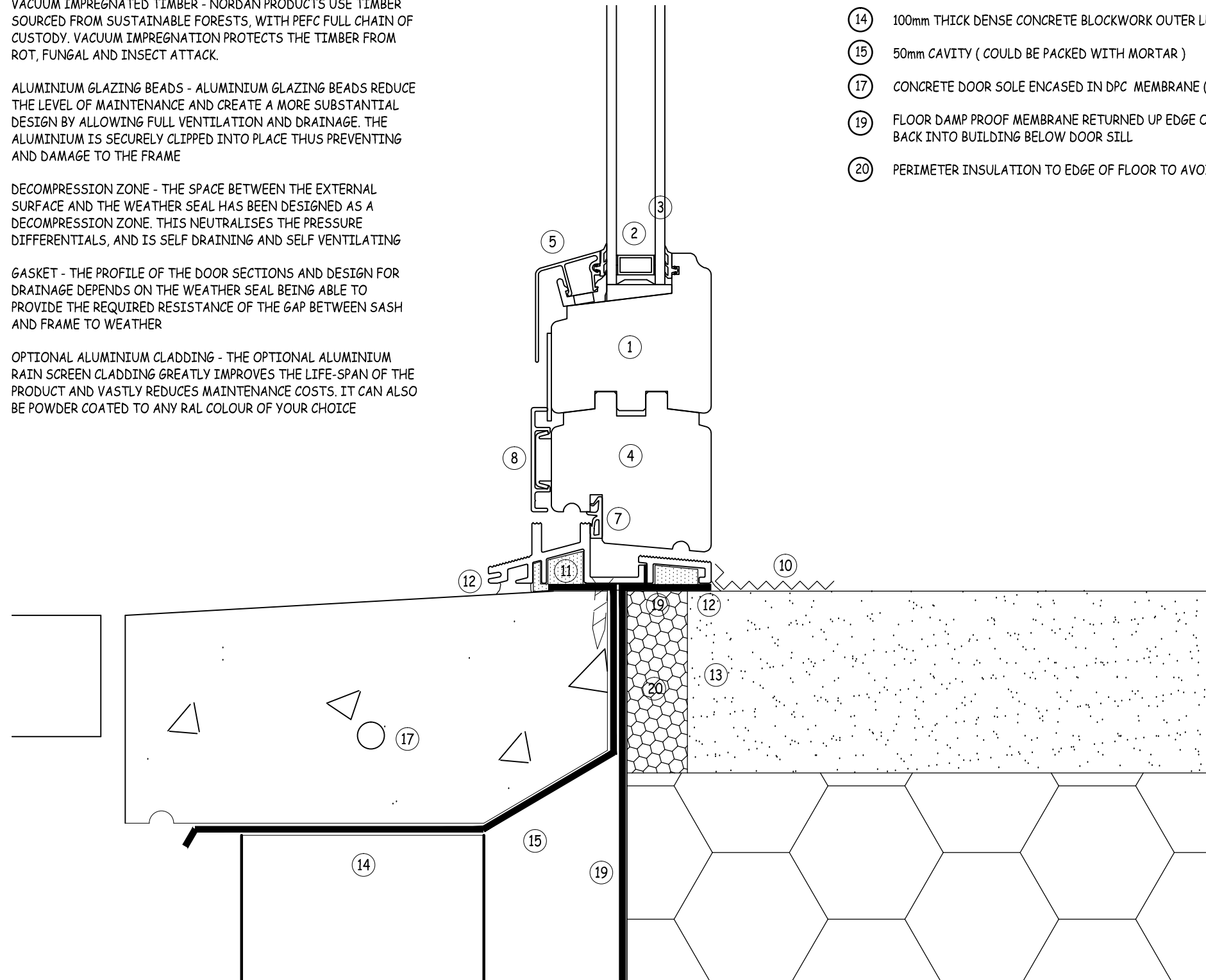

Door Sole Detail

Scale 1:2

ALL CONSTRUCTIONS

DESIGN ADVICE

DRAWING TO BE READ IN CONJUNCTION WITH NORDAN MEASURING & INSTALLATION LEAFLET. AVAILABLE AT www.nordan.co.uk/uk/downloads

ALL DETAILS ARE SUBJECT TO CHANGE BY PROJECT INSURER / CERTIFIERS LATEST REQUIREMENTS i.e NHBC

ALL DETAILS ARE SUBJECT TO CHANGE BY TIMBER FRAME KIT MANUFACTURERS REQUIREMENTS

ALL DETAILS MUST BE READ IN CONJUNCTION WITH THE LATEST ACCREDITED CONSTRUCTION DETAILS (SCOTLAND) & ALTERED ACCORDINGLY TO ENSURE AIR TIGHTNESS & THERMAL CONTINUITY

AIR TIGHTNESS GENERAL NOTES

- INSTALL DOOR TO OVERLAP WITH OUTER LEAF OF WALL FINISH
- INSTALL AIR TIGHTNESS SEAL BETWEEN THE INSIDE FACE OF THE DOOR AND THE STRUCTURAL FINISH OF THE DOOR OPENING

THERMAL CONTINUITY GENERAL NOTES

- CHECK THAT THERE IS NO DEBRIS IN THE CAVITY
- INSTALL CAVITY BARRIER AROUND OPENING

TITLE:	INWARD DOOR SOLE DETAIL
DATE:	MAY 2011
SCALE:	1:2 @ A3
DWG NO:	NDUK ID 030



© 2010 NorDan AS



www.nordan.co.uk