

FRANK | Product List

valid as of 1 April 2014

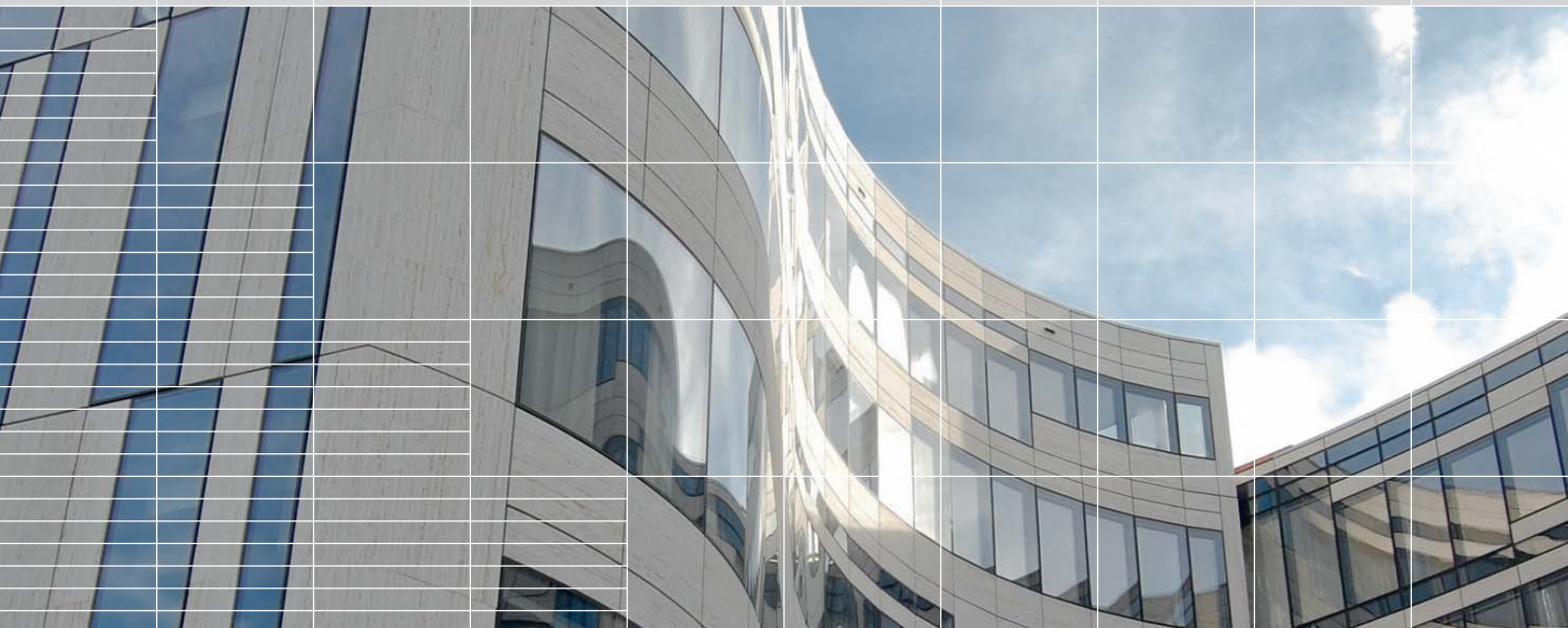

Coupler

threaded steel coupler systems





Coupler

The rebar connection system with the 100% load transmission – suitable for both static and dynamic load.

- Coupler threaded coupler system is a useful addition to the rebar connection system with diameters from 12 mm.
- Holds a general approval issued by the DIBt (German Institute for Structural Engineering) of Berlin, Germany, Z-1.5-100
- Mild steel B500B according to DIN 488
- Secure protection of the CA bars by thread protection caps
- The use of both the single box and coupler box ensures precise location of the reinforcement bars, as well as outstanding corrosion protection and additional thrust interlocking
- Simply screw the CE-bars into the box, finally tightening it to the specified torque using a torque wrench
- Leverage of the static benefit of an “indented joint” by observing the geometry according to DIN EN 1992-1-1 with NA(D) (DIN 1045-1)

CA-bar + socket incl. thread protection cap

1st concrete pour

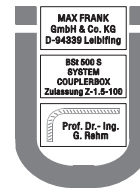
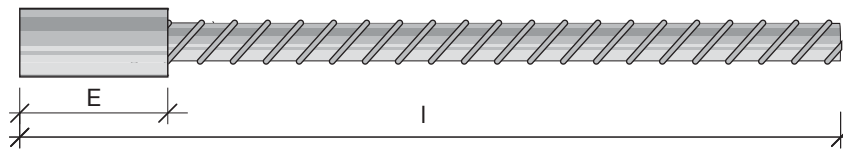

CE-additional bar

2nd concrete pour

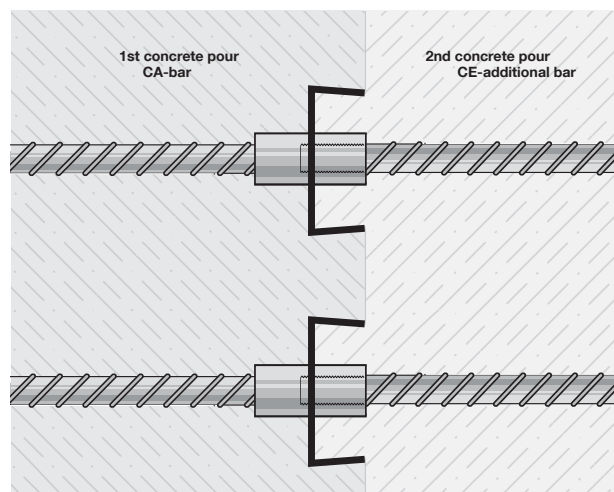
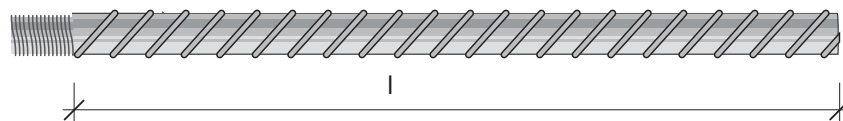

CA bar + socket

incl. thread protection cap for the first concrete pour

Art. no.	Diameter mm	Length mm	Sleeve E mm	Weight kg/pce.
CCA120400	12	400	43	0.44
CCA120570	12	570	43	0.56
CCA120800	12	800	43	0.77
CCA121500	12	1500	43	1.39
CCA140660	14	660	47	0.87
CCA140930	14	930	47	1.19
CCA141500	14	1500	47	1.88
CCA161020	16	1020	47	1.81
CCA161440	16	1440	47	2.48
CCA161800	16	1800	47	3.05
CCA201280	20	1280	55	3.36
CCA201800	20	1800	55	4.64
CCA202100	20	2100	55	5.38
CCA251600	25	1600	64	6.53
CCA252260	25	2260	64	9.07
CCA252600	25	2600	64	10.38
CCA281790	28	1790	69	9.15
CCA282530	28	2530	69	12.73
CCA283000	28	3000	69	15.00
CCA32SONL	32	according to data given	80	-

CE-additional bar

for the second concrete pour

Art. no.	Diameter mm	Length mm	Weight kg/pce.
CCE120400	12	400	0.36
CCE120570	12	570	0.51
CCE120800	12	800	0.71
CCE121500	12	1500	1.33
CCE140660	14	660	0.80
CCE140930	14	930	1.13
CCE141500	14	1500	1.81
CCE161020	16	1020	1.62
CCE161440	16	1440	2.28
CCE161800	16	1800	2.85
CCE201280	20	1280	3.16
CCE201800	20	1800	4.45
CCE202100	20	2100	5.19
CCE251600	25	1600	6.16
CCE252260	25	2260	8.70
CCE252600	25	2600	10.01
CCE281790	28	1790	8.65
CCE282530	28	2530	12.22
CCE283000	28	3000	14.49
CCE32SONL	32	according to data given	-

CAE socket and thread bar

for the first and second concrete pour

Art. no.	Diameter mm	Sleeve E mm	Tightening moment Nm	Weight kg/pce.
CCAE120400	12	43	60	0.80
CCAE120570	12	43	60	1.07
CCAE120800	12	43	60	1.48
CCAE121500	12	43	60	2.72
CCAE140660	14	47	100	1.67
CCAE140930	14	47	100	2.32
CCAE141500	14	47	100	3.70
CCAE161020	16	47	100	3.43
CCAE161440	16	47	100	4.76
CCAE161800	16	47	100	5.90
CCAE201280	20	55	200	6.52
CCAE201800	20	55	200	9.09
CCAE202100	20	55	200	10.57
CCAE251600	25	64	250	12.69
CCAE252260	25	64	250	17.77
CCAE252600	25	64	250	20.39
CCAE281790	28	69	280	17.80
CCAE282530	28	69	280	24.95
CCAE283000	28	69	280	29.49

Fixing aids

Coupler Single box (with cover)

	Designation	Art. no.	Type	Diameter mm	Weight kg/pce.
	Fix single Coupler box to the formwork with two nails; insert CA rod into the box as far as it will go and attach it to the local reinforcement.	CEBOX12*	Single box \varnothing 12 + \varnothing 14	22	0.12
		CEBOX16*	Single box \varnothing 16 + \varnothing 20	33	0.12
		CEBOX25	Single box \varnothing 25	40	0.12
		CEBOX28	Single box \varnothing 28	45	0.12

* Coupler box for bar \varnothing 14 corresponds to that of \varnothing 12, and for bar \varnothing 20 to that of \varnothing 16

Fixing aids

Coupler box (with cover)

	Designation	Art. no.	Type	Possible connection per 1.2 m element	Distance s cm	Weight kg/pce.
	The single box can be easily extended for longer applications. Bar spacing "s" can be supplied in any dimension. Coupler box with cover and 2 end caps. Other bar spacings "s" can be supplied on request.	CCB1210120*	Couplerbox \varnothing 12	12	10	0.90
		CCB1610120*	Couplerbox \varnothing 16	12	10	0.90
		CCB2510120	Couplerbox \varnothing 25	12	10	0.90
		CCB2810120	Couplerbox \varnothing 28	12	10	0.90
		CCB1215120*	Couplerbox \varnothing 12	8	15	0.90
		CCB1615120*	Couplerbox \varnothing 16	8	15	0.90
		CCB2515120	Couplerbox \varnothing 25	8	15	0.90
		CCB2815120	Couplerbox \varnothing 28	8	15	0.90
		CCB1220120*	Couplerbox \varnothing 12	6	20	0.90
		CCB1620120*	Couplerbox \varnothing 16	6	20	0.90
		CCB2520120	Couplerbox \varnothing 25	6	20	0.90
		CCB2820120	Couplerbox \varnothing 28	6	20	0.90

* Coupler box for bar \varnothing 14 corresponds to that of \varnothing 12, and for bar \varnothing 20 to that of \varnothing 16

Coupler

Torque wrench for 12 - 28 mm

	Art. no.	Weight kg/pce.
	CLDREH	5.00

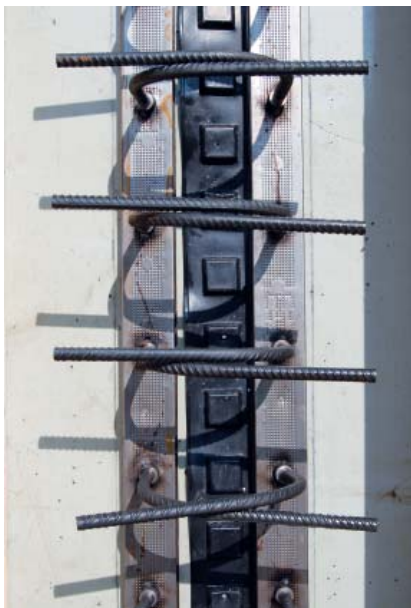

Pre-assembled Coupler reinforcement elements in the 1st CP with additional teething by means of joint profile former



Reinforcement layer in the 1st CP: attachment of the WCA coupling bars to the local reinforcement



Concreting result: position of the Coupler sleeves within the indented joint

Special Coupler types are manufactured to your requirements. Please get in contact with our technical advisory service.

Type CA

Article number CCA12*SONL

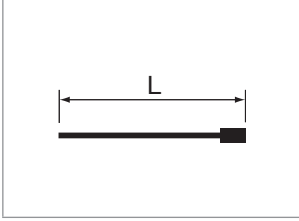

Type CE

Article number CCE12*SONL

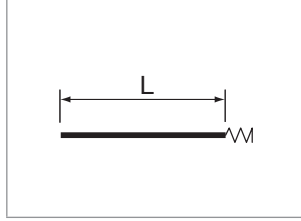

Type ECA

Article number CECA12*

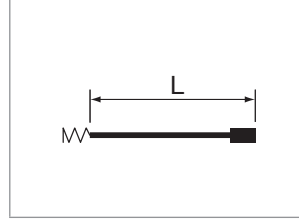

Type DCA

Article number CSDCA

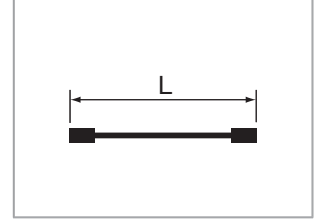

Type DCE

Article number CSDCE

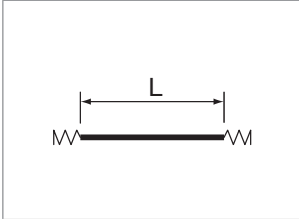

Type WCA

Article number CSWCA

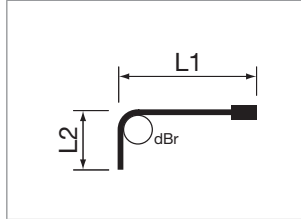

Type WCASB

Article number CSWCASB

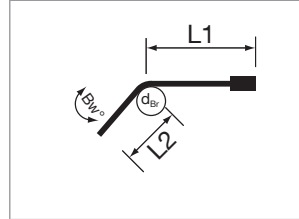

Type DCAW

Article number CSDCAW

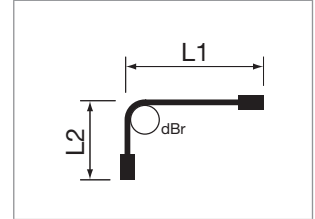

Type WCE

Article number CSWCE

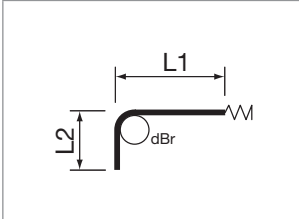

Type DWCA

Article number CSDWCA

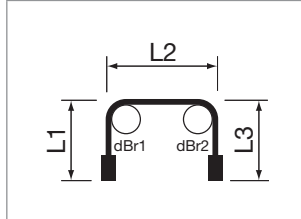

Type WCAG

Article number CSWCAG

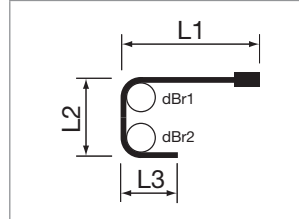

Type WWCA

Article number CSWWCA

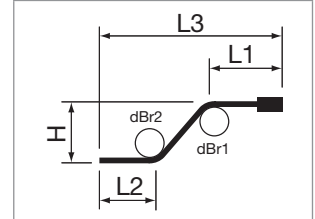

Type WWECA

Article number CSWWECA

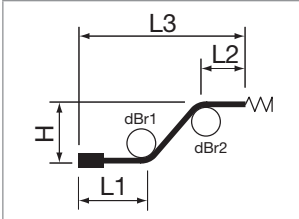

Type WWCE

Article number CSWWCE

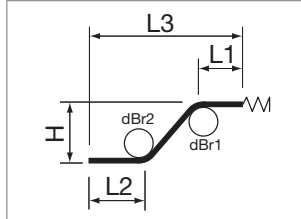

Type CALG

Article number CSCALG

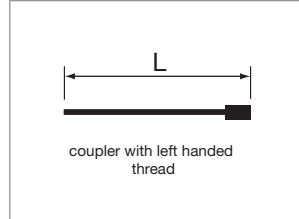

Type WCALG

Article number CSWCALG

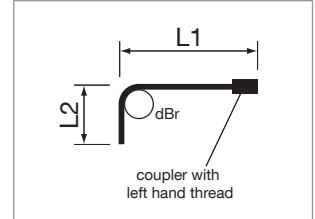

Type CA-APG

Article number CSCAAPG

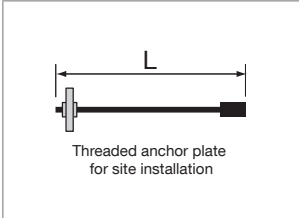

Type CA-APS

Article number CSCAAPS

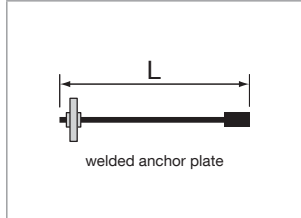

Type CE-APG

Article number CSCEAPG

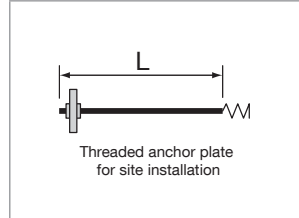

Type CE-APS

Article number CSCEAPS

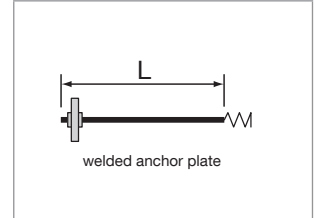

* varying according to bar diameter 12, 14, ...

- Special types are cost-efficiently manufactured to your requirements. Please enquire for delivery time.
- Certificate of suitability (SLV Munich) for welding of concrete reinforcing steel by flash welding machine, as well as further certificates of suitability (SLV Munich) for concrete steel connections according to DIN EN ISO 17660-1 present.

Please enquire for prices of the special types.

The production of special accessories is carried out using the same quality criteria as for the standard ranges. However, our certification does not cover the production of special accessories. Structural analysis verification must be carried out in each specific application.

Adapter connection

The adapter should be used when rebars with bent legs are required or are unable to be screwed in.

System description



Socket with right-hand/left-hand thread (designation "LG" for left-hand thread)



Adapter for connecting left-hand threaded socket to standard right-hand threaded socket



Standard right-hand threaded socket

Application example

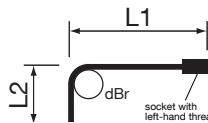

For adapter connection in one concrete pour, a socket with right-hand/left-hand thread must be used.



Screwing the adapter brings the rebars together up to the limit stop. A locknut is used for fixing the assembly.

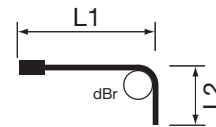

A standard right-hand threaded socket is fixed to the second rebar.

Product combinations with Coupler threaded steel coupler system

Coupler meets the highest requirements regarding force transmission for both static and dynamic loads.

To meet the highest construction site standards and to provide for installation friendly handling, Couplers are pre-installed into prefabricated elements in our factory.

The option to combine our products enables structural engineers to reliably and securely achieve their static requirements regarding construction joints (joint category and reinforcement) during installation on site.



The joint elements are pre-fabricated ex factory in an installation friendly manner.



Potential on-site errors, such as incorrect rebar diameters and bar placement or non-observance of the design cover are minimised this way.



Exact reinforcement layer in the 2nd concreting phase due to simple installation of the Coupler connecting rods in the indented joint.

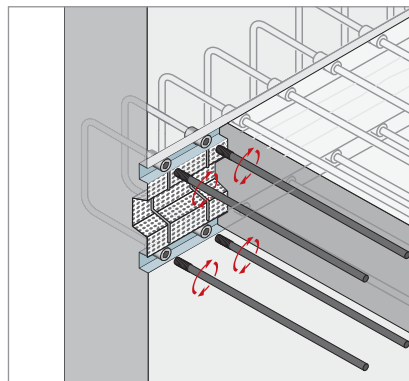
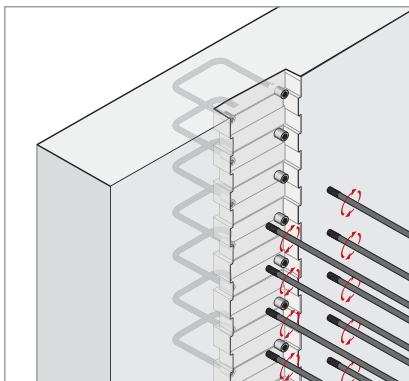

Coupler rebar connection system is used to finish prefabricated joint formwork elements for highly stressed components with large steel diameters 12 to 28 mm ex factory. On the basis of the variation options with the different joint formwork elements such as St^abox[®] S, St^abox[®] T, Strema^aform[®], Strema^aboard or joint formwork profile, the elements can be designed both in transverse and in thrust direction as indented joint according to DIN EN 1992-1-1 with NA(D).

Product combinations with Coupler offer many planning and solution options according to construction site standards, please consult our application technology department!



Max Frank GmbH & Co. KG

Technologies for the construction industry

Mitterweg 1
94339 Leiblfing
Germany

Phone +49 9427 189-117
Fax +49 9427 1588

info@maxfrank.com
www.maxfrank.com