

# Maxima

Clay interlocking double roman

# Maxima

## Clay interlocking double roman



Maxima is a clay interlocking double roman tile suitable for roof pitches down to 17.5°. It is available in a Natural Red colour and has an open gauge – making it easy to lay.

### Fittings

A clay hand verge tile is designed to provide a neat finish at the left hand edge of the roof. Concrete segmental ridge tiles and third round hip tiles are available in a Mosborough Red colour. Concrete segmental ridge and third round hip tiles can be used in conjunction with Marley Eternit Universal RidgeFast and HipFast systems for ventilation purposes and to provide a completely dry fixed solution.

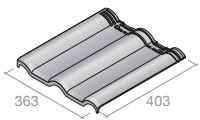

Maxima clay left hand verge tile (code 82678)

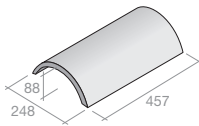

Segmental ridge tile (code 206)

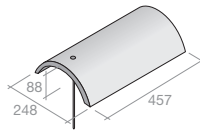

Segmental security ridge tile (code 229)

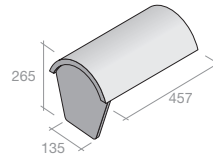

Segmental stop end ridge tile (code 191)

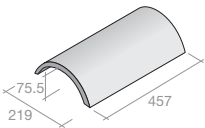

Third round hip tile (code 289)

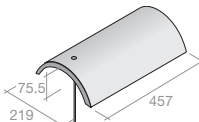

Third round security hip tile (code 364)

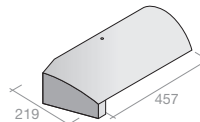

Third round stop end hip tile (code 291)

### Technical data

Size of tile	403mm x 333mm
Minimum roof pitch*	17.5°
Maximum pitch	70°
Headlap	75mm (minimum)
Batten spacing	328mm (at 75mm headlap)
Cover width	300mm (nominal)
Covering capacity	10.1 tiles/m <sup>2</sup> at 75mm headlap (net)
Weight of tiling	43.4 kg/m <sup>2</sup> at 75mm headlap (approx.)
Weight per tile	4.3kg
Weight per pallet	1070kg
Quantity per pallet	240
Battens required	3.05 lin.m/m <sup>2</sup> at 75mm headlap (net)
Batten size recommended (fixed to BS 5534)	38 x 25mm for rafters/supports not exceeding 450mm centres 50 x 25mm for rafters/supports not exceeding 600mm centres
Nail size	40 x 3.35mm aluminium clout head
Clips	Tile clip and nail (30430) Eave clip (30452) Eave clip nail (30455) RH verge clip (30289) LH verge tile clip (30289), LH verge clip - standard tile (30290)

\* Rafter length restrictions apply at low roof pitches. For further information please contact our Technical Advisory Service.

### Maxima key dimensions and data

- > minimum pitch 17.5°
- > 10.1 tiles/m<sup>2</sup>
- > flexible, open gauge

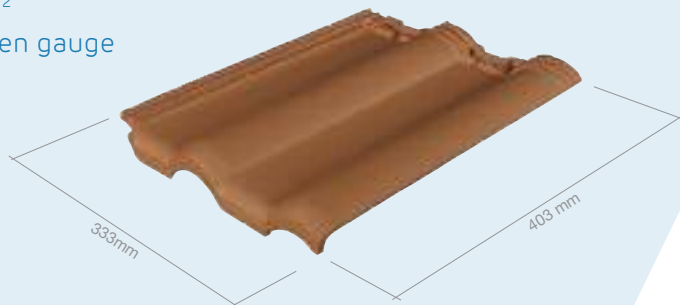

## Typical construction using Maxima clay interlocking double roman tiles

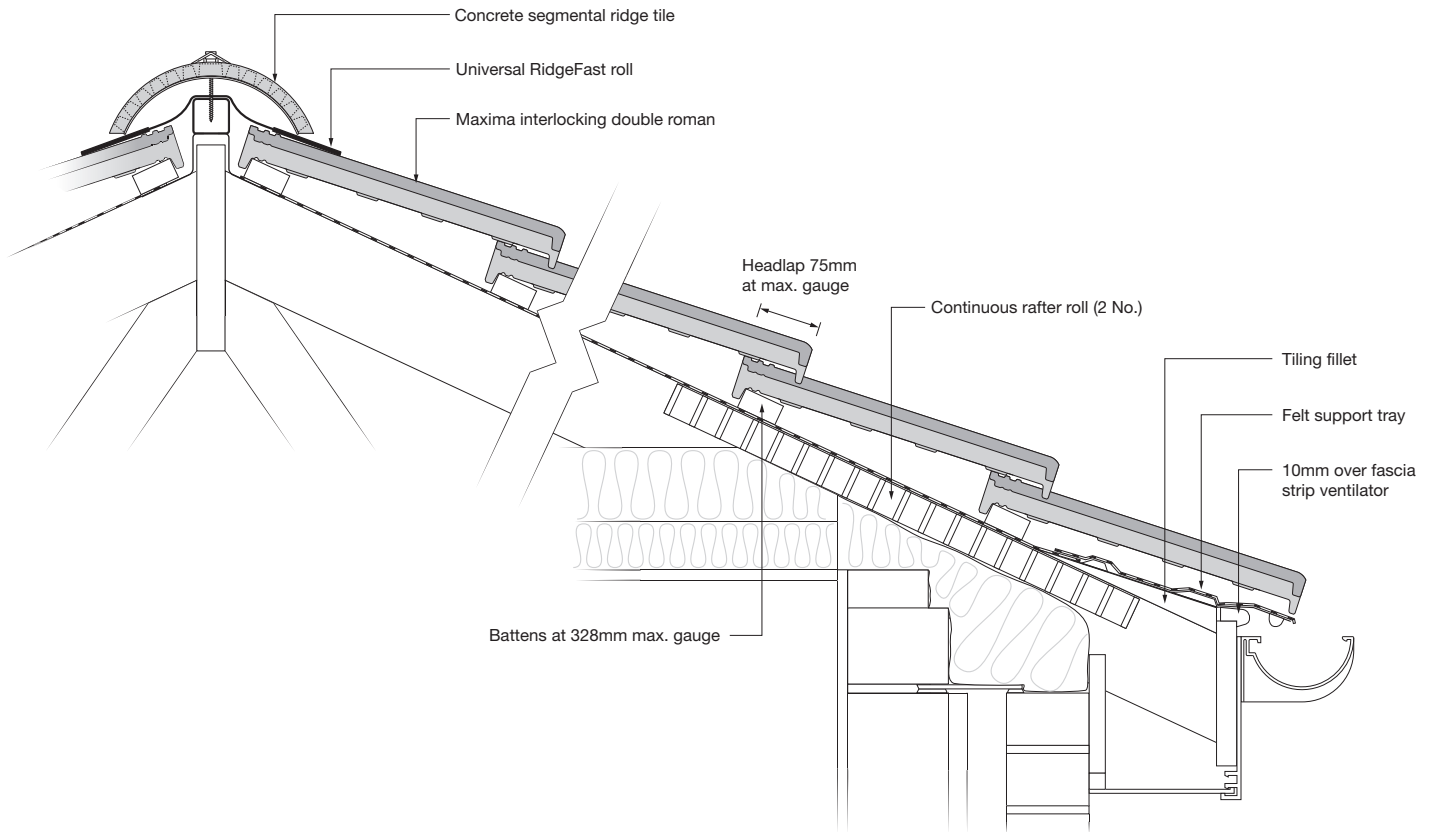

A flexible, large format tile bringing the beauty and durability of clay to new and refurbishment projects

> Tilefix  
[marleyeternit.co.uk/tilefix](http://marleyeternit.co.uk/tilefix)

> Estimator  
[marleyeternit.co.uk/estimator](http://marleyeternit.co.uk/estimator)

> NBS specs  
[marleyeternit.co.uk/specrite](http://marleyeternit.co.uk/specrite)

> Fixing guide  
[marleyeternit.co.uk/resources](http://marleyeternit.co.uk/resources)

## Roof ventilation and accessories

The following Universal products and accessories can be used with concrete segmental ridges, third round hip tiles and Maxima interlocking clay tiles. Our dedicated website contains further information about dry fix and ventilation solutions: [www.whydryfix.co.uk](http://www.whydryfix.co.uk)

Note: Minimum and maximum pitches may vary – please contact our Technical Advisory Service for more information.



### Universal eaves vent system

- Universal 10mm eaves vent system (6m) (code 46350)
- Universal 25mm eaves vent system (6m) (code 46351)
- Comb filler strip (code 30425)
- Continuous rafter roll (2 x 6 m) (code 46323)



### Universal RidgeFast system

- Universal RidgeFast system (6m) (code 33000)
- RidgeFast blanking tape (2 x 2 m) (code 33001)
- RidgeFast roll applicator (code 33002)
- RidgeFast/HipFast union pack (6 no. unions) (code 33003)



### Universal HipFast system

- Universal HipFast system (6m) (code 34001)
- Universal HipFast support tray (6m) (code 34002)
- RidgeFast/HipFast union pack (6 no. unions) (code 33003)



### Universal GRP dry valley

- High profile (3m) (code 30421)
- Accommodates up to 20° pitch difference either side of valley
- Suitable on rafter pitches from 17.5° to 60°



### Mortar bedded security ridge

- Mortar bedded security ridge kit (code 43605)
- Watch a quick video on mortar bedded security fixing at [marleyeternit.co.uk/securityridge](http://marleyeternit.co.uk/securityridge) or scan the QR code shown



### Mortar bedded security hip

- Mortar bedded security hip kit (code 43606)
- Watch a quick video on mortar bedded security fixing at [marleyeternit.co.uk/securityhip](http://marleyeternit.co.uk/securityhip) or scan the QR code shown



### Universal tile vent

- Universal tile vent terminal – terracotta colour (code 36704)
- Flexible Pipe (dia. 110mm) (code 39091)
- Minimum pitch 20°

Natural Red

A flexible, large format tile bringing the beauty and durability of clay to new and refurbishment projects

> Tilefix

[marleyeternit.co.uk/tilefix](https://marleyeternit.co.uk/tilefix)

> Estimator

[marleyeternit.co.uk/estimator](https://marleyeternit.co.uk/estimator)

> NBS specs

[marleyeternit.co.uk/specrite](https://marleyeternit.co.uk/specrite)

> Fixing guide

[marleyeternit.co.uk/resources](https://marleyeternit.co.uk/resources)

## Resources

### Technical advice

Our Technical Advisory Service is staffed by a qualified team with specialist knowledge.

**Tel 01283 722588 E-mail [info@marleyeternit.co.uk](mailto:info@marleyeternit.co.uk)**

### Samples

Samples of clay interlocking and plain tiles, fibre cement slates and concrete tiles are available on request.

**Tel 01283 722588 [marleyeternit.co.uk/samples](http://marleyeternit.co.uk/samples)**

### Stockist information

To find details for stockists of Marley Eternit products, visit:

**[marleyeternit.co.uk/stockists](http://marleyeternit.co.uk/stockists)**

### Training centre

We have a purpose-built training centre where we are able to impart our expertise through a range of practical and classroom courses. To find out more about our courses, visit:

**[marleyeternit.co.uk/training](http://marleyeternit.co.uk/training)**

### Customer services

Knowledgeable and friendly staff are available to offer quotations, expert advice, deal with orders and all other enquiries.

**Tel 08705 626400 E-mail [info@marleyeternit.co.uk](mailto:info@marleyeternit.co.uk)**

### Sales support

Our Area Sales Managers have in depth knowledge of your local area. They are available to visit your site to carry out a roof survey, and to offer specific solutions for both new build and refurbishment projects.

**[marleyeternit.co.uk/localcontacts](http://marleyeternit.co.uk/localcontacts)**

Call 01283 722588  
Email [info@marleyeternit.co.uk](mailto:info@marleyeternit.co.uk)  
Or visit [www.marleyeternit.co.uk](http://www.marleyeternit.co.uk)



Marley Eternit Lichfield Road Branston Burton upon Trent DE14 3HD



an **etex** company