

ITALIANO

**ISTRUZIONI PER L'INSERIMENTO DEI TELAI  
NELLE PARETI IN CARTONGESSO**

ENGLISH

**INSTRUCTIONS FOR MOUNTING CAP  
PRODUCTS TO PLASTERBOARD WALLS**

FRANCAIS

**NOTICE D'INSTALLATION DES ELEMENTS  
ET DES BATIS DANS LES PAROIS EN PLACOPLATRE**

DEUTSCH

**MONTAGEANLEITUNG ZUR BEFESTIGUNG  
VON ELEMENTEN AN GIPSKARTONWÄNDEN**

ESPAÑOL

**INSTRUCCIONES PARA INTRODUCIR LOS ELEMENTOS  
Y LOS BASTIDORES EN LAS PAREDES DE CARTÓN YESO**

NEDERLANDS

**INSTRUCTIES VOOR DE PLAATSING VAN DE  
ELEMENTEN EN DE FRAMES IN GIPSPLATEN WANDEN**

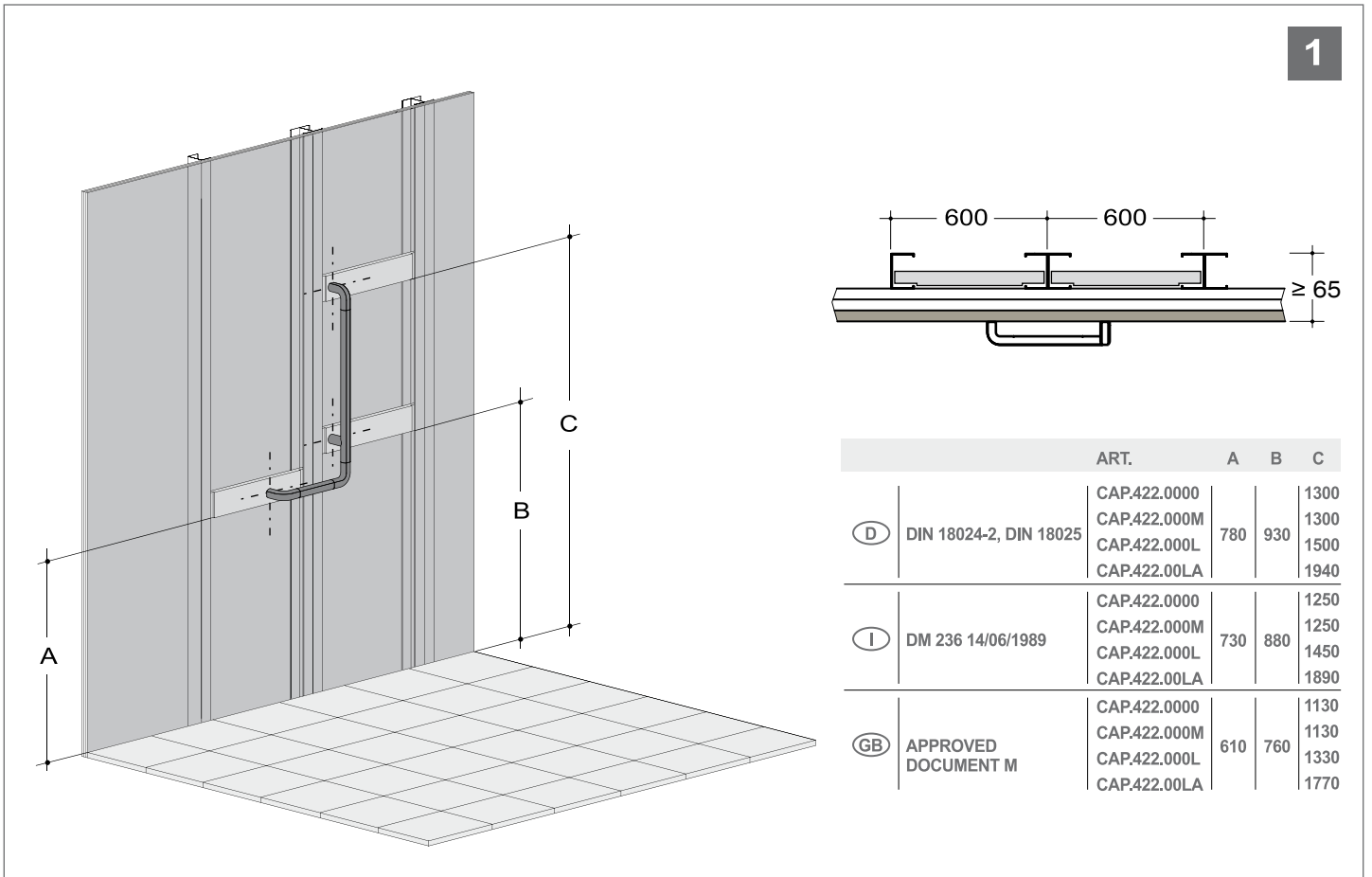
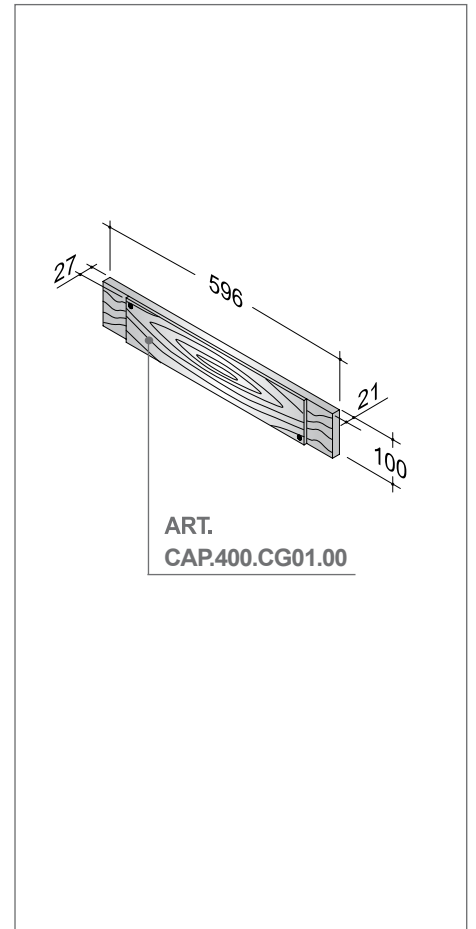
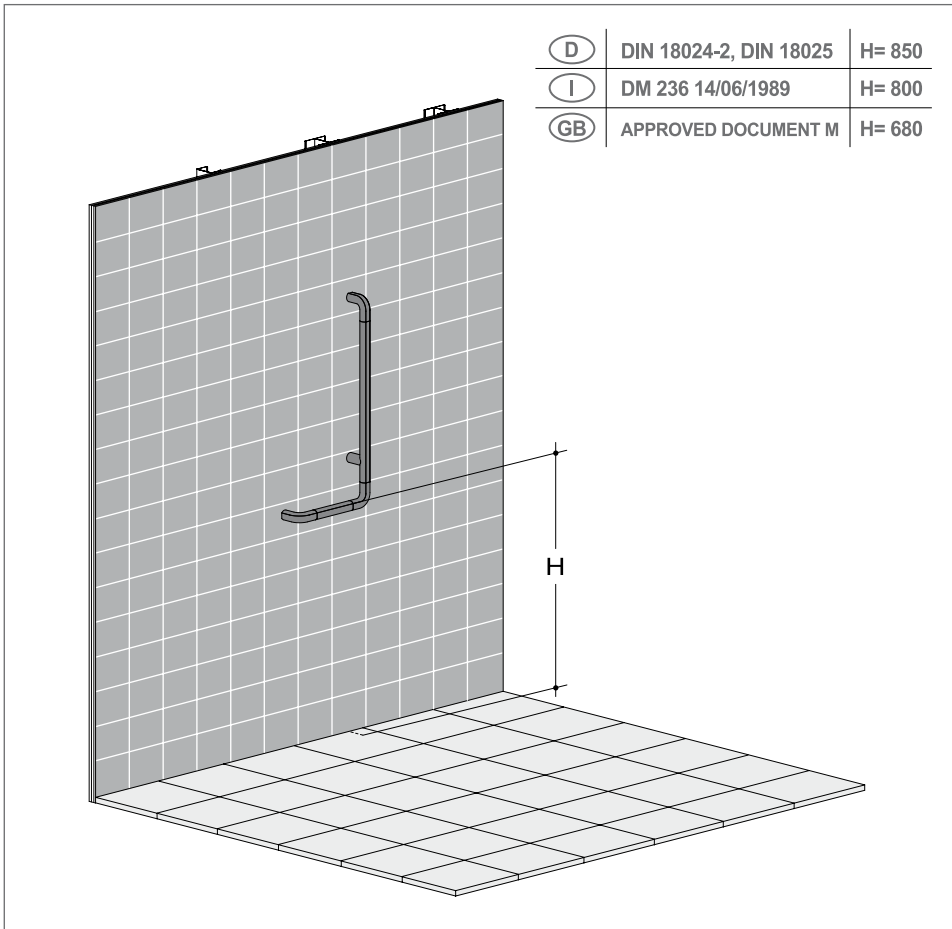
**ART. CAP.422.0000 - CAP.422.000M - CAP.422.000L - CAP.422.00LA**

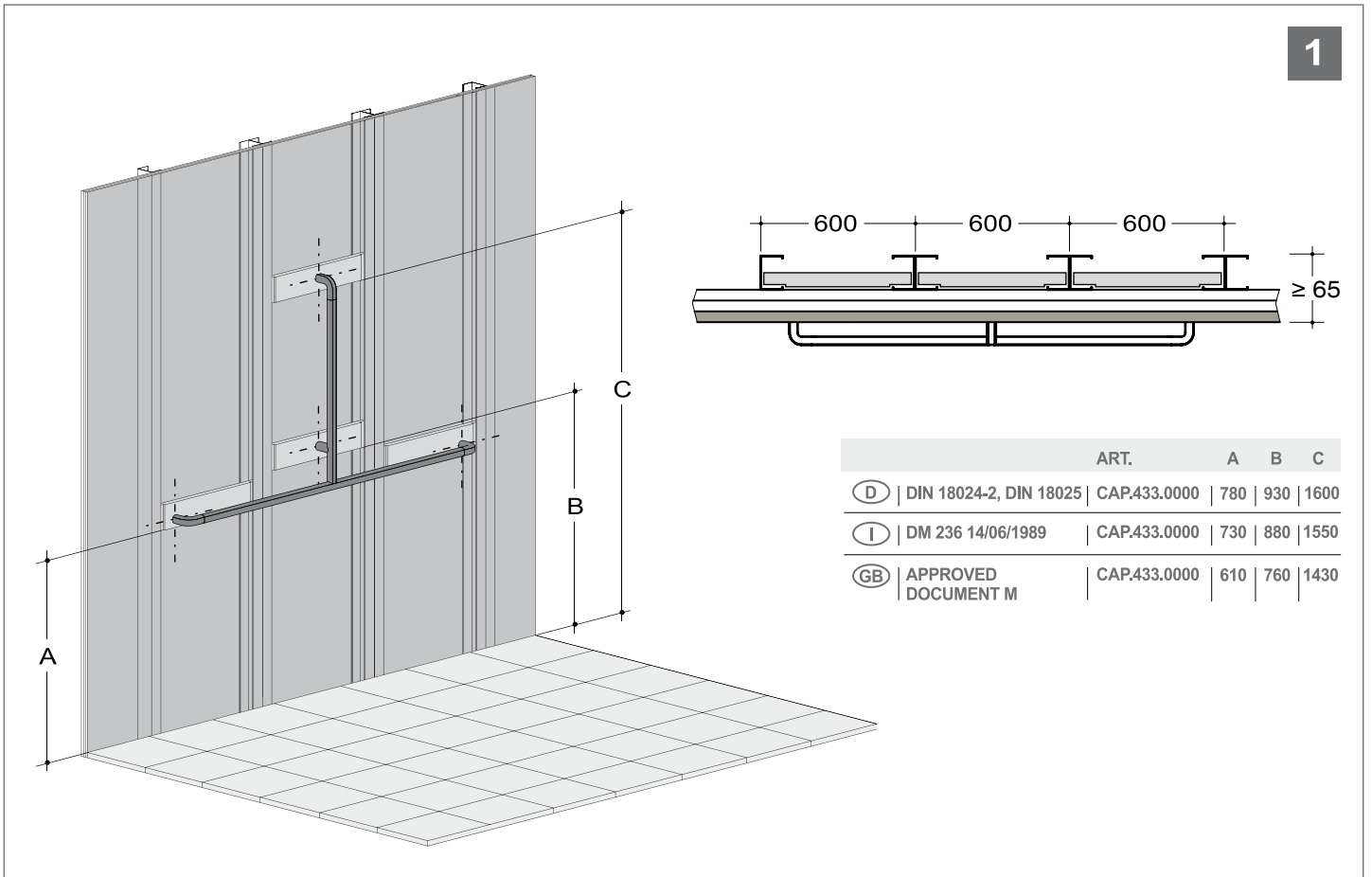
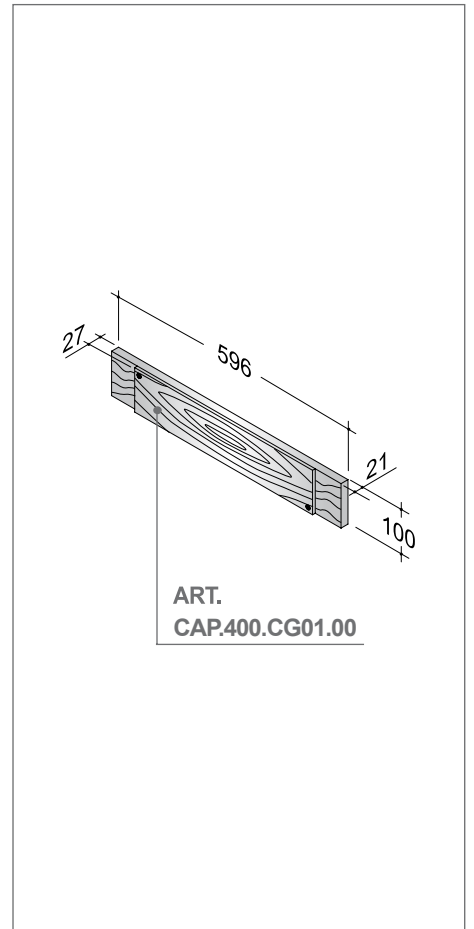
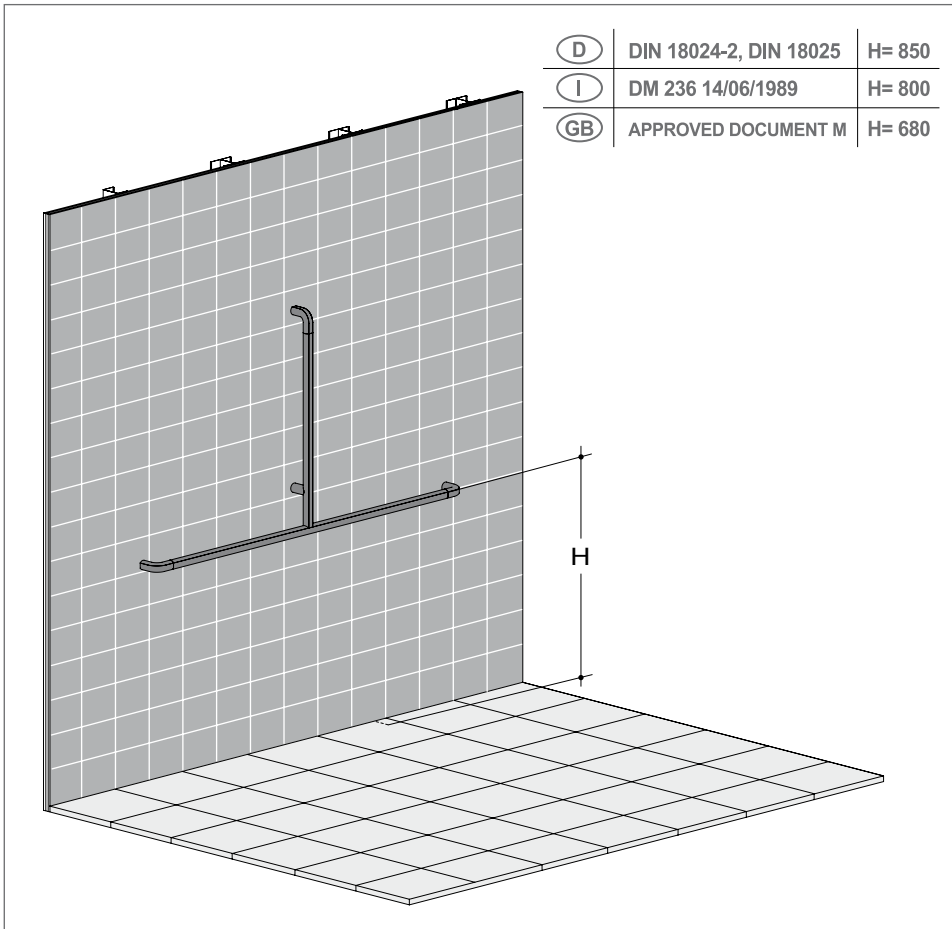
**ART. CAP.433.0000**

**PROGRAMMA CAP**
**ART. CAP.424.000L**

<b>(D)</b>	DIN 18024-2, DIN 18025	H= 850
<b>(I)</b>	DM 236 14/06/1989	H= 800
<b>(GB)</b>	APPROVED DOCUMENT M	H= 680

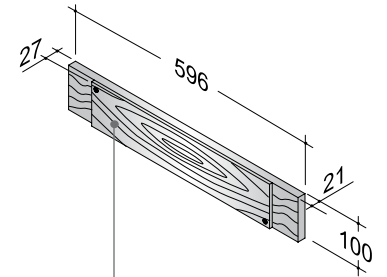
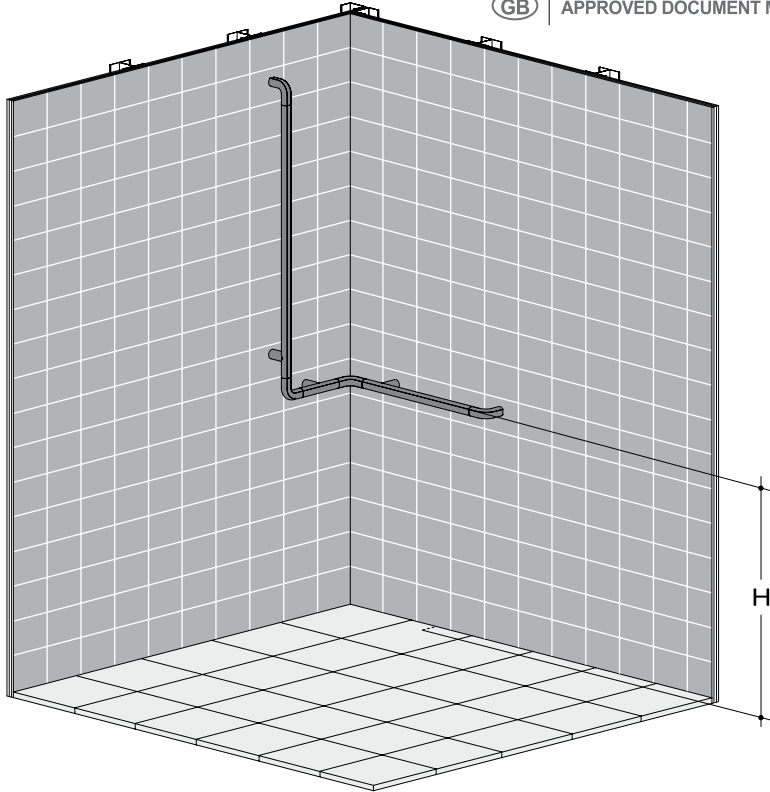
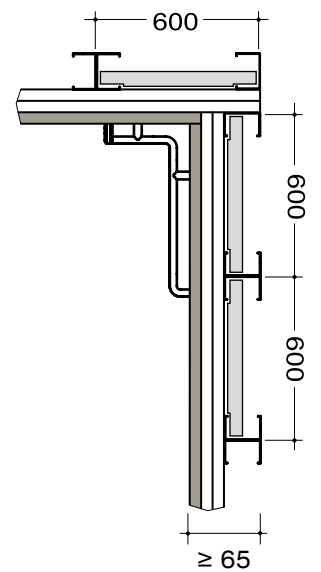
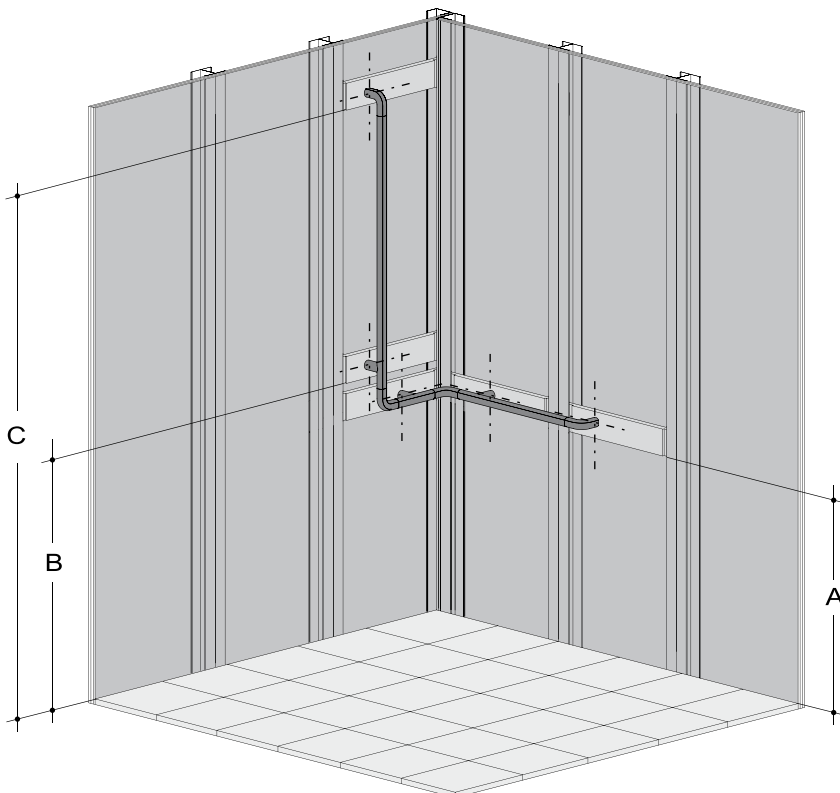
**ART.  
CAP.400.CG01.00**

	ART.	A	B	C
<b>(D)</b>	DIN 18024-2, DIN 18025   CAP.424.000L	780	930	1940
<b>(I)</b>	DM 236 14/06/1989   CAP.424.000L	730	880	1890
<b>(GB)</b>	APPROVED DOCUMENT M   CAP.424.000L	610	760	1770

**ART. CAP.424.0000 – CAP.424.00LA**

(D)	DIN 18024-2, DIN 18025	H= 850
(I)	DM 236 14/06/1989	H= 800
(GB)	APPROVED DOCUMENT M	H= 680

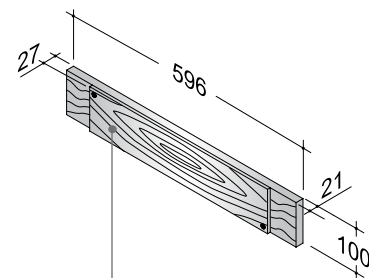
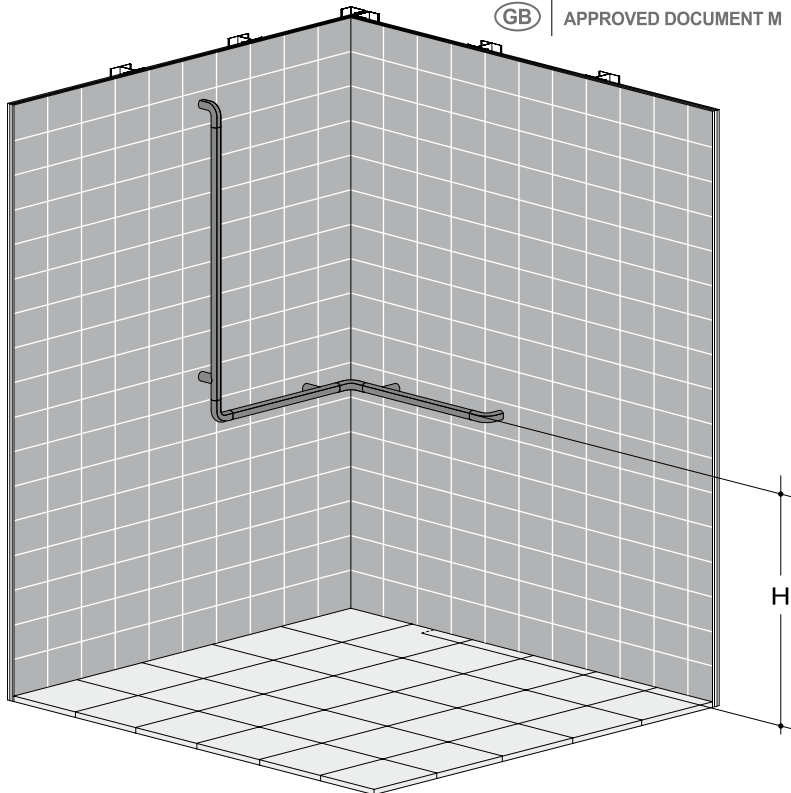
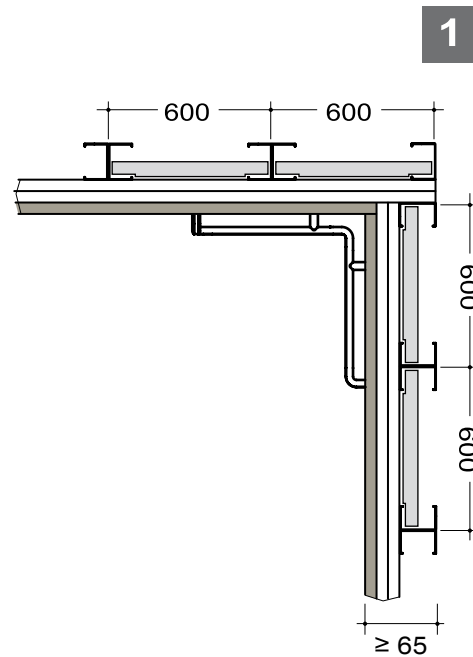
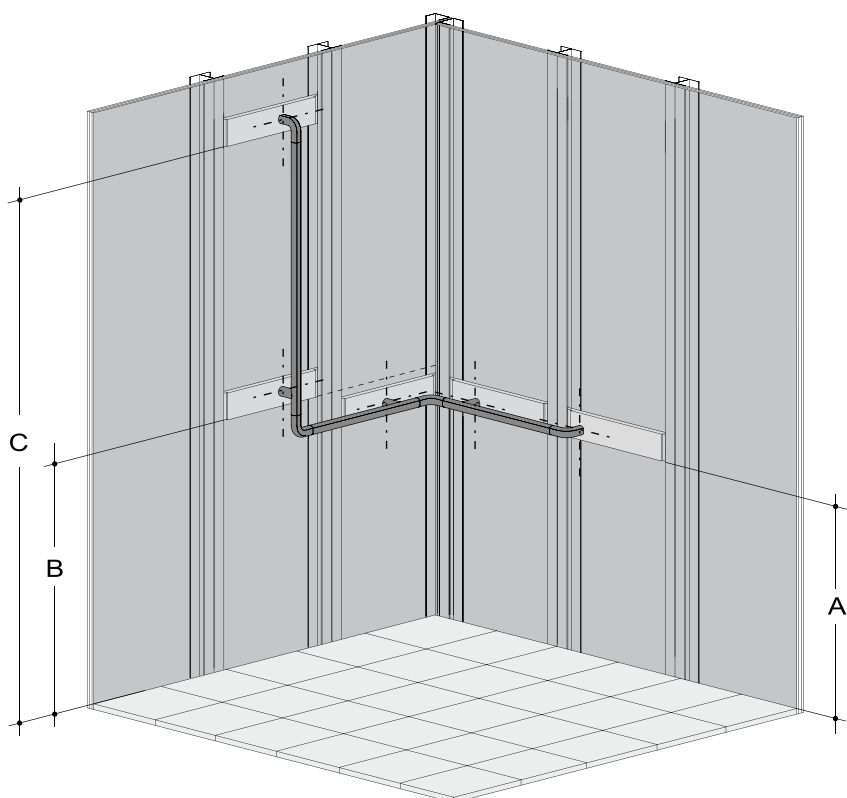
**ART.  
CAP.400.CG01.00**

	ART.	A	B	C	
(D)	DIN 18024-2, DIN 18025	CAP.424.0000	780	930	1600
		CAP.424.00LA			1940
(I)	DM 236 14/06/1989	CAP.424.0000	730	880	1550
		CAP.424.00LA			1890
(GB)	APPROVED DOCUMENT M	CAP.424.0000	610	760	1430
		CAP.424.00LA			1770

**ART. CAP.443.000B**

(D)	DIN 18024-2, DIN 18025	H= 850
(I)	DM 236 14/06/1989	H= 800
(GB)	APPROVED DOCUMENT M	H= 680

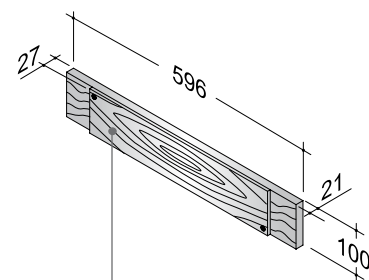
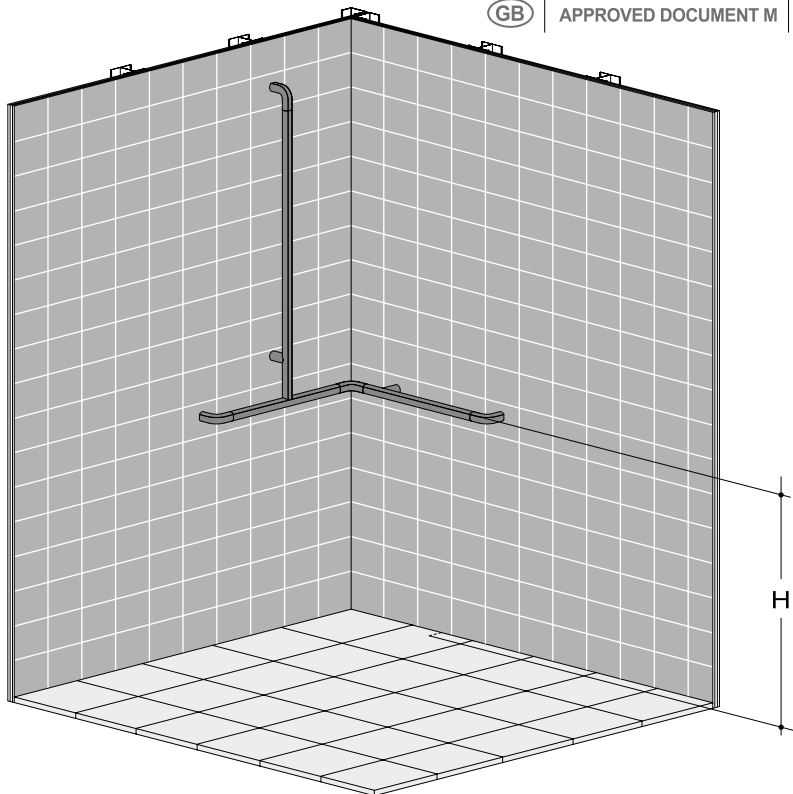
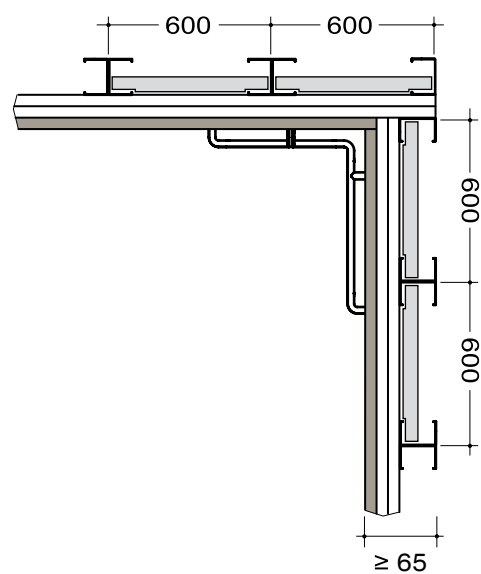
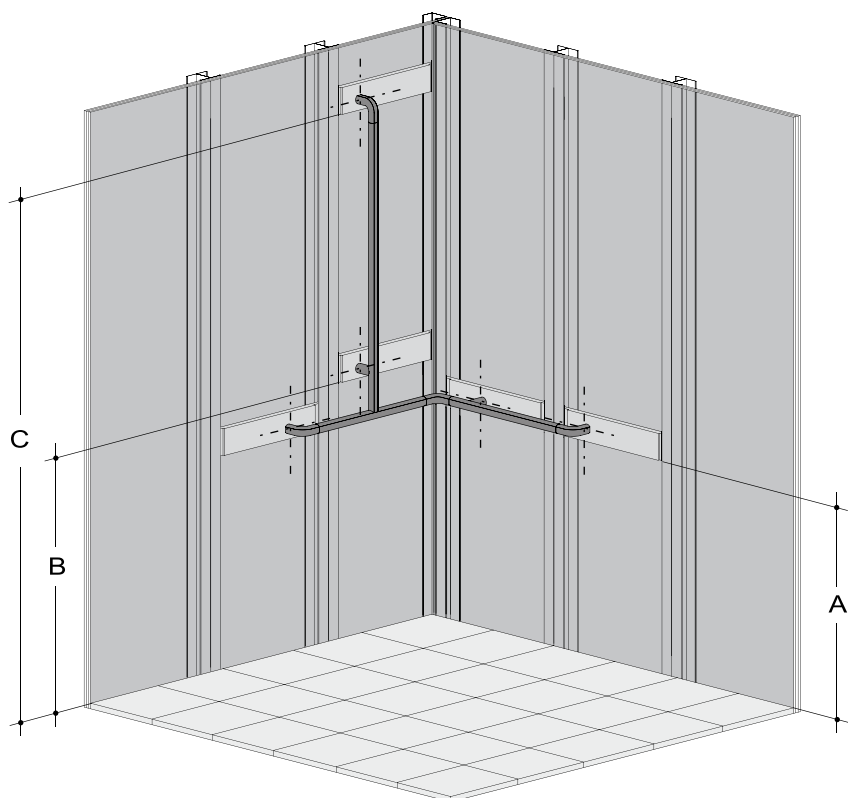
**ART.  
CAP.400.CG01.00**

	ART.	A	B	C	
(D)	DIN 18024-2, DIN 18025	CAP.443.000B	780	930	1940
(I)	DM 236 14/06/1989	CAP.443.000B	730	880	1890
(GB)	APPROVED DOCUMENT M	CAP.443.000B	610	760	1770

**ART. CAP.443.00BL**

(D)	DIN 18024-2, DIN 18025	H= 850
(I)	DM 236 14/06/1989	H= 800
(GB)	APPROVED DOCUMENT M	H= 680

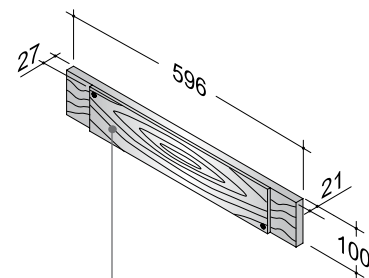
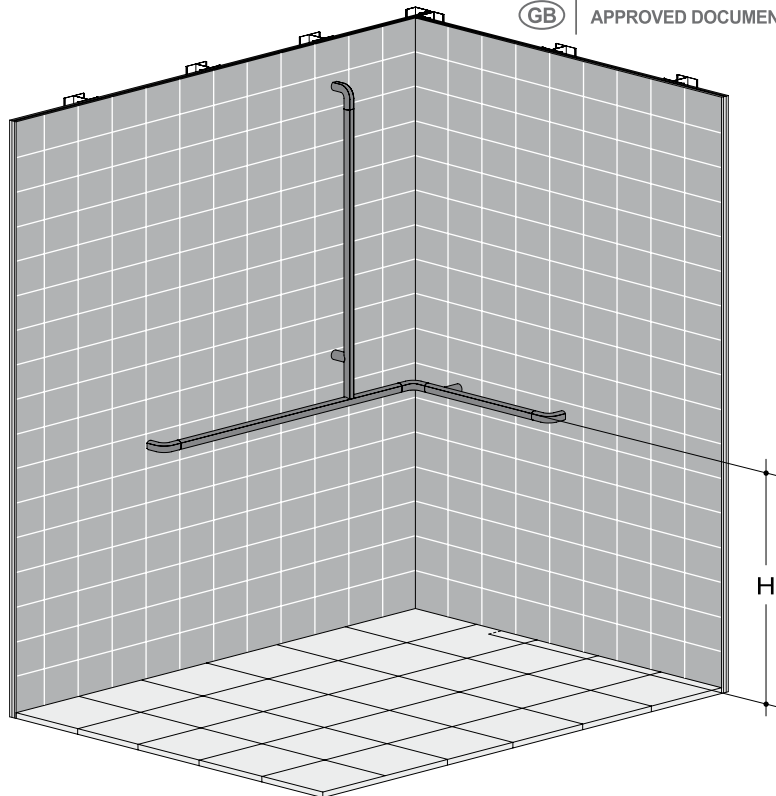
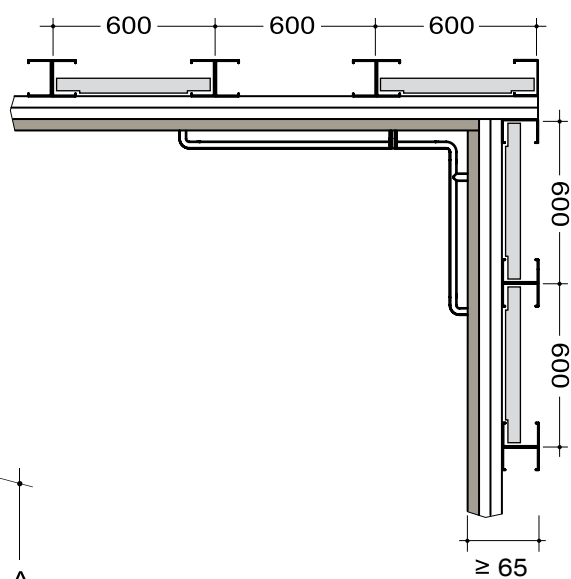
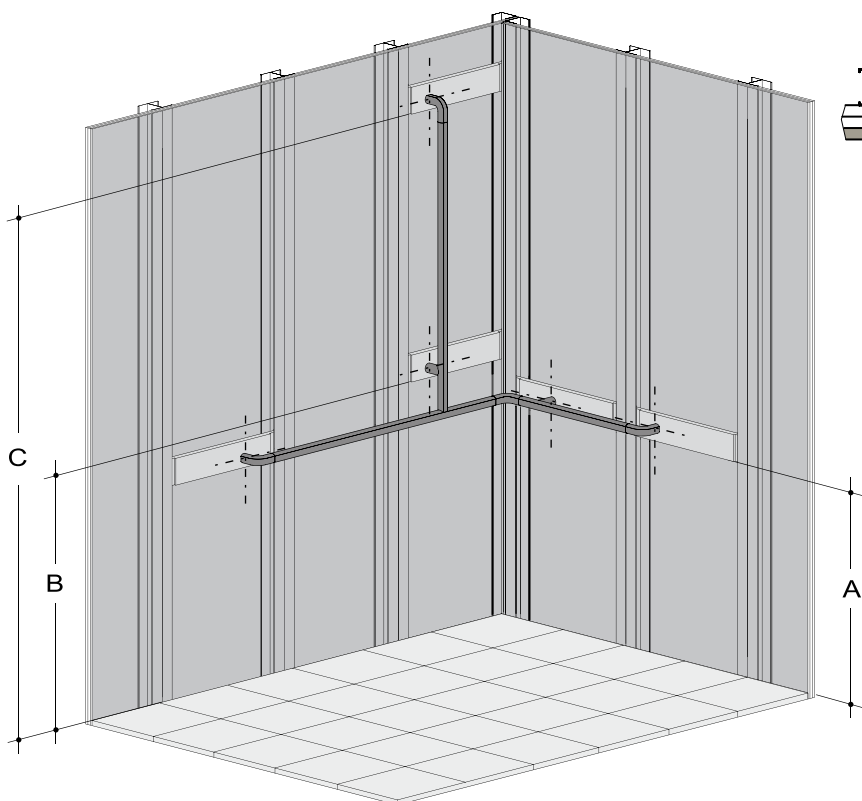
**ART.  
CAP.400.CG01.00**

	ART.	A	B	C
(D)	DIN 18024-2, DIN 18025   CAP.443.00BL	780	930	1940
(I)	DM 236 14/06/1989   CAP.443.00BL	730	880	1890
(GB)	APPROVED DOCUMENT M   CAP.443.00BL	610	760	1770

**PROGRAMMA CAP**
**ART. CAP.442.0000 - CAP.442.000M**

(D)	DIN 18024-2, DIN 18025	H= 850
(I)	DM 236 14/06/1989	H= 800
(GB)	APPROVED DOCUMENT M	H= 680

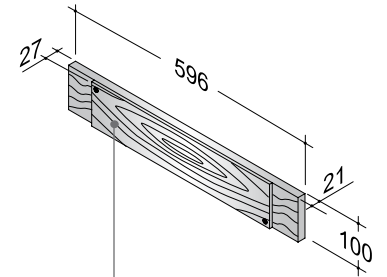
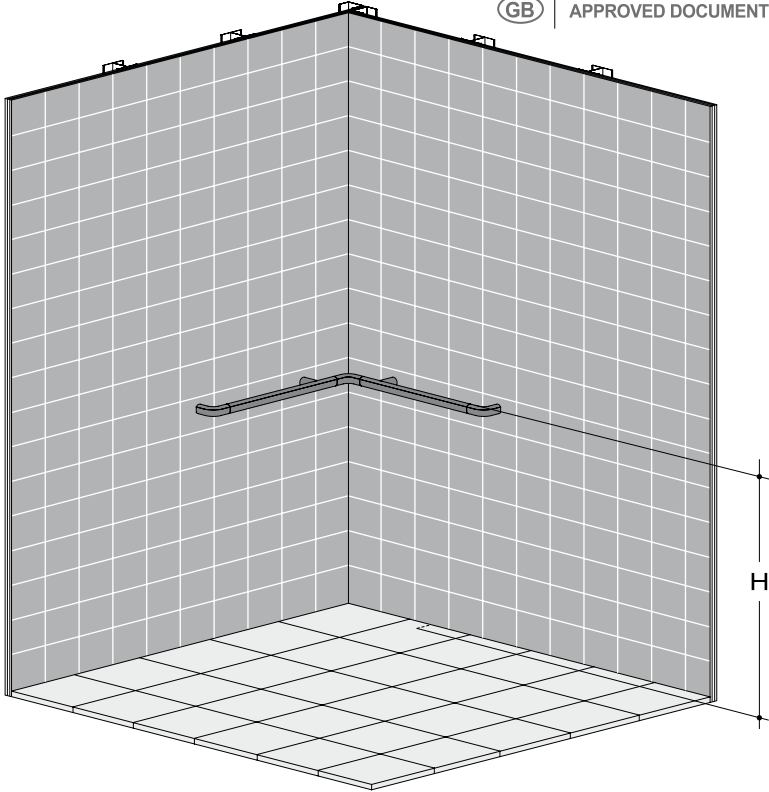
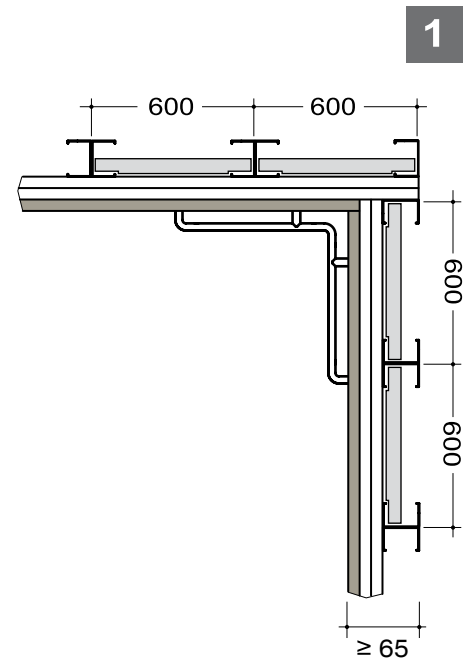
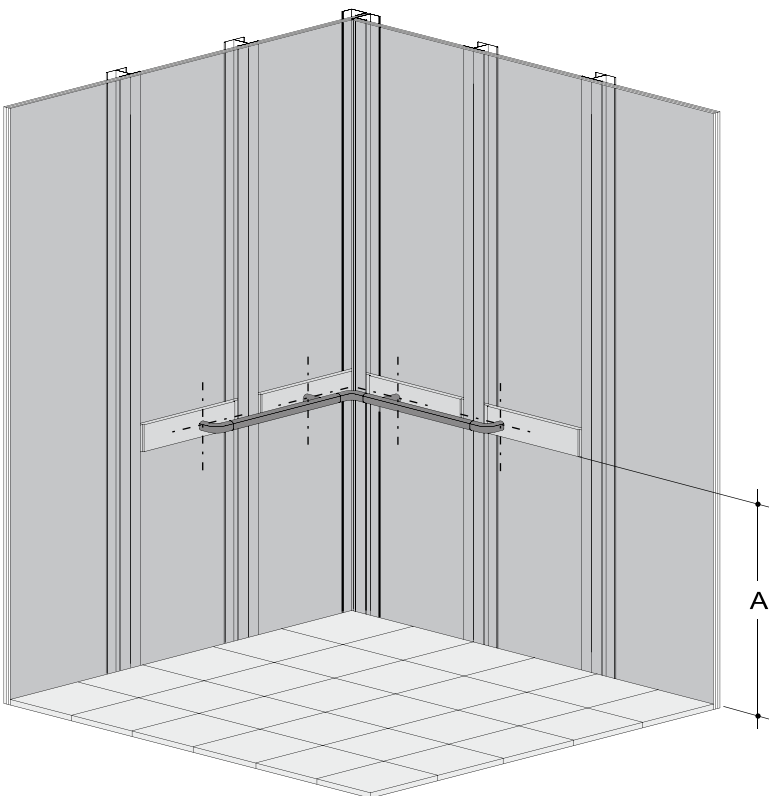
**ART.  
CAP.400.CG01.00**

	ART.	A
(D)	DIN 18024-2, DIN 18025   CAP.442.0000   CAP.442.000M	780
(I)	DM 236 14/06/1989   CAP.442.0000   CAP.442.000M	730
(GB)	APPROVED DOCUMENT M   CAP.442.0000   CAP.442.000M	610

**PROGRAMMA CAP**
**ART. CAP.442.000L**

(D)	DIN 18024-2, DIN 18025	H= 850
(I)	DM 236 14/06/1989	H= 800
(GB)	APPROVED DOCUMENT M	H= 680

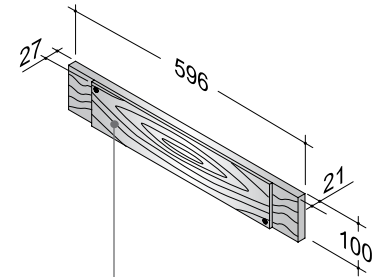
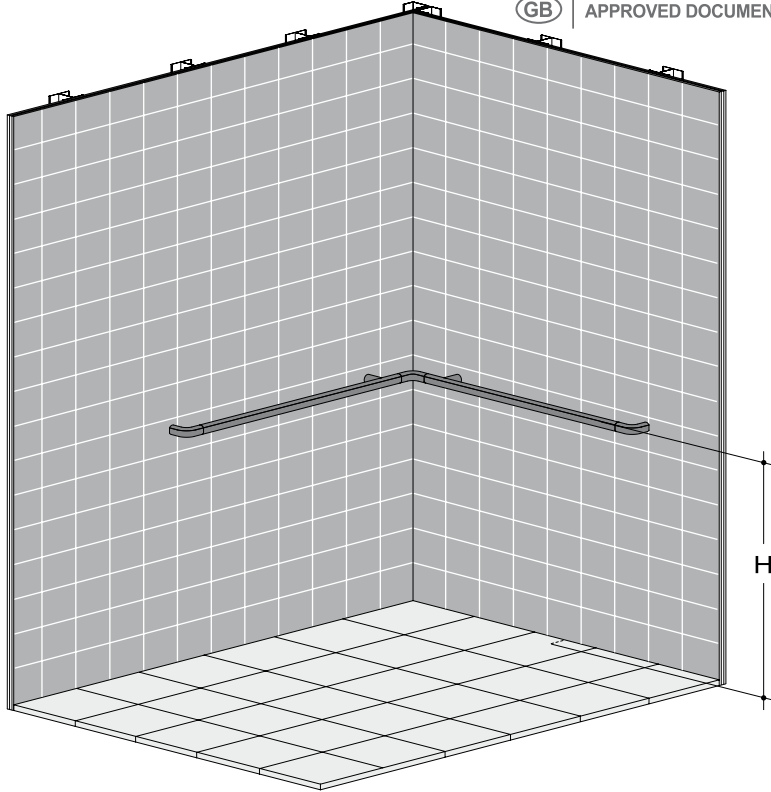
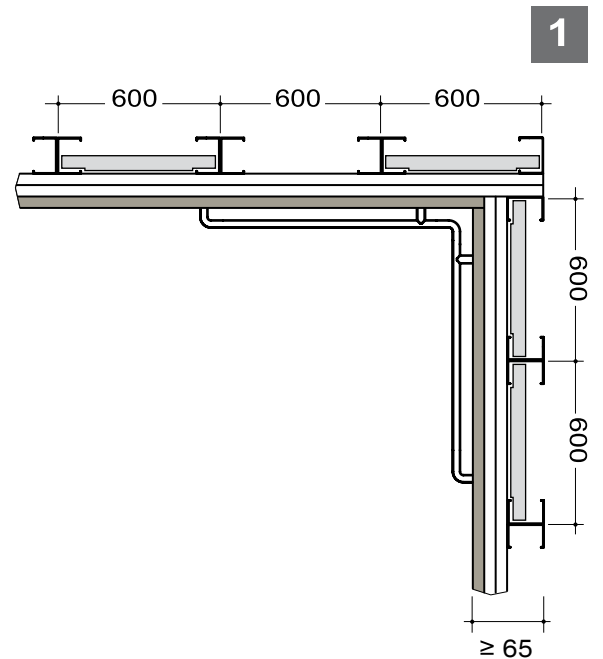
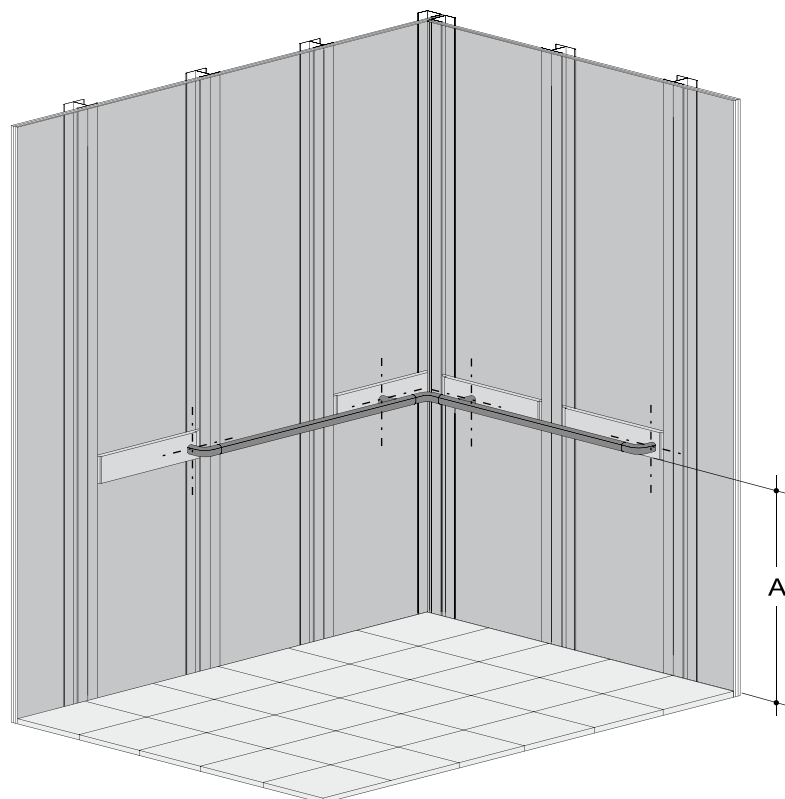

**ART.  
CAP.400.CG01.00**

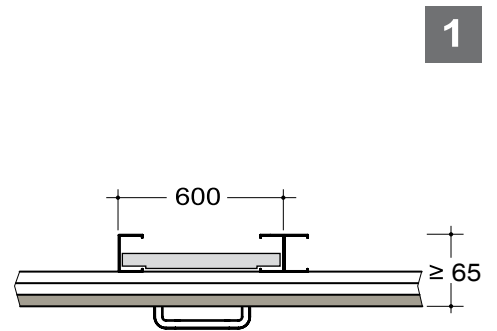
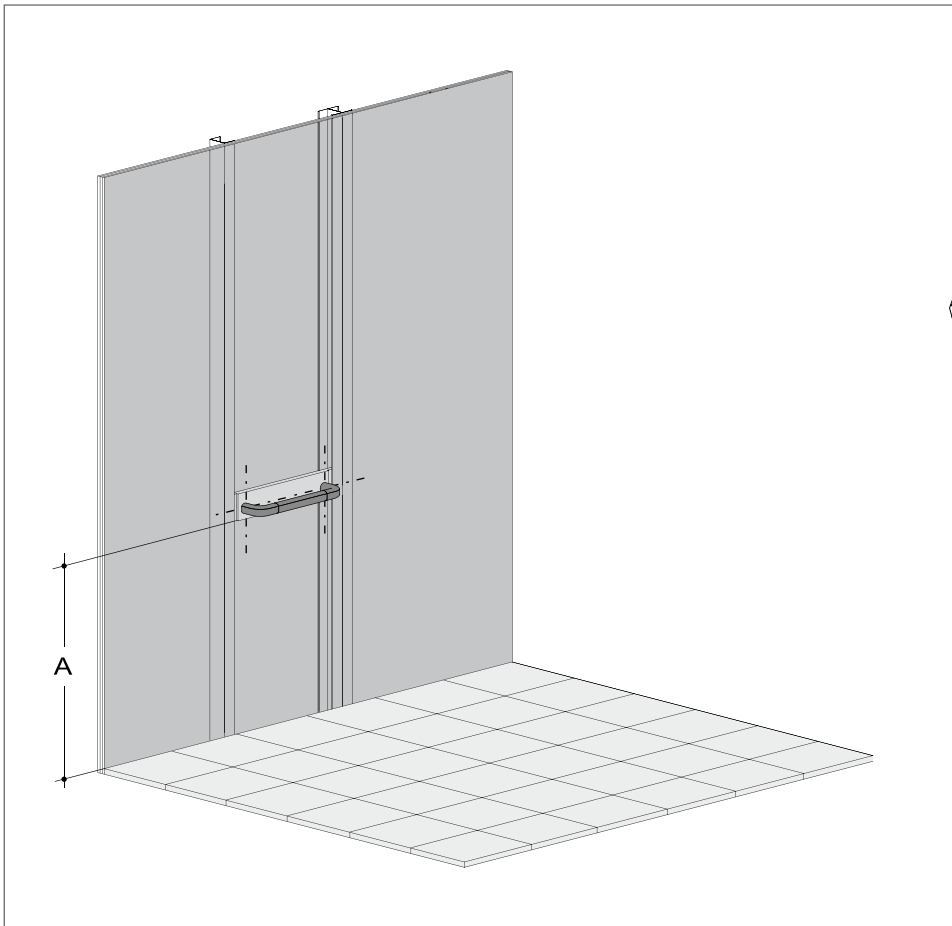
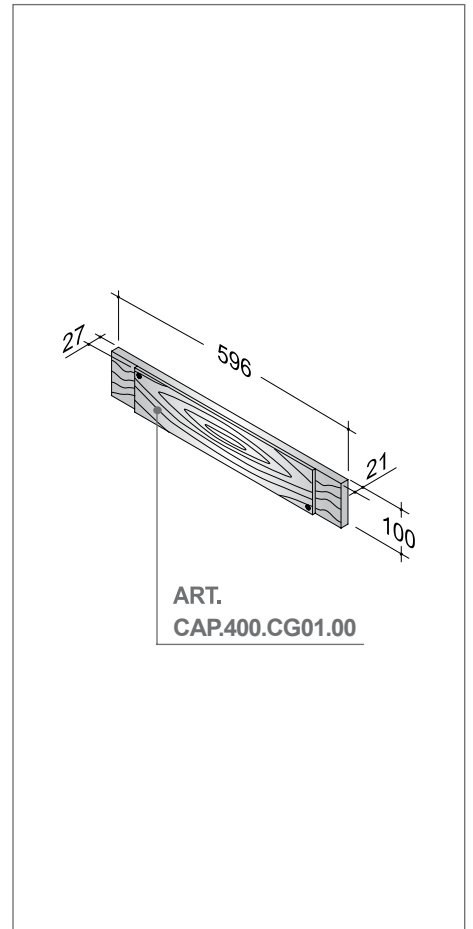
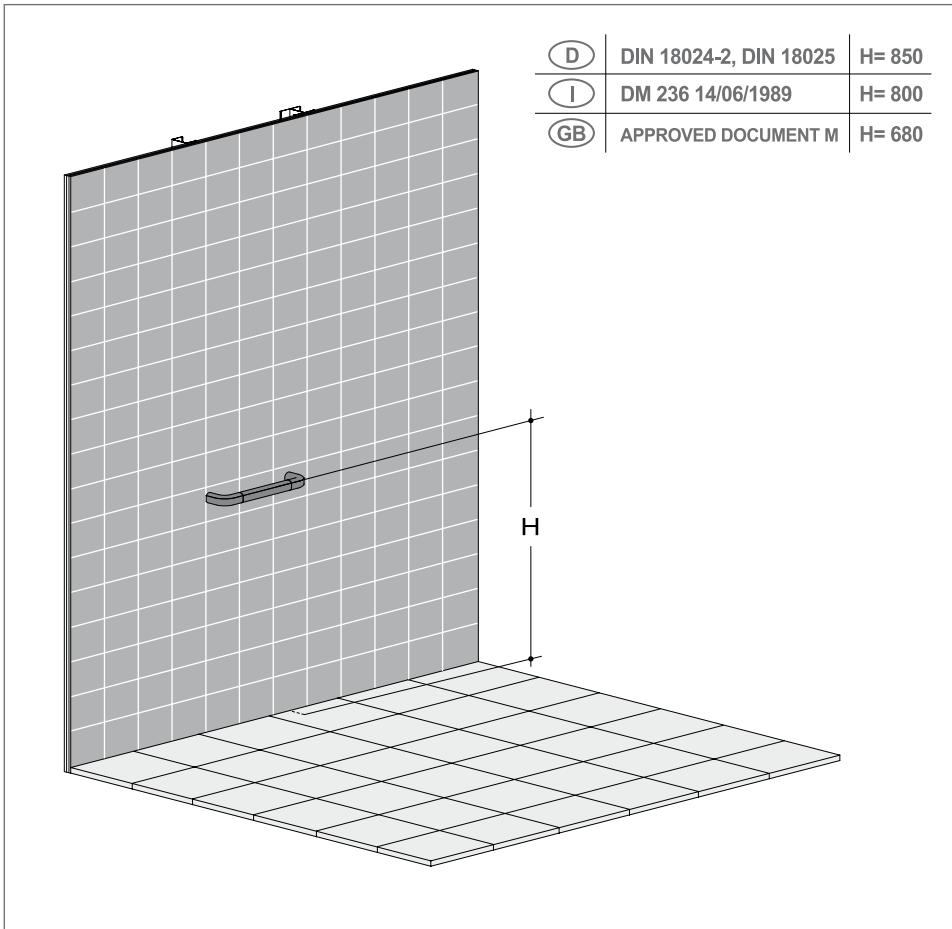
	ART.	A
(D)	DIN 18024-2, DIN 18025   CAP.442.000L	780
(I)	DM 236 14/06/1989   CAP.442.000L	730
(GB)	APPROVED DOCUMENT M   CAP.442.000L	610

**PROGRAMMA CAP**
**ART. CAP.440.0000 - CAP.440.000Z**

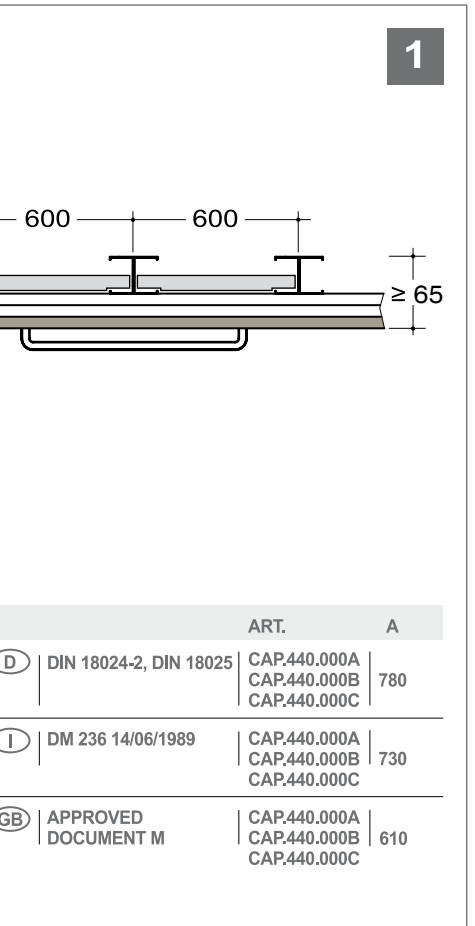
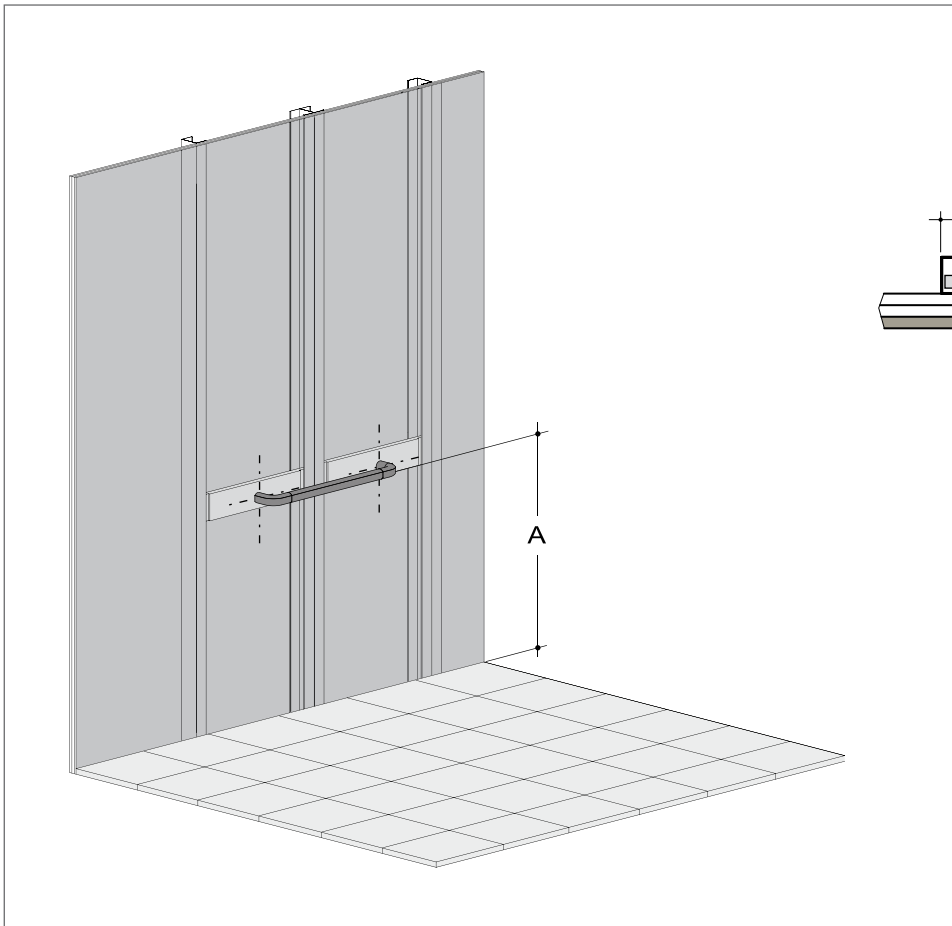
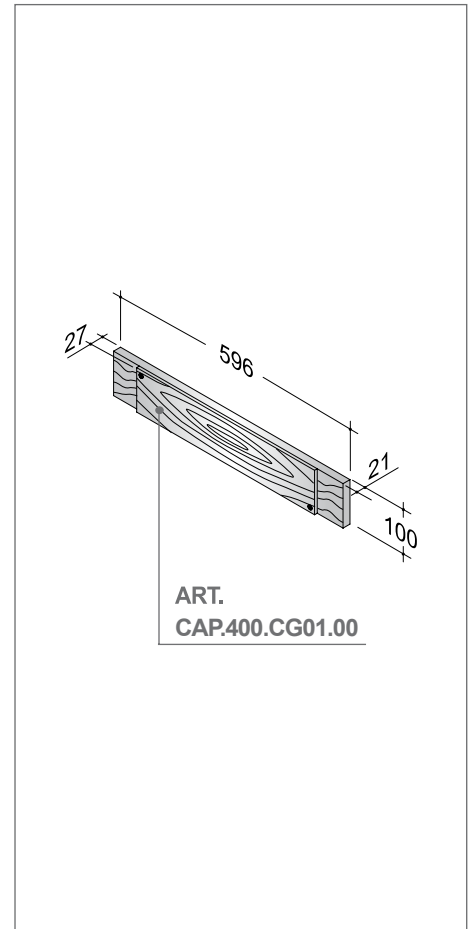
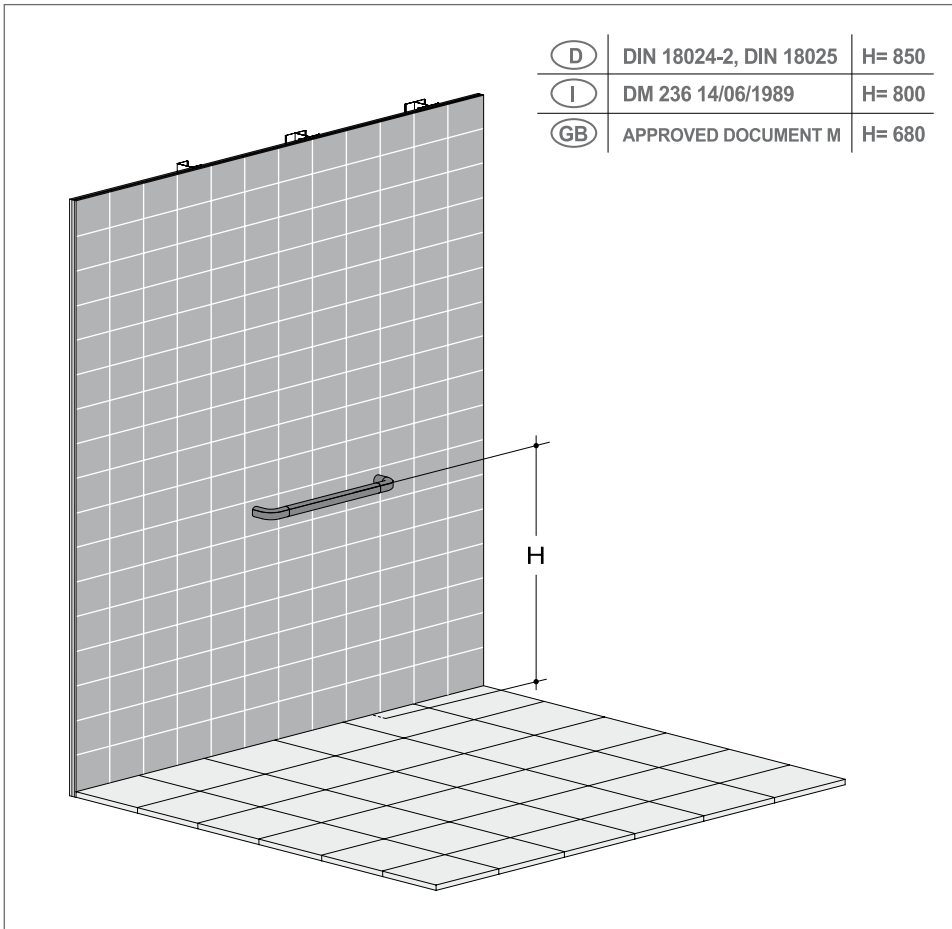
	ART.	A
(D)	DIN 18024-2, DIN 18025 CAP.440.0000 CAP.440.000Z	780
(I)	DM 236 14/06/1989 CAP.440.0000 CAP.440.000Z	730
(GB)	APPROVED DOCUMENT M CAP.440.0000 CAP.440.000Z	610

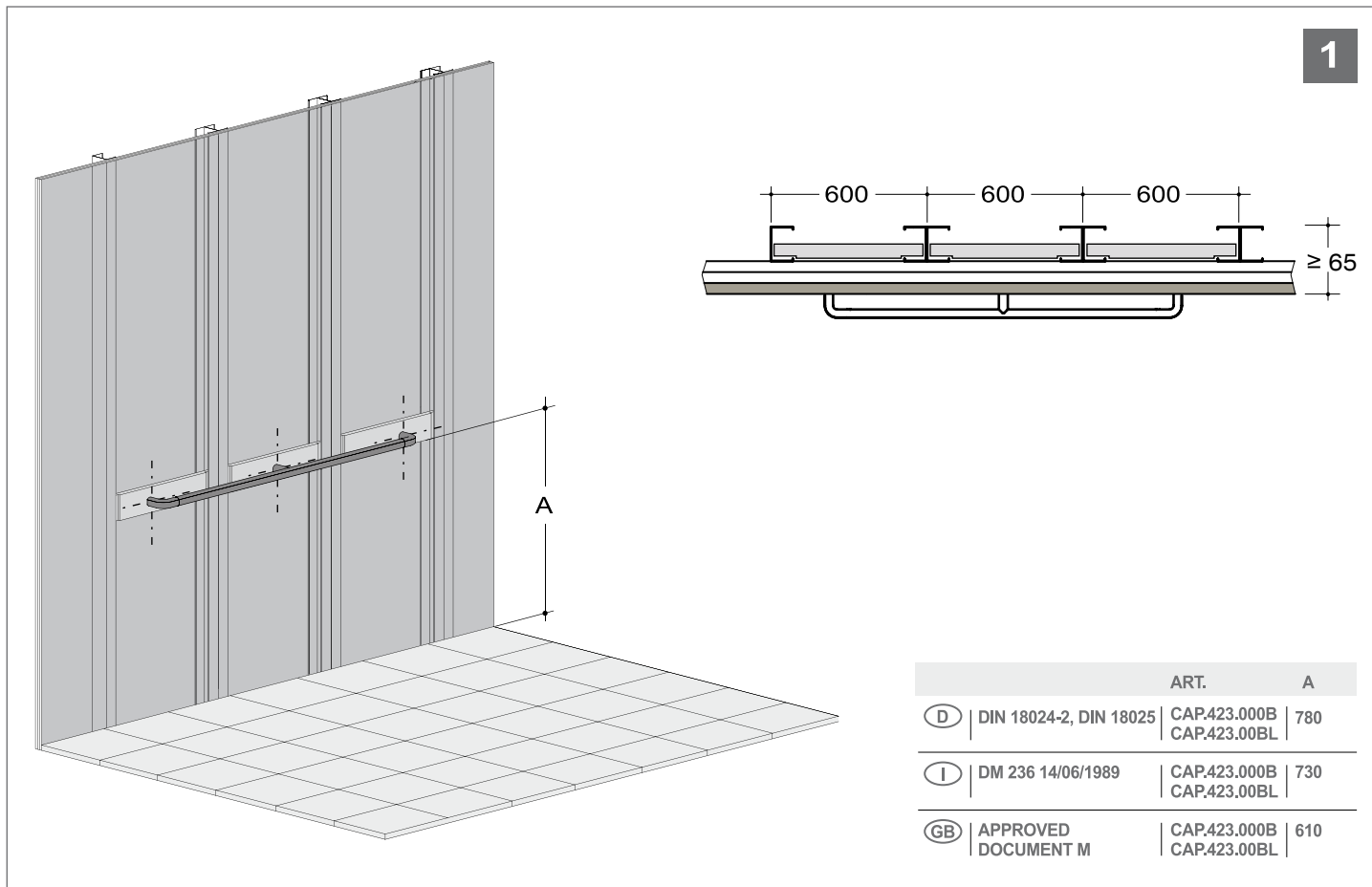
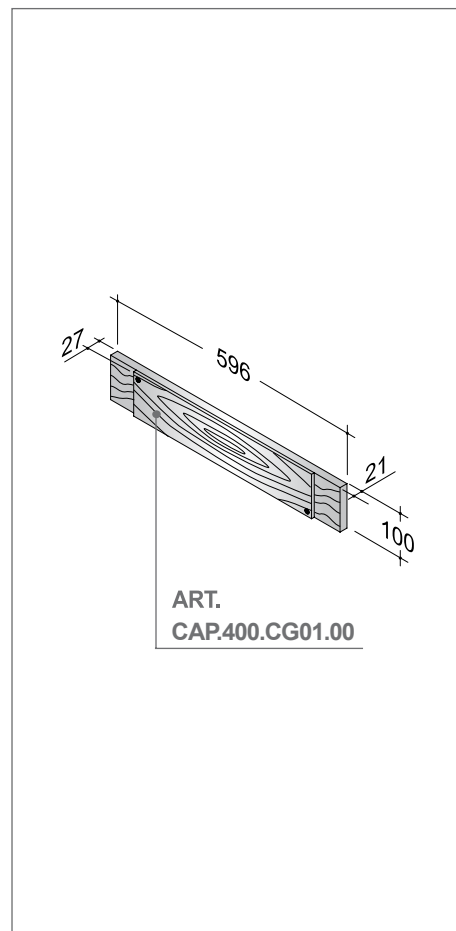
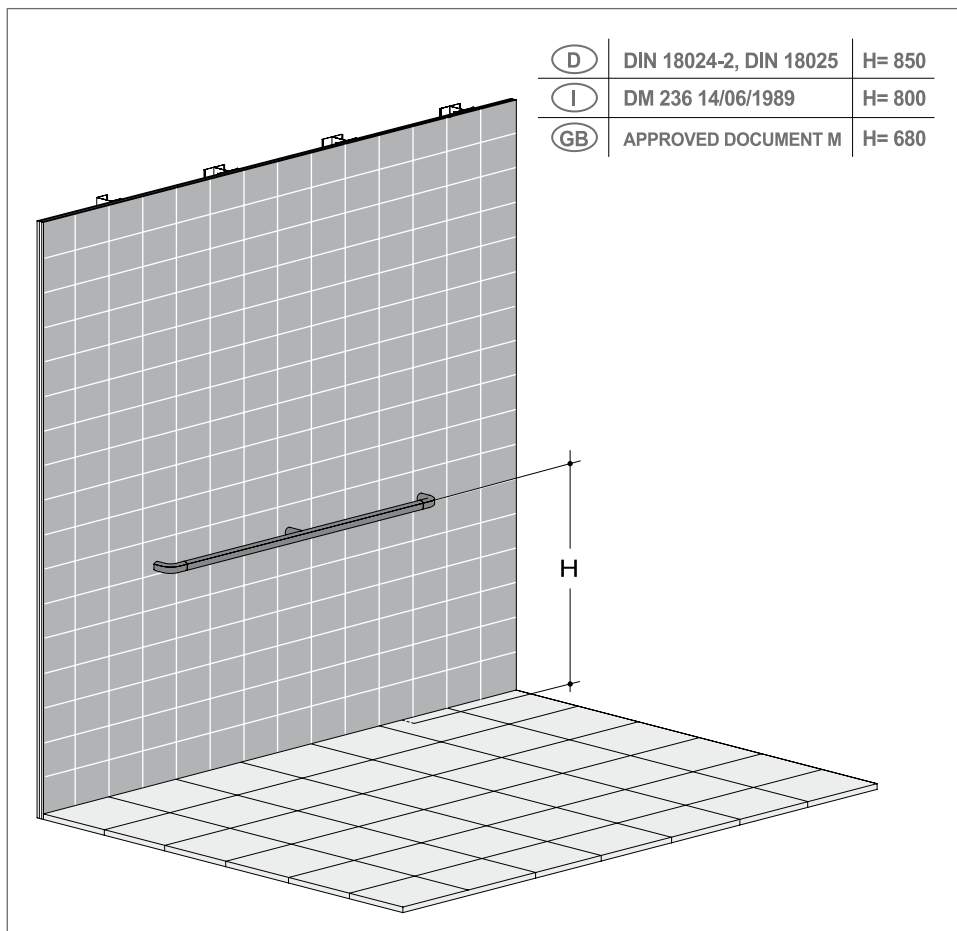
**PROGRAMMA CAP**
**ART. CAP.440.000A - CAP.440.000B - CAP.440.000C**

**PROGRAMMA CAP**
**ART. CAP.423.000B - CAP.423.00BL**

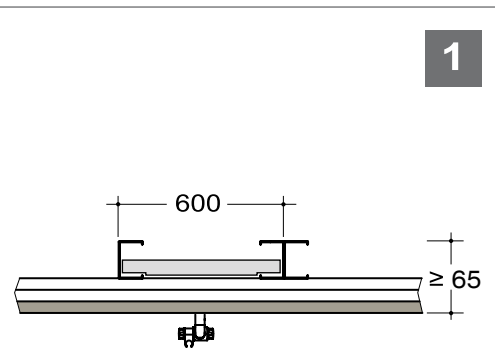
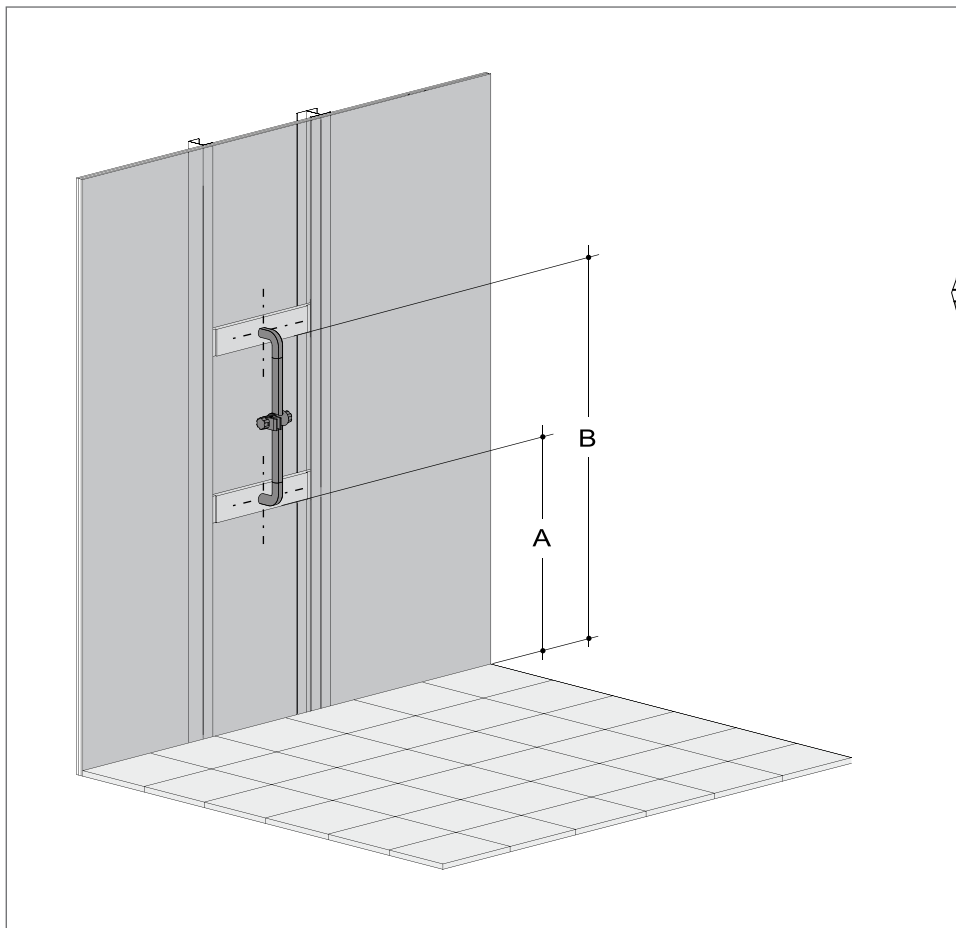
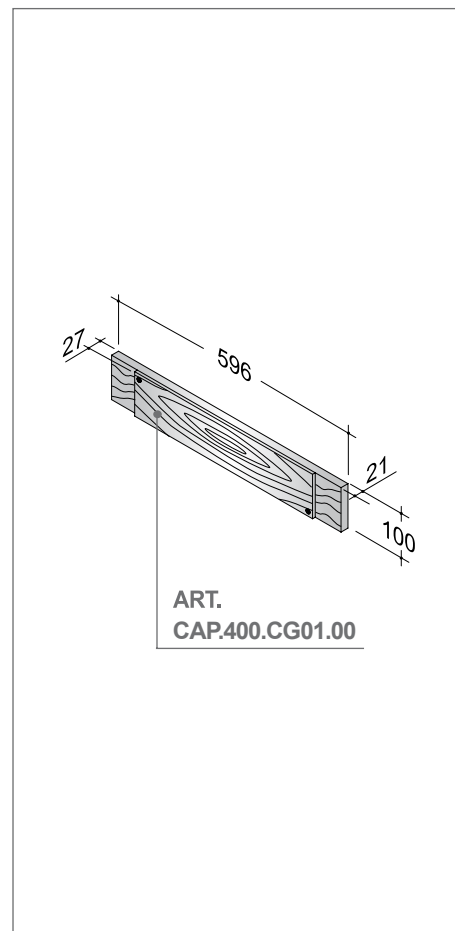
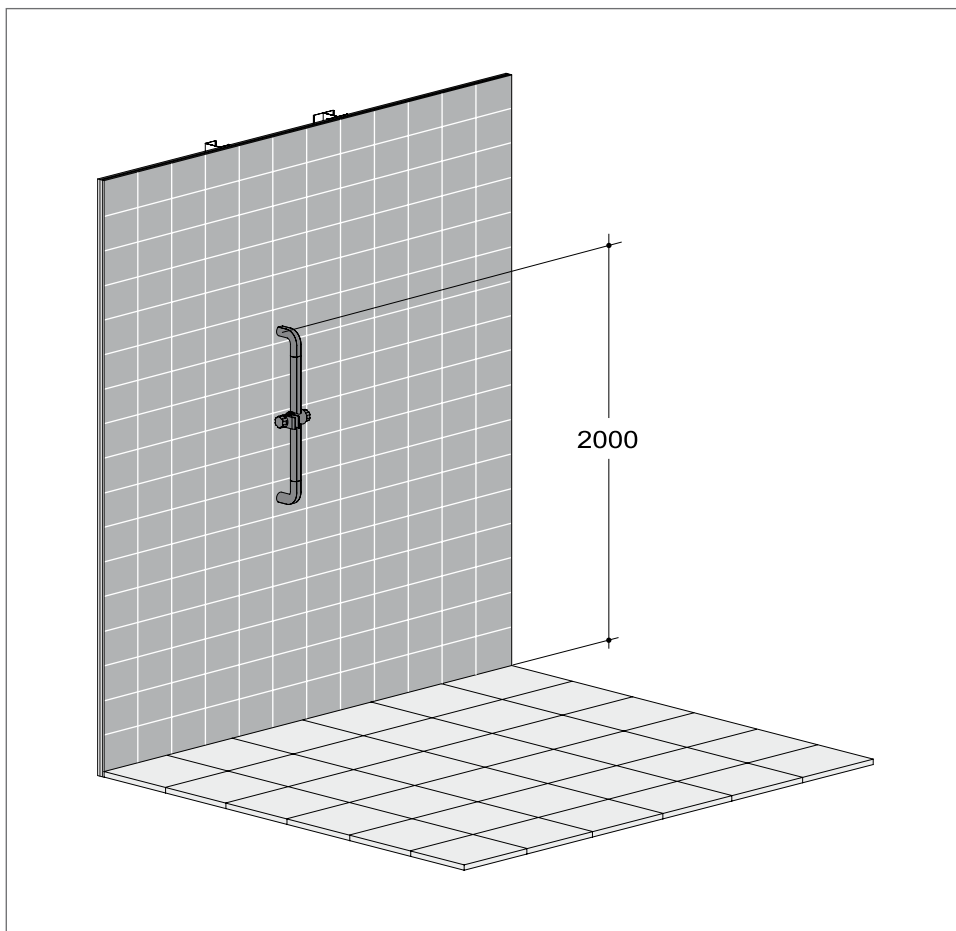
**ART. CAP.487.0000 – CAP.487.000A - CAP.487.000B - CAP.487.000C**

ART.	A	B
CAP.487.0000	1380	1950
CAP.487.000A	1180	
CAP.487.000B	980	
CAP.487.000C	780	

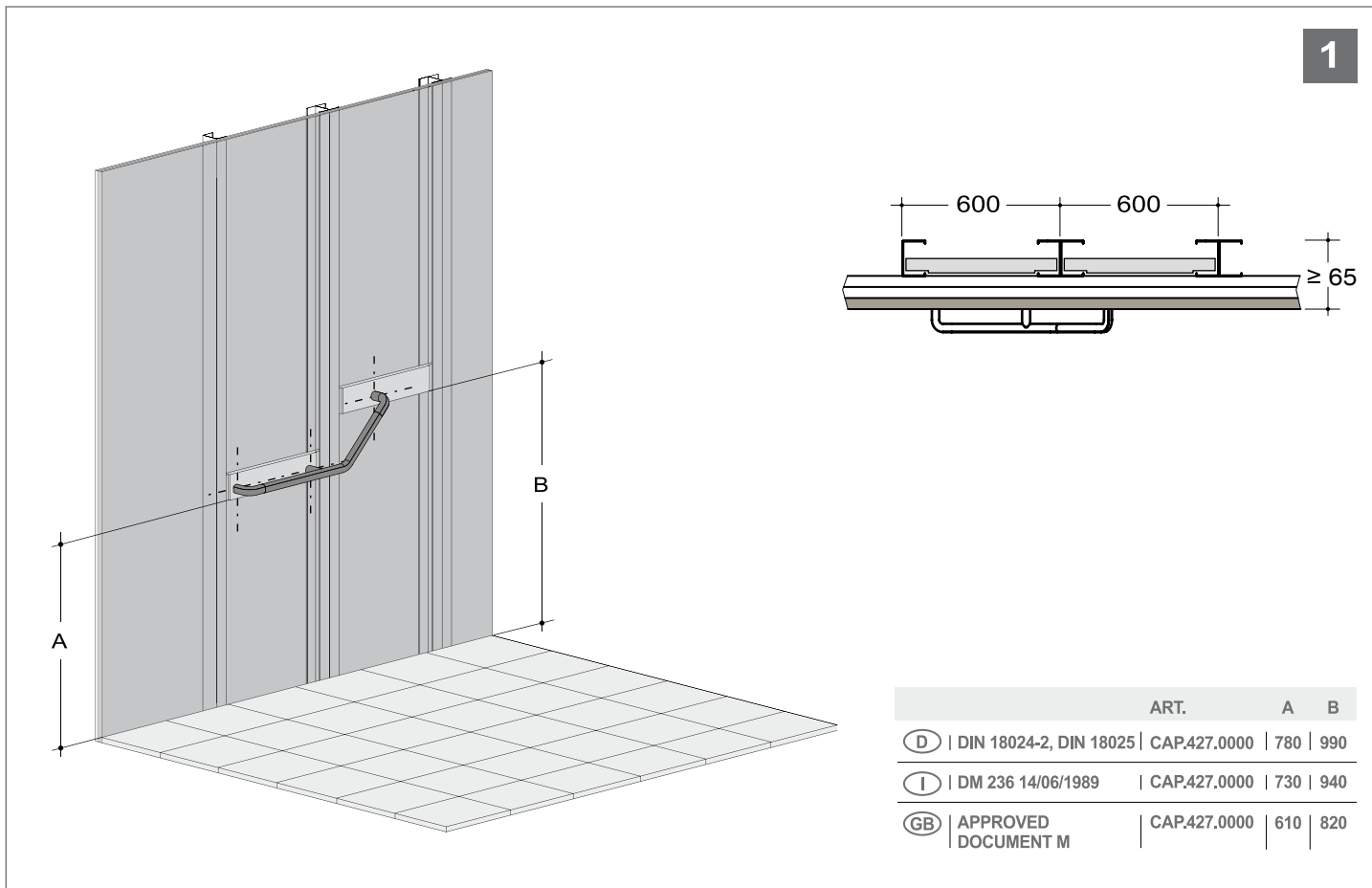
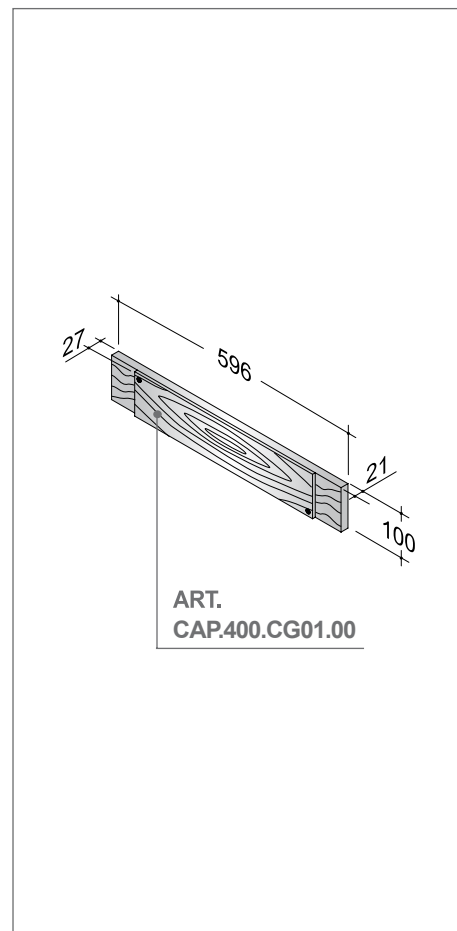
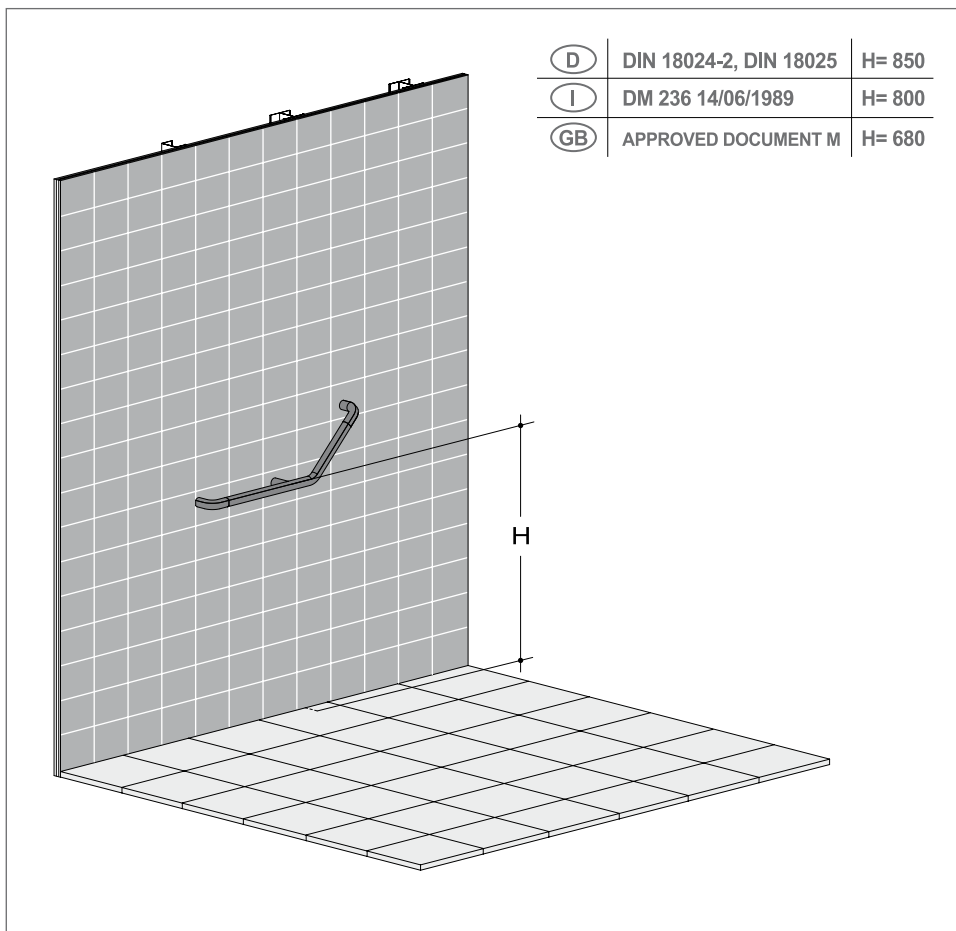
**ART. CAP.427.0000**

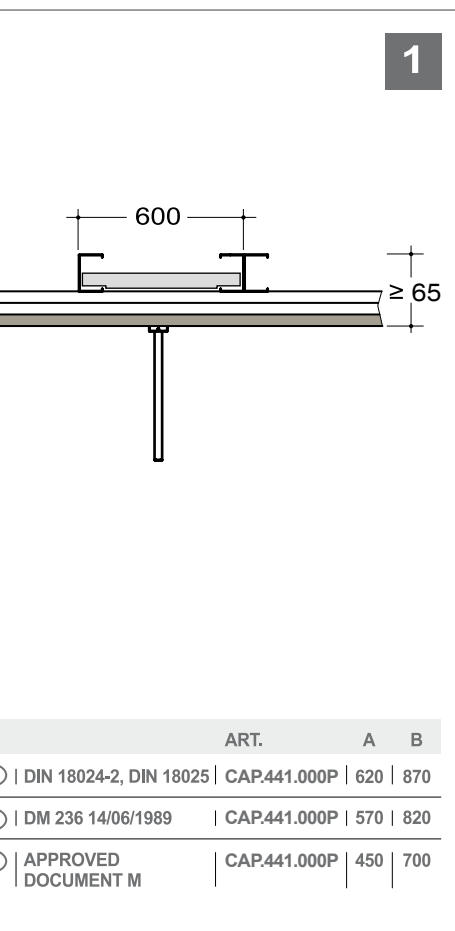
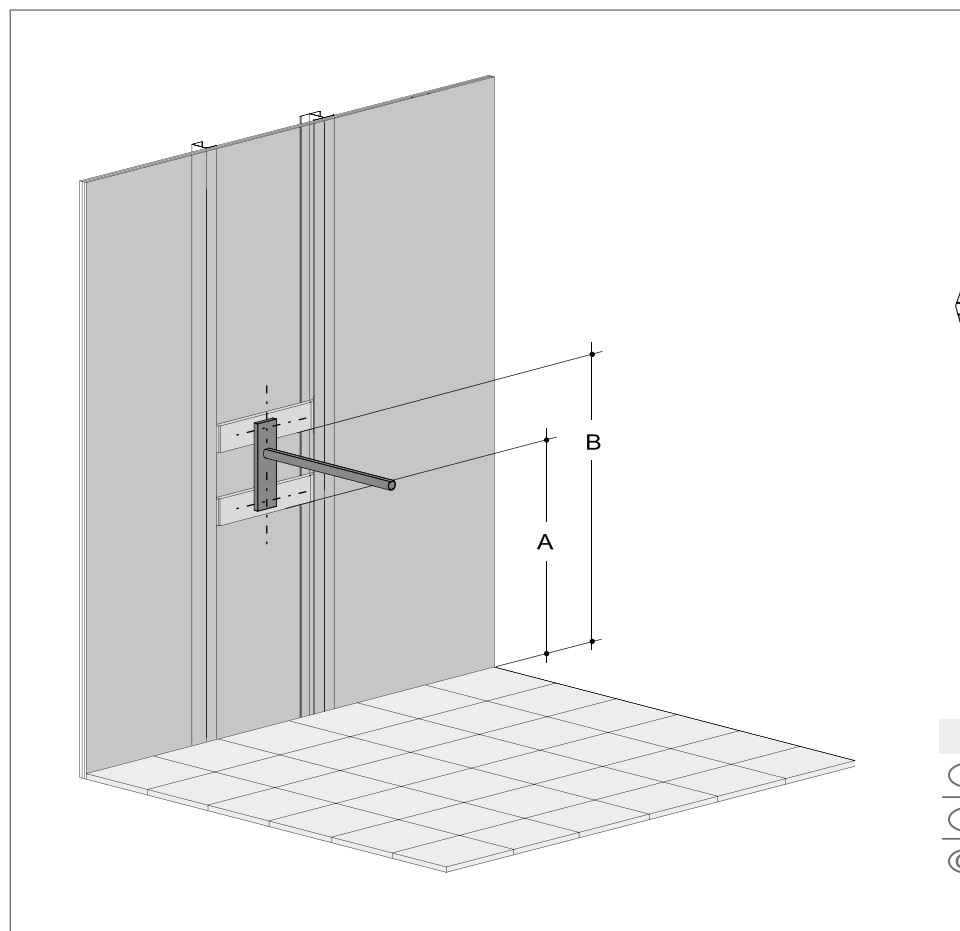
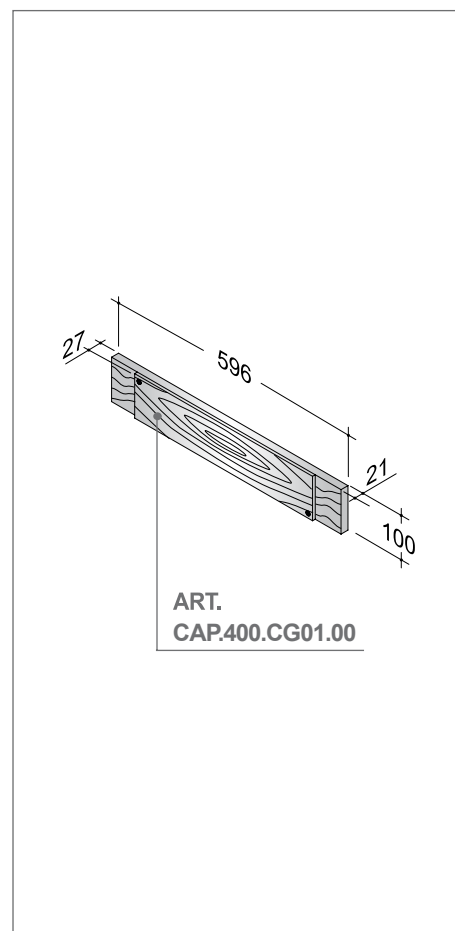
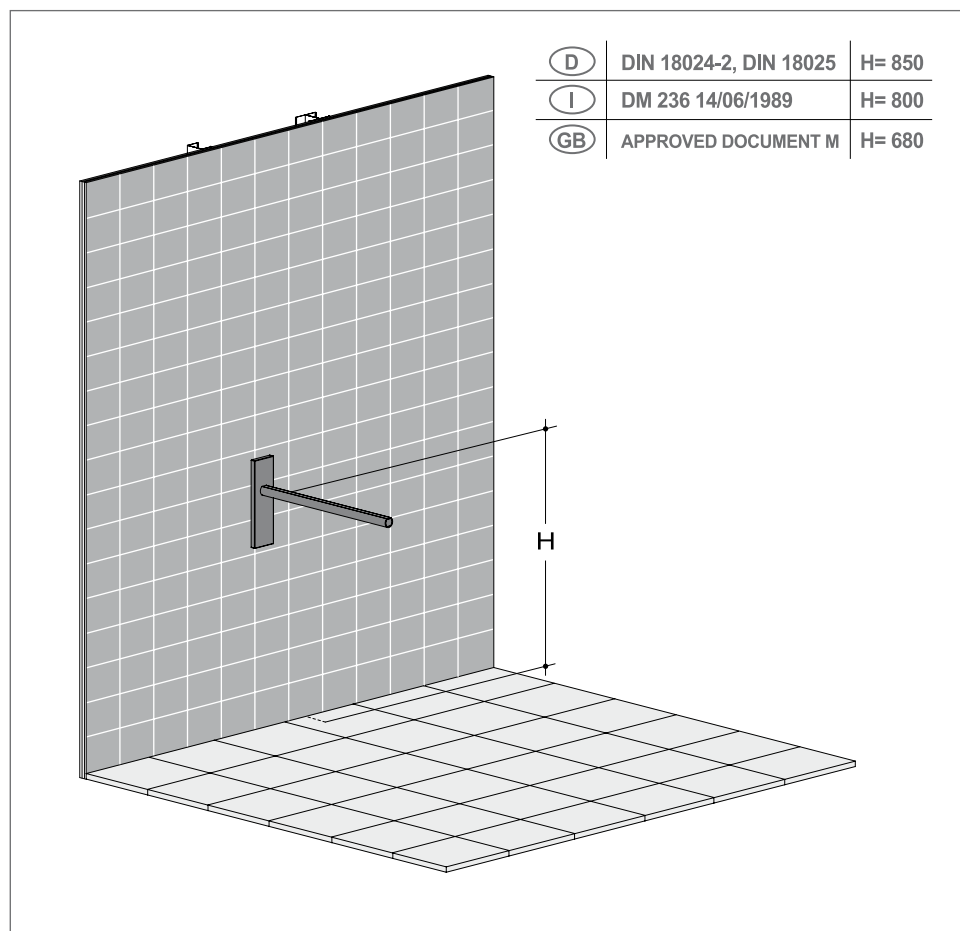
**PROGRAMMA CAP**
**ART. CAP.441.000P**

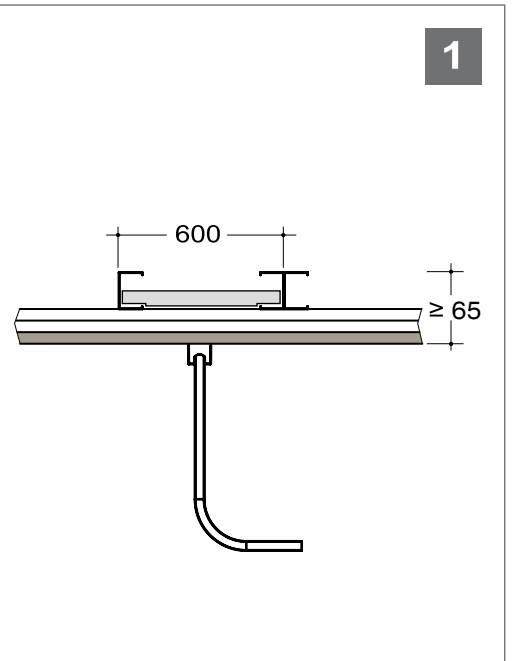
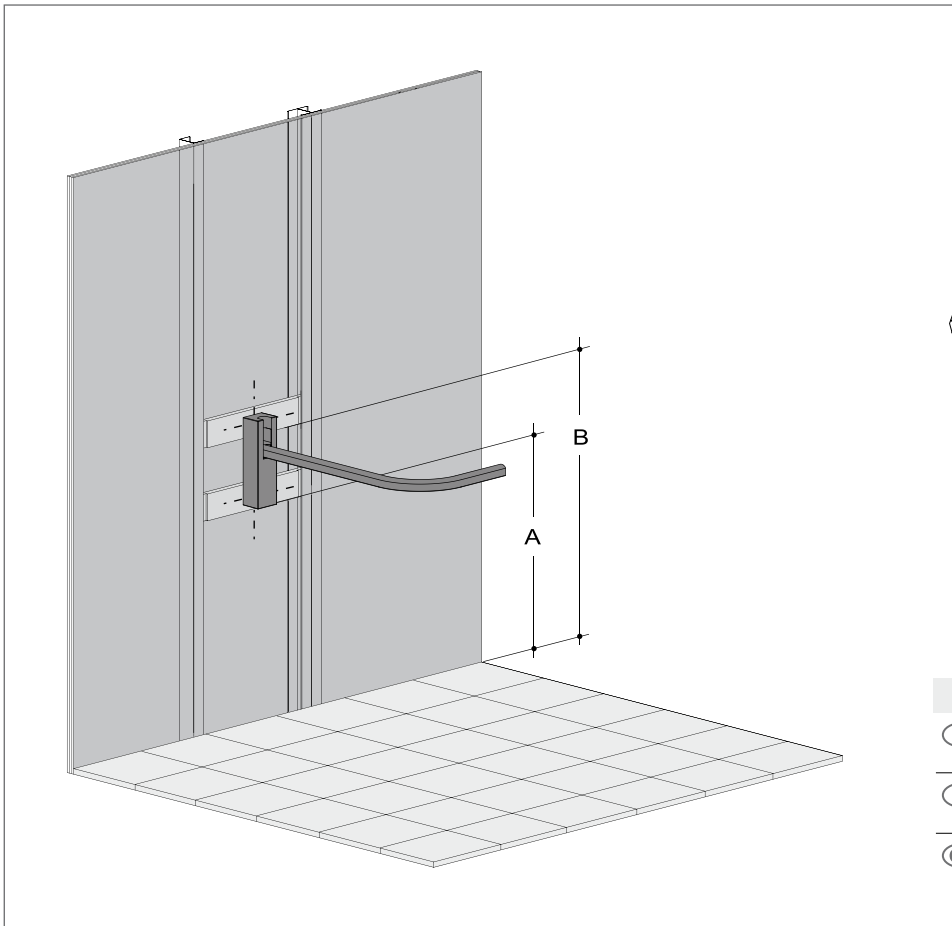
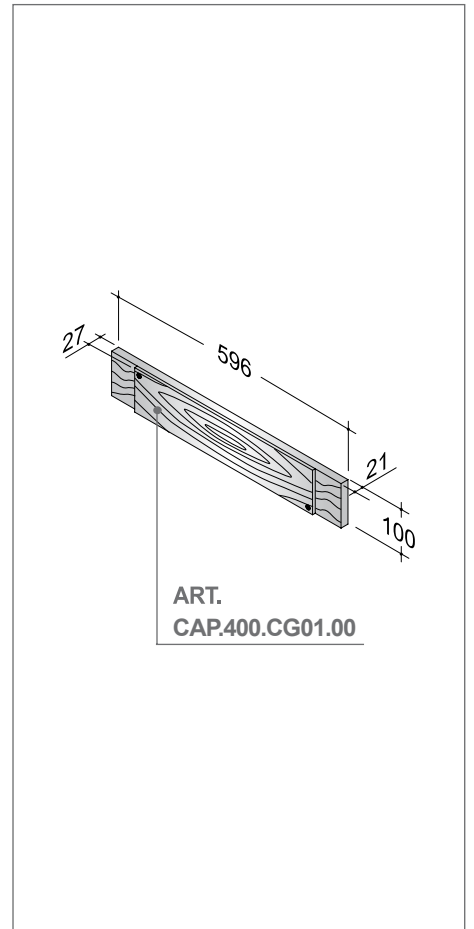
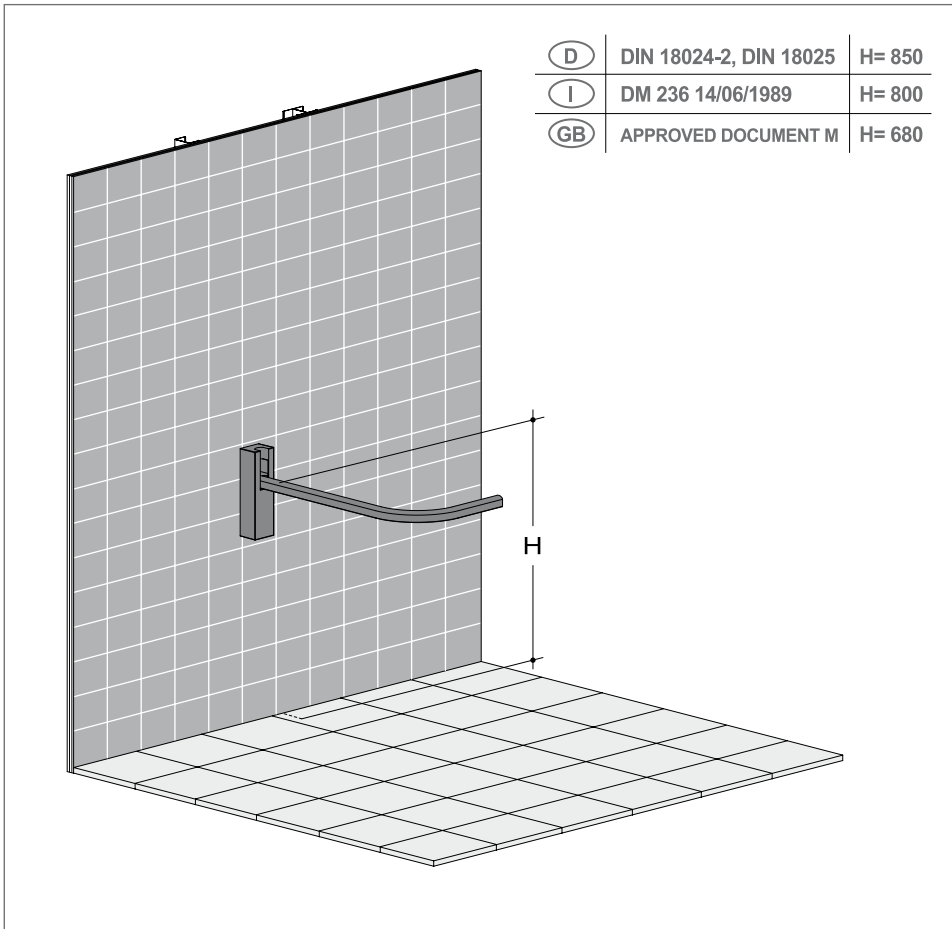
**PROGRAMMA CAP**
**ART. CAP.435.000R - CAP.435.000L**

	ART.	A	B
(D)	DIN 18024-2, DIN 18025   CAP.435.000R   CAP.435.000L	620	870
(I)	DM 236 14/06/1989   CAP.435.000R   CAP.435.000L	570	820
(GB)	APPROVED DOCUMENT M   CAP.435.000R   CAP.435.000L	450	700

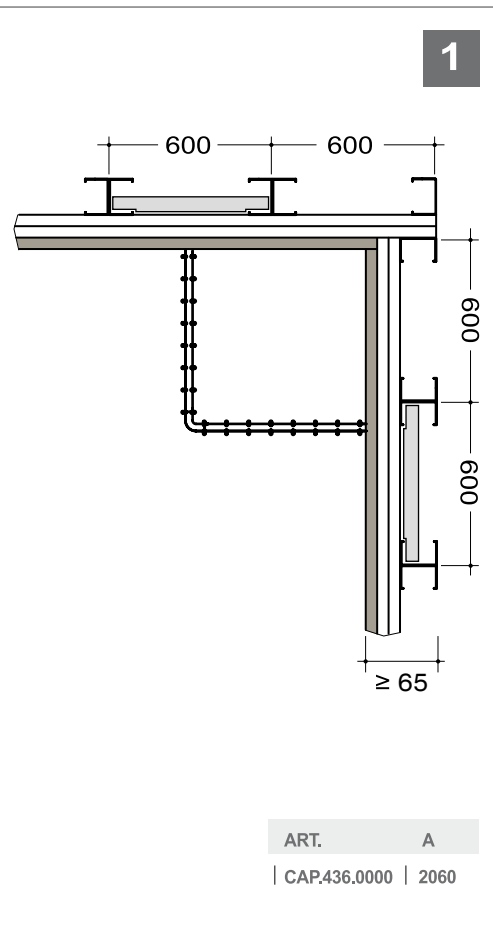
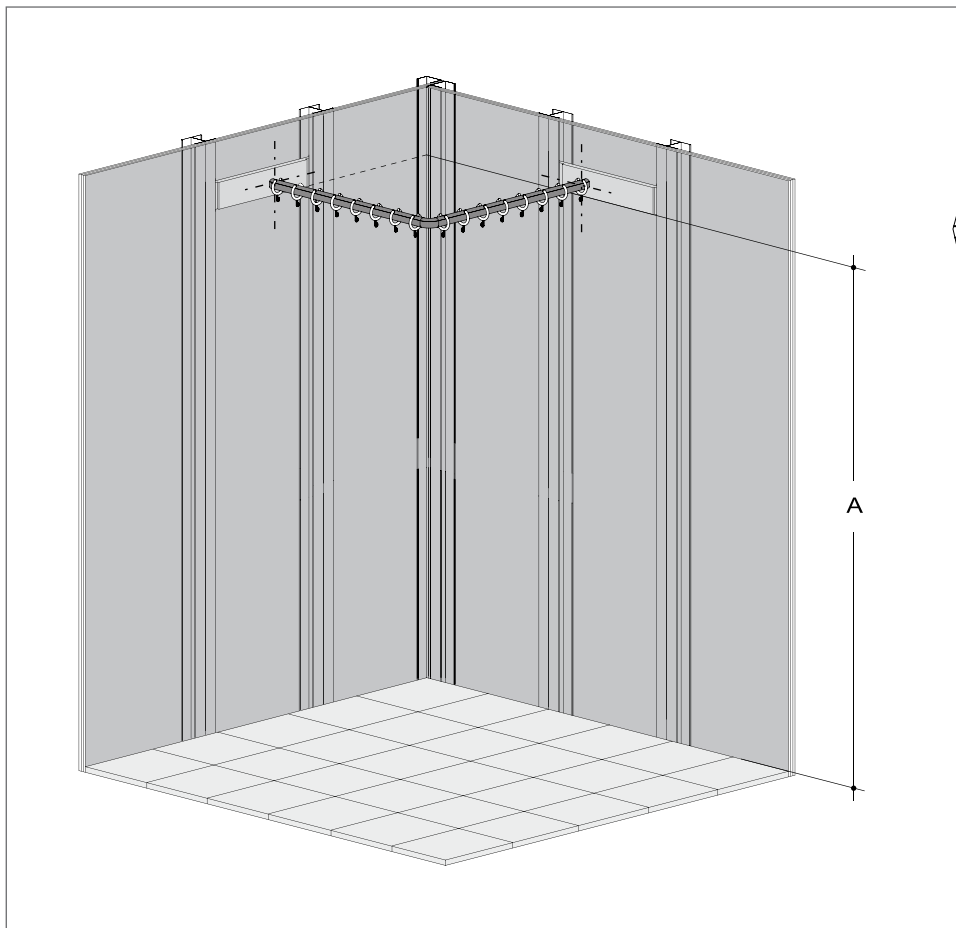
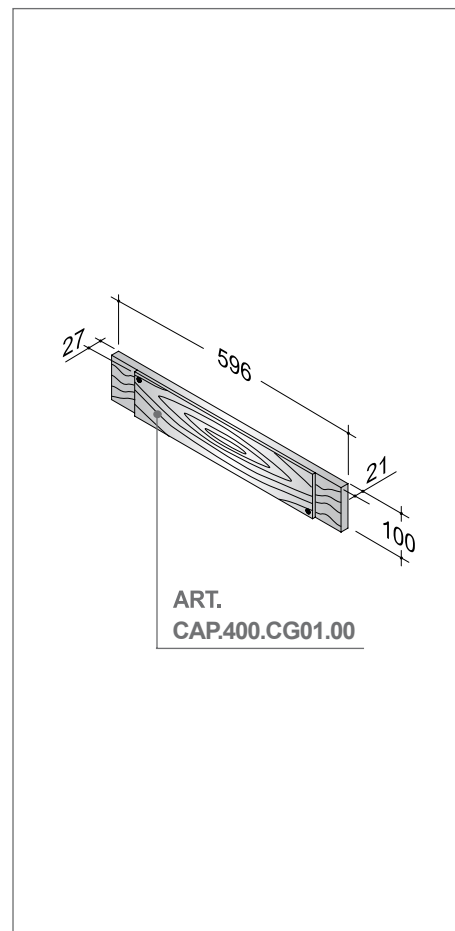
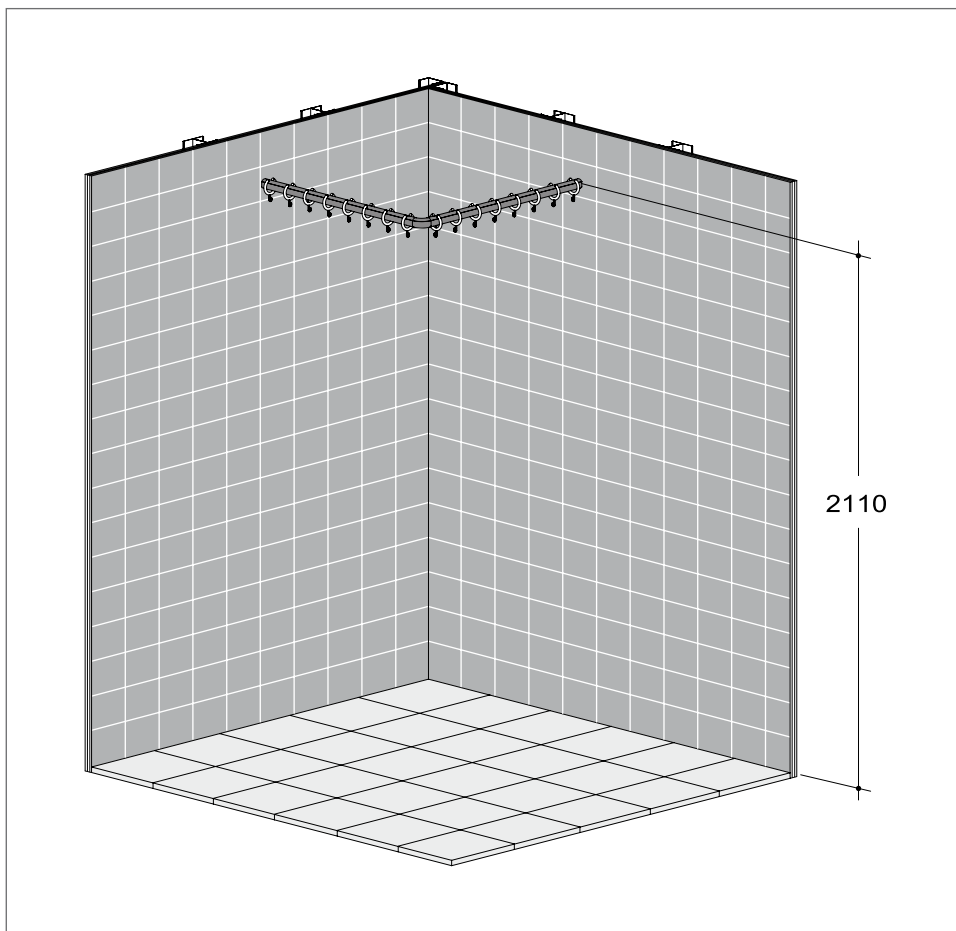
**PROGRAMMA CAP****ART. CAP.436.0000**

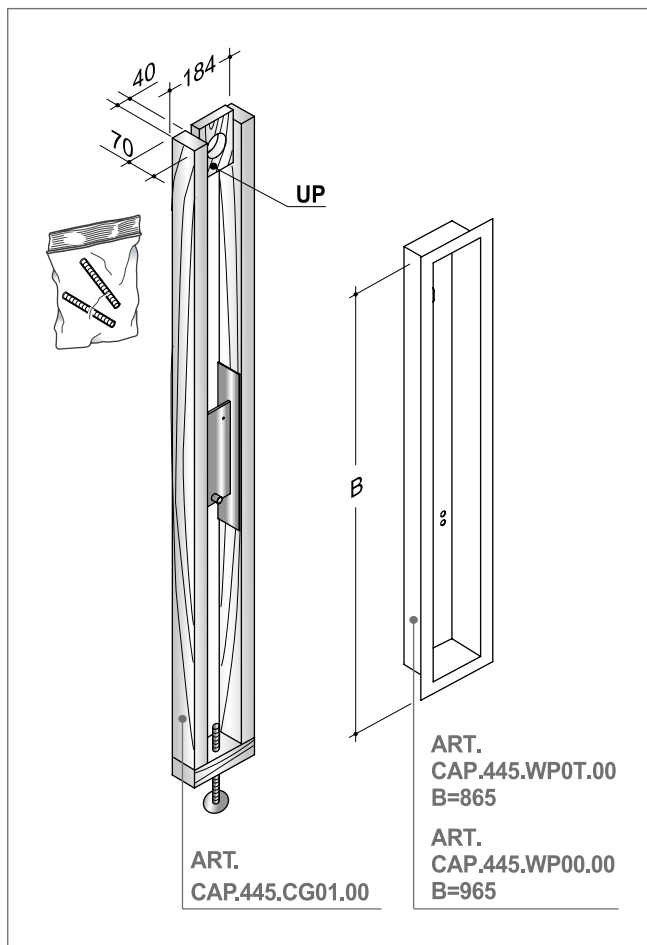
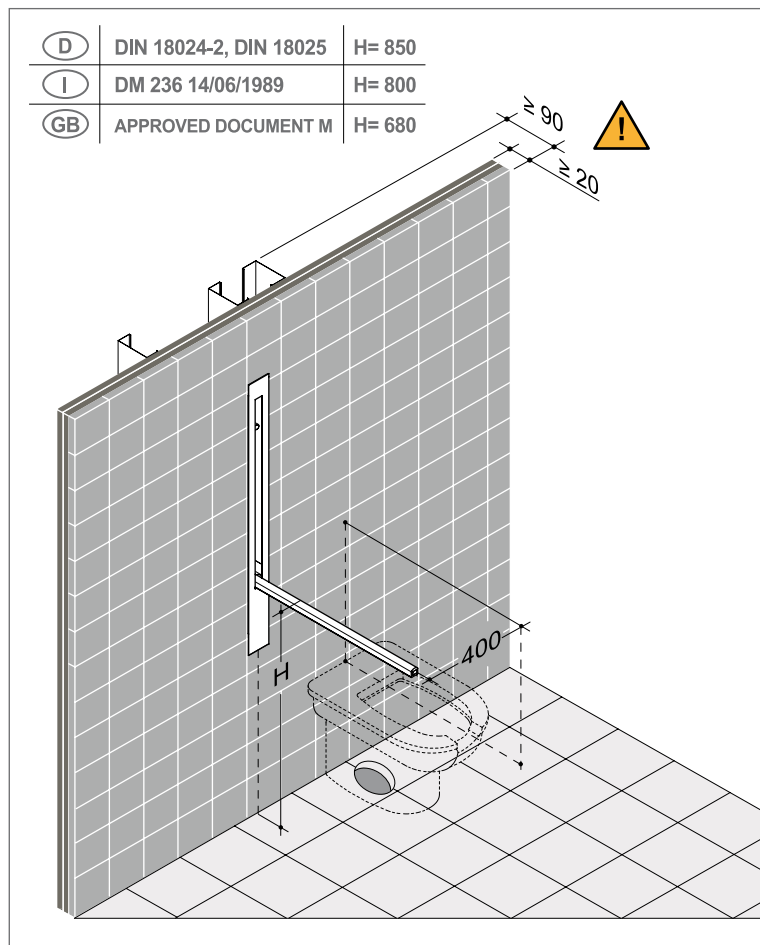
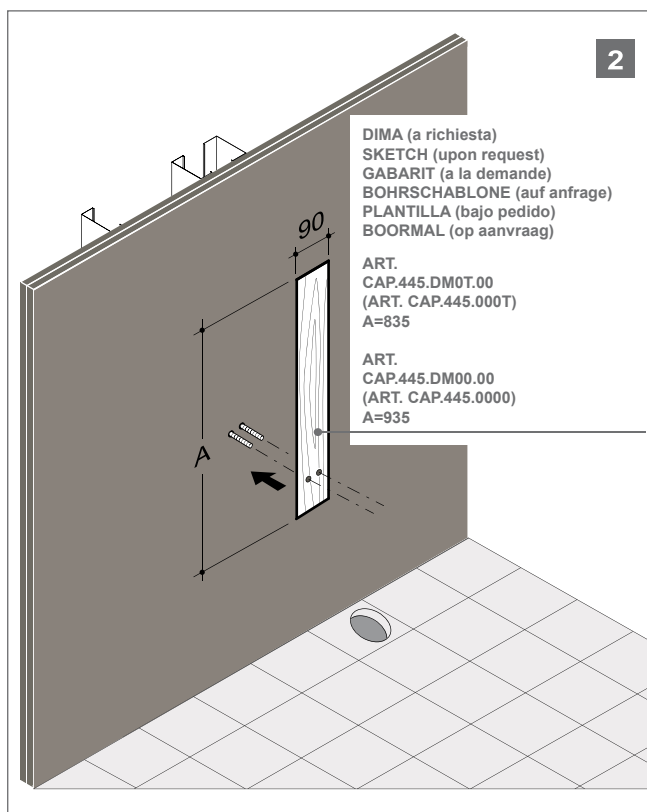
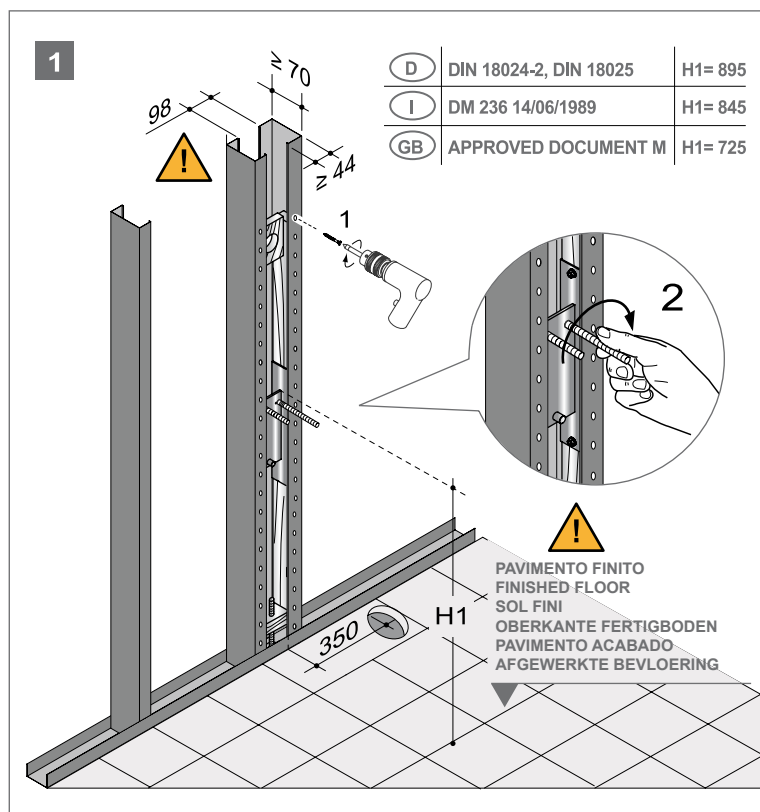
**ART. CAP.445.000T - CAP.445.0000**

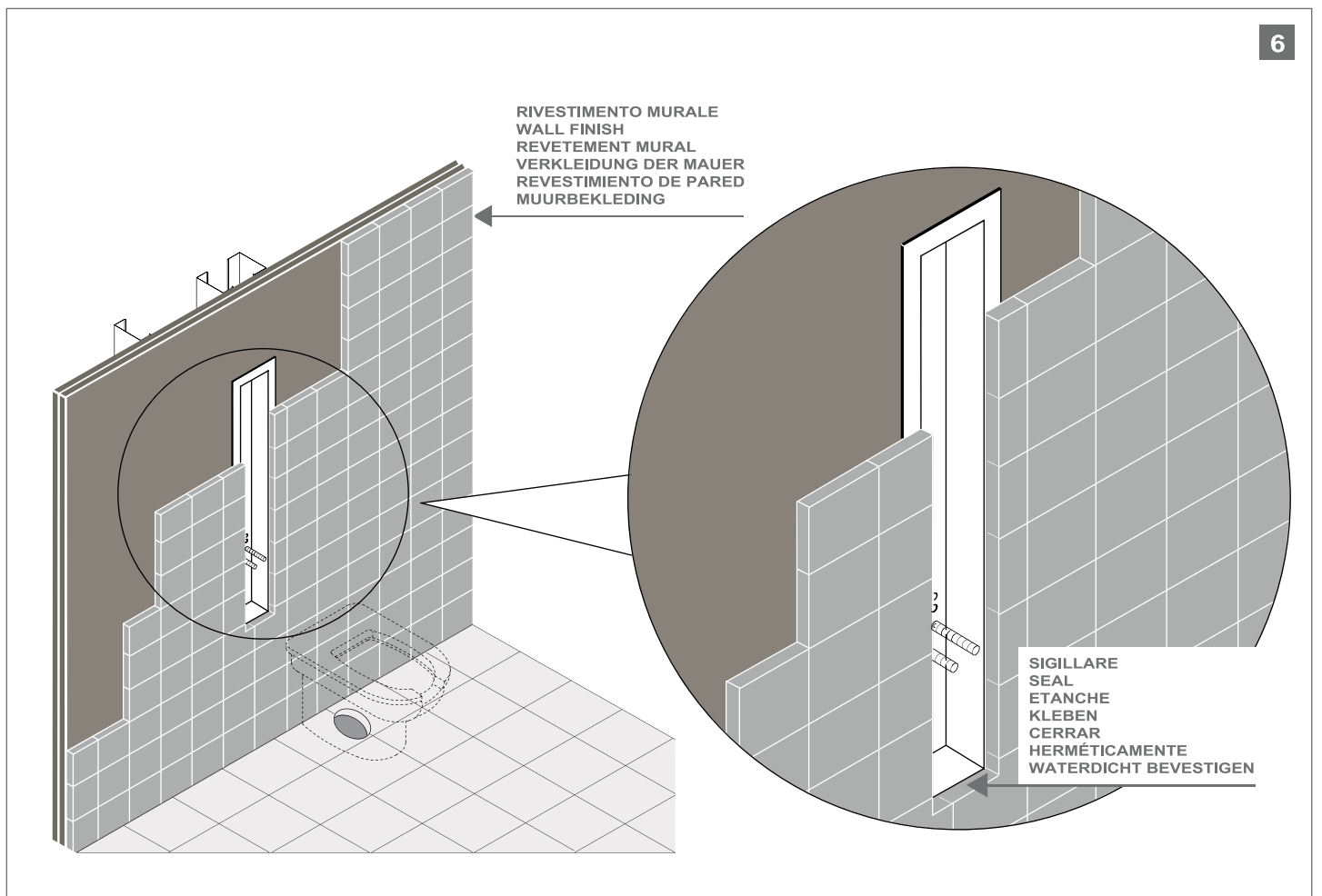
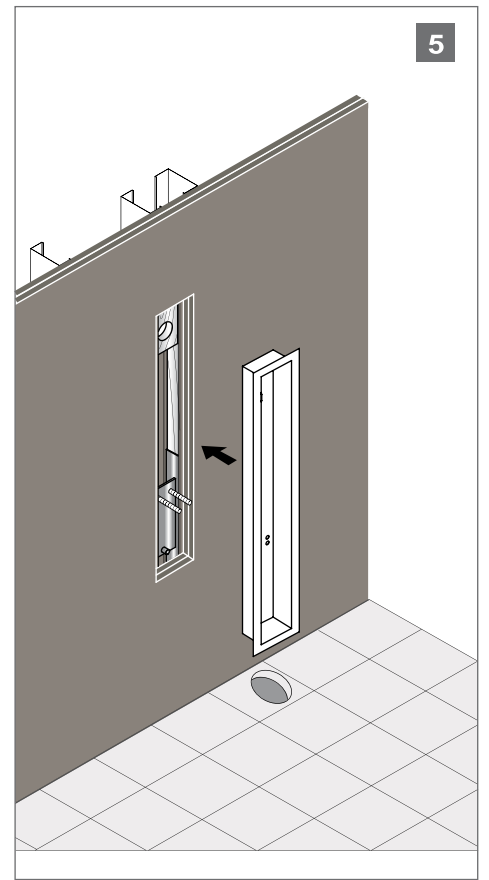
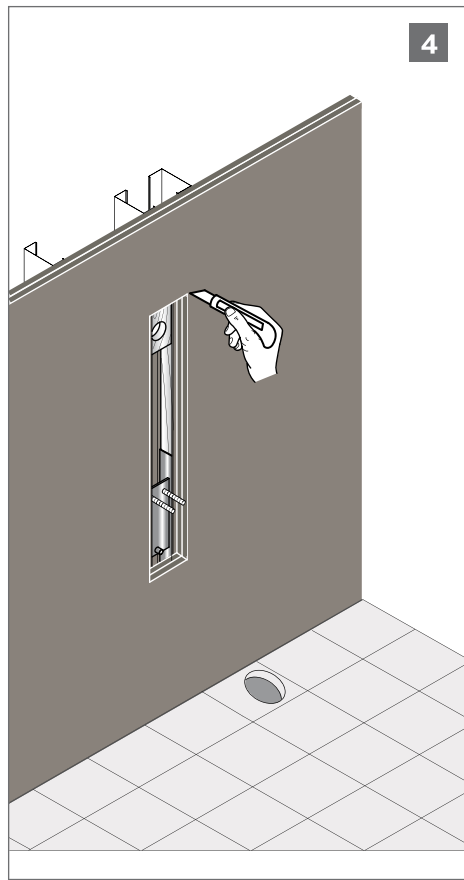
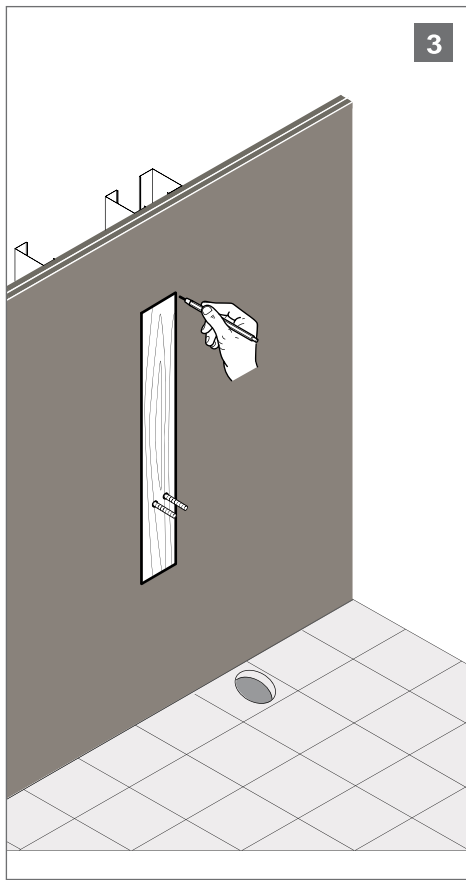
**PROCEDURA DI INSTALLAZIONE - INSTALLATION PROCEDURE - PROCEDURE D'INSTALLATION - INSTALLATIONSVERFAHREN - PROCEDIMIENTO DE INSTALACION - INSTALLATIEPROCEDURE**

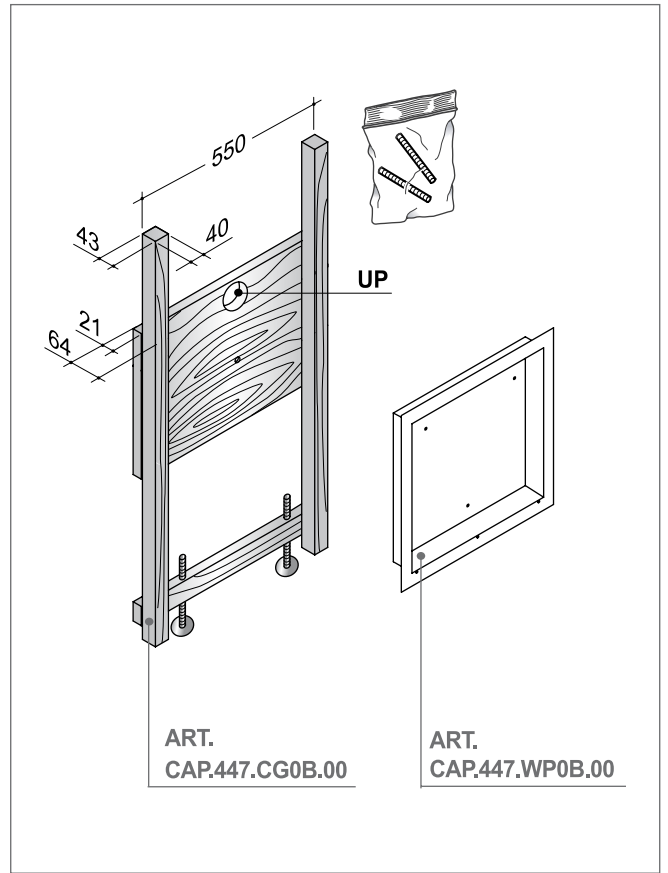
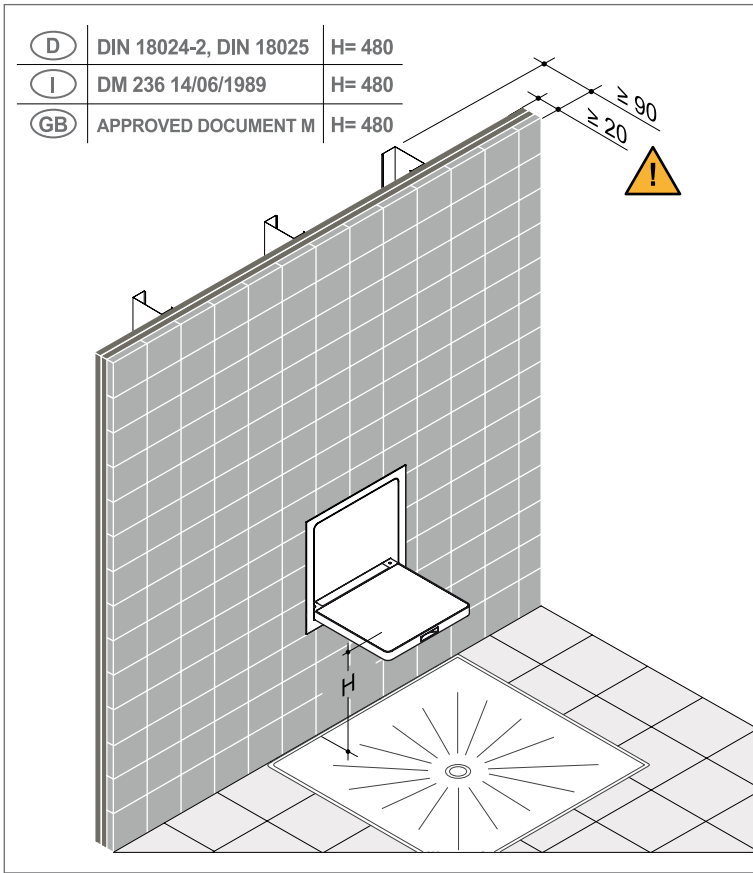
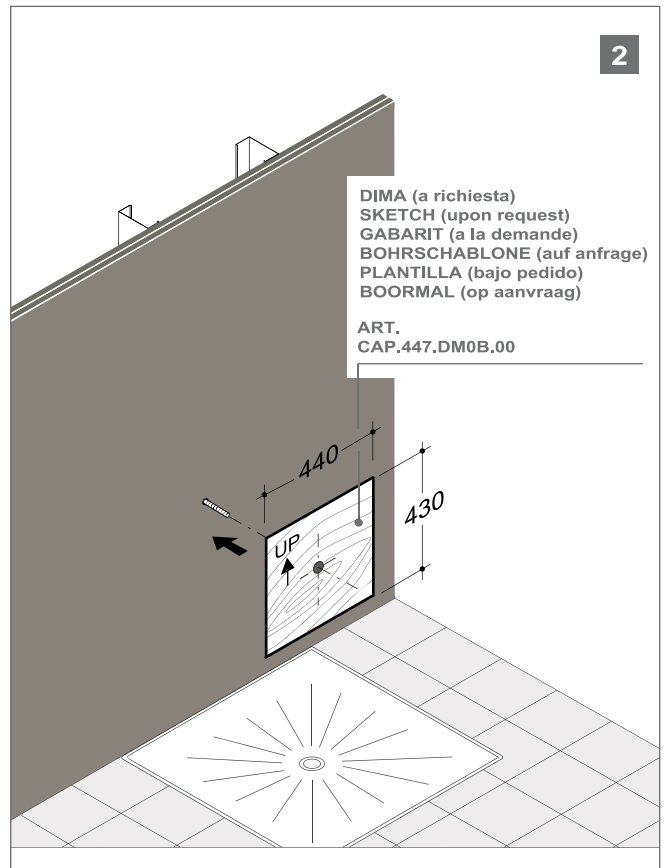
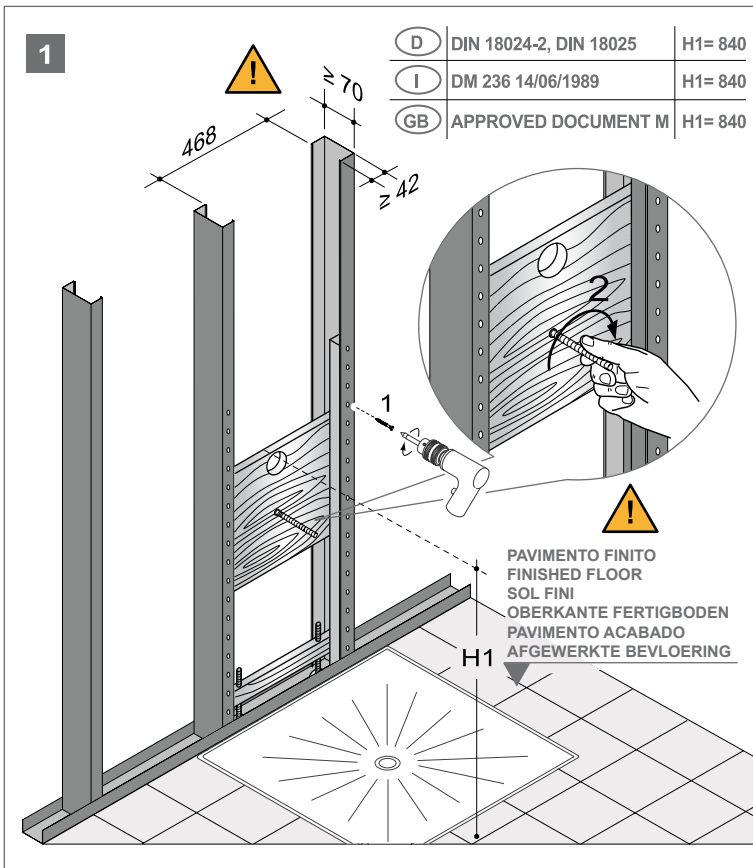

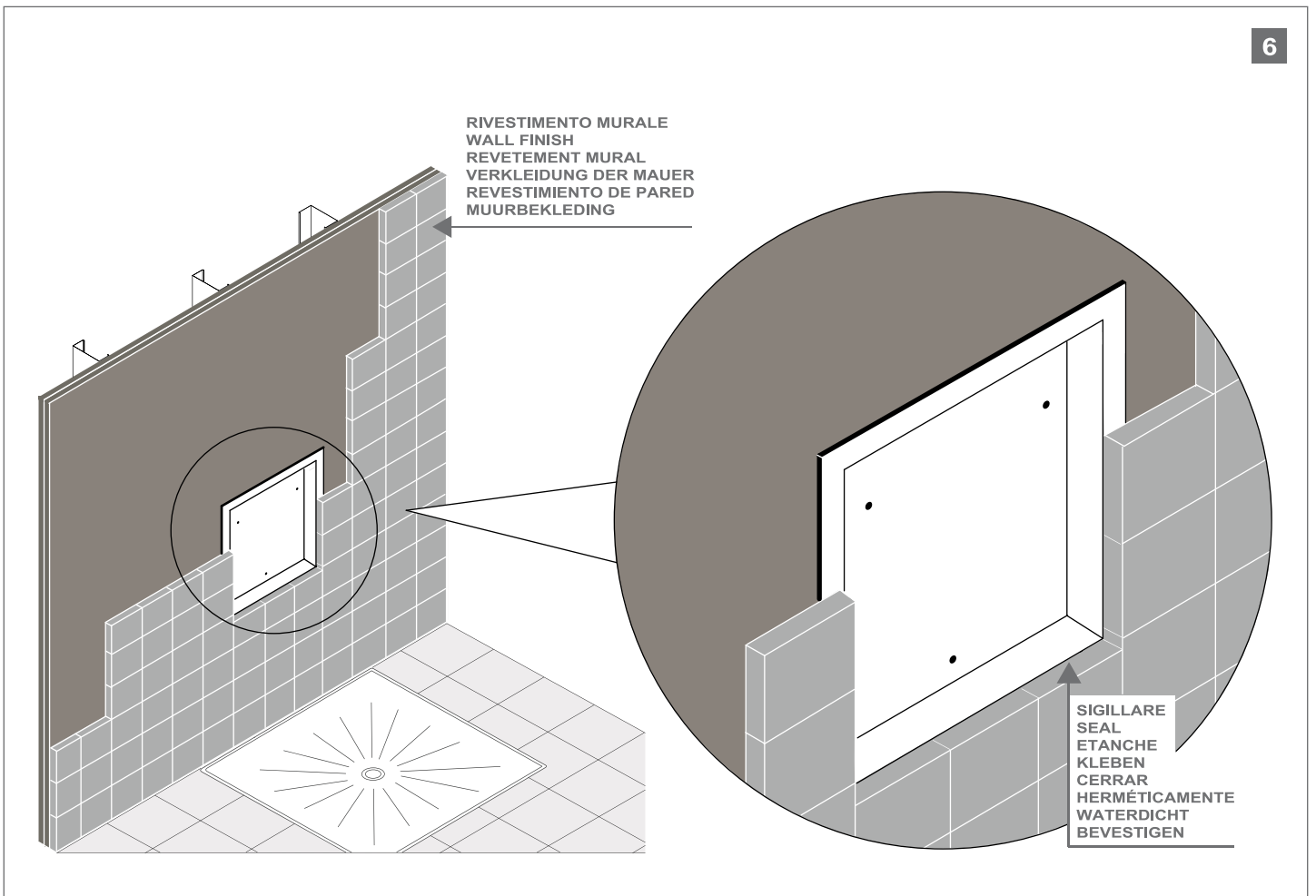
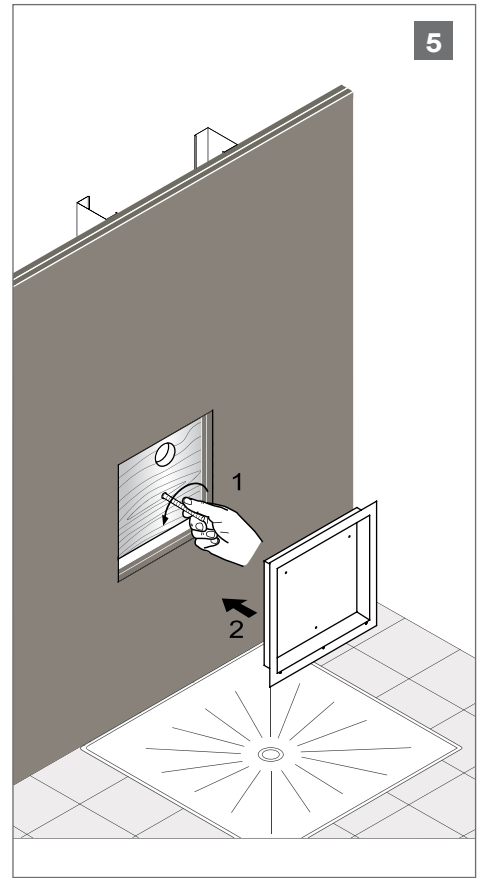
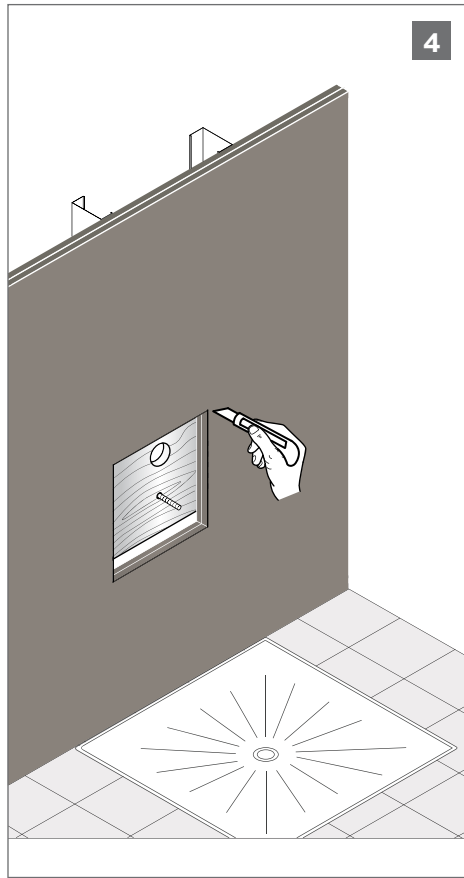
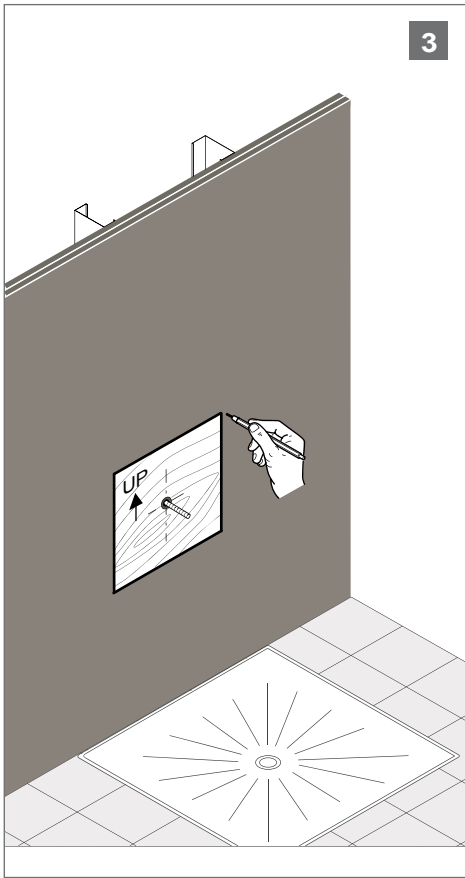
**PROGRAMMA CAP**
**ART. CAP.447.000B**

**PROCEDURA DI INSTALLAZIONE - INSTALLATION PROCEDURE - PROCEDURE D'INSTALLATION - INSTALLATIONSVERFAHREN - PROCEDIMIENTO DE INSTALACION - INSTALLATIEPROCEDURE**





ITALIANO

**ISTRUZIONI PER L'INSERIMENTO DEI TELAI  
NELLE PARETI IN MURATURA**

ENGLISH

**INSTRUCTIONS FOR MOUNTING FIXTURES  
IN BRICK WALLS**

FRANCAIS

**NOTICE D'INSTALLATION DES BATIS  
DANS LES PAROIS MAÇONNEES**

DEUTSCH

**MONTAGEANLEITUNG ZUR BEFESTIGUNG  
VON ELEMENTEN AN MASSIVWÄNDEN**

ESPAÑOL

**INSTRUCCIONES PARA INTRODUCIR  
LOS BASTIDORES EN LAS PAREDES DE MAMPOSTERÍA**

NEDERLANDS

**INSTRUCTIES VOOR DE PLAATSING VAN DE FRAMES  
IN GEMETSELDE WANDEN**

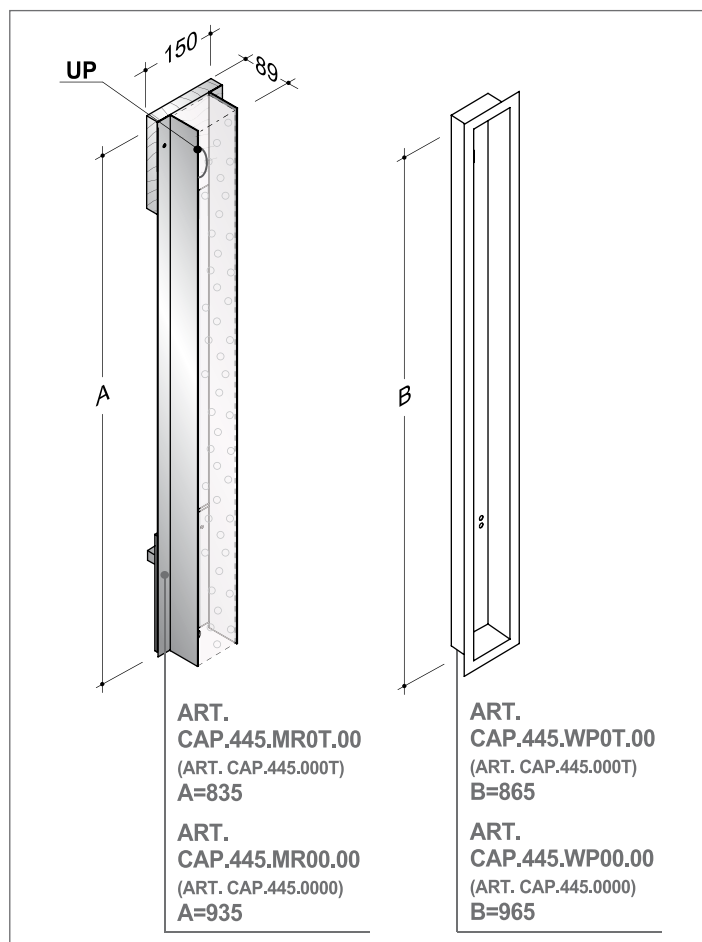
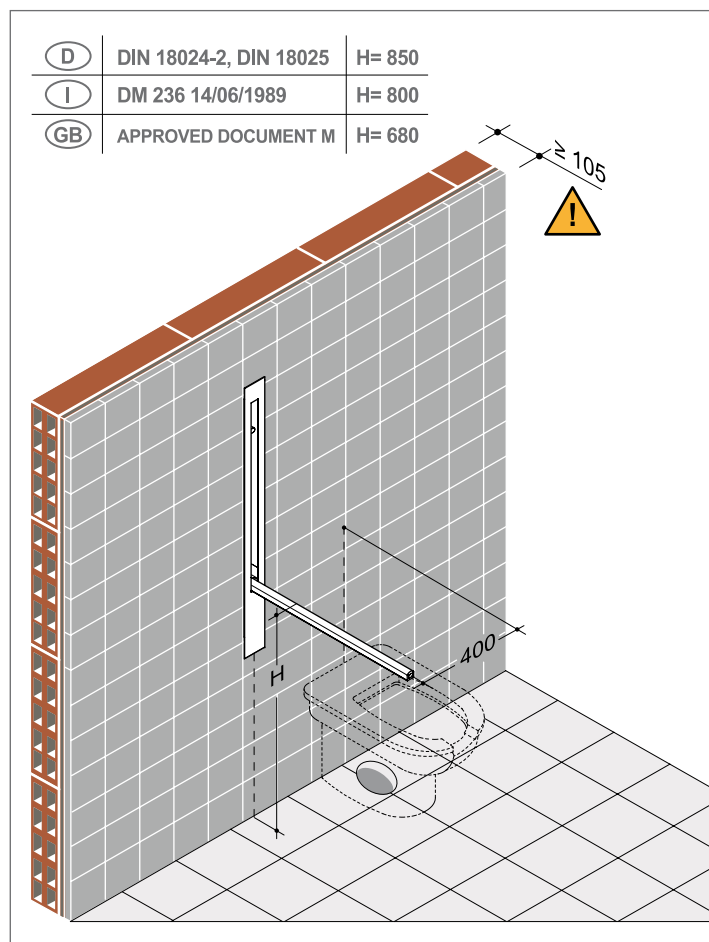
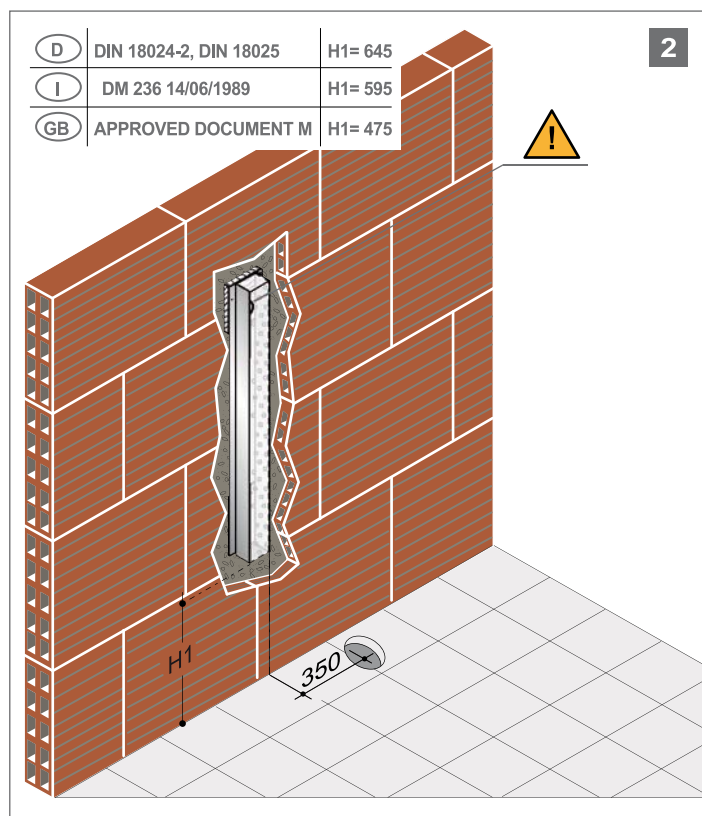
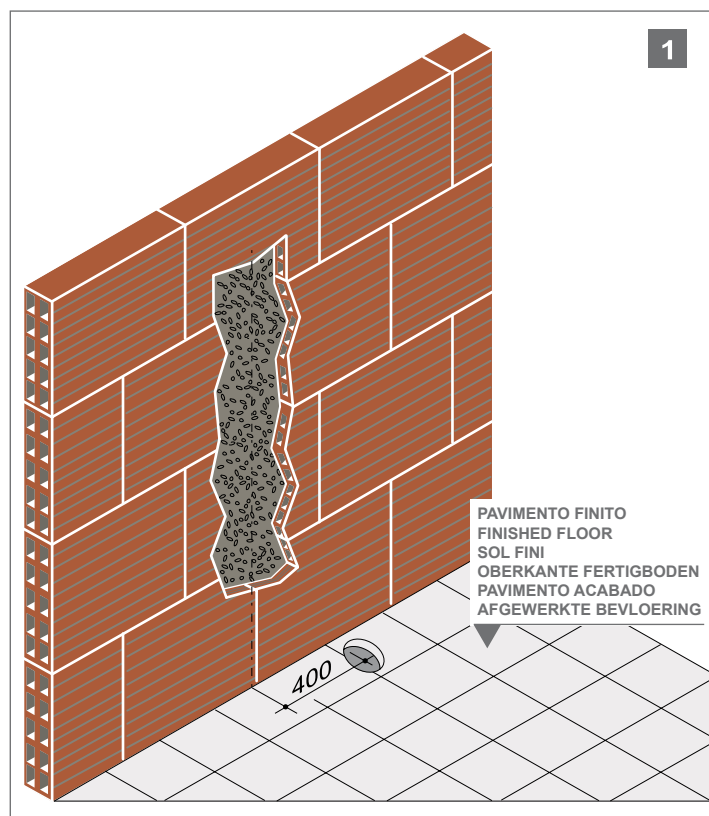
**ART. CAP.445.000T - CAP.445.0000**

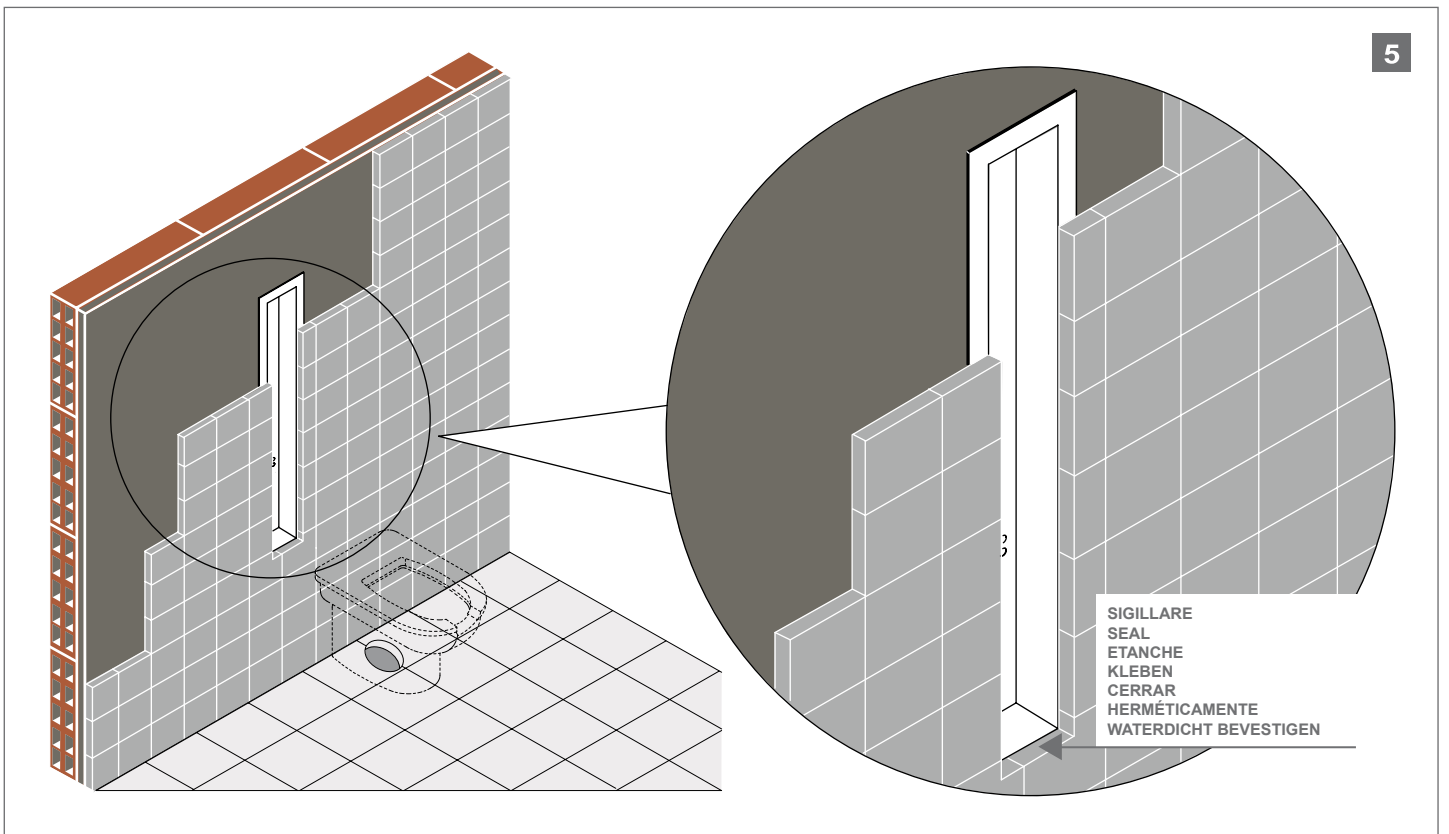
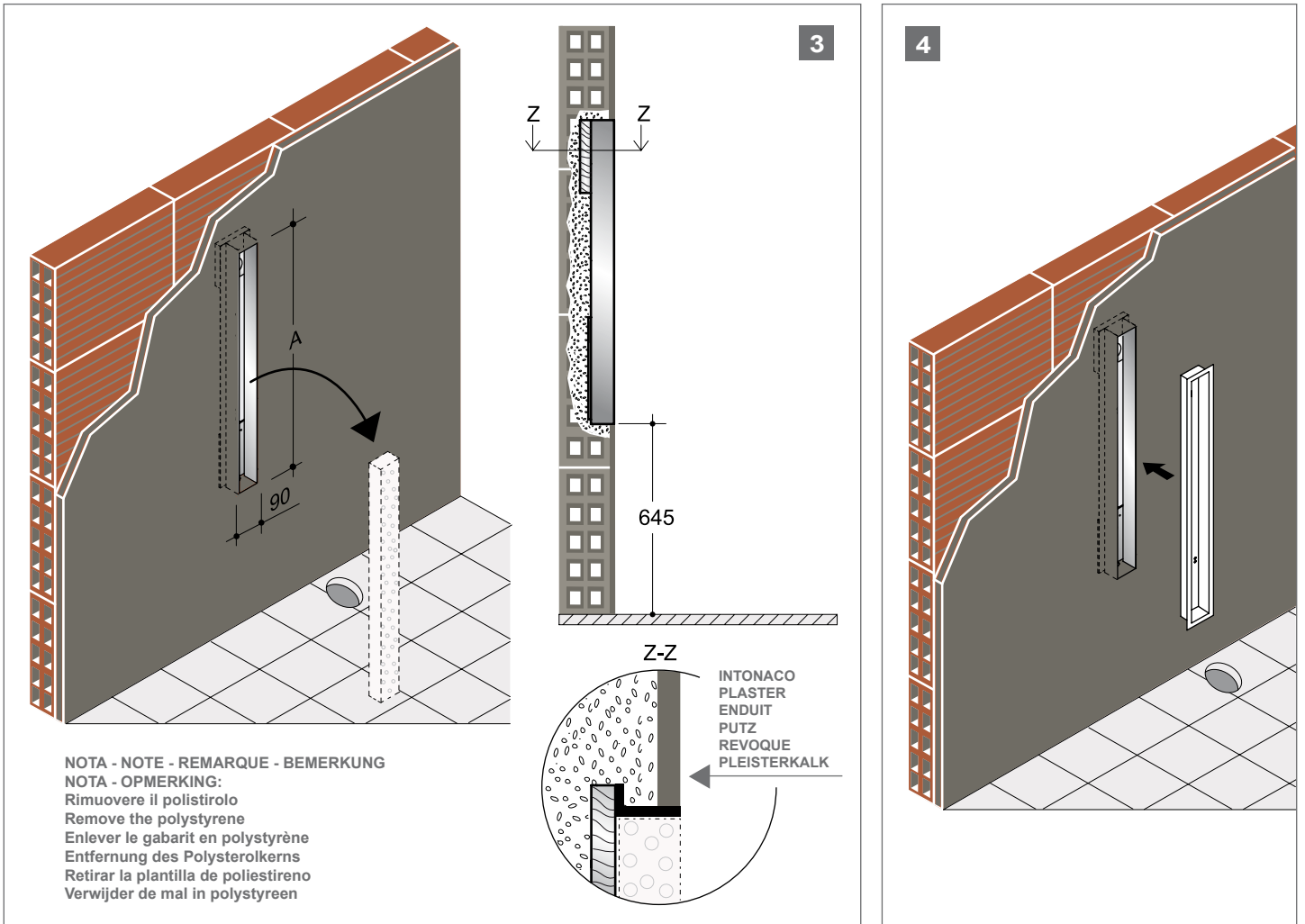
**PROCEDURA DI INSTALLAZIONE - INSTALLATION PROCEDURE - PROCEDURE D'INSTALLATION - INSTALLATIONSVERFAHREN - PROCEDIMIENTO DE INSTALACION - INSTALLATIEPROCEDURE**

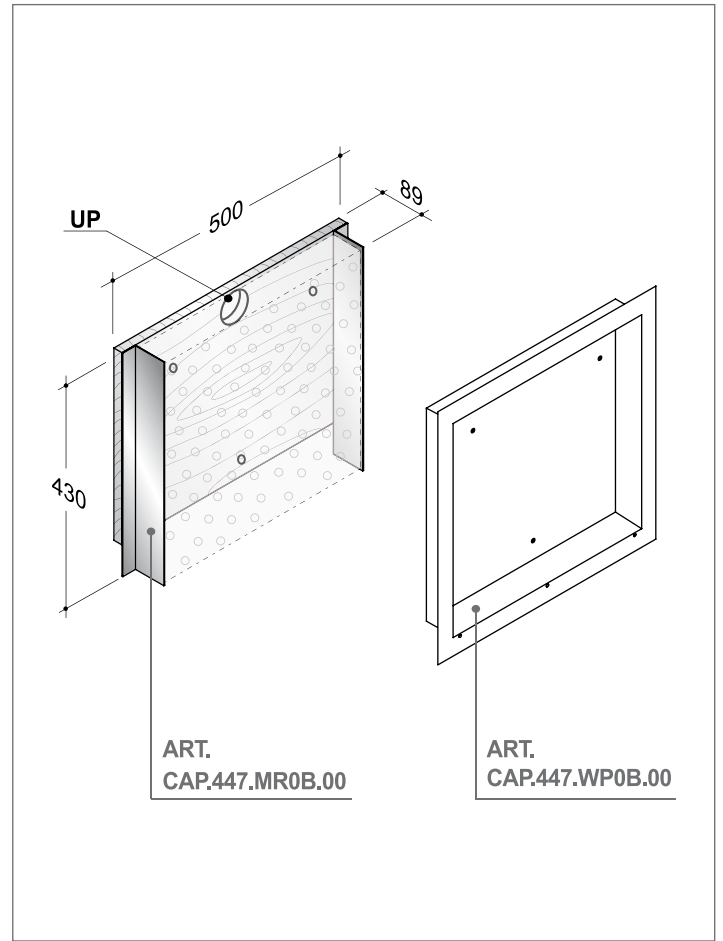
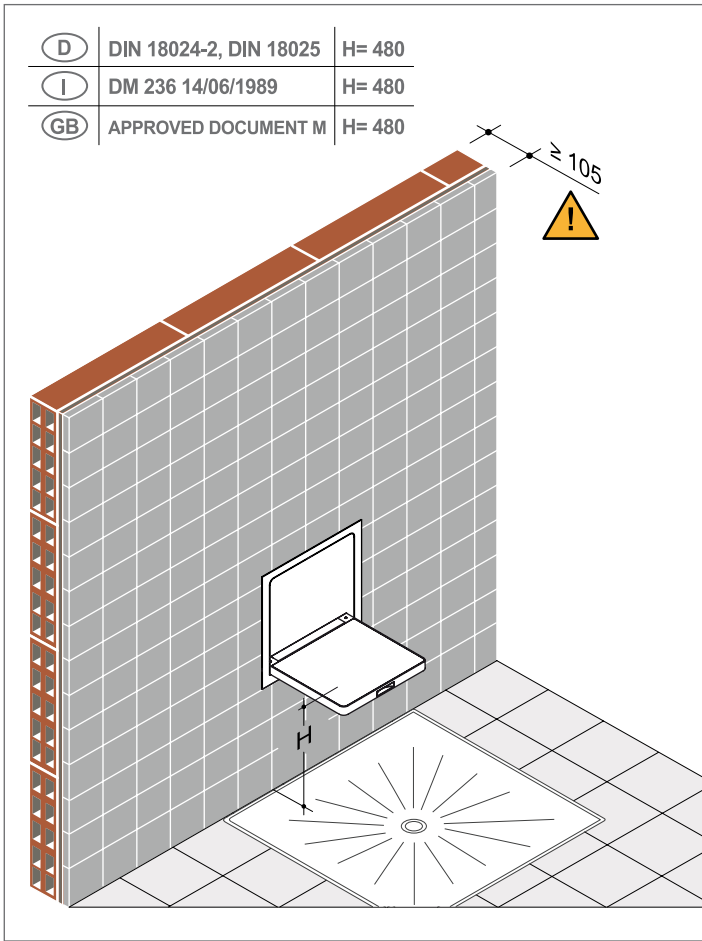
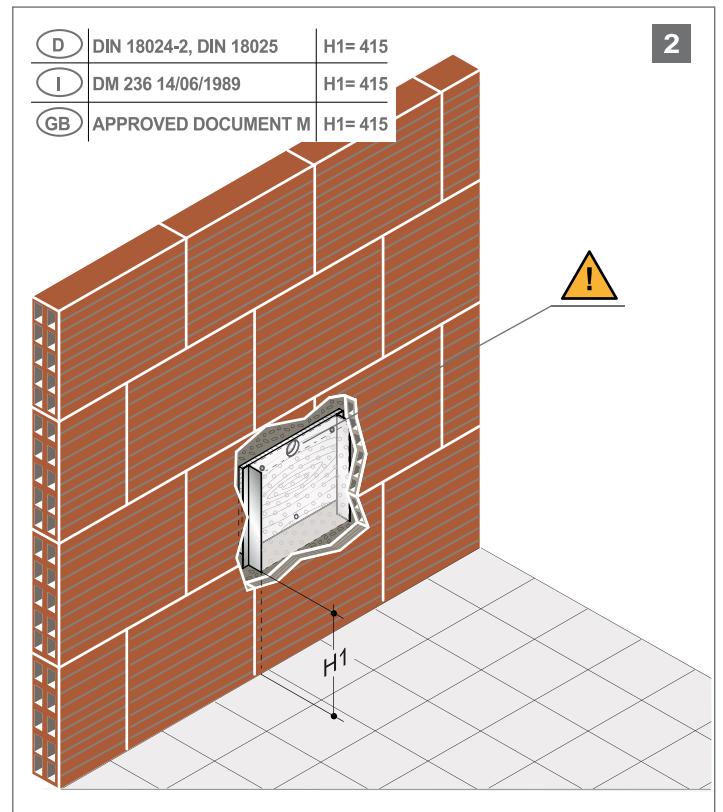
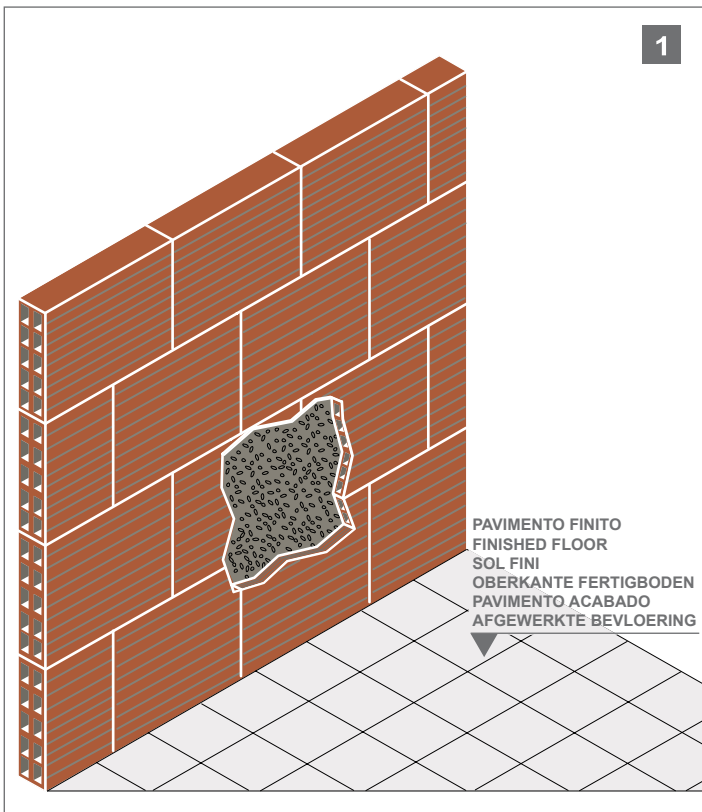
**PROGRAMMA CAP**

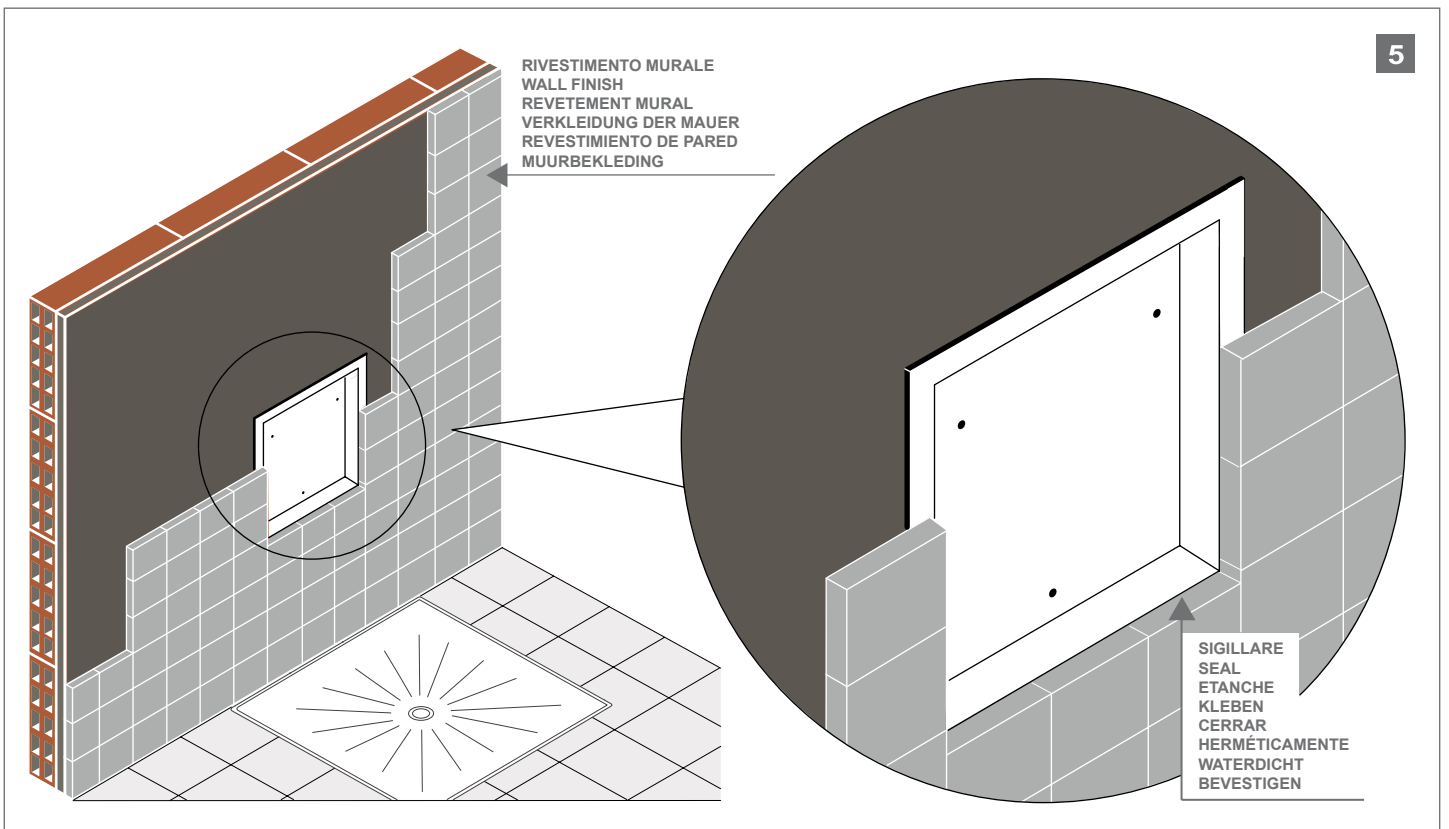
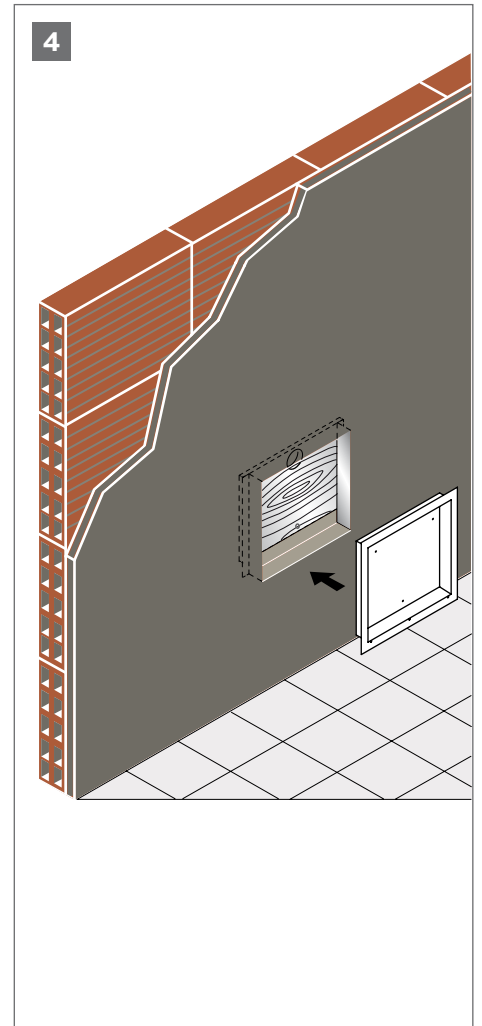
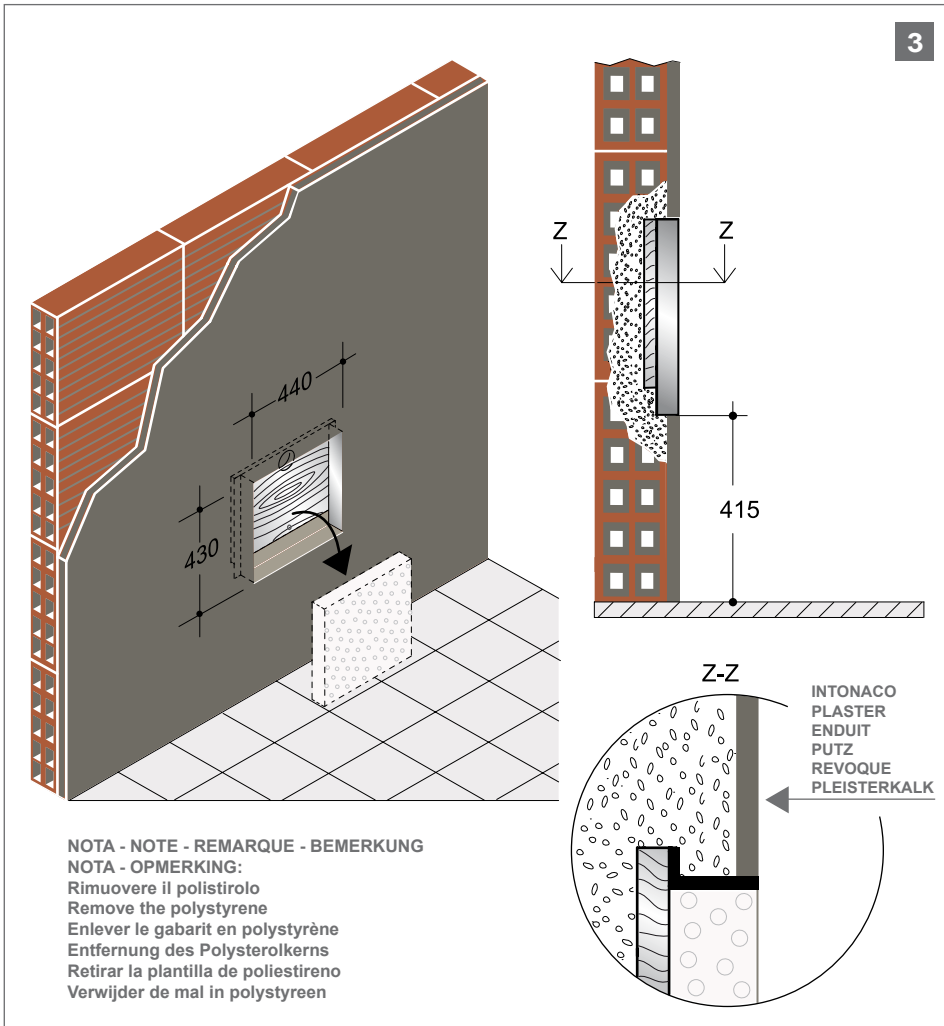
**PROGRAMMA CAP**
**ART. CAP.447.000B**

**PROCEDURA DI INSTALLAZIONE - INSTALLATION PROCEDURE - PROCEDURE D'INSTALLATION - INSTALLATIONSVERFAHREN - PROCEDIMIENTO DE INSTALACION - INSTALLATIEPROCEDURE**



**INDICE - INDEX - INDEX - INDEX - INDICE - INDEX**

ART.	PAG.	ART.	PAG.
CAP.400.CG01.00	16	CAP.483.00DL. ..	22
CAP.407.000L. ..	24	CAP.483.00DR. ..	22
CAP.407.000R. ..	24	CAP.483.00PL. ..	23
CAP.422.0000. ..	12	CAP.483.00PR. ..	23
CAP.422.000L. ..	12	CAP.483.0BDL. ..	23
CAP.422.000M. ..	12	CAP.483.0BDR. ..	23
CAP.422.00LA. ..	12	CAP.483.0BPL. ..	24
CAP.423.000B. ..	13	CAP.483.0BPR. ..	23
CAP.423.00BL. ..	13	CAP.486.000L. ..	26
CAP.424.0000. ..	12	CAP.486.000R. ..	26
CAP.424.000L. ..	12	CAP.487.0000. ..	13
CAP.424.00LA. ..	12	CAP.487.000A. ..	13
CAP.427.0000. ..	14	CAP.487.000B. ..	13
CAP.429.0000. ..	25	CAP.487.000C. ..	13
CAP.429.000A. ..	25	CAP.487.000R. ..	27
CAP.429.000B. ..	25	CAP.488.0000. ..	27
CAP.429.000C. ..	25	CAP.490.0000. ..	22
CAP.429.000D. ..	25	CAP.492.000L. ..	26
CAP.429.000E. ..	25	CAP.492.000R. ..	26
CAP.433.0000. ..	12	CAP.498.0000. ..	25
CAP.435.000L. ..	24	CAP.562.0000. ..	27
CAP.435.000R. ..	24	CAP.0VM.CG01.00	18
CAP.436.0000. ..	25	CAP.0VM.MR01.00	18
CAP.436.000B. ..	25	CAP.4PR.0000. ..	24
CAP.436.00BA. ..	25	4CN.0SC.000B. ..	28
CAP.436.00BB. ..	25	4CN.0SC.000C. ..	28
CAP.436.00BC. ..	25	CAP.0SC.00AE. ..	28
CAP.436.00BD. ..	25	4CN.0SC.00BE. ..	28
CAP.437.0000. ..	25	4CN.0SC.00CE. ..	28
CAP.437.000A. ..	25	4CN.0SC.00DE. ..	28
CAP.440.0000. ..	13	4CN.0SC.00EE. ..	28
CAP.440.000A. ..	13	4CN.0AN.0002. ..	27
CAP.440.000B. ..	13	4CN.407.0000. ..	27
CAP.440.000C. ..	13	4CN.486.00SR. ..	27
CAP.440.000Z. ..	13		
CAP.441.000P. ..	14		
CAP.442.0000. ..	13		
CAP.442.000L. ..	13		
CAP.442.000M. ..	13		
CAP.443.000B. ..	12		
CAP.443.00BL. ..	12		
CAP.445.0000. ..	14		
CAP.445.000T. ..	14		
CAP.445.CG01.00	16		
CAP.445.DM00.00	16		
CAP.445.DM0T.00	16		
CAP.445.MR00.00	17		
CAP.445.MR0T.00	17		
CAP.445.WP00.00	18		
CAP.445.WP0T.00	18		
CAP.447.000B. ..	14		
CAP.447.CG0B.00	17		
CAP.447.DM0B.00	17		
CAP.447.MR0B.00	17		
CAP.447.WP0B.00	18		
CAP.481.000L. ..	26		
CAP.481.000R. ..	26		
CAP.483.00BL. ..	22		
CAP.483.00BR. ..	22		



PBA S.p.A.  
Via Enrico Fermi, 1 - I-36056 Tezze sul Brenta (VI)  
Tel. +39 0424 5451 - Fax +39 0424 545222  
e-mail: [info@pba.it](mailto:info@pba.it) - [www.pba.it](http://www.pba.it)

PBA Deutschland GmbH  
Raiffeisenstraße, 4a - D-83607 Holzkirchen  
Tel. +49 8024 608140 - Fax +49 8024 6081420  
e-mail: [info@de.pba.it](mailto:info@de.pba.it) - [www.pba.it](http://www.pba.it)