

LD71



Miniature Adjustable Low Glare LED Downlight

Data sheet - Page 1

LD71 is a miniature, adjustable LED downlight, ideal for display, niches or general downlighting effects. It is very discreet with the LED set back by 10mm to reduce the glare, with a maximum tilt of 25°. It utilizes the latest LED technology with a typical CRI of 93 in warm white. IP40 as standard, but can be specified IP54 for bathrooms or wet environments.

Key Features

- Very minimal depth and bezel diameter
- Adjustable with a 25° tilt
- High power for its size
- High efficiency optics specially designed for LightGraphix guarantee excellent beam spread and shape
- Recessed LED position for reduced glare
- Optional IP54 version for wet areas, comes with glass and gasket
- Hidden fixing options include spring clips
- Simple and fast installation
- Available with Switch, 0-10V, DMX, Dali or Mains dimmable drivers

Specification

Applications



| | | | | | | |
|--------------------------------------|---------------|------|------|-------|------|------|
| Beam Angles | 12°, 31°, 48° | | | | | |
| LED type | 1 x Cree XPG | | | | | |
| Colour temperature | 2700K / 3000K | | | 5000K | | |
| Drive Current (mA) | 350 | 500 | 700 | 350 | 500 | 700 |
| LED power* (W) | 1.2W | 1.7W | 2.4W | 1.2W | 1.7W | 2.4W |
| CRI (typical) | 93 | 93 | 93 | 75 | 75 | 75 |
| Forward voltage (V) ₁₀₀ | 3.0V | 3.2V | 3.4V | 3.0V | 3.2V | 3.4V |
| Delivered lumens (L ₁₀₀) | 75 | 99 | 127 | 116 | 153 | 197 |
| Lumens per circuit watt** | 63 | 58 | 53 | 97 | 90 | 82 |

LED lifetime (to 70% lumen maintenance) 50,000hrs at a max ambient temperature of 35°C (if specifying fitting in ambient temperatures of up to 45°C run at 500mA max, LD71-500)

Materials Anodised aluminium body

Glass 1.2mm thick borosilicate (IP54 version only)

Wiring Comes pre-wired with 2 core 100mm lead, can be specified with up to 10m at extra cost

IP rating IP40 standard (optional IP54)

*LED wattage includes losses associated with using an 85% efficient driver

**data shown allows for an ambient temperature of 35°C

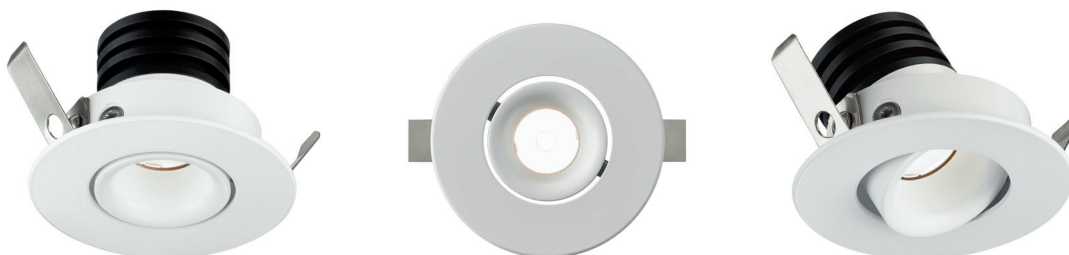

LD71



Miniature Adjustable Low Glare LED Downlight

Data sheet - Page 2

Dimensions

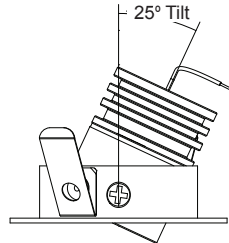
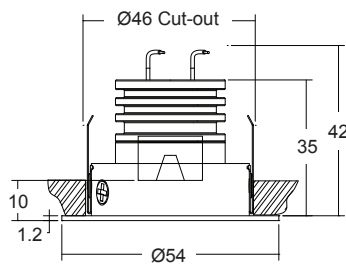

LED and optic position recessed by 10mm for reduced glare

Photometrics

Photometric files are included in the design pack which can be downloaded from the LD71 product page on the website.

Order Codes and Options

| Product code | LED colour | Lens angle | IP rating | Finish |
|------------------------------|----------------------|----------------------|----------------------|----------------------|
| LD71 - 350 - 500 - 700 | <input type="text"/> | <input type="text"/> | <input type="text"/> | <input type="text"/> |

Example: LD71-700 / LW30 / MB / IP54 / White

Product codes with output options

| | |
|-------------------|----------|
| 1.2W LED at 350mA | LD71-350 |
| 1.7W LED at 500mA | LD71-500 |
| 2.4W LED at 700mA | LD71-700 |

LED colour options

| LED colour options | Suffix |
|--------------------------|--------|
| Extra Warm White (2700K) | /LW27 |
| Warm white (3000K) | /LW30 |
| Cool White (5000K) | /LW50 |
| Blue | /LB |
| Green | /LG |
| Red | /LR |
| Amber | /LA |

Beam / lens angle options

| | |
|-----------------|-----|
| 12° narrow spot | /NB |
| 31° medium | /MB |
| 48° wide | /WB |

IP Rating

| | |
|-------------------------------------|-------|
| IP40 (dry internal use as standard) | /IP40 |
| IP54 rated for moist environments | /IP54 |

Bezel finish options

Paint finish silver / black / white (RAL 9016) / RAL
 Chrome finish (minimum order - please contact us)

Use with 350mA, 500mA or 700mA constant current LED drivers

We have a wide range of dimmable LED drivers, 0-10V, DMX, DALI and Mains dimmable. Please see the downloads section on our website:

To run 1-14 LD71-500 in series use a TXDEL500D (0-10V dimmable)

To run 1-13 LD71-700 in series use a TXDEL700D (0-10V dimmable)