



Floor grommets...

perfectly balancing capacity and size



ACCESS GROMMETS

The Electrak range of simple to install access grommets allow cables and conduit to link between underfloor power and desk power systems

- Ranging from 144mm to 232mm in diameter
- 169mm diameter grommet can accommodate up to 3 x 32mm conduits - perfectly balancing capacity and size
- Push-fit lid with optional screw fixing to prevent unauthorised access



Removable inlay for optional carpet fitting

Cable flap allows permanent connection of services

Flat mounted RCD socket

NEW 169mm diameter provides the perfect balance between size and capacity

Spring loaded screws for rapid installation

Available pre-wired to power track tap-offs

POWER AND DATA GROMMETS

The Electrak range of cleaner's grommets are the latest addition to its power and data grommets range. Within their 169mm diameter, the grommet can house a flat RCD socket and provide ample space for the user to plug in or unplug equipment.

- Cleaner's grommet with flat mounted RCD socket or standard socket options
- Push-fit lid with cable flap feature
- Spring loaded screws for rapid installation
- Available pre-wired to power track tap-offs

floor grommets

access / power and data



EG0010



EG0030



EG0040



EG0045

Dimensions and technical information p. 33

Pack	Cat. Nos.	Plastic access grommets
1	EG0010	<p>Quick fit installation Precision engineered from hard wearing durable ABS Grey mouldings. Other colours available to special order Grommets conform to IEC-61534-22 Simply secured by pushing down the spring-loaded screws and rotating a quarter turn</p> <p>144 mm Ø – cut-out size 127 mm Ø</p> <p>Can accommodate all cable types or three metal conduits up to a 20 mm Ø or 25 mm without foam</p>
1	EG0030	<p>169 mm Ø – cut-out size 152 mm Ø</p> <p>Allows power, data and flexible conduit up to 32 mm to pass through raised access floor Lid can be locked with screw (included) Maximum number of conduits : 9 x 20 mm Ø 5 x 25 mm Ø 3 x 32 mm Ø</p>
1	EG0055	<p>232 mm Ø – cut-out size 215 mm Ø</p> <p>High capacity grommet Recommended for installation in light traffic areas</p>

Pack	Cat. Nos.	Aluminium access grommet
1	EG0015	<p>Body – cast aluminium Lid – injection moulded plastic Nylon 66 with neoprene cable gasket Secured by quarter-turn fasteners Floor depth 25 to 55 mm Access grommet depth 60 mm (95 mm when back box included)</p> <p>144 mm Ø – cut-out size 127 mm Ø</p> <p>Allows power, data and flexible conduit up to 25 mm to pass through raised access floor</p>

Pack	Cat. Nos.	Aluminium power grommet
1	EG0025	<p>13 A power grommet Supplied complete with 13 A unswitched socket</p>

Pack	Cat. Nos.	Plastic power and data grommets
1	EG0040	<p>169 mm Ø – cut-out size 152 mm Ø</p> <p>Quick fit installation Precision engineered from hard wearing durable ABS Grey mouldings. Other colours available to special order. Conform to IEC-61534-22 Removable carpet recess Cable flap feature so grommet lid can be closed while in use Simply secured by pushing down the spring loaded screws and rotating a quarter turn</p> <p>13 A power grommet Supplied complete with 13 A unswitched socket</p>
1	EG0045	<p>RCD power grommet Supplied complete with 13 A RCD socket</p>
1	EG0051	<p>13 A power/data grommet Supplied complete with 13 A socket and 1 x 37 x 22 mm cut-out</p>
1	EG0052	<p>Data grommet Supplied complete with data plate 2 x 37 x 22 mm cut-out</p>

Pack	Cat. Nos.	Pre-wired power grommets
1	EG0041	<p>169 mm Ø – cut-out size 152 mm Ø</p> <p>Cleaners socket version DP1332 - 3 m unfused</p>
1	EG0042	<p>DP1532 - 5 m unfused</p>
1	EG0043	<p>DP1313 - 3 m 13 A fused</p>
1	EG0044	<p>DP1513 - 5 m 13 A fused</p>
1	EG0046	<p>RCD socket version DP1332 - 3 m unfused</p>
1	EG0047	<p>DP1532 - 5 m unfused</p>
1	EG0048	<p>DP1313 - 3 m 13 A fused</p>
1	EG0049	<p>DP1513 - 5 m 13 A fused</p>

floor grommets

technical information

144 mm Ø plastic floor grommet

Dimensions

144 mm grommet
EG0010

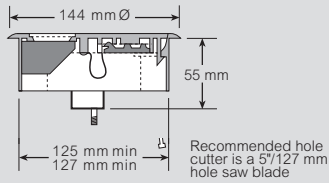

169 mm Ø plastic floor grommets

Access grommet

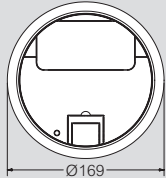
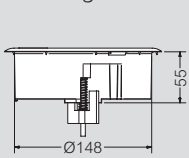

Cat. No. EG0030

Power grommet

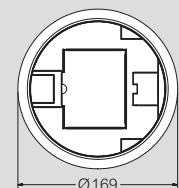
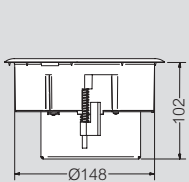

Recommended hole cutter is a 6 1/8 inch hole saw blade

232 mm Ø plastic floor grommet

Dimensions

Large quick fit grommet
Cat. No. EG0055

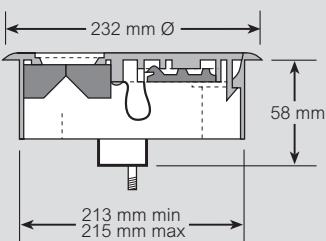

Floor panel cut-out diameter

Recommended hole cutter is a adjustable hole saw blade with Ø range of 40 mm - 300 mm

To install plastic floor grommet

A



Lift handle and pull to remove lid

B

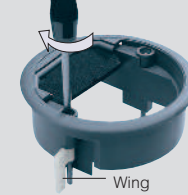

Push grommet into raised floor tile aperture
Push down spring loaded screws and rotate quarter turn to secure
Ensure wings are located under floor panel
For honeycombed floor panels one wing should face downwards and one wing should face upwards

C



Drop cable access insert into housing opening

D



Slide lid into lug holes

E



(1) Push down lid to close
(2) If grommet is not in use, replace cable access insert

144 mm Ø aluminium grommets

Access grommet

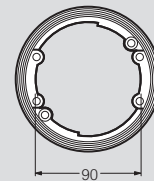
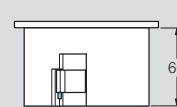

Cat. No. EG0015

13 A power grommet

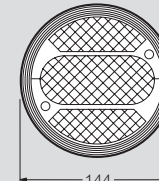
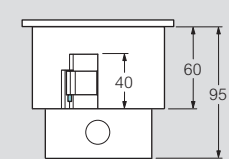

Cat. No. EG0025

Recommended hole cutter is a 5 1/8 inch hole saw blade