

FSW20500

Overhead Ladder



The horizontal ladder, also known as monkey bars, are perfect for improving overall body control and strength by performing various exercises such as L-holds and chin-up holds, and 'walking' hand over hand from one end to another. Perfect as a training tool preparing for obstacle and survival runs. The side bars offer a perfect reach and can be used for a great variety of additional exercises.

Product Line	Outdoor Fitness
Category	Street Workout & Calisthenics
Age group	13+
Max. fall height (CM)	133
Total height (CM)	240
Safety Zone	18 m ²



**SUR-
FACE**

**IN-
GROU.**



ASTM

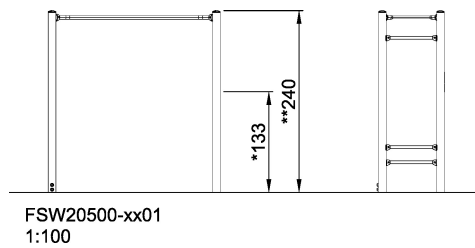
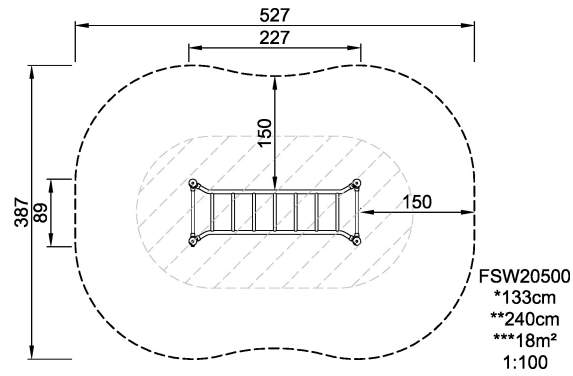

* = Highest designated play surface.
** = Total height of product.

Weight/heaviest parts	kg.	Installation (Manpower)	1 Persons
Concrete required	NaN m3	Installation (Hours)	2 Hours
Foundation amount/footing	NaN	Excavation	NaN m3