

INSTALLATION GUIDE

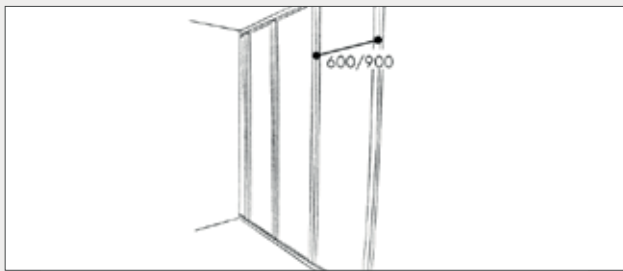

FURRING

- Fix 50 x 50 mm or 50 x 100 mm wooden furring vertically at 600 mm intervals.
- The furring must be placed vertically precisely in relation to the joint between the panels.

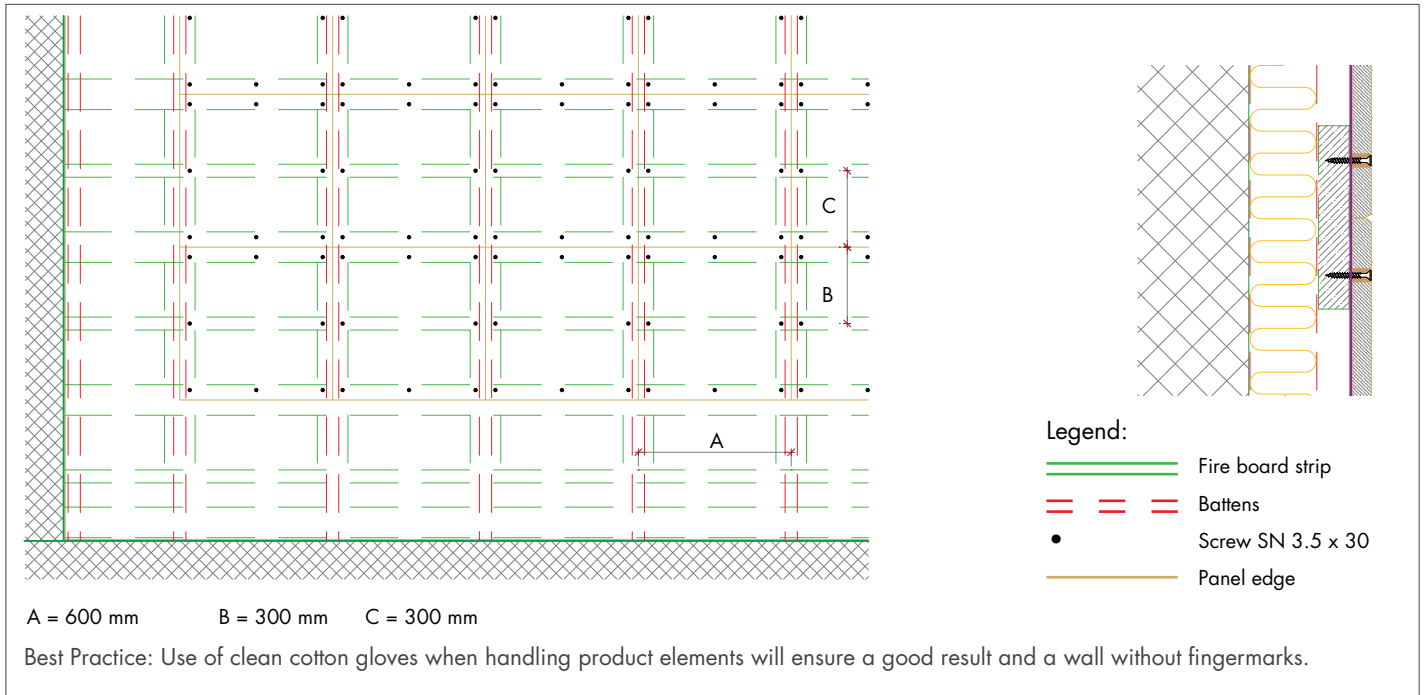
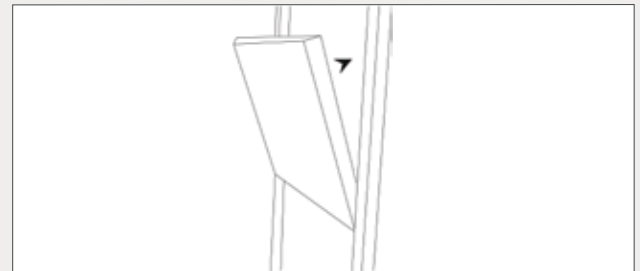

INSULATION

- Place mineral wool (stone wool 30-40 kg/m³ or glass wool 20-25 kg/m³) between the furring.

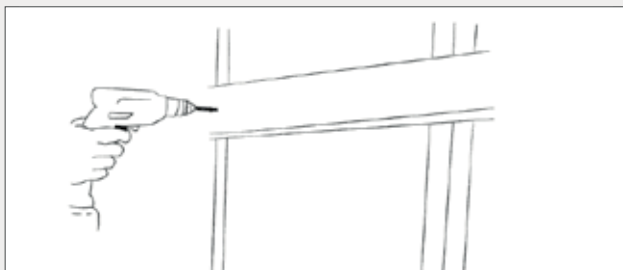

INSTALLATION OF HORIZONTAL FURRING

- Use special fire protective furring.
- Screw fix 20 x 120 mm fire protective furring horizontally at 600 mm intervals (the furring must be placed precisely in relation to the joint between the panels).
- Up to 1800 mm above the floor fix additional horizontal fire protective furring 20 x 50 mm midway between the main horizontal furring (the furring must be placed in relation the centre of the panel).



INSTALLATION OF VERTICAL FURRING

- Fix vertical fire protective furring 20 x 120 mm directly on top of the primary vertical wooden furring, between the horizontal furring.
- It is important that the furring is installed in this way to make a plane support framework for the Kinopanel.

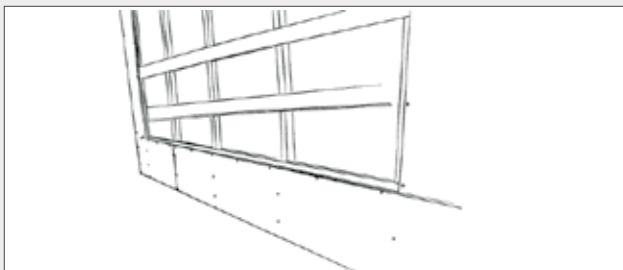

INSTALLATION OF FRIEZE

- If a frieze is to be installed, it is important that the frieze opening is at right angles and made precisely in relation to the number of Kinopanel to be installed.
- The frieze should be installed, filled and painted prior to installation of the Kinopanel.

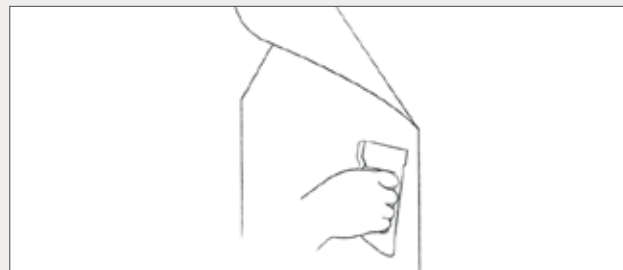

FIXING OF KINO FELT

- Staple the Kino felt to the furring in the area where the Kinopanel are to be installed.

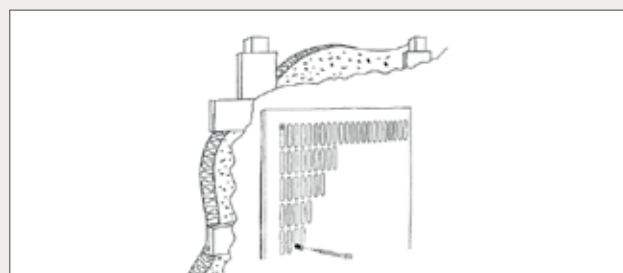

INSTALLATION OF PANELS

- Kinopanel is fixed on all four sides at 300 mm distances (i.e. 8 screws per 600 x 600 mm panel)
- Mount acoustic rubber plugs in the perforation slots of the panel and screw through the plugs with Knauf Danoline screw SN3.5x30, so that the Kinopanel is securely fixed to the framework.

DETAILS

