

# INSTALLATION GUIDE

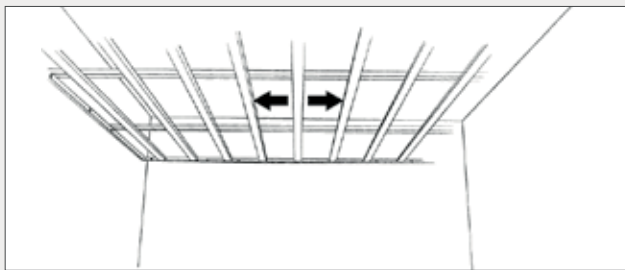

## CEILING LAYOUT

- Divide the ceiling surface from the centre of the room or in accordance with the existing ceiling plans.

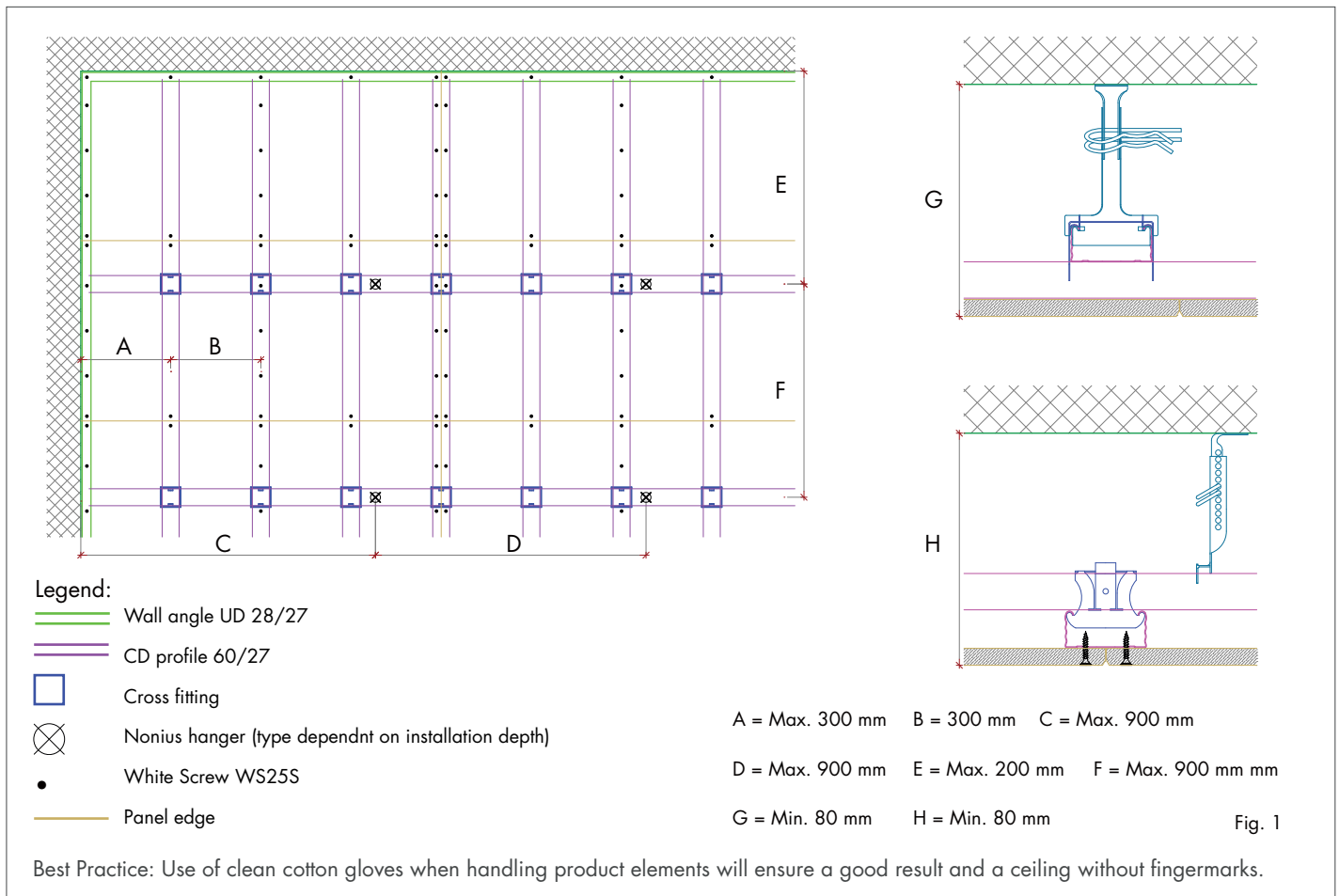
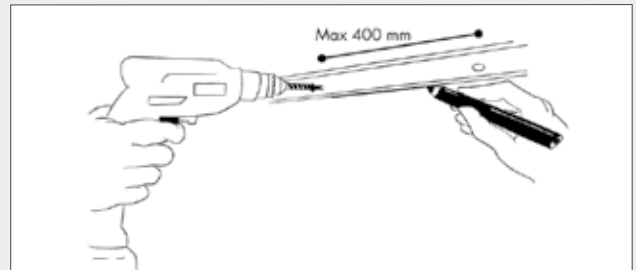

## INSTALLING THE WALL PROFILE

- Mark out.
- Install UD profile 28/27 with a max. distance between screws of 400 mm. Choose the fixings in accordance with the substrate.

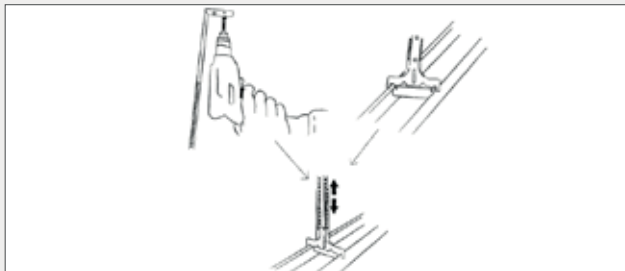

## HANGERS

- Secure the upper part to the construction above it at 900 mm c/c.
- Secure the lower part to the primary profile.

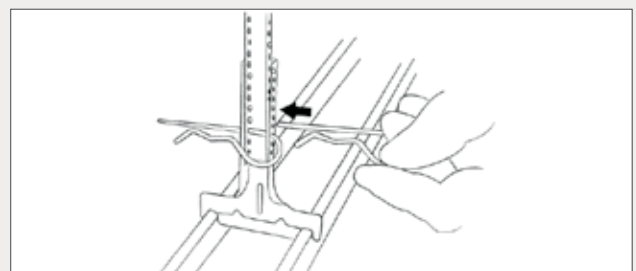

## PRIMARY PROFILES

- Connect the two parts of the hangers with two split pins, one immediately above the other.
- Place the primary profiles at a max. distance of 900 mm from each other.

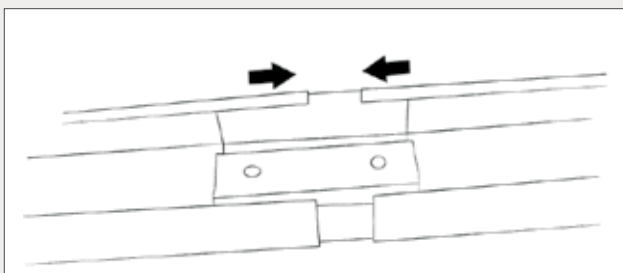

### JOINING CD PROFILES

- Join the CD profiles (both primary and secondary profiles) with the help of length connectors.
- The joints can be made as butt joints.



### SECONDARY PROFILES

- Place a cross fitting on the primary profile.
- Press the underlying secondary profile into it.
- Place secondary profiles at 300 mm c/c.
- Adjust the locations of the secondary profiles and lock the cross fitting.

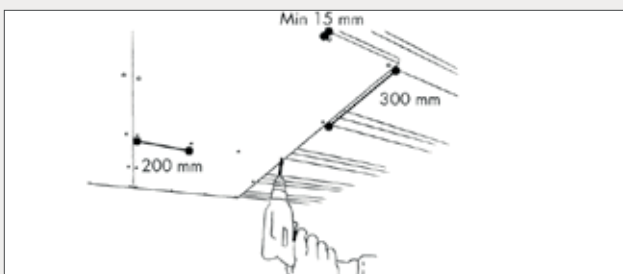

### INSTALLATION

- Always wear cotton gloves when handling the panels.
- Mark the position of screws on the Contrapanel. Use the supplied template for this if necessary.
- Install the elements from the centre. Install the first row with the help of string.
- Secure screws min. 15 mm from the edge of the element at 300 mm c/c.
- Use white screws.

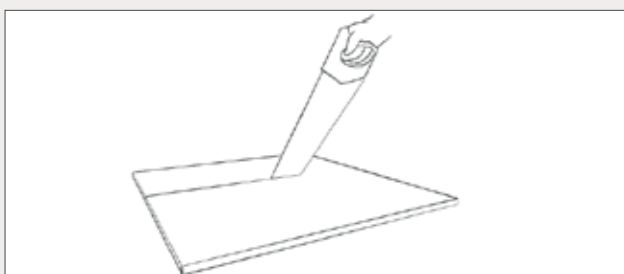

### CUTTING

- Cut the elements to size from the front with a fine-toothed saw.