

**stûv**<sub>21</sub>

---

A fireplace both open and closed

21

Stûv Stories +Stûv 21

A pure mix  
of an open and  
closed fireplace

[stuv.com](http://stuv.com)

## Stûv Stories

Welcome to the world of Stûv! Our products provide ways to layout and rearrange your interior. The story that they tell is straightforward and warm, simple and efficient. A story where appearance is functional and where objects blend into the architecture. Quality and perfection are the watchwords at Stûv. To improve is to simplify. This means humanising design. It also means constant innovation until a perfect harmony is found between pleasure and respect for the environment. Stûv is a state of mind.

Stûv Stories +Stûv 21

Stûv, the creator  
of the retractable  
glass door



**Stûv Stories +Stûv 21-family**

# A family of products both open and closed

The Stûv 21 range is a typical family. Sober and discrete, with a focus on the purity and beauty of the fire. However, it is also an open family full of warmth and fun. A fireplace which is open and closed at the same time thanks to the window which can be slid partially or fully. The Stûv 21 is available in a single-face or double-face model and in a number of different sizes. The frames, front panel and casing complement the fireplace to ensure a perfect finish and enhancement. The Stûv 21 family, the unique combination of optimum performance and atmosphere.



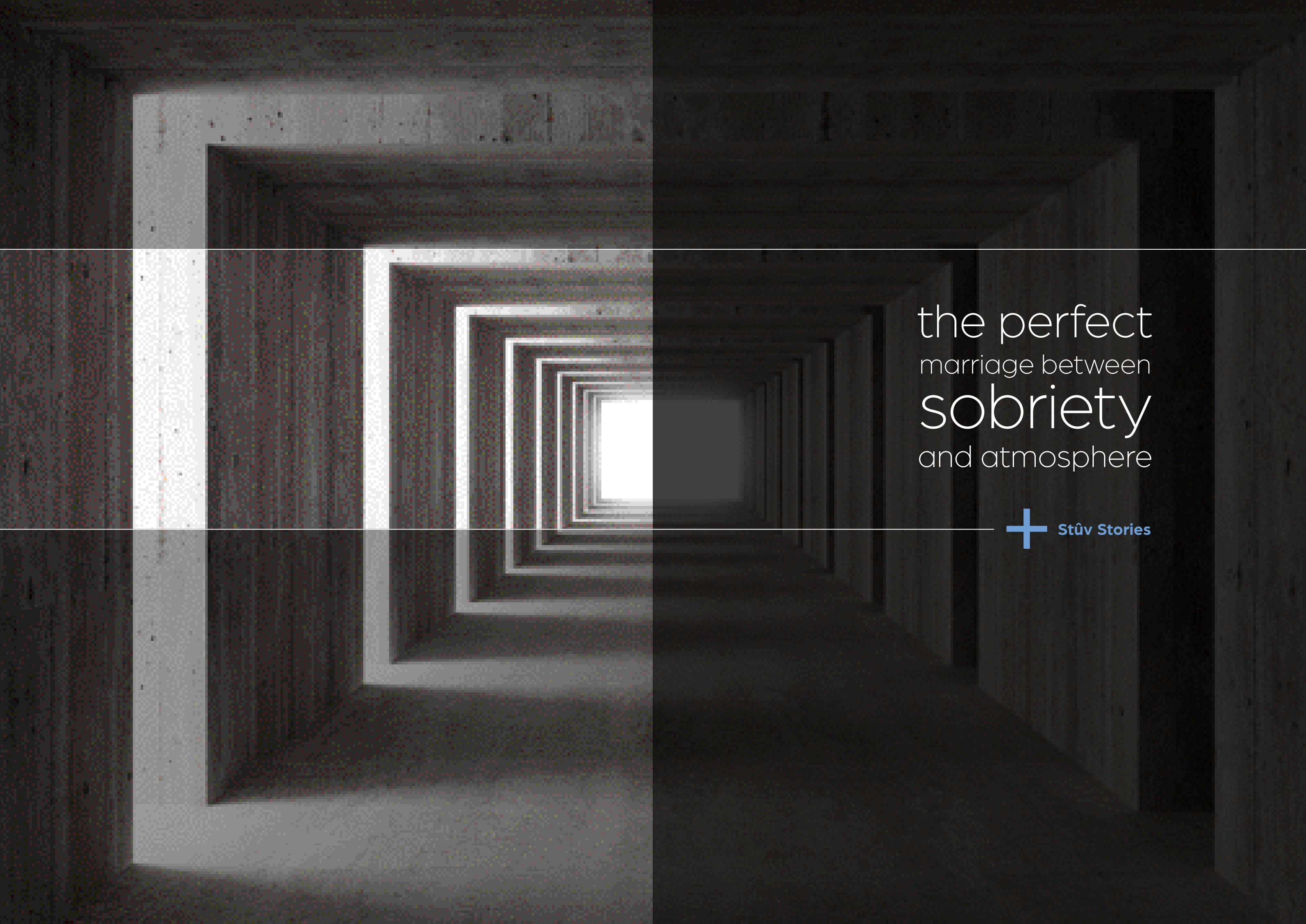

the perfect  
marriage between  
**sobriety**  
and atmosphere

 **Stûv Stories**

The valve allows one to regulate the volume of air entering the apparatus and therefore the amount of heat released.

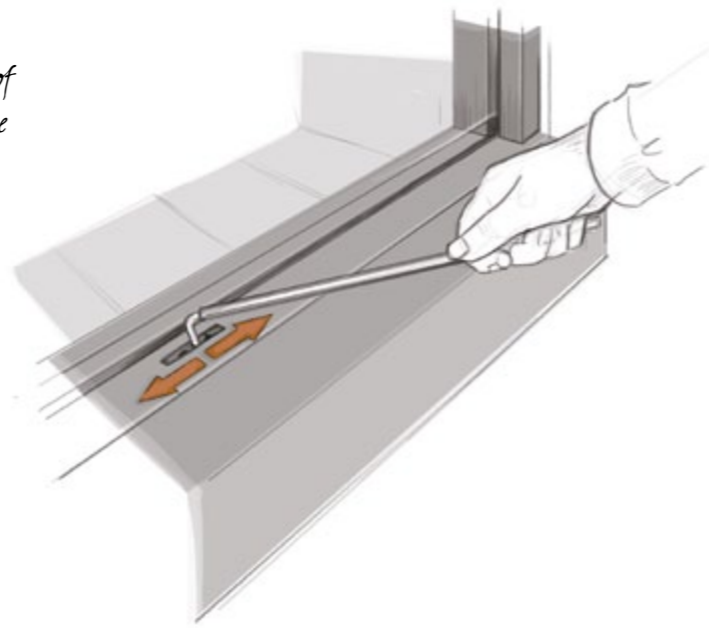

The valve allows one to regulate the volume of air entering the apparatus and therefore the amount of heat released.

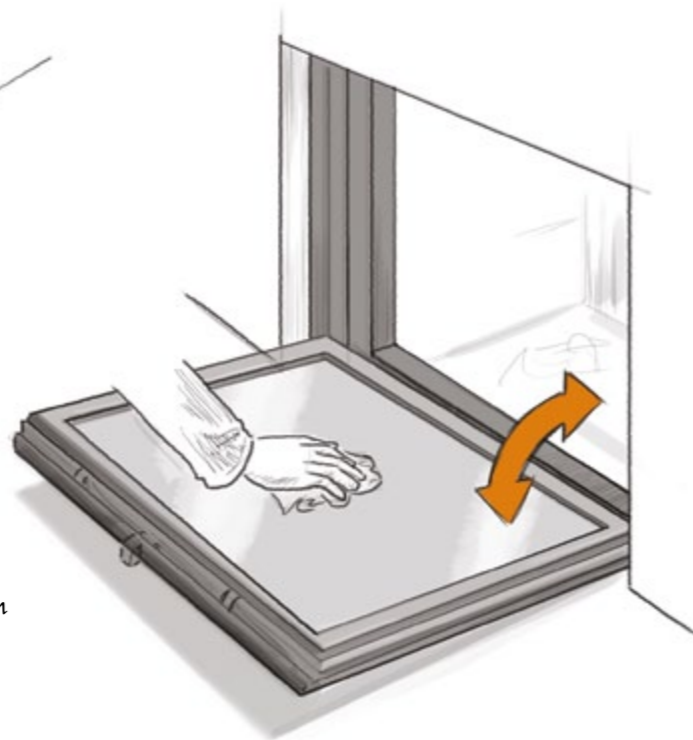
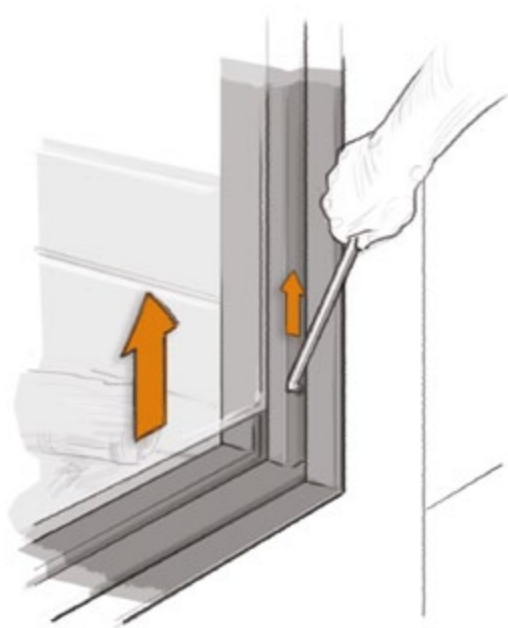

In order to facilitate the cleaning and maintenance of the window, the frame can be tipped without having to dismantle it.

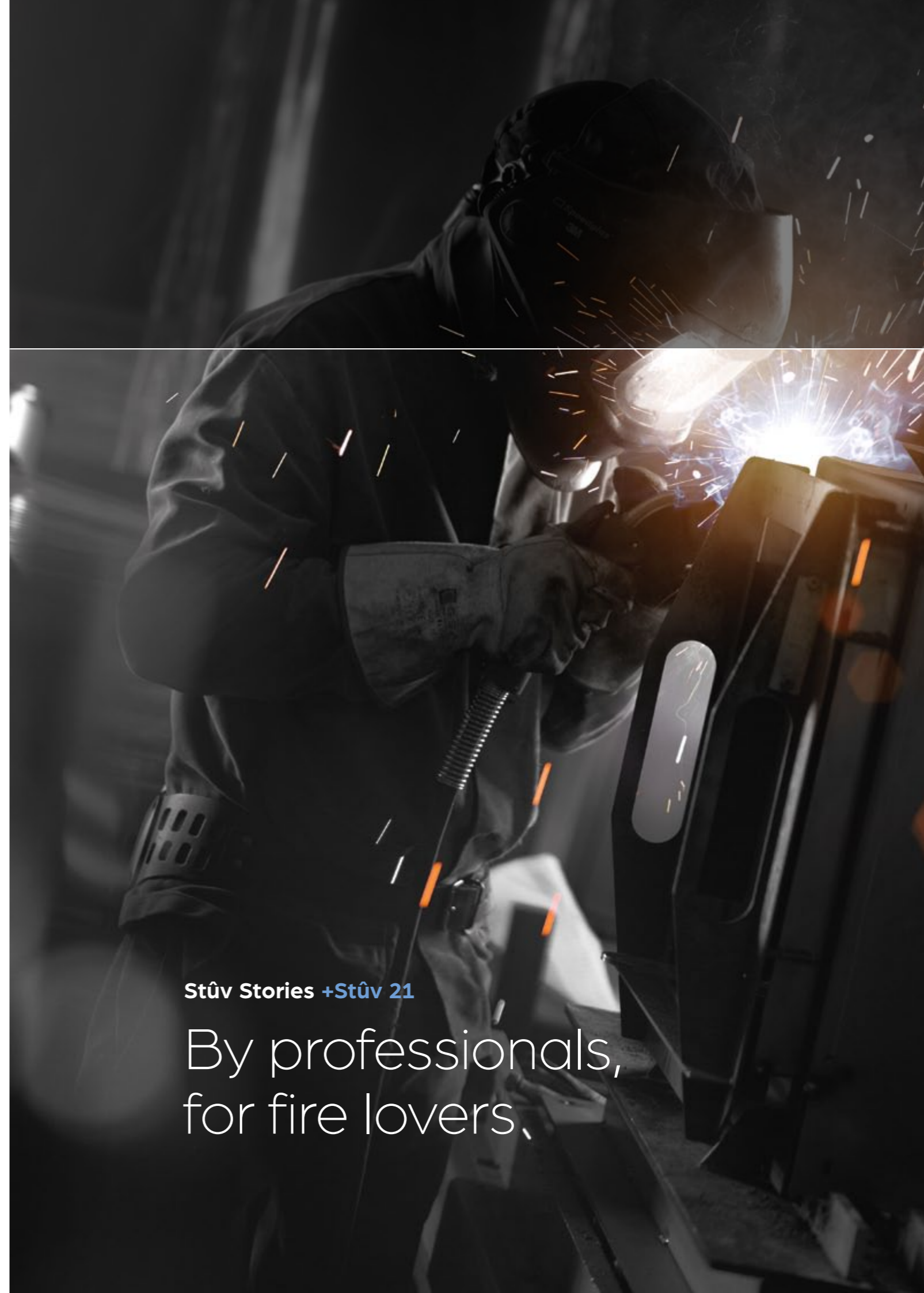

Stûv Stories +Stûv 21

By professionals,  
for fire lovers,

## Stûv Stories +Stûv 21-65-C

- + Heat strength regulation
- + Ability to be connected to the outside air
- + Air-funnelling option
- + Fan option

# Choose a suitable frame



model shown: Stûv 21-65C with fram SF4 RAL 9010

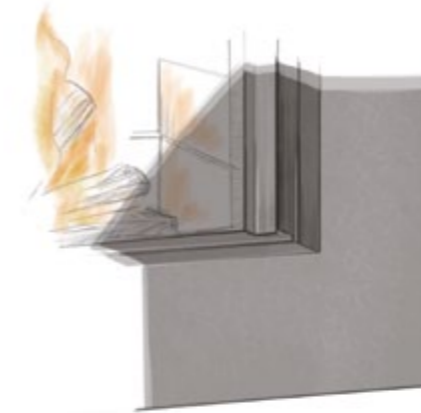

*Stûv SF4: large frame available in many different colours. Also available in customised sizes.*

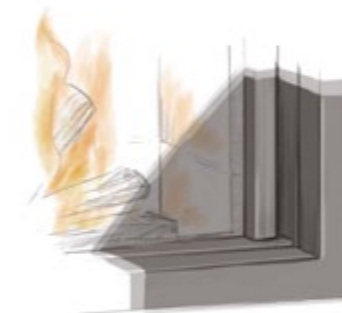

*Narrow frame in StuvGrey steel*

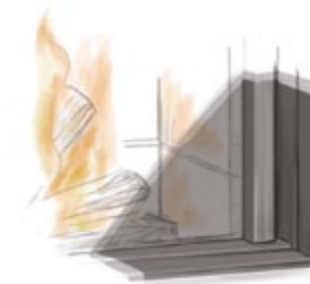

*Thin frame in 4mm StuvGrey steel*

## Stûv Stories +Stûv 21-65-H

- + Heat strength regulation
- + Ability to be connected to the outside air
- + Air-funnelling option
- + Fan option



model shown: Stûv 21-65H with frame SF6 RAL 9010

## Stûv Stories +Ready-to-fit SF15 fireplace



- + Steel chimney integrating air convection inlets and outlets - no need for decorative grilles
- + Easy installation
- + The front panel can open to allow maintenance or access to regulation elements.



## Stûv Stories +Stûv 21-75

- + Heat strength regulation
- + Ability to be connected to the outside air
- + Air-funnelling option
- + Fan option

Enjoy your fire the  
way you want it

## Stûv Stories +Stûv 21-85

- + Heat strength regulation
- + Ability to be connected to the outside air
- + Air-funnelling option
- + Fan option
- + Available in two interior shades: light or dark

A stylish fire...



Sober, it blends perfectly into any interior

**Stûv Stories +Stûv 21-95**

- + Heat strength regulation
- + Ability to be connected to the outside air
- + Air-funnelling option
- + Fan option



## Stûv Stories +Stûv 21-105

- + Heat strength regulation
- + Ability to be connected to the outside air
- + Air-funnelling option
- + Fan option
- + Available in two interior shades: light or dark

Integration of fire into  
the architecture



## Stûv Stories +Stûv 21-105 SF8



- + Steel frame finish with lateral extensions
- + Perfect harmony with the fire
- + Available made-to-measure

## Stûv Stories +Stûv 21-125

- + Heat strength regulation
- + Air-funnelling option
- + Fan option

## Stûv Stories +Stûv 21-135

- + Heat strength regulation
- + Air-funnelling option
- + Fan option



Finish shown: Stûv 21-135 with frame SF4 RAL 9010

## Stûv Stories +Stûv 21-75DF

- + Heat strength regulation
- + Ability to be connected to the outside air
- + Air-funnelling option
- + Fan option

## Stûv Stories +Stûv 21-85DF

- + Heat strength regulation
- + Ability to be connected to the outside air
- + Air-funnelling option
- + Fan option



Double face:  
window retractable  
on both sides

## Stûv Stories +Stûv 21-95DF

- + Double face: window retractable on both sides
- + Heat strength regulation
- + Ability to be connected to the outside air
- + Air-funnelling option
- + Fan option



## Stûv Stories +Stûv 21-125DF

- + Double face: window retractable on both sides
- + Heat strength regulation
- + Ability to be connected to the outside air
- + Air-funnelling option
- + Fan option



## Stûv Stories +Facades

- + Subtle colours, designed in collaboration with colourist Bernard Gilbert
- + Perfect harmony with the fire
- + Colours give different tones during the course of the day

# Front panels in wonderful colours

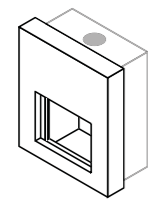

SF1

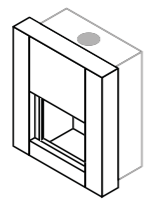

SF1 AIR\*

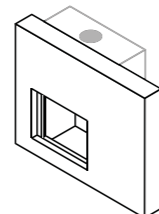

SF2

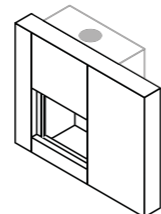

SF2 AIR\*

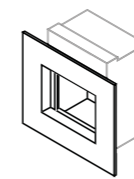

SF4

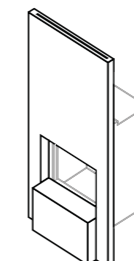

SF5

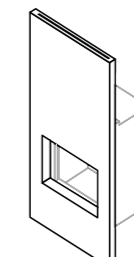

SF6

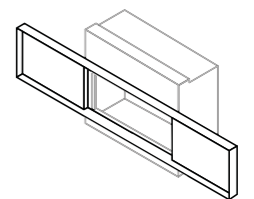

SF8

\* the AIR models are compatible with the external air connection

## Stûv Stories +Ready-to-fit fireplaces

- + Available in a selection of 19 colours
- + Also available in rust
- + Direct inlet of exterior air

Front panels to suit the tastes of all generations!



SF2 rust



SF2 AIR RAL 9010



DF7 RAL 9010 (made to measure)

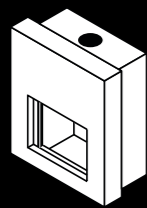

SF1

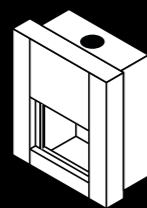

SF1 AIR\*

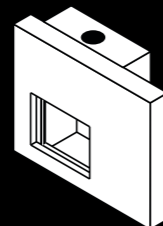

SF2

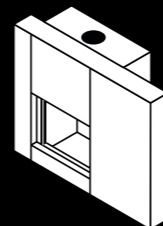

SF2 AIR\*

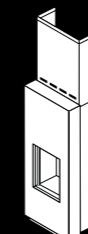

SF15

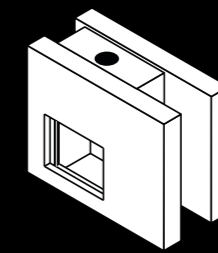

DF2

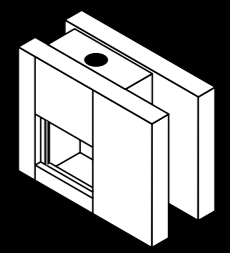

DF2 AIR\*

\* the AIR models are compatible with the external air connection

# Wonderfully purified design

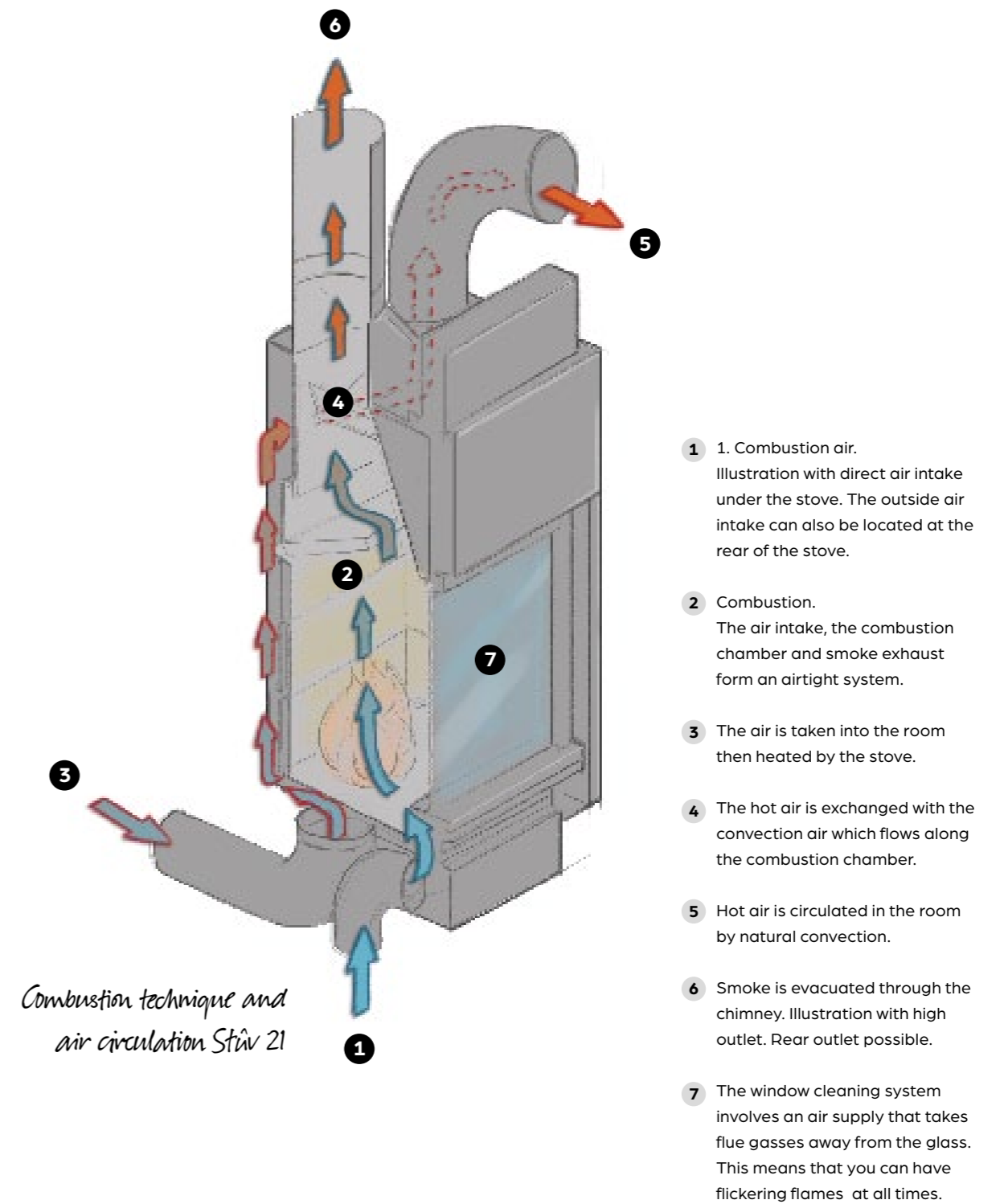

## Stûv Stories +Stûv mobilobox and log trolley



- + Mobilobox: everything is to hand (matches, maintenance products, barbecue kit, kindling etc.)
- + Practical log trolley, with simple and sleek lines: an essential accessory for all Stûv stoves.

## Stûv Stories +Stûv barbecue

Would you like to feel like you do in the summer all the year round? Now it's possible! Cooking food is healthier with the Stûv barbecue, as it is placed in front of the flames and not above the embers. Kebabs, sausages or fish is cooked in this way by radiation and not likely to get burnt by the drops of grease which flare up when they come in contact with burning charcoal. Installing the grille on the stove is child's play and, so that nothing spoils your pleasure, the chimney draught sucks away all the smells!



# Stûv 21

## technical specifications



technical specifications	Stûv 21/65 C	Stûv 21/65 H	Stûv 21/75 SF	Stûv 21/85 SF	Stûv 21/95 SF	Stûv 21/105 SF	Stûv 21/125 SF	Stûv 21/135 SF	Stûv 21/75 DF	Stûv 21/85 DF	Stûv 21/95 DF	Stûv 21/125 DF
weight   kg	155	197	182	234	292	224	305		187	236	297	310
nominal heat power   kW	7	12	10	13	15	19	21	20	19	22	22	27
optimum output range   kW	5-12	8-12	8-11	8-14	10-18	7-19	11-23	11-21	9-19	11-21	12-27	14-27
efficiency   %	76	78	80	78	76	84	76	76	75	75	76	72
CO emissions   %	0,08	0,06	0,07	0,08	0,09	0,09	0,10	0,08	0,08	0,06	0,05	0,21
particle emissions*   mg/Nm <sup>3</sup>	65	13	16	22	18	15	22	64	30	15	31	31
range of wood consumption**   kg/h	1,5-3,5	2,3-3,7	2,2-3,1	2,3-4,0	2,9-5,3	1,9-5,1	3,2-6,6	3,2-6,2	2,8-6,1	3,3-6,3	3,6-8,0	4,3-8,3
length of logs   V / H - cm	33/33	33/50	50/50	50/50	60/50	33/80	50/100	50/100	-/50	-/50	-/50	-/100
outside air intake   ø mm	100	100	100	100	100	100	-	-	100	100	100	-
patent	1445541	1445541	1445541	1445541	1445541	1445541	1445541	1445541	1445541	1445541	1445541	1445541
Options	Stûv 21/65 C	Stûv 21/65 H	Stûv 21/75 SF	Stûv 21/85 SF	Stûv 21/95 SF	Stûv 21/105 SF	Stûv 21/125 SF	Stûv 21/135 SF	Stûv 21/75 DF	Stûv 21/85 DF	Stûv 21/95 DF	Stûv 21/125 DF
+ open fire possible	s	s	s	s	s	s	s	s	s	s	s	s
+ barbecue kit	o	o	o	o	o	o	o	o	o	o	o	o
+ outside air connection	o	o	o	o	o	o	-	-	o	o	o	-
+ electric ventilation	o	o	o	o	o	o	o	o	o	o	o	o
Dimensions	21/65-C SF	21/65-H SF	21/75 SF	21/85 SF	21/95 SF	21/105 SF	21/125 SF	21/135 SF	21/75 DF	21/85 DF	21/95 DF	21/125 DF
+ (A) width   mm	650	650	750	850	950	1050	1250	1350	750	850	950	1250
+ (B) depth   mm	440	490	490	540	590	496	563	500	670	670	670	670
+ (C1) max. height   mm	1165	1455	1137	1295	1455	1040	1295	1040	1136	1295	1455	1295
+ (C2) min. height   mm	1010	1225	1005	1115	1225	-	1115	-	1005	1115	1225	1115
+ (D) width of the glass   mm	470	470	570	670	770	870	1070	1170	570	670	770	1070
+ (E) height of the glass   mm	470	615	456	535	615	400	535	400	456	535	615	535
+ (F) width of the opening   mm	584	584	684	784	884	984	1184	1282	684	784	884	1184
+ (G) height of opening   mm	539	683	524	603	683	469	603	469	524	603	683	603
+ (H) duct diameter - ø   mm	180	200	180	200	250	200	300	250	250	250	250	300
+ (I) position of the duct   mm	171	196	186	201	221	201	221	203	336	336	336	336

- \* measurement method in accordance with DIN +
- \*\* at 12 % humidity
- V/H vertical position/horizontal position
- o optional
- s standard
- not available

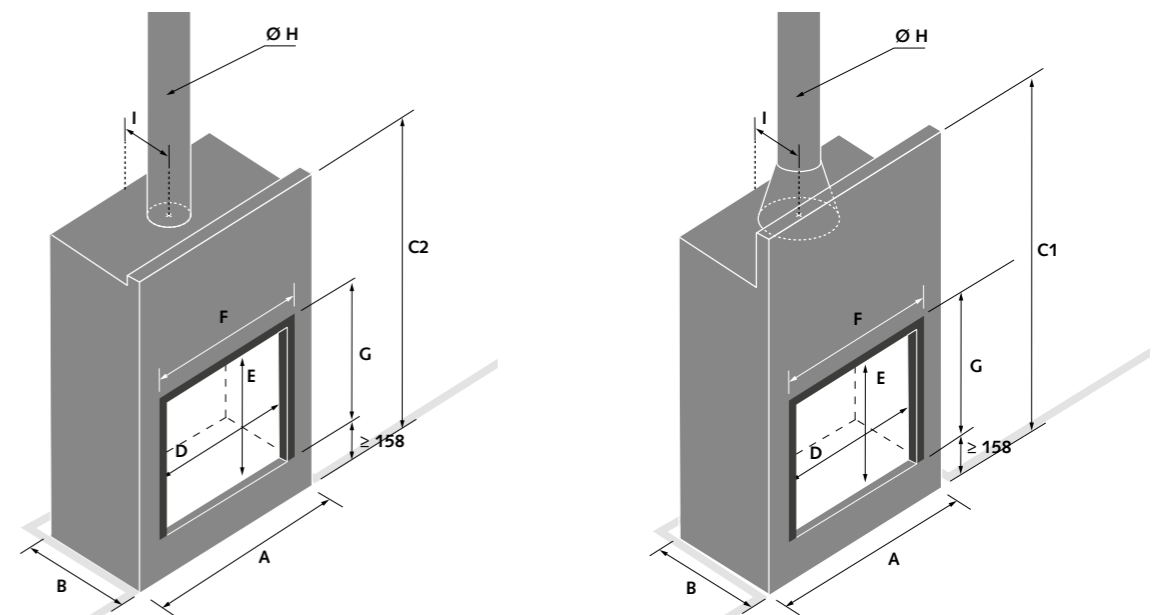

## Stûv 21 Facades

		SF1	SF1 AIR	SF2	SF2 AIR	SF4	SF5	SF6	SF8
<b>21/65H</b>	H	-	-	-	-	1164	-	2010	-
	L	-	-	-	-	1064	-	884	-
	E	-	-	-	-	24	-	70	-
<b>21/75</b>	H	1270	1430	1270	1430	1004	2010	2010	-
	L	1084	1084	1584	1584	1164	984	984	-
	E	200	200	200	200	24	170	70	-
<b>21/85</b>	H	1370	1530	1370	1530	1084	2000	2000	-
	L	1184	1184	1684	1684	1264	1084	1084	-
	E	200	200	200	200	24	170	70	-
<b>21/95</b>	H	1490	1650	1490	1650	1163	2000	2000	-
	L	1284	1284	1784	1784	1364	1184	184	-
	E	200	200	200	200	24	170	70	-
<b>21/105</b>	H	-	-	1164	1325	949	2000	-	481
	L	-	-	1884	1884	1464	1284	-	2400
	E	-	-	200	200	24	170	-	100
<b>21/125</b>	H	1370	-	1370	-	1084	2000	2000	-
	L	1584	-	2084	-	1664	1484	1484	-
	E	200	-	200	-	24	170	70	-
<b>21/135</b>	H	-	-	-	-	918	-	-	-
	L	-	-	-	-	1724	-	-	-
	E	-	-	-	-	24	-	-	-

## Stûv 21 Ready-to-fit fireplaces

		SF1	SF1 AIR	SF2	SF2 AIR	SF15	DF2	DF2 AIR
<b>21/65H</b>	H	-	-	-	-	1977	-	-
	L	-	-	-	-	776	-	-
	P	-	-	-	-	533	-	-
<b>21/75</b>	H	1270	1430	1270	1430	-	1270	1430
	L	1084	1084	1584	1584	-	584	1584
	P	570	570	570	570	-	800	800
<b>21/85</b>	H	1370	1530	1370	1530	-	1370	1530
	L	1184	1184	1684	1684	-	1684	1685
	P	620	620	620	620	-	800	800
<b>21/95</b>	H	1490	1650	1490	1650	-	1490	1650
	L	1284	1284	1784	1784	-	1784	1784
	P	670	670	670	670	-	800	800
<b>21/105</b>	H	-	-	1164	1325	-	-	-
	L	-	-	1884	1884	-	-	-
	P	-	-	570	570	-	-	-
<b>21/125</b>	H	1370	-	1370	-	-	1370	-
	L	1584	-	2084	-	-	2084	-
	P	640	-	640	-	-	800	-

H width (mm)  
 L height (mm)  
 P depth (mm)  
 E thickness visible from the front (mm)

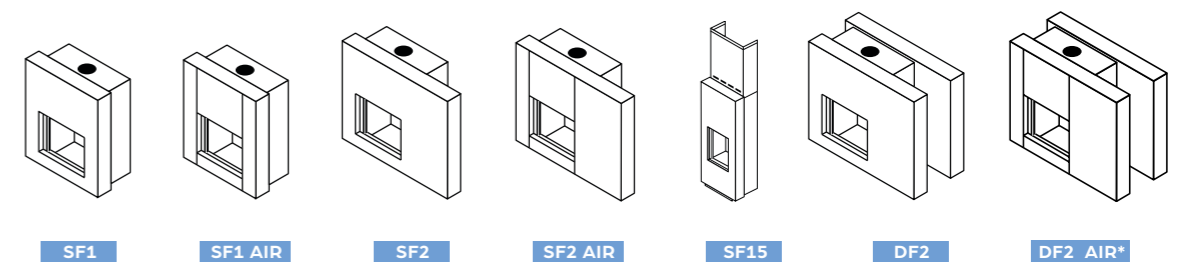
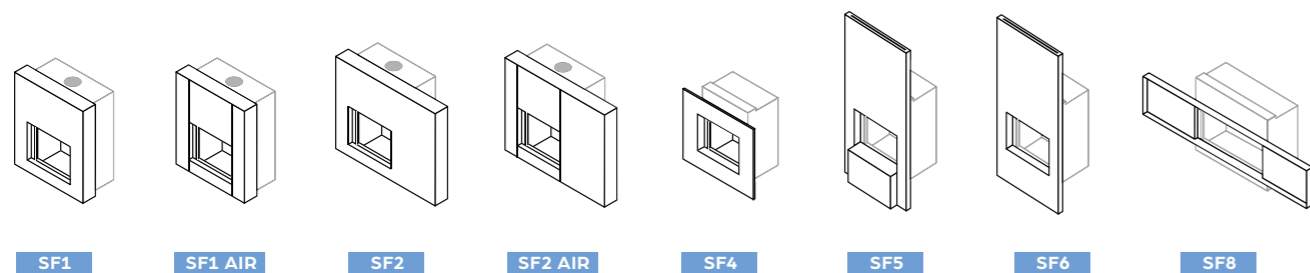

## The constant search for improvement...

Stûv invests enormously in research and development in both its own laboratory and thanks to its partnerships with specialists in the field of combustion. Each detail is important in optimising the performance of the stove. Stûv devices meet the most stringent standards in terms of respect for the environment. We prioritise ergonomics and simplicity at all stages – installation, use, maintenance – so that every user can use their Stûv exactly how they want it. This is the reason we provide detailed installation instructions, we select our sales network and organise training sessions for our retail and installations partners.

### The Stûv guarantee

- + Stûv fireplaces are renowned for their design and performance. They are also solid, reliable and durable.
- + The fireplaces and their components are made in Europe with the utmost care. A well-maintained Stûv fireplace is for life.
- + This is why Stûv offers the users of its products an extended guarantee. Three years' guarantee in addition to the legal guarantee.
- + In total, 5 years on the body of the fireplace, 3 years on the electrical components and 3 years on the other components.

### What do you need to do to benefit from this extended guarantee?

Complete the guarantee form that you will find at the end of the user manual and return the hard copy to Stûv or – the easier option – complete the online form at [stuv.com](http://stuv.com).



All Stûv fireplaces are designed to burn wood with a humidity level of less than 20 %.

All Stûv fireplaces were tested according to EN 13240 CE and EN 13229.

Complies with standards :

Stûv 21/65 C, 21/125 SF : Flamme Verte 5\* (FR), BlmSchV 1 (DE), LRV (CH), DIN+ (EU), BE Phase 1 & 2 (BE), VKF (CH)

Stûv 21/65 H, 61/75 SF & DF, 21/85 SF & DF, 21/95 SF & DF, 21/105 SF : Flamme Verte 7\*(FR), BlmSchV 1 & 2 (DE),

LRV (CH), DIN+ (EU), BE Phase 1, 2 & 3 (BE), VKF (CH)

Stûv 125 DF : Flamme Verte 4\* (FR), DIN+ (EU), VKF (CH)

Stûv 21/135 SF : Flamme Verte 5\* (FR), BlmSchV 1 (DE), LRV (CH), DIN+ (EU), AEAI (CH)

## Colophon

design Brigitte Boits

styling Edith Vervest

copy JP Nieuwerkerk

communication manager Serge Alhadeff

responsible editor Gérard Pitance

Documents and photos are for information purposes only. Stûv reserves the right to make changes without warning. Every care has been taken in the preparation of this brochure; however, we do not accept any responsibility for any mistakes that it may contain.

photos: pp. 16, 24 ©Atelier Blink & Jacky Lecouturier,  
pp.11, 32-36 : © François Chevalier, pp. 28, 31 © Laurent Brandais;  
p. 29 © Jean-Yves Clément;  
p. 22 : © William Reue; pp.5, 24 © Luc Roymans; p. 27 © O. Szczepaniak;  
p. 27 © Olivier samso, Arcand/Osa images;  
pp. 12, 14, 15, 18, 23, 25, 30, 32, 34, 37, 43 © Olivier Vandentempel

EN - 93102115 -201409

## **Stûv 16**

Pure simplicity

## **Stûv 21**

A fireplace both open and closed

## **Stûv 30**

Subtle curves, endless possibilities

## **Stûv 30-compact**

+ Subtle curves, pure heat

## **Stûv microMega**

micro volume inside,  
Mega view of the flames

Stûv stoves are distributed by :

---

---

Stûv stoves are designed and  
manufactured by: **Stûv nv**  
rue Jules Borbouse 4  
B - 5170 Bois - de - Villers  
Belgium  
t +32 (0)81 43 47 96  
info@stuv.com  
**stuv.com**

Join us on :



**stûv**