

Installation of windows and doors



Installation of doors

Place the door frame in the opening to fit flush with the wall structure in both sides. Wedge the jamb in the correct position.

Plumb, level and square the jamb and adjust it with the packers.

Install the hinge side first. Make sure it is perfectly plumb, so that the door stays in position when it is opened.

Drill pilot holes through the door hinges.

See fixing details on page 4

Before fixing, place spacers that have similar size as the distance between the door frame and the wall behind the door frame in line with the door hinge. As a minimum, wedge and fix as recommended by DVC (Dansk Vindues Certificering which is the Danish Window Certification). The distance between spacers and screws should not exceed 900 mm.

To prevent burglary, a frame screw should be positioned close to the strike plate.

The spacer should be set on the external and internal side of the jamb. Make sure there is space for jointing compound as well.

Bottom wedge is replaced with a spacer.

Drill pilot hole in the opposite side of the jamb.

Check door frame for plumb.

The last screws in the vertical frame are fitted.

Always use packers to ensure that the bottom frame is safely supported.

Installation of windows

Place the window frame in the opening to fit flush with the wall structure in both sides. Wedge the frame in the correct position.

Plumb, level and square the jamb and adjust it with the packers.

Install the hinge side first. Make sure it is perfectly plumb, so the window stays in that position when it is opened.

Drill pilot holes through the slanted wall for hidden installation.

See fixing details on page 4

Before fixing, place spacers that have similar size as the distance between the window frame and the wall, behind the window frame in all corners. As a minimum, wedge and fix as recommended by DVC (Dansk Vindues Certificering which is the Danish Window Certification). The distance between fixing points should not exceed 900 mm.

The distance from the corner to the spacer, both horizontally and vertically must be approximately 100 mm.

The spacer should be set on the flat side of the window frame. Make sure there is space for jointing compound as well.

Bottom wedge is replaced with a spacer.

Drill pilot hole in the opposite side of the element.

Check window frame for plumb.

Fit the last screws in the vertical frame.

Fix the window frame in top and bottom. Position the spacers next to the screws which are fixed in the stationary part.

Seal bottom screws to avoid water penetration.

Fixing details

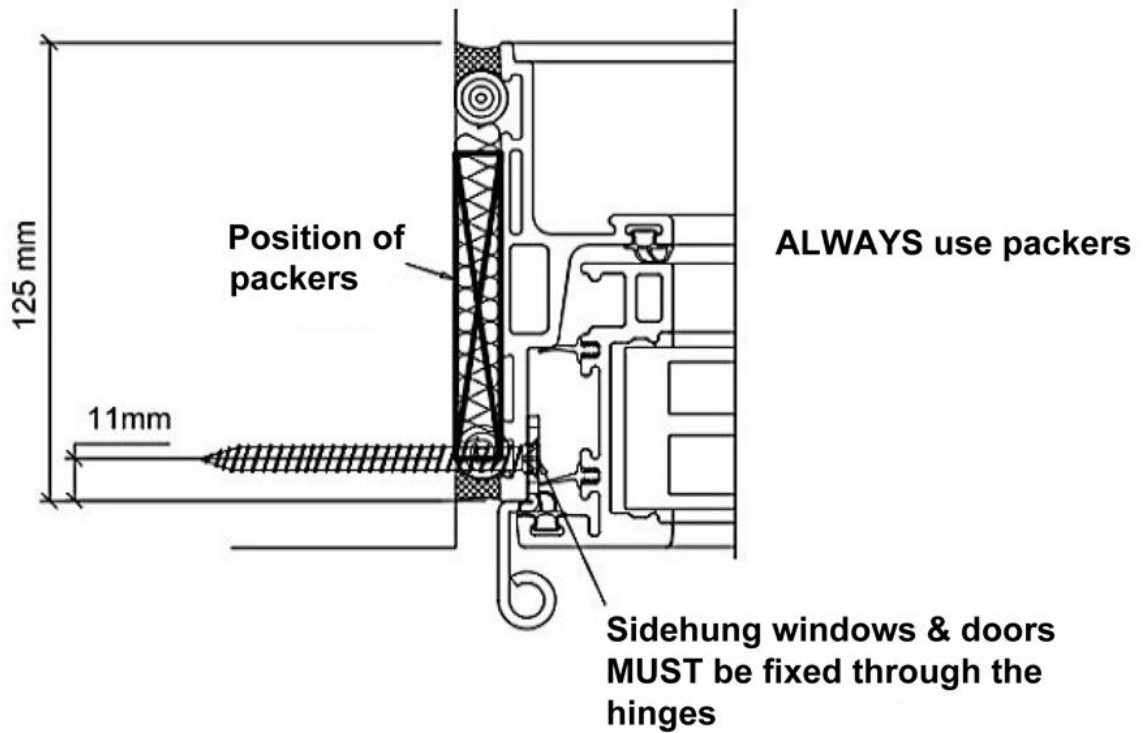
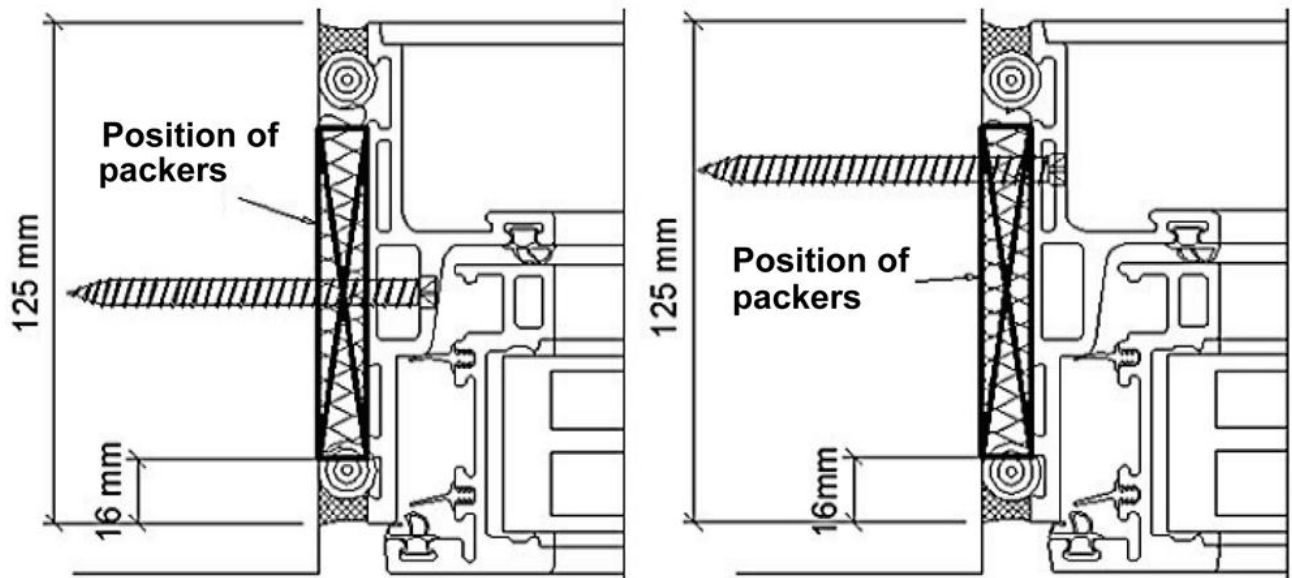

Assembly of elements.

Standard, hidden installation

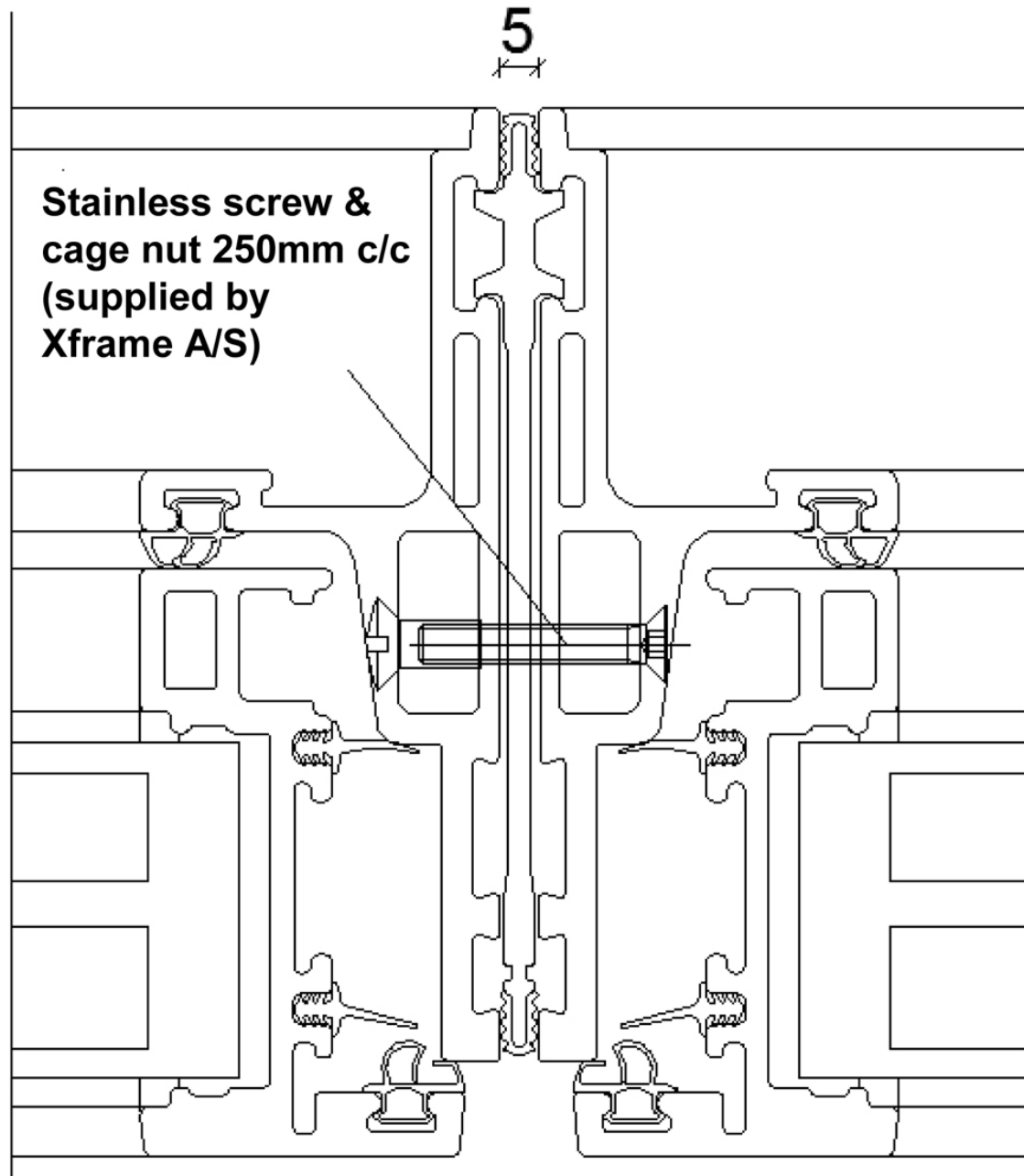

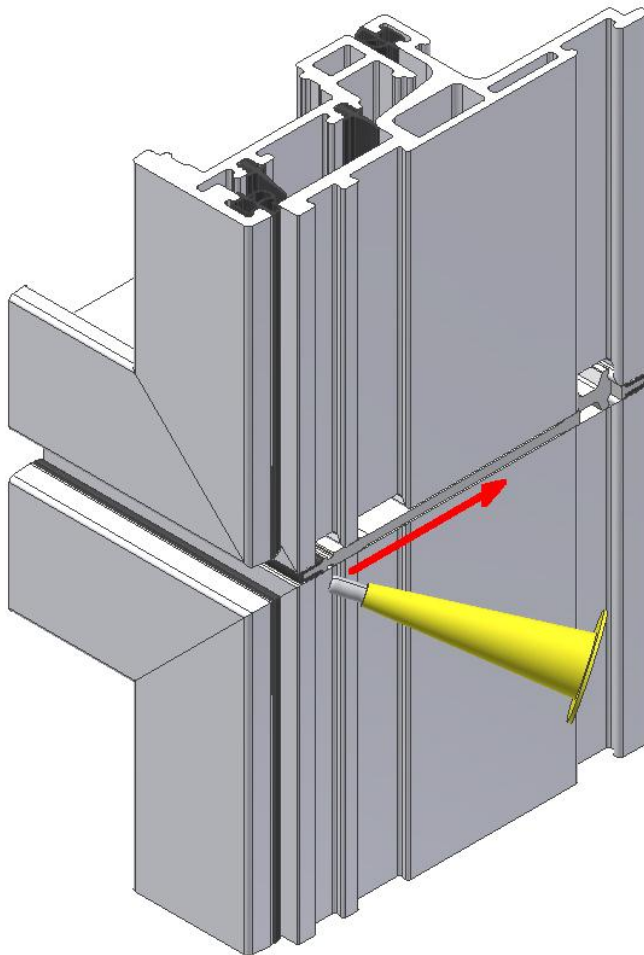
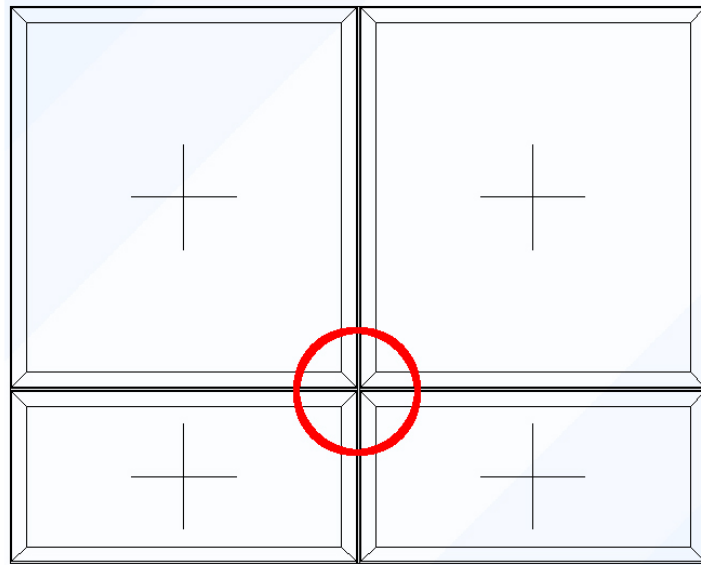

When assembling, the vertical assembly profile is usually through-going. The end of the horizontal assembly profiles must be joined before assembly.

Assembly of Turn/Tilt Elements:

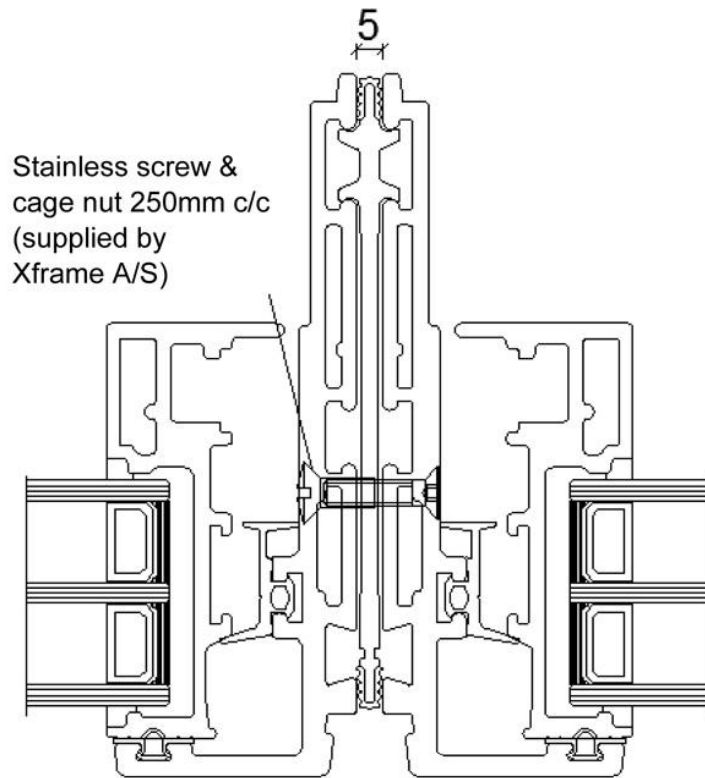

Instruction Guidance for Turn/Tilt Elements:

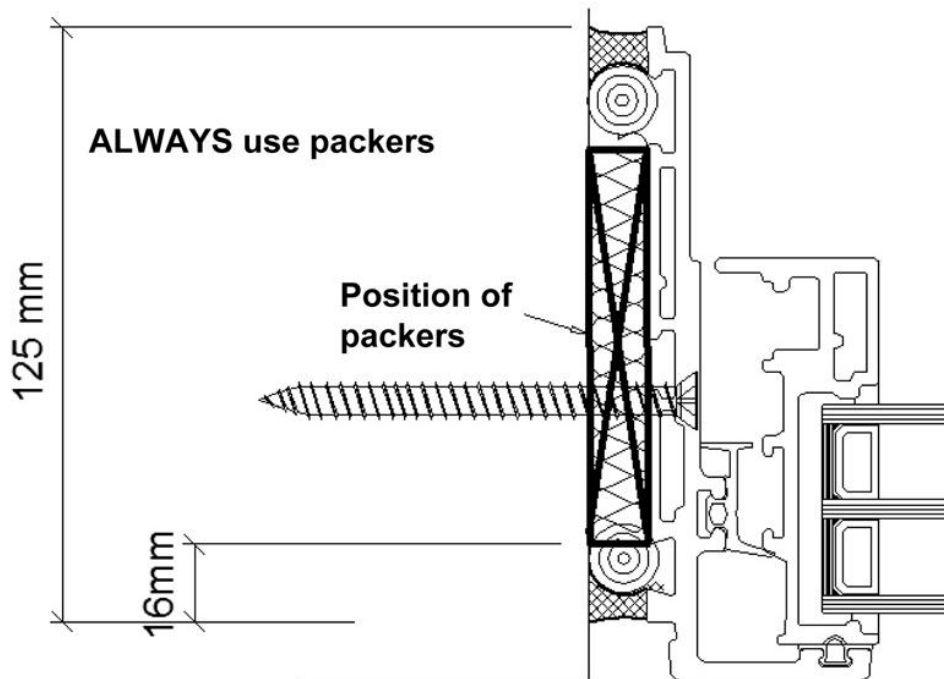

How to disassemble Xframe fixed frames

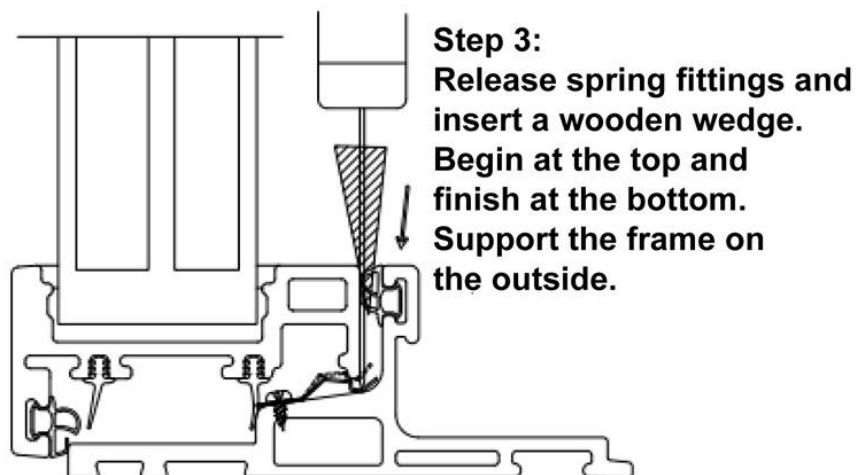
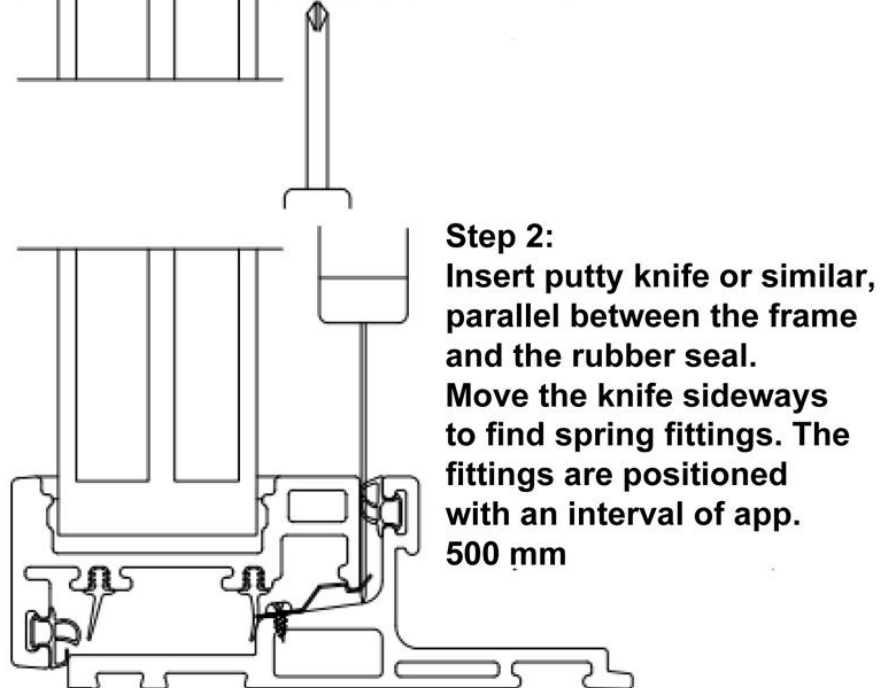
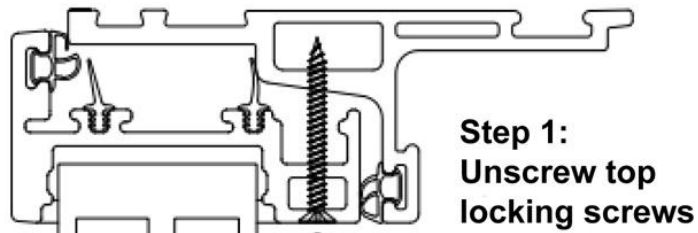

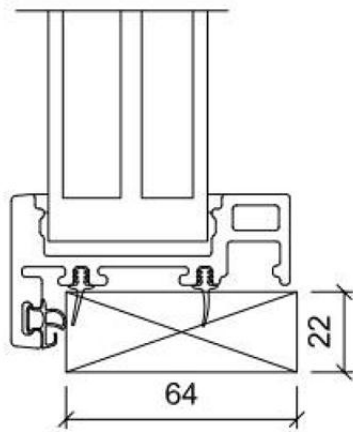

Step 4:
Wedge the frame
to avoid to damage
the lower edge of
the frame profile.
Smallest size 22 x 64 mm.

Step 5:
On reinstallation of the frame,
it is important to secure that
all the spring fittings grip
the frame. If possible, bend
the spring fittings before
the installation.

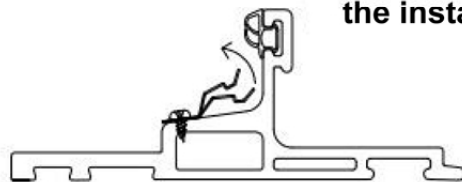

Installation of aluminium sill:

