

Fastlane® Glassgate 400

with IP communications



Setting the Standard

Fastlane Glassgate 400 offers a taller, more secure and imposing barrier for higher security areas. Using Stainless Steel for its good looks and durability, GG400 has a light and open appearance whilst maintaining a commanding presence. Easy and intuitive to use with swinging glass barriers available in several different heights up to 1.8 metres (70.9")



Users are met with a familiar glass door arrangement, as easy to use as it is to look at. GG400 now features Fastlane *Connect*, IP communications for control, configuration and diagnostics. Connection can be as simple as just connecting to your network and switching on. Recent enhancement of the product

includes the new IDL 32 beam-path detection engine offering best in class detection and interpretation of entities moving between the pedestals. The GG400 offers a high power friction brake and is optionally available with a lock system offering the very highest security from a swing panel product.

Barrier type

GLASS

ARM

OPTICAL

Secure

- ➔ Class leading infrared detection systems
- ➔ Detects and deters tailgaters in very close proximity
- ➔ Barriers are a visual and physical deterrent

Accurate

- ➔ Accurately assesses traffic through the barrier
- ➔ Differentiates body mass from smaller objects
- ➔ Provides feedback of traffic flow

Fast

- ➔ Quick and safe action
- ➔ High processing speed reduces traffic build-up
- ➔ Door-like motion ensures quick user acceptance

Aesthetics

- ➔ Inspired, elegant design
- ➔ Glass barriers provide secure and welcome entry
- ➔ Barriers open flush with the pedestal, minimizing footprint

Reliability

- ➔ Quality build lowers whole life costs
- ➔ Fewer failures mean lower repair costs
- ➔ On-line diagnostics and support packages

Fastlane® Glassgate 400



➔ Dimensions

L x W x H	1408 x 218 x 1063mm / 55.4 x 8.5 x 41.8 Inches
Weight	88kg / 194lbs Interlane 73kg / 161lbs
Standard lane width	660mm / 26"
DDA/ADA lane width	914mm / 36"
Barrier height	1061 to 1800mm / 41.8 to 70.9"
Barrier material	10/12mm Toughened and Laminated Safety Glass EN14179 / ANSI 97.1
Barrier breakaway force	≥ 70N
Barrier speed of operation	0.8 seconds (min)
Infrared optical matrix - pulsed beam paths	32
Tailgate detection distance	5mm / 1/4"

➔ Pedestrian Access Throughput

Optical system performance	1 person per second
Typical application	40 persons per minute
Card buffering capacity	10 cards max.
Turnstile functions	As detailed in the product functional test specification

➔ Turnstile Power Specifications

Receive Gate / Transmit gate	24Vdc 1.25A
Interlane	2 X 24Vdc 1.25A

➔ Environmental

Temperature	5 to 50 degrees centigrade
Relative humidity	5 to 95% non-condensing
Energy consumption per lane	438kW hours per annum
Ingress protection	IP20 (Internal building applications only)

➔ Power Supply (Included)

Enclosure	Black mild steel, wall mounted, 330mm (13") x 200mm (8") x 136mm (5.5")
Modules	Dual or quad 24Vdc 2.5A overcurrent fold back
Input voltage	100-240Vac, 60/50Hz, 5A fused spur connection
Approvals	UL 60950-1 CSA C22.2 No. 60950-1-07 second edition

➔ Access Control Inputs

Voltage-free contacts;	Entry request (NORMALLY OPEN closing for 1 second)
1mA current sense	Exit request (NORMALLY OPEN closing for 1 second)
Screw terminal connector	Visitor entry (NORMALLY OPEN momentary closing contact)
Max conductor CSA 16AWG/ 1.5mm ²	Visitor exit (NORMALLY OPEN momentary closing contact)

➔ Access Control Outputs

Voltage-free contacts;	Entry monitor (NORMALLY CLOSED opening for 1 second)
Contact Rating 28Vdc 0.5A	Exit monitor (NORMALLY CLOSED opening for 1 second)
Screw terminal Connector	Alarm 1 (NORMALLY CLOSED opening for 1-16 seconds)
Max conductor CSA 16AWG/ 1.5mm ²	Alarm 2 (NORMALLY OPEN closing for 1 second)
Fire panel integration input	Opto-coupled Input 12-24V dc @ 25mA nom
Ethernet connection	RJ45 TCP/IP Port
Turnstile status display	RGB LED diffused through 10mm high clear frosted acrylic
Alarm sounder output	73dB

For further information please contact your local supplier



Manufactured by Integrated Design Ltd
 Feltham Point, Air Park Way, Feltham, Middlesex TW13 7EQ, UK
 t: +44 (0) 208 890 5550
 f: +44 (0) 208 890 2444
 e: info@fastlane-turnstiles.com
 w: www.fastlane-turnstiles.com



Glassgate 400 dimensions detail

(Standard round ends, single lane). Please see the Glassgate 400 Drawing Pack for additional details.

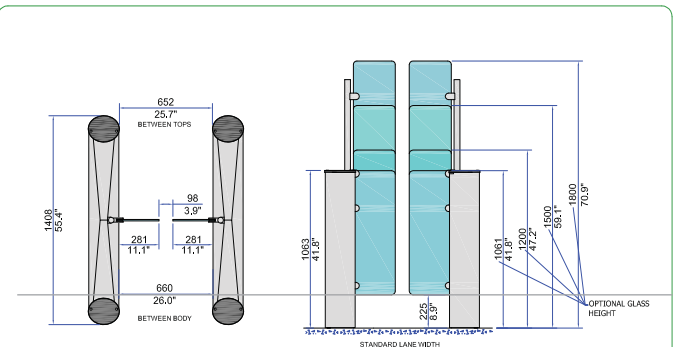

PRODUCT: GLASSGATE 400
 TITLE: SALES ILLUSTRATION
 DRAWING No: GG400
 FOR SALES INFORMATION ONLY SUBJECT TO CHANGE
 ALL DIMENSIONS IN MILLIMETERS
 1:6 (subject to the copyright drawings only) 1:10

Installation photos may not represent current production models
 Please note specifications are subject to change without prior notice and performance features vary from model to model.