

Ideal Commercial Range

Product Guide



Ideal Commercial Heating Solutions



Ideal Commercial Heating is one of the most respected names in the UK commercial and domestic heating industry, operating from its Hull manufacturing plant and offices since 1906, Ideal Commercial Heating is one of the few true British Manufacturers left in the heating industry.

With over 100 years of manufacturing experience, you can be confident to know that our capabilities stretch beyond traditional boiler technologies and now include a wide range of new energy solutions in the form of photovoltaics, solar thermal

and heat pumps; all perfectly designed to meet your individual building requirements. Our products are easy to specify, simple to install & maintain and most importantly are reliable.

The Commercial Heating Team

As industry leaders, Ideal Commercial Heating are committed to ensuring that all products are engineered to the highest standards. From dedicated one-to-one support throughout the design, planning and after sales service stages, you can be confident to know that we can provide you with the Ideal Commercial heating and hot water solution.

Contents

Condensing

4	Evomax
6	Evomax Frame and Header Kits
8	Evomax Low Height Frame and Header Kits
10	Imax Xtra
12	Evomod

Gas Atmospheric

14	Concord CXA/H CXS/H
16	Concord CXSi/H
18	Concord ESi

High Efficiency

20	Super Series 4
22	Super Plus

Pressure Jet

24	Buccaneer GTE
26	Falcon GTS
28	Harrier GTS
30	Viceroy GTS
32	Viscount GTS
34	Vanguard L

Cylinders

36	Commercial Unvented Cylinders
----	-------------------------------

Stelrad radiators

38-49	Stelrad Radiators
-------	-------------------

Training & Support

50	Ideal Commercial Training
51	Ideal Service & Support



FM 59915



OHS 593264



Evomax 30 -150 kW

Condensing



Evomax 30 - 150 kW

Available in outputs of 30, 40, 60, 80, 100, 120 and 150 kW, the Evomax is designed to ensure all installation requirements can be achieved. There is also an LPG Evomax range from 30 - 80 kW for off mains installations.

Features and benefits

- Largest range of outputs in market (30 - 150 kW)
- Robust & light aluminium silicon alloy heat exchanger
- Up to 110% part load efficiency
- High 5:1 turndown
- Compact – one width & height for easy siting
- Simple controls interface with large backlit display
- Comprehensive range of options
- Designed for easy installation, commissioning and servicing
- Quality product through design, component selection and proving
- NOx <40mg/kWh (Class 5) for all natural gas models
- 2 year parts and labour warranty



Authorised User No. 00041

Dimensions and clearances

Boiler	Dim A	Dim B	Dim C
30, 40, 60, 80	360	130	118
100, 120	520	226	118
150	610	233	120

The following minimum clearances must be maintained for operation and servicing.

- Top of boiler - dependent on flue size
- Sides of boiler - 25mm
- Bottom of boiler - 300mm
- Front of boiler - 450mm
- Clearance between multiple boiler installations - 25mm

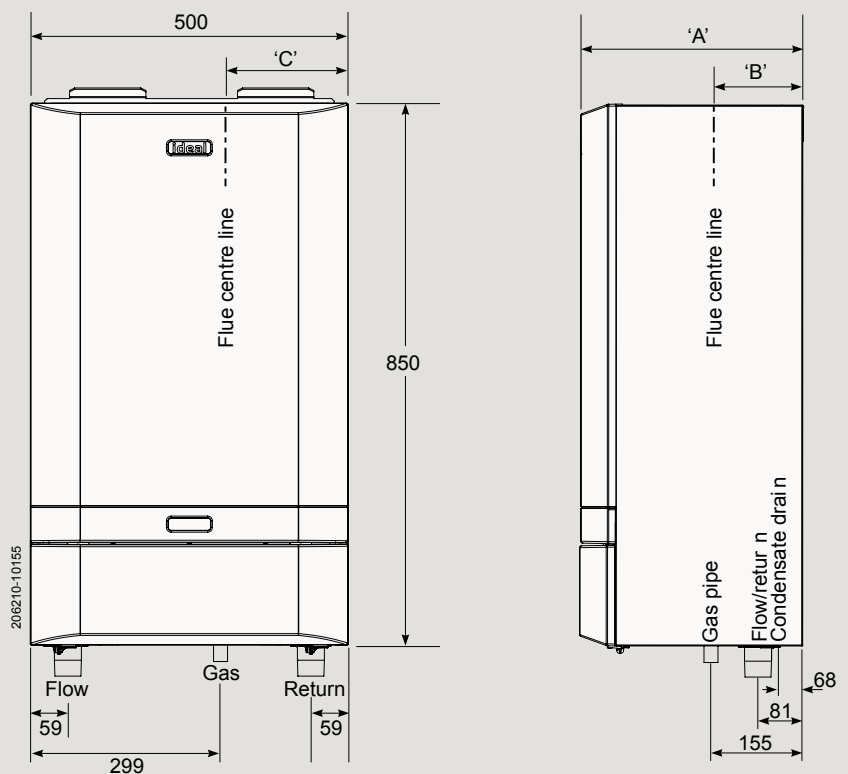

For full details of all configurations & specifications, please refer to the Evomax sales brochure.

All dimensions in mm

Evomax 30 - 150 kW

Model		30/30P	40/40P	60/60P	80/80P	100	120	150
Boiler output (condensing) min.	kW	6.5 / 6.4	8.5 / 8.3	12.7 / 15.5	17.2 / 21.2	21.6	26.0	32.5
Boiler output (condensing) max.	kW	31.54 / 30.9	42.0 / 41.2	63.5 / 62.1	84.4 / 82.6	103.9	124.7	158
Boiler output (non condensing) min.	kW	6	8	12 / 15	16 / 20	20	24	30
Boiler output (non condensing) max.	kW	30	40	60	80	100	120	150
Height	mm				850			
Width	mm				500			
Depth	mm	360					520	610
Flow connection	inch				G1¼			
Return connection	inch				G1¼			
Gas connection	inch				G¾			
Nominal flue size	mm	80/125					100/150	100/150*
Maximum flue lengths	m	42	42	7.5/30	12/35	20	17.6	7.5
Maximum working pressure	bar				4			
Water content	litre	3		5		7		9.2
Weight	kg	49		60.30		75.70		89.75
NOx emissions at 0% O ₂	mg/kWh	31 / 79	39.1 / 80	32.3 / 83.8	39.8 / 68	39.6	38.8	38.1
Seasonal efficiency	%	96.7 / 97.2	96.2 / 96.7	96.4 / 96.9	97.2 / 97.7	96.7	96.6	96.7

Max flow temperature 82°C. *For use with vertical flues only.

Included as standard

Boiler	Evomax
Remote indication (run & alarm)	✓
Hours run	✓
BMS (0-10v) operation	✓
Pump overrun	✓
Large backlit LCD controls, including 5 line plain text display	✓

Optional kits

Boiler	Evomax
Modulating sequencer kit (maximum 5 boilers)	✓
Programmable room thermostat kit	✓
Outside sensor kit	✓
Tank sensor kit	✓
Room sensor kit	✓
Safety interlock kit	✓
Pump kit	✓
Multi boiler frame & header kits	✓



Evomax Cascade

Frame and Header Kits



Boiler Frame and Header Kits

The Frame and Header Kits are suitable for modular (cascade) boiler installations, and are available up to a maximum output of 600 kW, in both in-line and back-to-back arrangements.

In-line kits

Packs include flow & return headers with mixing header and gas header, all with fixing brackets. For easy connection flexible stainless steel pipe and connections are supplied together with pressure relief valves, boiler shut off valves and drain cock. Appropriately sized ErP modulating shunt pumps are also included. Flow, return and low loss headers together with the flexible boiler connections are all pre insulated. Separate single boiler frame kits are available for use with in-line kits if required.



Back-to-back kits

Packs include all the in-line contents plus the required special frame kits for such compact installations.

Both types of kit are available for the following number of boilers and sizes. Mixing header kits and modulating pump kits are also available separately.

Available options

	Models	Size
2 boilers	30-100	DN80
2 boilers	120-150	DN80
3 boilers	30-100	DN80
3 boilers (back to back)	30-100	DN100
3 boilers	120-150	DN100
4 boilers	30-100	DN100
4 boilers	120-150	DN100
5 boilers	30-100	DN100
5 boilers	120	DN100
6 boilers	30-100	DN100

In-line kits do not include the support frame as the boilers can be wall mounted, but a frame kit is available if the wall is unsuitable to facilitate boiler mounting.

Please note, models 120 kW and 150 kW currently do not incorporate the modulating pump. For full details of all configurations & specifications, please refer to the Evomax sales brochure.

In-line Frame & Header Kits 3 x Evomax 30 - 150 kW

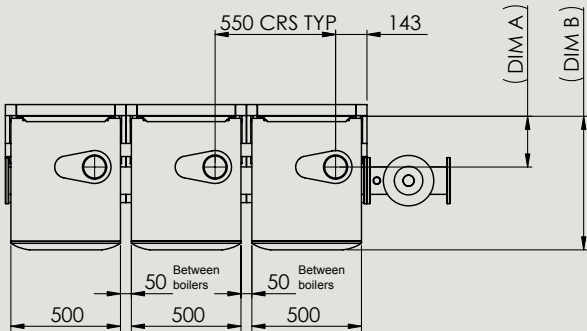

Output	DIM A	DIM B	DIM C	D (DN flange)	Concentric flue
30-80 kW	128	360	413	DN80	80/125
100 kW	224	520	573	DN80	100/150
120 kW	224	520	573	DN100	100/150
150 kW	232	610	663	DN100	100/150

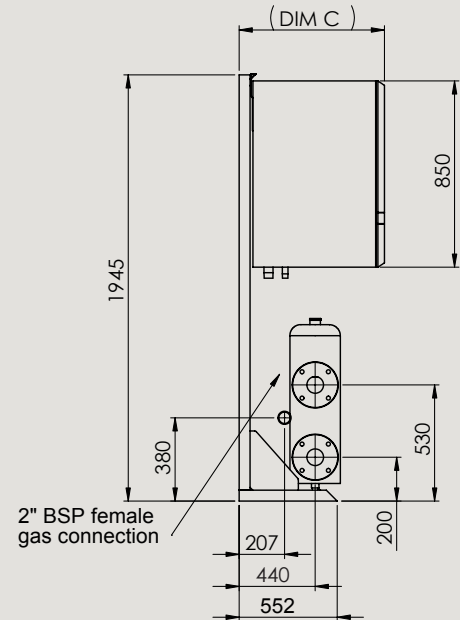
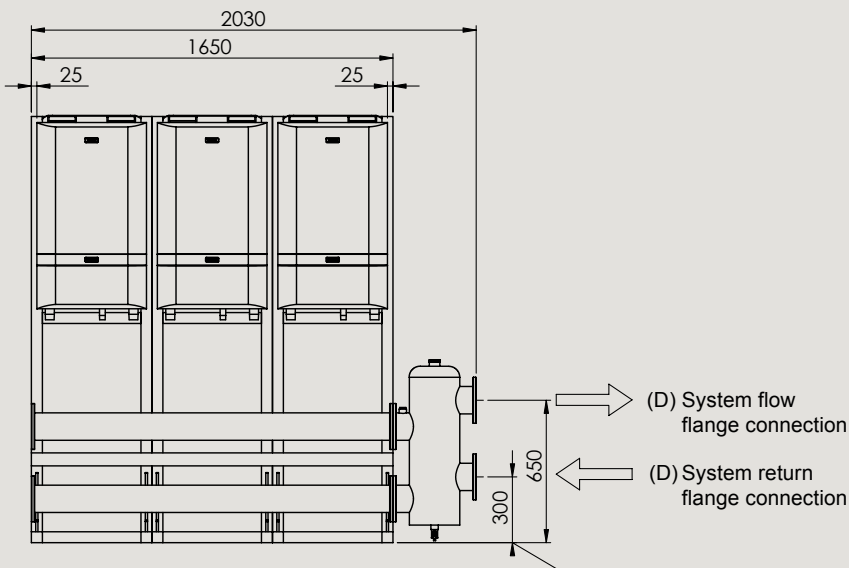

If not wall mounting the boiler, a frame is required per appliance.
 Mixing header and gas connections can be located either on the LHS or RHS of the assembly to suit needs of each particular system.



Evomax Cascade

Low Height Frame and Header Kits



Boiler Frame and Header Kits

The Low Height Frame and Header Kits make installation much simpler in circumstances of reduced headroom, offering an option of replacing a floor standing atmospheric boiler with a high efficiency model.

Three options are available allowing for outputs from 30 kW to 450 kW.

Features and benefits

- Frame and Header Kits fit easily through standard doorways
- Lift weights are as low as possible
- The Low Height Frame and Header Kit is supplied on one palette shrink wrapped together with all ancillary fittings needed for assembly
- All pipe work connections are supplied with either the boiler, header kit or are preassembled to the header kit
 - Preassembled to header; the boiler the flow and return flexible connections, which reduce installation time
 - Delivered with header kit; connection pipe assembly, non return valves & pipe work connector all isolation valves, pressure relief valve, drain cock and associated fittings
- The Low Height Frame and Header Kit can be installed with either an Ideal Commercial Sequencer offering direct modulation of the system, reducing running costs, or a proprietary option
- The extremely compact dimensions allow for replacement of existing standard efficiency floor standing boilers, using a single wall mounted condensing boiler up to 150 kW allowing sufficient space to install flue system, pump and pipe headers
- High quality and well-finished components
- Supplied with frames and low energy modulating pumps (ErP approved)

Please note, the Evomax boilers are to be ordered separately.

Available options

	Models	Size
1 boiler	30-150	DN50 (2" BSP)
2 boilers	60-300	DN65
3 boilers	90-450	DN80

In-line Frame and Header Kits 3 x Evomax 30 - 150 kW

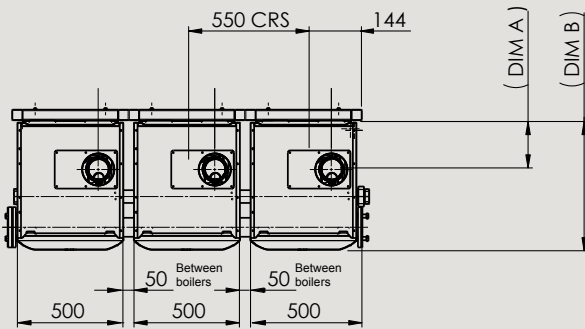

Output	DIM A	DIM B	DIM C	D (DN flange)	Concentric flue
30-150 kW	130	642	410	DN50 (2" BSP)	80/125
60-300 kW	226	642	570	DN65	100/150
90-450 kW	233	642	660	DN80	100/150

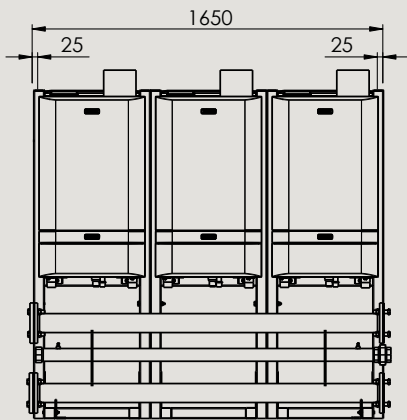

→ (D) System flow
flange connection

← (D) System return
flange connection

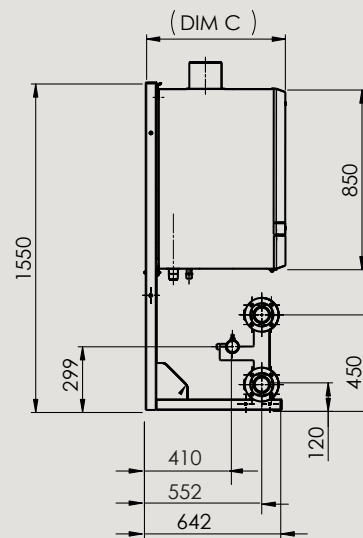

Imax Xtra 80 - 560 kW

Floor Standing / Condensing



Imax Xtra 80 - 560 kW

The Imax Xtra range of condensing boilers is offered in ten models with outputs from 80 to 560 kW suitable for floor standing application in either single or multiple applications.

Features and benefits

- Robust cast aluminium silicon alloy heat exchanger
- In-built commissioning and fault diagnostics
- Volt free contacts and BMS operation standard
- Meets Building Regulations (Part L2)
- Compact size - small footprint
- High 5:1 turndown
- Up to 107.5% nett efficiency (fully condensing)
- Fits through standard doorways
- Conventional or room sealed flue options
- Direct weather compensation option
- NOx <40mg/kWh (Class 5)
- 2 year parts and labour warranty

Dimensions and clearances

Boiler	Dim A	Dim B	Dim C
80	600	1150	1024
120	600	1150	1024
160	600	1150	1024
200	600	1150	1327
240	600	1150	1327
280	600	1150	1327
320	1200	1150	1004
400	1200	1150	1326
480	1200	1150	1326
560	1200	1150	1326

The following minimum clearances must be maintained for operation and servicing.

- Top of boiler - n/a
- Sides of boiler (models 80-280) - LH 450mm, RH 150mm
- Sides of boiler (models 320-560) - 450mm
- Rear of boiler (models 80-280) - 700mm
- Rear of boiler (models 320-560) - 1000mm
- Front of boiler - 600mm

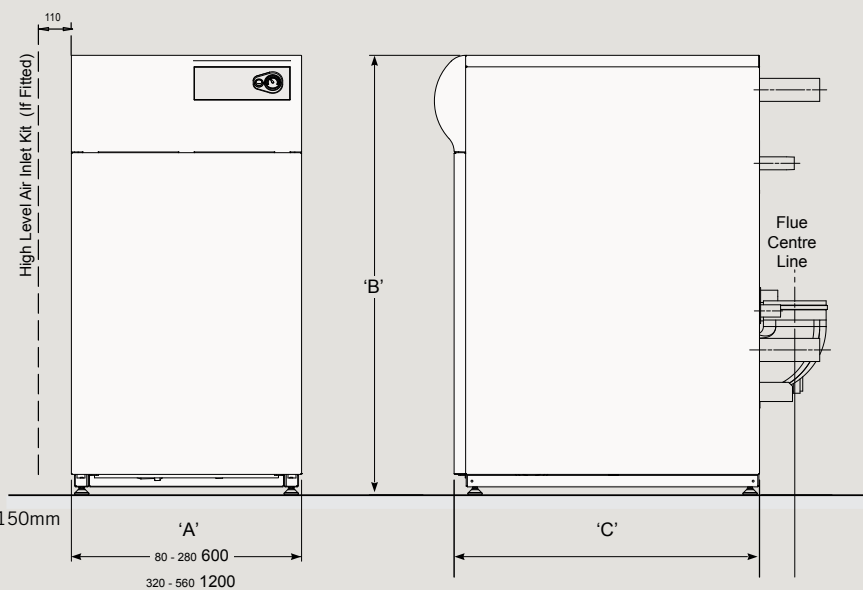

For full details of all configurations & specifications, please refer to the condensing boilers sales brochure.

Imax Xtra 80 - 560 kW

Model		80	120	160	200	240	280	320	400	480	560	
Boiler Output (condensing) 40°C min.	kW	25.8	25.8	32.3	47.3	51.6	55.9	75.3	107.5	116.1	118.3	
Boiler Output (condensing) 40°C max.	kW	82.2	123.4	164.5	207.8	249.4	290.9	329.0	415.6	498.8	581.8	
Boiler Output (non-condensing) 70°C min	kW	23.3	23.3	29.1	43.1	47.0	51.0	67.8	97.7	105.5	107.7	
Boiler Output (non-condensing) 70°C max.	kW	77.9	116.9	155.8	195.4	234.5	273.6	311.6	390.8	469.0	547.2	
Height	mm	1150										
Width	mm	600						1200				
Depth	mm	1024			1327			1004	1326			
Flow connection (BSP)	inch	R2"						80*				
Return connection (BSP)	inch	R2"						80*				
Gas connection (BSP)	inch	R1"						R2"				
Nominal flue size / concentric	mm	150			200			250				
Flue header								✓	✓	✓	✓	
Maximum working pressure	bar	6										
Water content	litre	11.0	14.3	17.5	18.4	24.0	27.2	35.0	36.8	48.0	54.4	
Approx dry weight	kg	132	150	168	198	215	233	336	396	430	466	
Boiler clearances	front (mm)	600										
	back (mm)	700						1000				
	side (mm)	LH-450 RH-150						450				
NOx emissions at 0% O ₂	mg/kWh	26	26	35	26	26	26	35	26	26	26	
Seasonal efficiency	%	95.13			95.18			95.13	95.18			

*DN flange. Flow, return and gas connection sizes shown are for the optional header kit. If header kit not used: Flow & return connections are 2 x R2. Gas connection is 2 x R1.

Optional kits

Boiler	Imax Xtra	
	80 - 280	320 - 560
Modulating sequence control for controlling multiple boiler installations	✓	✓
Programmable room thermostat	✓	✓
Tank sensor kit	✓	n/a
BMS control kit (0-10V)	standard	standard
Outside sensor kit	✓	✓
Room sensor kit	✓	✓

Boiler	Imax Xtra	
	80 - 280	320 - 560
Sequencer DHW sensor kit	✓	✓
Control interface kit	standard	standard
Flow, return & gas header kit	n/a	✓
RS air duct connector	n/a	320/400 only
Horizontal flue connector †	n/a	✓
Vertical flue connector †	n/a	✓

† Appropriate flue connector kits are mandatory for use with the 320-560 kW output boilers as per CE approvals.



Evomod 250 - 1000 kW

Modular / Condensing



Evomod 250 - 1000 kW

Available in 250, 500, 750 and 1000 kW, the Evomod will achieve an output up to 1MW from a single unit solution together with a minimum footprint that enables the product to be installed where space is limited. Each module provides a maximum of 250 kW heat output and will modulate down through a sophisticated control system.

Features and benefits

- Modules up to 3 high stacking
- Stainless steel heat exchanger
- Built in module diagnostics, sequencing and remote indication
- Plain text display for fast and easy use
- Single flue outlet, system, gas and electrical connections
- Up to 20:1 turndown
- Easy access for servicing
- Minimum footprint with easy site handling and standard doorway access
- NOx <40mg/kWh (Class 5)
- 2 year parts and labour warranty
- Up to 108.5% nett efficiency (fully condensing)
- Single boiler control for all module options



Authorised User No. 00041

Dimensions and clearances

Boiler	Dim A	Dim B	Dim C
250	710	860	1399
500	710	1480	1399
750	710	2100	1399
1000	1420	1428	1399

The following minimum clearances must be maintained for operation and servicing.

- Top of boiler - 300mm
- Left of boiler - 400mm
- Right of boiler - 450mm
- Rear of boiler - 750mm
- Front of boiler - 600mm

For full details of all configurations & specifications, please refer to the Evomod sales brochure.

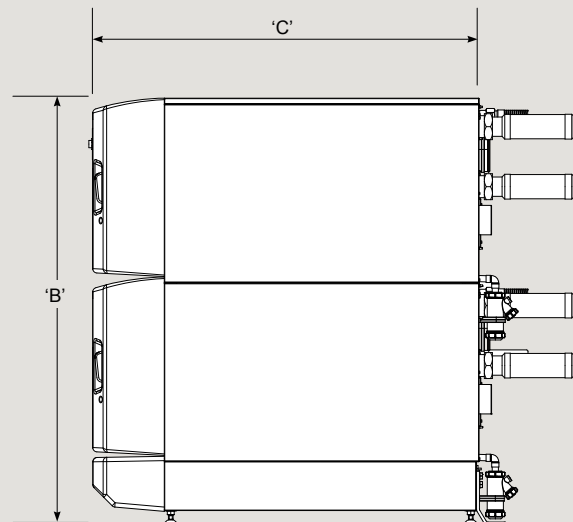
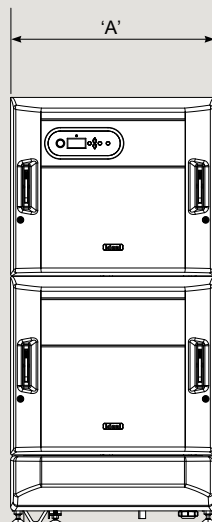

Evomod 250 - 1000 kW

Model		250	500	750	1000
Boiler output (condensing) min.	kW			46.7	
Boiler output (condensing) max.	kW	252.5	505	757.5	1010
Boiler output (non condensing) min.	kW			51.4	
Boiler output (non condensing) max.	kW	232.5	465	697.5	930
Height	mm	860	1480	2100	1428
Width	mm		710		1420
Depth	mm			1339	
Depth inc headers & flue	mm	1775		2118	
Flow connection	inch	2½ PN16		5 PN16	
Return connection	inch	2½ PN16		5 PN16	
Gas connection	inch	R1¼		R2	R2½
Nominal flue size	mm	150		250	300
Maximum working pressure	bar			6	
Water content	litre	14.8	29.6	44.4	59.2
Weight	kg	229	420	611	845
NOx emissions at 0% O ₂	mg/kWh			39.7	
Seasonal efficiency	%			95.9	

Included as standard

Boiler	Evomod
Remote indication (run & alarm)	✓
Hours run	✓
BMS (0-10v) operation	✓
Pump overrun	✓
Large backlit LCD controls, including 5 line plain text display	✓

Optional kits

Boiler	Evomod
Water & gas header assembly packaged	✓
Water & gas header assembly c/w valves packaged	✓
Water connection kit (250)	✓
Air inlet collar	✓



Concord CXA/H, CXS/H 40-120 kW

Gas Atmospheric



Concord CXA/H, CXS/H 40 - 120 kW

The Concord CXA and CXS ranges are available in 9 model sizes from 40 kW to 120 kW*. All models are suitable for installation in modular configurations – just 6 boilers can provide up to 720 kW output.

Features and benefits

- Ultra reliable gas atmospheric boilers
- High, full and part load efficiencies
- Auto ignition
- Remote indication kit options
- CXA/H natural gas (40 - 120 kW)
or propane CXA P/H (40 - 100 kW)
- CXA/H is On/Off and CXS/H is High/Low operation
- Assembled as standard
- Can be delivered in sections as special
- 1 year parts and labour warranty

* Up to 100 kW for propane models.

Dimensions and clearances

Boiler	Dim A	Dim B	Dim C
40	600	1000	750
50 - 60			882
70 - 80			1042
90 - 100			1212
110 - 120			1385
110 - 120			1385

The following minimum clearances must be maintained for operation and servicing.

- Top of boiler - n/a
- Sides of boiler (40-80H) - 50mm
- Sides of boiler (90-120H) - 100mm
- Rear of boiler (40-60H) - n/a
- Rear of boiler (70 & 80H) - 150mm
- Rear of boiler (90-120H) - 300mm
- Front of boiler - 750mm

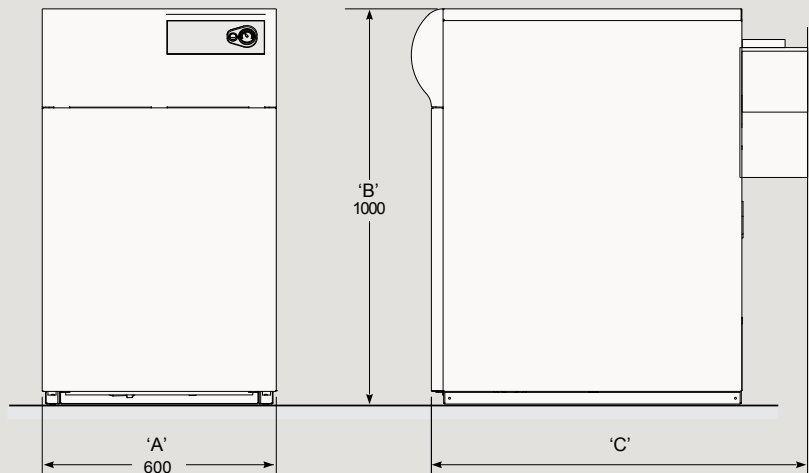

Concord CXA/H, CXS/H 40 - 120 kW

Model	Natural gas	40	50	60	70	80	90	100	110	120	
Sections		3	4		5		6		7		
Output	kW	40	50	60	70	80	90	100	110	120	
Height	mm	1000									
Width	mm	600									
Depth	mm	750	882		1042		1212		1385		
Flow / return connection (BSP)	inch	RC2									
Gas connection (BSP)	inch	RC¾					RC1				
Flue size	mm	150		175		200		250			
Maximum working pressure	bar	6									
Water content	litre	22	30		37		45		53		
Approx dry weight	kg	210	265		330		395		490		
Boiler clearances	front (mm)	750									
	back (mm)	0			150			300			
	side (mm)	50					100				
Seasonal efficiency CXA/H	%	83.6	83.4	83.3	82.4	82.6	83.7	82.2	83.6	84.8	
Seasonal efficiency CXS/H	%	82.2	81.8	82.7	82.1	82.5	82.6	83.2	84.2	82.7	

Concord CXA/H, CXS/H 40 - 100P/H kW

Model	Propane	40P	50P	60P	70P	80P	90P	100P	
Sections		3	4		5		6		
Output	kW	40	50	60	70	80	90	100	
Height	mm	1000							
Width	mm	600							
Depth	mm	750	882		1042		1212		
Flow / return connection (BSP)	inch	RC2							
Gas connection (BSP)	inch	RC¾					RC1		
Flue size	mm	150		175		200			
Maximum working pressure	bar	6							
Water content	litre	22	30		37		45		
Approx dry weight	kg	210	265		330		395		
Boiler clearances	front (mm)	750							
	back (mm)	0			150		300		
	side (mm)	50					100		
Seasonal efficiency CXS/H propane	%	85.4	85.3	85.1	84.3	84.4	85.6	84.0	

Optional kits

Boiler	CXA	CXS
Volt free contacts, boiler run, overheat & lockout	✓	✓
Down draft thermostat kit	✓	✓

Boiler	CXA	CXS
Header kits (available from merchants)	✓	✓
Propane models	✓	

Note: Down draft thermostat kit is mandatory on multiple installations.

Concord CXSi/H 110 - 180 kW

Gas Atmospheric



Concord CXSi/H 110 - 180 kW

Ideal's Concord CXSi range offers reliable gas atmospheric cast iron boilers, available in outputs from 110 kW up to 180 kW.

Flexibility of installation is provided through site assembled or factory assembled availability.

Features and benefits

- Ultra reliable gas atmospheric boilers
- High, full and part load efficiencies
- Auto ignition
- Remote indication kit options
- Site assembly as standard
- Works assembly option
- High/Low operation
- 1 year parts and labour warranty

Dimensions and clearances

Boiler	110	120	140	160	180
Dimension A	1036	1036	1036	1086	1140
Dimension B	175	175	175	197	250
Dimension C	1107	1107	1230	1353	1476
Dimension D	816	816	939	1062	1185
Dimension E	553	553	615	676	738
Dimension F	220	220	220	220	320

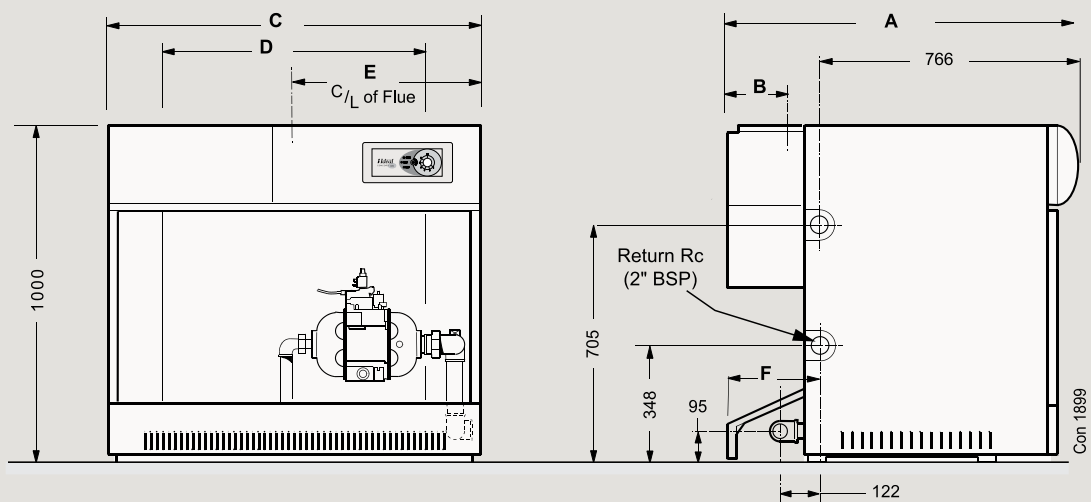

Concord CXSi/H 110 - 180 kW

Model		110	120	140	160	180
Sections		7		8	9	10
Output	kW	110	120	140	160	180
Height	mm	1000				
Width	mm	1107		1230	1353	1476
Depth	mm	1036			1086	1140
Flow / return connection (BSP)	inch	Flow: DN65 Flange. Return RC2				
Gas connection (BSP)	inch	RC1½				
Flue size	mm	250				300
Maximum working pressure	bar	6				
Water content	litre	53		60	68	76
Approx dry weight	kg	520		587	654	721
Boiler clearances	front (mm)	700				
	back (mm)	200				
	side (mm)	100 (not including clearance for side fitted flow header)				
Seasonal efficiency	%	83.19	81.87	82.67	83.03	82.97

Boiler	CXSi
Volt free contacts, alarm & boiler run conditions	✓



Concord ESi 140 - 380 kW

Gas Atmospheric



Concord ESi 140 - 380 kW

The Concord ESi is a sectional cast iron boiler, with an atmospheric two stage gas burner and electronic ignition via an ignition burner. The heat output is adjustable to 85% of full the output. The Concord ESi is suitable for natural gas only.

Features and benefits

- High/Low adjustable operation on all models
- High, full and part load efficiencies
- Robust cast iron heat exchanger
- Easy to install and service
- Low return temperature capability
- Site assembly as standard
- 1 year parts and labour warranty

Dimensions and clearances

Boiler	140	160	180	200	220	260	300	340	380
Dimension A	1362	1362	1362	1362	1362	1412	1412	1412	1462
Dimension B	970	1058	1146	1234	1322	1498	1674	1850	2026
Diameter C ϕ	250	250	300	300	300	350	350	350	400
Dimension D	632	720	808	896	984	1160	1336	1512	1688
Dimension E	165	165	165	165	165	190	190	190	220
Dimension F	1406	1406	1406	1406	1406	1406	1406	1406	1406

All models dimensions and clearances on page opposite.

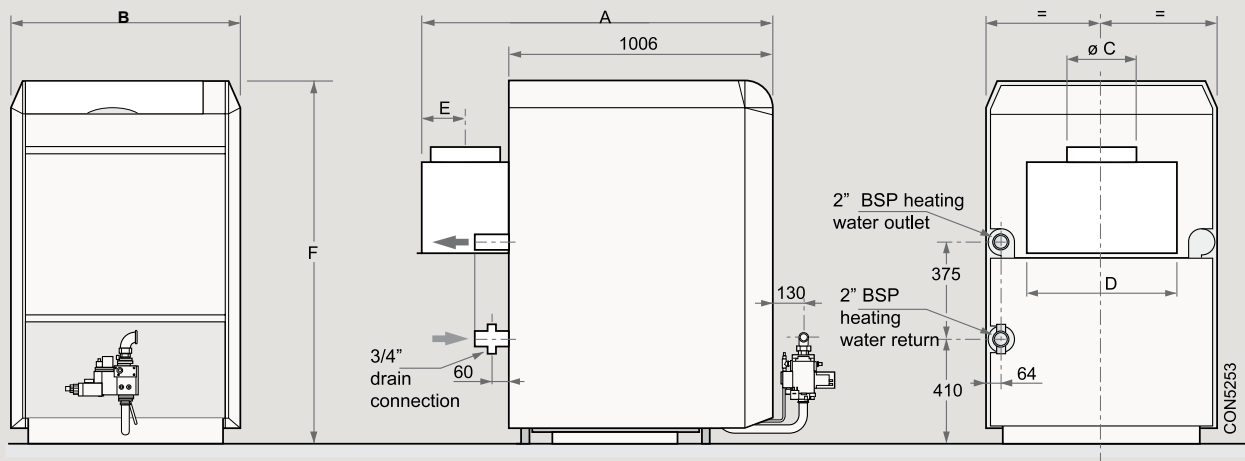

Concord ESi 140 - 380 kW

Model		140	160	180	200	220	260	300	340	380
Sections		8	9	10	11	12	14	16	18	20
Output	kW	140	160	180	200	220	260	300	340	380
Height	mm	1406								
Width	mm	970	1058	1146	1234	1322	1498	1674	1850	2026
Depth	mm	1362					1412			1462
Flow / return connection (BSP)	inch	R2								
Gas connection (BSP)	inch	RP1					RP1¼			RP1½
Flue size	mm	250		300			350		400	
Maximum working pressure	bar	6								
Water content	litre	61	68	76	84	91	106	122	137	154
Approx dry weight	kg	575	635	690	750	805	920	1035	1150	1350
Boiler clearances	front (mm)	1000								
	back (mm)	(measured from rear edge of jacket) (mm) 500								
		At sides water connection side (RH or LH) (mm) 400								
		At sides non connection side (RH or LH) (mm) 200								
Seasonal efficiency	%	81.71	82.02	82.33	82.64	82.87	83.18	83.44	83.67	83.91

Optional kits

Boiler	ESi
Hours run meter (1 or 2 hours)	✓
Flue gas thermometer	✓
DHW sensor kit	✓



Super Series 4 50 - 600 kW

High Efficiency



Super Series 4 50 - 600 kW

The Super Series 4 comprises of identical 50 kW modules with heat outputs from 50 kW to 600 kW, with the number of modules in use dependent on the maximum load.

Features and benefits

- Proven and reliable technology for over 20 years
- Vertical and horizontal models
- High efficiency 85% (gross CV)
- 50 kW Modules
- Sequence controlled
- Small footprint
- Complete package including gas/water headers
- Low noise
- Easy to install and service
- NOx Class 5
- 1 year parts and labour warranty

Dimensions and clearances

Boiler	Dim A	Dim B	Dim C
250/V	1171	1967	
250/H	1783	1443	698
300V	1171	1972	

All models dimensions and clearances on page opposite.

The following minimum clearances must be maintained for operation and servicing. All models clearances and dimensions on page opposite.

Clearances for 250V - 300V models:

- Top of boiler - n/a
- Left of boiler - 900mm
- Right of boiler - 900mm
- Rear of boiler - 25mm
- Front of boiler - 950mm

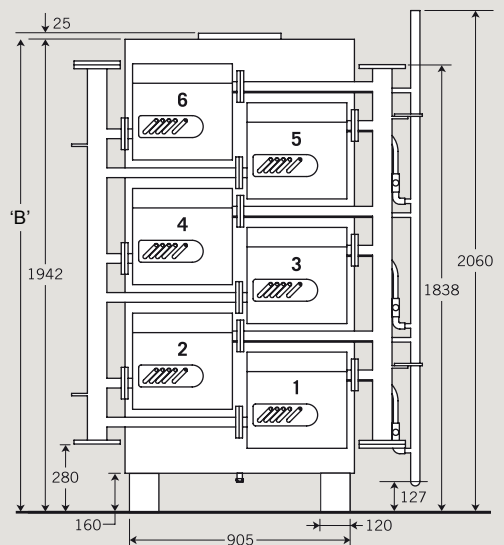
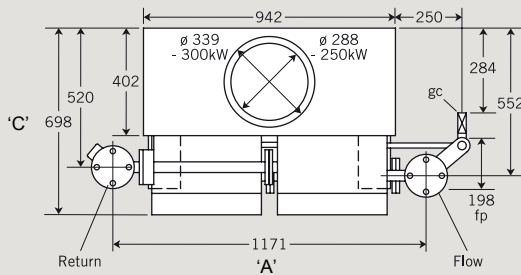

250 / 300 kW
Vertical

For full details of all configurations & specifications, please refer to the Super Series sales brochure and installation manual.

Super Series 4 50 - 600 kW

Model		50/V	100/V	150/V	150/VA	200/V	250/V	250/H	300/V	300/H
Sections		1	2	3		4	5		6	
Output	kW	50	100	150		200	250		300	
Height	mm	782	1432	1912	1487		1967	1443	1972	1443
Width	mm	439	701		1171			1783	1171	1783
Depth	mm	698								
Flow / return connection (BSP)	inch	40	50	65			80			
Gas connection (BSP)	inch	RC $\frac{3}{4}$	RC1	RC1 $\frac{1}{4}$	RC1 $\frac{1}{4}$	RC1 $\frac{1}{4}$	RC1 $\frac{1}{2}$	RC1 $\frac{1}{2}$	RC1 $\frac{1}{2}$	RC1 $\frac{1}{2}$
Flue size	mm	125	175	200		250			300	
Maximum working pressure	bar	6								
Water content	litre	4.5	11.9	20.7	21.7	26.2	37.7	39.7	44.5	
Approx dry weight	kg	82.1	187.7	274.1	296.4	348	461	411.2	511.2	513.7
Boiler clearances	front (mm)	950								
	back (mm)	25								
	left (mm)	450	900							
	right (mm)	450	900							
Seasonal efficiency	%	84.50	84.39	84.75		84.96				

Model		350/V	400/V	450/V	450/H	500/V	500/H	550/V	550/H	600/V	600/H
Sections		7	8	9		10		11		12	
Output	kW	350	400	450		500		550		600	
Height	mm	1618		2144	1345	2144	1345	2144	1345	2144	1345
Width	mm	1822		1833	2393	1833	2393	1833	2392	1833	2393
Depth	mm	1350									
Flow / return connection (BSP)	inch	100			125						
Gas connection (BSP)	inch	RC2									
Flue size	mm	350		400				450			
Maximum working pressure	bar	6									
Water content	litre	63.3	68.1	97.6	92.6	102.4	97.4	107.2	102.2	112	107
Approx dry weight	kg	765	813	985	972	1033	1020	1080	1067	1129	1115
Boiler clearances	front (mm)	950									
	back (mm)	950									
	left (mm)	1200									
	right (mm)	1200									
Seasonal efficiency	%	84.96									

Optional kits

Boiler	Super Series 4
Water flow switch for boiler protection in the event of pump failure	✓
External sequencer control kit	✓
Module blanking off pack	✓

Super Plus 200 - 600 kW

High Efficiency



Super Plus 200 - 600 kW

Super efficient, straightforward to specify, easy to install and service. The Super range is an established performer in high efficiency modular boiler systems, comprising of identical 100 kW modules with outputs from 200 kW to 600 kW.

Features and benefits

- Proven and reliable technology for over 25 years
- Easy to install and service
- High efficiency 85% (gross)
- 100 kW Modules
- Small footprint
- Sequence controlled
- Complete package including gas and water headers
- NOx Class 5
- 1 year parts and labour warranty

Dimensions and clearances

Boiler	Dim A	Dim B	Dim C
300/3	1510	1900	990
400/4			
500/5	2115		

All models dimensions and clearances on page opposite.

The following minimum clearances must be maintained for operation and servicing. All models clearances and dimensions on page opposite.

Clearances for all models:

- Top of boiler - n/a
- Left of boiler - 500mm
- Right of boiler - 500mm
- Rear of boiler - 25mm
- Front of boiler - 900mm

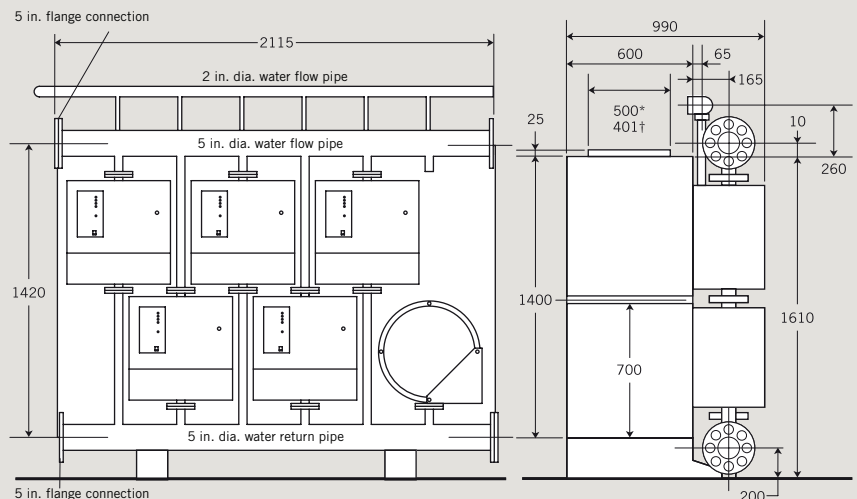

500* for 18in. flue pipe = Super Plus 500/5 & 600/6
 400† for 14in. flue pipe = Super Plus 300/3 & 400/4

For full details of all configurations & specifications, please refer to the Super Series sales brochure and installation manuals.

Super Plus 200 - 600 kW

Model		200/S	300/3	300/3A	400/4	400/4A	500/5	600/6	
Modules		2	3		4		5	6	
Output	kW	200	300		400		500	600	
Height	mm	1800							
Width	mm	910	1510	2115	1510	2115			
Depth	mm	990							
Flow / return connection (BSP)	inch	65					125		
Gas connection (BSP)	inch	RC1½			RC2				
Flue size	mm	250	350		450				
Maximum working pressure	bar	6							
Water content	litre	19.8	29.7		39.7		49.5	59.4	
Approx dry weight	kg	328.3	466.4	466.4	546.1		715.6	794.6	
Boiler clearances	front (mm)					900			
	back (mm)					25			
	left (mm)					500			
	right (mm)					500			
Seasonal efficiency	%	84.12	84.69	84.67			84.96		

Optional kits

Boiler	Super Plus
Water flow switch for boiler protection in the event of pump failure	✓
Remote indication of boiler on, lockout and overheat for each module	✓
Module blanking off pack	✓



Buccaneer GTE 21 - 39 kW

Pressure Jet



Buccaneer GTE 21 - 39 kW

Buccaneer GTE boilers are fully automatically controlled floor standing boilers designed for connecting to a flue pipe and require a separate automatic fuel oil or gas burner.

Features and benefits

- Gas or oil fired
- High efficiency
- Minimal emissions
- Compact size
- 3 pass cast iron heat exchanger
- Comprehensive control
- Low temperature operation
- Assembled
- Single phase only
- Packaged boiler include Nuway, Riello or EOGB as standard (options can be supplied on request)
- 1 year parts and labour warranty

Dimensions and clearances

Boiler	GTE4	GTE5	GTE6
Dimension B	692	819	946
Dimension C	812	939	1066
Diameter ø D	125	125	153
Dimension E	427	554	681
Dimension F	50	50	99

All Models dimensions and clearances on page opposite.

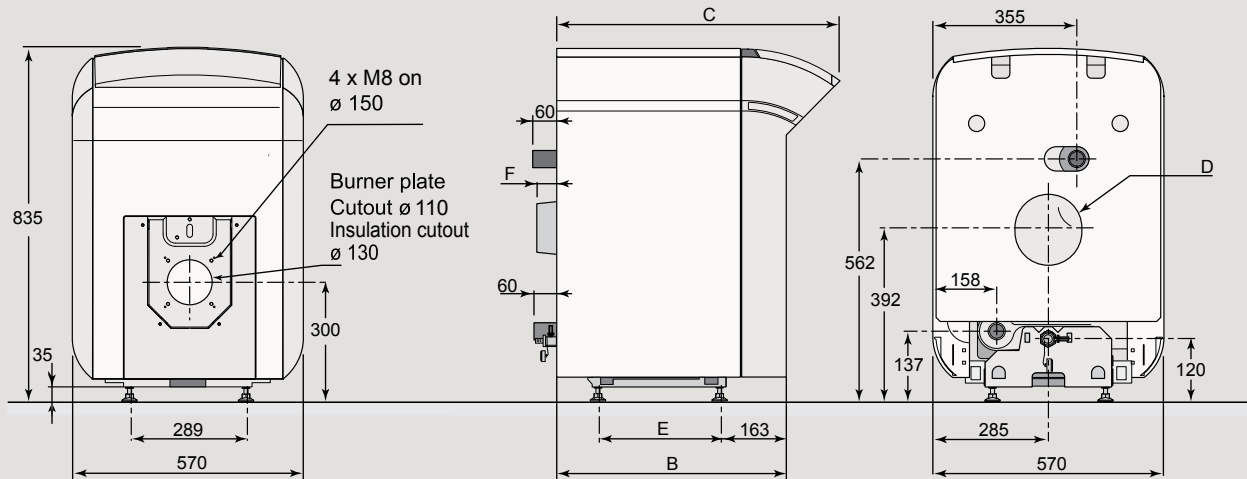

Buccaneer GTE 21 - 39 kW

Model		GTE 4	GTE 5	GTE 6
Sections		4	5	6
Output	kW	21 - 27	27 - 33	32 - 39
Height	mm		835	
Width	mm		570	
Depth	mm	812	939	1066
Flow / return connection (BSP)	inch		R1¼	
Flue size	mm	125		153
Maximum working pressure	bar			4
Water content	litre	24.5	30.0	35.5
Approx dry weight	kg	182	210	238
Boiler clearances	front (mm)			1000
	back (mm)			500
	left (mm)			500
	right (mm)			500
Seasonal efficiency	(gas) %	85.51	84.68	84.18
	(oil) %	88.90	88.10	87.60

Optional kits

Boiler	Buccaneer GTE
Flue gas thermometer	✓
DHW sensor	✓



Falcon GTS 40 - 100 kW

Pressure Jet



Falcon GTS 40 - 100 kW

The Falcon GTS range of cast iron sectional pressure jet boilers offers high efficiency operation, ease of maintenance, fuel flexibility and low emissions in a compact package. Suitable for oil or gas operation the Falcon GTS is supplied in a choice of 5 standard models, rated in outputs from 40 kW to 100 kW

Features and benefits

- Gas fired, oil fired or dual fuel
- High efficiency
- 3 pass cast iron heat exchanger
- Compact size
- Comprehensive control (on/off or high/low)
- Low temperature operation
- Site assembly
- Works assembly option
- Single phase only
- Packaged boiler include Nuway, Riello or EOGB as standard (options can be supplied on request)
- 1 year parts and labour warranty

Dimensions and clearances

Boiler	GTS 4	GTS 5	GTS 6	GTS 7	GTS 8
Dimension A	700	827	954	1081	1208
Dimension B	772	899	1026	1153	1208
④ Diameter ø	153	153	180	180	180
Dimension E	380	507	634	761	888

All Models dimensions and clearances on page opposite.

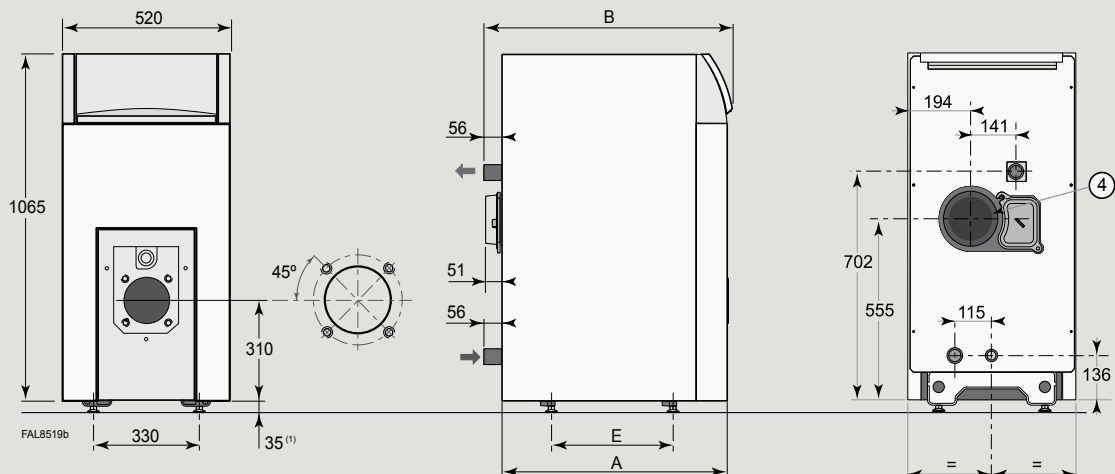

Falcon GTS 40 - 100 kW

Model		GTS 4	GTS 5	GTS 6	GTS 7	GTS 8
Modules		4	5	6	7	8
Output	kW	40 - 50	50 - 64	64 - 78	78 - 92	92 - 100
Height	mm	1100				
Width	mm	520				
Depth	mm	772	899	1026	1153	1280
Flow / return connection (BSP)	inch	R1¼				
Flue size	mm	153			180	
Maximum Working Pressure	bar	4				
Water content	litre	36	43	50	57	64
Approx dry weight	kg	254	296	344	381	423
Boiler clearances	front (mm)	1000				
	back (mm)	500				
	left (mm)	500				
	right (mm)	500				
Seasonal efficiency	(gas) %	84.37	84.54	84.79	84.77	84.83
	(oil) %	87.70	87.90	88.20		

Optional kits

Boiler	Falcon GTS
DHW sensor	✓



Harrier GTS 105 - 330 kW

Pressure Jet



Harrier GTS 105 - 330 kW

Suitable for oil or gas operation the Harrier GTS range is supplied in a choice of 5 standard models, rated in outputs from 105 kW to 330 kW and has a maximum operating pressure of 6 bar. High/low operation available on all models.

Features and benefits

- Gas fired, oil fired or dual fuel
- High efficiency
- Minimal emissions
- 3 pass cast iron heat exchanger
- Compact size
- Left or right hinged burner door
- Site assembly
- Single phase or 3 phase
- Packaged boiler include Nuway, Riello or EOGB as standard (options can be supplied on request)
- Low NOx and fully modulating burners available *on request*
- 1 year parts and labour warranty

Dimensions and clearances

Boiler	GTS 5	GTS 6	GTS 7	GTS 8	GTS 9
Dimension A	130	130	130	130	130
Dimension B	105	105	105	105	105
Dimension C	165	165	165	165	165
Dimension D	738	738	738	738	738
Dimension H	1297	1297	1297	1297	1297
Dimension L	1151	1311	1471	1631	1791
Dimension P	650	810	970	1130	1290
Diameter Ø R	180	180	200	200	200

All models dimensions and clearances on page opposite.

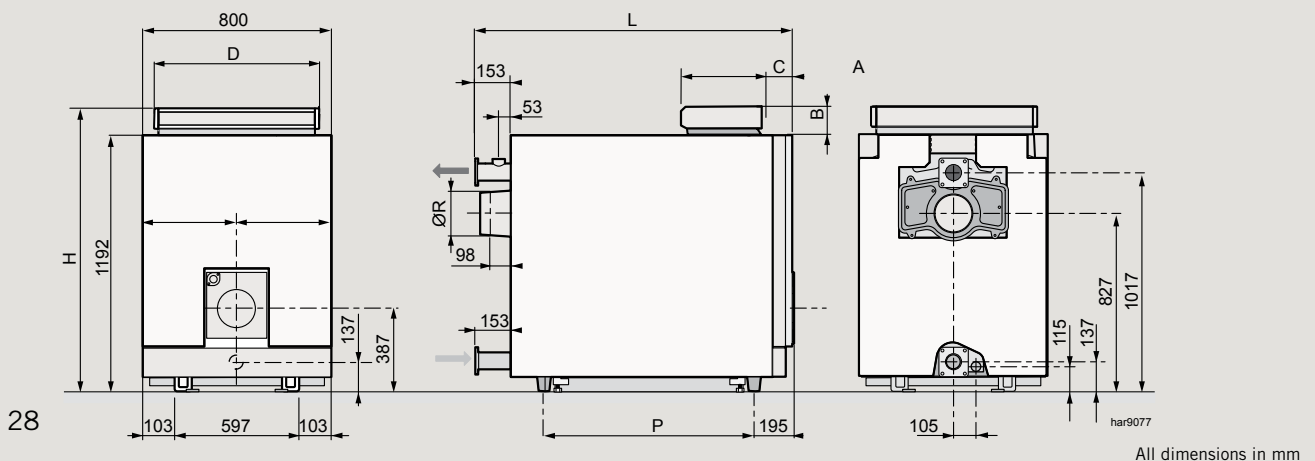

Harrier GTS 105 - 330 kW

Model		GTS 5	GTS 6	GTS 7	GTS 8	GTS 9
Sections		5	6	7	8	9
Output	kW	140	180	230	280	330
Height	mm	1297				
Width	mm	800				
Depth	mm	1151	1311	1471	1631	1791
Flow / return connection (DN flange)		65				
Flue Size	mm	180			200	
Maximum working pressure	bar	6				
Water content	litre	116	136	156	176	196
Approx dry weight	kg	736	846	981	1103	1230
Boiler clearances	front (mm)	1500				
	back (mm)	1000				
		Side - non hinge (mm) 100 Side - door hinge (mm) 500 or 200 + burner length				
Seasonal efficiency	(gas) %	83.87	84.00	84.55	84.64	84.82
	(oil) %	87.20	87.40	87.90	88.00	88.20

Optional kits

Boiler	Harrier GTS
Flue gas thermometer	✓



Viceroy GTS 300 - 780 kW

Pressure Jet



Viceroy GTS 300 - 780 kW

Suitable for oil or gas operation the Viceroy GTS range is supplied in a choice of 7 standard models, rated in outputs from 300 kW to 780 kW and has a maximum operating pressure of 6 bar. All models have high/low operation.

Features and benefits

- Gas fired, oil fired or dual fuel
- High efficiency
- Compact size
- 3 pass cast iron heat exchanger
- Quick and simple erection
- Left or right hinged burner door
- Site assembly
- Single phase or 3 phase
- Packaged boiler include Nuway, Riello or EOGB as standard (options can be supplied on request)
- 1 year parts and labour warranty

Dimensions and clearances

Boiler	GTS 8	GTS 9	GTS 10	GTS 11	GTS 12	GTS 13	GTS 14
Outside diameter	250	250	250	300	300	300	300
Dimension J	1800	1950	2120	2305	2465	2465	2785
Dimension L	1505	1665	1825	1985	2145	2305	2465
Dimension S	1183	1343	1503	1663	1823	1983	2143
Dimension K	1605	1605	1605	1605	1605	1605	1605
Dimension M	738	738	738	738	738	738	738

All models dimensions and clearances on page opposite.

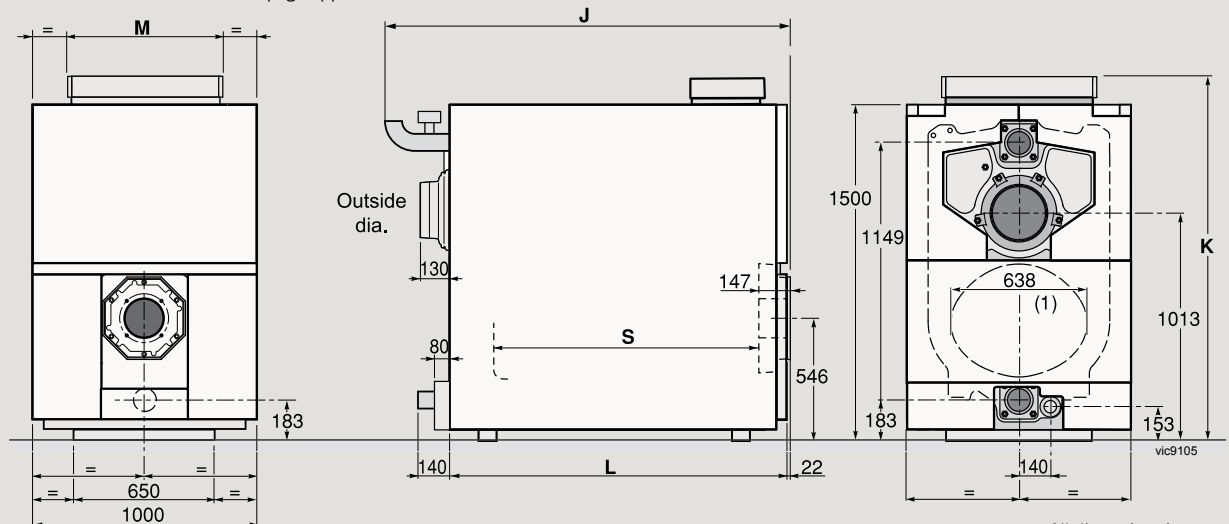

All dimensions in mm

Viceroy GTS 300 - 780 kW

Model		GTS 8	GTS 9	GTS 10	GTS 11	GTS 12	GTS 13	GTS 14
Sections		8	9	10	11	12	13	14
Output	kW	390	450	540	600	670	720	780
Height	mm	1605						
Width	mm	1000						
Depth	mm	1657	1817	1977	2137	2297	2457	2617
Flow / return connection	mm	75			100			
Flue size	mm	250			300			
Maximum working pressure	bar	6						
Water content	litre	366	409	452	495	538	581	624
Approx dry weight	kg	1802	2072	2238	2454	2638	2880	3057
Boiler clearances	front (mm)	1500	2000			2500		
	back (mm)	1000						
	left (mm)	500						
	right (mm)	500						
Seasonal efficiency	(gas) %	83.55	82.88	84.17	83.30	83.81		83.59
	(oil) %	86.90	86.20	87.50	86.60	87.20		86.90

Optional kits

Boiler	Viceroy GTS
Flue gas thermometer	✓



Viscount GTS 754 - 1450 kW

Pressure Jet



Viscount GTS 754 - 1450 kW

The cast iron Viscount GTS boiler range is designed to obtain the largest heat exchange surface in the most space efficient size, yet maintain long life and easy servicing. Low modulated temperature operation down to 40°C allows more fuel savings.

Features and benefits

- Gas fired, oil fired or dual fuel
- Minimal emissions
- 4 pass cast iron heat exchanger
- Comprehensive control
- Low temperature return
- Quick and simple erection
- Site assembly
- Left or right hinged burner door
- Single phase or 3 phase
- Packaged boiler include Nuway, Riello or EOGB as standard (options can be supplied on request)
- 1 year parts and labour warranty

Dimensions and clearances

Boiler	GTS 14	GTS 15	GTS 16	GTS 17	GTS 18	GTS 19	GTS 20	GTS 21	GTS 22	GTS 23	GTS 24	GTS 25
Dim A	1674	1785	1896	2007	2118	2229	2380	2491	2602	2713	2824	2935
Dim B	1744	1744	1966	1966	2188	2188	2450	2450	2672	2672	2894	2894
Dim C	1488	1488	1488	1488	1504	1504	1504	1504	1504	1504	1504	1504
Dim D	217	188	189	210	236	257	208	209	230	231	252	253
Dim L	2105	2245	2355	2445	2555	2645	2845	2955	3045	3155	3245	3355

Note: with models 21, 22, 23, 24 and 25, a plain plate which must be cut out is supplied without the 100 mm chimney connection.

All models dimensions and clearances on page opposite.

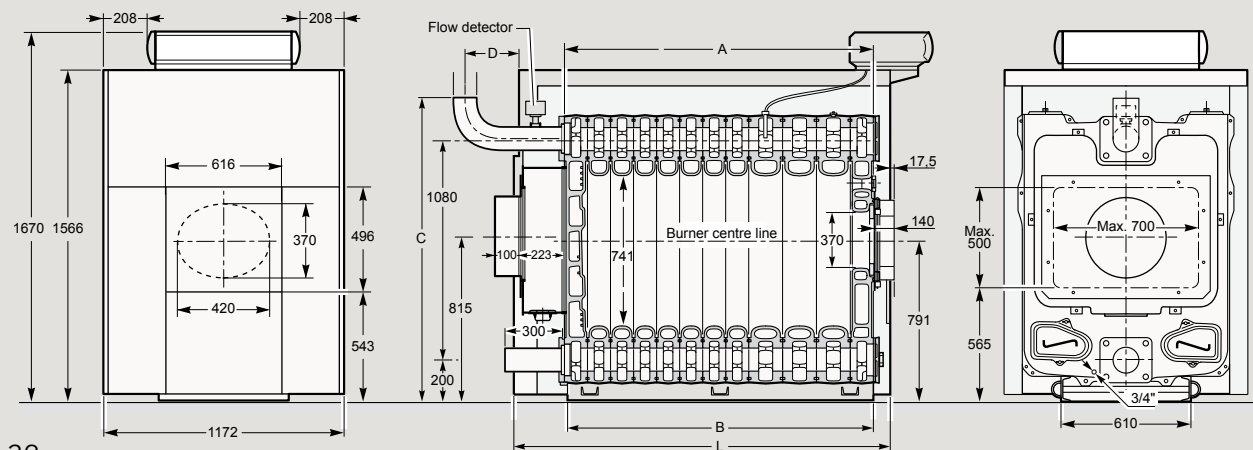

Viscount GTS 754 - 1450 kW

Model		GTS 14	GTS 15	GTS 16	GTS 17	GTS 18	GTS 19	GTS 20	GTS 21	GTS 22	GTS 23	GTS 24	GTS 25	
Sections		14	15	16	17	18	19	20	21	22	23	24	25	
Output	kW	812	870	928	986	1044	1102	1160	1218	1276	1334	1392	1450	
Height	mm	1670												
Width	mm	1172												
Depth	mm	2105	2245	2355	2445	2555	2645	2845	2955	3045	3155	3245	3355	
Flow / return connection	mm	139.7						159						
Flue size	mm	450				500				500x700max				
Maximum working pressure	bar	6												
Water content	litre	655	693	731	769	807	845	905	943	981	1019	1057	1095	
Approx dry weight	kg	3171	3364	3561	3756	3955	4124	4343	4538	4734	4930	5107	5297	
Boiler clearances	front (mm)	1500												
	back (mm)	300	436			656			936			1266		
	Right (mm)	1200												
Seasonal efficiency	(gas) %	84.29	84.23	84.91	84.26	84.33	84.55	84.48	84.73	84.53	84.34	84.64	84.97	
	(oil) %	87.70	87.60	88.30	87.60	87.70	87.90	87.90	88.10	87.90	87.90	88.00	88.40	

Optional kits

Boiler	Viscount GTS
Flue gas thermometer	✓



Vanguard L 340 - 3500 kW

Pressure Jet



Vanguard L 340 - 3500 kW

Vanguard L boilers are designed with a large combustion chamber positioned in the lower part of the heat exchanger, the Vanguard L range ensures maximum heat transfer efficiency (up to 92.5% net). The Vanguard L range is capable of an impressive output to size ratio.

Features and benefits

- Natural gas, oil fired or dual fuel
- Steel shell construction
- One or two stage operation
- High efficiency 92% net (83% gross)
- Reverse flame combination chamber design
- Easy to install and service
- 6 bar pressure as standard
- Supplied complete - not sectional
- Wide range of outputs
- Single phase or 3 phase
- Packaged boiler include Nuway, Riello or EOGB as standard (options can be supplied on request)
- 1 year parts and labour warranty

Dimensions and clearances

Boiler	340	420	510	630
Dim A	860	890	890	890
Dim B	1210	1275	1470	1780
Dim C	1182	1352	1352	1352
Dim D	190	190	190	190

Boiler	340	420	510	630
Dim I	1541	1606	1801	2113
Dim Q*	750	780	780	780
Dim R*	1112	1177	1372	1682

* Minimum dimensions for boiler room access requirements.

All models dimensions and clearances on page opposite.

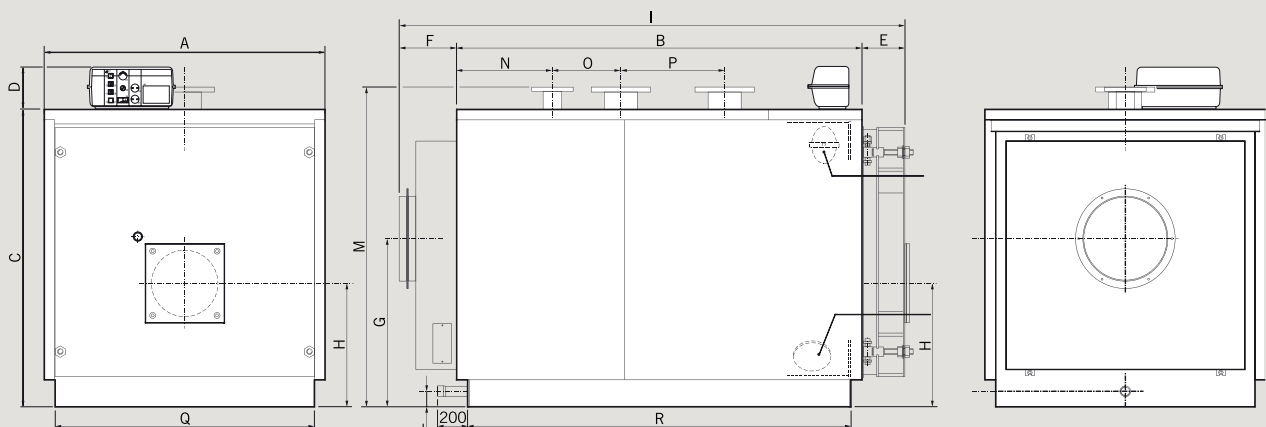

Vanguard L 340 - 3500 kW

Model		340	420	510	630	760	870
Output	kW	340	420	510	630	760	870
Height	mm	1372	1542			1622	
Width	mm	860	890			1122	
Depth	mm	1541	1606	1801	2113	1989	2184
Flow / return connection	mm	80	100			125	
Flue size	mm	250			350		
Maximum working pressure	bar	6					
Water content	litre	298	398	462	565	671	753
Approx dry weight	kg	629	796	919	1047	1341	1447
Boiler clearances	front (mm)	Same as boiler					
	back (mm)	500					
	left (mm)	100					
	right (mm)	200+ burner length					
Seasonal efficiency	(gas) %	84.06	84.19	84.20	84.21		
	(oil) %	87.42	87.56	87.57			

Model		970	1100	1320	1570	1850	2200	2650	3000	3500
Output	kW	970	1100	1320	1570	1850	2200	2650	3000	3500
Height	mm	1622			1732		1892		2080	2340
Width	mm	1122	1352		1462		1622		1670	1920
Depth	mm	2379	2346	2686	2781	3151	3225	3545	3835	3879
Flow / return connection	mm	125	150		175		200			
Flue size	mm	350	400		450		520		570	620
Maximum working pressure	bar	6								
Water content	litre	836	1040	1242	1418	1617	2086	2324	2553	4862
Approx dry weight	kg	1553	1821	2030	2780	3280	4145	4465	5110	6700
Boiler clearances	front (mm)	Same as boiler								
	back (mm)	500								
	left (mm)	100								
	right (mm)	200+ burner length								
Seasonal Efficiency	(gas) %	84.19	84.22	84.20	84.20	84.21	84.22	84.23	84.19	84.18
	(oil) %	87.56	87.59	87.56	87.57		87.59		87.55	87.54

Note: Models 1320 - 3500 are delivered direct to site.

Commercial Cylinders

Unvented 400 - 1200 Litres



Commercial Cylinders

The Ideal Commercial range of unvented cylinders is available from 400 to 1200 litres to meet hot water requirements in a variety of commercial premises.

Features and benefits

- 25 year warranty
- Duplex Stainless Steel
- Complete with unvented control kit
- Standby heat loss 2.82kW/hr over 24 hours
- Heat up time 45 minutes
- Recovery time with primary heat source only 24 minutes
- Low installation weight

Model Selection Guide

Required hot water capacity (litres)	Models	System configuration
500*	2 x 250L models	Figure 1 or Figure 2
600*	2 x 300L models	Figure 1 or Figure 2
700* ²	1 x 400L and 1 x 300L model	Figure 2
800*	2 x 400L models	Figure 1 or Figure 2
900*	3 x 300L models	Figure 1 or Figure 2
1000* ²	1 x 400L and 2 x 300L models	Figure 2
1200*	3 x 400L models	Figure 1 or Figure 2

* With cylinders of the same storage capacity please refer to configurations outlined in diagram 1.

*² With cylinders of different storage capacity please refer to configurations outlined in diagram 2.

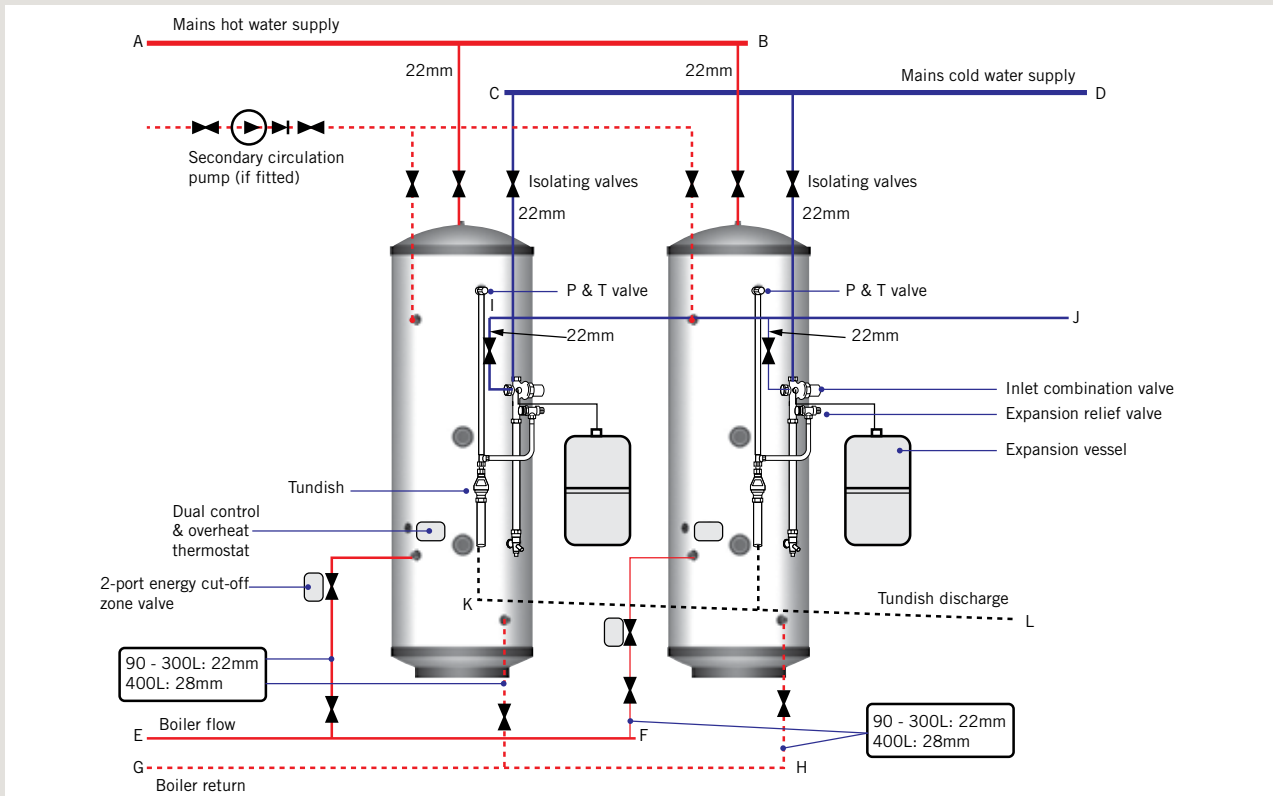

Diagram 1

The configuration shown in diagram 1 (shown above) should normally be used when there is only one hot water distribution network in the building. The cylinders coupled together in this configuration should have the same storage capacity.

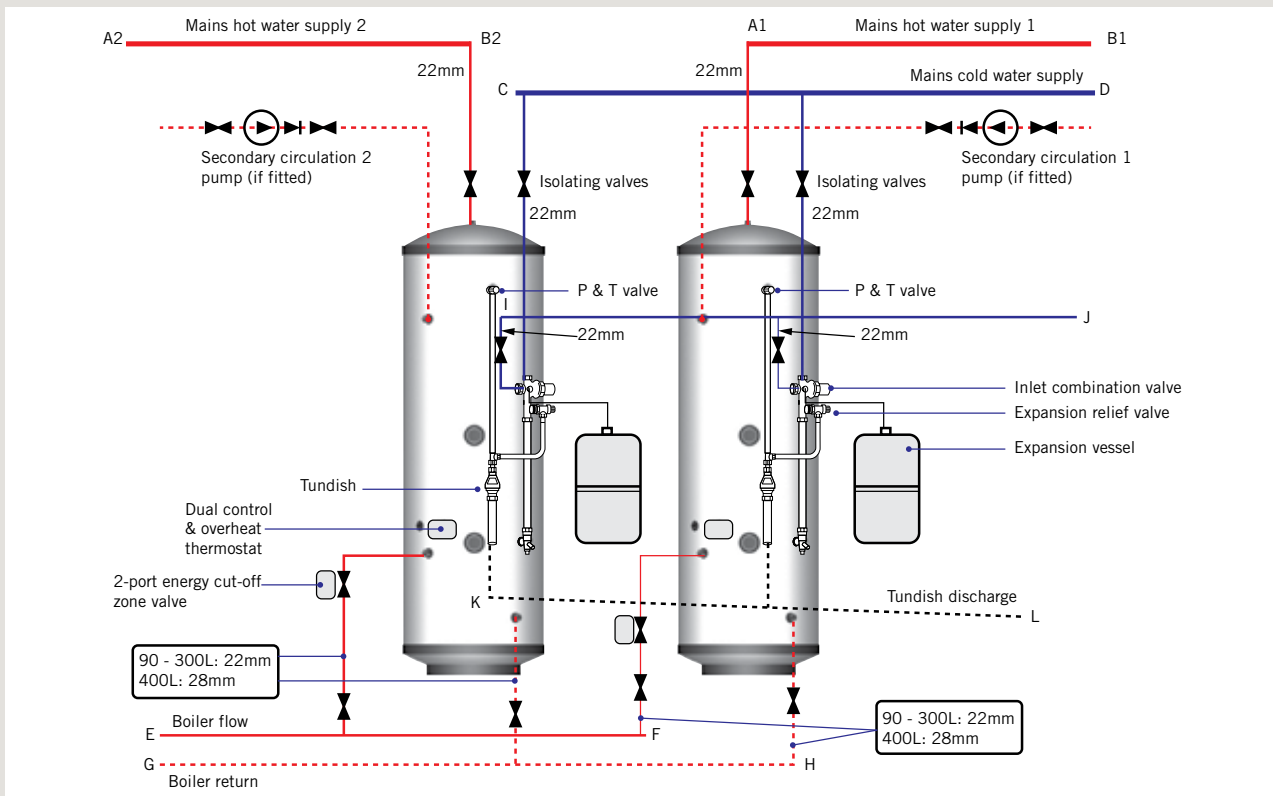

Diagram 2

The configuration shown in diagram 2 (shown above), should normally be used when there is more than one independent hot water distribution network in the building. Here, the cylinders coupled together can have different storage capacities because these supply different networks. The common boiler flow and return pipe work (EF & GH) should be sized for the total primary design flow rate through all the cylinder heat exchangers coupled together.

Note: Cylinders of equal size and water supply to be sized to feed both, alternatively a separate cold mains supply should be taken to each cylinder.

Stelrad Radiators

You probably know that Stelrad is the brand behind the UK's best selling and most popular radiator ranges. With nationwide availability from stock, models to perfectly suit any domestic or commercial application and a reputation for reliability and service.

We also have great new designs, styles and technological advances, making Stelrad even more of a flexible choice for you. Think radiators, think Stelrad - every time.



- Models: 183
- Heights: 300mm to 700mm
- Lengths: 400mm to 3000mm
- Outputs: 190 to 6033 watts, 650 to 20585 Btu/hr
- Types: P1, K1, P+ & K2
- Conforms to EN442

10
TEN YEAR
WARRANTY



Compact Range



- Compact Vertex models: 21
- Heights: 1800, 2000mm & 2200mm
- Lengths: 300mm to 700mm
- Outputs: 1146 to 3003 watts, 3910 to 10246 Btu/hr
- Types: P2 & K2
- Conforms to EN442



- Compact horizontal models: 200
- Heights: 300mm to 700mm
- Lengths: 400mm to 3000mm
- Outputs: 190 to 5883 watts, 647 to 20073 Btu/hr
- Types: P1, K1, P+ & K2
- Conforms to EN442



Compact K3



- Models: 40
- Heights: 300mm to 700mm
- Lengths: 400mm to 2400mm
- Outputs: 956 to 5734 watts, 3262 to 19564 Btu/hr
- Type: K3
- Conforms to EN442

10
TEN YEAR
WARRANTY



Towel Rails



- Models: 26
- Heights: 700mm to 1800mm
- Lengths: 400mm, 500mm & 600mm
- Outputs: 240 to 1022 watts, 820 to 3489 Btu/hr
- Choice of curved or straight
- Choice of white or chrome
- Conforms to EN442

5
FIVE YEAR
WARRANTY



Compact with Style Range



- Compact with Style Vertical models: 24
- Heights: 1600mm to 2200mm
- Lengths: 300mm to 700mm
- Outputs: 693 to 2772, watts 2365 to 9458 Btu/hr
- Types: P2 & K2
- Conforms to EN442

- Compact with Style horizontal models: 52
- Heights: 200mm to 600mm
- Lengths: 400mm to 2000mm
- Outputs: 235 to 3202 watts, 802 to 10925 Btu/hr
- Types: K1, P+ & K2
- Conforms to EN442

5
FIVE YEAR
WARRANTY



Planar Range



- Planar Vertical models: 12
- Heights: 1800mm, 2000mm & 2200mm
- Lengths: 400mm to 700mm
- Outputs: 1476 to 2961 watts, 5036 to 10103 Btu/hr
- Types: K1 & K2
- Conforms to EN442
- Planar horizontal models: 100
- Heights: 300mm to 700mm
- Lengths: 400mm to 3000mm
- Outputs: 235 to 4234 watts, 802 to 14448 Btu/hr
- Types: K1 & K2
- 6 tapings make the Planar ideal for commercial applications
- Conforms to EN442

5
FIVE YEAR
WARRANTY



Concord Range



- Choice of 4 different radiator options
- Concord Plane: 102 models, 3 heights, widths from 500mm to 3000mm
- Concord Lo-Line: 16 models, 2 heights and 8 length options
- Concord Vertical: 6 models, 2 heights and 3 length options
- Concord Slimline: 8 models, 2 height and 4 length options
- Outputs: 382 to 6276 watts, 1303 to 21419 Btu/hr
- Conforms to EN442

BIM



5
FIVE YEAR
WARRANTY

Classic Column Range



- Classic Column horizontal models: 54
- Heights: 300mm to 750mm
- Lengths: 444 to 1870mm
- Outputs: 288 to 2972 watts, 983 to 10140 Btu/hr
- Types: 2, 3 & 4 columns
- Conforms to EN442
- Classic Column Vertical models: 6
- Heights: 1800mm, 2000mm & 2500mm
- Lengths: 352 to 444mm
- Outputs: 868 to 1539 watts, 2962 to 5251 Btu/hr



BIM

5
FIVE YEAR
WARRANTY

NEW *Swing*



- Models: 12
- Heights: 1820mm & 2020mm
- Lengths: 504mm to 727mm
- Outputs: 1224 to 2376 watts, 4176 to 8107 Btu/hr
- Types: P+ & K2
- Conforms to EN442

5
FIVE YEAR
WARRANTY



Radical



- 33 models
- Heights: 300mm to 600mm
- Lengths: 400mm to 2000mm
- Outputs: 333 to 3234 watts,
1136 to 11034 Btu/hr
- Types: K1 & K2
- RIBA & CIBSE approved CPD courses available

GreenbuildAWARDS
Winner 2013
'Retro-fit Product of the Year'



 **Stelrad**
Europe's favourite radiator

Call 0870 849 8056
or visit www.stelrad.com



LST Standard

- Models: 72
- Heights: 500mm, 600mm & 800mm
- Lengths: 560mm to 1960mm
- Outputs: 196 to 2767 watts, 668 to 9442 Btu/hr
- Types: K1, P+ & K2
- Fully compliant with all safety standards
- Meets strict NHS requirements
- Conforms to EN442
- RIBA & CIBSE approved CPD courses available



LST Plus

- Models: 72
- Heights: 500mm, 650mm & 750mm
- Lengths: 650mm to 2050mm
- Outputs: 203 to 2511 watts, 692 to 8566 Btu/hr
- Types: K1, P+ & K2
- Complete one box solution
- Anti-bacterial paint as standard
- Integral remote sensing thermostat valve (Danfoss RA 2000)
- Tamper-proof lock-shield valve
- Arthritic control adaptor
- Meets strict NHS requirements
- Conforms to EN442
- RIBA & CIBSE approved CPD courses available





LST Plus Vertical

- Models: 3
- Heights: 2110mm
- Lengths: 560mm, 660mm & 760mm
- Outputs: 1335 to 1862 watts, 4555 to 6353 Btu/hr
- Type: K2
- Complete one box solution
- Anti-bacterial paint as standard

- Integral remote sensing thermostat valve (Danfoss RA 2000)
- Tamper-proof lock-shield valve
- Arthritic control adaptor
- Meets strict NHS requirements
- Conforms to EN442
- RIBA & CIBSE approved CPD courses available



NEW LST i Plus

- Models: 72
- Heights: 500mm, 650mm & 800mm
- Lengths: 650mm to 2050mm
- Outputs: 196 to 2767 watts, 669 to 9441 Btu/hr
- Types: K1, P+ & K2
- Complete one box solution
- Anti-bacterial paint as standard

- Integral remote sensing thermostat valve (Danfoss RA 2000)
- Tamper-proof lock-shield valve
- Arthritic control adaptor
- Meets strict NHS requirements
- Conforms to EN442
- RIBA & CIBSE approved CPD courses available



Ideal Commercial Training



These comprehensive one-day courses can be mixed and matched for individual installation and servicing companies. The course uses a simple step-by-step approach with hands on training to ensure all aspects of commissioning, servicing, and fault finding can be dealt with quickly and efficiently.

Commercial Boiler Training Courses

1 and 2 days

Courses are available on the following products:

- Evomax range (1 day) - Leeds & Reading
- Evomod range (1 day) - Leeds
- Imax Xtra (1 day) - Leeds
- Concord CX range (2 days - Hull only)
- Concord Super range (2 days - Hull only)

Each course covers the following:

- Product range overview
- Product specification
- Application and installation of products
- Electronic circuits and components
- Flue and accessory options
- Component overview, change and repair
- User controls
- Sequence of operation
- Fault finding
- Commissioning

The course involves discussion with tutors and demonstrations with practical advice.

Lunch and refreshments are provided and a certificate is awarded upon completion.

Price £80.00 for 1 day

(including VAT) per person

Price £160.00 for 2 days

(including VAT) per person

Training

Tel: 01482 498432

techincal.training@idealheating.com

Ideal Service & Support

At Ideal, we are committed towards delivering the highest levels of customer service. With over a century of experience in the heating industry, we know how important confidence and trust is to our customers.

You can be confident to know that you're partnering with a British manufacturer that's supported by a dedicated national service team, delivering help and advice to you and your customers throughout the year.

Our rigorous research and development procedures and manufacturing quality control checks, ensures that all of our products are produced to the highest standards; delivering total comfort and peace of mind.

The call centre team, based in Hull, East Yorkshire, is comprehensively trained to provide tailored advice. All calls will be answered by trained members of staff who will take ownership of the call. All of our trained staff are on-hand to assist with enquiries or help diagnose and resolve faults over the telephone. Should that not be possible, we will arrange an appointment for one of our engineers to visit. Our dedicated team of engineers are fully trained to exacting standards and are all Gas Safe registered.



Ideal Commercial Heating Service

Sales

Tel: 01482 498690

Fax: 01482 498299

Technical

Tel: 01482 498376

Fax: 01482 498621

commercial.services@idealheating.com

The Ideal Commercial Heating product range

Boiler output	kW	20	40	100	150	200	600	800	1000	1500	3500
	Btu/h (000)	68	136	340	511	682	2047	2729	3412	5118	11942
Condensing Boilers											
Evomax			30-150								
Evomax Cascade			30-600								
Imax Xtra				80-560							
Evomod							250-1000				
High Efficiency Boilers											
Concord Super Series 4				50-600							
Concord Super Plus							200-600				
Atmospheric Boilers											
Concord CXA/H			40-120								
Concord CXS/H			40-120								
Concord CXSi/H					110-180						
Concord ESi						140-380					
Pressure Jet Boilers											
Buccaneer GTE		21-39									
Falcon GTS			40-100								
Harrier GTS				105-330							
Viceroy GTS							300-780				
Viscount GTS								754-1450			
Vanguard L									340-3500		

Approval

These appliances are certified to G.A.D. 90/396 and B.E.D. 92/42 Safety and Performance Directives for gas boilers.

Ideal Commercial Heating pursues a policy of continuous improvement in design and performance of its products and reserves the right to vary specification without notice. Statutory rights of the consumer are not affected.

Please note:

The information in this brochure was correct at the time of going to print. Ideal Commercial Heating reserve the right to make any modifications to product specifications or any other details, without prior notification. For further clarification, please enquire in writing to the head office address (address below).

Ideal Commercial Heating

P.O. Box 103
National Avenue
Kingston Upon Hull
HU5 4JN

T: 01482 492251

F: 01482 448858

www.idealcommercialheating.com



FM 59915



OHS 593264